

MATCHLINE SEE DWG T-2

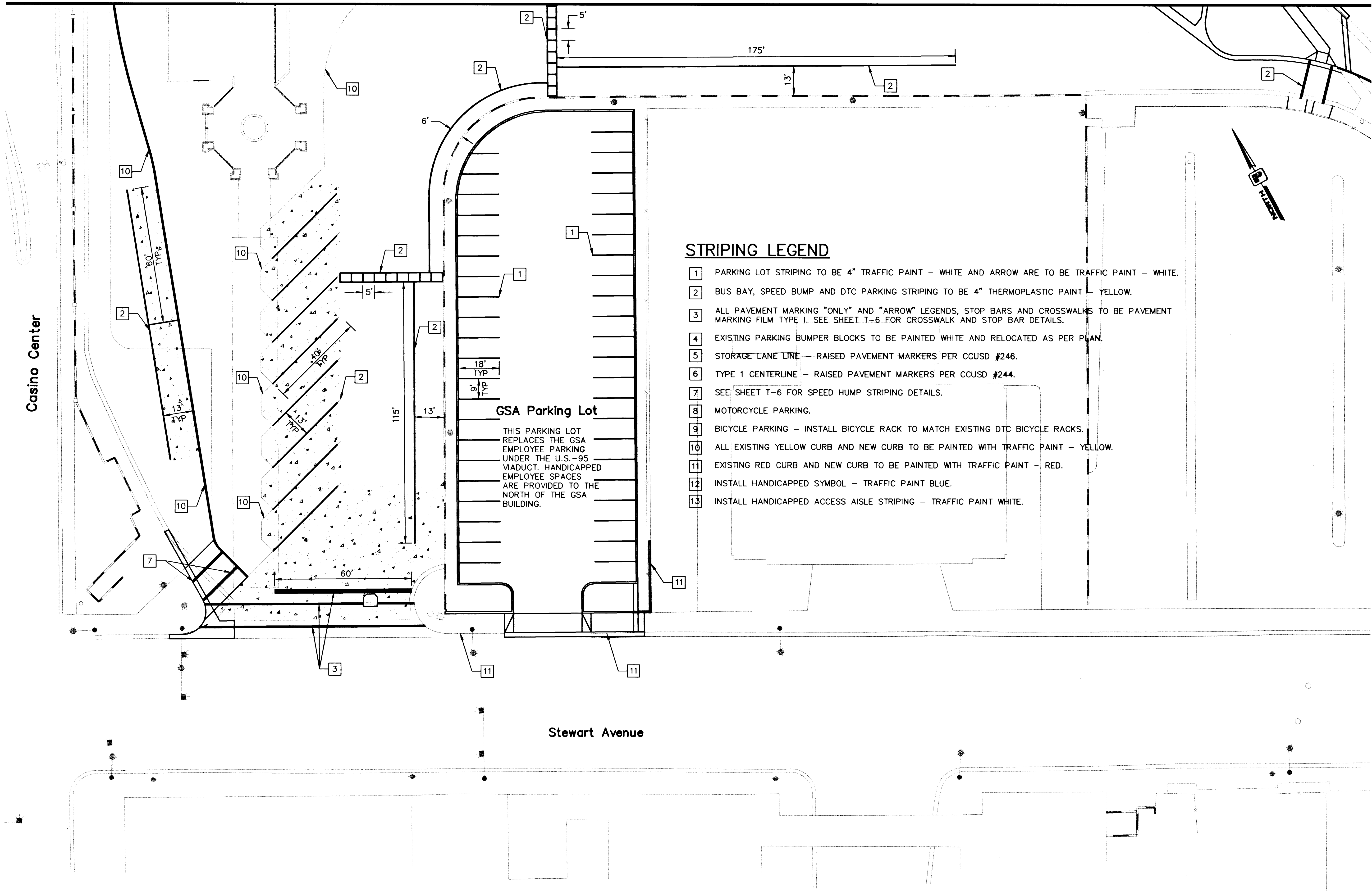

STRIPING LEGEND

- 1 PARKING LOT STRIPING TO BE 4" TRAFFIC PAINT - WHITE AND ARROW ARE TO BE TRAFFIC PAINT - WHITE.
- 2 BUS BAY, SPEED BUMP AND DTC PARKING STRIPING TO BE 4" THERMOPLASTIC PAINT - YELLOW.
- 3 ALL PAVEMENT MARKING "ONLY" AND "ARROW" LEGENDS, STOP BARS AND CROSSWALKS TO BE PAVEMENT MARKING FILM TYPE I. SEE SHEET T-6 FOR CROSSWALK AND STOP BAR DETAILS.
- 4 EXISTING PARKING BUMPER BLOCKS TO BE PAINTED WHITE AND RELOCATED AS PER PLAN.
- 5 STORAGE LANE LINE - RAISED PAVEMENT MARKERS PER CCUSD #246.
- 6 TYPE 1 CENTERLINE - RAISED PAVEMENT MARKERS PER CCUSD #244.
- 7 SEE SHEET T-6 FOR SPEED HUMP STRIPING DETAILS.
- 8 MOTORCYCLE PARKING.
- 9 BICYCLE PARKING - INSTALL BICYCLE RACK TO MATCH EXISTING DTC BICYCLE RACKS.
- 10 ALL EXISTING YELLOW CURB AND NEW CURB TO BE PAINTED WITH TRAFFIC PAINT - YELLOW.
- 11 EXISTING RED CURB AND NEW CURB TO BE PAINTED WITH TRAFFIC PAINT - RED.
- 12 INSTALL HANDICAPPED SYMBOL - TRAFFIC PAINT BLUE.
- 13 INSTALL HANDICAPPED ACCESS AISLE STRIPING - TRAFFIC PAINT WHITE.

GSA Parking Lot

THIS PARKING LOT REPLACES THE GSA EMPLOYEE PARKING UNDER THE U.S.-95 VIADUCT. HANDICAPPED EMPLOYEE SPACES ARE PROVIDED TO THE NORTH OF THE GSA BUILDING.

APPROVED

REVISIONS
DESCRIPTION

NO. DATE

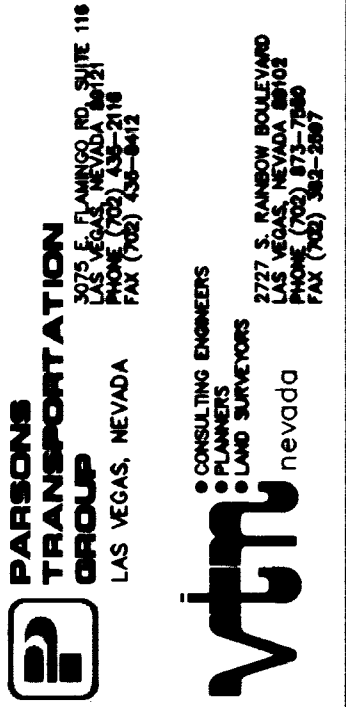
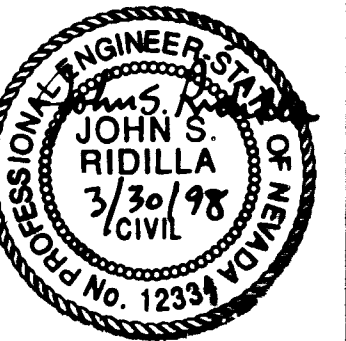

DOWNTOWN TRANSPORTATION CENTER REDESIGN
STRIPING PLAN
REGIONAL TRANSPORTATION COMMISSION

JOB NO. 641209
DATE: 03/30/98
HORIZ. SCALE: 1"=20'
VERT. SCALE: NONE
DRAWN BY: CDA
DESIGNED BY: JSR
APPROVED BY: JJC

DRAWING NO. 16 OF 29
T-1 OF T-6

PLT - VP-A (PS)
5228-STR.DWG - 03/30/98

G:\PROJECTS\641209\VTM\5228-STR.DWG Mon Mar 30 12:02:31 1998 Plotted by M.B.N.

MATCHLINE SEE DWG T-2

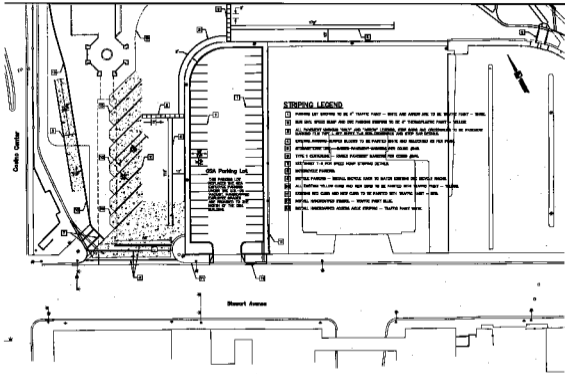

Civic Center

Garage Parking Lot

Street Avenue

STRIPING LEGEND

- 1. PARKING LOT STRIPING TO BE 4" TRAFFIC PAINT - WHITE AND CENTER LINE TO BE WHITE PAINT - BROWN
- 2. SIDE WALK STRIPING BUMP AND ONE PARKING STRIPING TO BE 4" THERMOPLASTIC PAINT - YELLOW
- 3. ALL PARKING STRIPING TRUCK AND TRUCKING STRIPING, CURB MARKS AND STRIPING TO BE PARKING STRIPING (SEE TOP L-1, 2, 3, 4, 5, 6, 7, 8, 9, 10, 11, 12, 13, 14, 15, 16, 17, 18, 19, 20, 21, 22, 23, 24, 25, 26, 27, 28, 29, 30, 31, 32, 33, 34, 35, 36, 37, 38, 39, 40, 41, 42, 43, 44, 45, 46, 47, 48, 49, 50, 51, 52, 53, 54, 55, 56, 57, 58, 59, 60, 61, 62, 63, 64, 65, 66, 67, 68, 69, 70, 71, 72, 73, 74, 75, 76, 77, 78, 79, 80, 81, 82, 83, 84, 85, 86, 87, 88, 89, 90, 91, 92, 93, 94, 95, 96, 97, 98, 99, 100)
- 4. STRIPING PARKING STRIPING BUMP TO BE PAVED WHITE AND STRIPING TO BE PAVED BROWN
- 5. STRIPING TRUCK AND TRUCKING STRIPING BUMP TO BE PAVED BROWN
- 6. TRUCK AND TRUCKING STRIPING BUMP TO BE PAVED BROWN
- 7. TRUCK AND TRUCKING STRIPING BUMP TO BE PAVED BROWN
- 8. TRUCK AND TRUCKING STRIPING BUMP TO BE PAVED BROWN
- 9. TRUCK AND TRUCKING STRIPING BUMP TO BE PAVED BROWN
- 10. TRUCK AND TRUCKING STRIPING BUMP TO BE PAVED BROWN
- 11. TRUCK AND TRUCKING STRIPING BUMP TO BE PAVED BROWN
- 12. TRUCK AND TRUCKING STRIPING BUMP TO BE PAVED BROWN
- 13. TRUCK AND TRUCKING STRIPING BUMP TO BE PAVED BROWN
- 14. TRUCK AND TRUCKING STRIPING BUMP TO BE PAVED BROWN
- 15. TRUCK AND TRUCKING STRIPING BUMP TO BE PAVED BROWN

DATE: 10/15/88	PROJECT: BOWLING GREEN TRANSPORTATION CENTER RECONSTRUCTION
DRAWN BY: J. W. BROWN	DESIGNED BY: J. W. BROWN
CHECKED BY: J. W. BROWN	APPROVED BY: J. W. BROWN
SCALE: AS SHOWN	DATE: 10/15/88
VERTICAL ENGINEERING INCORPORATED 1000 WEST BOWLING GREEN AVENUE BOWLING GREEN, KY 40304 (502) 795-1111	
BOWLING GREEN TRANSPORTATION CENTER RECONSTRUCTION EXHIBIT PLAN GENERAL TRANSPORTATION PLAN	