

LEGEND

	RAINBIRD XBT-10 OR XBT-20
	RAIN BIRD CONTROL VALVE 100-PEB (AS PER DETAIL)
	RAIN BIRD CONTROL VALVE 150-PEB (AS PER DETAIL)
	2' GATE VALVE
	2' SCH. 40 PVC MAIN SET IN 4' SCH. 40 PVC SLEEVE
	SCH. 40 PVC LATERAL PIPING (SIZES AS SHOWN)
	EXISTING IRRIGATION SLEEVE (UNDER ROADWAYS AND DRIVEWAYS) INSTALLED AS PART OF CONTRACT 1.
	NEW IRRIGATION SLEEVE (UNDER NEW HARDSCAPE) INSTALLED AS PART OF THIS CONTRACT.
	RAIN BIRD QUICK COUPLER VALVE (44NP)
	RAIN BIRD CLUSTER CONTROL UNIT #CCU-J-PH-TW-88
	RAIN BIRD SATELLITE CONTROLLER PAR 16-TW-88
	EXISTING/NEW WATER METER (REFER TO PLANS)
	2' BACKFLOW PREVENTION ASSEMBLY (CLA-VAL RP-4, CONBRACO 40-208-A2, OR EQUAL)

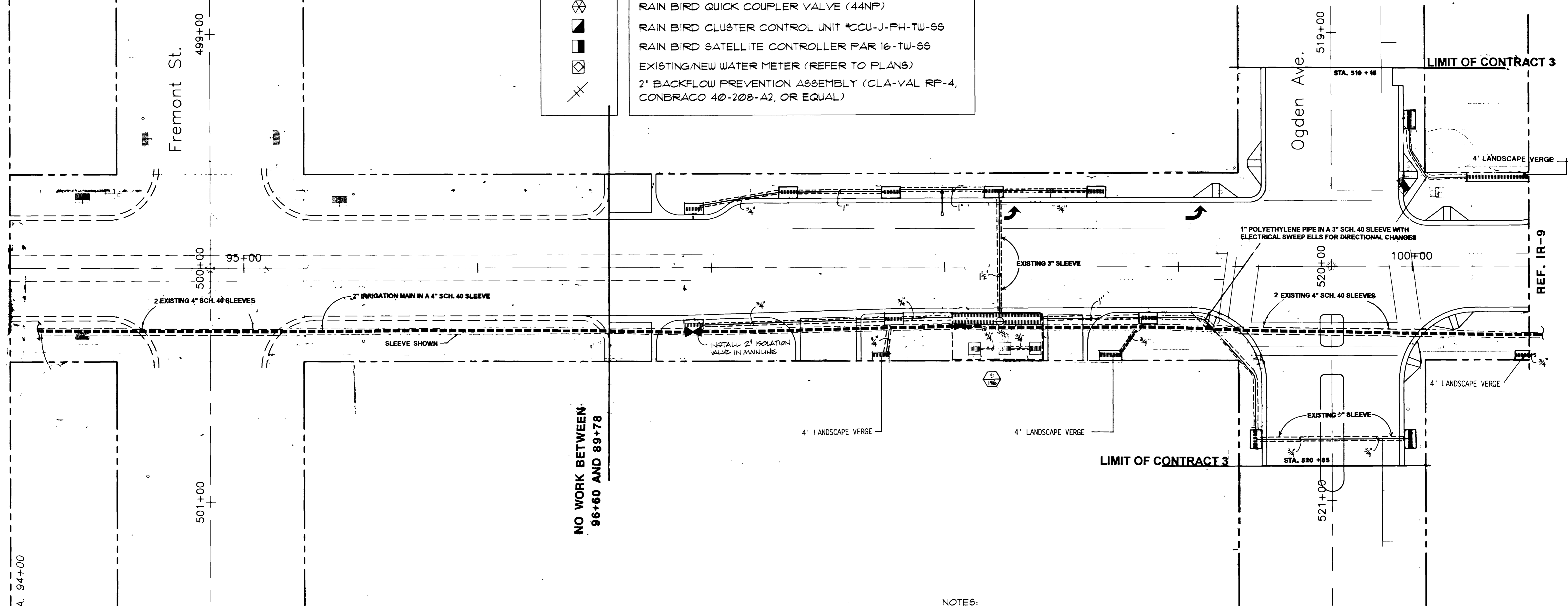

NOTE:
ALL CONTROL VALVES, QUICK COUPLERS, AND OTHER IRRIGATION SYSTEM APPARATUS SHALL ONLY BE INSTALLED IN LANDSCAPE VERGES.

- NOTES:**
1. ALL CONTROL VALVES, QUICK COUPLERS AND OTHER APPARATUS SHALL BE INSTALLED IN LANDSCAPE VERGE AREAS AND IN CONCRETE VALVE BOXES ADJACENT TO SIDEWALK AREAS.
 2. ALL SLEEVES UNDER ROADWAYS AND EXISTING DRIVEWAYS WERE INSTALLED UNDER CONTRACT 1 AND SHALL BE CONSIDERED BY OTHERS FOR THE PURPOSES OF THIS CONTRACT. SLEEVE LOCATIONS DEPICTED ON PLAN DRAWINGS ARE REPRESENTATIONAL ONLY. CONTRACTOR SHALL FIELD LOCATE ALL SLEEVES AND MAKE ANY NECESSARY PIPING ADJUSTMENTS. ADDITIONALLY, CONTRACTOR SHALL BE RESPONSIBLE FOR INSTALLATION OF SLEEVES UNDER ANY NEW HARDSCAPE UNDER THIS CONTRACT. (REF. SLEEVING SIZE DETAIL, SHT IR - 10)

Call before you Dig.
1-800-227-2600

NO.	REVISIONS	DATE	BY



Kimley-Horn and Associates, Inc.
Las Vegas, Nevada © 1994

DESIGNED BY
DRAWN BY
CHECKED BY
NOTE BOOK NO.



DOWNTOWN CORRIDOR IMPROVEMENTS
CITY OF LAS VEGAS DEPT. OF PUBLIC WORKS
LAS VEGAS, NEVADA
CONTRACT 3 - 4TH STREET
(CHARLESTON BLVD. TO STEWART AVE.)

DATE 9/1/95
SCALE 1"=20'

IRRIGATION PLAN
STA. 96+60 TO STA. 100+50

DWG. NO. 107-V-2288A
FILE NO.
IR-8
SHEET 28 OF 49

