

A301

5-13-96

95260

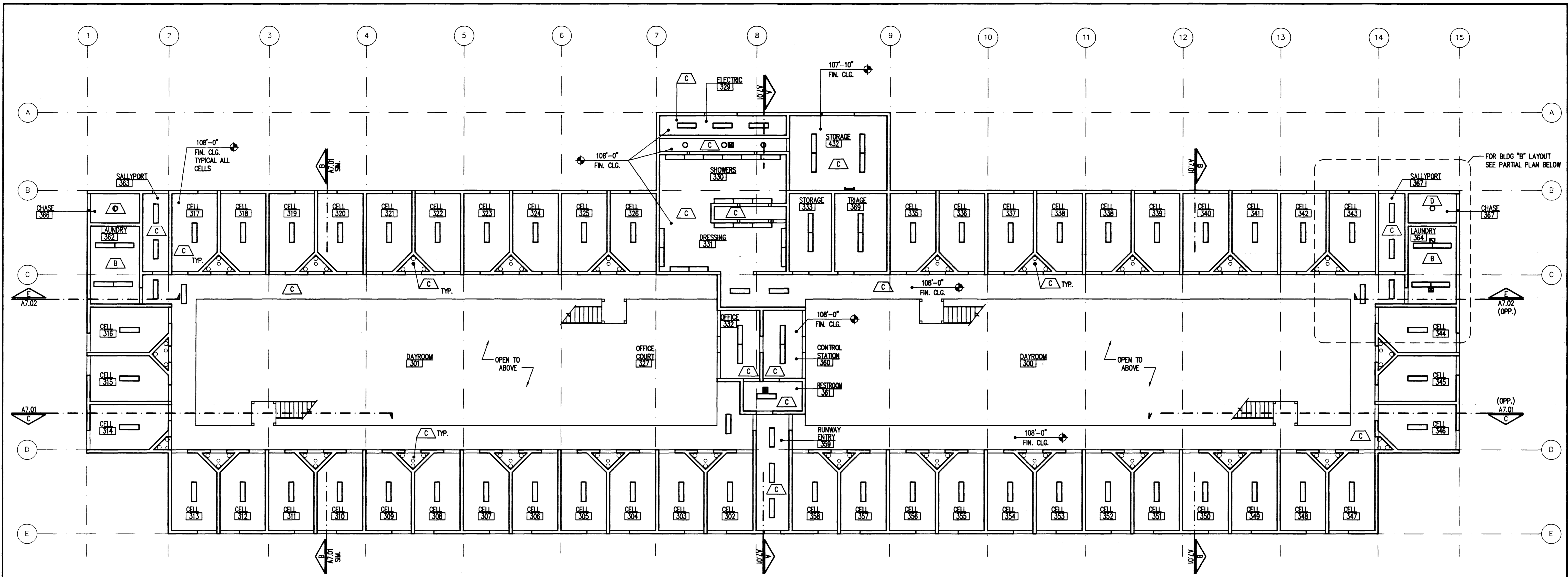

FIRST FLOOR REFLECTED CEILING PLAN - BUILDING 'A' - MALE HOUSING UNIT

SCALE: 1/8"=1'-0"

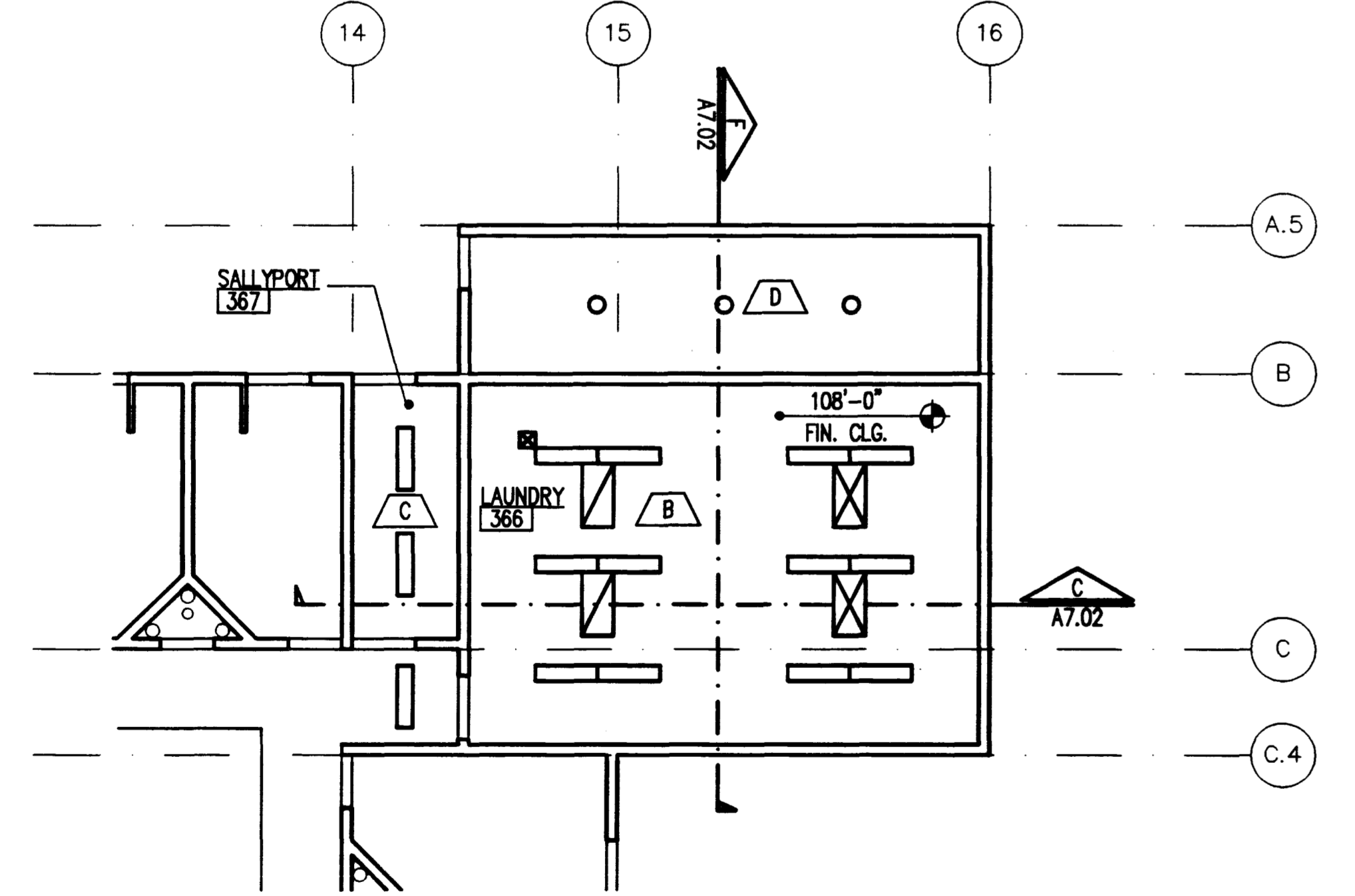

PARTIAL FIRST FLOOR REFLECTED CEILING PLAN - BUILDING 'B' - MALE HOUSING UNIT

SCALE: 1/8"=1'-0"

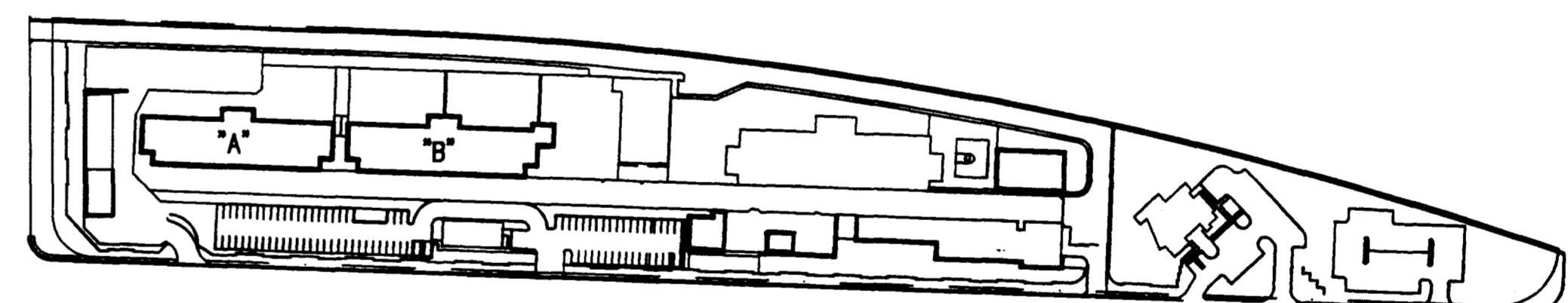

KEY PLAN

REFLECTED CEILING PLAN LEGEND	GENERAL NOTES	CEILING JOIST SCHEDULE	SYMBOL LEGEND																																			
<p>A ACT. - ACOUSTICAL TILE CEILING SUSPENDED. (SEE SPECIFICATIONS).</p> <p>B GYPSUM BOARD CEILING ON JOISTS. SEE CEILING JOIST SCHEDULE.</p> <p>C CONCRETE CEILING</p> <p>D OPEN TO STRUCTURE</p>	<p>1. COORDINATE ALL ROOF PENETRATIONS WITH MECHANICAL AND STRUCTURAL DRAWINGS.</p>	<table border="1"> <thead> <tr> <th>SPAN</th> <th>JOISTS</th> <th>S (IN 3)</th> <th>I (IN 4)</th> <th>BRIDGING (ROWS)</th> </tr> </thead> <tbody> <tr> <td>8'-0"</td> <td>40 SJ 18</td> <td>0.439</td> <td>0.882</td> <td>1</td> </tr> <tr> <td>9'-0"</td> <td>40 SJ 16</td> <td>0.555</td> <td>1.116</td> <td>1</td> </tr> <tr> <td>14'-0"</td> <td>60 SJ 20</td> <td>0.588</td> <td>1.787</td> <td>2</td> </tr> <tr> <td>15'-6"</td> <td>60 SJ 18</td> <td>0.779</td> <td>2.351</td> <td>2</td> </tr> <tr> <td>18'-0"</td> <td>725 SJ 18</td> <td>1.023</td> <td>3.732</td> <td>2</td> </tr> <tr> <td>19'-6"</td> <td>725 SJ 16</td> <td>1.304</td> <td>4.754</td> <td>2</td> </tr> </tbody> </table> <p>NOTES: 1. THE ABOVE SCHEDULE IS BASED ON USG STEEL FRAMING SYSTEM WITH JOIST SPACING AT 16" O.C. 2. BRIDGING GAUGE TO MATCH JOIST. 3. DEFLECTION IS LIMITED TO L/360.</p>	SPAN	JOISTS	S (IN 3)	I (IN 4)	BRIDGING (ROWS)	8'-0"	40 SJ 18	0.439	0.882	1	9'-0"	40 SJ 16	0.555	1.116	1	14'-0"	60 SJ 20	0.588	1.787	2	15'-6"	60 SJ 18	0.779	2.351	2	18'-0"	725 SJ 18	1.023	3.732	2	19'-6"	725 SJ 16	1.304	4.754	2	<p> 2'x2' LIGHT FIXTURE (SEE ELECTRICAL DRAWINGS)</p> <p> 1'x4' LIGHT FIXTURE (SEE ELECTRICAL DRAWINGS)</p> <p> 2'x4' AIR RETURN- (SEE MECHANICAL DRAWINGS)</p> <p> 2'x2' AIR RETURN- (SEE MECHANICAL DRAWINGS)</p> <p> AIR SUPPLY - SEE MECHANICAL</p> <p> SMOKE EVACUATION - SEE MECHANICAL</p> <p> EXHAUST FAN (SEE ELECTRICAL DRWS)</p> <p> WALL MOUNTED AIR DIFFUSER SEE MECHANICAL</p>
SPAN	JOISTS	S (IN 3)	I (IN 4)	BRIDGING (ROWS)																																		
8'-0"	40 SJ 18	0.439	0.882	1																																		
9'-0"	40 SJ 16	0.555	1.116	1																																		
14'-0"	60 SJ 20	0.588	1.787	2																																		
15'-6"	60 SJ 18	0.779	2.351	2																																		
18'-0"	725 SJ 18	1.023	3.732	2																																		
19'-6"	725 SJ 16	1.304	4.754	2																																		

SYM.	DESCRIPTION	DATE	BY

DO NOT SCALE DRAWINGS

12.573

All designs, arrangements and plans indicated or presented by this drawing, as instruments of service, are owned by and the property of DOMINGO CAMBEIRO CORPORATION. To alter these documents for any project by anyone other than the original architect is a violation of NRS 623. The plans and/or specifications shall be restricted to the original site for which they were prepared and publication thereof is expressly limited to such use. Reproduction, publication or re-use by any method in whole or in part, is prohibited. None of such designs, arrangements or plans shall be used by or disclosed to any person, firm, agency, or corporation without the written permission of DOMINGO CAMBEIRO CORPORATION. Visual contact with these plans and specifications shall constitute prima facie evidence of acceptance of these restrictions.

© DOMINGO CAMBEIRO CORPORATION 1996

SEAL

Domingo Cambeiro Corporation
 ARCHITECTURE • ENGINEERING • PLANNING • INTERIORS
 3555 PECOS-McLEDD IC. LAS VEGAS, NEVADA 89121-3805 (702) 732-0084 FAX. 732-9802

REV	DESCRIPTION	DATE	BY

PROJECT
**CITY OF LAS VEGAS
 DETENTION FACILITY HOUSING EXPANSION**
 3100 EAST STEWART AVENUE
 LAS VEGAS, NEVADA

FIRST FLOOR REFLECTED CEILING PLAN

DRAWING NO.
A3.01

DATE
 5-13-96

JOB NO. 95260
 FILE NO. 9260A301.DWG
 513-552b Sheet 19 of 92

