

C5.01 R.3

12.4.96

95260

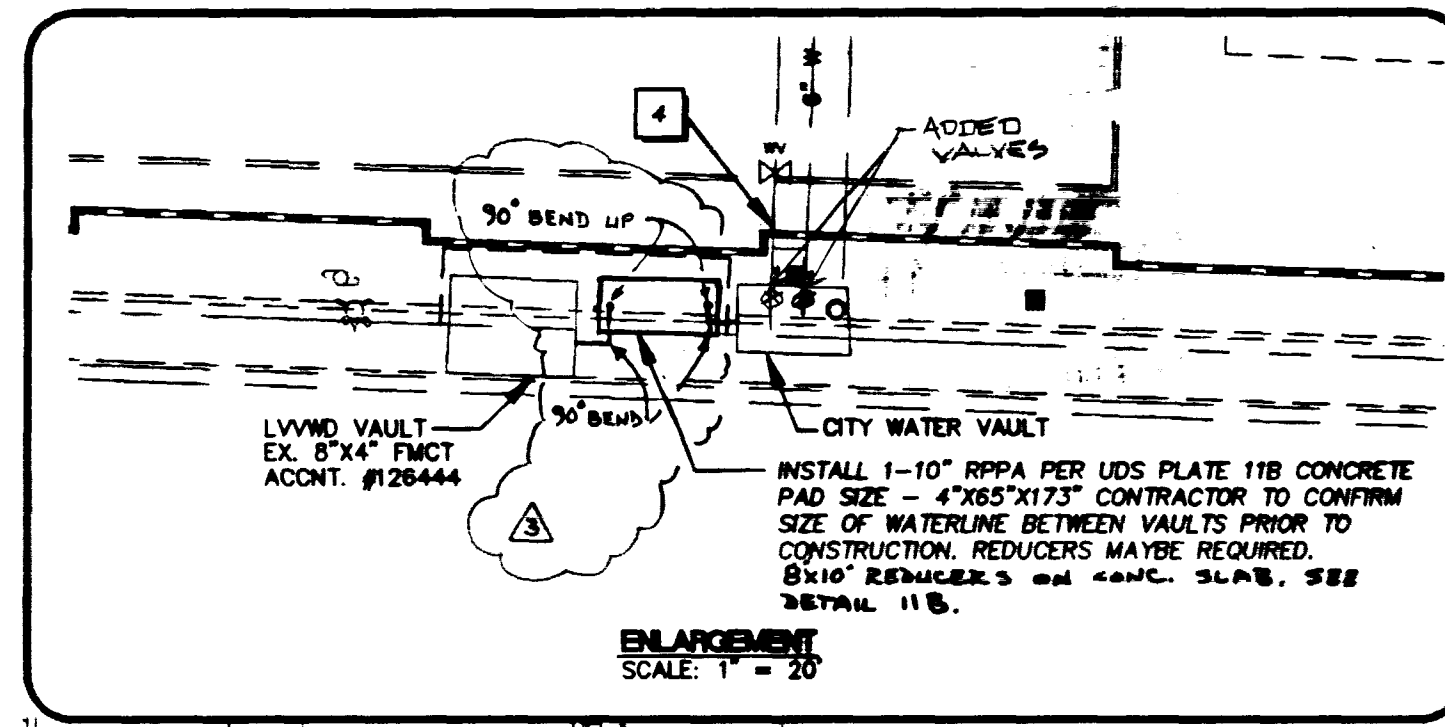

FIRE FLOW CALCULATIONS

FIRE FLOW REQUIREMENT IS: 1500 GALLONS PER MINUTE AT 20 PSI RESIDUAL PRESSURE.

BASED ON:	A	B	C	BUILDING IDENTIFIER
SQUARE FOOTAGE:	39499	39700	6961	SQUARE FEET
LARGEST AREA BETWEEN 4-HOUR AREA SEPARATION WALLS:	NA	NA	NA	SQUARE FEET
BUILDING HEIGHT:	24'	24'	15'	FEET
NUMBER OF STORIES:	TWO	TWO	ONE	FLOOR
TYPE OF CONSTRUCTION:	1	201	NA	SM
OCCUPANCY:	1	201	NA	
FULL AUTOMATIC FIRE SPRINKLER SYSTEM:	YES	YES	YES	

REVIEWED BY: *[Signature]*

DATE: 9-10-96

CONSTRUCTION KEY NOTES (ALL KEY NOTES NOT NECESSARILY SHOWN ON THIS SHEET)

- EXISTING WATERLINE TO BE REMOVED.
- EXISTING SANITARY SEWER TO BE REMOVED PER DESIGN AND CONSTRUCTION STANDARDS FOR WASTEWATER COLLECTION SYSTEMS (UDCS) SECTION 3.14.
- CAUTION: POSSIBLE 3" ELECTRICAL CONDUIT NEAR 2" WL.
- STUB AND CAP EXISTING WATER LATERAL PER NOTE BELOW OR PER LVWD STANDARDS.
- 18" MINIMUM VERTICAL SEPARATION BETWEEN SANITARY SEWER AND WATERLINE.

REDUCED PRESSURE PRINCIPLE ASSEMBLY 1 - 8" - 1 - 10"

APPROVED REDUCED PRESSURE PRINCIPLE ASSEMBLY(S) SHALL BE INSTALLED PER THE UDACS PLATE NO. 118 NO WATER SHALL BE TAKEN FROM A SERVICE REQUIRING BACKFLOW PREVENTION UNTIL THE REDUCED PRESSURE PRINCIPLE ASSEMBLY HAS BEEN SUCCESSFULLY TEST BY THE LVWD.

ANY BLOCK WALL OR OTHER FENCE MATERIAL SHALL BE DESIGNED AND CONSTRUCTED AROUND THE OUTSIDE OF THE EASEMENT(S) TO ALLOW THE DISTRICT DIRECT ACCESS FROM THE ADJACENT RIGHT-OF-WAY.

GENERAL UTILITY CONSTRUCTION NOTES

- WATER LINES TO HAVE THRUST BLOCKS CONSTRUCTED PER UDS PLATE NO. 5.
- NET TAPS TO BE CONSTRUCTED IN CONFORMANCE WITH UDS PLATE NO. 22 (OPTION).
- TRENCH BACKFILL FOR WATER LINES TO BE CONSTRUCTED PER UDS PLATE NO. 6B.
- TRENCH BACKFILL FOR SEWER LINES TO BE CONSTRUCTED PER SD-16A.
- CONTRACTOR TO LOCATE AND VERIFY SIZE, LINETYPE, CONDITION, DEPTH, PRESSURE, AND LOCATION OF ALL EXISTING UTILITY LINES WITHIN THE CONSTRUCTION AREA PRIOR TO CONSTRUCTION. THE CIVIL ENGINEER SHALL BE CONTACTED ONCE THE UTILITY LINE IS LOCATED.
- THESE DRAWINGS MAY NOT INDICATE ALL EXISTING BURIED UTILITY LINES. CONTRACTOR IS TO EXERCISE GREAT CARE DURING EXCAVATION IN ORDER TO AVOID MAKING CONTACT WITH ANY EXISTING UTILITY LINES IF UTILITY LINES ARE DAMAGED BY THE CONTRACTOR, SUCH DAMAGE SHALL BE REPLACED TO THE SATISFACTION OF THE OWNER AT THE CONTRACTORS EXPENSE.
- CONTRACTOR TO SAWCUT AND REMOVE EXISTING ASPHALT AND CONCRETE AS NECESSARY FOR UTILITY TRENCHES, BACKFILL AND PATCH ALL TRENCHES AS INDICATED IN DETAILS AND /OR ACCORDING TO THE GOVERNING ENTITY (CITY OF LAS VEGAS).
- INSTALLATION OF ALL UTILITY LINES SHALL BE COORDINATED WITH THE CITY OF LAS VEGAS DETENTION FACILITY AND C.L.V. FIRE DEPARTMENT TO MINIMIZE DISRUPTION OF DETENTION FACILITY ACTIVITIES.

SANITARY SEWER CONTRIBUTION (ESTIMATE)

AVERAGE DAILY FLOW = 131.8 GPM (0.283 CFS)

PEAK FLOW = 500 GPM (1.114 CFS)

Call before you Dig
1-800-227-2600

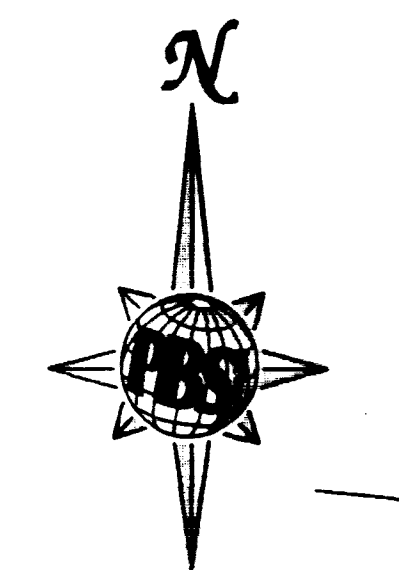

BENCHMARK

CITY OF LAS VEGAS BENCHMARK NUMBER 2LV013604:
RIVET AND PLATE IN TOP OF CURB SOUTHEAST RETURN OF STEWART AVE. AND MOJAVE ROAD.
NAVD 88 1812.31 FEET
552.3933 METERS

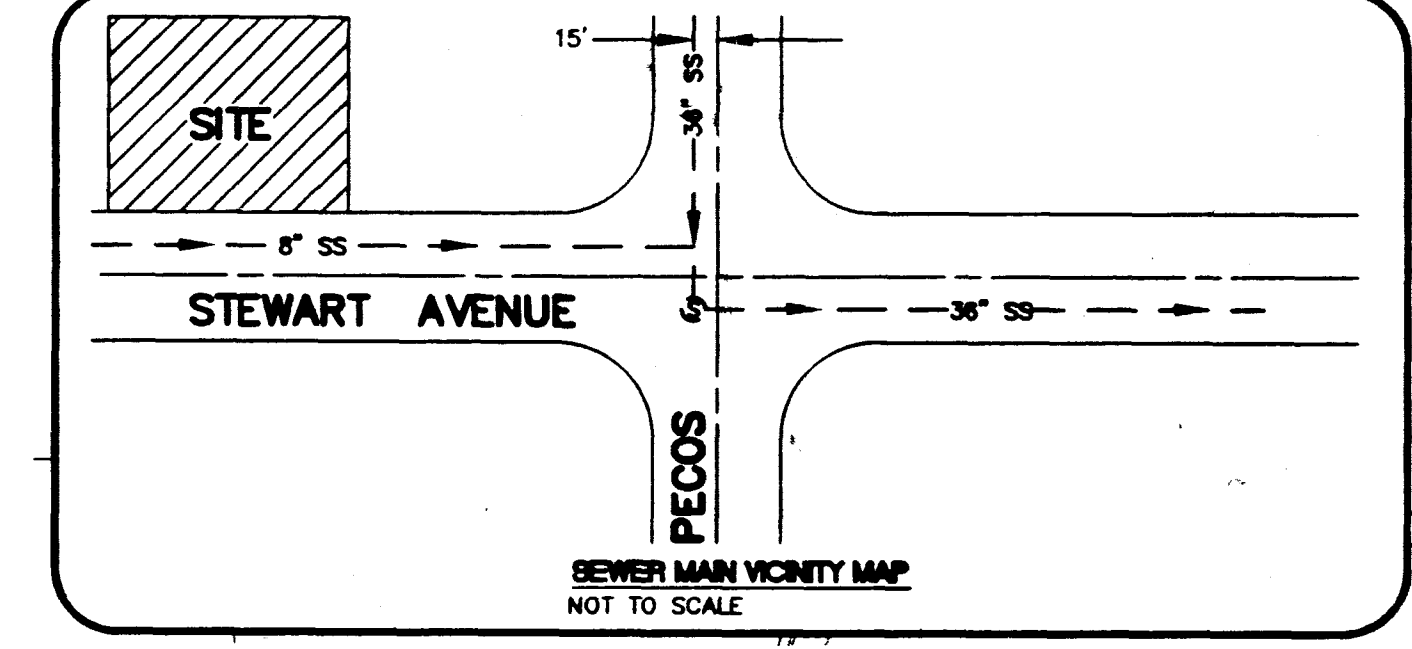
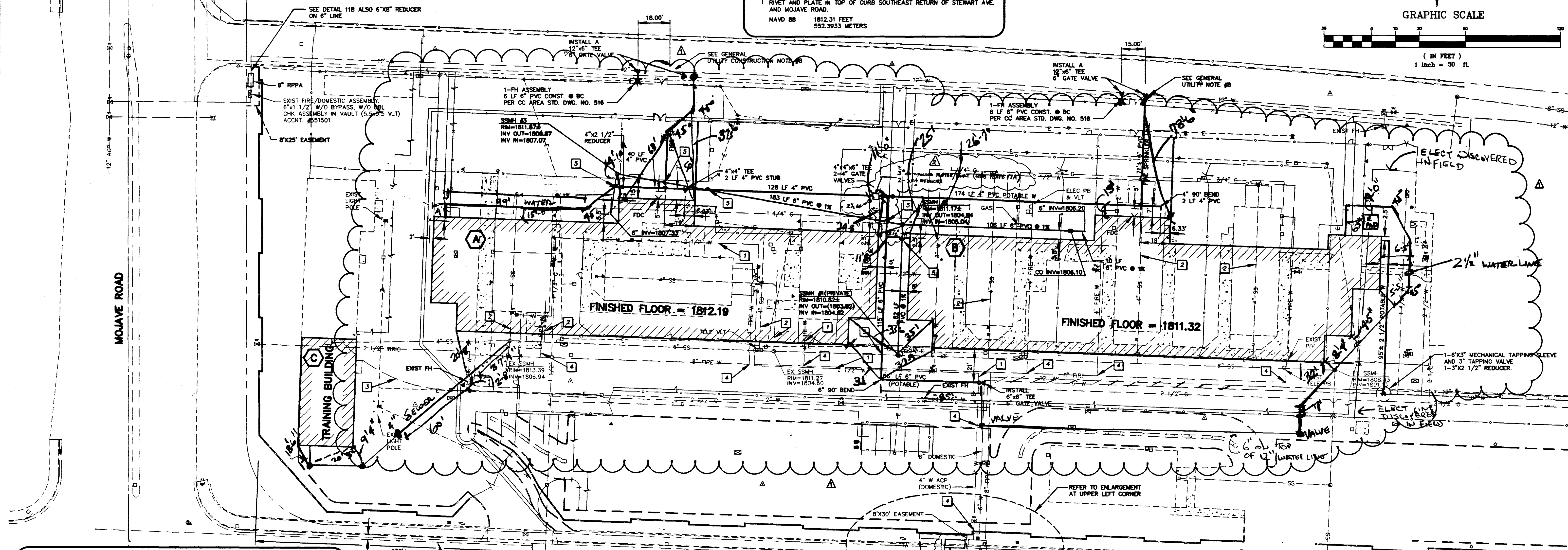

CUT AND CAP

THE CONTRACTOR SHALL CUT THE EXISTING PIPE WHERE SHOWN ON THE DRAWING AND INSTALL A MECHANICAL JOINT CAP. WHERE A JOINT OR COUPLING IN THE EXISTING PIPE IS UNCOVERED AT THE CUT AND CAP LOCATIONS, THE INSTALLATION OF A CAP OR PLUG MAY BE PERMITTED, WITH APPROVAL.

THE CONTRACTOR SHALL INSTALL A CONCRETE THRUST BLOCK IN ACCORDANCE WITH THE PROVISIONS OF THE UDAC STANDARD PLATE NO. 5 AT ALL INSTALLED CAPS AND OR PLUGS.

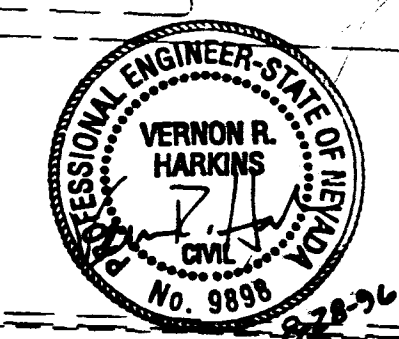

APPROVED

[Signature] 9/11/96

LAS VEGAS VALLEY WATER DISTRICT

DATE

C:\dms\955\955.DWG Wed Aug 28 10:13:27 1996

REVISIONS

REV	DESCRIPTION	DATE	BY
A	RELOCATED BUILDING 8.67 WEST	8/28/96	
B	3" HOUSE METER FOR S.B.O.C.	8/29/96	
C	RELOCATE 10" RPPA TO BSW GAS VALVE	10/4/96	

© DOMINGO CAMBEIRO CORPORATION 1996

DO NOT SCALE DRAWINGS

All designs, arrangements and plans indicated or presented by this drawing, as instruments of service, are owned by and the property of DOMINGO CAMBEIRO CORPORATION. The plans and/or specifications shall be restricted to the original site for which they were prepared and publication thereof is expressly limited to such use. Reproduction, publication or re-use by any method in whole or in part, is prohibited. None of such designs, arrangements or plans shall be used by or disclosed to any person, firm, agency, or corporation without the written permission of DOMINGO CAMBEIRO CORPORATION. Visual contact with these plans and specifications shall constitute prima facie evidence of acceptance of these restrictions.

Domingo Cambeiro Corporation

ARCHITECTURE • ENGINEERING • PLANNING • INTERIORS

3555 PECOS-McLEOD IC. LAS VEGAS, NEVADA 89121-3805 (702) 732-0084

POST, BUCKLEY, SCHUH & ERNGAN

201 North Green Valley Pkwy
Suite 100
Henderson, Nevada 89044
Telephone 702/263-7275
Fax 702/263-7200

ENGINEERING • PLANNING • SURVEYING • CONSTRUCTION SERVICES

DRAWN BY: KAW
CHECKED BY: VRH
DATE: 8/27/96

DETENTION FACILITY EXPANSION AT STEWART AVENUE AND MOJAVE ROAD

UTILITY PLAN

SHEET NO. **C5.01**

SHEET 5 OF 6

JOB NO. 51955
FILE NO. 955UT BR-UT1

AS BUILT DRAWING
DATE 10/20/97

