

REVISIONS			
NO.	DESCRIPTION	BY	APPD.

# DIAMOND HEAD VILLAS - PHASE 2

OWNER / DEVELOPER  
 CHANDLER CONSTRUCTION  
 3321 SUNRISE AVENUE  
 LAS VEGAS, NEVADA 89101  
 TEL (702) 438-3239

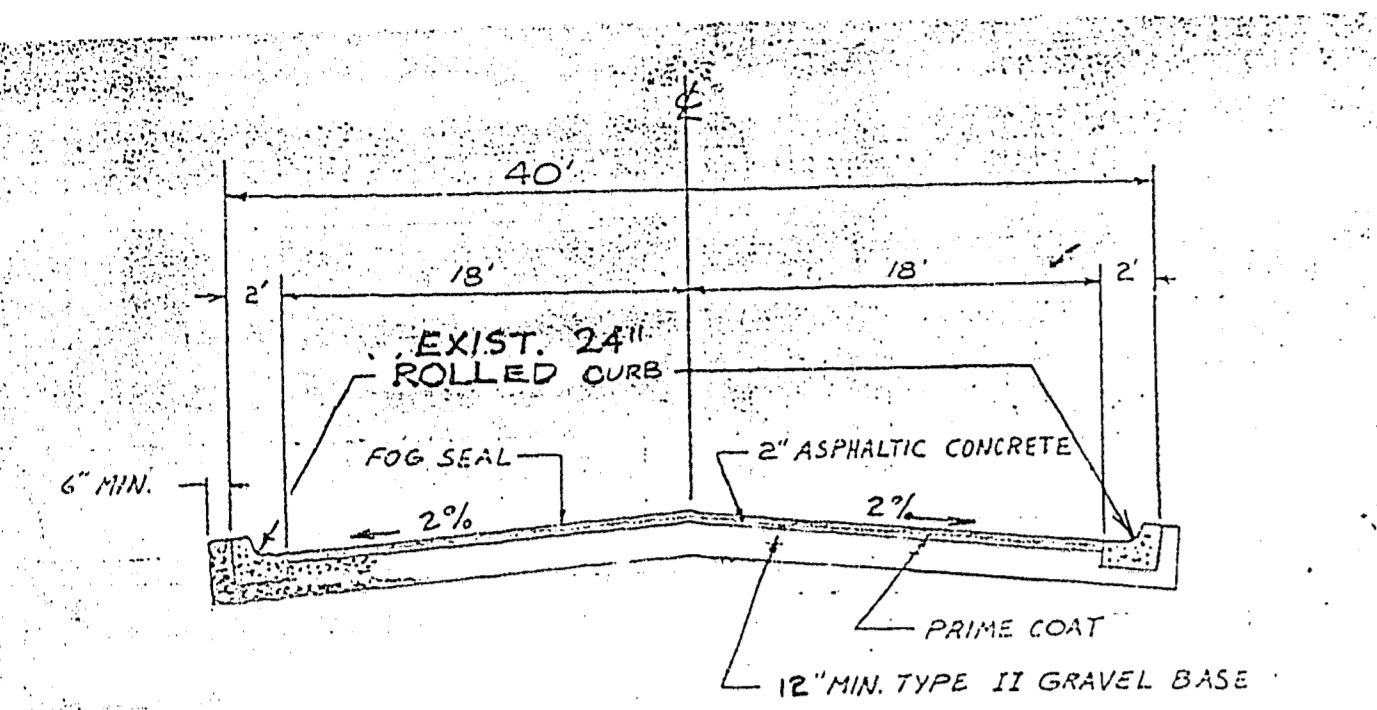

AC PAVEMENT TO BE 1/2" ABOVE LIP OF CURB AFTER COMPACTION  
**ROXELLA LANE**  
 (NO SCALE) (TYPICAL PRIVATE STREET)  
 40' STREET SECTION  
 ROXELLA LANE

CITY OF LAS VEGAS GENERAL NOTES

- \* REQUIRED NOTES - OTHERS ONLY IF APPLICABLE
- \*1. ALL CONSTRUCTION AND MATERIALS SHALL BE IN ACCORDANCE WITH THE "UNIFORM STANDARD SPECIFICATIONS FOR PUBLIC WORKS CONSTRUCTION OFF-SITE IMPROVEMENTS, CLARK COUNTY AREA, NEVADA" LATEST ISSUE. THE "UNIFORM STANDARD DRAWINGS FOR PUBLIC WORKS CONSTRUCTION, CLARK COUNTY AREA, NEVADA, LATEST ISSUE, AND OTHER APPLICABLE APPROVED STANDARDS ISSUED BY THE CONTROLLING AGENCY, THE UNIFORM BUILDING CODE, AND ALL LOCAL CITY CODES AND ORDINANCES APPLICABLE, EXCEPT AS NOTED ON THIS SHEET AS "DEVIATIONS FROM STANDARDS."
- \*2. THE EXISTENCE AND LOCATION OF ANY OVERHEAD OR UNDERGROUND UTILITY LINES, PIPES, OR STRUCTURES SHOWN ON THESE PLANS ARE OBTAINED BY A RESEARCH OF THE AVAILABLE RECORDS. EXISTING UTILITIES ARE LOCATED ON PLANS ONLY FOR THE CONVENIENCE OF THE CONTRACTOR. EXISTING UTILITY SERVICE LATERALS MAY NOT BE SHOWN ON THE PLANS. THE CONTRACTOR SHALL AT HIS OWN EXPENSE, LOCATE ALL UNDERGROUND AND OVERHEAD INTERFERENCES WHICH MAY AFFECT HIS OPERATION DURING CONSTRUCTION AND SHALL TAKE ALL NECESSARY PRECAUTIONS TO AVOID DAMAGE TO SAME. THE CONTRACTOR SHALL USE EXTREME CAUTION WHEN WORKING NEAR OVERHEAD OR UNDERGROUND POWER, GAS AND/OR OTHER UTILITIES SO AS TO SAFELY PROTECT ALL PERSONNEL AND EQUIPMENT, AND SHALL BE RESPONSIBLE FOR ALL COSTS AND LIABILITY IN CONNECTION THEREWITH.
- \*3. THE CONTRACTOR SHALL TAKE ALL PRECAUTIONARY MEASURES NECESSARY TO PROTECT EXISTING UTILITY LINES, STRUCTURES, AND STREET IMPROVEMENTS WHICH ARE TO REMAIN IN PLACE, FROM DAMAGE, AND ALL SUCH IMPROVEMENTS OR STRUCTURES DAMAGED BY THE CONTRACTOR'S OPERATIONS SHALL BE REPAIRED OR REPLACED SATISFACTORY TO THE CITY ENGINEER OR OWNING UTILITY COMPANY AT THE EXPENSE OF THE CONTRACTOR.
- 4. ALL CONSTRUCTION SHALL BE AS SHOWN ON THESE PLANS. ANY REVISIONS SHALL HAVE THE PRIOR WRITTEN APPROVAL OF THE CITY ENGINEER.
- 5. CURB AND GUTTER WITH A GRADE OF LESS THAN FOUR TENTHS OF ONE PERCENT SHALL BE WATER TESTED AS SOON AS POSSIBLE AFTER CONSTRUCTION. ANY CURB AND GUTTER FOUND TO BE UNACCEPTABLE TO THE CITY SHALL BE REMOVED AND REPLACED.
- \*6. TYPE V CEMENT SHALL BE USED IN ALL OFF-SITE CONCRETE WORK. CONCRETE TO BE 3000 P.S.I., MINIMUM AT 28 DAYS. MIX DESIGN TO BE APPROVED BY THE QUALITY CONTROL DIVISION PRIOR TO USE ON THE PROJECT.
- 7. SIDEWALK RAMPS SHALL BE CONSTRUCTED IN EACH QUADRANT OF AN INTERSECTION PER STANDARD DRAWING NO. 235. EXACT LOCATION OF RAMPS MAY BE ADJUSTED IN THE FIELD BY A CITY INSPECTOR.
- \*8. PERMITS ARE REQUIRED FOR ANY WORK IN THE PUBLIC RIGHT-OF-WAY. THE CONTRACTOR SHALL SECURE ALL PERMITS AND INSPECTIONS REQUIRED FOR THIS CONSTRUCTION.
- 9. EXPANSION JOINTS REQUIRED, MAXIMUM EVERY 300 FEET IN EXTRUDED CURB.
- 10. APPLY FOG SEAL ONLY AFTER ALL CORRECTIONS AND ADJUSTMENTS HAVE BEEN MADE.
- 11. CONTRACTOR SHALL PROVIDE ALL NECESSARY HORIZONTAL AND VERTICAL TRANSITIONS BETWEEN NEW CONSTRUCTION AND EXISTING SURFACES TO PROVIDE FOR PROPER DRAINAGE AND FOR INGRESS AND EGRESS TO NEW CONSTRUCTION. THE EXTENT OF TRANSITIONS TO BE SHOWN ON PLANS, OR AS DESIGNATED IN THE FIELD BY A CITY INSPECTOR.
- 12. ALL GRADING WORK SHALL CONFORM TO THE SOILS REPORT AS PREPARED BY THE SOILS ENGINEER AND APPROVED BY THE CITY ENGINEER, AND AS SHOWN ON THESE PLANS.
- 13. EXACT LOCATION OF ALL SAWCUT LINES MAY BE DETERMINED IN THE FIELD BY A CITY OF LAS VEGAS INSPECTOR IF LOCATION ON PLANS IS NOT CLEARLY SHOWN, OR EXISTING PAVEMENT CONDITION REQUIRES RELOCATION.
- 14. THE CONTRACTOR SHALL TAKE ALL PRECAUTIONS NECESSARY TO PROTECT EXISTING PERMANENT SURVEY MONUMENTS. ANY MONUMENTS DISTURBED SHALL BE REPLACED AND ADJUSTED PER AVAILABLE RECORDS IN ACCORDANCE WITH N.R.S. STATUTE NO. 625.550.
- 15. UTILITY COMPANY METER BOXES, MANHOLE LIDS, VALVE COVERS, ETC. SHALL BE LOCATED OUT OF DRIVEWAYS, DRIVEWAY APRONS, FLOW LINES AND CROSS GUTTERS UNLESS WRITTEN APPROVAL IS GRANTED BY THE UTILITY COMPANY, AND THE CITY ENGINEER.
- 16. WALL NOTES:  
 A. ALL WALLS, NEW OR EXISTING, ARE ONLY SHOWN FOR THE PURPOSE OF GRADING RELATIONSHIPS.  
 B. THE STRUCTURAL AND ARCHITECTURAL DESIGN OF ALL WALLS (RETAINING OR NON-RETAINING) MUST BE APPROVED BY THE CITY OF LAS VEGAS BUILDING DEPARTMENT.
- 17. ASPHALT MIX DESIGN SHALL BE SUBMITTED TO AND APPROVED BY THE CITY ENGINEER PRIOR TO THE PLACEMENT OF ASPHALT ON ANY CITY STREET.
- 18. A.C. PAVEMENT TO BE 1/2" ABOVE LIP OF ALL GUTTERS OR CROSS GUTTERS AFTER COMPACTION EXCEPT AT SIDEWALK RAMPS.

BASIS OF BEARING  
 N 00° 06' 04" W., THE WEST LINE OF THE E 1/2 OF SECTION 32,  
 T. 20 S., R. 62 E., M.D.M. ASSHOWN ON MAP RECORDED IN  
 BOOK 890, PAGE 50 OF PLATS, CLARK COUNTY, NEVADA RECORDS.

BENCHMARK  
 CLV BENCHMARK NO. 2LV02295566  
 RIVET IN ALUMINUM PLATE  
 IN NE CURB RETURN BONANZA ROAD AND MARION DRIVE  
 ELEVATION 1768.857

APPROVALS

*Lee Tuipulehake* 7/28/94  
 NEVADA POWER CO. LEE TUIPLEHAKE DATE  
*James Malloy* 8/16/94  
 SPRINT CENTRAL TELEPHONE CO. DATE  
*James Malloy* 08/01/94  
 SOUTHWEST GAS CORP. LYNN A. MALLOY, P.E. DATE  
 SEE SHT 3  
 LAS VEGAS VALLEY WATER DIST. DATE  
 SEE SHEET 3  
 CLV FIRE DEPARTMENT DATE  
*Dennis Anderson* 5-17-95  
 DENNIS ANDERSON, P.E. 9160  
 CITY ENGINEER  
 CITY OF LAS VEGAS

APPROVAL OF THESE PLANS BY THE CITY ENGINEER IS LIMITED TO THOSE IMPROVEMENTS CONSTRUCTED IN THE DESIGNATED RIGHT-OF-WAY AND/OR DESIGNATED IMPROVEMENTS. THIS APPROVAL DOES NOT AUTHORIZE THE CONSTRUCTION OF ANY IMPROVEMENTS THAT DEVIATE FROM ADOPTED STANDARDS AND/OR SPECIFICATIONS EXCEPT THOSE SPECIFICALLY LISTED UNDER "DEVIATIONS FROM STANDARDS". THE ENGINEER SHALL RESOLVE ANY DEVIATION OTHER THAN THOSE LISTED IN "DEVIATIONS FROM STANDARDS" IN FAVOR OF THE UNIFORM STANDARDS DRAWINGS AND SPECIFICATIONS CLARK COUNTY NEVADA.

INDEX OF SHEETS

- 1. TITLE SHEET
- 2. GRADING PLAN
- 3. UTILITY PLAN

PLANS LIBRARY  
 LOGGED OUT TO:  
 FIRM: B & E  
 PERSON: *Pat Beebe*  
 DATE: 8-22-95

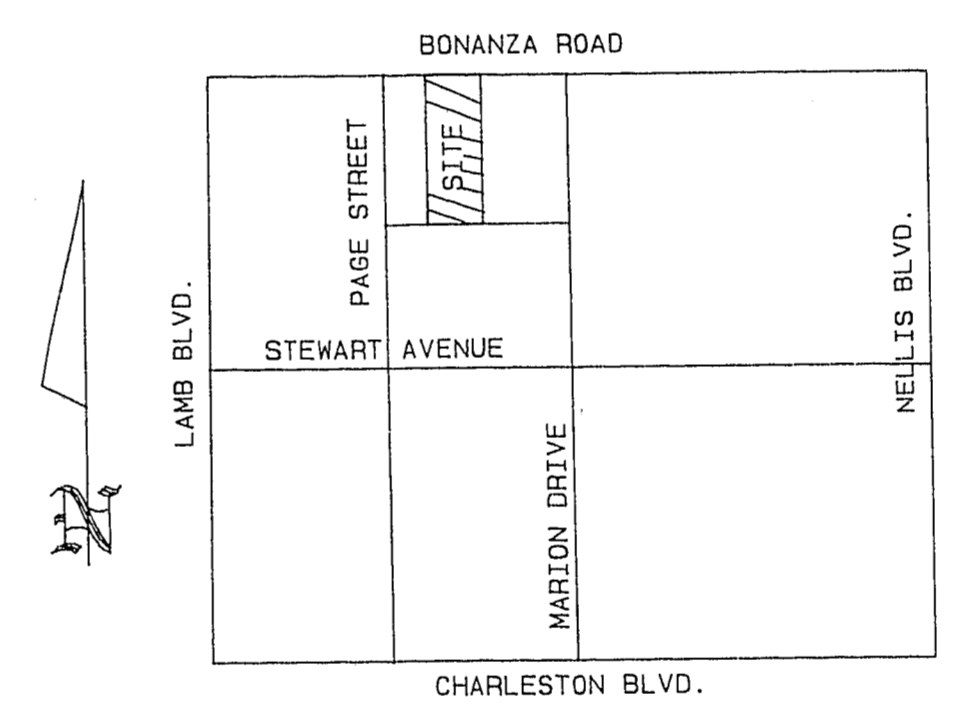

VICINITY MAP  
 NO SCALE

GENERAL CONDITIONS  
 THE CONTRACTOR IS SPECIFICALLY CAUTIONED THAT THE LOCATION AND/OR ELEVATION OF EXISTING UTILITIES AS SHOWN ON THESE PLANS IS BASED ON RECORDS OF THE VARIOUS UTILITY COMPANIES AND, WHERE POSSIBLE, MEASUREMENTS TAKEN IN THE FIELD. THE INFORMATION IS NOT TO BE RELIED ON AS BEING EXACT OR COMPLETE. THE CONTRACTOR MUST CALL THE APPROPRIATE UTILITY COMPANY AT LEAST 48 HOURS BEFORE ANY EXCAVATION TO REQUEST EXACT FIELD LOCATION OF THE CONTRACTOR TO RELOCATE ALL EXISTING UTILITIES WHICH CONFLICT WITH THE PROPOSED IMPROVEMENTS SHOWN ON THE PLANS.

- DEVIATIONS FROM STANDARDS
- 1. 1" A CURB WITH NO SIDEWALK RAMPS AT CORNERS OF INTERIOR PRIVATE STREETS
  - 2. INVERTED CROWN ON 30' DRIVEWAY ACCESS STREETS WITH 2" VALLEY GUTTER
  - 3. 24" ROLLED CURB (15' ± EA. SIDE OF ROXELLA LN. TO MATCH EXISTING 24" ROLLED CURB)

*James Malloy*  
 02 JUN 94

**TITLE SHEET**  
 DIAMOND HEAD VILLAS  
 CONDOMINIUMS PHASE II

**B & E ENGINEERING CORPORATION**  
 71 NORTH PECOS ROAD SUITE 107  
 LAS VEGAS, NEVADA 89101  
 (702) 438-0313 TITLE TEXT 5/95 DEY

NO.	REVISION	BY	DATE
1	DRIVE TO STREET, 24" ROLLED CURB		3/27/95 DEY
2	CITY ENGINEER APPROVAL NOTE		4/5/95 DEY
3	CITY ENGINEER APPROVAL NOTE		5/15/95 DEY

DES. BY: DWG. BY: GHB CHKD. BY: \_\_\_\_\_  
 SCALE: 1" = 30' DATE: \_\_\_\_\_  
 JOB NO. 94010 SHT. 1 OF 3