

BENCH MARK :
 CLV.B.M. # 06025 D13
 LOCATED @ SW CORNER
 OF DECATUR BLVD. &
 NEBRASKA
 ELEV. 2201.439

REFERENCE :
 CITY OF LAS VEGAS
 DRAWING NO. 107-V-811
 SHEETS 5, 6, 7 OF 9

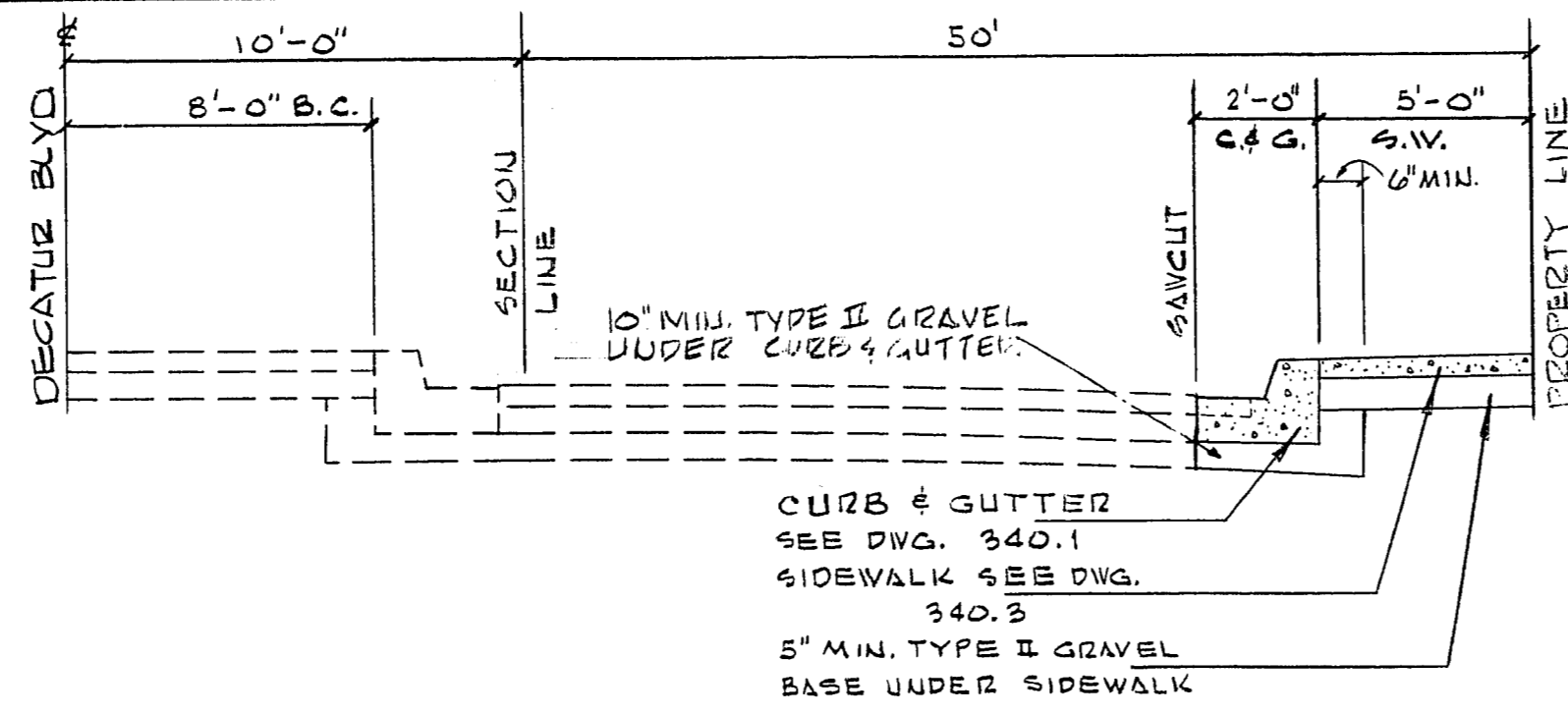

NOTE - CITY OF LAS VEGAS SURVEY SHALL VERIFY ELEVATIONS OF CURB FORMS PRIOR TO POURING CONCRETE.

SCALE : HORZ. 1"=20' VERT. 1"=2'

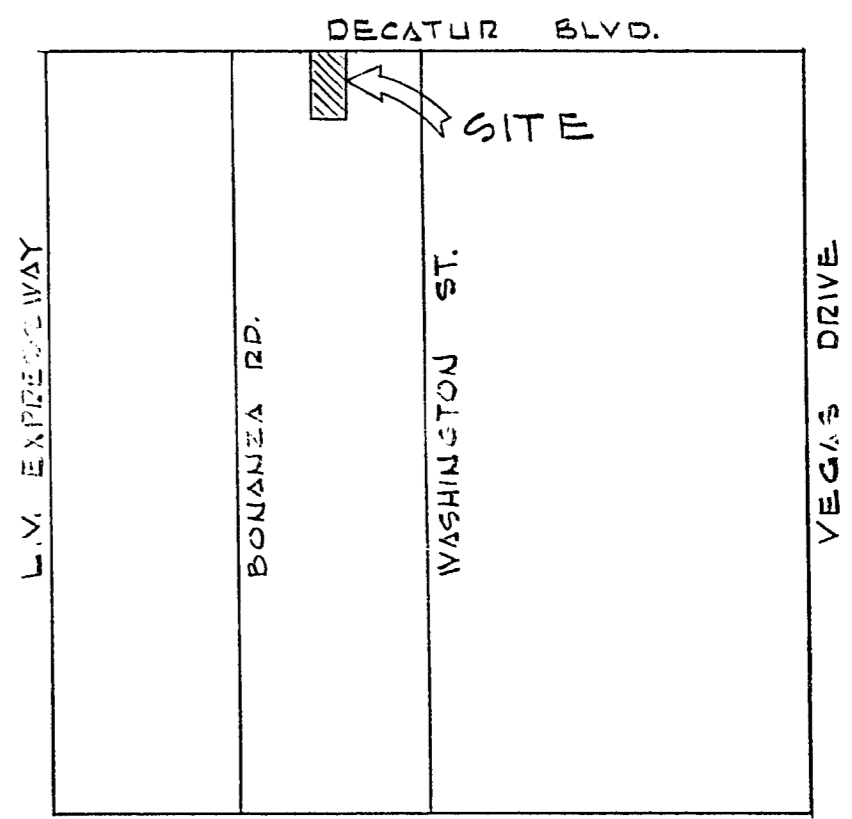

VICINITY MAP
 NO SCALE
 SECTION 30
 T. 20 S., R. 61 E., M.D.B.#M

ESTIMATE OF QUANTITIES

① SAW CUT EXIST. PAVEMENT	268 LF
② 2' L' TYPE CURB & GUTTER	268 LF
③ 5'-0" WIDE CONC. SIDEWALK	1220 SF
④ 24'-0" WIDE CONC. COMMERCIAL DRIVEWAY	1 EA
⑤ 400 WATT ST. LT. W/ II GA. STANDARD	4 EA
⑥ 1/4" PVC ST. LT. CONDUIT (EXISTING)	

NOTE:
 1) STREET LIGHT SPEC. S-180/240 VOLT SINGLE PHASE THREE WIDE SYSTEM TO APPLY
 2) ALL CONSTRUCTION SHALL CONFORM TO THE UNIFORM STANDARD SPECIFICATIONS AND DRAWINGS FOR PUBLIC WORKS CONSTRUCTION, CLARK COUNTY AREA NEVADA

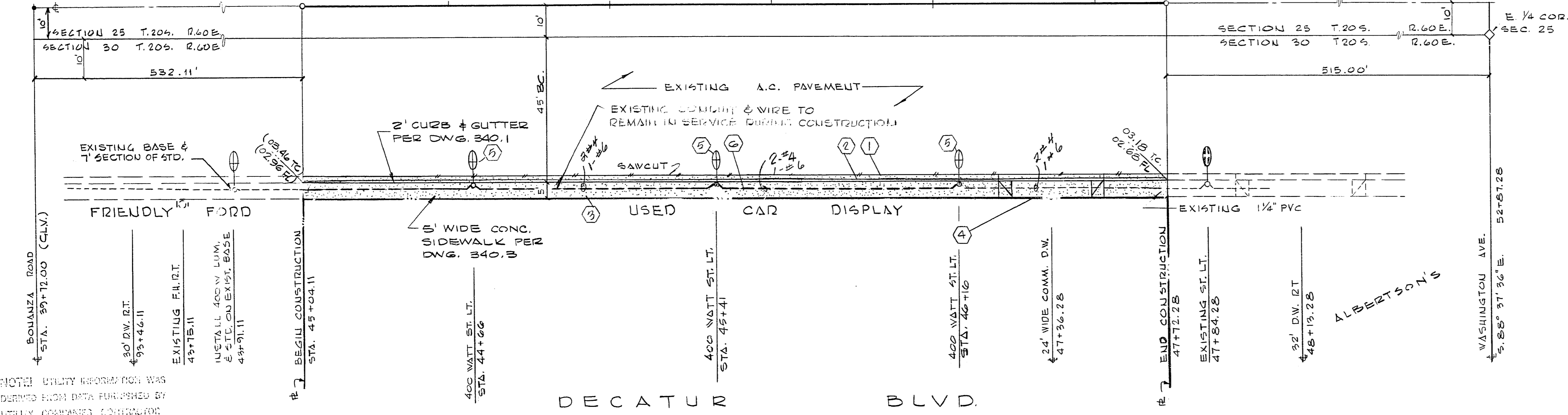

NOTE: UTILITY RECORDS FOR THIS PROJECT WAS OBTAINED FROM DATA FURNISHED BY UTILITY COMPANIES. CONTRACTOR MUST CONFIRM LOCATION OF UTILITIES BEFORE COMMENCING EXCAVATION.

DESIGN TOP OF CURB ELEVATIONS	AS-BUILT ELEVATION @ LIP OF CURB	AS-BUILT LIP OF CURB
45+00 STA. 03.46 T.C.	45+04.11 STA. 03.07 LIP	2204
45+50 STA. 03.41 T.C.	45+14.11	2202
46+00 STA. 03.36 T.C.	45+24.11	2200
46+50 STA. 03.31 T.C.	46+34.11	
47+00 STA. 03.26 T.C.	47+44.11	
47+50 STA. 03.21 T.C.	47+54.11	
47+72.28 STA. END CONSTRUCTION	47+64.11	

APPROVAL

U.B. Williams 5/1/73
 CITY ENGINEER DATE

J.A. Smith 5-5-73
 CITY FIELD ENGINEER DATE

George Lewis 3-7-73
 CITY ELECTRICAL ENGINEER DATE

Edmund A. Wiegand 3/1/73
 NEVADA POWER COMPANY DATE

Bob Pfeiffer 3-1-73
 CLV. ELECTRICAL COORDINATOR DATE

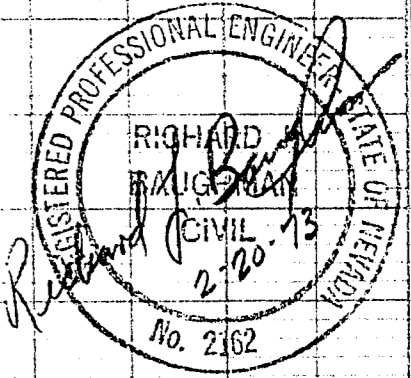

PREPARED FOR:
 ZICK & SHARP ARCHITECTS
 2616 STATE STREET
 LAS VEGAS, NEVADA 89102

DATE: 5-20-73
 DESIGN: JJB
 DRAWN: PJP
 CHECK: JJB
 SCALE: SEE ABOVE

BAUGHMAN, HAUGHT & TURNER
 CIVIL ENGINEERS
 MINING ENGINEERS
 LAND SURVEYORS
 2335 WEST CHARLESTON BOULEVARD
 LAS VEGAS, NEVADA 89102

STREET & STREET LIGHT DESIGN
 SECTION 30 TRANS. 20 SOUTH, RANGE 61 EAST M.D.B.#M
 CITY OF LAS VEGAS
 NEVADA
 DECATUR BLVD.

SHEET 1 OF 1
 PROJ. NO.

26447 107-1900