

7.13.99

| | | | |
|--------------|--------------|----------|----------|
| DESIGNED BY: | 1057-002-991 | DATE: | 04-08-99 |
| DRAWN BY: | ADR | DATE: | 04-08-99 |
| CHD BY: | | DATE: | |
| NO. | | REVISION | |
| | | DATE | APPL |

L. R. NELSON CONSULTING ENGINEERS, INC.
 3035 East Patrick Lane Suite 9
 Las Vegas, Nevada 89120
 (702) 798-7978
 (702) 451-2296 FAX

*STRUCTURAL
 *CIVIL
 *SURVEY

NEVADA
 CITY OF LAS VEGAS
 EZ PAWN SITE
 UTILITY PLAN
 EZ PAWN #E0101
 BELROSE/ERNEST MAY

SHEET NUMBER
3
 OF 3 SHEETS
 1057-002-991



GRAPHIC SCALE

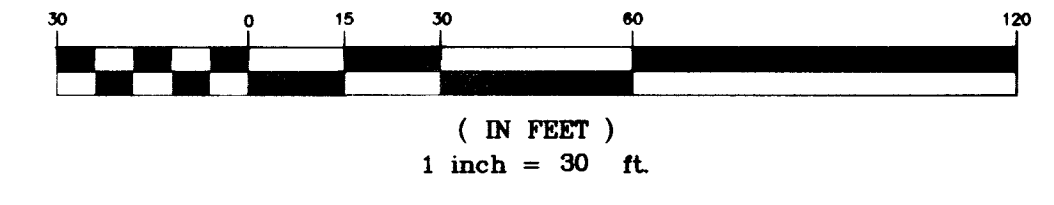

LAS VEGAS VALLEY WATER DISTRICT NOTES

- NO WORK SHALL BEGIN UNTIL THE WATER PLANS HAVE BEEN RELEASED FOR CONSTRUCTION BY THE LVVWD. FOLLOWING WATER PLAN APPROVAL, FORTY-EIGHT (48) HOUR NOTICE SHALL BE GIVEN TO THE LVVWD COMMUNICATION SUPPORT CENTER (258-7171) PRIOR TO THE START OF CONSTRUCTION. NOTICE MUST BE GIVEN BY 2:00 P.M. THE BUSINESS DAY PRIOR TO A LVVWD INSPECTION.
- ALL WORK SHALL CONFORM TO LVVWD STANDARD PLATES, DRAWINGS, AND SPECIFICATIONS, AND THE "UNIFORM DESIGN AND CONSTRUCTION STANDARDS FOR WATER DISTRIBUTION SYSTEMS" (UDACS), LATEST EDITION.
- ALL WORK, EXCEPT AS MODIFIED BY THESE PLANS OR BY NOTE 2, SHALL BE DONE IN ACCORDANCE WITH THE MOST CURRENT DRAFT OR EDITION OF THE "UNIFORM STANDARD SPECIFICATIONS, PUBLIC WORKS" CONSTRUCTION, OFF-SITE IMPROVEMENTS, CLARK COUNTY AREA, NEVADA".
- A SINGLE PIPE MATERIAL SHALL BE USED THROUGHOUT THE PROJECT, UNLESS OTHERWISE APPROVED BY THE LVVWD.
- ALL SERVICE LATERALS TWO (2") INCHES IN DIAMETER AND SMALLER SHALL BE COPPER TUBING WITH LVVWD APPROVED SERVICE SADDLES.
- ALL WATER METER BOXES SHALL BE LOCATED OUTSIDE OF DRIVEWAY AREAS.
- ALL VALVES SHALL BE LOCATED OUTSIDE OF DRIVEWAYS, GUTTERS, CURBS AND VALLEY GUTTERS.
- THE FOLLOWING REQUIREMENTS MUST BE MET IN THE EVENT A WATER LINE AND SANITARY SEWER OR STORM SEWER LINE CROSS:
 - A MINIMUM OF EIGHTEEN INCH (18") VERTICAL SEPARATION (OUTSIDE TO OUTSIDE) MUST BE MAINTAINED WHEN THE WATER LINE IS INSTALLED OVER THE SANITARY OR STORM SEWER LINE. IF THE VERTICAL SEPARATION CANNOT BE MAINTAINED OR THE WATER LINE MUST BE PLACED UNDER THE SANITARY OR STORM SEWER LINE, THE SANITARY OR STORM SEWER LINE MUST BE CONSTRUCTED WITH ONE OF THE FOLLOWING OR, AS SHOWN ON THESE PLANS:
 - POTABLE WATER SUPPLY QUALITY MATERIAL.
 - ENCASEMENT, WITH FOUR INCH (4") CONCRETE (MINIMUM).
 - SLEEVING WITH POTABLE WATER SUPPLY QUALITY PIPE.
 - EACH PROVISION MUST EXTEND ALONG THE SANITARY OR STORM SEWER, ON EITHER SIDE OF THE WATER MAIN, A MINIMUM TEN FOOT (10') DISTANCE PERPENDICULAR TO THE EXTERIOR OF MAIN.
- WARNING TAPE SHALL BE REQUIRED OVER ALL MAINS, ALL SIX INCH (6") DIAMETER AND LARGER SERVICE LATERALS, AND ANY SERVICE LATERAL NOT INSTALLED PERPENDICULAR TO THE MAIN IN ACCORDANCE WITH STANDARD PLATE No. 27.
- ALL WATER FACILITIES SHALL BE FILLED, DISINFECTED, PRESSURE TESTED, FLUSHED, AND AN ACCEPTABLE WATER SAMPLE OBTAINED, PRIOR TO CONNECTION TO THE LVVWD'S DISTRIBUTION SYSTEM.
- THE CONTRACTOR MUST OBTAIN ALL METERS TWO INCH (2") AND SMALLER FROM LVVWD CENTRAL STORES. TELEPHONE 258-3152 FORTY-EIGHT (48) HOURS PRIOR TO PICK-UP.
- CONSTRUCTION MAY INTERRUPT SERVICE, WITH LVVWD APPROVAL AND PROPER NOTIFICATION, BETWEEN THE HOURS OF 10:00 PM AND 6:00 AM, SUNDAY THROUGH THURSDAY. CIRCUMSTANCES THAT MAY REQUIRE TEMPORARY SERVICE FEED MUST HAVE PRIOR LVVWD APPROVAL.
- ALL WATER FACILITY CONSTRUCTION MATERIALS USED MUST BE LISTED ON THE LVVWD'S PRE-APPROVED MATERIALS AND MANUFACTURERS LISTING FOR NEW FACILITIES, LATEST REVISION, OR SPECIFICALLY APPROVED ON THESE PLANS.

APPROVALS

SEE BELOW
 CITY FIRE MARSHAL _____ DATE _____
 LAS VEGAS VALLEY WATER DISTRICT _____ DATE 7/28/99
 APPROVED FOR CONSTRUCTION

BENCHMARK

BM# 7001-2956
 ELEVATION = 2084.18 FEET (NAVD 88)
 RIVET AND SQUARE ALUMINUM PLATE IN TOP OF CURB, NEAR MID CURVE, IN NORTHEAST SIDE OF TURN ISLAND IN NORTHEAST CORNER OF BONANZA RD AND RANCHO DR.

BASIS OF BEARINGS

NORTH 00°21'18" EAST, BEING THE WEST LINE OF THE NORTHWEST QUARTER (NW 1/4) OF THE SOUTHEAST QUARTER (SE 1/4) OF SECTION 29, TOWNSHIP 20 SOUTH, RANGE 61 EAST, M.D.M., CITY OF LAS VEGAS, COUNTY OF CLARK, STATE OF NEVADA.

DISCLAIMER NOTE

UTILITY LOCATIONS SHOWN HEREON ARE APPROXIMATE ONLY. IT SHALL BE THE CONTRACTOR'S RESPONSIBILITY TO DETERMINE THE EXACT HORIZONTAL AND VERTICAL LOCATION OF ALL EXISTING UNDERGROUND AND OVERHEAD UTILITIES PRIOR TO COMMENCING CONSTRUCTION. NO REPRESENTATION IS MADE THAT ALL EXISTING UTILITIES ARE SHOWN HEREON. THE ENGINEER ASSUMES NO RESPONSIBILITY FOR UTILITIES NOT SHOWN OR UTILITIES NOT SHOWN IN THEIR PROPER LOCATION.

Avoid cutting underground utility lines. It's costly.
Call before you Dig
 1-800-227-2800 (UNDERGROUND SERVICE ONLY)

Avoid overhead power line contact.
Call before you OVERHEAD
 1-702-593-6111 (NEVADA POWER ENVIRONMENT AND SAFETY SERVICES DEPARTMENT)

FIRE DEPARTMENT NOTES

- ALL WORK SHALL BE DONE IN STRICT ACCORDANCE WITH THE CITY OF LAS VEGAS FIRE DEPARTMENT'S ORDINANCE #5115, "HYDRANT SPECIFICATIONS", AND "HYDRANT INSTALLATION SPECIFICATIONS".
- AUTHORIZED HYDRANTS FOR THIS PROJECT ARE:
 - A. KENNEDY - GUARDIAN MODELS KB1A AND KB1D
 - B. MUELLER - SUPER CENTURION 250 MODEL A-423
 - C. CLOW - MEDALLION MODEL F-2546LVD
- ON ANY RESIDENTIAL OR COMMERCIAL INSTALLATIONS FIRE HYDRANTS SHALL BE INSTALLED AND FIRE APPARATUS ACCESS ROADS SHALL BE MAINTAINED BEFORE COMMENCEMENT OF ANY COMBUSTIBLE CONSTRUCTION. ALL FIRE HYDRANTS SHALL BE IN GOOD WORKING ORDER AND SHALL BE CAPABLE OF DELIVERING THE REQUIRED FIRE FLOW.
- TO IDENTIFY THE FIRE HYDRANT LOCATIONS, CONTRACTOR SHALL PLACE A BLUE REFLECTIVE MARKER AT THE CENTER LINE OF STREET ADJACENT TO THE FIRE HYDRANTS AS REQUIRED BY ORDINANCE #5115.
- ALL UNDERGROUND INSPECTIONS, PRESSURE AND FLUSH VERIFICATIONS OF ALL FIRE HYDRANTS AND FIRE LINES, SHALL BE CONDUCTED BEFORE COVERING THE LINES. CALL THE CITY OF LAS VEGAS INSPECTION HOT-LINE AT 229-2071 TO REQUEST AN INSPECTION BY THE CITY OF LAS VEGAS FIRE DEPARTMENT.
- PAINTING OF THE CURBS AND FIRE HYDRANTS. ALL OTHER WORK NECESSARY AS REQUIRED BY ORDINANCE #5115, FOR THE PROTECTION OF FIRE HYDRANTS FROM PHYSICAL DAMAGE, SHALL BE COMPLETED BEFORE APPROVAL BY THE CITY OF LAS VEGAS FIRE DEPARTMENT.
- A PERMIT IS REQUIRED FROM THE CITY OF LAS VEGAS FIRE DEPARTMENT FOR ON-SITE WATER LINES AND FIRE HYDRANTS. THE PERMIT AND CONTRACTOR'S MATERIAL AND TEST CERTIFICATE FOR UNDERGROUND PIPING FORM SHALL BE OBTAINED FROM THE FIRE PROTECTION ENGINEER BEFORE COMMENCEMENT OF WORK.
- PRIVATE FIRE HYDRANTS SHALL BE PAINTED RED.
- PRIOR TO THE FINAL OCCUPANCY, A FLOW TEST MUST BE WITNESSED BY THE CITY OF LAS VEGAS FIRE DEPARTMENT TO VERIFY AVAILABILITY OF THE REQUIRED FIRE FLOW.
- ALL ON-SITE UNDERGROUND WATER MAINS AND MATERIALS SHALL BE U.L. LISTED, A.W.W.A. APPROVED, AND SHALL BE RATED FOR THE APPROPRIATE WORKING PRESSURE.
- FIRE HYDRANT SPACING SHALL BE:
 - RESIDENTIAL - 500 FEET UNSPRINKLERED; 1,000 FEET SPRINKLERED.
 - COMMERCIAL - 300 FEET UNSPRINKLERED; 600 FEET SPRINKLERED.
- WHERE NEW WATER MAINS ARE EXTENDED ALONG STREETS WHERE FIRE HYDRANTS ARE NOT NEEDED FOR PROTECTION OF THE STRUCTURES, FIRE HYDRANTS SHALL BE INSTALLED AT A MAXIMUM 1,000 FOOT SPACING TO PROVIDE FOR TRANSPORTATION HAZARDS.
- NO FIRE HYDRANT SHALL BE LOCATED WITHIN THE REQUIRED RADIUS OF A CUL-DE-SAC OR WITHIN 20' OF THE PERIMETER OF THE RADIUS OF THE CUL-DE-SAC.
- NO FIRE HYDRANT SHALL BE LOCATED WITHIN 6 FEET OF ANY CURB RETURN, DRIVEWAY, POWER POLE, STREET LIGHT OR ANY OTHER OBSTRUCTION.
- THE MAXIMUM DISTANCE FROM A FIRE HYDRANT TO THE END OF A DEAD-END STREET SHALL NOT EXCEED 200 FEET.
- THE MAXIMUM DISTANCE FROM A FIRE HYDRANT TO A FIRE DEPARTMENT CONNECTION (FDC) SHALL NOT EXCEED 100 FEET, AS MEASURED BY AN APPROVED ROUTE.
- TWO SOURCES OF SUPPLY ARE REQUIRED WHENEVER THERE ARE 4 OR MORE FIRE HYDRANTS/SPRINKLER LEAD-INS ARE INSTALLED ON A SINGLE SYSTEM.
- SECTIONAL CONTROL VALVES SHALL BE INSTALLED SO THAT NO MORE THAN 2 FIRE HYDRANTS CAN BE OUT OF SERVICE DUE TO A BREAK IN A WATER MAIN.
- ALL FIRE APPARATUS ACCESS ROADS SHALL HAVE AN UNOBSTRUCTED WIDTH OF NOT LESS THAN 20 FEET (FLOW LINE TO THE FLOW LINE), PROVIDING NO PARKING IS ALLOWED ON EITHER SIDE; 28 FEET (FLOW LINE TO THE FLOW LINE), IF PARALLEL PARKING IS ALLOWED ON ONE SIDE ONLY; AND 36 FEET (FLOW LINE TO THE FLOW LINE), IF PARALLEL PARKING IS ALLOWED ON BOTH SIDES. VERTICAL CLEARANCE SHALL BE NOT LESS THAN 13 FEET 6 INCHES.
- ALL FIRE APPARATUS ACCESS ROADS SHALL BE PAVED TO PROVIDE ALL-WEATHER DRIVING CAPABILITIES, AND SHALL BE DESIGNED AND MAINTAINED TO SUPPORT THE IMPOSED LOADS OF THE FIRE APPARATUS.
- THE GRADIENT FOR A FIRE APPARATUS ACCESS ROADS SHALL NOT EXCEED 12% ANGLES OF APPROACH AND ANGLES OF DEPARTURE SHALL NOT EXCEED 6% FOR 25 FEET PRIOR TO OR AFTER THE GRADE CHANGE.
- THE TURNING RADIUS OF A FIRE APPARATUS ACCESS ROADS SHALL BE NO LESS THAN 45 FEET OUTSIDE AND 22 FEET INSIDE TURNING RADIUS.
- A FIRE APPARATUS ACCESS ROAD SHALL BE REQUIRED WHEN ANY PORTION OF AN EXTERIOR WALL OF THE FIRST STORY IS LOCATED MORE THAN 150 FEET FROM A FIRE DEPARTMENT VEHICLE ACCESS (SEE EXCEPTIONS IN UFG97, SECTION 902.2).
- ALL DEAD-END FIRE APPARATUS ACCESS ROADS AND OR FIRE LANES, PUBLIC OR PRIVATE, IN EXCESS OF 150 FEET IN LENGTH SHALL BE PROVIDED WITH AN APPROVED TURN AROUND AREA HAVING A MINIMUM DIAMETER OF 81 FEET (BACK OF THE CURB TO THE BACK OF CURB).
- ALL FIRE APPARATUS ACCESS ROADS SHALL BE MARKED BY PLACING APPROVED SIGNS AT THE START OF THE DESIGNATED FIRE LANE, ONE SIGN AT THE END OF THE FIRE LANE AND WITH SIGNS AT INTERVALS 100 FEET ALONG ALL DESIGNATED FIRE LANES. SIGNS TO BE PLACED ON BOTH SIDES OF AN ACCESS ROADWAY IF NEEDED TO PREVENT PARKING ON EITHER SIDE. SIGNS TO BE INSTALLED NO HIGHER THAN 10 FEET OR LESS THAN 6 FEET FROM ROADWAY LEVEL. THE CURBS ALONG OR ON THE PAVEMENT OR CEMENT IF CURB IS NOT PROVIDED SHALL BE PAINTED WITH A RED WEATHER RESISTANT PAINT IN ADDITION TO THE SIGNS.
- ELECTRICALLY CONTROLLED ACCESS GATES SHALL BE PROVIDED WITH AN APPROVED EMERGENCY VEHICLE DETECTOR/RECEIVER SYSTEM. SAID SYSTEM SHALL BE INSTALLED IN ACCORDANCE WITH THE CITY OF LAS VEGAS GUIDELINES FOR AUTOMATIC EMERGENCY VEHICLE ACCESS GATES.

CONSTRUCTION NOTES & ESTIMATE OF QUANTITIES

- FIRE HYDRANT ASSEMBLY PER UDACS STD. PLATE NO. 7 1 EA.
- 3/4" REDUCED PRESSURE PRINCIPLE ASSEMBLY (RPPA) 1 EA.
- SAWCUT, REMOVE, & REPLACE A.C. PAVEMENT AS INDICATED PER U.S.D. STD. DWG. NO. 503
- RE-STRIPE PARKING AS INDICATED TO ALLOW FOR CONSTRUCTION OF 3/4" R.P.P.A.
- INSTALL (4) 4" DIA. PIPE BOLLARDS PER UDACS PLATE No. 23
- PAINT CURB RED PER CLV FIRE DEPARTMENT STANDARDS

** FIRE HYDRANT ASSEMBLY INCLUDES: TEE, VALVE, LATERAL, RISER, THRUST BLOCKS AND ALL ASSOCIATED HARDWARE

(1) 3/4" REDUCED PRESSURE PRINCIPLE ASSEMBLY (RPPA)

APPROVED REDUCED PRESSURE PRINCIPLE ASSEMBLY(S) SHALL BE INSTALLED PER THE UDACS PLATE NO. 11A. NO WATER SHALL BE TAKEN FROM A SERVICE REQUIRING BACKFLOW PREVENTION UNTIL THE REDUCED PRESSURE PRINCIPLE ASSEMBLY HAS BEEN SUCCESSFULLY TESTED BY THE LVVWD.

ANY BLOCK WALL OR OTHER FENCE MATERIAL SHALL BE DESIGNED AND CONSTRUCTED AROUND THE OUTSIDE OF THE EASEMENT(S) TO ALLOW THE DISTRICT DIRECT ACCESS FROM THE ADJACENT RIGHT-OF-WAY.

PROJECT NAME: **EZ PAWN**
 P 3
 This project water plan complies with the Las Vegas Valley Water District's technical requirements. However, this water plan is **NOT APPROVED FOR CONSTRUCTION** at this time and this signature does not provide or imply a water commitment.
 _____ DATE 7-13-99

NOTE

THIS PROPERTY MAY HAVE STATIC WATER PRESSURE IN EXCESS OF 80 PSI. THE UNIFORM PLUMBING CODE REQUIRES THAT INDIVIDUAL, ON-SITE (PRIVATE), PRESSURE REDUCING VALVES BE INSTALLED WHENEVER THE PRESSURE EXCEEDS 80 PSI. PRV'S ARE THE DEVELOPER'S RESPONSIBILITY AND WILL NOT BE INSPECTED OR INCLUDED IN THE ACCEPTANCE OF L.V.V.W.D. FACILITIES.

LEGEND

- W--- EXISTING WATER LINE
- SS--- EXISTING SEWER LINE
- EXISTING FIRE HYDRANT
- EXISTING VALVE
- EXISTING MANHOLE
- PROPOSED SEWER LINE
- PROPOSED WATERLINE
- PROPOSED FIRE HYDRANT
- EXISTING POWER POLE
- PROPOSED MANHOLE
- CLEANOUT
- FINISH FLOOR
- EXISTING STREETLIGHT
- PAINT FACE OF CURB RED (FIRE LANE)

FIRE FLOW CALCULATIONS

| | |
|-----------------------------|-------------|
| BUILDING HEIGHT | 15 FT. |
| OCCUPANCY CLASSIFICATION | COMMERCIAL |
| CONSTRUCTION CLASSIFICATION | TYPE Vn |
| TOTAL FLOOR AREA | 9900 S.F. |
| ESTIMATED FIRE FLOW | 2750 G.P.M. |
| AUTOMATIC SPRINKLER SYSTEM | NO |
| NUMBER OF STORIES | 1 |

Reviewed By: _____
 Date: 7-15-99

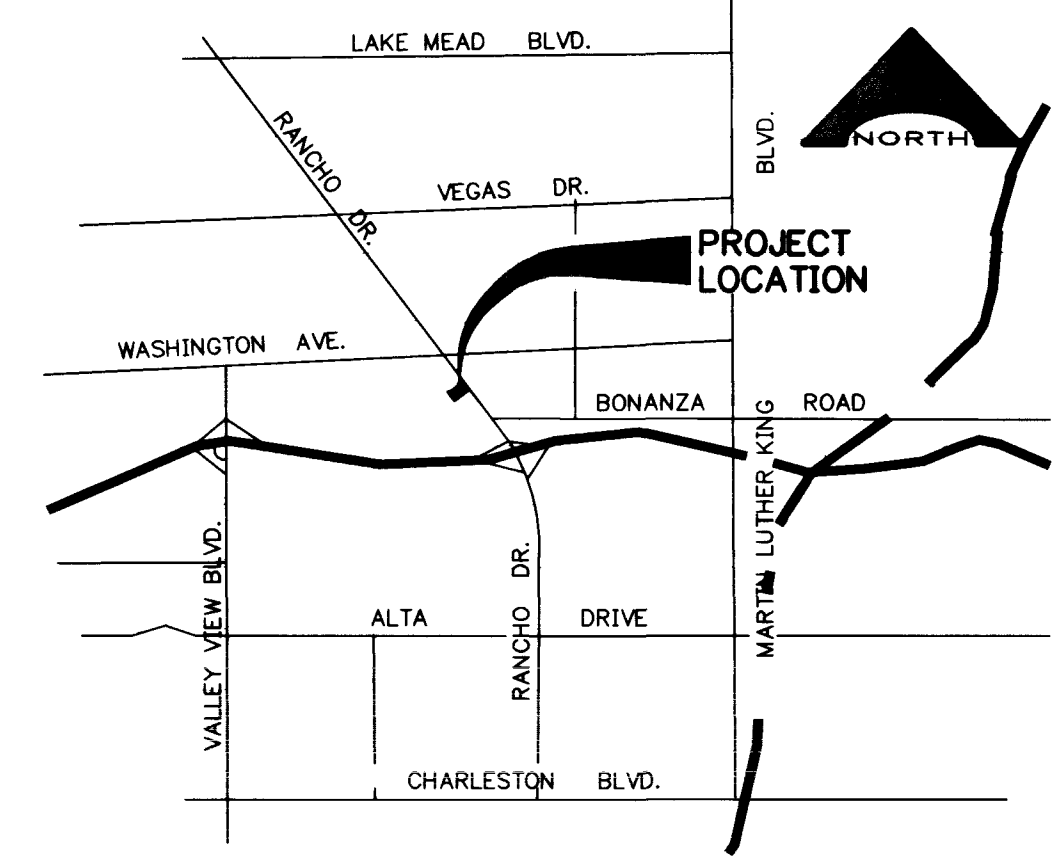

VICINITY MAP

NOT TO SCALE

DETAIL "A"

SCALE: 1" = 10'

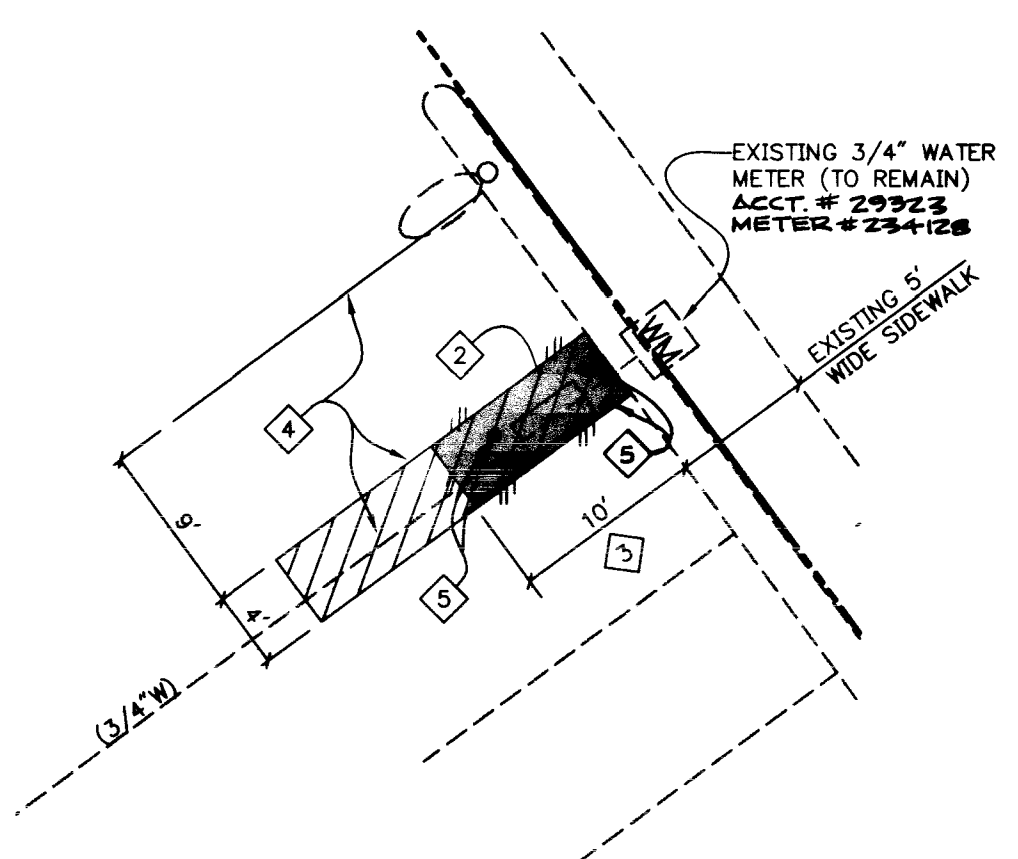

17004 17281

107-V3113

