

CONSTRUCTION NOTES

- CONSTRUCT "L" TYPE CURB AND GUTTER PER USD STD. DWG. NO. 216.
- CONSTRUCT TACK-ON TYPE ISLAND CURB PER USD STD. DWG. NO. 220.
- CONSTRUCT SIDEWALK PER USD STD. DWG. NO. 234, 4" THICK, 5' WIDE.
- CONSTRUCT HANDICAP ACCESS RAMP PER USD STD. DWG. 235.
- CONSTRUCT 2" A.C. PAVEMENT OVER 4" TYPE II AGGREGATE BASE.
- CONSTRUCT 3" WIDE CONCRETE V-GUTTER PER DETAIL SHEET 6.
- CONSTRUCT 8" WIDE CONCRETE CROSS GUTTER & SPANDREL PER USD STD. DWG. 228.
- CONSTRUCT DECORATIVE CONCRETE PAVING (SEE ARCHITECTS PLANS).
- CONSTRUCT CONCRETE CHANNEL PER DETAIL SHEET 6.

L.V.V.W.D. STANDARD NOTES

- NO WORK SHALL BEGIN UNTIL THE WATER PLANS HAVE BEEN RELEASED FOR CONSTRUCTION BY LVVWD. FOLLOWING WATER PLAN APPROVAL, 48 HOUR NOTICE SHALL BE GIVEN TO THE LVVWD COMMUNICATION SUPPORT CENTER (258-7171) PRIOR TO THE START OF CONSTRUCTION. NOTICE MUST BE GIVEN BY 2:00 P.M. THE BUSINESS DAY PRIOR TO AN LVVWD INSPECTION.
- ALL WORK SHALL CONFORM TO LVVWD STANDARD PRACTICE, DRAWINGS, AND SPECIFICATIONS AND THE UNIFORM DESIGN AND CONSTRUCTION STANDARDS FOR WATER DISTRIBUTION SYSTEMS (UDACS), LATEST EDITION.
- ALL WORK, EXCEPT AS MODIFIED BY THESE PLANS OR BY NOTE 2, SHALL BE DONE IN ACCORDANCE WITH THE MOST CURRENT DRAFT OR EDITION OF THE UNIFORM STANDARD SPECIFICATIONS FOR PUBLIC WORKS CONSTRUCTION OFF-SITE IMPROVEMENT, CLARK COUNTY AREA.
- A SINGLE PIPE MATERIAL SHALL BE USED THROUGHOUT THE PROJECT UNLESS OTHERWISE APPROVED BY THE LVVWD.
- ALL SERVICE LATERALS TWO (2) INCHES IN DIAMETER AND SMALLER SHALL BE COPPER TUBING WITH LVVWD APPROVED SERVICE SADDLES.
- ALL WATER METER BOXES SHALL BE LOCATED OUTSIDE OF DRIVEWAY AREAS.
- ALL VALVES SHALL BE LOCATED OUTSIDE OF DRIVEWAYS, VALLEY AND CURB GUTTERS.
- THE FOLLOWING REQUIREMENTS MUST BE MET IN THE EVENT OF A WATERLINE AND SANITARY OR STORM SEWER LINE CROSS:
 - A MINIMUM EIGHTEEN (18) INCH VERTICAL SEPARATION (OUTSIDE TO OUTSIDE) MUST BE MAINTAINED WHEN THE WATER LINE IS INSTALLED OVER THE SANITARY OR STORM SEWER LINE. IF THE VERTICAL SEPARATION CANNOT BE MAINTAINED OR THE WATER LINE MUST BE PLACED UNDER THE SANITARY OR STORM SEWER LINE, THE SANITARY OR STORM SEWER LINE MUST BE CONSTRUCTED WITH ONE OF THE FOLLOWING OR, AS SHOWN ON THESE PLANS:
 - POTABLE WATER SUPPLY QUALITY MATERIAL.
 - ENCASEMENT, WITH FOUR (4) INCH CONCRETE (MINIMUM).
 - SLEEVING WITH POTABLE WATER SUPPLY QUALITY PIPE.
 EACH PROVISION MUST EXTEND ALONG THE SANITARY OR STORM SEWER, ON EITHER SIDE OF THE MAIN, A MINIMUM 10 FOOT DISTANCE PERPENDICULAR TO THE WATER MAIN EXTERIOR.
- WARNING TAPE SHALL BE REQUIRED OVER ALL MAINS, ALL SIX (6) DIAMETER AND LARGER SERVICE LATERALS, AND ANY SERVICE LATERAL NOT INSTALLED PERPENDICULAR TO THE MAIN IN ACCORDANCE WITH STANDARD PLATE NO. 27.
- ALL WATER FACILITIES SHALL BE FILLED, DISINFECTED, PRESSURE TESTED, FLUSHED, FILLED AND AN ACCEPTABLE WATER SAMPLE OBTAINED, PRIOR TO CONNECTION TO THE LVVWD'S DISTRIBUTION SYSTEM.
- THE CONTRACTOR MUST OBTAIN ALL METERS TWO (2) INCHES AND SMALLER FROM THE LVVWD CENTRAL STORES. TELEPHONE 258-3152 FORTY-EIGHT (48) HOURS PRIOR TO PICKUP.
- CONSTRUCTION MAY INTERRUPT SERVICE, WITH LVVWD APPROVAL AND PROPER NOTIFICATION, BETWEEN THE HOURS OF 10 P.M. AND 6 A.M., SUNDAY THROUGH THURSDAY. CIRCUMSTANCES MAY REQUIRE TEMPORARY SERVICE FEEDS BE INSTALLED, WITHOUT LVVWD REIMBURSEMENT. ANY TEMPORARY SERVICE FEED MUST HAVE PRIOR LVVWD APPROVAL.
- ALL WATER FACILITY CONSTRUCTION MATERIALS USED MUST BE AS LISTED ON THE LVVWD'S PRE-APPROVED MATERIALS AND MANUFACTURERS LISTING FOR NEW FACILITIES, LATEST REVISION, OR SPECIFICALLY APPROVED ON THESE PLANS.

- CONSTRUCT UNDER SIDEWALK DRAIN PER USD STD. DWG. 236.
- RELOCATE EXISTING STREET LIGHT.
- CONSTRUCT NEW FIRE HYDRANT ASSEMBLY PER USD STD. DWG. 516.
- PAINT CURBS RED AND PLACE SIGNS INDICATING "FIRE LANE" PER CLV-FIRE DEPT. STANDARDS.
- REMOVE (AND SAME FOR RE-USE) EXISTING FDC, INSTALL 4"x90" BENDS AND 4" RISER (DYNA FLOW OR EQUAL).
- 6"x4" REDUCER
- 6"x45" BEND
- 6"x90" BEND
- NEW PRESTANDING FIRE DEPARTMENT CONNECTION (FDC) ON 4" STEEL RISER

PROJECT NAME: Parking Lot Improvement
 Pg. 4 of 6
 This project water plan complies with the Las Vegas Valley Water District's technical requirements. However, this water plan is **NOT APPROVED FOR CONSTRUCTION** at this time and this signature does not provide or imply a water commitment.
Kevin E. Brinkley 9-25-98
 LVVWD DATE

FIRE LINE NOTES

- CONSTRUCTION TO CONFORM TO ALL APPLICABLE NFPA AND CITY OF LAS VEGAS FIRE DEPT. STANDARDS.
- ALL BENDS TO HAVE THRUST BLOCKS PER UDS PLATE NO. 5.

CURVE DATA

CURVE	RADIUS	LENGTH	TANGENT	DELTA
C1	25.00'	39.27'	25.00'	90°00'00"
C2	15.00'	23.56'	15.00'	90°00'00"
C3	15.00'	23.67'	15.10'	90°23'45"
C4	15.00'	33.02'	29.53'	126°08'42"
C5	15.00'	24.94'	16.45'	95°16'43"
C6	15.00'	23.56'	15.00'	90°00'00"
C7	10.00'	10.81'	6.00'	61°55'27"
C8	20.00'	43.34'	37.74'	124°09'17"
C9	1699.72'	340.30'	170.72'	11°28'16"
C10	1.50'	3.94'	5.75'	150°47'47"
C11	50.00'	30.25'	15.96'	45°14'27"
C12	1.50'	3.89'	5.33'	148°36'18"

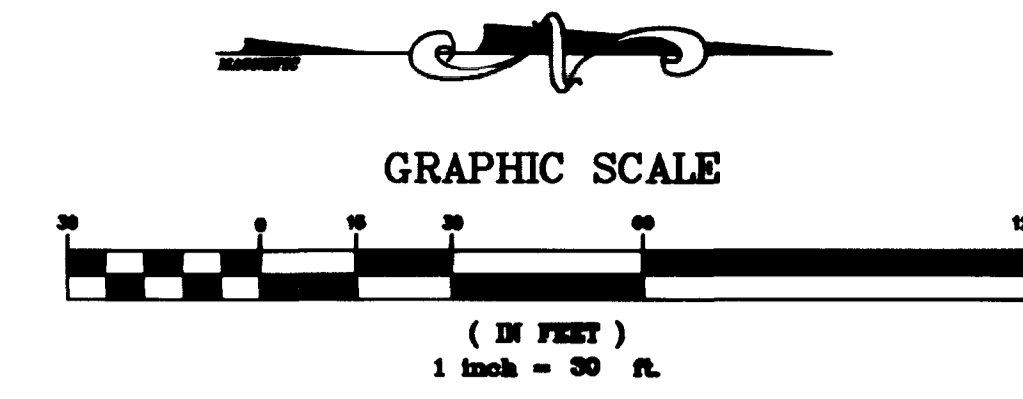

LEGEND

- 27 LOT NUMBER
- 2400' CONTOUR LINE (1' INTERVAL)
- FG FINISH GRADE
- FL FLOW LINE
- TC TOP OF CURB
- BC BACK OF CURB
- BCR BEGIN CURB RETURN
- EX EXISTING
- VG VALLEY GUTTER
- SCARP AREA
- CONCRETE BLOCK WALL
- NG NATURAL GROUND
- RETAINING WALL
- OB GRADE BREAK
- 42.1 PAD GRADE
- 0.5% DIRECTION AND RATE OF SLOPE
- BVC BEGIN VERTICAL CURVE
- MVC MID-POINT OF VERTICAL CURVE
- EVC END VERTICAL CURVE
- EXISTING WALL
- FF FINISH FLOOR ELEVATION
- BFE BASE FLOOD ELEVATION
- SL SEWER LATERAL

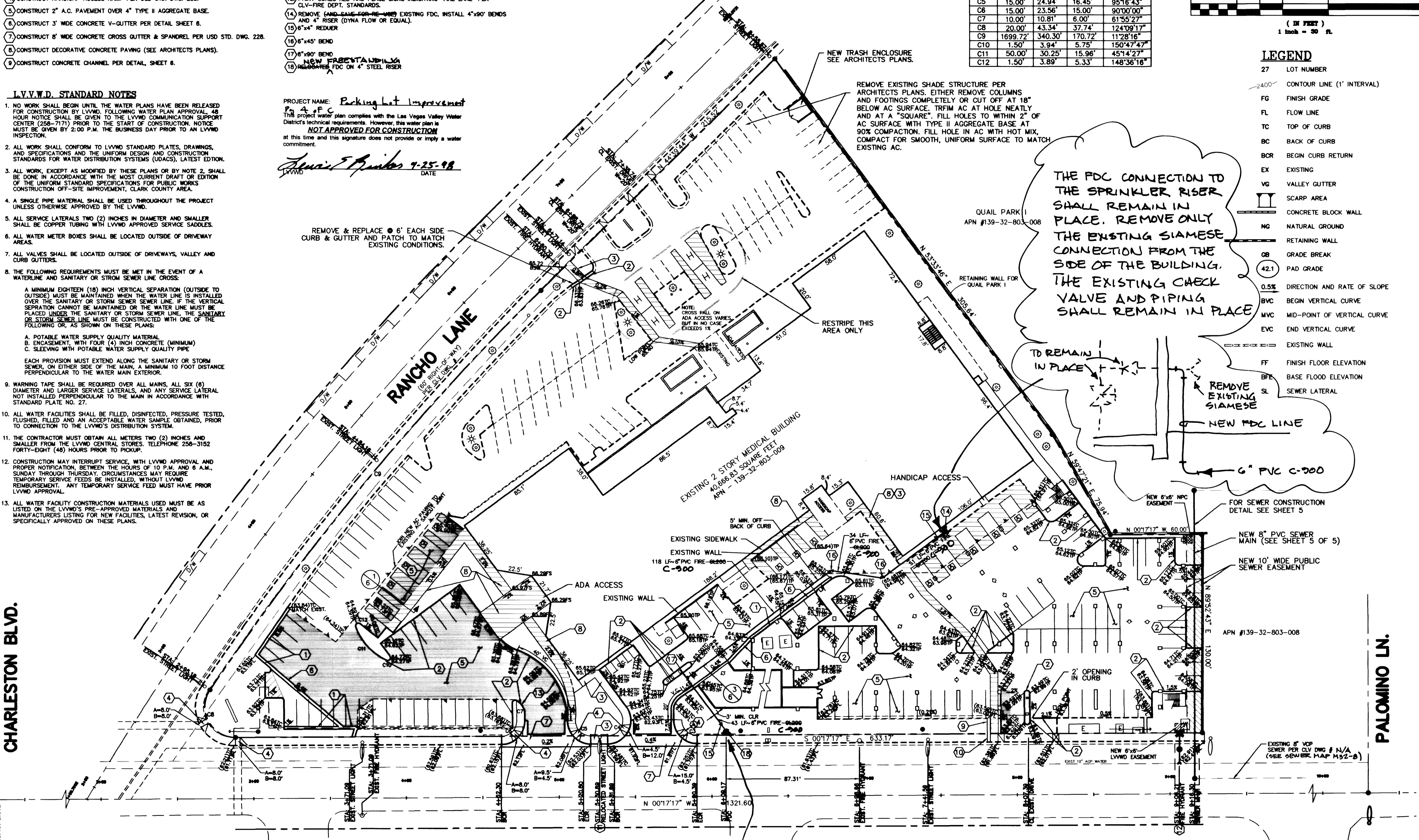

THE FDC CONNECTION TO THE SPRINKLER RISER SHALL REMAIN IN PLACE. REMOVE ONLY THE EXISTING SIAMESE CONNECTION FROM THE SIDE OF THE BUILDING. THE EXISTING CHECK VALVE AND PIPING SHALL REMAIN IN PLACE.

NOTE: THE EXISTING SPRINKLER SUPPLY LINE TO THE BUILDING SHALL EITHER BE RELOCATED OUTSIDE THE PARKING STRUCTURE, OR ENCASED IN STEEL SLEEVE PER CLV FIRE DEPARTMENT STANDARDS.

INSTALL A NEW PRESTANDING FIRE DEPARTMENT CONNECTION (FDC)

FIRE FLOW CALCULATIONS

FIRE FLOW REQUIREMENT IS 6,000 GALLONS PER MINUTE AT 20 PSI RESIDUAL PRESSURE.

	MEDICAL BUILDING	PARKING STRUCTURE
BASED ON:		
SQUARE FOOTAGE:	78,118	81,090
HEIGHT:	2 STORES	2 DECKS ABOVE GROUND
CONSTRUCTION:	2-HR.	II-N
SPRINKLERS:	YES	DRY STANDPIPE SYSTEM
REQUIRED FIRE FLOW:	2,500 GPM	6,000 GPM
*INCLUDES 50% REDUCTION FOR FIRE SPRINKLER SYSTEM		
REVIEWED BY:	<i>[Signature]</i>	DATE: 8/22/98

APPROVALS

NEVADA POWER COMPANY	DATE
THIS APPROVAL IS ONLY FOR THE PLACEMENT AND CLEARANCE OF STREET LIGHTS AND SIGNAL LIGHT INSTALLATIONS.	
LAS VEGAS VALLEY WATER DISTRICT	DATE
CITY OF LAS VEGAS FIRE DEPARTMENT	DATE: 8/22/98

Call before you Dig. It's a Law.
 1-800-227-2600

AVOID HITTING OVERHEAD POWER LINES. IT'S COSTLY.

CALL BEFORE YOU DO OVERHEAD

CALL 1-702-593-8111

TOWER REALTY AND DEVELOPMENT, INC.
 1701 W. CHARLESTON BLVD., #500
 LAS VEGAS, NEVADA 89102
 (702) 366-0444

AGRA Infrastructure, Inc.
 ENGINEERING GLOBAL SOLUTIONS
 2015 W. CHARLESTON BLVD., SUITE 100
 LAS VEGAS, NEVADA
 PHONE: (702) 678-3817

DELTA POINT
 901 S. RANCHO LANE

PARKING LOT IMPROVEMENT PLAN AND ADA ACCESS PLAN

SHEET: 3/17/98
 DESIGNED BY: MS
 CHECKED BY: MS
 PROJECT NO: L06E1014
 SCALE: 1" = 30'

DATE: 3/17/98

4 of 6 SHEETS
 DRAWING NO. 107-V2966

REVISION

