

WASHINGTON AVENUE

(PUBLIC)

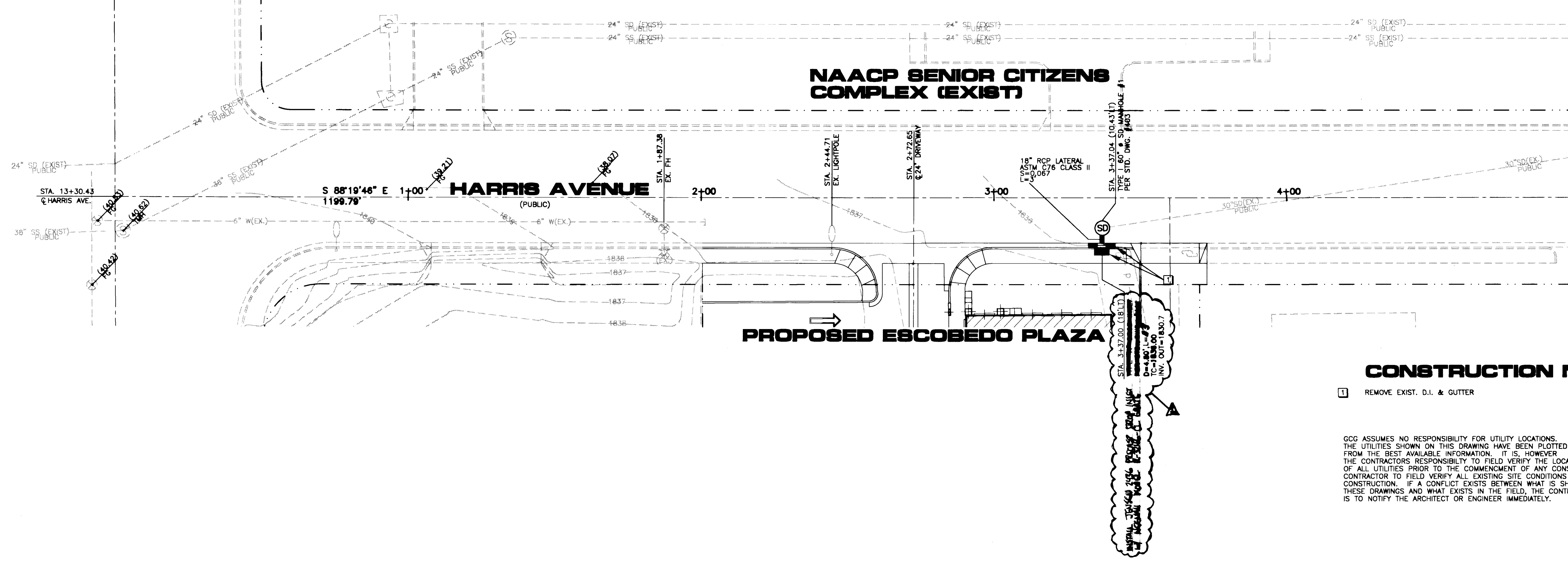

GRAPHIC SCALE



(IN FEET)
1 inch = 20 ft.

BASIS OF BEARINGS

SOUTH 01°17'00" WEST ALONG THE WESTERLY LINE OF THE SOUTHWEST QUARTER (SW 1/4) OF SECTION 25, TOWNSHIP 20 SOUTH, RANGE 61 EAST, M.D.M.

BENCHMARK

CITY OF LAS VEGAS BM#2LV01255W6, RIVET AND PLATE IN TOP OF CURB, SS RETURN EASTERN AVE. AND HARRIS AVE.
NAVD 88 DATUM
ELEVATION = 1840.795 FEET
ELEVATION = 561.0755 METERS

NAACP SENIOR CITIZENS COMPLEX (EXIST)

HARRIS AVENUE

(PUBLIC)

PROPOSED ESCOBEDO PLAZA

CONSTRUCTION NOTES

- 1 REMOVE EXIST. D.I. & GUTTER

GCG ASSUMES NO RESPONSIBILITY FOR UTILITY LOCATIONS. THE UTILITIES SHOWN ON THIS DRAWING HAVE BEEN PLOTTED FROM THE BEST AVAILABLE INFORMATION. IT IS, HOWEVER, THE CONTRACTOR'S RESPONSIBILITY TO FIELD VERIFY THE LOCATION OF ALL UTILITIES PRIOR TO THE COMMENCEMENT OF ANY CONSTRUCTION. CONTRACTOR TO FIELD VERIFY ALL EXISTING SITE CONDITIONS PRIOR TO CONSTRUCTION. IF A CONFLICT EXISTS BETWEEN WHAT IS SHOWN ON THESE DRAWINGS AND WHAT EXISTS IN THE FIELD, THE CONTRACTOR IS TO NOTIFY THE ARCHITECT OR ENGINEER IMMEDIATELY.

Avoid cutting underground utility lines. It's costly.
Call before you Dig.
1-800-227-2600

STORM DRAIN PROFILE

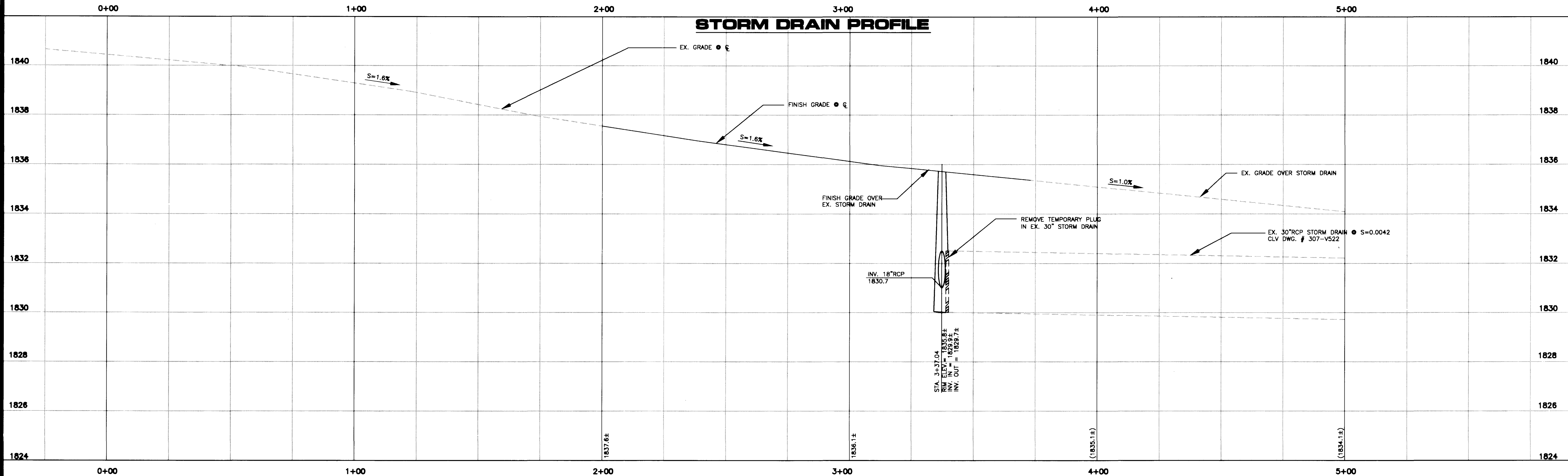

EDMUNDO & PANFLA ESCOBEDO
3008 HOLLY HILL DR.
LAS VEGAS, NEVADA 89104 -4305

Gomez
CONSULTING GROUP, INC.
11 WEST PACIFIC AVENUE
HENDERSON, NEVADA 89015-7304
(702) 566-0440

SHEET 30-INCH STORM DRAIN PLAN & PROFILE STA. 3+37.00 TO 4+00.00 ESCOBEDO PLAZA

DRAWN BY: CLN
DESIGNED BY: CLN
CHECKED BY: MEG
PROJECT NO: 4928
SCALE: 1"=20'
HORIZ: 1"=2'
VERT: 1"=2'

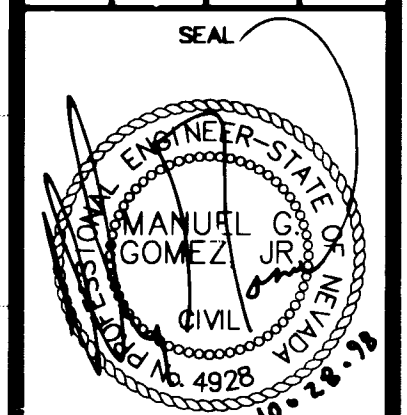

SHEET SD1
11 OF 11 SHEETS
DRAWING NO. 107-V2888

WASHINGTON AVENUE



DATE OF REVISION
 10/15/2010
 REVISION
 1. 10/15/2010
 2. 10/15/2010
 3. 10/15/2010

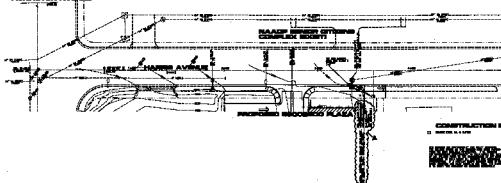

CONSTRUCTION NOTES
 1. SEE PLAN 10/15/2010



10/15/2010
 10/15/2010
 10/15/2010

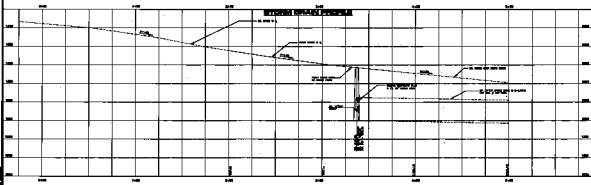

PROJECT NO.	DATE
BY	SCALE
CHECKED BY	DATE
APPROVED BY	DATE
10/15/2010 10/15/2010 10/15/2010	