

# IMPROVEMENT PLANS OF DECATUR / LAKE MEAD COMMERCIAL

## CITY OF LAS VEGAS GENERAL NOTES

- ALL CONSTRUCTION AND MATERIALS SHALL BE IN ACCORDANCE WITH THE "UNIFORM STANDARD SPECIFICATIONS FOR PUBLIC WORKS CONSTRUCTION OFF-SITE IMPROVEMENTS, CLARK COUNTY AREA NEVADA", LATEST EDITION; THE "UNIFORM STANDARD DRAWINGS FOR PUBLIC WORKS CONSTRUCTION, CLARK COUNTY AREA NEVADA", LATEST EDITION; AND OTHER APPLICABLE APPROVED STANDARDS ISSUED BY THE CONTROLLING AGENCY; THE UNIFORM BUILDING CODE; AND ALL LOCAL CITY CODES AND ORDINANCES APPLICABLE, EXCEPT AS NOTED ON THIS SHEET AS "DEVIATIONS FROM STANDARDS".
- THE EXISTENCE AND LOCATION OF ANY OVERHEAD OR UNDERGROUND UTILITY LINES, PIPES, OR STRUCTURES SHOWN ON THESE PLANS ARE OBTAINED BY A RESEARCH OF THE AVAILABLE RECORDS, EXISTING UTILITIES AS SHOWN FROM CLV PLANS LIBRARY ARE APPROXIMATE AND FOR RECORD PURPOSES. EXISTING UTILITIES ARE LOCATED ON PLANS ONLY FOR THE CONVENIENCE OF THE CONTRACTOR. EXISTING UTILITY SERVICE LATERALS MAY NOT BE SHOWN ON THE PLANS. THE CONTRACTOR SHALL, AT HIS OWN EXPENSE, LOCATE ALL UNDERGROUND AND OVERHEAD INTERFERENCES WHICH MAY AFFECT HIS OPERATION DURING CONSTRUCTION AND SHALL TAKE ALL NECESSARY PRECAUTIONS TO AVOID DAMAGE TO SAME. THE CONTRACTOR SHALL USE EXTREME CAUTION WHEN WORKING NEAR OVERHEAD UTILITIES SO AS TO SAFELY PROTECT ALL PERSONNEL AND EQUIPMENT, AND SHALL BE RESPONSIBLE FOR ALL COST AND LIABILITY IN CONNECTION THEREWITH.
- THE CONTRACTOR SHALL TAKE ALL PRECAUTIONARY MEASURES NECESSARY TO PROTECT EXISTING UTILITY LINES, STRUCTURES AND STREET IMPROVEMENTS WHICH ARE TO REMAIN IN PLACE, FROM DAMAGE, AND ALL SUCH IMPROVEMENTS OR STRUCTURES DAMAGED BY THE CONTRACTOR'S OPERATIONS SHALL BE REPAIRED OR REPLACED SATISFACTORY TO THE CITY ENGINEER AND OWNING UTILITY COMPANY AT THE EXPENSE OF THE CONTRACTOR.
- ALL CONSTRUCTION SHALL BE AS SHOWN ON THESE PLANS, ANY REVISIONS SHALL HAVE THE PRIOR WRITTEN APPROVAL OF THE CITY ENGINEER.
- TYPE V CEMENT SHALL BE USED IN ALL OFF-SITE CONCRETE WORK. CONCRETE TO BE 3000 P.S.I. MINIMUM @ 28 DAYS. MIX DESIGN TO BE APPROVED BY THE CITY ENGINEER, PRIOR TO THE USE ON THE PROJECT.
- PERMITS ARE REQUIRED FOR ANY WORK IN THE PUBLIC RIGHT-OF-WAY. THE CONTRACTOR SHALL SECURE ALL PERMITS AND INSPECTIONS REQUIRED FOR THIS CONSTRUCTION.
- EXPANSION JOINTS REQUIRED, MAXIMUM EVERY 300' IN EXTRUDED-TYPE CURB.
- AC PAVEMENT TO BE ONE-HALF INCH (1/2") ABOVE TOP OF ALL GUTTERS AFTER COMPACTION, EXCEPT AT SIDEWALK RAMPS AND CROSS GUTTERS.
- CURB AND GUTTER FOUND TO BE UNACCEPTABLE TO THE CITY OF LAS VEGAS SHALL BE REMOVED AND REPLACED PER STANDARD DRAWING 216.
- SIDEWALK RAMPS SHALL BE CONSTRUCTED IN EACH QUADRANT OF AN INTERSECTION PER STANDARD DRAWING 235. EXACT LOCATION OF RAMPS MAY BE ADJUSTED IN THE FIELD BY A CITY INSPECTOR.
- CONTRACTOR SHALL PROVIDE ALL NECESSARY HORIZONTAL AND VERTICAL TRANSITIONS BETWEEN NEW CONSTRUCTION AND EXISTING SURFACES TO PROVIDE FOR PROPER DRAINAGE AND FOR INGRESS AND EGRESS TO NEW CONSTRUCTION. THE EXTENT OF TRANSITIONS TO BE AS SHOWN ON PLANS.
- ALL GRADING WORK SHALL CONFORM TO THE SOILS REPORT AS PREPARED BY THE SOILS ENGINEER APPROVED BY THE CITY ENGINEER, AND AS SHOWN ON THESE PLANS.
- EXACT LOCATION OF ALL SAWCUT LINES MAY BE ADJUSTED OR DETERMINED IN THE FIELD BY A CITY OF LAS VEGAS ENGINEER IF LOCATIONS ON PLANS IS NOT CLEARLY SHOWN, OR EXISTING PAVEMENT CONDITION REQUIRES RELOCATIONS.
- THE CONTRACTOR SHALL TAKE ALL PRECAUTIONS NECESSARY TO PROTECT EXISTING PERMANENT SURVEY MONUMENT. ANY MONUMENTS DISTURBED SHALL BE REPLACED AND ADJUSTED PER AVAILABLE RECORDS IN ACCORDANCE WITH N.R.S. STATUTE NO. 625.550.
- UTILITY COMPANY METER BOXES, MANHOLE LIDS, VALVE COVERS, ETC., SHALL BE LOCATED OUT OF DRIVEWAYS, DRIVEWAY APRONS, FLOWLINES, AND CROSS GUTTERS UNLESS WRITTEN APPROVAL IS GRANTED BY THE UTILITY COMPANY AND THE CITY ENGINEER.
- ALL WALLS, NEW OR EXISTING, ARE ONLY SHOWN ON CIVIL PLANS FOR THE PURPOSE OF DEFINING GRADING RELATIONSHIPS; FLOOD CONTROL, AND SIGHT DISTANCE AT INTERSECTIONS. NEW WALLS REQUIRE BUILDING PERMIT AND BUILDING INSPECTION.
- ASPHALT MIX DESIGN MUST BE SUBMITTED AND APPROVED BY THE CITY ENGINEER PRIOR TO THE PLACEMENT OF ASPHALT WITHIN CITY RIGHT-OF-WAY.
- CONTRACTOR SHALL ADJUST ALL NEW AND EXISTING INLETS, VALVE BOXES, MANHOLE RIMS, AND SEWER CLEAN-OUTS, ETC. TO FINISH GRADE AS APPLICABLE WHETHER OR NOT THEY ARE SHOWN ON THE PLANS.
- MATERIALS, HANDLING AND PLACEMENT OF PORTLAND CEMENT CONCRETE SHALL BE IN ACCORDANCE WITH APPLICABLE SECTIONS OF MDOOT OR THE CLARK COUNTY AREA SPECIFICATIONS (AS APPLICABLE) AND THE PLANS AND DETAILS SHOWN HEREON.

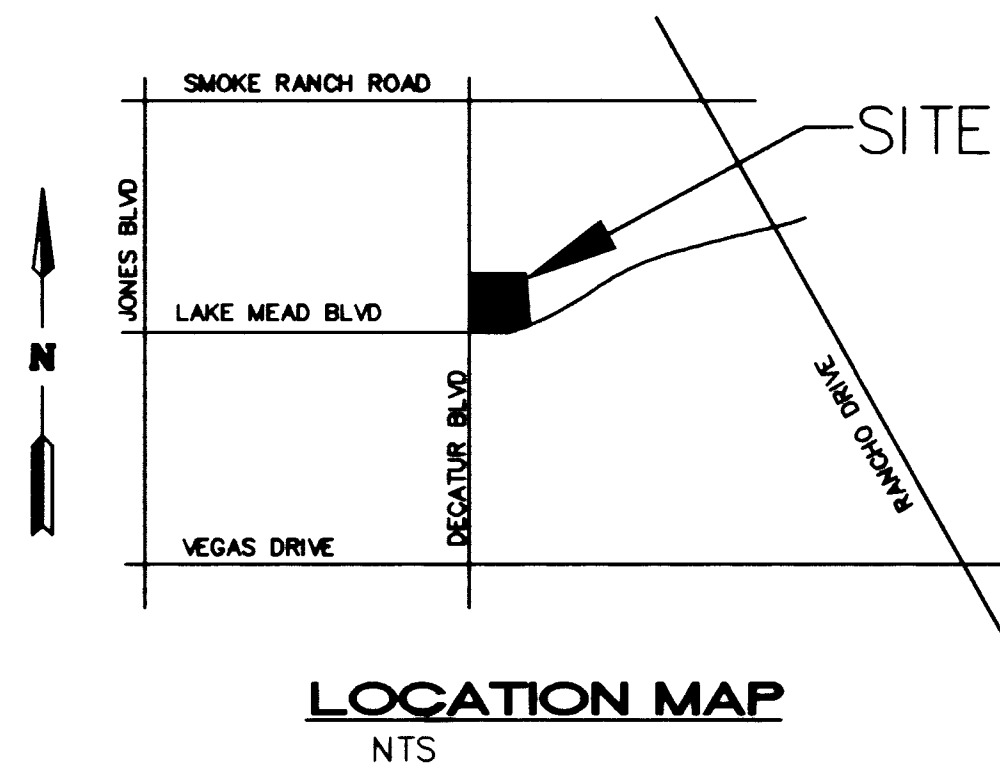
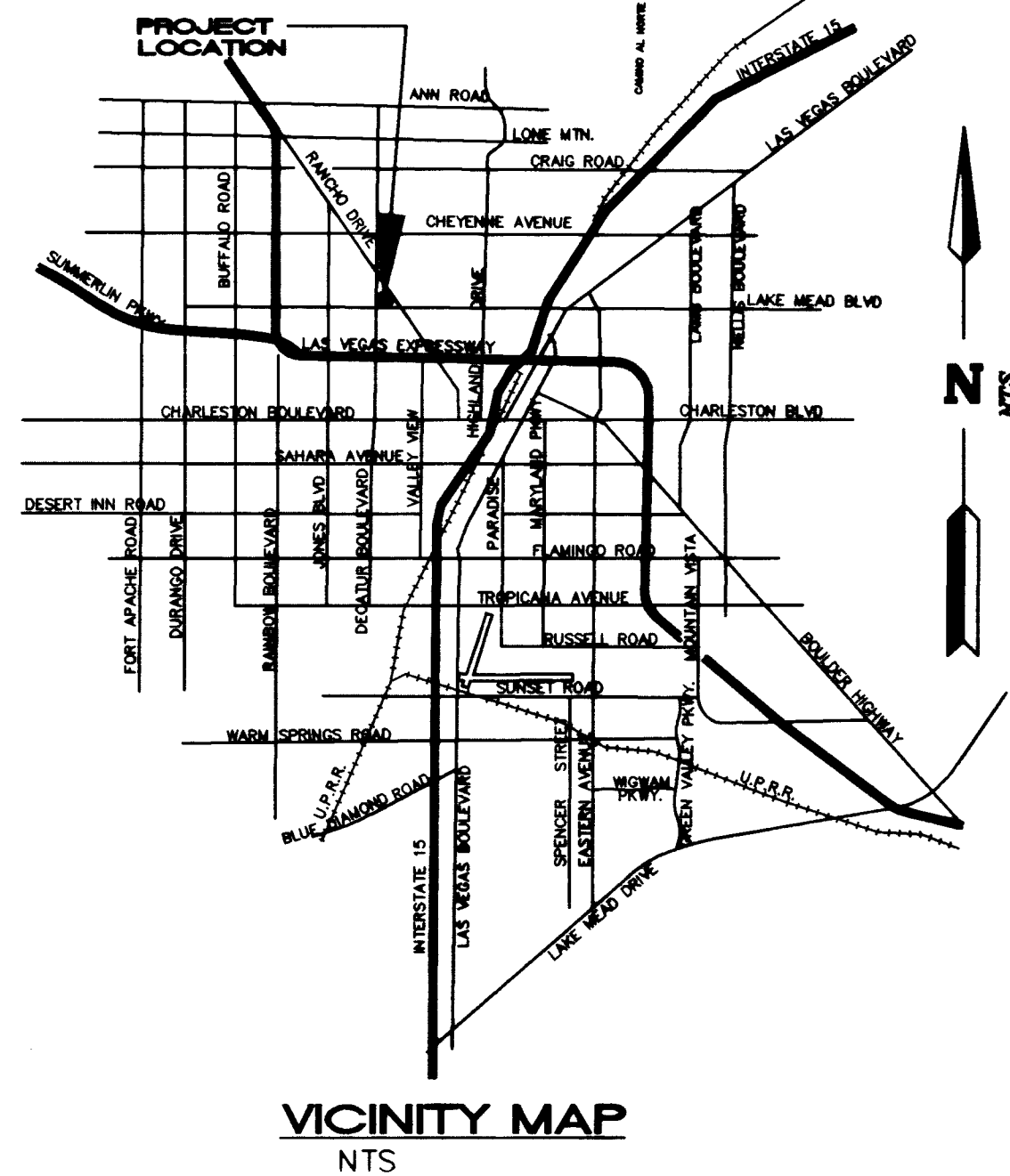

## SHEET INDEX

SHEET 1	COVER SHEET
SHEET 2	GRADING PLAN
SHEET 3	MASTER UTILITY PLAN

## QUANTITIES: WATER NOTES/QUANTITIES

1" RPPA (PRIVATE)	1 EA
1" METER (PUBLIC)	1 EA
1" WATER (PRIVATE)	82 LF
6" DODA (PRIVATE)	1 EA
6" WATER (PRIVATE)	63 LF
1 FIRE HYDRANT ASSEMBLY (PRIVATE)	1 EA
1" STUB AT BUILDING (PRIVATE)	1 EA

## SEWER QUANTITIES (PRIVATE)

6" STUB	1 EA
6" CLEAN OUT	1 EA
6" SEWER SERVICE	48 LF



## STREET QUANTITIES (PUBLIC)

24" L' CURB & GUTTER	82 L.F.
8" CROSS GUTTER	720 S.F.
4" SIDEWALK	310 S.F.
RELOCATE STREET LIGHTS	2 EA.

## PAVING QUANTITIES (PRIVATE)

24" L' CURB & GUTTER	190 L.F.
6" TYPE II	165 C.Y.
1' A' OR TACK-ON TYPE CURB	295 L.F.
2" ASPHALTIC CONCRETE PAVING	975 S.Y.

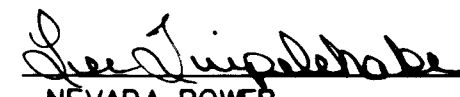
## APPROVALS:

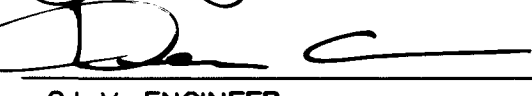
 5/8/98  
 NEVADA POWER DATE  
 5/8/98  
 SOUTHWEST GAS CORP. DATE  
 5-8-98  
 SPRINT CENTRAL TELEPHONE-NEVADA DATE  
 6-22-98  
 C.L.V. ENGINEER DATE

## DEVIATION FROM STANDARDS

DRIVEWAYS ARE DEVIATION FROM STANDARD DRAWING 222A (PARTIAL RADII, SHORTENED THROATS)

## OWNER/DEVELOPER:

BECKER INVESTMENTS  
50 SOUTH JONES BOULEVARD  
LAS VEGAS, NV. 89107  
(702) 870-1226

APPROVAL OF THESE PLANS BY THE CITY ENGINEER IS LIMITED TO THOSE IMPROVEMENTS CONSTRUCTED IN THE DEDICATED RIGHTS-OF-WAY AND/OR DEDICATED EASEMENTS. THIS APPROVAL DOES NOT AUTHORIZE THE CONSTRUCTION OF ANY IMPROVEMENTS THAT DEViate FROM ADOPTED STANDARDS AND/OR SPECIFICATIONS EXCEPT THOSE SPECIFICALLY LISTED UNDER "DEVIATIONS FROM STANDARDS". THE ENGINEER SHALL RESOLVE ANY DEVIATION OTHER THAN THOSE LISTED IN "DEVIATIONS FROM STANDARDS" IN FAVOR OF THE UNIFORM STANDARD DRAWINGS AND SPECIFICATIONS CLARK COUNTY AREA, NEVADA.

**NOTICE!**

EXISTING UTILITIES ARE SHOWN ON PLANS FOR THE CONVENIENCE OF THE CONTRACTOR ONLY. THE CONTRACTOR IS RESPONSIBLE FOR THE PROTECTION OF ALL UTILITIES. THE ENGINEER BEARS NO RESPONSIBILITY FOR UTILITIES NOT SHOWN OR SHOWN INCORRECTLY.

**Call 811 BEFORE YOU DIG**

1-800-227-2600  
UNDERGROUND SERVICE (USA)

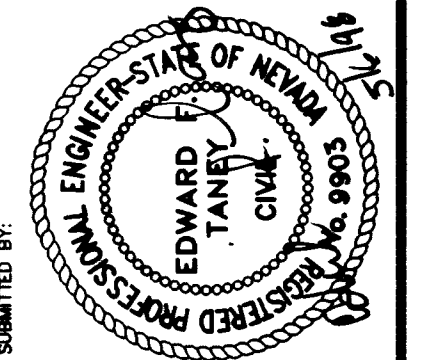
  
 SUBMITTED BY: EDWARD TANEY  
 ENGINEER-STATE OF NEVADA  
 LICENSE NO. 10175  
**ALPHA ENGINEERING COMPANY**  
 800 W. Sahara Blvd., Las Vegas, NV. 89107  
 Phone: (702) 271-1000

PROJECT: **DECATUR / LAKE MEAD COMMERCIAL**  
 TITLE: **COVER SHEET**

JOB NO.:	714608
NAME:	RDC
DATE:	4/21/98
SCALE:	NOT TO SCALE

PAGE:	1
OF:	3

DRAWING NO.: 714608CS

# IMPROVEMENT PLANS OF DECATUR / LAKE MEAD COMMERCIAL

- 1. APPROVED BY THE CITY OF DECATUR, GEORGIA
- 2. APPROVED BY THE CITY OF DECATUR, GEORGIA
- 3. APPROVED BY THE CITY OF DECATUR, GEORGIA
- 4. APPROVED BY THE CITY OF DECATUR, GEORGIA
- 5. APPROVED BY THE CITY OF DECATUR, GEORGIA
- 6. APPROVED BY THE CITY OF DECATUR, GEORGIA
- 7. APPROVED BY THE CITY OF DECATUR, GEORGIA
- 8. APPROVED BY THE CITY OF DECATUR, GEORGIA
- 9. APPROVED BY THE CITY OF DECATUR, GEORGIA
- 10. APPROVED BY THE CITY OF DECATUR, GEORGIA
- 11. APPROVED BY THE CITY OF DECATUR, GEORGIA
- 12. APPROVED BY THE CITY OF DECATUR, GEORGIA
- 13. APPROVED BY THE CITY OF DECATUR, GEORGIA
- 14. APPROVED BY THE CITY OF DECATUR, GEORGIA
- 15. APPROVED BY THE CITY OF DECATUR, GEORGIA
- 16. APPROVED BY THE CITY OF DECATUR, GEORGIA
- 17. APPROVED BY THE CITY OF DECATUR, GEORGIA
- 18. APPROVED BY THE CITY OF DECATUR, GEORGIA
- 19. APPROVED BY THE CITY OF DECATUR, GEORGIA
- 20. APPROVED BY THE CITY OF DECATUR, GEORGIA



MAP



LOCATION MAP

- SHEET INDEX**
- SHEET 1 COVER SHEET
  - SHEET 2 GRADING PLAN
  - SHEET 3 WATER PUMP PLAN

**QUANTITIES**

**PAVING, MOTOR/OIL/WATER**

PAVING	1.00
MOTOR/OIL/WATER	1.00

**UTILITY QUANTITIES (FOOTING)**

UTILITY QUANTITIES (FOOTING)	1.00
------------------------------	------

**UTILITY QUANTITIES (SIGNAL)**

UTILITY QUANTITIES (SIGNAL)	1.00
-----------------------------	------

**UTILITY QUANTITIES (CONCRETE)**

UTILITY QUANTITIES (CONCRETE)	1.00
-------------------------------	------

**DEVIATION FROM STANDARDS**  
 DEPARTS THE STANDARD  
 (SEE PLAN, SEE, STANDARD)

**APPROVALS**

*[Signature]* \_\_\_\_\_  
*[Signature]* \_\_\_\_\_  
*[Signature]* \_\_\_\_\_  
*[Signature]* \_\_\_\_\_

**COMMERCIAL CORNER**

1000 INVESTMENTS  
 50 SOUTH JONES BOULEVARD  
 LAWYERS, WILSON, GA 30157  
 (770) 420-1000



**ALPHA OMEGA CONSULTING COMPANY**

1000 INVESTMENTS  
50 SOUTH JONES BOULEVARD  
LAWYERS, WILSON, GA 30157  
(770) 420-1000

---

DECATUR LAKE MEAD COMMERCIAL CORNER SHEET

---

1