

MATCHLINE STA 9+00.00  
SEE DWG No. C1

MATCHLINE STA 20+00.00  
SEE DWG No. C3

REVISIONS		DATE	DESCRIPTION
1	Changed Pipe Size from 36" to 36"	10/1/98	

**DURANGO INTERCEPTOR SEWER**  
 DRAWN BY: J. ARROYO  
 CHECKED BY: J. LUSTIG  
 DATE: 8-31-98  
 JOB NO.: 51149  
 PROJECT: City of Las Vegas, Green Valley Pkwy, Station 100, Henderson, Nevada 89014  
 PHONE: 702/263-7506

**PROFESSIONAL ENGINEER-STATE OF NEVADA**  
 J. LUSTIG  
 No. 12119  
 11/19/00

Department of Public Works  
**DURANGO INTERCEPTOR SEWER  
 PLAN AND PROFILE  
 STA 9+00.00 TO STA 20+00.00**

**CITY OF LAS VEGAS NEVADA**  
 DRAWING No. 7  
 C2

**SANITARY SEWER ALTERNATIVES**

ALT "A" - 8" SEWER STA 1+03.75 TO STA 18+80.47
10" SEWER STA 18+80.47 TO STA 98+90.83
27" SEWER STA 98+90.83 TO STA 125+20.39
30" SEWER STA 125+20.39 TO STA 156+66.01
36" SEWER STA 156+66.01 TO STA 190+44.26
ALT "B" - 8" SEWER STA 1+03.75 TO STA 190+44.26 (FOR BIDDING PURPOSES ONLY)

**NOTE:**  
 ALL EXISTING UTILITY LOCATIONS SHOWN HEREON ARE APPROXIMATE ONLY. IT SHALL BE THE CONTRACTOR'S RESPONSIBILITY TO DETERMINE THE EXACT VERTICAL AND HORIZONTAL LOCATION OF ALL EXISTING UNDERGROUND UTILITIES PRIOR TO CONSTRUCTION AND RELOCATE THESE UTILITIES AS NECESSARY. NO REPRESENTATION IS MADE THAT ALL UTILITIES ARE SHOWN HEREON. THE ENGINEER ASSUMES NO LIABILITY FOR UTILITIES NOT SHOWN OR UTILITIES NOT SHOWN IN THEIR PROPER LOCATIONS.

SCALE: HORIZ. 1"=40'  
 VERT. 1"=4'

Call before you Dig  
 1-800-227-2600

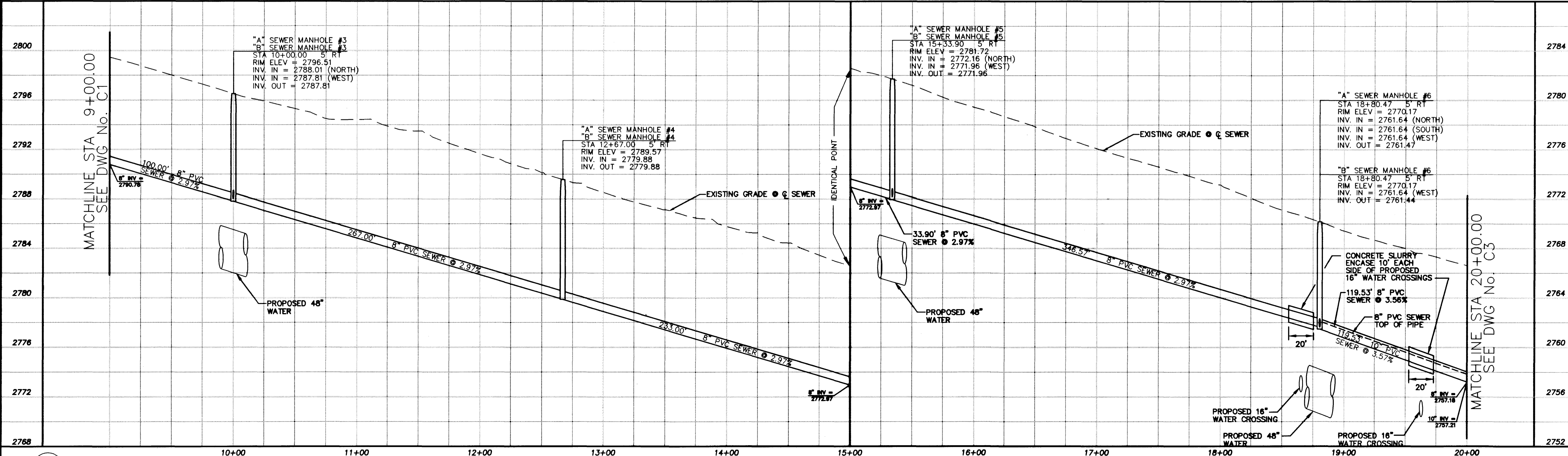

10420 10806

307-V770

