

NOTES:
 1. STREET LIGHTS SHALL NOT ENROACH INTO SIDEWALKS OR WALKWAYS.
 2. PUBLIC SIDEWALK EASEMENTS SHALL BE PROVIDED ON THE APPROPRIATE SIDE OF THOSE PRIVATE STREETS WHERE SIDEWALKS ARE TO BE BUILT AND THAT GARAGE DOOR SETBACKS ARE TO BE MEASURED FROM THE PROPERTY LINE OR THE HOUSE SIDE OF THE SIDEWALK, WHICHEVER IS THE SHORTEST DISTANCE.
 * STRUCTURAL SECTION TO CONFORM WITH APPROVED SOILS REPORT DATED: AUGUST 10' 1998 FILE NO. 98745E1 BY GEOTECHNICAL & ENVIRONMENTAL SERVICES, INC.

RAVEN CREEK AVE. (40' PRIVATE ST.)
 SCALE: NONE

CONSTRUCTION NOTES

- 1] CONSTRUCT 8" CONCRETE VALLEY GUTTER PER CLARK COUNTY AREA STD. DWG NO. 228
- 2] CONSTRUCT "L" CURB AND GUTTER PER CLARK COUNTY AREA STD. DWG NO. 216
- 3] CONSTRUCT TACK ON ISLAND CURB PER CLARK COUNTY STD. DWG. NO. 220
- 4] CONSTRUCT SIDEWALK RAMP (CASE I) PER CLARK COUNTY AREA STD. DWG. NO. 235
- 5] CONSTRUCT 5.0' WIDE CONCRETE SIDEWALK PER CLARK COUNTY AREA STD. DWG. NO. 234
- 6] CONSTRUCT 4.0' WIDE CONCRETE SIDEWALK PER CLARK COUNTY AREA STD. DWG. NO. 234
- 7] CONSTRUCT SIDEWALK DRAIN PER CLARK COUNTY AREA STD. DWG. NO. 236
- 8] INSTALL TEMPORARY END OF ROAD BARRICADE
- 9] CONSTRUCT 10.0' ROLL TO "L" TYPE CURB SEE DETAIL SHEET 17
- 10] SAWCUT EXIST. A.C. PAVING AND REMOVE
- 11] NO PARKING ANYTIME (PAINT CURB RED)
- 12] CONSTRUCT ROLL TYPE CURB AND GUTTER PER CLARK COUNTY AREA STD. DWG. NO. 217A

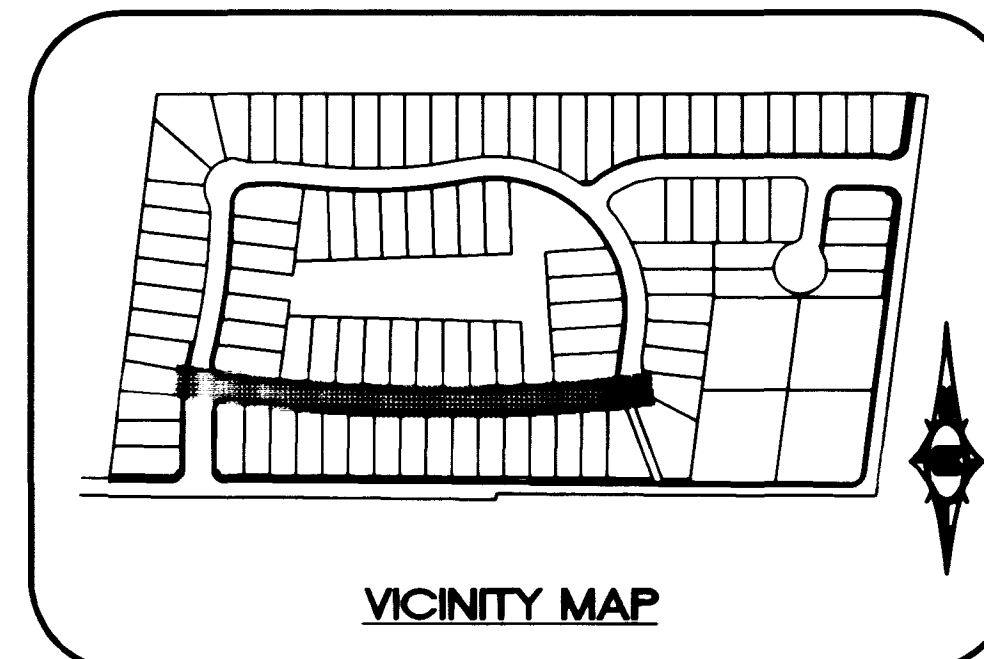

BACK OF CURB CURVE DATA

CURVE	DELTA	RADIUS	LENGTH	TANGENT
* C1	101°7'42"	3002.00'	539.41'	270.43'
* C2	77°13'10"	42.00'	56.60'	33.54'
C3	09°58'20"	2984.00'	519.34'	260.34'
C4	77°13'10"	24.00'	32.35'	19.17'
C5	25°50'31"	50.00'	22.55'	11.47'
C6	129°00'43"	50.00'	112.58'	104.86'

* INDICATES CENTERLINE CURVE DATA

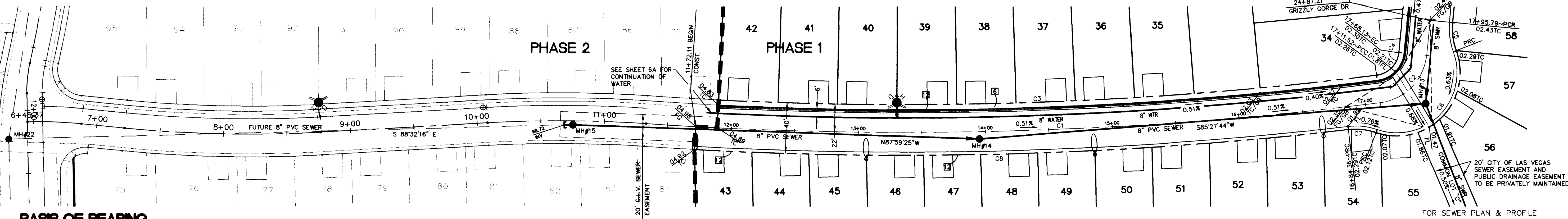
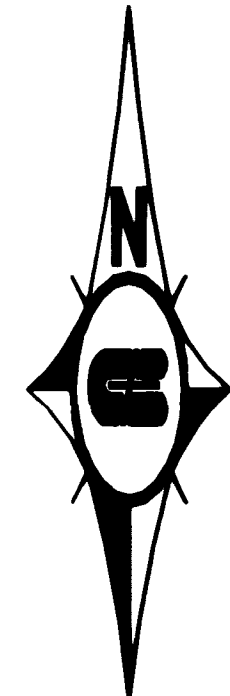

BASIS OF BEARING

NORTH 88°46'05" EAST BEING THE CENTERLINE OF AZURE DRIVE AS SHOWN ON RECORDS OF SURVEY FILE 52 PAGE 70 AND FILE 90 PAGE 44 IN THE OFFICE OF THE COUNTY RECORDER, CLARK COUNTY NEVADA.

BENCHMARK

CITY OF LAS VEGAS BENCHMARK #23 11V9025N4 BEING AN ALCAP ON REBAR AT THE CENTERLINE INTERSECTION OF CENTENNIAL PKWY. AND BRADLEY ROAD.
 NAVD88 ELEVATION: 2302.77' = 701.8865 METERS

RAVEN CREEK AVE.
 (PRIVATE STREET W/ PUE, CLV SEWER EASEMENT, PUBLIC DRAINAGE EASEMENT TO BE PRIVATELY MAINTAINED)
 (MAINTAINED BY H.O.A.)

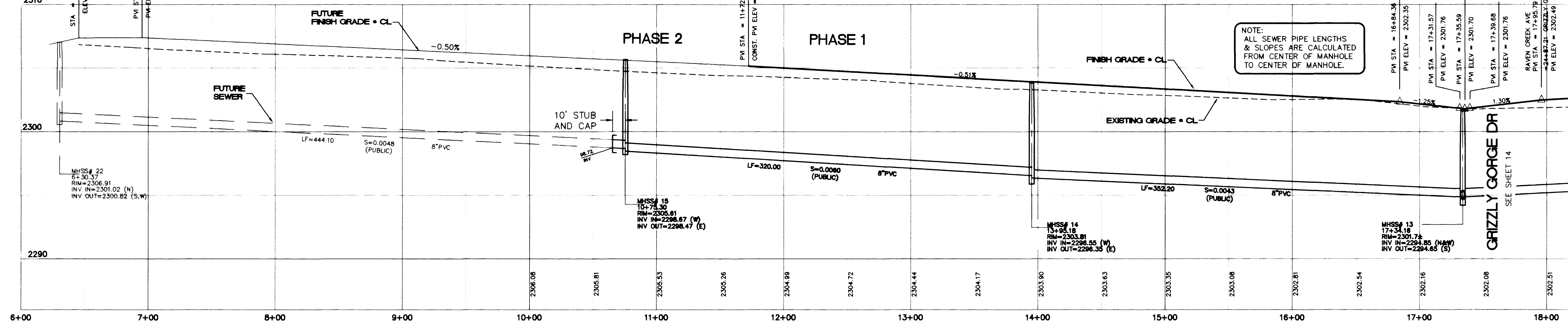
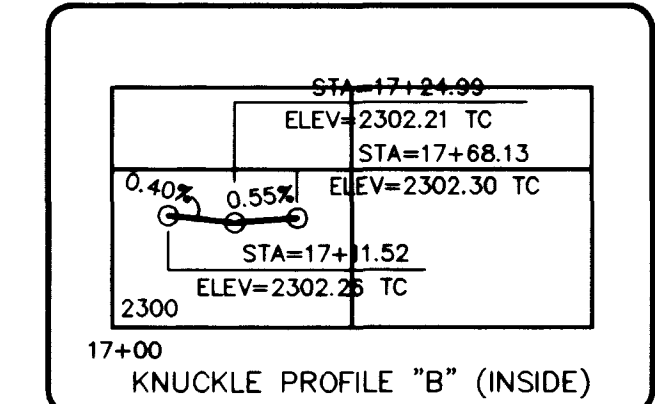
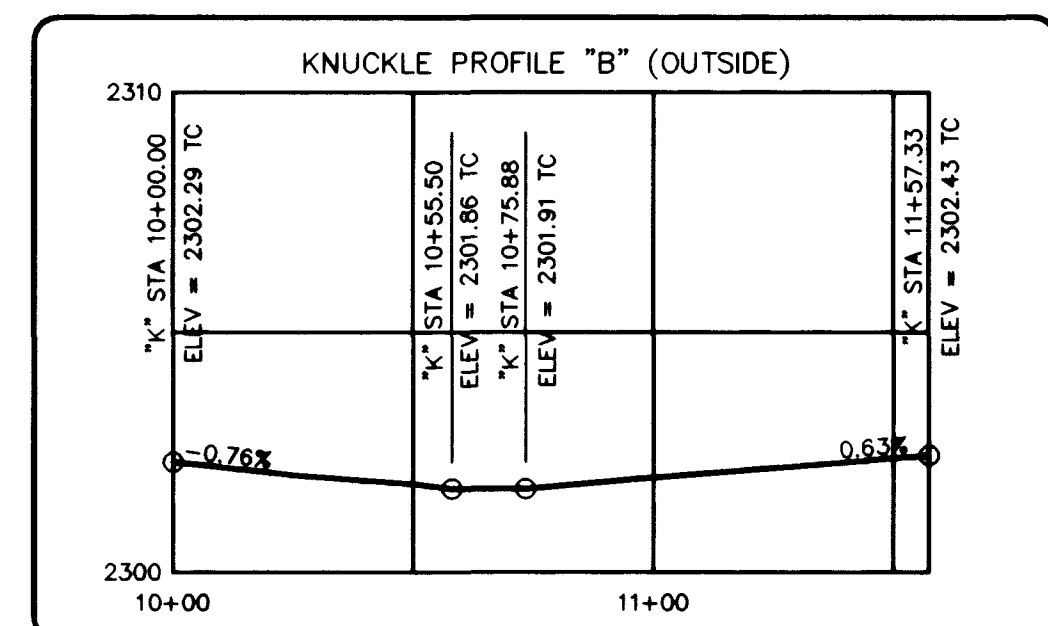
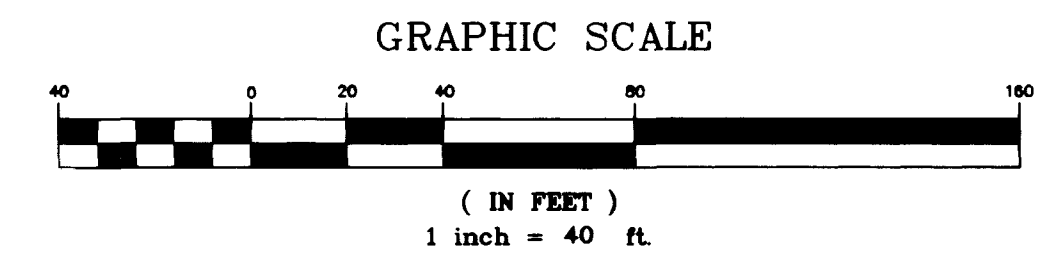

NOTE:
 ALL SEWER PIPE LENGTHS & SLOPES ARE CALCULATED FROM CENTER OF MANHOLE TO CENTER OF MANHOLE.

REVISION BY DATE

Pulte Homes
 An American Favorite

Carter :: Burgess
 6655 Bermuda road
 Consultants in Planning, Engineering, Architecture, Las Vegas, NV 89119
 Construction Management, and Related Services (702) 938-5400 Fax (702) 938-5454

PLAN AND PROFILE
 RAVEN CREEK AVENUE

EAGLE CREEK 11
 PHASE 1

DRAWN BY: RCM
 DESIGNED BY: RCM
 CHECKED BY: RJT
 PROJECT NO: 98V089
 SCALE: 1"=40' HORIZ.
 1"=4' VERT.

PROFESSIONAL ENGINEER-STATE OF NEVADA
 ROBERT W. JOHNSON
 No. 13698
 8/13/99

SHEET 15 OF 19 SHEETS
 DRAWING NO. 1074-4614-1

L:\98V189_Design\PH1\8189-15P.DWG - CITY OF LAS VEGAS

