

Call before you Dig.  
1-800-227-2600

SAFETY ALERT  
Call before you Overhead.  
593-6111

BACK OF CURB CURVE DATA				
CURVE	DELTA	RADIUS	LENGTH	TANGENT
C1	21°33'15"	100.00	37.62	19.03
C2	16°16'24"	100.00	28.40	14.30
C18	127°02'58"	43.00	95.35	86.34
C19	83°56'27"	30.00	43.95	26.98
C20	96°03'34"	20.00	33.53	22.24
C21	83°56'27"	20.00	29.30	17.99
C22	96°03'34"	20.00	33.53	22.24
C23	83°56'27"	20.00	29.30	17.99

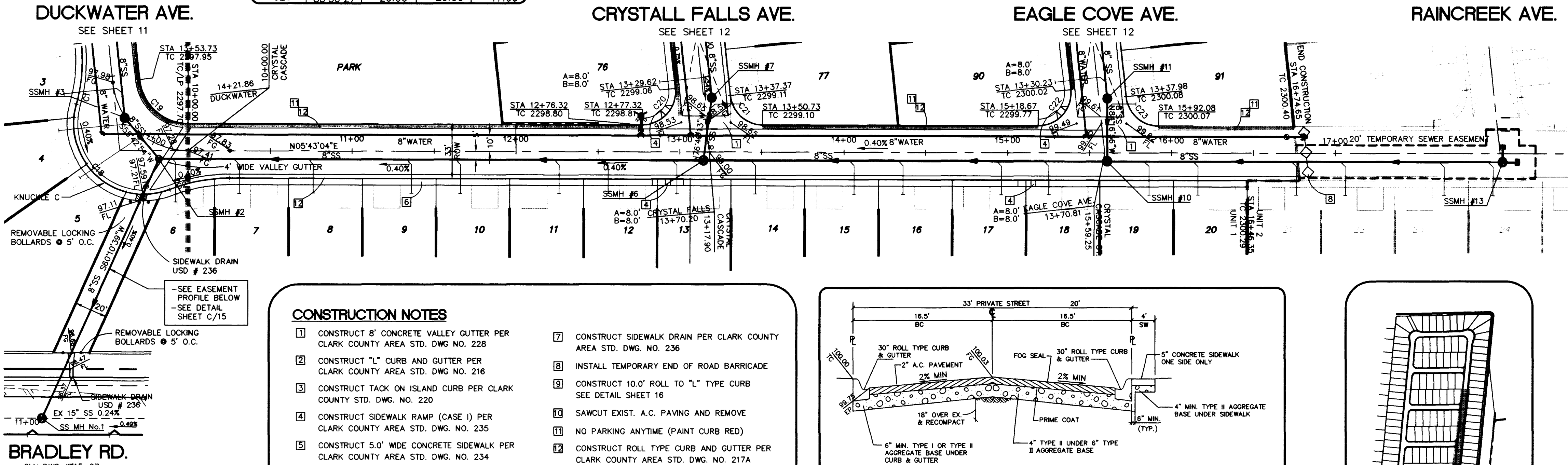
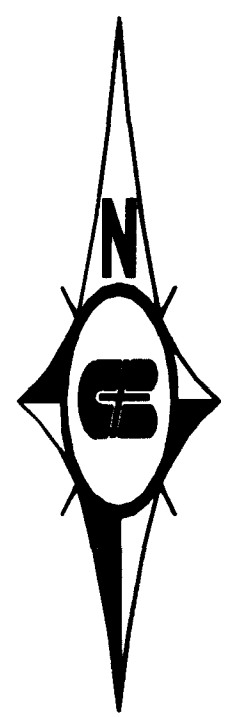
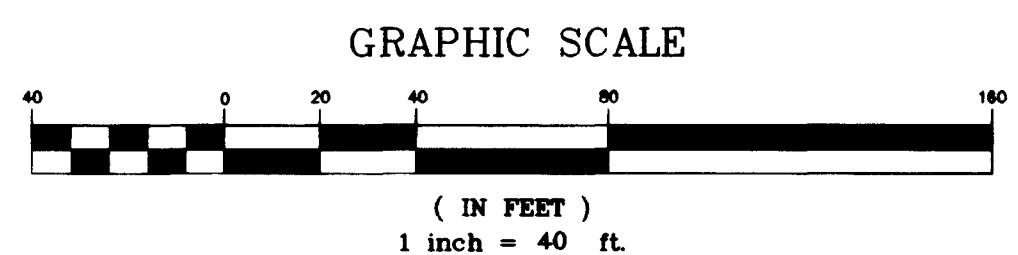

**BASIS OF BEARING**  
NORTH 88°46'05" EAST BEING THE CENTERLINE OF AZURE DRIVE AS SHOWN ON RECORDS OF SURVEY FILE 52 PAGE 70 AND FILE 90 PAGE 44 IN THE OFFICE OF THE COUNTY RECORDER, CLARK COUNTY, NEVADA.

**BENCHMARK**  
CITY OF LAS VEGAS BENCHMARK #23 1LV9025N4 BEING AN ALCAP ON REBAR AT THE CENTERLINE INTERSECTION OF CENTENNIAL PKWY. AND BRADLEY ROAD.  
NAVD88 ELEVATION: 2302.77' = 701.8865 METERS

- CONSTRUCTION NOTES**
- 1 CONSTRUCT 8" CONCRETE VALLEY GUTTER PER CLARK COUNTY AREA STD. DWG. NO. 228
  - 2 CONSTRUCT "L" CURB AND GUTTER PER CLARK COUNTY AREA STD. DWG. NO. 216
  - 3 CONSTRUCT TACK ON ISLAND CURB PER CLARK COUNTY STD. DWG. NO. 220
  - 4 CONSTRUCT SIDEWALK RAMP (CASE I) PER CLARK COUNTY AREA STD. DWG. NO. 235
  - 5 CONSTRUCT 5.0' WIDE CONCRETE SIDEWALK PER CLARK COUNTY AREA STD. DWG. NO. 234
  - 6 CONSTRUCT 4.0' WIDE CONCRETE SIDEWALK PER CLARK COUNTY AREA STD. DWG. NO. 234
  - 7 CONSTRUCT SIDEWALK DRAIN PER CLARK COUNTY AREA STD. DWG. NO. 236
  - 8 INSTALL TEMPORARY END OF ROAD BARRICADE
  - 9 CONSTRUCT 10.0' ROLL TO "L" TYPE CURB SEE DETAIL SHEET 16
  - 10 SAWCUT EXIST. A.C. PAVING AND REMOVE
  - 11 NO PARKING ANYTIME (PAINT CURB RED)
  - 12 CONSTRUCT ROLL TYPE CURB AND GUTTER PER CLARK COUNTY AREA STD. DWG. NO. 217A

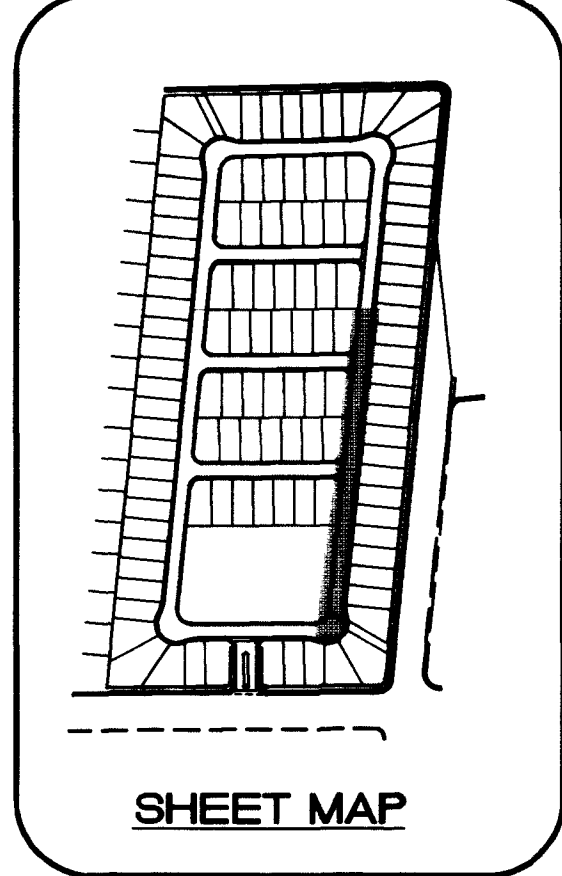
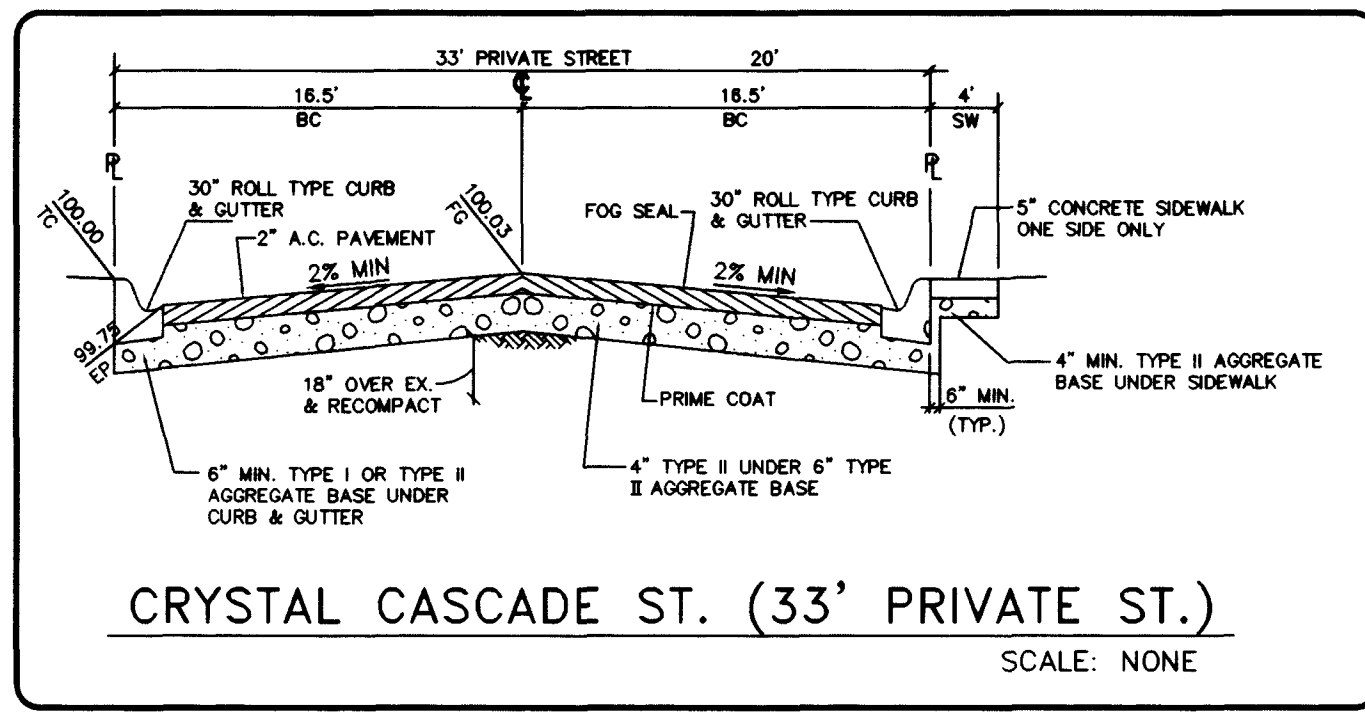

**CRYSTAL CASCADE ST.**  
(MAINTAINED BY H.O.A.)  
(PRIVATE STREET W/ PUE, PUBLIC SEWER EASEMENT, PUBLIC DRAINAGE EASEMENT TO BE PRIVATELY MAINTAINED)

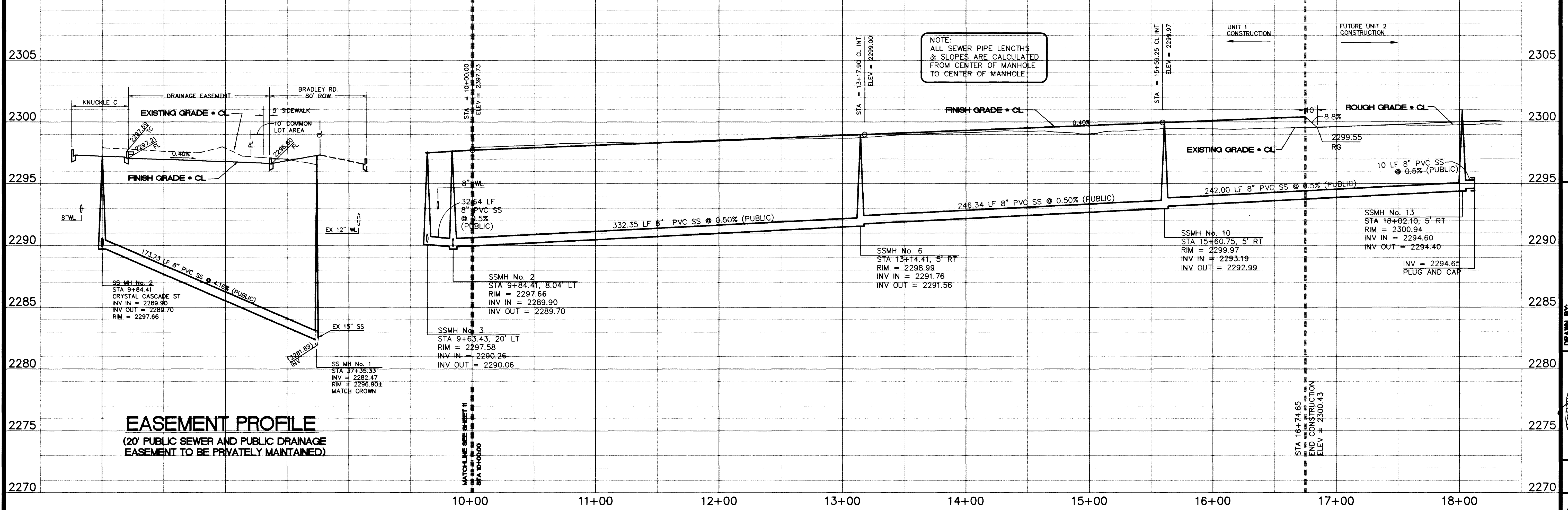

**PLAN AND PROFILE**  
PULTE HOMES  
EAGLE CREEK ESTATES NORTH  
UNIT 1

DRAWN BY: [ ]  
DESIGNED BY: [ ]  
CHECKED BY: [ ]  
PROJECT NO.: 88055810  
SCALE: 1" = 4' HORIZ. VERT.

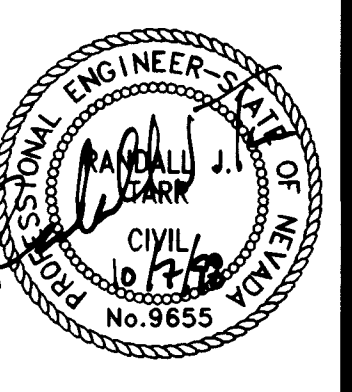

SHEET  
**C0**  
10 OF 17 SHEETS  
DRAWING NO.  
1074-4571-1



BACK OF CURB DRIVE DATA	
DRIVE NO.	DRIVE LENGTH (FEET)
1	100
2	100
3	100
4	100
5	100
6	100
7	100
8	100
9	100
10	100
11	100
12	100
13	100
14	100
15	100
16	100
17	100
18	100
19	100
20	100
21	100
22	100
23	100
24	100
25	100
26	100
27	100
28	100
29	100
30	100
31	100
32	100
33	100
34	100
35	100
36	100
37	100
38	100
39	100
40	100
41	100
42	100
43	100
44	100
45	100
46	100
47	100
48	100
49	100
50	100



**NAME OF OWNER**  
**STATE OF CALIFORNIA**  
 1000 11th ST. SACRAMENTO, CALIF. 95833

**REFERENCE**  
 SET OF AS-BUILT DRAWINGS FOR PROJECT NO. 1000 11th ST. SACRAMENTO, CALIF. 95833

- CONSTRUCTION NOTES**
- 1. EXISTING DRIVEWAY TO BE REMOVED AND RECONSTRUCTED TO MATCH ADJACENT DRIVEWAYS.
  - 2. EXISTING DRIVEWAY TO BE RECONSTRUCTED TO MATCH ADJACENT DRIVEWAYS.
  - 3. EXISTING DRIVEWAY TO BE RECONSTRUCTED TO MATCH ADJACENT DRIVEWAYS.
  - 4. EXISTING DRIVEWAY TO BE RECONSTRUCTED TO MATCH ADJACENT DRIVEWAYS.
  - 5. EXISTING DRIVEWAY TO BE RECONSTRUCTED TO MATCH ADJACENT DRIVEWAYS.
  - 6. EXISTING DRIVEWAY TO BE RECONSTRUCTED TO MATCH ADJACENT DRIVEWAYS.
  - 7. EXISTING DRIVEWAY TO BE RECONSTRUCTED TO MATCH ADJACENT DRIVEWAYS.
  - 8. EXISTING DRIVEWAY TO BE RECONSTRUCTED TO MATCH ADJACENT DRIVEWAYS.
  - 9. EXISTING DRIVEWAY TO BE RECONSTRUCTED TO MATCH ADJACENT DRIVEWAYS.
  - 10. EXISTING DRIVEWAY TO BE RECONSTRUCTED TO MATCH ADJACENT DRIVEWAYS.



**CRYSTAL CASCADE ST.**  
 (SECTION OF 1000)

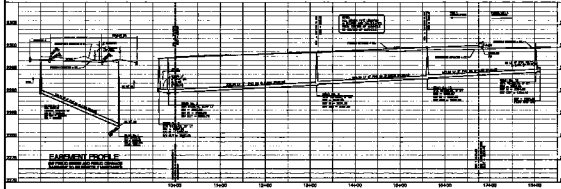

**Public Hearing**  
 An Ordinance of the City of Sacramento, California, to Amend Chapter 10.00 of the City Code, Relating to the City Code, and to Amend Chapter 10.00 of the City Code, Relating to the City Code, and to Amend Chapter 10.00 of the City Code, Relating to the City Code.

**PLANS AND PROFILES**  
 1000 11th ST. SACRAMENTO, CALIF. 95833

**DATE**  
 1983-84

**SCALE**  
 1" = 40'

**PROJECT NO.**  
 1000 11th ST. SACRAMENTO, CALIF. 95833

**DATE**  
 1983-84

**SCALE**  
 1" = 40'

**PROJECT NO.**  
 1000 11th ST. SACRAMENTO, CALIF. 95833

