

DATUM ELEV  
2285.00

PROFILE  
SCALE: HORIZ. 1" = 40'  
VERT. 1" = 4'

NOTE:  
ALL STATIONS ARE REFERENCED TO CENTERLINE OF PRIVATE STREET. NOT CENTERLINE OF AC. ALL GRADES SHOWN IN PROFILE ARE REFERENCED TO CENTERLINE OF AC (CROWN LINE) AT THAT STATION. SEE TYPICAL SECTION

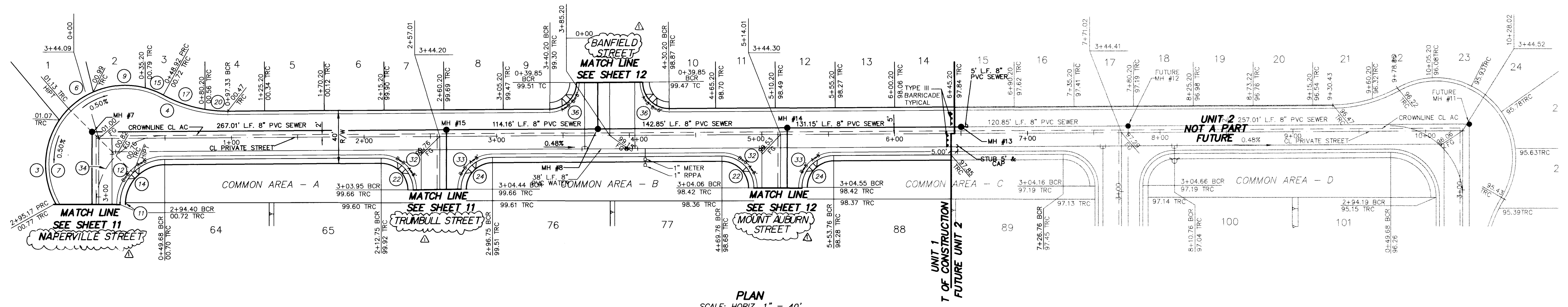

PLAN  
SCALE: HORIZ. 1" = 40'

PEPPERPIKE AVENUE  
(PRIVATE STREET)

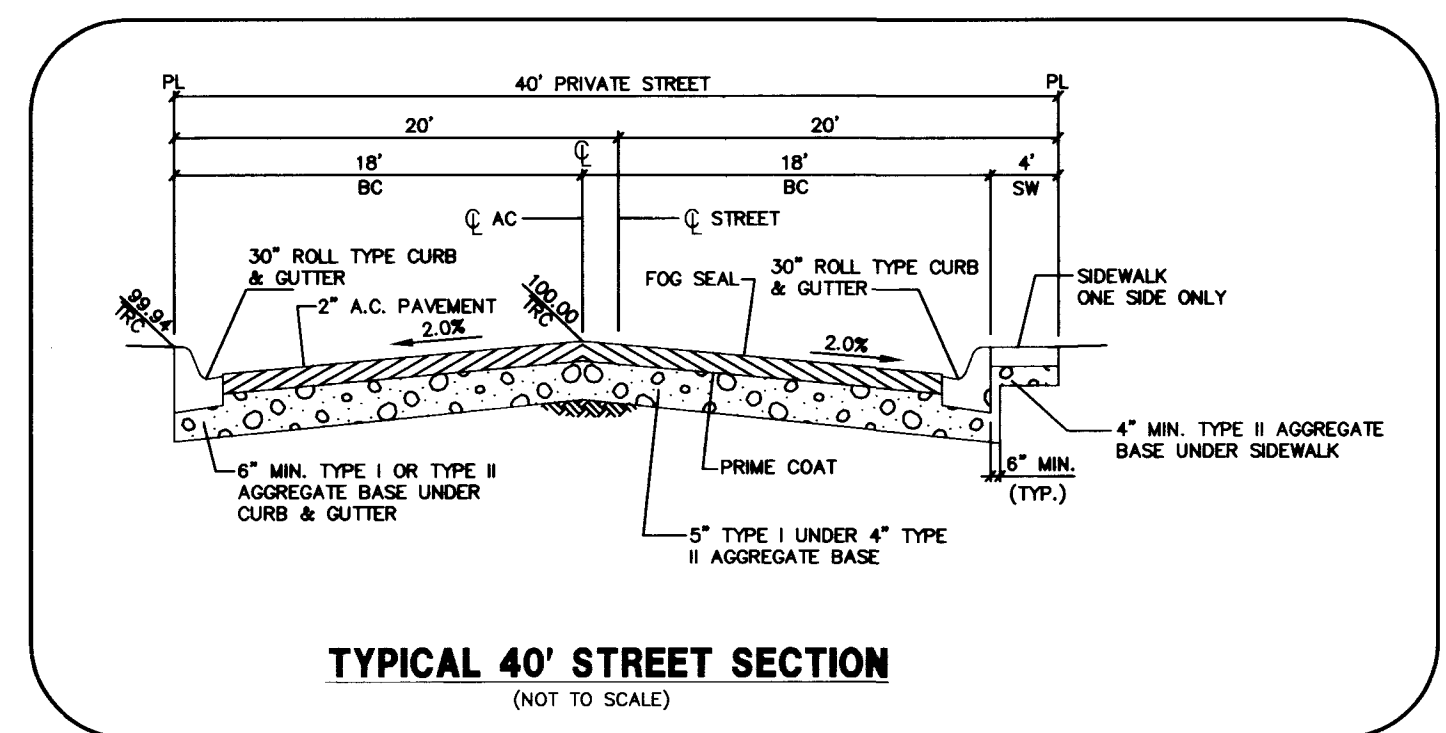

TYPICAL 40' STREET SECTION  
(NOT TO SCALE)

CURVE	DELTA	RADIUS	LENGTH	TANGENT
BC 3	63°3'38"	60.00'	66.21'	36.93'
BC 4	28°57'18"	100.00'	50.54'	25.82'
BC 6	31°35'48"	60.00'	33.44'	17.17'
BC 7	147°32'47"	60.00'	154.51'	206.16'
BC 9	38°3'45"	60.00'	40.03'	20.79'
BC 11	02°35'42"	30.00'	1.36'	0.68'
BC 12	89°38'11"	34.00'	33.19'	33.78'
BC 14	87°02'29"	30.00'	45.57'	28.49'
BC 15	14°09'36"	60.00'	14.83'	7.45'
BC 17	19°05'13"	100.00'	33.51'	16.81'
BC 20	08°52'05"	100.00'	17.22'	8.63'
BC 22	90°21'49"	20.00'	31.54'	20.13'
BC 24	89°38'11"	20.00'	31.29'	19.87'
BC 27	90°00'00"	25.00'	39.27'	25.00'
BC 32	90°21'49"	24.00'	37.85'	24.15'
BC 33	89°38'11"	24.00'	37.55'	23.85'
BC 34	89°38'11"	52.00'	81.35'	51.67'
BC 36	90°00'00"	20.00'	31.42'	20.00'

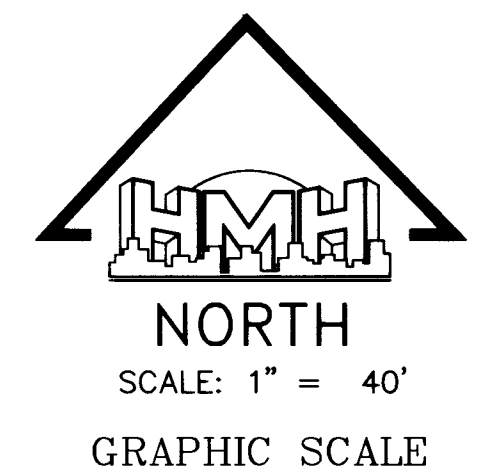

( IN FEET )  
1 inch = 40 ft.

BENCHMARK  
CITY OF LAS VEGAS VERTICAL CONTROL #38-1LV90-36N4  
RIVET AND PLATE IN SOUTH TOP OF CURB, ANN ROAD AT  
CURB ANGLE POINT, 1530' EAST OF CALVERTS STREET.  
NAVD88 DATUM ELEVATION: 696.2262 METERS (2284.20 FEET)

