

FALCONWING AVENUE

(PRIVATE STREET W/ PUBLIC SEWER EASEMENT)

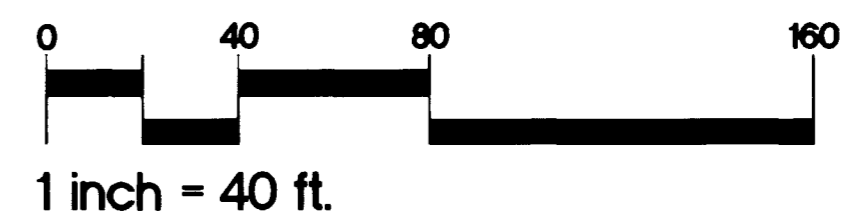

CONSTRUCTION NOTES

- 1 CONST. 2" MIN. AC OVER 4" TYPE II AB OVER 6" TYPE I AB
- 2 CONST. 30" ROLL TYPE CURB AND GUTTER PER STD. DWG. NO. 217A
- 3 CONST. 24" "L" TYPE CURB AND GUTTER PER STD. DWG. NO. 216
- 4 CONST. 5" CONC SIDEWALK PER STD. DWG. NO. 234
- 5 CONST. SIDE RAMP PER STD. DWG. NO. 235, CASE III
- 7 INSTALL 100W H.P.S. STREET LIGHT PER STD. DWG. NO. 309 & 319
- 10 INSTALL 1 1/4" PVC STREET LIGHT CONDUIT
- 12 TRANSITION FROM 24" "L" TYPE CURB TO 30" ROLL TYPE CURB (DIST. 10')
- 13 CONST. CMU WALL (PER CLV STANDARDS)
- 14 CONST. CMU RETAINING WALL (PER CLV STANDARDS)
- 20 INSTALL 48" DIA. TYPE I MANHOLE PER STD. DWG. NO. 403
- 21 INSTALL 8" DIA. PVC SDR-35 SEWER MAIN
- 24 REMOVE EXISTING CAP AND CONNECT TO EX.
- 25 INSTALL SEWER BACK WATER VALVE PER UPC SD-29
- 31 INSTALL FIRE HYDRANT ASSY PER USD PLATE NO. 7

AN EASEMENT IN FAVOR OF LAS VEGAS VALLEY WATER DISTRICT A QUASI-MUNICIPAL CORPORATION FOR PIPELINES.
 RECORDED : _____ OFFICIAL RECORDS.
 DOCUMENT No : _____

BC CURVE DATA TABLE

CURVE	DELTA	RADIUS	LENGTH	TANGENT
C1	90°00'00"	20.00'	31.42'	20.00'
C2	09°59'12"	280.50'	48.89'	24.51'
C3	09°59'12"	300.00'	52.29'	26.21'
C4	07°25'51"	319.50'	41.44'	20.75'
C5	09°59'12"	313.50'	54.64'	27.39'
C6	09°59'12"	294.00'	51.24'	25.69'
C7	09°59'12"	274.50'	47.84'	23.98'
C8	09°16'11"	100.00'	16.18'	8.11'
C9	108°32'23"	49.00'	92.82'	68.11'
C10	90°00'00"	39.50'	62.05'	39.50'
C11	92°05'28"	20.00'	32.15'	20.74'

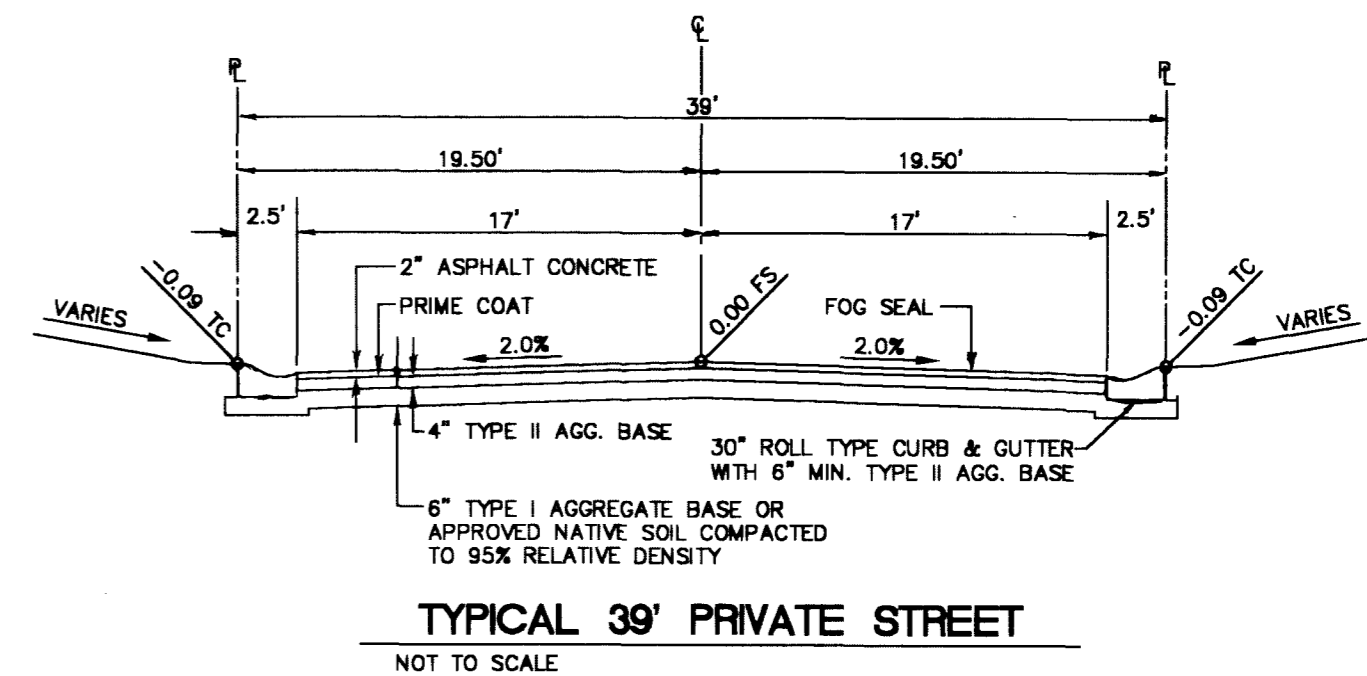

BASIS OF BEARINGS

BEING THE SOUTH LINE OF THE SOUTHEAST QUARTER (SE 1/4) OF SECTION 16, TOWNSHIP 19 SOUTH, RANGE 60 EAST, M.D.M., CITY OF LAS VEGAS, CLARK COUNTY, NEVADA AS SHOWN BY MAP THEREOF ON FILE, IN BOOK 74 PAGE 01 OF PLATS, IN THE OFFICE OF THE CLARK COUNTY, NEVADA RECORDER. THE BEARING BEING SOUTH 85°49'40" EAST

PROJECT BENCHMARK NAVD88

LOCATION AND DESCRIPTION	NAVD88 DATUM=
NAV88 NO. 6 STATION 1LV9016N4 1-1/2" BRASS TAG ON IRON PIPE, RLS 1552 AT GRAND TETON DRIVE AND CIMARRON ROAD	2477.43 FT 755.1215m

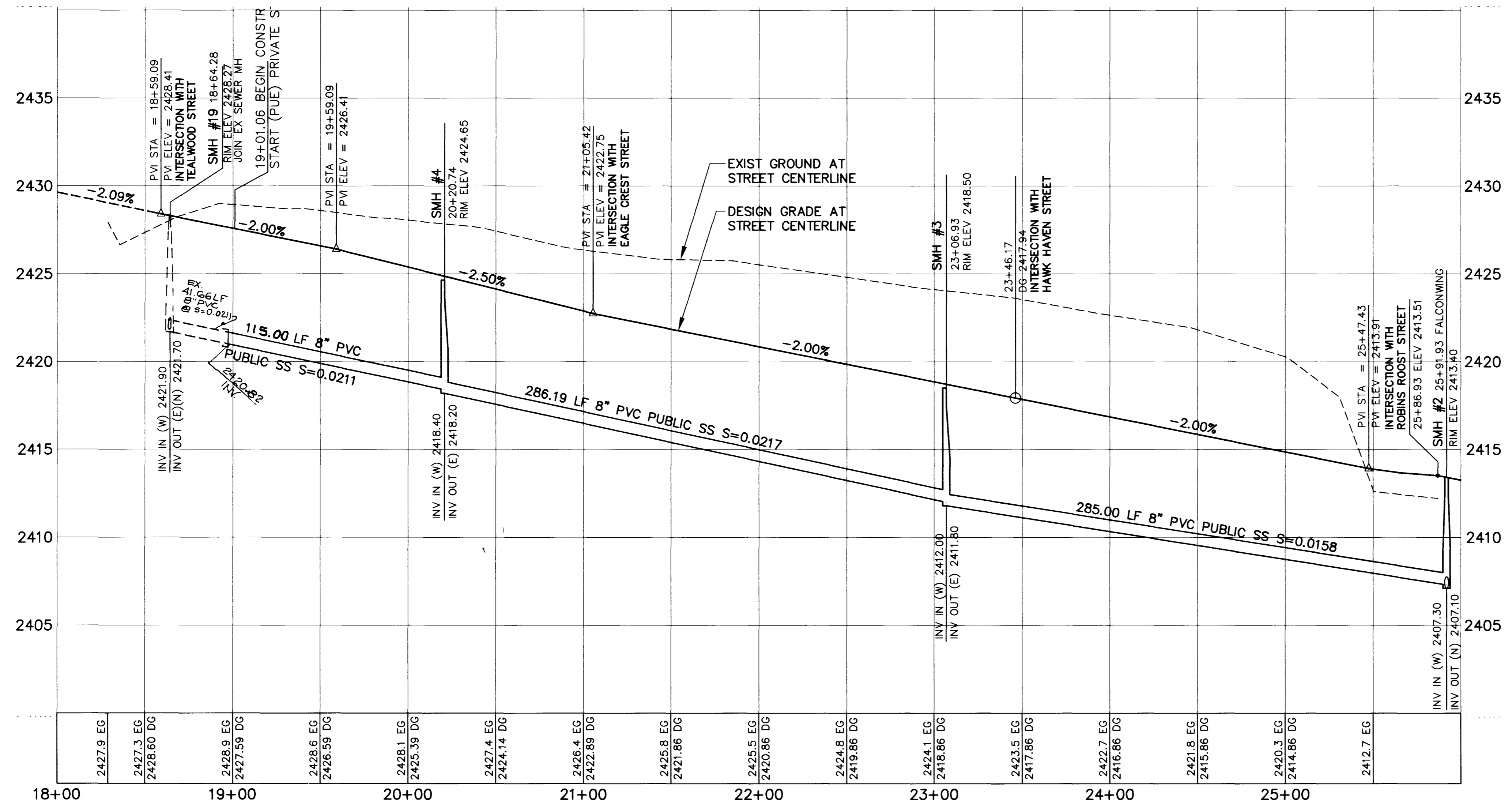

NO.	DATE	BY	REVISION DESCRIPTION

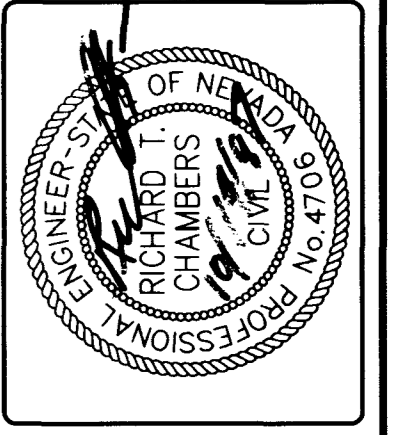

RHODES ENGINEERING SERVICES
 ENGINEERING • SURVEYING
 4690 SOUTH ARVILLE, SUITE A
 LAS VEGAS, NEVADA 89103
 (702) 873-5338

TITLE: **EAGLE HEIGHTS AT ELKHORN SPRINGS**
 PROJECT: **FALCONWING AVENUE - PLAN AND PROFILE**

JOB NO:	
DWG NO:	
SCALE: 1"=40'	
DATE: 7/29/97	
DESIGN BY: DIV	
SHT NO:	
	S2
	10 OF 15 SHEETS

Call before you Dig
 1-800-227-2600

