

DEER SPRINGS WAY (PUBLIC)

PROFILE
SCALE: HORIZ. 1" = 40'
VERT. 1" = 4'



BACK OF CURB DATA

CURVE	RADIUS	DELTA	LENGTH	TANGENT
1	30.00'	89°30'16"	46.86'	29.74'

HC RAMP DATA

HC RAMP #	GRADE (%)	"A" (FT)	"B" (FT)
1	-2 TO 2	8.0'	8.0'

(STD. DWG. NO. 235, CASE 1)

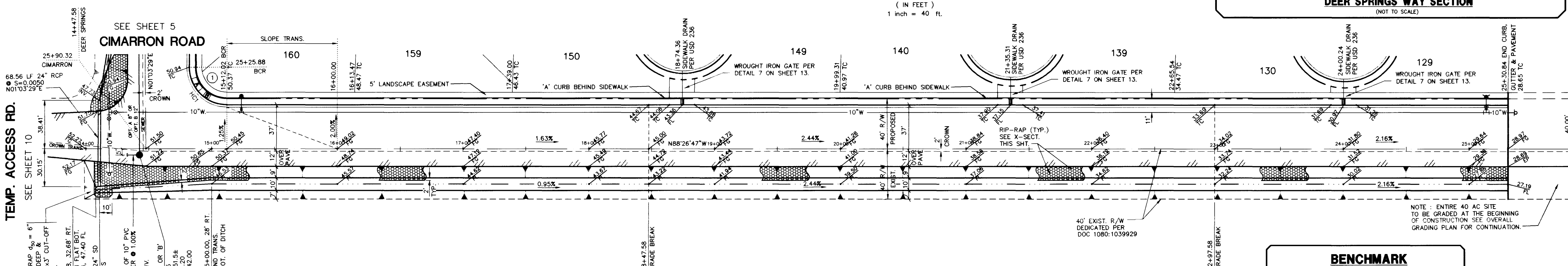
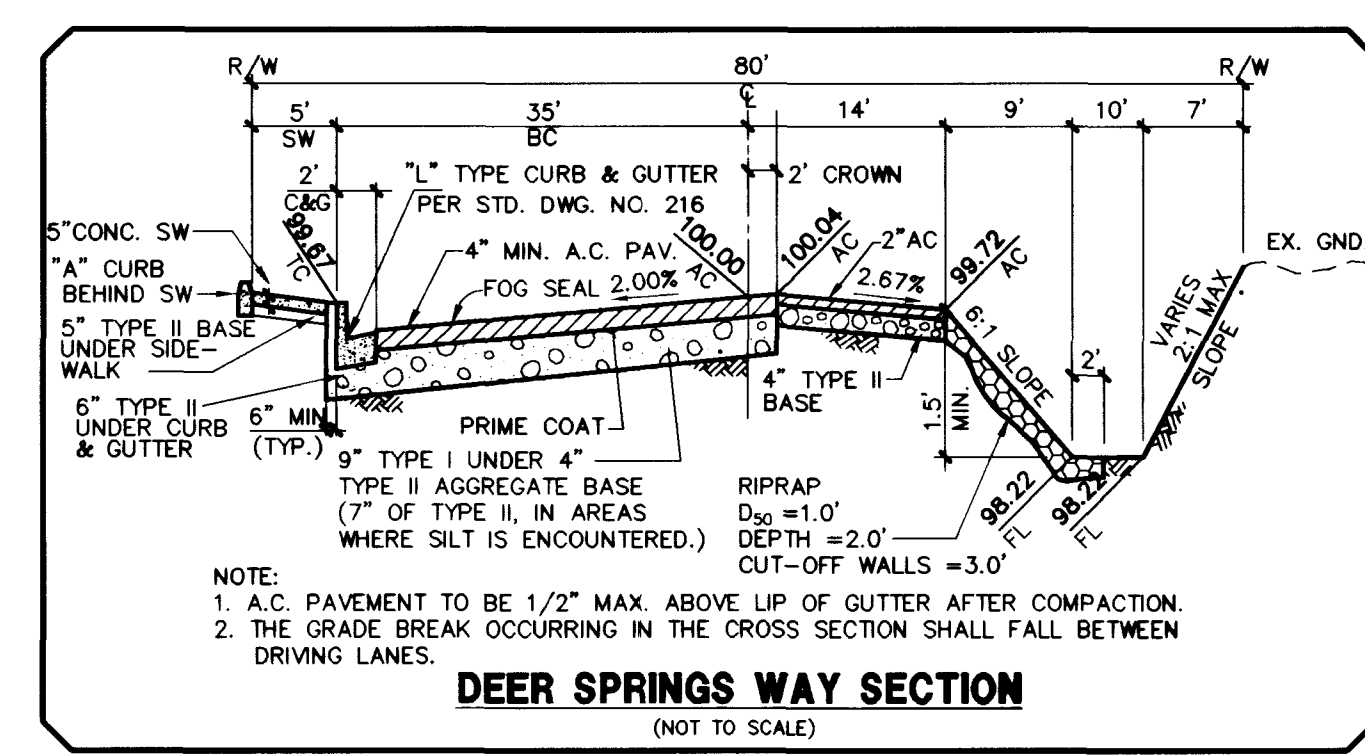

DEER SPRINGS WAY (PUBLIC)

BENCHMARK
CLV BM # 1 LV90 21 N6
3\"/>

NO.	DESCRIPTION	DATE	APP'D.

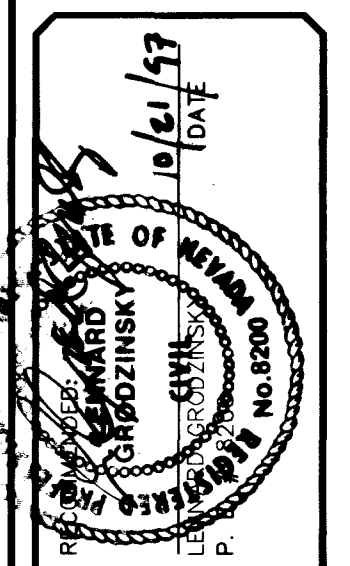

DATE: 9/4/97
DRAWN BY: [Signature]
DESIGNED BY: [Signature]
CHECKED BY: [Signature]
JOB NO.: 0141.0006
SCALE: 1" = 40'

PENTACORE
CIVIL ENGINEERING • LAND SURVEYING • PLANNING • CONSTRUCTION MANAGEMENT • ADA CONSULTING
6763 WEST CHARLESTON BOULEVARD
LAS VEGAS, NEVADA 89102 (702)258-0115

EXECUTIVE DEVELOPMENT CORPORATION
ELKHORN - CIMARRON ESTATES UNIT 4A
STREET PLAN - PROFILE
DEER SPRINGS WAY

Q:\041\0006\UNIT4A\PP\DEER Thu Sep 4 13:18:27 1997 J. HERSHOUER

DEER.DWG DISK # 0141\COORD\UNIT4A\PP\

6027

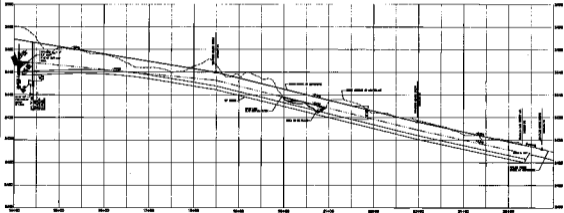

DEER SPRINGS WAY (PUBLIC)

SCALE
 1" = 40' HORIZ.
 1" = 10' VERT.



NO.	DESCRIPTION	DATE
1	PREPARED BY	11/15/78
2	REVISION	11/15/78
3	REVISION	11/15/78
4	REVISION	11/15/78
5	REVISION	11/15/78



DEER SPRINGS WAY (PUBLIC)

REVISION
 11/15/78

DATE	11/15/78
BY	W. J. ...
CHECKED BY	...
APPROVED BY	...



PROJECT NO.	...
DATE	11/15/78
BY	W. J. ...
CHECKED BY	...
APPROVED BY	...

PENTACORE
 ENGINEERING & ARCHITECTURE
 1000 ...

ENGINEER	W. J. ...
DATE	11/15/78
PROJECT NO.	...
DATE	11/15/78
BY	W. J. ...
CHECKED BY	...
APPROVED BY	...