

12-11-98 LWE ADD SCREEN WALL AT DURANGO & FAWN MEADOW
 11-20-98 IKJ REV. WALL TO SOLID GROUT
 10-19-96 DLF FILL DURANGO DR PER CH
 8-9-96 DLF ADD V.C. IN ANTLER RIDGE DR PER CH
 8/28/96 CRH ADD CUL-DE-SAC TO ANTLER RIDGE, "PUNCH THROUGH"
 FAWN MEADOW & ADD GATE TO FAWN MEADOW
 6/9/96 ROM REV. PER CLV COMMENTS
 5-15-96 ROM REV. PER HYDRO. COMMENTS
 REV. DATE BY REVISION

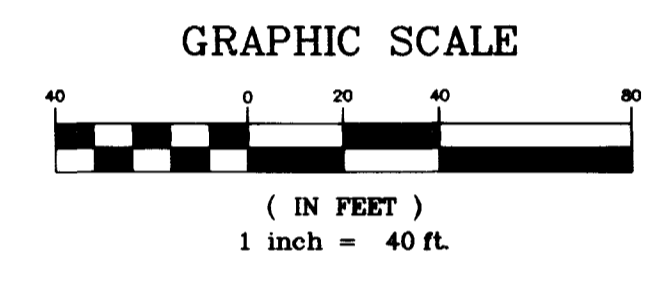
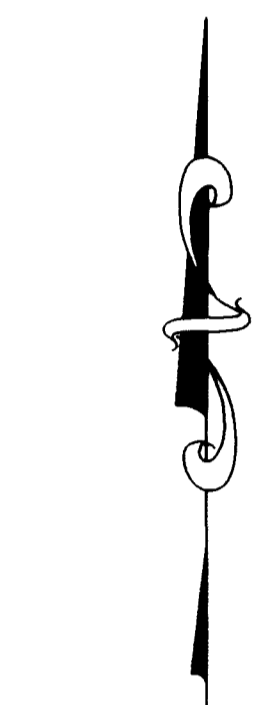

BASIS OF BEARINGS

SOUTH 88°55'31" WEST, BEING THE SOUTH LINE OF THE SOUTHWEST QUARTER (SW 1/4) OF SECTION 21, T. 19 S., R. 60 E., M.D.M., CLARK COUNTY, NEVADA, COINCIDENT WITH THE CENTERLINE OF CENTENNIAL PARKWAY, AS SHOWN ON THAT CERTAIN MAP ON FILE IN THE OFFICE OF THE COUNTY RECORDER IN FILE 81 OF PARCEL MAPS AT PAGE 28.

BENCHMARK

CLARK COUNTY BM # 0C90 - 21NW6
 RIVET AND SQUARE ALUMINUM PLATE IN TOP OF CENTER OF HEAD WALL ON THE WEST SIDE OF HIGHWAY - 95, NEAR MILE MARKER 88.95
 ELEVATION = 764.787 METERS (NAVD/88)
 ELEVATION = 2509.14 U.S. SURVEY FEET (NAVD/88)

Call before you Dig
 1-800-227-2600

Avoid cutting underground utility lines. It's costly.

"I CERTIFY THAT THIS GRADING PLAN IS IN CONFORMANCE WITH THE APPROVED DRAINAGE STUDY ON FILE AT THE CITY OF LAS VEGAS FOR THIS PROJECT"

ENGINEER: [Signature]
 DATE: 30 JUNE 96

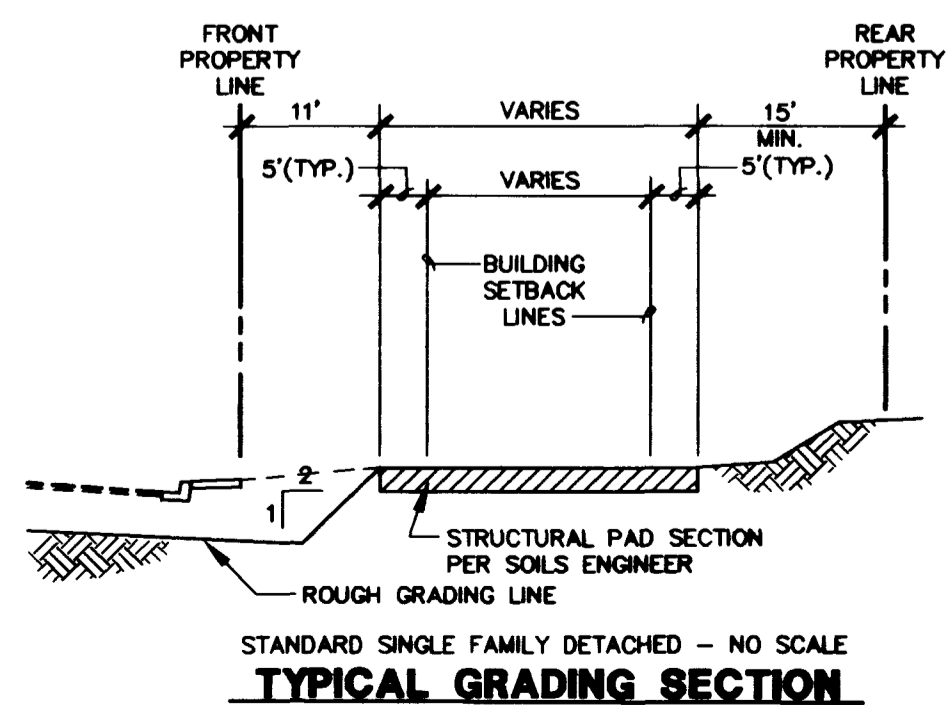

FINAL ROUGH GRADING PLAN

DEER SPRINGS RANCH UNIT 2

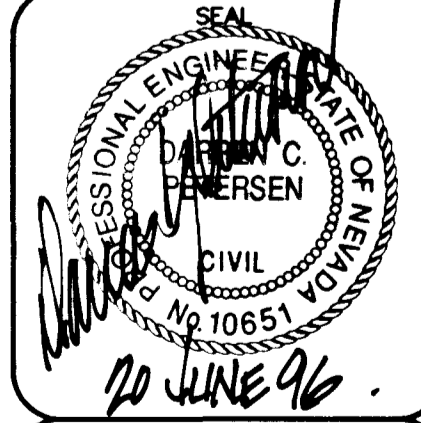

NO. 4884-2
 BY: CKH/RDM
 DATE: FEB 96
 SCALE: HORIZ. 1"=40'
 VERT. NONE
 SHEET 6 OF 28 SHEETS

AMERICAN WEST HOMES, INC.
 CITY OF LAS VEGAS, NEVADA

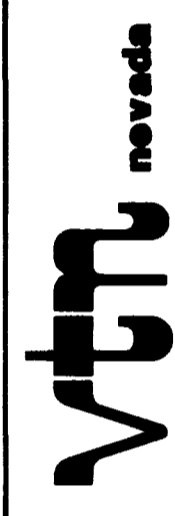

CONSULTING ENGINEERS • PLANNERS • LAND SURVEYORS
 2727 SOUTH RAINBOW BOULEVARD
 LAS VEGAS, NEVADA 89102-5148 PHONE (702) 873-7550 FAX (702) 362-2597

H:\CAD\LAND\VEV\BB4\BB4L.AND Wed Jun 26 14:09:15 1996 Plotted by: MGB

11530 12360

3011

107V-4478-2

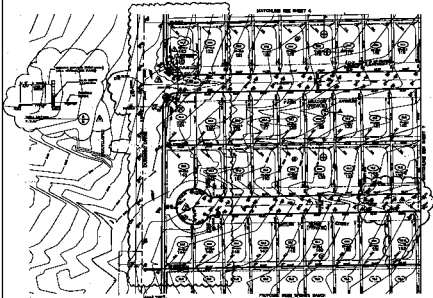

NAME OF PLANNING
PLANNING AND ENGINEERING
PROPERTY DEVELOPMENT

ADDRESS
 1000 10th Street
 1000 10th Street
 1000 10th Street

Lot Cell
1000 10th



I CERTIFY THAT THE ABOVE PLAN IS A
 TRUE AND CORRECT COPY OF THE
 ORIGINAL AS SUBMITTED TO THE
 CITY OF LOS ANGELES.



PROJECT NO.	1000 10th Street
DATE	10/10/10
SCALE	1" = 100'
DESIGNED BY	J. J. J.
CHECKED BY	J. J. J.
APPROVED BY	J. J. J.
DATE	10/10/10

FINAL ROUGH GRADING PLAN
DEER SPRINGS PARCEL
SHEET 2



VTM

CONSULTING ENGINEERS & PLANNERS & LAND SURVEYORS
 1000 10th Street
 Los Angeles, California 90015
 Tel: (213) 475-1000 Fax: (213) 475-1001