

2404
2400
2396
2392
2388
2384
2380
2376
2372
2368
2364

2404
2400
2396
2392
2388
2384
2380
2376
2372
2368
2364

MATCHLINE STATION 18+50.00
SEE SHEET 19 OF 21

18+00 19+00 20+00 21+00 22+00 23+00 24+00

MATCHLINE STATION 18+50.00
SEE SHEET 19 OF 21

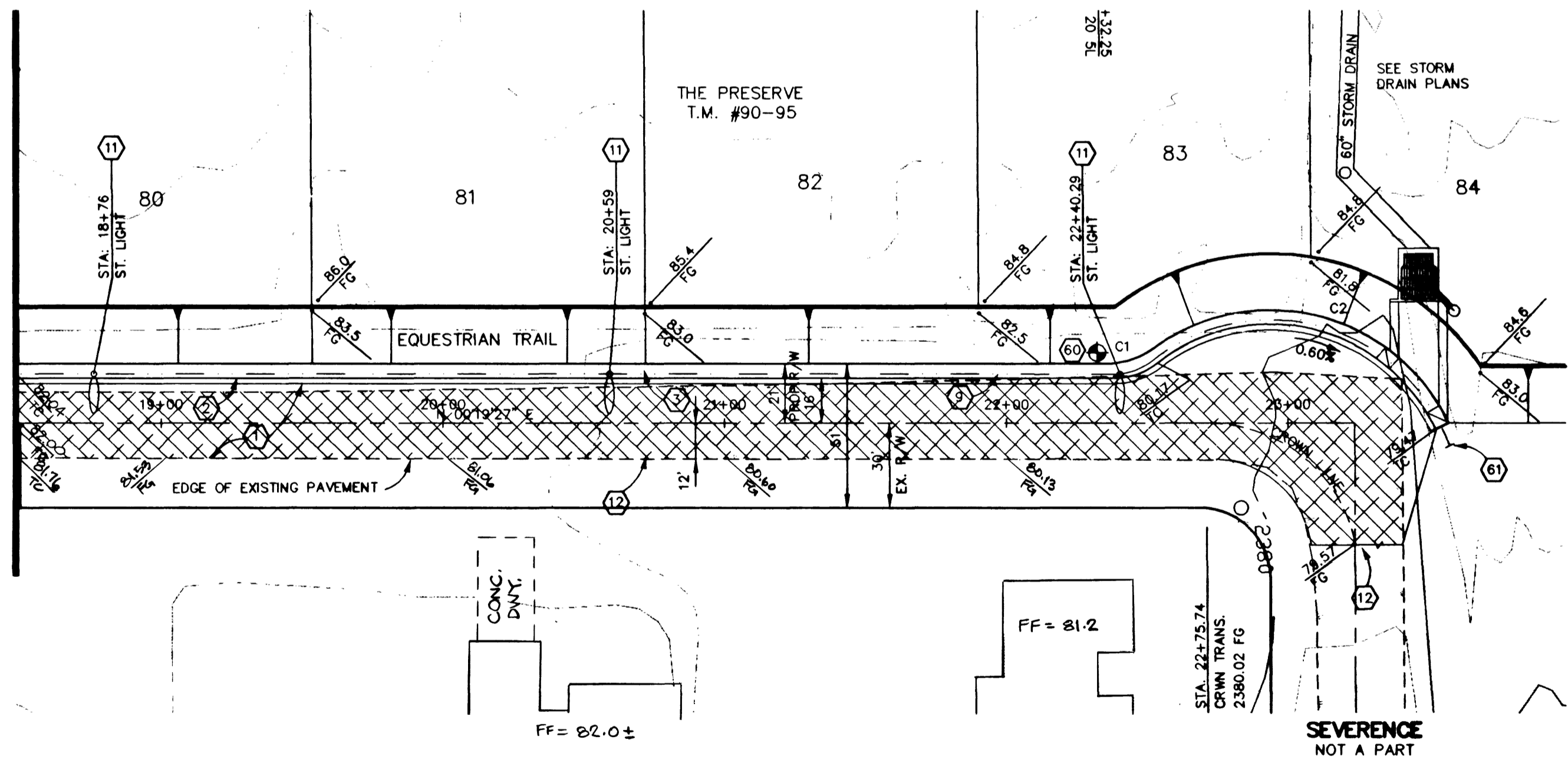

- CONSTRUCTION NOTES :
- 1 2" A.C. OVER 6" TYPE II A.B. OVER 6" TYPE I A.B.
 - 2 6" "L" TYPE CURB AND GUTTER
 - 3 5' SIDEWALK
 - 4 2" STREET LIGHT CONDUIT
 - 5 100W HPS STREET LIGHT
 - 6 SAWCUT, REMOVE EXISTING A/C AND MATCH (OR EXTEND TO 12" PLANT E.) SP & R/OOC
 - 7 CAP 2" STREET LIGHT CONDUIT

NO.	DATE	BY	APP'D	REVISION DESCRIPTION

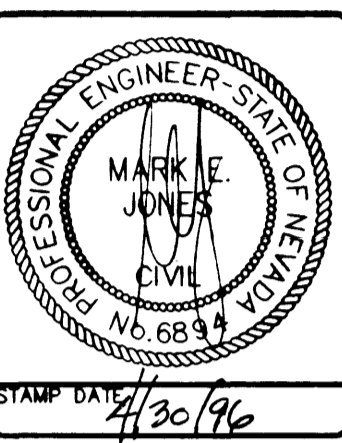

SOUTHWEST ENGINEERING
LAND PLANNING • MAPPING • DEVELOPMENT
5426 W. VEGAS DRIVE
LAS VEGAS, NEVADA 89108
(702) 646-9700

STREET/SEWER PLAN & PROFILE
PIONEER WAY
ELKHORN SPRINGS
PHASE II

WORK ORDER NO: 950925
DESIGN BY: M. JONES
DATE: 04/16/96
SCALE: 1" = 40'
CADFILE: PIONEER.DWG
SHEET 20 OF 21 SHEETS

APPROVED FOR CONSTRUCTION
107 Y-4299-2
DATE 5-02-96
L.V.V.W.D.

BENCHMARK
PROJECT DATUM=NGVD29 NO.14, STATION 1LV9021N6 3" BRASS CAP USC & GS BM #113 3/4 MILE NORTH OF 1LV9028NNE6, 50' (FT.) EAST OF OLD RAILROAD BED ELEVATION = 2452.515 EQUATION ELEVATION = 2452.515 + 2.401' = 2454.916 (TO NAVD88) (747.5266m + 0.7318m = 748.2584m)

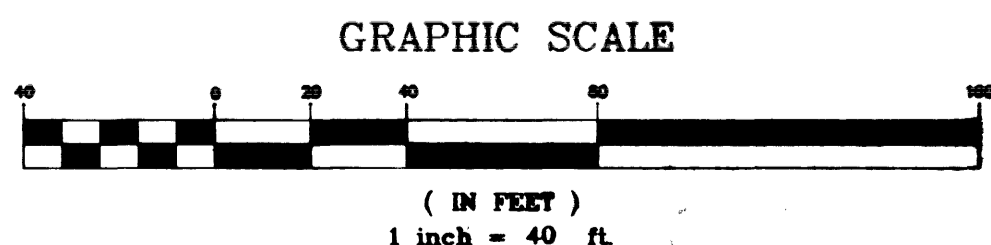

PIONEER WAY
SEE THE PRESERVE UNIT I
GRADING PLAN FOR RETAINING WALLS

BACK OF CURB CURVE TABLE

CURVE	RADIUS	DELTA	TANGENT	LENGTH
C1	25.00'	37°55'06"	8.59'	16.54'
C2	65.00'	102°32'11"	81.04'	116.32'

NOTICE TO CONTRACTOR !
EXISTING UTILITY LOCATIONS SHOWN HEREON ARE APPROXIMATE ONLY. IT SHALL BE THE CONTRACTOR'S RESPONSIBILITY TO DETERMINE THE EXACT VERTICAL AND HORIZONTAL LOCATION OF ALL EXISTING UNDERGROUND UTILITIES PRIOR TO COMMENCING CONSTRUCTION. NO REPRESENTATION IS MADE THAT ALL EXISTING UTILITIES ARE SHOWN HEREON. THE ENGINEER ASSUMES NO RESPONSIBILITY FOR UTILITIES NOT SHOWN OR UTILITIES NOT SHOWN IN THEIR PROPER LOCATION.

AVOID CUTTING UNDERGROUND UTILITIES. IT'S COSTLY.
CALL before you Dig
1-800-227-2600
UNDERGROUND SERVICE (USA)