

SEE STORM DRAIN PLANS FOR LOCATION AND CONSTRUCTION OF STORM DRAIN FACILITIES.

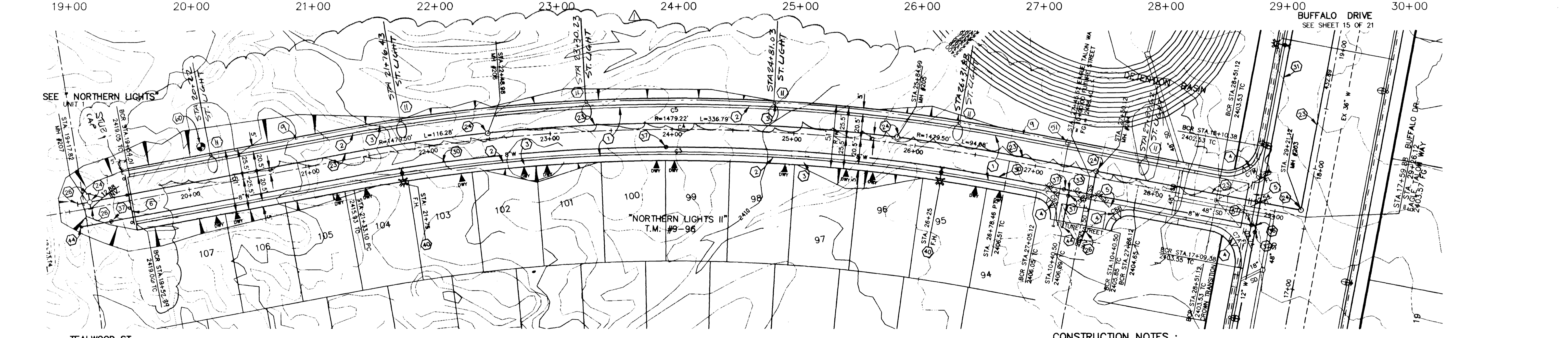

EAGLE TALON WAY

BENCHMARK
 PROJECT DATUM=NGVD29 NO.14, STATION 1LV9021N6 3" BRASS CAP USC & GS BM #113 3/4 MILE NORTH OF 1LV9028NNE6, 50' (FT.) EAST OF OLD RAILROAD BED ELEVATION = 2452.515 EQUATION ELEVATION = 2452.515 + 2.401' = 2454.916 (TO NAVD88) (747.5266m + 0.7318m = 748.2584m)

NOTICE TO CONTRACTOR!
 EXISTING UTILITY LOCATIONS SHOWN HEREON ARE APPROXIMATE ONLY. IT SHALL BE THE CONTRACTOR'S RESPONSIBILITY TO DETERMINE THE EXACT VERTICAL AND HORIZONTAL LOCATION OF ALL EXISTING UNDERGROUND UTILITIES PRIOR TO COMMENCING CONSTRUCTION. NO REPRESENTATION IS MADE THAT ALL EXISTING UTILITIES ARE SHOWN HEREON. THE ENGINEER ASSUMES NO RESPONSIBILITY FOR UTILITIES NOT SHOWN OR UTILITIES NOT SHOWN IN THEIR PROPER LOCATION.

AVOID CUTTING UNDERGROUND UTILITIES. IT'S COSTLY.
CALL before you Dig
 1-800-227-2600
 UNDERGROUND SERVICE (USA)

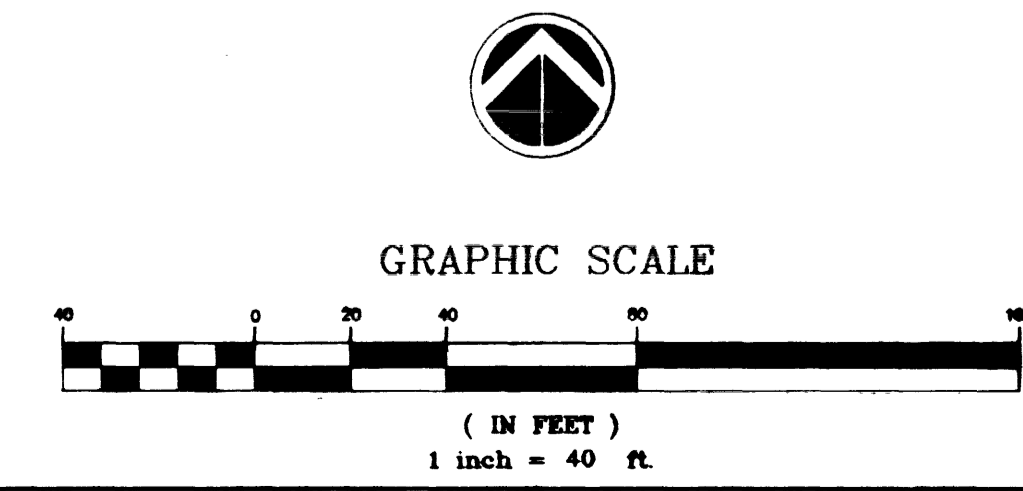

CENTERLINE & BACK OF CURB TABLE

CURVE	RADIUS	DELTA	TANGENT	LENGTH
C3	1454.00'	21°11'29"	272.00'	537.78'
C4	1474.50'	21°11'29"	275.83'	545.36'
C5	1495.00'	21°11'29"	279.67'	552.94'
C6	20.00'	90°00'00"	20.00'	31.42'
C7	30.00'	90°00'00"	30.00'	47.12'

S/W RAMP DATA

S/W RAMP DATA	S/W RAMP DATA
C1	C2
A = 8.0'	A = 8.0'
B = 8.0'	B = 8.0'
Z = 2.75'	Z = 2.75'

S/W RAMP DATA	S/W RAMP DATA
C6A	C6B
A = 8.0'	A = 4.5'
B = 8.0'	B = 21.5'
Z = 2.75'	Z = 2.75'

S/W RAMP DATA	S/W RAMP DATA
C7A	C7B
A = 8.0'	A = 9.5'
B = 8.0'	B = 4.5'
Z = 2.75'	Z = 2.75'

- CONSTRUCTION NOTES:**
- ① 2" A.C. OVER 4" TYPE II A.B. OVER 6" TYPE I A.B.
 - ② 24" "L" TYPE CURB AND GUTTER
 - ③ 5' SIDEWALK
 - ④ WHEELCHAIR RAMP
 - ⑤ 8" WIDE CROSS GUTTER
 - ⑥ INSTALL STD. BARRICADE
 - ⑨ 1-1/4" STREET LIGHT CONDUIT
 - ⑪ 100W HPS STREET LIGHT
 - ⑬ 8" SEWER MAIN (PUBLIC SEWER)
 - ⑭ 4' DIA. SEWER MANHOLE
 - ⑮ STUB 8" SEWER 5' BEYOND MANHOLE (OR 10' BEYOND CURB)
 - ⑯ 8" PVC WATER MAIN
 - ⑰ 12" PVC WATER MAIN
 - ⑱ 12" GATE VALVE
 - ⑳ 8" TEE
 - ㉑ 12"x 8" TEE w/ THRUST BLOCK
 - ㉒ 8" GATE VALVE
 - ㉓ FIRE HYDRANT ASSEMBLY
 - ㉔ CAP 8" WATER & 2" B.O. 5 FT. BEYOND CENTERLINE (OR CURB)
 - ㉕ NO. 3 1/2 PULLBOX
 - ㉖ SP & ROOC

APPROVED FOR CONSTRUCTION
 DATE: 04/16/96
 DATE: 5/12/96

REGIONAL DESCRIPTION: EAGLE TALON WAY, STATION 19+00 TO 30+00, 1" = 40'

DATE: 04/16/96

DESIGNER: M. JONES

DATE: 04/16/96

SCALE: 1" = 40'

CADFILE: EAGLE-T-B.DWG

SHEET 18 OF 21 SHEETS

SOUTHWEST ENGINEERING
 LAND PLANNING • MAPING • DEVELOPMENT
 5425 W. VEGAS DRIVE
 LAS VEGAS, NEVADA 89108
 (702) 646-9700

STREET/SEWER PLAN & PROFILE
 EAGLE TALON WAY
ELKHORN SPRINGS
 PHASE II