

TYPICAL TRAFFIC/ STREET LIGHT DETAIL
NO SCALE

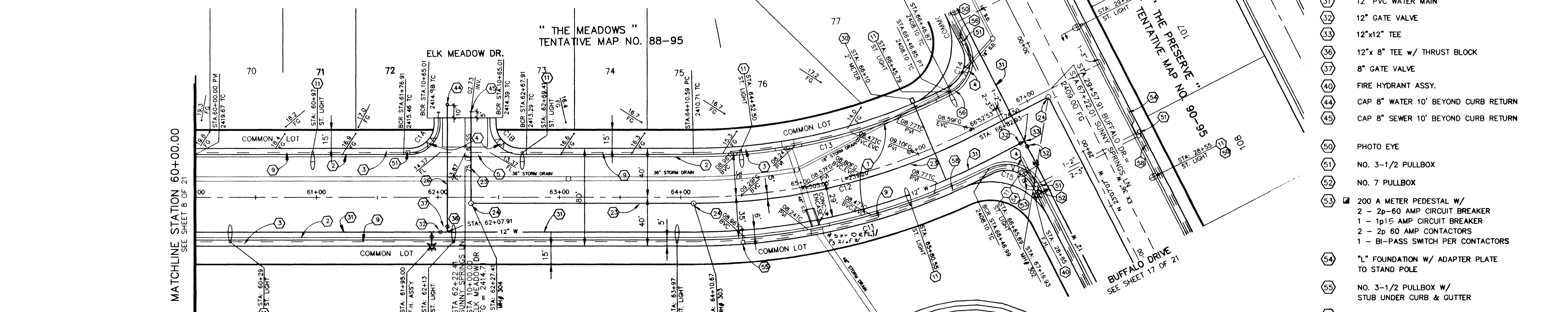

BENCHMARK

PROJECT DATUM=NGVD29 NO.14, STATION 1LV9021N6 3" BRASS CAP USC & GS BM #113 3/4 MILE NORTH OF 1LV9028NNE6, 50' (FT.) EAST OF OLD RAILROAD BED ELEVATION = 2452.515 EQUATION ELEVATION = 2452.515 + 2.401' = 2454.916 (TO NAVD88) (747.5266m + 0.7318m = 748.2584m)

NOTICE TO CONTRACTOR!
EXISTING UTILITY LOCATIONS SHOWN HEREON ARE APPROXIMATE ONLY. IT SHALL BE THE CONTRACTOR'S RESPONSIBILITY TO DETERMINE THE EXACT VERTICAL AND HORIZONTAL LOCATION OF ALL EXISTING UNDERGROUND UTILITIES PRIOR TO COMMENCING CONSTRUCTION. NO REPRESENTATION IS MADE THAT ALL EXISTING UTILITIES ARE SHOWN HEREON. THE ENGINEER ASSUMES NO RESPONSIBILITY FOR UTILITIES NOT SHOWN OR UTILITIES NOT SHOWN IN THEIR PROPER LOCATION.

AVOID CUTTING UNDERGROUND UTILITIES. IT'S COSTLY.
CALL before you Dig
1-800-227-2600
UNDERGROUND SERVICE (USA)

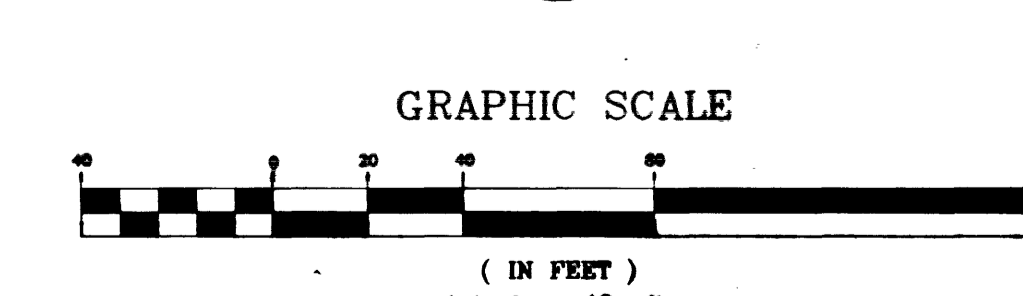

SUNNY SPRINGS LANE

SEE THE MEADOWS GRADING PLAN FOR RETAINING WALLS
CENTERLINE & BACK CURB OF CURVE TABLE

CURVE	RADIUS	DELTA	TANGENT	LENGTH
C1A	25.00'	90°00'00"	25.00'	39.27'
C1B	25.00'	90°00'00"	25.00'	39.27'
C11	535.00'	27°05'16"	128.88'	252.93'
C12	500.00'	27°08'19"	120.68'	236.83'
C13	465.00'	27°04'21"	111.95'	219.71'
C14	30.00'	90°03'59"	30.03'	47.16'
C15	30.00'	89°56'56"	29.97'	47.10'

S/W RAMP DATA		S/W RAMP DATA	
C1A	C1B	C14	C15
A = 8'	A = 4.5'	A = 4.5'	A = 8.0'
B = 8'	B = 9.5'	B = 9.5'	B = 8.0'
Z = 2.75'	Z = 2.75'	Y = 2.75'	Y = 2.75'

PROFILE @ ELK MEADOW DR.

- CONSTRUCTION NOTES:**
- 1 4" A.C. OVER 4" TYPE II A.B. OVER 9" TYPE I A.B.
 - 2 24" "L" TYPE CURB AND GUTTER
 - 3 5' SIDEWALK
 - 4 WHEELCHAIR RAMP
 - 5 8' WIDE CROSS GUTTER
 - 9 2" STREET LIGHT CONDUIT
 - 11 250W HPS STREET LIGHT/BUFFALO DR. 200W HPS STREET LIGHT/SUNNY SPRINGS LN.
 - 23 8" SEWER MAIN (PUBLIC)
 - 24 4" DIA. SEWER MANHOLE
 - 26 8" PVC WATER MAIN
 - 30 INSTALL 2" WATER METER & 2" SERVICE W/ RPPA
 - 31 12" PVC WATER MAIN
 - 32 12" GATE VALVE
 - 33 12"x12" TEE
 - 36 12"x 8" TEE W/ THRUST BLOCK
 - 37 8" GATE VALVE
 - 40 FIRE HYDRANT ASSY.
 - 44 CAP 8" WATER 10' BEYOND CURB RETURN
 - 45 CAP 8" SEWER 10' BEYOND CURB RETURN
 - 50 PHOTO EYE
 - 51 NO. 3-1/2 PULLBOX
 - 52 NO. 7 PULLBOX
 - 53 200 A METER PEDESTAL W/ 2 - 2p-60 AMP CIRCUIT BREAKER 1 - 1p15 AMP CIRCUIT BREAKER 2 - 2p 60 AMP CONTACTORS 1 - BI-PASS SWITCH PER CONTACTORS
 - 54 "L" FOUNDATION W/ ADAPTER PLATE TO STAND POLE
 - 55 NO. 3-1/2 PULLBOX W/ STUB UNDER CURB & GUTTER
 - 56 NO. 5 PULLBOX
 - 58 2" FUTURE LOOPS

APPROVED FOR CONSTRUCTION
DATE 04/15/96
L.V.V.W.D. DATE

REVISION DESCRIPTION

DATE BY APPROVE

NO.

PROFESSIONAL ENGINEER STATE OF NEVADA
MARK E. JONES
CIVIL
LICENSE NO. 6894

STAMP DATE 4/15/96

SOUTHWEST ENGINEERING
LAND PLANNING • MAPPING • DEVELOPMENT
5426 W. VEGAS DRIVE
LAS VEGAS, NEVADA 89108
(702) 648-9700

TITLE: STREET/SEWER PLAN & PROFILE
PROJECT: SUNNY SPRINGS LANE
ELKHORN SPRINGS
PHASE II

WORK ORDER NO. 950925
DESIGN BY: M. JONES
DATE: 04/15/96
SCALE: 1" = 40'
CABLE: SUNSPP-B.DWG
SHEET 9 OF 21 SHEETS