

8" PUBLIC SEWER
STA. 14+42.75 TO STA. 15+83.22

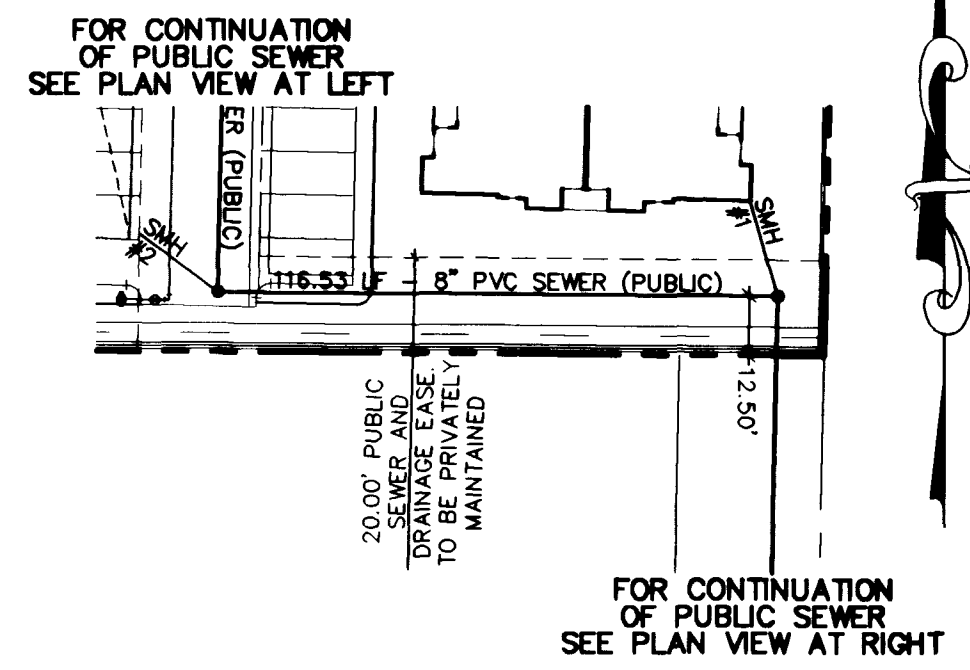

8" PUBLIC SEWER
STA. 13+26.22 TO STA. 14+42.75

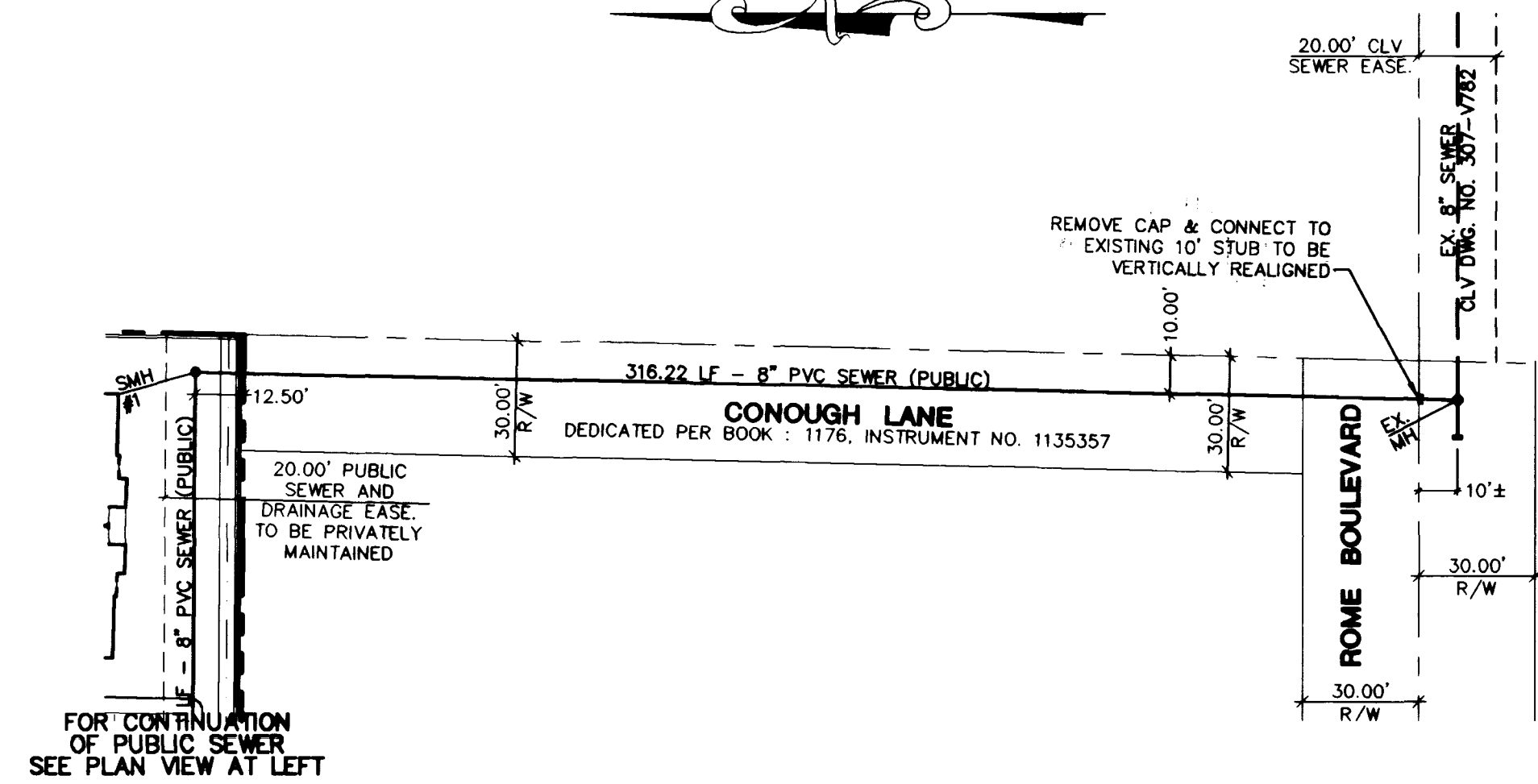

8" PUBLIC SEWER
STA. 10+00.00 TO STA. 13+26.22

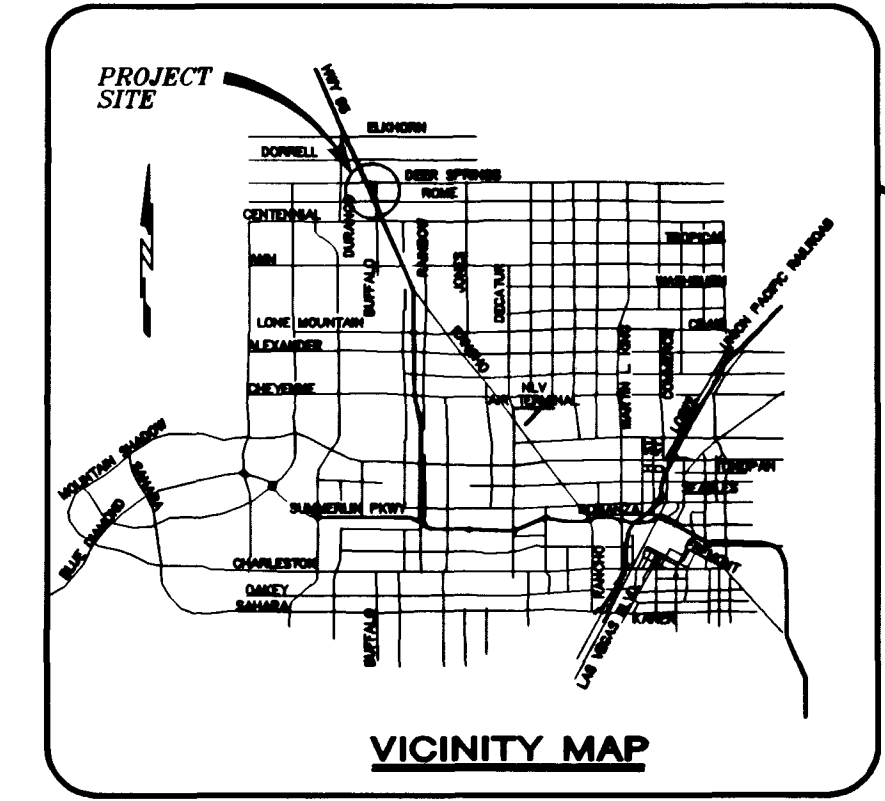

PROJECT BENCHMARK

TBM, 1"69 3" BRASS CAP USC & GS 50' EAST OF US 95 & 200' ± SOUTH OF CENTENNIAL ON 88 DATUM METER 734.5745=2410.02 FEET
TBM # 1LV9028NNE6

BASIS OF BEARINGS

THE BASIS OF BEARINGS FOR THIS PROJECT IS GRID NORTH, AS DEFINED BY THE NEVADA COORDINATE SYSTEM OF 1983 (NCS83), EAST ZONE, (2701), AS DETERMINED BY NORTH LAS VEGAS HARN CONTROL POINTS 700, 704, 714, AS SHOWN ON A RECORD OF SURVEY ON FILE IN THE CLARK COUNTY, NEVADA, RECORDER'S OFFICE IN FILE 82 OF SURVEYS, AT PAGE 52.

Avoid cutting underground utility lines. It's costly.

Avoid overhead power line contact

Call before you Dig
1-800-227-2600

Call before you OVERHEAD
1-702-593-6111

NOTE: CONTRACTOR SHALL VERIFY HORIZONTAL AND VERTICAL LOCATION OF EXISTING UTILITIES AND NOTIFY THE DESIGN ENGINEER IMMEDIATELY OF ANY DISCREPANCIES PRIOR TO CONSTRUCTION.

NOTE:
ALL STATIONING IS BASED ON SEWER LENGTHS FROM MANHOLE TO MANHOLE.

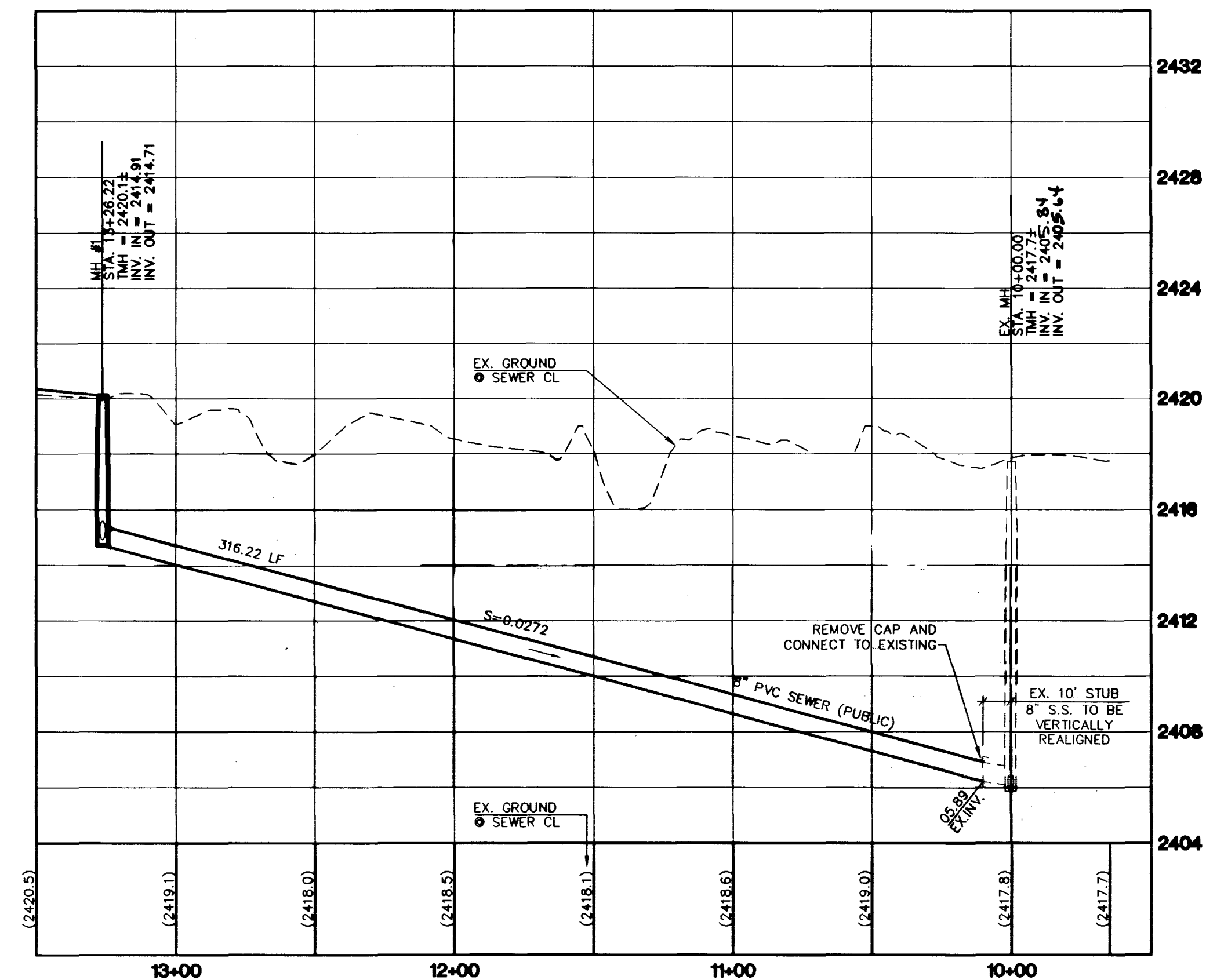
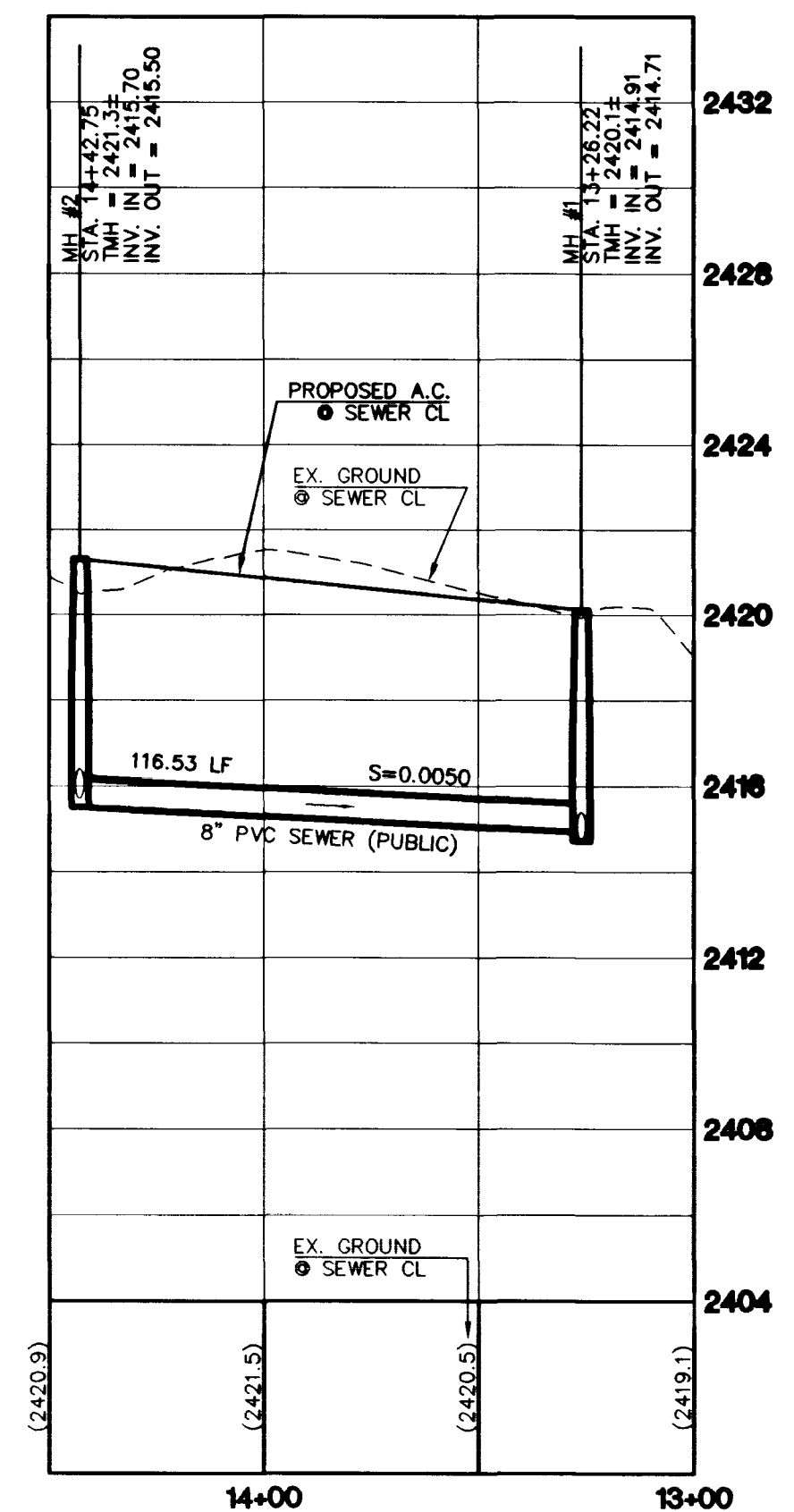
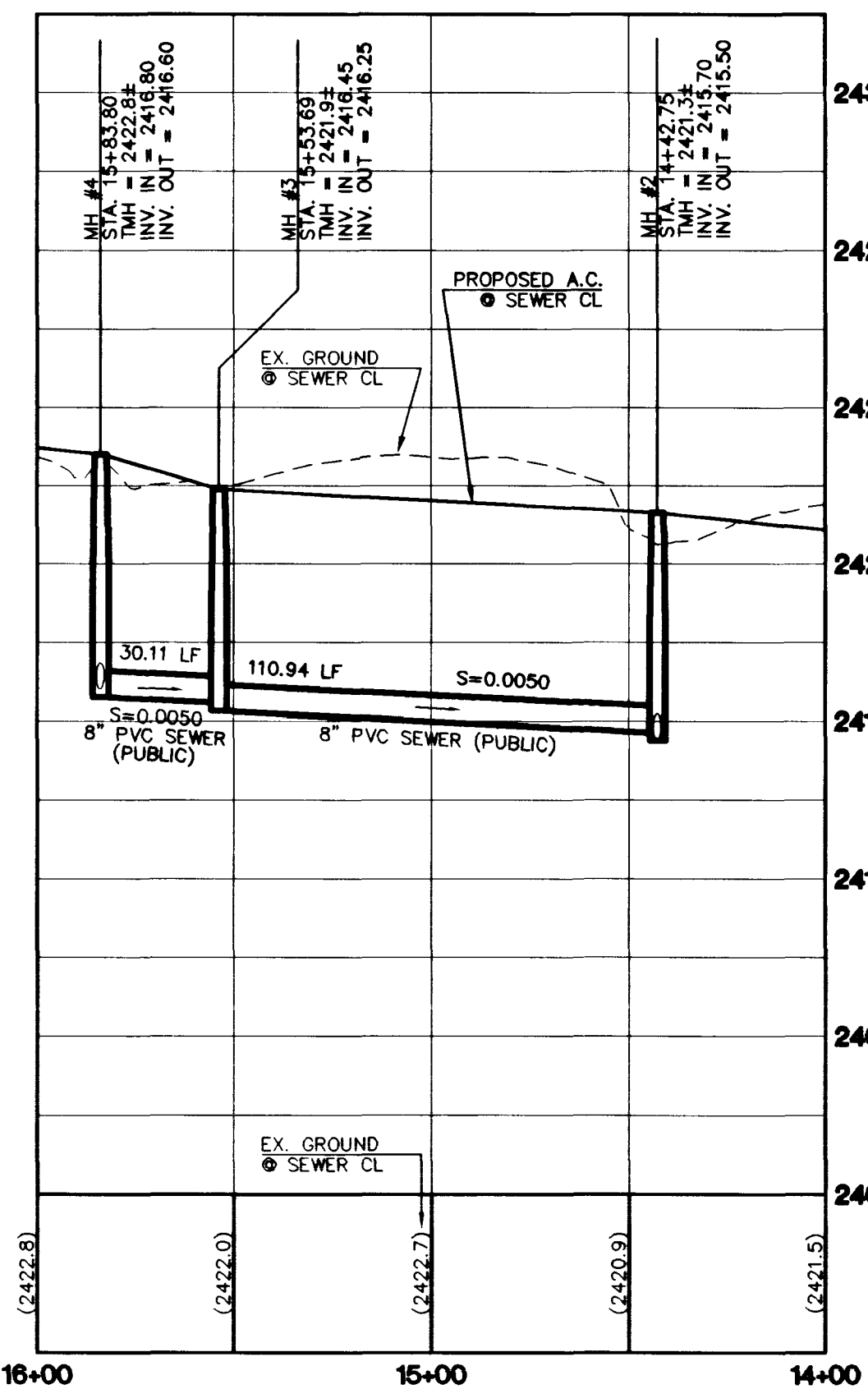
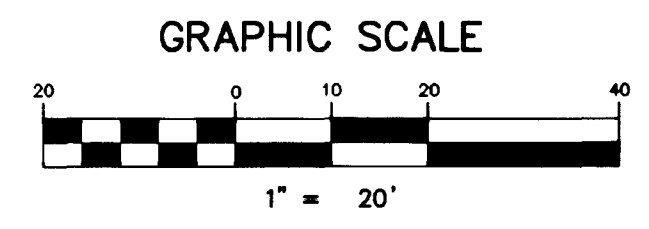

DRAWN BY: dtb		DESIGNED BY: dtb		CHECKED BY: TEH		PROJECT NO: 5522	
DATE: MARCH 1999		DATE: MARCH 1999		DATE: MARCH 1999		SCALE: 1"=40' HORIZ. N/A VERT.	
SHEET SS1		SHEET SS1		SHEET SS1		SHEET SS1	
15 OF 17 SHEETS		15 OF 17 SHEETS		15 OF 17 SHEETS		15 OF 17 SHEETS	
DRAWING NO. 107-V3108		DRAWING NO. 107-V3108		DRAWING NO. 107-V3108		DRAWING NO. 107-V3108	

DEER SPRINGS APARTMENTS

PUBLIC 8" SEWER LINE PLAN AND PROFILE STA. 10+00.00 TO STA. 15+83.22

BIG SKY DEVELOPMENT
3330 N. BUFFALO DRIVE
LAS VEGAS, NEVADA 89129
(702) 593-2650

novada CONSULTING ENGINEERS & PLANNERS • LAND SURVEYORS
2727 SOUTH RAINBOW BOULEVARD LAS VEGAS, NEVADA 89102-5148
PH. (702) 873-7550 FAX (702) 362-2597

