

FOR CONTINUATION SEE SHEET C7

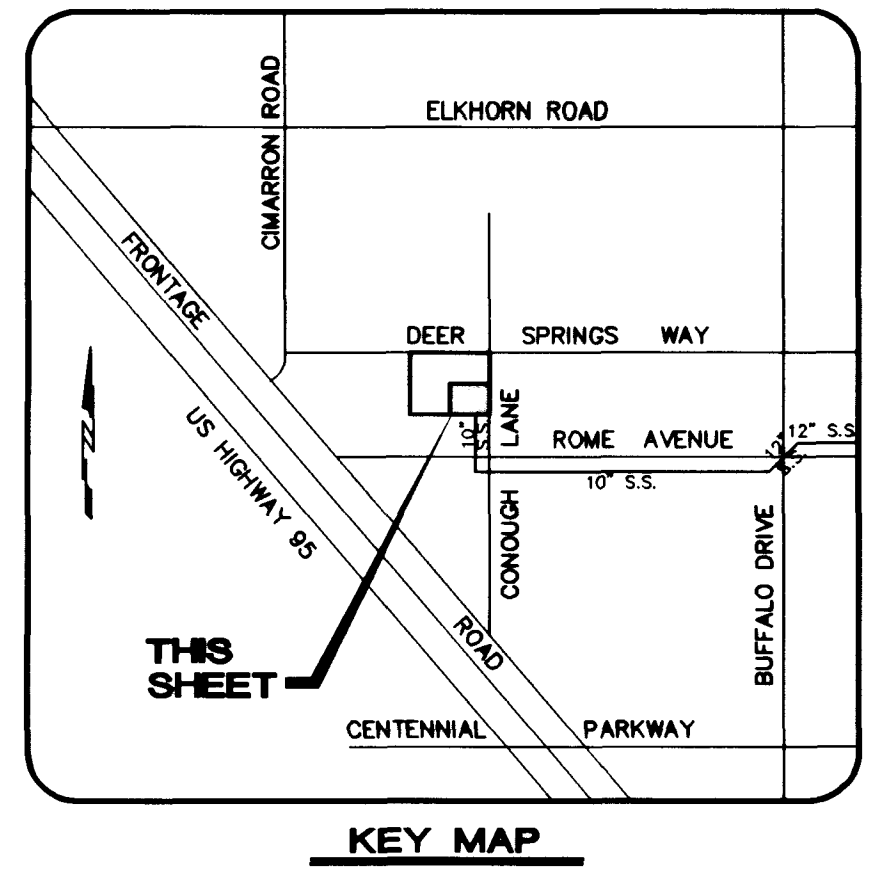
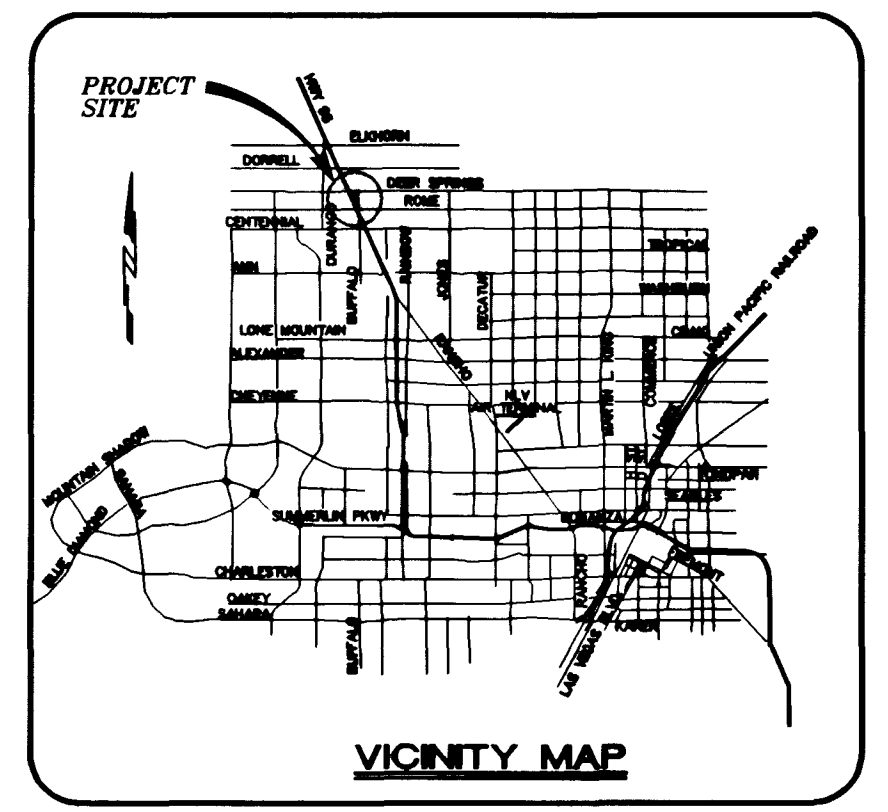
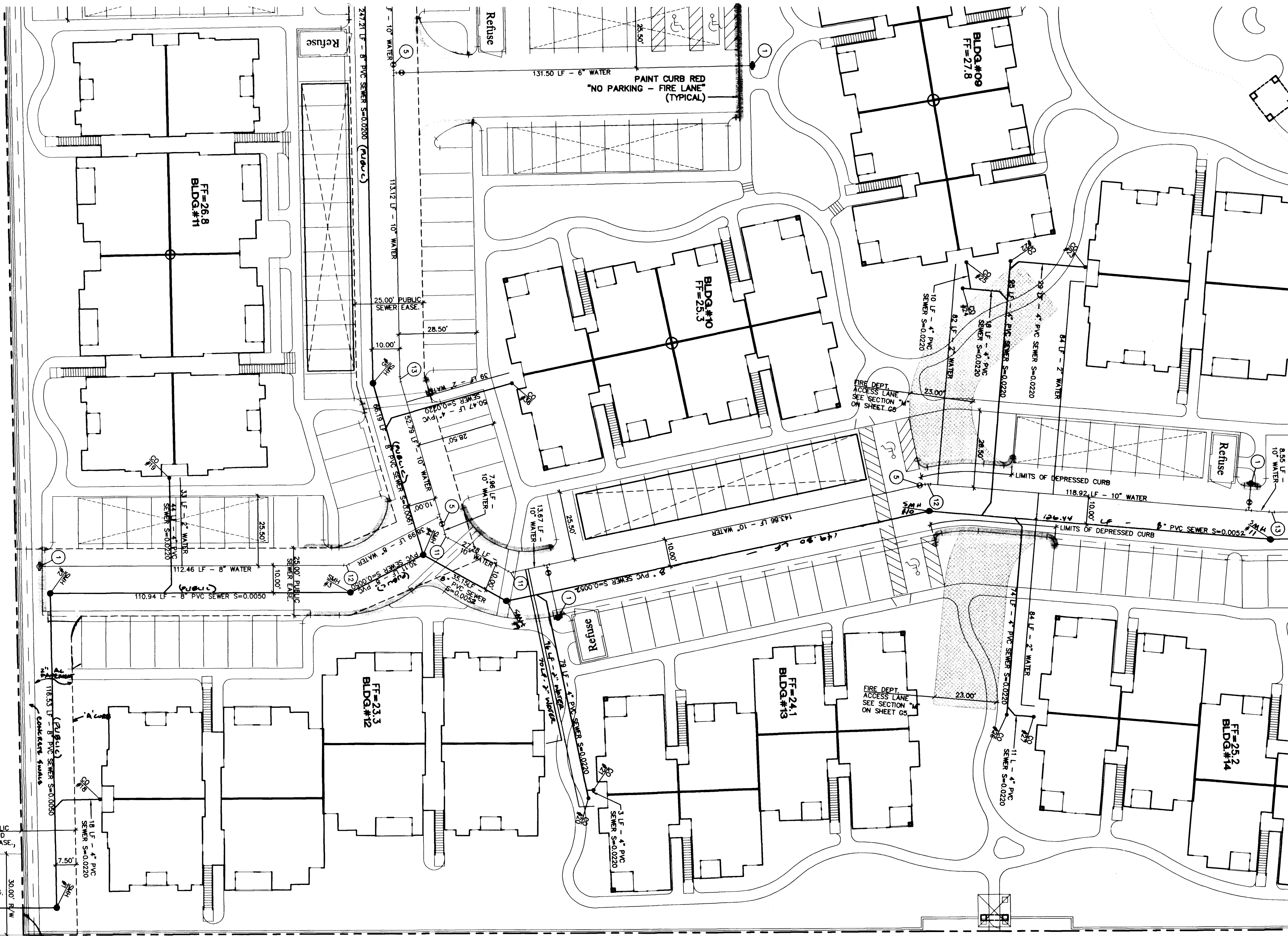

PROJECT BENCHMARK
 TBM, T169 3" BRASS CAP USC & GS 50' EAST OF
 US 95 & 200' ± SOUTH OF CENTENNIAL ON
 88 DATUM METER 734-5745-2410.02 FEET
 TBM # 1LV928NNE6

BASIS OF BEARINGS
 THE BASIS OF BEARINGS FOR THIS PROJECT IS GRID
 NORTH, AS DEFINED BY THE NEVADA COORDINATE SYSTEM
 OF 1983 (NCS83), EAST ZONE, (2701), AS DETERMINED
 BY NORTH LAS VEGAS HARN CONTROL POINTS
 700, 704, 714, AS SHOWN ON A RECORD OF SURVEY
 ON FILE IN THE CLARK COUNTY, NEVADA, RECORDER'S
 OFFICE IN FILE 82 OF SURVEYS, AT PAGE 52.

Avoid cutting underground
 utility lines. It's costly.
Call before you Dig
 1-800-227-2600

Avoid overhead power
 lines. It's costly.
Call before you Overhead
 1-702-593-6111

NOTE: CONTRACTOR SHALL VERIFY HORIZONTAL AND
 VERTICAL LOCATION OF EXISTING UTILITIES AND
 NOTIFY THE DESIGN ENGINEER IMMEDIATELY OF
 ANY DISCREPANCIES PRIOR TO CONSTRUCTION.

STREET LIGHT NOTE
 ALL STREET LIGHTING INSTALLATION EXCEPT AS NOTED ON THE STREET
 LIGHTING PLANS SHALL CONFORM TO THE IMPROVEMENT STANDARDS,
 DEPARTMENT OF PUBLIC WORKS, CLARK COUNTY, NEVADA, AND THE
 UNIFORM STANDARD SPECIFICATIONS FOR PUBLIC WORKS CONSTRUCTION,
 OFF-SITE IMPROVEMENTS, CLARK COUNTY AREA, NEVADA.
 ALL POLES TO BE GALVANIZED. ALL HAND HOLE COVERS MUST BE
 INSTALLED. POLE CAPS POURED AND ALL PULL BOX LIDS BOLTED
 DOWN PRIOR TO ENERGIZING CIRCUIT. ALL WIRE MUST HAVE THW INSULATION.

SEWER CONNECTION NOTE
 A SEGMENT OF THE DOWNSTREAM SEWER SYSTEM
 THAT WILL SERVE THIS PROJECT HAS NOT BEEN
 COMPLETED AND/OR ACCEPTED FOR MAINTENANCE
 BY THE CITY OF LAS VEGAS. ANY WORK DONE
 ON THIS PROJECT PRIOR TO THE COMPLETION
 AND/OR ACCEPTANCE OF THE DOWNSTREAM SEWER
 SYSTEM(S) SHALL BE DONE AT THE DEVELOPER'S
 OWN RISK. THE CITY OF LAS VEGAS RESERVES
 THE RIGHT TO PREVENT THE PHYSICAL CONNECTION
 OF THIS PROJECT INTO THE DOWNSTREAM SEWER
 SYSTEM UNTIL ALL SEGMENTS HAVE BEEN ACCEPTED
 FOR MAINTENANCE, OR UNTIL SUCH TIME AS THEY
 HAVE BEEN DEEMED AVAILABLE FOR SERVICE.

ALL SEWER LOCATED OUTSIDE OF ANY PUBLIC RIGHT-OF-WAY AND
 ANY PUBLIC SEWER EASEMENT IS PRIVATE SEWER PER UPC.

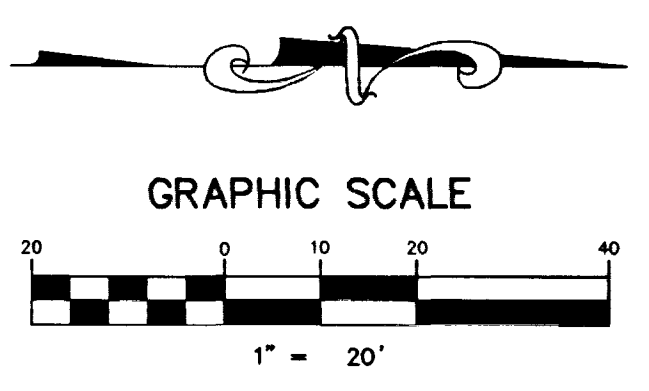

— CURB TO BE PAINTED RED
 "NO PARKING - FIRE LANE"
 (TYPICAL)

- NOTES:**
1. ALL CLEANOUTS LOCATED IN PAVED AREAS WILL BE PROVIDED WITH VALVE BOXES, TRAFFIC BEARING LIDS AND CONCRETE COLLARS.
 2. FOR SEWER CONTRIBUTIONS SEE SHEET C5

FOR CONTINUATION OF OFFSITE SEWER
 SEE SHEET S81

CONOUGH 1 LANE
 DEDICATED PER BOOK: 1176,
 INSTRUMENT NO. 1135357

FOR CONTINUATION SEE SHEET C8

LAS VEGAS VALLEY WATER DISTRICT DATE

CITY OF LAS VEGAS FIRE DEPT. DATE 6/30/99

BIG SKY DEVELOPMENT		MASTER UTILITY PLAN		DEER SPRINGS APARTMENTS	
3320 N. BUFFALO DRIVE LAS VEGAS, NEVADA 89129 (702) 395-2050		2727 SOUTH RAINBOW BOULEVARD LAS VEGAS, NEVADA 89102-5148 PH: (702) 873-7550 FAX: (702) 362-2597			
DRAWN BY: MARCH 1999		DESIGNED BY: MARCH 1999		CHECKED BY: MARCH 1999	
PROJECT NO: 107-V310B		SCALE: 1"=20'		VERT: N/A	
		SHEET C8		8 OF 17 SHEETS	

