

FOR CONTINUATION SEE SHEET C7

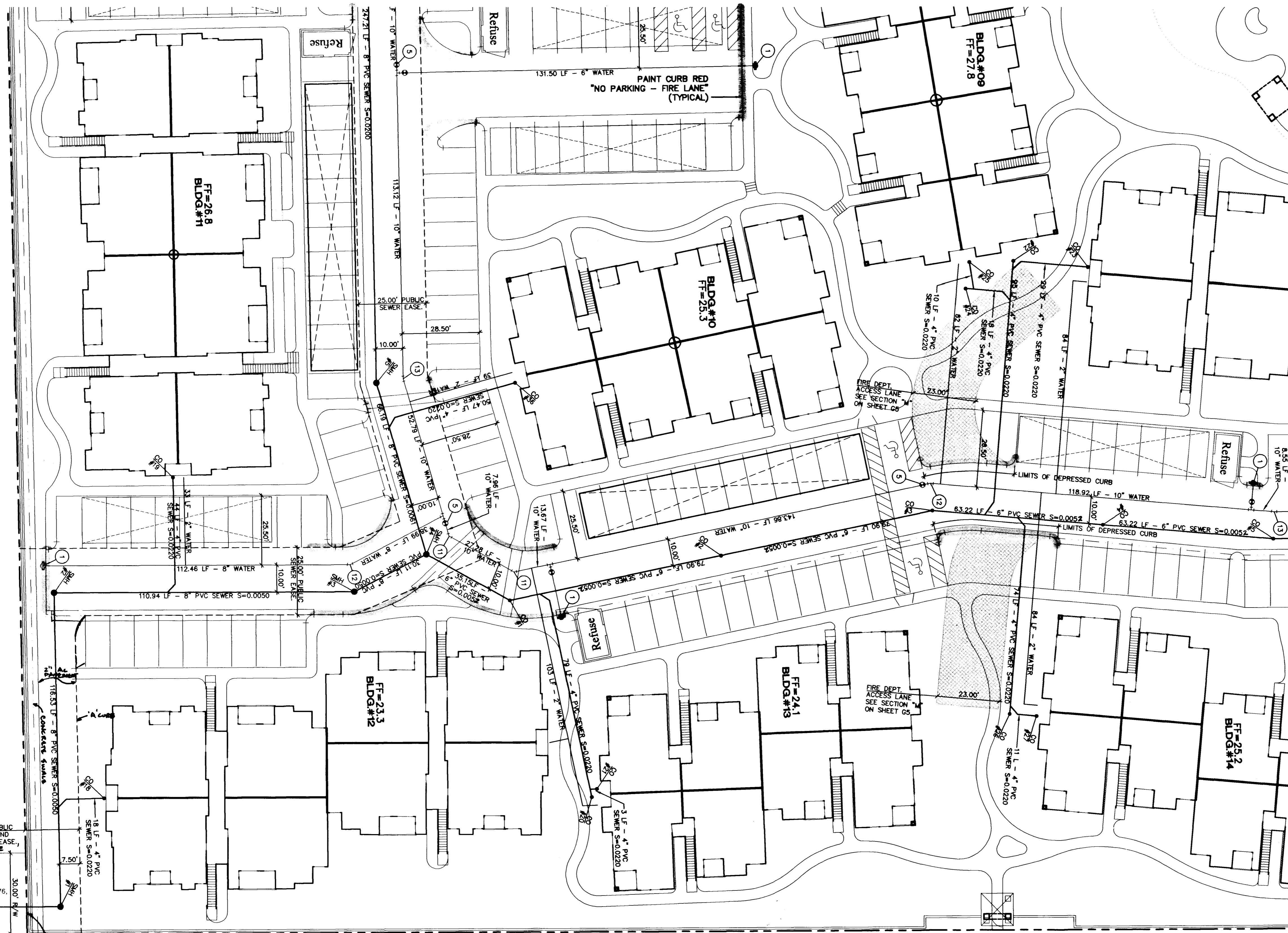

FOR CONTINUATION SEE SHEET C8

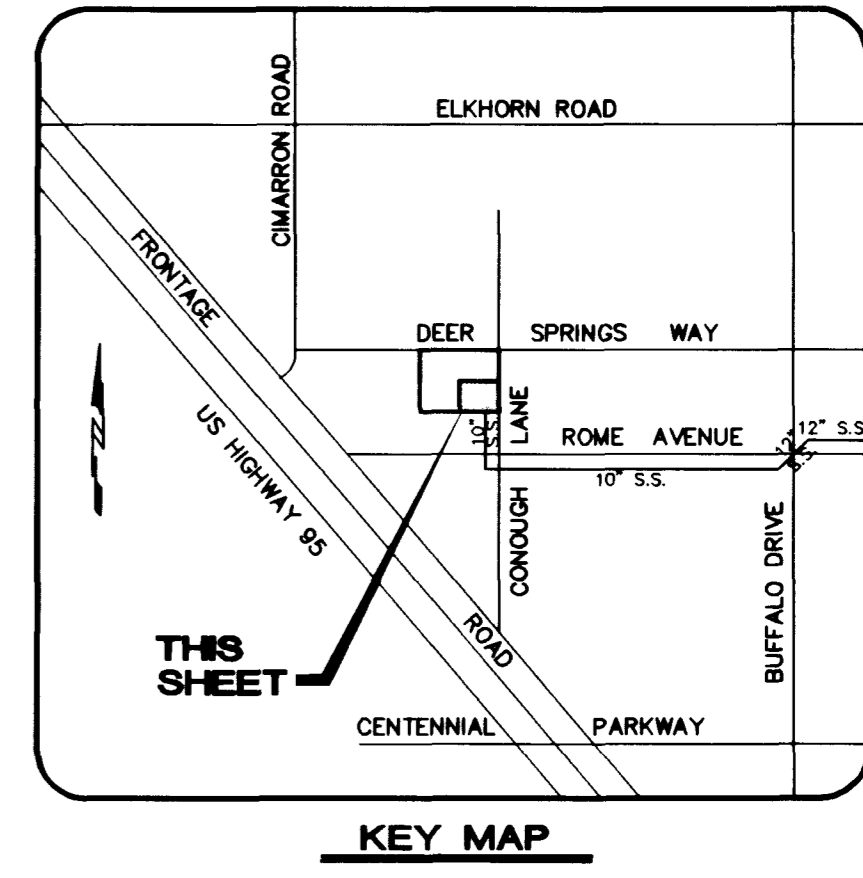
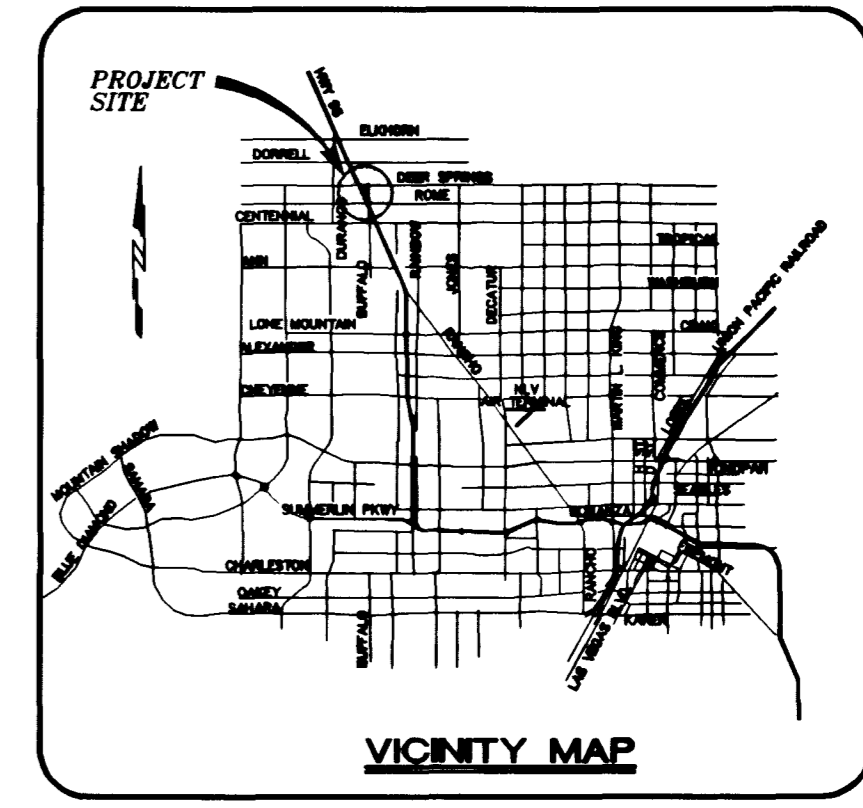

PROJECT BENCHMARK

TBM, T169 3" BRASS CAP USC & GS 50' EAST OF US 95 & 200' ± SOUTH OF CENTENNIAL ON 88 DATUM METER 734.5745-2410.02 FEET TBM # 1LV9028NNE6

BASIS OF BEARINGS

THE BASIS OF BEARINGS FOR THIS PROJECT IS GRID NORTH, AS DEFINED BY THE NEVADA COORDINATE SYSTEM OF 1983 (NCS83), EAST ZONE, (2701), AS DETERMINED BY NORTH LAS VEGAS HARN CONTROL POINTS 700, 704, 714, AS SHOWN ON A RECORD OF SURVEY ON FILE IN THE CLARK COUNTY, NEVADA, RECORDER'S OFFICE IN FILE 82 OF SURVEYS, AT PAGE 52.

Avoid cutting underground utility lines. It's costly.

Call before you Dig 1-800-227-2600

Avoid overhead power line contact.

Call before you OVERHEAD 1-702-593-6111

NOTE: CONTRACTOR SHALL VERIFY HORIZONTAL AND VERTICAL LOCATION OF EXISTING UTILITIES AND NOTIFY THE DESIGN ENGINEER IMMEDIATELY OF ANY DISCREPANCIES PRIOR TO CONSTRUCTION.

STREET LIGHT NOTE

ALL STREET LIGHTING INSTALLATION EXCEPT AS NOTED ON THE STREET LIGHTING PLANS SHALL CONFORM TO THE IMPROVEMENT STANDARDS, DEPARTMENT OF PUBLIC WORKS, CLARK COUNTY, NEVADA, AND THE UNIFORM STANDARD SPECIFICATIONS FOR PUBLIC WORKS CONSTRUCTION, OFF-SITE IMPROVEMENTS, CLARK COUNTY AREA, NEVADA.

ALL POLES TO BE GALVANIZED. ALL HAND HOLE COVERS MUST BE INSTALLED. POLE CAPS POURED AND ALL PULL BOX LIDS BOLTED DOWN PRIOR TO ENERGIZING CIRCUIT. ALL WIRE MUST HAVE THW INSULATION.

SEWER CONNECTION NOTE

A SEGMENT OF THE DOWNSTREAM SEWER SYSTEM THAT WILL SERVE THIS PROJECT HAS NOT BEEN COMPLETED AND/OR ACCEPTED FOR MAINTENANCE BY THE CITY OF LAS VEGAS. ANY WORK DONE ON THIS PROJECT PRIOR TO THE COMPLETION AND/OR ACCEPTANCE OF THE DOWNSTREAM SEWER SYSTEM(S) SHALL BE DONE AT THE DEVELOPER'S OWN RISK. THE CITY OF LAS VEGAS RESERVES THE RIGHT TO PREVENT THE PHYSICAL CONNECTION OF THIS PROJECT INTO THE DOWNSTREAM SEWER SYSTEM UNTIL ALL SEGMENTS HAVE BEEN ACCEPTED FOR MAINTENANCE, OR UNTIL SUCH TIME AS THEY HAVE BEEN DEEMED AVAILABLE FOR SERVICE.

CURB TO BE PAINTED RED "NO PARKING - FIRE LANE" (TYPICAL)

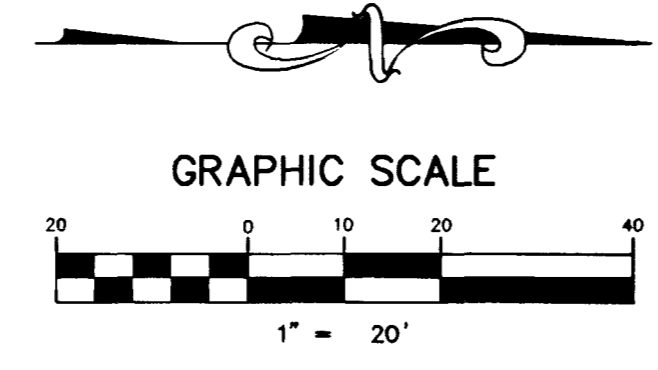

- NOTES:**
- ALL CLEANOUTS LOCATED IN PAVED AREAS WILL BE PROVIDED WITH VALVE BOXES, TRAFFIC BEARING LIDS AND CONCRETE COLLARS.
 - FOR SEWER CONTRIBUTIONS SEE SHEET C5

FOR CONTINUATION OF OFF-SITE SEWER SEE SHEET S81

16985 16977

LAS VEGAS VALLEY WATER DISTRICT DATE

R. G. ...
 CITY OF LAS VEGAS FIRE DEPT. 6/30/99 DATE

BIG SKY DEVELOPMENT
 3320 N. BUFFALO DRIVE
 LAS VEGAS, NEVADA 89129
 (702) 395-2050

MASTER UTILITY PLAN

DRAWN BY:	MARCH 1999
DESIGNED BY:	MARCH 1999
CHECKED BY:	MARCH 1999
PROJECT NO:	5522

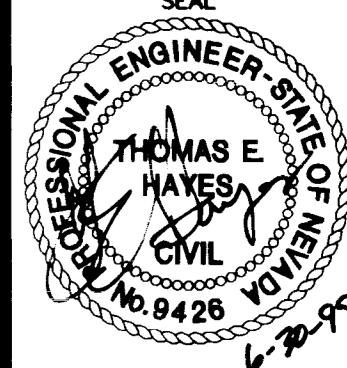

SHEET **C8**
 8 OF 17 SHEETS
 DRAWING NO. 107-V3108

DEER SPRINGS APARTMENTS
 2727 SOUTH RAINBOW BOULEVARD LAS VEGAS, NEVADA 89102-5148
 PH. (702) 873-7550 FAX (702) 362-2497
 VTM nevada CONSULTING ENGINEERS • PLANNERS • LAND SURVEYORS

H:\CAD\LANDEV\5522\552201.dwg Rev Jun 30 07:40:29 1999 Plotted by: dcb

