

APN #125-21-701-004
BLM UNDER CLV JURISDICTION
UNDEVELOPED

20.00' PUBLIC
SEWER AND
DRAINAGE EASE
TO BE PRIVATELY
MAINTAINED

25.00' PUBLIC
SEWER AND
DRAINAGE EASE
TO BE PRIVATELY
MAINTAINED

BLM APN #125-21-701-005
UNDER CLV JURISDICTION

UNDEVELOPED

Call before you Dig
1-800-227-2600

Call before you OVERHEAD
1-702-593-6111

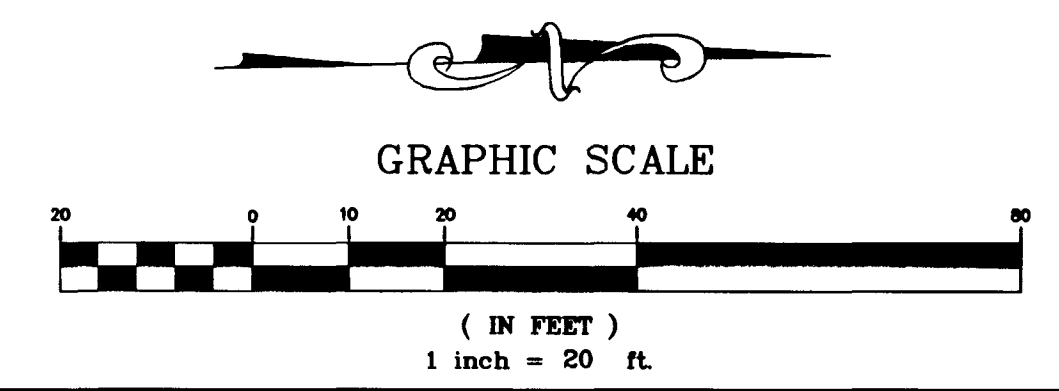

CONSTRUCTION NOTES:
INSTALL 8" MIN. DIAMETER PVC PIPE UNDER SIDEWALK WHERE APPLIES. (TYP.)

FOR GENERAL NOTES / LEGEND REFER TO SHEET C3

PROJECT BENCHMARK
TBM, T169 3" BRASS CAP USC & GS 50' EAST OF US 95 & 200' ± SOUTH OF CENTENNIAL ON 88 DATUM METER 734.5745±2410.02 FEET TBM # 11V9208NNE

BASIS OF BEARINGS
THE BASIS OF BEARINGS FOR THIS PROJECT IS GRID NORTH, AS DEFINED BY THE NEVADA COORDINATE SYSTEM OF 1983 (NCS83), EAST ZONE, (2701), AS DETERMINED BY NORTH LAS VEGAS HARN CONTROL POINTS 700, 704 AND 714, AS SHOWN ON A RECORD OF SURVEY ON FILE IN THE CLARK COUNTY, NEVADA, RECORDER'S OFFICE IN FILE 82 OF SURVEYS, AT PAGE 52.

"I CERTIFY THAT THIS GRADING PLAN IS IN CONFORMANCE WITH THE APPROVED DRAINAGE STUDY ON FILE WITH THE CITY OF LAS VEGAS FOR THIS PROJECT."

JAMES A. THOMAS, P.E. NO. 9705
DATE 7-2-99

BIG SKY DEVELOPMENT		GRADING PLAN		DEER SPRINGS APARTMENTS	
3320 N. BUFFALO DRIVE LAS VEGAS, NV 89129 (702) 395-2060		2727 SOUTH RAINBOW BOULEVARD LAS VEGAS, NEVADA 89102-5148 PH. (702) 873-7550 FAX (702) 362-2597			
DRAWN BY: MIA		SHEET: MARCH, 1999		TITLE: DEER SPRINGS APARTMENTS	
DESIGNED BY: RMF		MARCH, 1999		SCALE: 1"=20' HORZ. VERT.	
CHECKED BY:		PROJECT NO: 5522		SHEET: 04	
		DATE: 7-2-99		DRAWING NO: 107-V310B	
16909		17843			

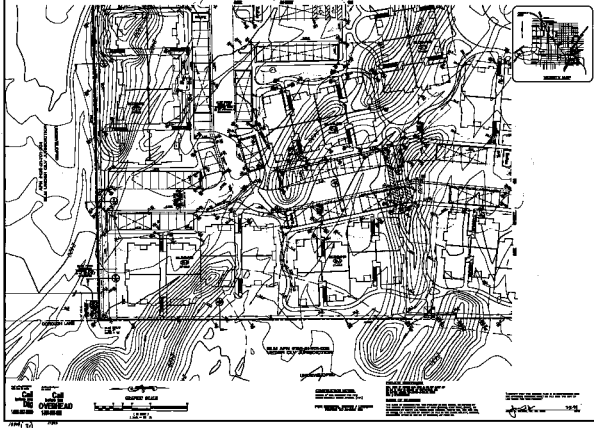

100' 0" 20' 0" 40' 0" 60' 0" 80' 0" 100' 0"
 1" = 100'
 OVERHEAD
 10-68



CONSTRUCTION
 100' 0" 20' 0" 40' 0" 60' 0" 80' 0" 100' 0"
 1" = 100'
 OVERHEAD
 10-68

100' 0" 20' 0" 40' 0" 60' 0" 80' 0" 100' 0"
 1" = 100'
 OVERHEAD
 10-68

100' 0" 20' 0" 40' 0" 60' 0" 80' 0" 100' 0"
 1" = 100'
 OVERHEAD
 10-68

	RESIDENTIAL DEVELOPMENT GENERAL PLAN 10-68
100' 0" 20' 0" 40' 0" 60' 0" 80' 0" 100' 0" 1" = 100' OVERHEAD 10-68	100' 0" 20' 0" 40' 0" 60' 0" 80' 0" 100' 0" 1" = 100' OVERHEAD 10-68
100' 0" 20' 0" 40' 0" 60' 0" 80' 0" 100' 0" 1" = 100' OVERHEAD 10-68	100' 0" 20' 0" 40' 0" 60' 0" 80' 0" 100' 0" 1" = 100' OVERHEAD 10-68