

FOR CONTINUATION SEE SHEET C7

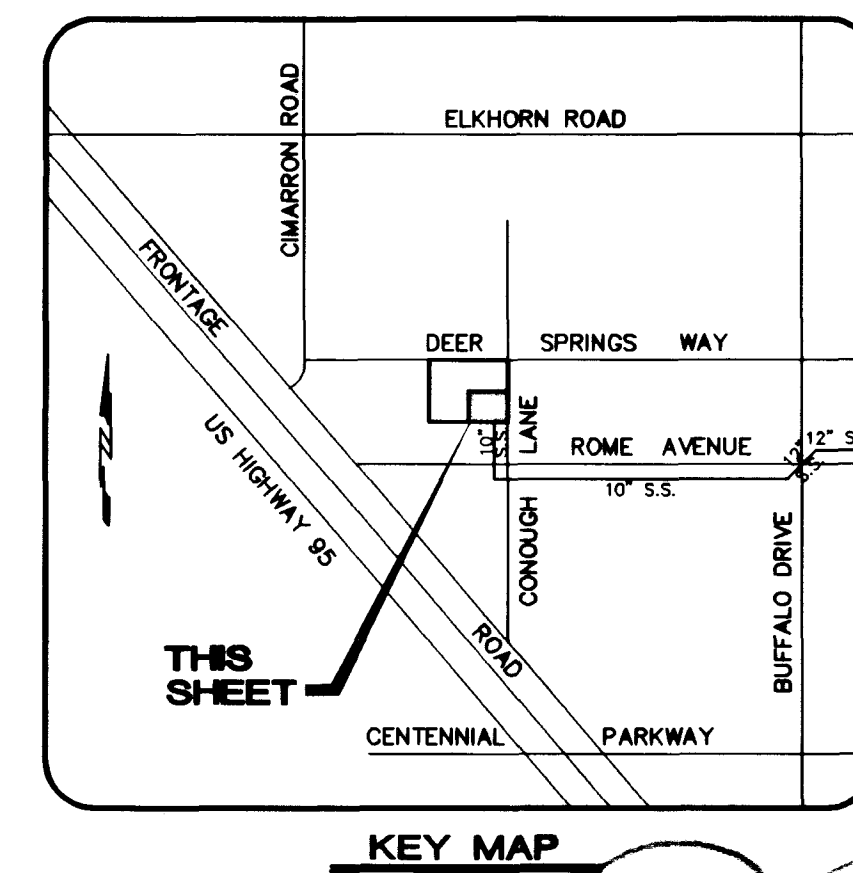
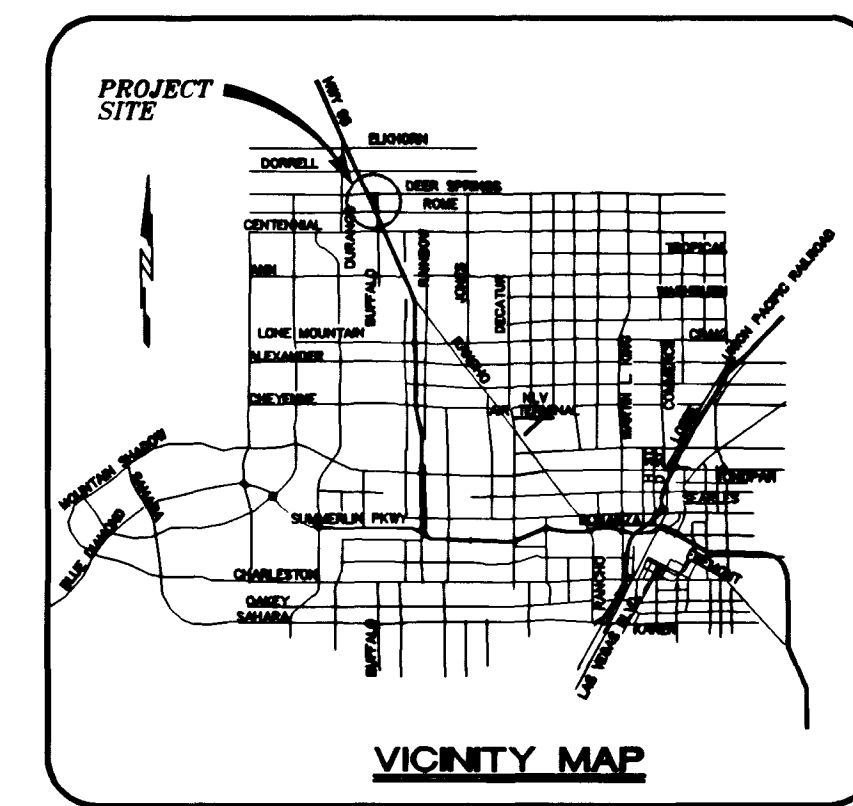

NO.	DATE	BY	REVISION
1	7/19/99	AB	REVISED
2	8/5/99	AB	REVISED
3	8/25/99	TEH	REVISED
4	8/25/99	TEH	REVISED
5	8/26/99	TEH	REVISED

BIG SKY DEVELOPMENT
 3320 N. BUFFALO DRIVE
 LAS VEGAS, NEVADA 89129
 (702) 395-2050

nv
 nevada CONSULTING ENGINEERS • PLANNERS • LAND SURVEYORS
 2727 SOUTH RAINBOW BOULEVARD LAS VEGAS, NEVADA 89102-5148
 PH. (702) 873-7550 FAX (702) 362-2597

MASTER UTILITY PLAN
DEER SPRINGS APARTMENTS

DRAWN BY: SUB	MARCH 1999	SHEET 8 OF 17 SHEETS
DESIGNED BY: AB	MARCH 1999	DRAWING NO. 107-V-310B
CHECKED BY: TEH	MARCH 1999	PROJECT NO. N/A
DATE	DATE	SCALE: 1" = 20' HORIZ. 1/4" = 1' VERT.



FOR CONTINUATION SEE SHEET C8

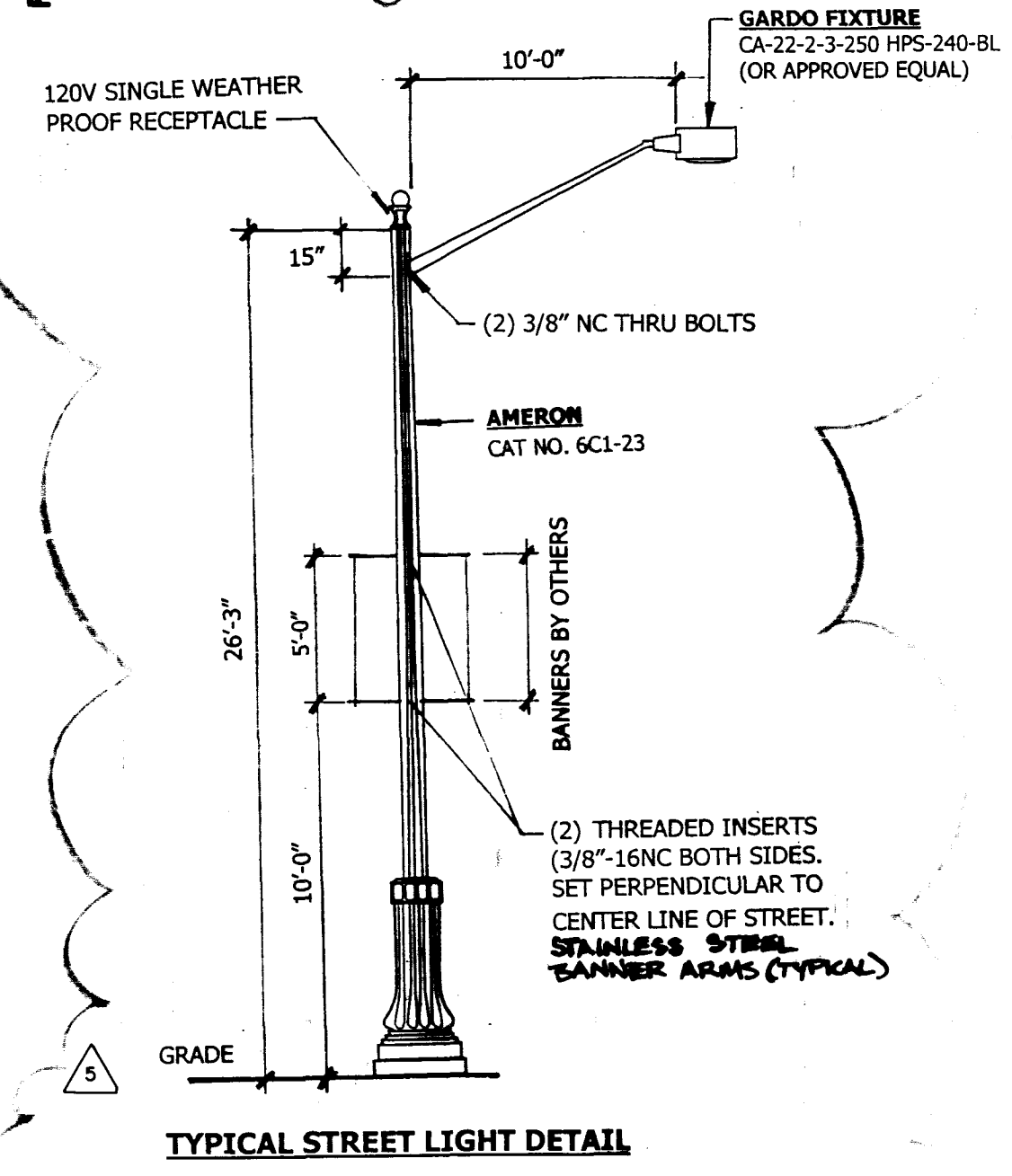

- NOTES:**
- PROVIDE (2) IN-LINE TWO POLE FUSEHOLDER WITH 10A FUSES AND (1) IN-LINE SINGLE POLE FUSE HOLDER WITH 10A FUSES PER POLE LOCATED AT THE HANDHOLE. WIRE FROM HANDHOLE TO 120V RECEPTACLE SHALL BE #10THHN STRANDED (3 TOTAL). WIRING TO LUMINAIRES AND RECEPTACLE FROM HANDHOLE SHALL INCLUDE GROUND.
 - 2" CONDUIT WITH 4-#4, 1-#8 THW WIRE (TYP.)
 - ALL PULLBOXES IN MEDIAN SHALL HAVE CONCRETE COLLARS PER USD NO. 329.
 - CONTROL CIRCUIT FOR 120V RECEPTACLE SHALL BE FED FROM STREET LIGHT PHOTO EYE.
 - COORDINATE ALL WORK WITH CITY OF LAS VEGAS ELECTRICAL SHOP PHONE NO.: 229-6331.

CURB TO BE PAINTED RED "NO PARKING - FIRE LANE" (TYPICAL)

LAS VEGAS VALLEY WATER DISTRICT DATE
 CITY OF LAS VEGAS FIRE DEPT. DATE

PROJECT BENCHMARK
 TBM, T189 3" BRASS CAP USC & GS 50' EAST OF US 95 & 200' ± SOUTH OF CENTENNIAL ON 88 DATUM METER 734.5745-2410.02 FEET
 TBM # 11V9028NNE6

BASIS OF BEARINGS
 THE BASIS OF BEARINGS FOR THIS PROJECT IS GRID NORTH, AS DEFINED BY THE NEVADA COORDINATE SYSTEM OF 1983 (NCS83), EAST ZONE, (2701), AS DETERMINED BY NORTH LAS VEGAS HARN CONTROL POINTS 700, 704, 714, AS SHOWN ON A RECORD OF SURVEY ON FILE IN THE CLARK COUNTY, NEVADA, RECORDER'S OFFICE IN FILE #2 OF SURVEYS, AT PAGE 52.

- NOTES:**
- ALL CLEANOUTS LOCATED IN PAVED AREAS WILL BE PROVIDED WITH VALVE BOXES, TRAFFIC BEARING LIDS AND CONCRETE COLLARS.
 - FOR SEWER CONTRIBUTIONS SEE SHEET C5

STREET LIGHT NOTE
 ALL STREET LIGHTING INSTALLATION EXCEPT AS NOTED ON THE STREET LIGHTING PLANS SHALL CONFORM TO THE IMPROVEMENT STANDARDS, DEPARTMENT OF PUBLIC WORKS, CLARK COUNTY, NEVADA, AND THE UNIFORM STANDARD SPECIFICATIONS FOR PUBLIC WORKS CONSTRUCTION, OFF-SITE IMPROVEMENTS, CLARK COUNTY AREA, NEVADA.

ALL POLES TO BE GALVANIZED. ALL HAND HOLE COVERS MUST BE INSTALLED. POLE CAPS POURED AND ALL PULL BOX LIDS BOLTED DOWN PRIOR TO ENERGIZING CIRCUIT. ALL WIRES MUST HAVE THW INSULATION.

ALL SEWER LOCATED OUTSIDE OF ANY PUBLIC RIGHT-OF-WAY AND ANY PUBLIC SEWER EASEMENT IS PRIVATE SEWER PER U.P.C.

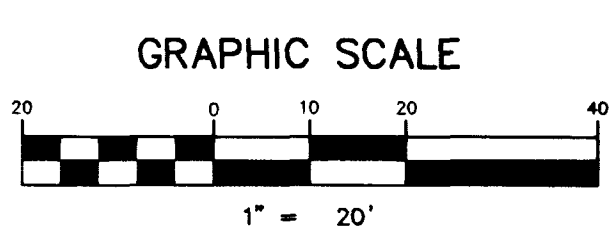

NOTE: CONTRACTOR SHALL VERIFY HORIZONTAL AND VERTICAL LOCATION OF EXISTING UTILITIES AND NOTIFY THE DESIGN ENGINEER IMMEDIATELY OF ANY DISCREPANCIES PRIOR TO CONSTRUCTION.

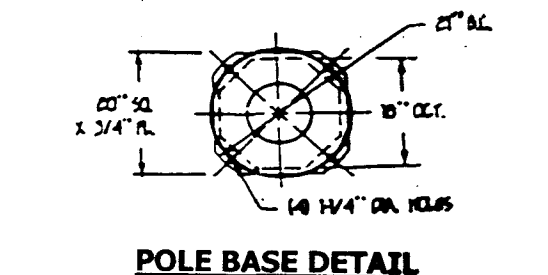
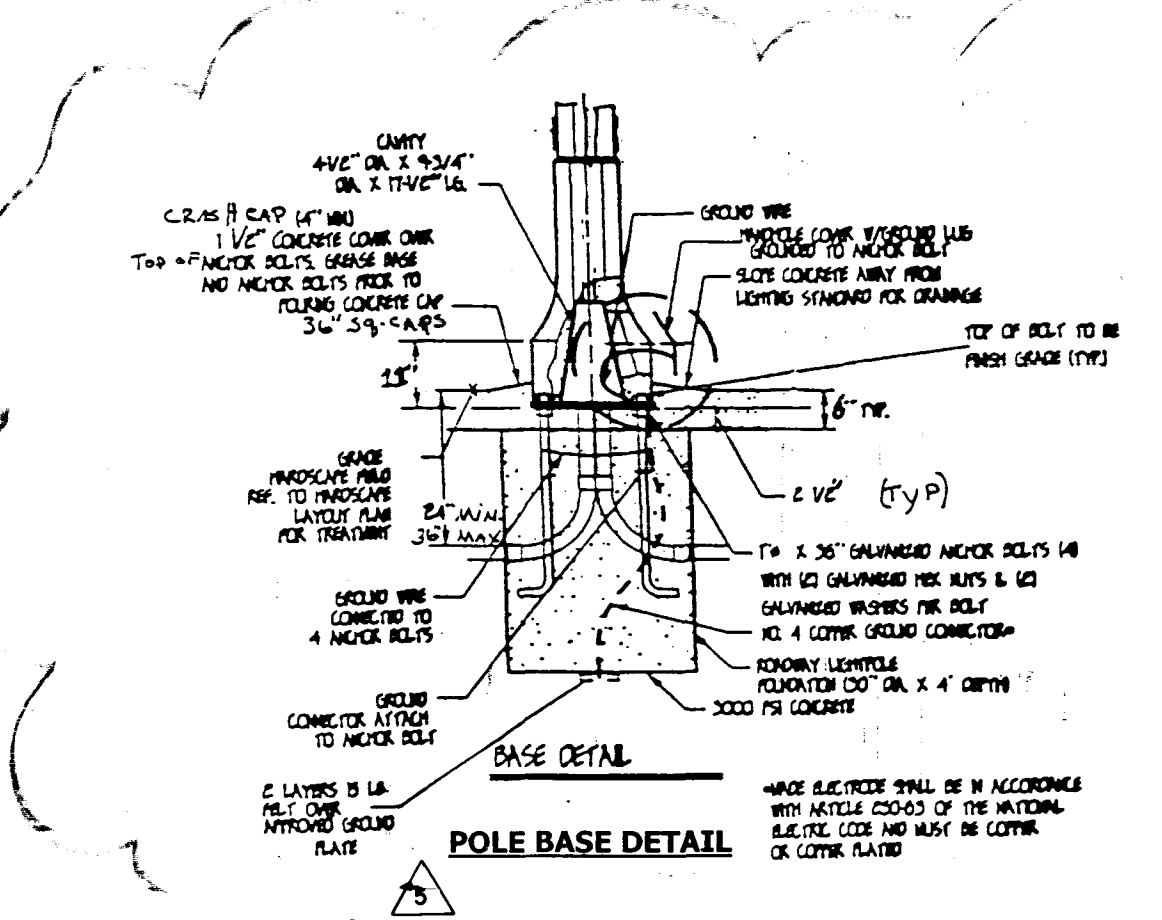

SEWER CONNECTION NOTE
 A SEGMENT OF THE DOWNSTREAM SEWER SYSTEM THAT WILL SERVE THIS PROJECT HAS NOT BEEN COMPLETED AND/OR ACCEPTED FOR MAINTENANCE BY THE CITY OF LAS VEGAS. ANY WORK DONE ON THIS PROJECT PRIOR TO THE COMPLETION AND/OR ACCEPTANCE OF THE DOWNSTREAM SEWER SYSTEM(S) SHALL BE DONE AT THE DEVELOPER'S OWN RISK. THE CITY OF LAS VEGAS RESERVES THE RIGHT TO PREVENT THE PHYSICAL CONNECTION OF THIS PROJECT INTO THE DOWNSTREAM SEWER SYSTEM UNTIL ALL SEGMENTS HAVE BEEN ACCEPTED FOR MAINTENANCE, OR UNTIL SUCH TIME AS THEY HAVE BEEN DEEMED AVAILABLE FOR SERVICE.

STREET LIGHT NOTE:
 ALL HANDHOLE COVERS MUST BE INSTALLED. POLE CAPS POURED, AND PULL BOX LIDS BOLTED DOWN PRIOR TO ENERGIZING CIRCUIT. ALL WIRES MUST HAVE THW INSULATION.

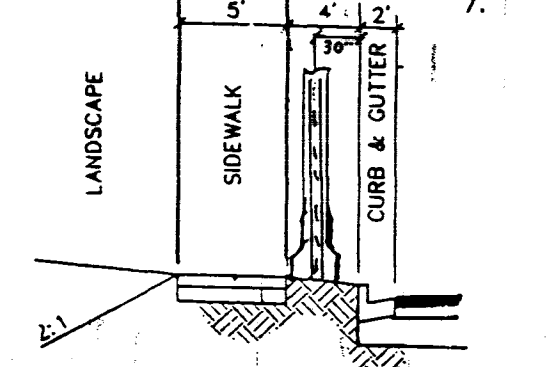

STREET LIGHT LOCATION FOR SIDE LIGHTING WITH AMENITY ZONE.
 NOTE: FINISH SHALL MATCH FIXTURE AND DAVIT ARM.

FOR CONTINUATION OF OFF-SITE SEWER SEE SHEET S81

CONOUGH LANE
 DEDICATED PER BOOK: 1176
 INSTRUMENT NO. 1135357
 (PUBLIC)

Call before you Dig
 1-800-227-2600

Call before you OVERHEAD
 1-702-593-6111

16905 16977 17376 17839

