

625 L.V.B.S.

L11&12 B24 South Add Zone C-2

Angela Jackson

CITY OF LAS VEGAS, NEVADA

LOG NO. & AREA _____ CONST. VAL. \$ N.Y.

DEPARTMENT OF BUILDING & SAFETY

APPLICATION & BUILDING PERMIT — for:
Commercial or Public Structures.

ADDRESS OF CONSTRUCTION: 621-625 Las Vegas Blvd So OWNER: Mrs. Whitesides

LOT(s) 11-12 BLOCK 24 SUBDIVISION South Addn ZONE: C-2

Existing structure on lot: Dwellings Accessory bldgs. Vacant lot Commercial Bldg. Other

PROPOSED CONSTRUCTION: (3) Demo - 3 UNITS USE: MOTEL

MATERIALS OF CONSTRUCTION: Wood Frame Concrete Block Reinforced Concrete Steel Frame

SQUARE FEET OF FLOOR AREAS: 1st _____ 2nd _____ 3rd _____ Other _____ TOTAL SQ. FT. 1200

FIRE ZONE: 1 2 3 Occupancy Group A B C D E F G H I J-1-2-3-4-5 CONST. TYPE: I II III IV V

ARCHITECT: _____ ENGINEER: _____ NO. of UNITS _____ NO. of STORIES _____

Plans Submitted: Yes No Calculations Submitted: Yes No Sewer Fee Req'd. Yes No

CONTRACTOR: Trichner Trucking Service STATE LICENSE # 8703 CITY LICENSE # 3387

ADD'L. PERMITS REQ'D: Air Cond. Elec. Plumbing Signs Paving Fence Public Walks Curb-gutters
Incinerators Fire Sprinkling System

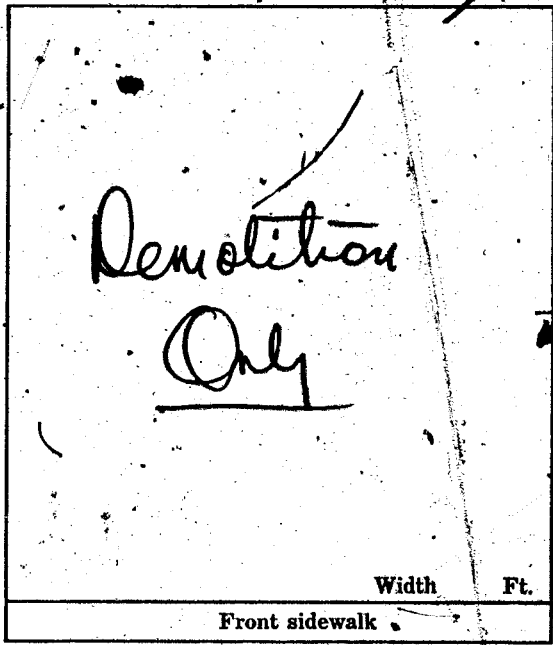

CONDITIONS OF THE PERMIT:

1. I agree to call the City Building Department for inspections before concrete is poured, before rough wiring, electrical, plumbing, framing is covered. Also for Air conditioning, sheet-rock and sheathing inspection.
2. I agree that when the job is completed that I will call for final inspection before occupancy.
3. I agree to perform all construction in accordance with City Ordinances and Building Codes.
4. The Contractor's signature below denotes authority from the owner to sign in his behalf and that the owner is aware of all requirements of this application and permit. Separate permits must be taken out for work outlined above this agreement.
5. I have read and understand the contents of this application and permit; I hereby state that the information I have supplied on this application is true and correct.

SIGNED: Trichner Trucking Service Contractor

BY: Vernon H. Jackson Agent of Owner

CLARK COUNTY HEALTH DEPT. Date _____

LAS VEGAS FIRE DEPARTMENT Date _____

PLANNING DEPT: [Signature] Date: 3-10-69

ENGINEERING DEPT: [Signature] Date: 3/10/69

BUILDING DEPT: [Signature] Date: 3/10/69

#12850 PERMIT NO: 46288 PERMIT FEE \$ 15.00

RECEIPT
18 \$015.00 — 8
CITY OF LAS VEGAS
DEPT. OF BUILDING & SAFETY
MUST BE MACHINE VALIDATED
11 MAR 69

Angela Jackson

H 7436

CITY OF LAS VEGAS, NEVADA

LOG NO. & AREA _____

DEPARTMENT OF BUILDING & SAFETY

APPLICATION & BUILDING PERMIT - for:
Commercial or Public Structures:

CONST. VAL. \$ _____

ADDRESS OF CONSTRUCTION: 625 S. V.B. S

OWNER: _____

LOT(s) _____

BLOCK _____

SUBDIVISION _____

ZONE: _____

Existing structure on lot:

Dwelling

Accessory Bldgs.

Vacant Lot

Commercial Bldg.

Other

PROPOSED CONSTRUCTION: Roofing

USE: _____

MATERIALS OF CONSTRUCTION:

Wood Frame

Concrete Block

Reinforced Concrete

Steel Frame

SQUARE FEET OF FLOOR AREAS: 1st _____

2nd _____

3rd _____

Other _____

TOTAL SQ. FT. _____

FIRE ZONE: 1 2 3

Occupancy Group A B C D E F G H I J

1-2-3-4-5

CONST. TYPE: I II III IV V

ARCHITECT: _____

ENGINEER: _____

NO. of UNITS _____

NO. of STORIES _____

Plans Submitted: -

Yes

No

Calculations Submitted

Yes

No

Sewer Fee Req'd.

Yes

No

CONTRACTOR: Dean Roofing Co. Inc.

STATE LICENSE #

6436

CITY LICENSE #

C11 225 2 01098

ADD'L. PERMITS REQ'D.:

Air Cond.

Elec.

Plumbing

Signs

Paving

Fence

Public Walks

Curb-gutters

Incinerators

Fire Sprinkling System

Ft.

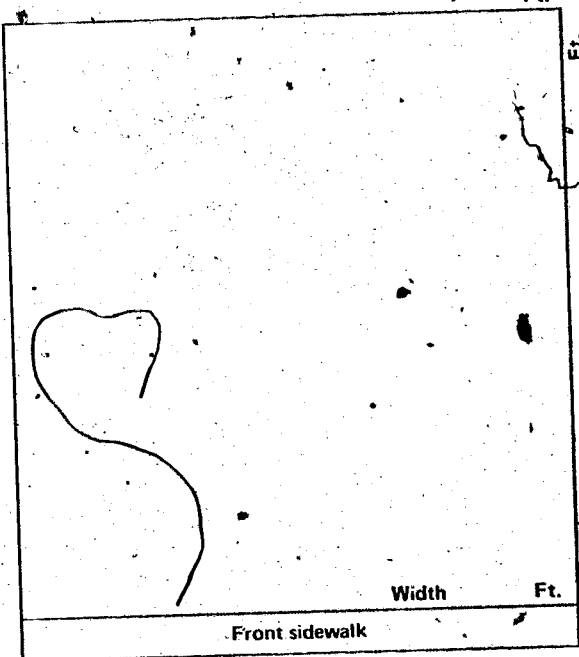

CONDITIONS OF THE PERMIT:

1. I agree to call the City Building Department for inspections before concrete is poured, before rough wiring, electrical, plumbing, framing is covered. Also for Air conditioning, drywall and sheathing inspection.
2. I agree that when the job is completed that I will call for final inspection before occupancy.
3. I agree to perform all construction in accordance with City Ordinances and Building Codes.
4. The Contractor's signature below denotes authority from the owner to sign in his behalf and that the owner is aware of all requirements of this application and permit. Separate permits must be taken out for work outlined above this agreement.
5. I have read and understand the contents of this application and permit; I hereby state that the information I have supplied on this application is true and correct.

Approval for the work under this permit will be given only after refuse and debris have been removed from job site and public right of way.

SIGNED: Dean Roofing Co. Inc. Contractor

[Signature] Agent or Owner

Clark County Health Department Date _____

Las Vegas Fire Department Date _____

PLANNING DEPT.: _____

Date: _____

PUBLIC WORKS DEPT.: _____

Date: _____

BUILDING DEPT.: J. Wenzel

Date: 3-30-76

#12850

PERMIT NO.: 1547

PERMIT FEE \$ 5.00

RECEIPT

9164 \$005.00 - 8

CITY OF LAS VEGAS
DEPT. OF
BUILDING & SAFETY

MUST BE MACHINE VALIDATED

30 MAR 76

Wayne Parkinson

CITY OF LAS VEGAS, NEVADA

DEPARTMENT OF BUILDING & SAFETY - APPLICATION AND PERMIT FOR PLUMBING

ADDRESS OF CONSTRUCTION: 625 Las Vegas Blvd So OWNER'S NAME: El Charo Cafe

CIRCLE: New Bldg Add'n Remodel; TYPE OF BLDG.: SFD APT. PUBLIC COMM.

CONTRACTOR'S NAME: R. Water Conditioning STATE LICENSE # 7453 CITY LICENSE # 559

UNITS	DESCRIPTION	FEE	TOTAL
	Bathtub	1.00	
	Shower	1.00	
	Lavatory	1.00	
	Toilet	1.00	
	Urinal	1.00	
	Floor Drain	1.00	
	Floor Sink	1.00	
	Wash Tray	1.00	
	Sink	1.00	
	Garbage Disposal	1.00	
	Garbage Disposal (comm.)	3.00	
	Clothes Dryer (gas)	1.00	
	Clothes Washer	1.00	
	Clothes Washer (comm.)	5.00	
	Dishwasher	1.00	
	Dishwasher (commercial)	5.00	
	Dental Unit	10.00	
	Drinking Fountain	1.00	
	Any Water using Equipment	1.00	
	Water Heater (gas) (elect.)	1.00	
	Sewer System - New, Replacement, or any Drainage System	4.00	
	Grease or Sand Trap	2.00	
	Trailer Trap	2.00	
	Septic Disposal System	4.00	
WATER SOFTENERS			
	Nonpermanent Type	4.00	
	Permanent Type (connected to Drainage)	5.00	5.00
SWIMMING POOLS			
	Private or Wading Pool	10.00	
	Public or Semi-public	20.00	

UNITS	DESCRIPTION	FEE	TOTAL
WATER DISTRIBUTION SYSTEM			
	Single Family Dwelling	4.00	
	Multiple Family Dwelling plus each unit	4.00 2.00	
	Bldg. Group "A" thru "G" per each floor	6.00	
	Hotel or Motel plus each bath	4.00 1.50	
	Trailer Park plus each space	20.00 1.00	
	Irrigation	4.00	
GAS PIPING SYSTEM			
	Single Family Dwelling	3.00	
	Multiple Family Dwelling plus each unit	6.00 1.00	
	Commercial Bldg. per floor plus each unit	3.00 3.00	
	Gas Appliance (any type)	1.00	
AUTOMATIC FIRE EXTINGUISHING SYSTEM			
	Underground Piping	10.00	
	Distribution Piping ea. ft.	.01	
	Sprinkler Head each	.10	
	In Range Hood and Vent	5.00	
DRY STANDPIPE SYSTEM			
	Piping	50.00	
	Each Outlet	1.00	
WET STANDPIPE SYSTEM			
	Piping	5.00	
	Fire Hose Cabinet	1.00	
	MINIMUM PERMIT FEE	4.00	
PIPELINE CONTRACTOR, SECT. 14 B P F \$			
TOTAL PERMIT FEE \$			

I hereby certify that I have carefully examined and read the above application; that the same is true and correct, and that the work herein described is to be done in accordance with all the provisions of the applicable Ordinances of the City of Las Vegas, Nevada and the State Laws, whether herein specified or not.

Approval for the work under this permit will be given only after refuse and debris have been removed from job site and public right of way.

Signed: Wayne Parkinson Date: 4-29-75
Registered Master Plumber, Spec. Contr. or Owner

Building Department: M. Miller Date: _____

Permit No. 983 Permit Fee \$ 5.00

#12870

RECEIPT

4491 \$005.00 - 7

CITY OF LAS VEGAS
DEPT. OF BUILDING & SAFETY
MUST BE MACHINE VALIDATED

- 1 MAY 75

Angela Jackson

CITY OF LAS VEGAS, NEVADA
DEPARTMENT OF BUILDING & SAFETY - AIR CONDITIONING APPLICATION & PERMIT

ADDRESS OF CONSTRUCTION: 625 Las Vegas Blvd. So. OWNER'S NAME: El Cholo Cafe

CIRCLE: Addition: -Remodel: New Bldg: TYPE OF BLDG.: SFD APT. COMM. **PUBLIC**

CONTRACTOR'S NAME: Remac Inc. STATE LICENSE 5904B CITY LICENSE C11540205716

UNITS	DESCRIPTION	FEE	TOTAL	UNITS	DESCRIPTION	FEE	TOTAL
	Unit heater - floor, wall or suspended	4.00			EVAPORATIVE COOLERS:	3.00	
	FOR EACH FORCED AIR OR GRAVITY TYPE FURNACE OR BURNER INCLUDING DUCTS AND VENT ATTACHED TO SUCH APPLIANCES:				5 outlets or under	5.00	
	Up to and including 100,000 B.t.u.'s	4.00			Over 5 and up to and including 10	.25	
	Over 100,000 B.t.u.'s	6.00			Each additional outlet over 10		
	FOR EACH HEATING APPLICATION, REFRIGERATION UNIT, COMFORT COOLING AND HEATING UNIT, ABSORPTION UNIT, COMPRESSOR OR BOILER:				VENTILATION:		
	Up to and including 3 ton or horsepower, or absorption system up to and including 100,000 B.t.u.'s	4.00			For each fan connected to a single duct	1.00	
	Over 3 ton or 3 horsepower up to and including 10, or absorption system over 100,000 B.t.u.'s up to and including 250,000 B.t.u.'s	7.00	7.00		For each commercial or industrial ventilation system*	5.00	
	Over 10 ton or 10 horsepower up to and including 30, or absorption system over 250,000 B.t.u.'s up to and including 1,000,000 B.t.u.'s	12.00			For each commercial kitchen hood	5.00	
	Over 30 ton or 30 horsepower up to and including 50, or absorption system over 1,000,000 B.t.u.'s up to and including 1,700,000 B.t.u.'s	20.00			MISCELLANEOUS:		
	Over 50 ton or 50 horsepower, or absorption system over 1,700,000 B.t.u.'s	30.00			For each water cooling tower	8.00	
	FOR EACH AIR HANDLING UNIT INCLUDING DUCTS ATTACHED THERETO:				Duct work only - each opening	.25	
	Up to and including 10,000 CFM	2.00			For installation or relocation of each commercial or industrial incinerator	15.00	
	Over 10,000 CFM	4.00			Gas piping related to the air cond. work in single family dwelling only	3.00	
					For each appliance, piece of equipment, any mechanical work or alteration or replacement not included in this schedule, the permit fee shall be computed the same as building permit fees by using the cost of installation for the valuation amount.		
					FOR THE ISSUANCE OF EACH PERMIT	3.00	
					TOTAL PERMIT FEE \$	10.00	

I hereby certify that I have carefully examined and read the above application; that the same is true and correct, and that the work herein described is to be done in accordance with all the provisions of the applicable Ordinances of the City of Las Vegas, Nevada and the State Laws, whether herein specified or not.

SIGNED: *Donald Olsen* Date 9-14-71
Air Conditioning Contractor - Owner

BUILDING DEPARTMENT: *Janet Meyer* Date 9-15-71

PERMIT NO. 464 PERMIT FEE \$ 10.00

RECEIPT
JM
1756 \$010.00 -
CITY OF LAS VEGAS
DEPT. OF BUILDING & SAFETY
MUST BE MACHINE VALIDATED
15 SEP 71

Ripelle Jackson

STOP WORK ORD

Placed on job at: 625 LV 19 2

Contractor / Owner: Rena

DATE 9-14-75 TIME 12:30

REASON no permit
second offense

Inspector: W. Jackson

Removal date: _____

Removal authorized by: _____

10.00 FEE Applicable (Yes/No) _____

Remarks: _____

Angela Jackson

CITY OF LAS VEGAS, NEVADA
 DEPARTMENT OF BUILDING & SAFETY - APPLICATION AND PERMIT FOR PLUMBING

ADDRESS OF CONSTRUCTION: *625 Las Vegas Blvd So*

OWNER'S NAME: *El Cholo Cafe*

CIRCLE: New Bldg.; Add'n; Remodel; TYPE OF BLDG.: SFD. APT. PUBLIC. COMM.

CONTRACTOR'S NAME: *Ace Plumbing*

STATE LICENSE #

CITY LICENSE #

UNITS	DESCRIPTION	FEE	TOTAL
	Bathub	1.00	
	Shower	1.00	
	Lavatory	1.00	
	Toilet	1.00	
	Urinal	1.00	
	Floor Drain	1.00	
<i>2</i>	Floor Sink	1.00	<i>2.00</i>
	Wash Tray	1.00	
	Sink	1.00	
	Garbage Disposal	1.00	
	Garbage Disposal (comm.)	3.00	
	Clothes Dryer (gas)	1.00	
	Clothes Washer	1.00	
	Clothes Washer (comm.)	5.00	
	Dishwasher	1.00	
	Dishwasher (commercial)	5.00	
	Dental Unit	10.00	
	Drinking Fountain	1.00	
	Any Water using Equipment	1.00	
	Water Heater (gas) (elect.)	1.00	
	Sewer System - New, Replacement, or any Drainage System	4.00	<i>4.00</i>
<i>1</i>	Grease or Sand Trap	2.00	<i>2.00</i>
	Trailer Trap	2.00	
	Septic Disposal System	4.00	
WATER SOFTENERS			
	Nonpermanent Type	4.00	
	Permanent Type (connected to Drainage)	5.00	
SWIMMING POOLS			
	Private or Wading Pool	10.00	
	Public or Semi-public	20.00	

UNITS	DESCRIPTION	FEE	TOTAL
WATER DISTRIBUTION SYSTEM			
	Single Family Dwelling	4.00	
	Multiple Family Dwelling plus each unit	4.00	
		2.00	
	Bldg. Group "A" thru "G" per each floor	6.00	
	Hotel or Motel plus each bath.	4.00	
		1.50	
	Trailer Park plus each space	20.00	
		1.00	
	Irrigation	4.00	
GAS PIPING SYSTEM			
	Single Family Dwelling	3.00	
	Multiple Family Dwelling plus each unit	6.00	
		1.00	
	Commercial Bldg. per floor plus each unit	3.00	
		3.00	
	Gas Appliance (any type)	1.00	
AUTOMATIC FIRE EXTINGUISHING SYSTEM			
	Underground Piping	10.00	
	Distribution Piping ea. ft.	.01	
	Sprinkler Head each	.10	
	In Range Hood and Vent	5.00	
DRY STANDPIPE SYSTEM			
	Piping	50.00	
	Each Outlet	1.00	
WET STANDPIPE SYSTEM			
	Piping	5.00	
	Fire Hose Cabinet	1.00	
	MINIMUM PERMIT FEE	4.00	
TOTAL PERMIT FEE \$		<i>88.00</i>	

I hereby certify that I have carefully examined and read the above application; that the same is true and correct; and that the work herein described is to be done in accordance with all the provisions of the applicable Ordinances of the City of Las Vegas, Nevada and the State Laws, whether herein specified or not.

Signed: *[Signature]* # 51
 REGISTERED MASTER PLUMBER, SPEC. CONTR. OR OWNER

Date: *3/4/71*

Building Department: *[Signature]*

Date: *3-5-71*

#12870

Permit No. *3279.4*

Permit Fee \$ *88*

RECEIPT
 5190 \$008.00 - 7
 CITY OF LAS VEGAS
 DEPT. OF BUILDING & SAFETY
 MUST BE MACHINE VALIDATED
 - 5 MAR 71

Angela Jackson

CITY OF LAS VEGAS, NEVADA

LOG NO. & AREA _____

CONST. VAL. \$ 4.00

DEPARTMENT OF BUILDING & SAFETY

APPLICATION & BUILDING PERMIT — for:
Commercial or Public Structures.

ADDRESS OF CONSTRUCTION: 625 L.V.B. So.

OWNER: Mrs. Whiteside

LOT(s) _____ BLOCK _____ SUBDIVISION _____ ZONE: _____

Existing structure on lot: Dwelling Accessory bldgs. Vacant lot Commercial Bldg. Other

PROPOSED CONSTRUCTION: Reroofing USE: _____

MATERIALS OF CONSTRUCTION: Wood Frame Concrete Block Reinforced Concrete Steel Frame

SQUARE FEET OF FLOOR AREAS: 1st _____ 2nd _____ 3rd _____ Other _____ TOTAL SQ. FT. _____

FIRE ZONE: 1 2 3 Occupancy Group A B C D E F G H I J-1-2-3-4-5 CONST. TYPE: I II III IV V

ARCHITECT: None ENGINEER: None NO. of UNITS _____ NO. of STORIES _____

Plans Submitted: Yes No Calculations Submitted Yes No Sewer Fee Req'd. Yes No

CONTRACTOR: Dean Roofing Co. Inc. STATE LICENSE # 6436 CITY LICENSE # C11 225 2 01098

ADD'L. PERMITS REQ'D: Air Cond. Elec. Plumbing Signs Paving Fence Public Walks Curb-gutters
Incinerators Fire Sprinkling System

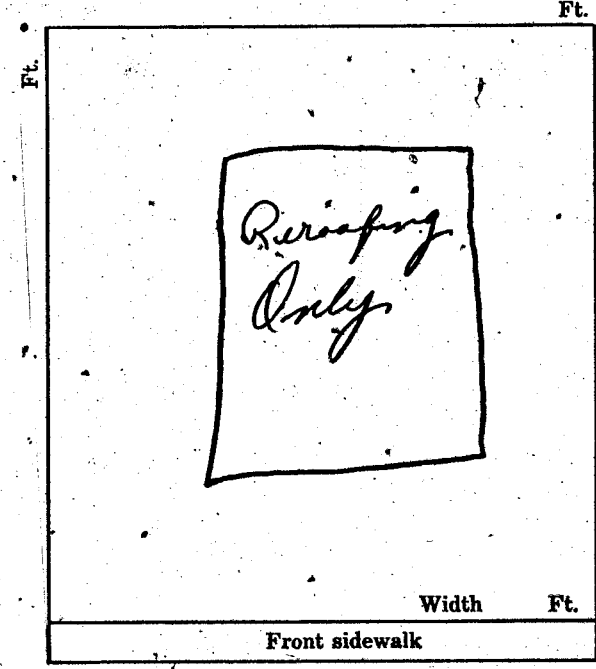

CONDITIONS OF THE PERMIT:

1. I agree to call the City Building Department for inspections before concrete is poured, before rough wiring, electrical, plumbing, framing is covered. Also for Air conditioning, sheet-rock and sheathing inspection.
2. I agree that when the job is completed that I will call for final inspection before occupancy.
3. I agree to perform all construction in accordance with City Ordinances and Building Codes.
4. The Contractor's signature below denotes authority from the owner to sign in his behalf and that the owner is aware of all requirements of this application and permit. Separate permits must be taken out for work outlined above this agreement.
5. I have read and understand the contents of this application and permit; I hereby state that the information I have supplied on this application is true and correct.

SIGNED: Dean Roofing Co. Inc. Contractor

BY: Angela Jackson Agent or Owner

CLARK COUNTY HEALTH DEPT. Date _____

LAS VEGAS FIRE DEPARTMENT Date _____

PLANNING DEPT: _____ Date: _____

ENGINEERING DEPT: _____ Date: _____

BUILDING DEPT: James Meyer Date: 8/14/68

#1285 PERMIT NO: 43921 PERMIT FEE \$ 4.00

RECEIPT
JM
 3702 \$004.00 — 8
 CITY OF LAS VEGAS
 DEPT. OF BUILDING & SAFETY
 MUST BE MACHINE VALIDATED
 14 AUG 68

Dona Olesky

8-12-82

Department of Building & Safety
City of Las Vegas, Nevada

Special Kardex
Elec. only, Plbg. only, A.C. only

Owner El Cholo Cafe Address 625 L. V. Blvd. S. Date: 9/15/71

Contractor _____ Permit No. _____

Lot _____ Block _____ Subdivision _____

Electric Only	Plumbing Only	Heat & Vent. A. C. Only
Contractor _____	Contractor _____	Contractor <u>Remac</u>
Permit No. _____	Permit No. _____	Permit No. <u>464</u>
Slab _____	Rough Soil _____	A.C. Rough Duct _____
Rough Elect _____	Rough Water _____	Ref. Ro. Piping _____
Final Rough _____	Top Out _____	Rough Gas _____
Final Fixture _____	Rough Gas _____	Final Refrig _____
Final Elec _____	Final Plbg. _____	Final Air Cond. <u>9-15-71</u>
Temp. Service _____	Final Gas _____	Final Gas _____
	Final Sewer _____	
	Final Septic Tank _____	

23.06-D Address 625 L. V. Blvd. S. Log No. HP Area _____

DEPT. of BLDG. & SAFETY - CITY of LAS VEGAS, NEVADA

OWNER _____ ADDRESS 625 Las Vegas Blvd South DATE 3-30-76
GEN. CONT. Dean Roofing Co. Inc. TYPE OF STRUCTURE Roofing

BUILDING	MECHANICAL	ELECTRICAL
Investigation _____	Plumbing Cont. _____ Date _____	Temp. pole cont. _____ Date _____
Location & Footing _____	Permit No. _____	Permit No. _____ Date _____
Stem Wall _____	Heat & Vent. A/C Cont. _____ Date _____	Inspection _____ Date _____
Concrete Slab Floor _____	Permit No. _____	Electrical Cont. _____ Date _____
Floor Framing _____	Sewer Cont. _____ Date _____	Permit No. _____ Date _____
Fireplace Footing _____	Permit No. _____	Fixtures Cont. _____ Date _____
Chimney Steel _____	Rough Soil _____	Permit No. _____ Date _____
Vert. Steel Reinf. _____	Rough Water _____	Slab _____
Horiz. Steel Reinf. _____	Top-Out _____	Rough _____
Roof Sheathing _____	Rough Gas _____	Final Rough _____
Framing _____	A/C Rough Duct _____	Final Fixture _____
Backing for siding _____	Ref. Rough Piping _____	Final Electrical _____
Ext. Lath _____	Final Plumbing _____	Temporary Service _____
Ext. Scratch _____	Final Gas _____	MISCELLANEOUS
Ext. Brown _____	Final Air Cond. _____	Grading & Drainage _____
Int. Lath _____	Final Refrig. _____	On-Site Parking Spaces _____ App _____
Int. Brown _____	Final Sewer _____	Eng. Approval of _____
Drywall _____	Final Septic Tank _____	Off-Site Improvements _____
Permit No. _____		
Final Building _____		
Appr. for Occu. _____		

INSPECTOR: _____ DATE _____
APPROVED FOR OCCUPANCY & METER HB 4-13-76
PLEASE NOTE REMARKS ON REVERSE SIDE 625 Las Vegas Blv. So LOG # _____ AREA # _____

Dona Ghesly

8-12-82

DEPT. of BLDG & SAFETY—CITY of LAS VEGAS, NEVADA

OWNER Mrs. Whiteside ADDRESS 625 Las Vegas Blvd. South DATE 8/14/68
GEN CONT. Dean Roofing Co., Inc. TYPE OF STRUCTURE reroof
PERMIT NO. 43921 LEGAL DESCRIPTION

BUILDING		MECHANICAL		ELECTRICAL	
LOCATION		PLUMBING CONT.		TEMP. POLE CONT.	
FIREPLACE FTG		PERMIT NO. DATE		PERMIT NO. DATE	
FOUNDINGS		HEAT & VENT. AC CONT.		INSPECTION	DATE
FOUNDATION WALL		PERMIT NO. DATE		ELECTRICAL CONT.	
FLOOR FRAMING		SEWER CONT.		PERMIT NO. DATE	
SLAB		PERMIT NO. DATE		FIXTURES CONT.	
CHIMNEY STEEL (FIREPLACE)		ROUGH SOIL		PERMIT NO. DATE	
WALL STEEL		ROUGH WATER		SLAB	
COLUMN STEEL		TOP-OUT		ROUGH	
BEAM STEEL		ROUGH GAS		FINAL REFRIG.	
FRAMING		AC ROUGH DUCT		FINAL FIXTURE	
ROOF SHEATHING		REF. ROOF PIPING		FINAL ELECTRICAL	
	INTERIOR EXTERIOR	FINAL PLUMBING		TEMPORARY SERVICE	
DRYWALL		FINAL GAS			
LATHING		FINAL AIR COND.		MISCELLANEOUS	
BACKING (SIDING)		FINAL REFRIG.		GRADING & DRAINAGE	
PLASTER	SCRATCH BROWN	FINAL SEWER		ON-SITE PARKING SPACES	APP.
URBAN REDEVELOPMENT APPROVAL		FINAL SEPTIC TANK		ENG APPROVAL OF	
FINAL BLDG	DATE			OFF-SITE IMPROVEMENTS	

APPROVED FOR OCCUPANCY METER Baily 8-30-68 INSPECTOR DATE
PLEASE NOTE REMARKS ON REVERSE SIDE LOG # AREA # 23.06

625 Las Vegas Blvd. South

Department of Building & Safety
City of Las Vegas, Nevada

Special Kardex
Elec. only, Plbg. only, A.C. only

Owner El Cholo Cafe Address 625 L V Blvd S Date: 5/1/75
Contractor Permit No.
Lot Block Subdivision

Electric Only	Plumbing Only	Heat & Vent. A. C. Only
Contractor	Contractor L. V. Water Cond	Contractor
Permit No.	Permit No. 983	Permit No.
Slab	Rough Soil	A.C. Rough Duct
Rough Elect	Rough Water	Ref. Ro. Piping
Final Rough	Top Out	Rough Gas
Final Fixture	Rough Gas	Final Refrig.
Final Elec	Final Plbg.	Final Air Cond
Temp. Service	Final Gas	Final Gas
	Final Sewer	
	Final Septic Tank	

23.06 D

Address

625 L. V. Blvd. S

Log No.

Softener

Area

Dona Ghesly

8-12-82

Department of Building & Safety
City of Las Vegas, Nevada

Special Kardex
Elec. only, Plbg. only, A. C. only

Owner El Cholo Cafe Address 325 Las Vegas Blvd So. Date: 3-5-71
Contractor _____ Permit No. _____
Lot _____ Block _____ Subdivision _____

Electric Only	Plumbing Only	Heat & Vent. A. C. Only
Contractor _____	Contractor <u>ACE Plng</u>	Contractor _____
Permit No. _____	Permit No. <u>32794</u>	Permit No. _____
Slab _____	Rough Soil _____	A. C. Rough Duct _____
Rough Elect _____	Rough Water _____	Ref. Ro. Piping _____
Final Rough _____	Top Out _____	Rough Gas _____
Final Fixture _____	Rough Gas _____	Final Refrig _____
Final Elec _____	Final Plbg. <u>11/18-71</u>	Final Air Cond _____
Temp. Service _____	Final Gas _____	Final Gas _____
	Final Sewer _____	
	Final-Septic Tank _____	

23.06 D Address 625 L. V. Blvd So. Log No. plmg Area _____

DEPT. of BLDG & SAFETY - CITY of LAS VEGAS, NEVADA

OWNER Hortense McKiernan ADDRESS 625 L. V. B. S. DATE 6-8-65
 GEN CONT Las Vegas Roofing TYPE OF STRUCTURE roof repair
 PERMIT NO. 30572 LEGAL DESCRIPTION Lot 13-14 Blk 24 South Addn

BUILDING	MECHANICAL	ELECTRICAL
LOCATION _____	PLUMBING CONT. _____	TEMP. POLE CONT. _____
FIREPLACE FTE. _____	PERMIT NO. _____ DATE _____	PERMIT NO. _____ DATE _____
FOOTINGS _____	HEAT & VENT. AC CONT. _____	INSPECTION _____ DATE _____
FOUNDATION WALL _____	PERMIT NO. _____ DATE _____	ELECTRICAL CONT. _____
FLOOR FRAMING _____	SEWER CONT. _____	PERMIT NO. _____ DATE _____
SLAB _____	PERMIT NO. _____ DATE _____	FIXTURES CONT. _____
CHIMNEY STEEL (FIREPLACE) _____	ROUGH SOIL _____	PERMIT NO. _____ DATE _____
WALL STEEL _____	ROUGH WATER _____	SLAB _____
COLUMN STEEL _____	TOP-OUT _____	ROUGH _____
BEAM STEEL _____	ROUGH GAS _____	FINAL ROUGH _____
FRAMING _____	AC ROUGH DUCT _____	FINAL FIXTURE _____
ROOF SHEATHING _____	NER ROUGH PIPING _____	FINAL ELECTRICAL _____
INTERIOR _____	FINAL PLUMBING _____	TEMPORARY SERVICE _____
EXTERIOR _____	FINAL GAS _____	
DRYWALL _____	FINAL AIR COND. _____	
LATHING _____	FINAL REFRIG. _____	
BACKING (SIDING) _____	FINAL SEWER _____	
PLASTER SCRATCH _____	FINAL SEPTIC TANK _____	
BROWN _____		
URBAN REDEVELOPMENT APPROVAL _____		
FINAL BLDG <u>6/13</u> DATE <u>6-23-65</u>		

INSPECTOR _____ DATE _____

APPROVED FOR OCCUPANCY & METER _____

PLEASE NOTE REMARKS ON REVERSE SHEET

625 L. V. B. S.

Dona Kocak

6-20-83

BUILDING DEPARTMENT
CITY OF LAS VEGAS

CORRECTION NOTICE

EL CHALO REST.

Job Located at *625 LVB 50.*

I have this day inspected this structure and these premises and have found the following violations of City and/or State laws governing same:

SEATING EXCEEDS LEGAL LIMITS ALLOWED BY UBC SEC 3301 AND TABLE 33A.

(OVER)

LEGAL OCCUPANT LOAD IS 60. EXCESS TABLES + CHAIRS ARE TO BE REMOVED.

ALSO OCCUPANT LOAD EXCEEDS 50 AND THEREFORE REQUIRES SECOND EXIT OTHER THAN THROUGH KITCHEN.

COMPLY BY 6-27-83
You are hereby notified to correct above violation and call for re-inspection.

Date *5-25-83* *Gene Nedevink*
Inspector

23.03 Do not remove this tag! *6-7-83*

OWNER WILL REMOVE
 TABLES & CHAIRS TO
 REDUCE ACTUAL OCC.
 LOAD TO LESS THAN
 50. WHEN BUSINESS
 PICKS UP THEY WILL
 BE REQUIRED TO
 PROVIDE ONE (1) OTHER
 EXMT.

Gene

REG. SUP. 13 CLV

APPROVED AND 88-722

Dona Noelle

6-20-83

625 AVBS

El Cholo Cafe
Famous Mexican Food
625 Las Vegas Blvd. So.
LAS VEGAS, NEVADA
Roberto Gomez
Alfredo Gomez
382-4273



June 9, 1983

Clay Hymer, Director
Dept. of Building & Safety
City of Las Vegas

Dear Sir:

As requested, I will eliminate the seating and the occupant load will not exceed 50 seats. This will be done by taking out 10 seats as per our conversation Monday, June 6. This will then put the cafe in compliance with UBC Sec. 3301, Table 33A legal occupant load.

It is our understanding that later on as business increases we can install more seating provided that we put in a second exit in the dining room.

Very truly yours,

ROBERT GOMEZ

A handwritten signature in black ink, appearing to read 'Roberto Gomez', written over the typed name.

RG/hm
cc/file

Gene Hooley

9-21-83

"RETROFIT" ORDINANCE SURVEY

BUILDING ADDRESS 625 L.V. Blvd. S. BUILDING NAME El Cholo
 D.B.A. El Cholo SUITE NO. _____
 TELEPHONE NUMBER 382-4273
 BUILDING TYPE Restaurant UNITS _____
 (Motel/Hotel/Apartments) _____
 BUILDING HEIGHT (Feet) 14 (Stories) 1 1800 ft
 OWNER Alfred & Bobby Gomez
 OWNER ADDRESS 3411 OWNER TELEPHONE 451-9107
 INSPECTION DATE 4/22/83 INSPECTOR V. White
 RECEIVED BY _____ TITLE owner/mgr
 REMARKS no requirements

Complete 6-9-83

ALFRED & BOBBY GOMEZ

OWNER SHALL FURNISH PLANS FOR COMPLIANCE WITHIN SIX (6) MONTHS OF SURVEY AND COMPLETE COMPLIANCE BY JUNE 14, 1984.
 (Date)

OWNER SHALL HAVE A STATE AND CITY LICENSED CONTRACTOR PERFORM CORRECTIONS AFTER SECURING PERMITS FROM THE CITY OF LAS VEGAS DEPARTMENT OF BUILDING & SAFETY, 386-6251, AND DEPARTMENT OF FIRE SERVICES, 386-6361, AS REQUIRED.

ANY BUILDING (EXCEPT SINGLE FAMILY DWELLINGS AND DUPLEXES)

- Emergency lighting at each interior corridor or other exit(s)
- Approved door closures when corridor serves occupant load of 30 or more
- Adequate exits must be provided immediately.

ANY 3-STORY BUILDING

- Enclose open stairways or vertical shafts

HOTEL/MOTEL (WHICH HAS 3 STORIES OR MORE WITH 20 UNITS OR MORE) APARTMENT/CONDOMINIUM (WHICH HAS 3 STORIES OR MORE WITH 15 UNITS OR MORE) ANY OFFICE BUILDING (3 STORIES OR MORE)

- Fire alarms per 1979 U.B.C., 1202 B, Para. 2, Ord. 2077 City of Las Vegas

HOTEL/MOTEL (WITH 6 UNITS OR MORE) APARTMENT (WITH 3 UNITS OR MORE)

- Battery or permanently wired smoke detectors in each room primarily used for sleeping
- Seal all openings from corridor which supplies air to a room or dwelling unit

CONDOMINIUM (WITH 3 UNITS OR MORE)

- Seal all openings from corridor which supplies air to a room or dwelling unit

55 FEET HOTEL, MOTEL, OFFICE, APARTMENT OR CONDOMINIUM

- Corridor sprinklers per Senate Retrofit Bill 214
- 1 Sprinkler at roomside of corridor door, condominiums exempted
- Elevator recall per 1978 ANSI A17.1 and 1981 211.3
- Floor number posted in stairwell at each floor and every lobby adjacent to elevator
- Have ventilation/air conditioning automatic shut-off per 1979 U.M.C., 1009, and smoke detectors per 1978 N.F.P.A. 90A
- Evacuation route posted in sleeping room, condominiums exempted
- Install vocal paging alarm, system conforming to State of Nevada Fire Marshal Regulations, condominiums exempted
- Install 80-decible vocal and instruction alarm at condominium common areas
- Helicopter landing authorization required

PUBLIC ASSEMBLY

- Install sprinklers in rooms of 5,000 square feet or larger when within a 12,000 square feet or larger structure
- Finishes per 1979 U.B.C., Chapter 42, in 300-occupant or more assembly room

RECOMMEND: "DO NOT USE ELEVATOR IN CASE OF EMERGENCY" SIGN IN EVERY ELEVATOR LOBBY EXCEPT GROUND FLOOR.

REQUIRED =
 NO REQUIREMENT = REQUIREMENT SATISFIED =

Gene Hooley

9-21-83

BOOTHS 32 =
TABLES 46 =

78

TOTAL 30x60 = 1800 sq ft

DINING 30x30 = 900 sq ft

OCCUPANCY @ 15 # PER = 60

KITCHEN @ 200 # PER = 9

TOTAL OCCUPANCY = 69

15) 900
60

50

Gene Hooley

9-27-83

BUILDING DEPARTMENT
CITY OF LAS VEGAS

CORRECTION NOTICE

EL CHALO REST.

Job Located at 625 LVB 50.

I have this day inspected this structure and these premises and have found the following violations of City and/or State laws governing same:

SEATING EXCEEDS LEGAL LIMITS ALLOWED BY UBC SEC 3301 AND TABLE 33A.

LEGAL OCCUPANT LOAD IS 60. EXCESS TABLES + CHAIRS ARE TO BE REMOVED.

ALSO - OCCUPANT LOAD EXCEEDS 50 AND THEREFORE REQUIRES SECOND EXIT OTHER THAN THROUGH KITCHEN.

COMPLY BY 6-27-83

You are hereby notified to correct above violation and call for re-inspection.

Date 5-25-83

Jim Madenick
Inspector

23.03

Do not remove this tag!

6-7-83

Done Hooley

9-22-83

CITY OF LAS VEGAS

INTER-OFFICE MEMORANDUM

Date

June 6, 1983

TO:

NED BARKER, FIRE MARSHAL
DEPARTMENT OF FIRE SERVICES

FROM:

Clay Hymer
CLAY HYMER, DIRECTOR
DEPARTMENT OF BUILDING AND SAFETY

SUBJECT:

EL CHOLO CAFE
625 LAS VEGAS BOULEVARD SOUTH

COPIES TO:

REE SWING
GENE FREDERICK

Mr. Gomez, owner of the property listed above, met with me on June 6, 1983, to discuss insufficient exiting in his structure. The occupant load was determined as exceeding fifty and two exits swinging outward were necessary for compliance to code.

However, due to the economic situation at the present time, and after having viewed a profit and loss statement provided by Mr. Gomez which clearly indicated a \$3,100 loss the last year, he has decided to remove seating and maintain an occupant load under fifty which will allow additional room for wider aisles, thereby coming under conformance of the code with only one exit. Mr. Gomez will provide this department with a letter of such conditions and has been made aware that if his business gets better and more seating is installed, then another exit will be necessary.

CH:sd

CLV 7007

Gomez Hoesly

9-21-83

El Cholo Cafe
Famous Mexican Food
625 Las Vegas Blvd. So.
LAS VEGAS, NEVADA
Roberto Gomez
Alfreda Gomez
382-4273



June 9, 1983

Clay Hymer, Director
Dept. of Building & Safety
City of Las Vegas

Dear Sir:

As requested, I will eliminate the seating and the occupant load will not exceed 50 seats. This will be done by taking out 10 seats as per our conversation Monday, June 6. This will then put the cafe in compliance with UBC Sec. 3301, Table 33A legal occupant load.

It is our understanding that later on as business increases we can install more seating provided that we put in a second exit in the dining room.

Very truly yours,

ROBERT GOMEZ

A handwritten signature in black ink, appearing to read "Roberto Gomez", written over the typed name.

RG/hm
cc/file

Donna Hooley 3-27-84

CITY OF LAS VEGAS, NEVADA

LOG NO. & AREA _____ DATE _____ CONST. VAL. \$ _____

DEPARTMENT OF BUILDING AND SAFETY
PHONE 386-6251

PLUMBING PERMIT

ADDRESS OF CONSTRUCTION 625 Las Vegas Blvd So. OWNER El Cholo Cafe

CONTRACTOR BAKE STATEWIDE FIRE PROTECTION, INC. STATE LICENSE NO. 012259 A CITY LICENSE NO. C 11381212653

LOT(S) _____ BLOCK _____ SUBDIVISION _____ ZONE _____

PROPOSED CONSTRUCTION:

PLUMBING PERMIT NO. 3182

USE: _____

Approval for the work under this permit will be given only after refuse and debris have been removed from job site and public right of way.

UNITS	DESCRIPTION	FEE	TOTAL
PERMIT ISSUANCE			
	For Issuing Each Permit	10.00	<i>10.00</i>
	For Issuing Each Supplemental Permit	4.50	
FIXTURE CHARGE			
	Bathub, Shower, Lavatory, Toilet, Urinal	EA. 2.00	
	Floor Drain, Floor Sink, Wash Tray, Sink	EA. 2.00	
	Garbage Disposal, Clothes Washer, Dishwasher (residential)	EA. 2.00	
	Garbage Disposal (commercial)	EA. 8.00	
	Clothes Washer, Dishwasher (commercial)	EA. 2.00	
	Clothes Dryer (gas) (venting)	2.00	
	Dental Unit	8.00	
	Drinking Fountain	2.00	
	Refrigerator - Ice Maker, Water Dispenser	2.00	
	Any other water using equipment, Attached Coffee Makers, Ice Makers	2.00	
	Hot Water Heater (Gas or Electric)	EA. 2.00	
SEWER SYSTEM			
	New, Replacement, Modification, or Any Drainage Work	10.00	
	Grease or Sand Trap or Interceptor	2.00	
	Trailer Trap (rental parks)	5.00	
WATER SOFTENERS			
	Non Permanent Type (rental)	2.00	
	Permanent Type (connected to drain)	2.00	
SWIMMING POOLS			
	Private or Wading Pool (including spa)	20.00	
	Public or Semi-Public	30.00	
	Spas - Preformed (private)	10.00	
	Spas - Preformed (commercial)	20.00	
WATER DISTRIBUTION SYSTEM			
	Single Family Dwelling	6.00	
	Multi-Family Dwelling	6.00	
	Plus Each Dwelling Unit	3.00	
	Commercial Building per floor	3.00	
	Plus Each Unit (leased space or office)	2.00	
	Hotel or Motel	8.00	
	Plus Each Unit	3.00	
	Trailer Park	30.00	
	Plus Each Space	2.00	
	Irrigation	8.00	
FUEL PIPING SYSTEM			
	Single Family Dwelling	6.00	
	Multi-Family Dwelling	10.00	
	Plus Each Unit	2.00	
	Commercial Building (per floor)	6.00	
	Plus Each Unit (leased space or office)	6.00	

UNITS	DESCRIPTION	FEE	TOTAL
	Medium Pressure Gas System (plan check)	12.00	
	Each Gas Appliance (any type)	2.00	
	Standby Emergency (generating engines)	5.00	
	Steam Boilers	5.00	
	Service Station Fuel Tank and Piping System	10.00	
	Fuel Tanks (each)	10.00	
AUTOMATIC FIRE EXTINGUISHING SYSTEM			
	Underground Piping	20.00	
	Distribution Piping (per foot)	05	
	Sprinkler Head (each)	20	
	In Range Hood and Vent	10.00	
	Dry Standpipe System		
	Piping	75.00	
	Each Outlet	2.00	
	Wet Standpipe System		
	Piping	10.00	
	Fire Hose Cabinet	2.00	
SOLAR ENERGY SYSTEMS			
	Collectors (including piping) (per collector)	5.00	
	Storage Tanks (each)	5.00	
PIPELINE CONTRACT			
	For Onsite Sewer, Gas or Water Contract Value Fee based on Building Code Permit Valuation Chart.	20.00	
	STI	20.00	
OTHER INSPECTIONS AND FEES			
	Inspections outside of normal business hours (minimum charge—three hours)	25.00	
	Reinspection fee assessed under provisions of TABLE 5.1.1.1. Uniform Building Code, 2008, EACH REVISION WHICH MUST BE SUBMITTED AND INDICATED (minimum charge—three hours)	15.00	
	Additional plan review required by the City of Las Vegas (minimum charge two hours)	20.00	

FORWARD ONE COPY TO THE FIRE DEPARTMENT

I hereby certify that I have carefully examined and read the above application, that the same is true and correct; and that the work herein described is to be done in accordance with all the provisions of the applicable Ordinances of the City of Las Vegas, Nevada and the State Laws, whether herein specified or not.

SIGNED John Roscigno Statewide Fire Protection, CONTRACTOR MASTER CARD NO. _____
 BY Edward Henrich Registered Master Plumber, Spec. Contr. or Owner
 BUILDING DEPT. MA DATE 3/23/84

Plumbing permit fees may be computed the same as building permit fees by using the cost of installation for valuation amount when such work is not included in the above schedule.

SEWER CONNECTION

FIXTURES X

FEE _____

PERMIT FEE \$20.00

TOTAL FEES _____

RECEIPT

MUST BE MACHINE VALIDATED

Marionne Francis

5-17-84

OWNER		ELEC. ONLY PLBG. ONLY, A.C. ONLY		DATE
ADDRESS		El Paso Cafe		5-3-84
CONTRACTOR		225 2715 S		
LOT	BLOCK	PERMIT NO.	SUBDIVISION	
LOG NO.	AREA		FINAL INSPECTION	
ELECTRIC ONLY		PLUMBING ONLY		
Contractor		Contractor	Shank & Fire	
Permit No.		Permit No.	3182	
Rough Elec.		Rough Soil		
Final Rough		Rough Water		
Final Elec.		Top Out		
Temp. Service		Rough Gas		
HEAT & VENT. A/C ONLY		Final Plbg.		
Contractor		Final Gas		
Permit No.		Sewer Final		
A/C Rough Duct		Final Bldg	105-3-84	
Rough Gas				
Final A/C				
Final Gas				

79-3-13 (11-81) DEPT. OF BLDG. & SAFETY CITY OF LAS VEGAS