

2302 S. 15th ST.

Theresa K. Quakes 9-29-80

CITY OF LAS VEGAS, NEVADA
DEPARTMENT OF BUILDING & SAFETY

PERMIT FEE \$ _____
APPLICATION & PERMIT FOR PLUMBING

JOB ADDRESS: 2302 S 15th

OWNER'S NAME: Pardew Phillips

LOT _____ BLOCK _____ SUBDIVISION _____ Bldg. type: SFD APT COMM

Circle: New bldg; Old bldg; Add'n; Remodel; Pool; Wtr. Sftner; Lawn Sprkr; Other

CONTRACTOR: Sturley Plbg & Htg

State Lic. # 7119 City Lic. # 910

QUANTITY	FIXTURE OR INSTALLATION	Unit Price	AMOUNT
	Bathtub	1.00	
	Clothes dryer (gas)	1.00	
	Clothes washer	1.00	
	Dental unit	1.00	
	Dishwasher	1.00	
	Drinking fountain	1.00	
	Fire sprinkling - underground piping	5.00	
	Fire sprinkling - distribution piping per each foot	.01	
	Fire sprinkling heads - per each head	.10	
	Floor drain \$1.00 Floor sink	1.00	
	Gas appliance (any type)	1.00	
	Gas piping system - single family dwelling	3.00	
	Gas piping system - multiple family \$3 per each unit plus	1.00	
	Gas piping system - commercial bldg. per each floor	3.00	4.00
	Grease trap	1.00	
	Irrigation system	4.00	
	Lavatory	1.00	
	Minimum fee for any permit	4.00	
	Piping, Drainage	4.00	
	Sewer replacement	4.00	
	Septic disposal system - Health Dept. approval required	4.00	
	Shower	1.00	
	Sink - kitchen type	1.00	
	Swimming pool - private - wading pool	8.00	
	Swimming pool - public - semi-public	12.00	
	Toilet	1.00	
	Urinal	1.00	
	Water distribution system, single family dwelling	4.00	
	Water distribution system multiple dwg. \$4 + each unit	1.00	
	Water distribution system, Group "A" thru "G" per each floor	4.00	
	Water distribution system, Group "H" (hotel) \$4 + per bath*	.50	
	Water heater (gas) (electric)	1.00	
	Water using equipment	1.00	
	Water softener nonpermanent type	4.00	
	Water softener permanent (connected to drainage)	5.00	
	Wash tray	1.00	

I hereby certify that I have carefully examined & read the above application; that the same is true & correct; and the work herein described is to be done in accordance with the provisions of City of Las Vegas Ordinances & State Laws, whether herein specified or not. As defined in City Code and Ordinances.

SIGNED: [Signature] Date: 4/4/67
Registered Plumber, Spec. Contr., Owner.

Engineering Dept. Date _____ Building Department Date _____
Sewer Conn. Fees _____
Paid in Engr. Dept. PERMIT NO 20799 PERMIT FEE \$ 4.00
23.10 #1287

TOTAL FEE \$ 4.00

RECEIPT
784 \$000.00 - 7
CITY OF LAS VEGAS
DEPT. OF BUILDING & SAFETY
Must be machine validated
- 5 APR 67

Theresa Kynakas 9-29-80

CITY OF LAS VEGAS, NEVADA

LOG NO. & AREA

CONST. VAL. \$ 132.00

DEPARTMENT OF BUILDING & SAFETY

APPLICATION & BUILDING PERMIT — for:
Fence, Wall, Retaining Wall.

ADDRESS OF CONSTRUCTION:

2300 / 4 2302 SA 15th ST

OWNER: Woodrow D. RAUSCH

LOT(s)

19

BLOCK

7

SUBDIVISION

Plants at Park West

ZONE:

R-2

Materials of Construction:

Block

Concrete

Wire

Wood

Other

Yes No

ARCHITECT:

ENGINEER:

PLANS:

CALCS:

CONTRACTOR:

McKinley Enterprises

STATE LICENSE #

7263 B

CITY LICENSE #

698-03178

TOTAL SQUARE FEET: 0

TOTAL LINEAL FEET: 0

Remarks:

Duplex APTS.

CONDITIONS OF THE PERMIT:

1. Any type of retaining wall must be engineered by a Civil or Structural Engineer.
2. If a home owner takes out the Building Permit and if the owner sublets the work to a Contractor, then the Contractor must take out the permit and pay for it.
3. No fence or wall can be built on City property or rights-of-way, but this is not intended to preclude construction within utility easements if utilities will not be damaged or made inaccessible.
4. The fence or wall shall not enclose any water meter, light standard, or fire alarm box and shall not come closer than 24" from the nearest fire hydrant outlet.
5. Department Inspectors must approve footings before concrete is poured and block wall reinforcing before grouting is done.
6. Maximum height of any wall or fence is 6', side and rear yards; 4' maximum in front yard with the vertical surface above the height of 2' — 50% open and further that fencing within 25' of the intersection of curb faces on corner and through lots is limited to a maximum height of 30".
7. I must not obstruct required onsite parking space (space for each dwelling unit) by the erection of this fence or wall.
8. By the signing of this application I herewith agree to the requirements outlined above.

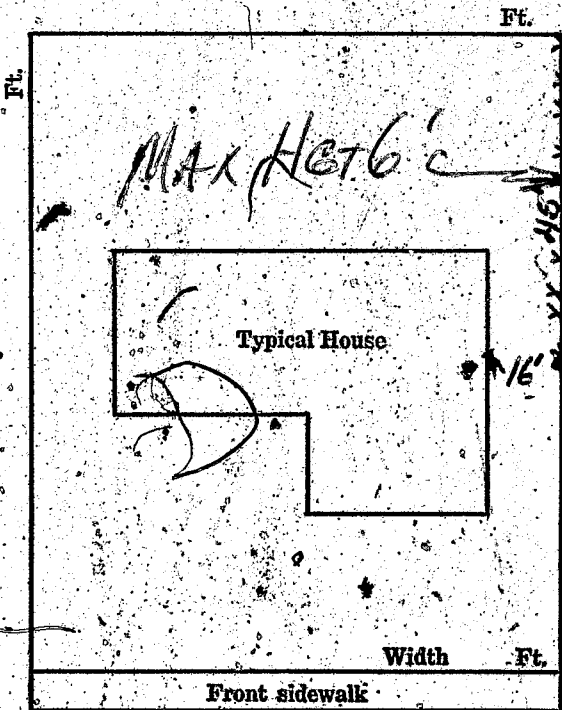

SIGNED:

McKinley Enterprises CONTRACTOR AGENT OWNER

DATE: 4/14/70

PLANNING DEPT: M.C.

Date: 4/14/70

ENGINEERING DEPT:

Date:

BUILDING DEPT: G. U. Smith

Date: 4-15-70

#1285

PERMIT NO: 52687

PERMIT FEE \$ 5.00

RECEIPT

2892 \$005.00 - 8

CITY OF LAS VEGAS
DEPT. OF
BUILDING & SAFETY

MUST BE MACHINE VALIDATED

15 APR 70

Donna Hooley

9-8-82

CITY OF LAS VEGAS, NEVADA

DEPARTMENT OF BUILDING AND SAFETY - ELECTRICAL APPLICATION & PERMIT

ADDRESS OF CONSTRUCTION: 2302 So 15th PHONE NO. _____
 OWNER'S NAME: Stewart Jack
 CIRCLE: Addition; Remodel; New Bldg. TYPE OF BLDG.: SFD APT. COMM. PUBLIC
 CONTRACTOR'S NAME: Owner STATE: NV CITY: _____ LICENSE # _____

UNITS	DESCRIPTION	FEE	TOTAL
PERMIT ISSUANCE			
1	For Issuing Each Permit	10.00	10.00
	Supplemental Fee	4.50	
APPLIANCE CHARGE			
	Receptacle Switch	.40	
	Each Light Fixture or Socket	.30	
	EACH OUTLET FOR: Dishwasher, Garbage Grinder, Trash Compactor, G.F.L., Clothes Washer, Dryer, Electric Range, Ovens, Smoke Detector, Special Purpose, Water Heater, Space Heater, Blast Coil Heater (PER K.W.), Mercury Lamp, Quartz Lamp, Sodium Lamp	.70	
	X-Ray Unit	10.00	
	Area Lighting (First 3,000 Watts)	8.00	
	Each Additional 1,000 Watts	3.00	
	Motors (1/2 H.P. And Over) Transformers Welders, Generators		
	First H.P. For each Unit	3.00	
	First KVA For Each Unit	.50	
	Each Additional H.P. or KVA	.20	
	Temporary Power or Pole	6.00	
	Electric Service (Incl'd First Meter) Up to 200 AMP	6.00	6.00
	400 AMP And 600 AMP	12.50	
	Over 600 AMP To 4200 AMP	25.00	
	Over 1200 AMP	50.00	
	Each Additional Meter Socket	.50	

UNITS	DESCRIPTION	FEE	TOTAL
1	Sub Panel (Each)	3.00	
	Swimming Pool (Residential)	20.00	
	Swimming Pool (Semi-Public)	30.00	
	Spas	8.00	
	Recreational Vehicle Spaces (Each)	3.00	
	Busways-Trolley or Plug-in (Ea. 100 Ft.)	3.00	
	All Misc. Electric		
1	Permanent A/C Unit (Pkg. Units)	3.00	3.00
	Each Air Handler	1.00	
LOW VOLTAGE INSTALLATIONS			
	Speaker Outlets (Each)	.30	
	Signal or Alarm Outlets (Each)	.30	
	Amplifiers	2.00	
	Control Panel	.50	
	TV Master System	.30	
	Telephone or Computer Outlet	.30	
	Starter Permit		
	Contract Price or Cost of Installation		
	Misc.		
CONDUIT ONLY			
	TOTAL PERMIT FEE \$	18.00	

Electrical permit fees may be computed the same as building permit fees by using the cost of installation for valuation amount when such work is not included in the above schedule.

FOR BUILDING DEPARTMENT USE ONLY

Plans submitted: yes no
 Received by PAC: _____ Date: _____
 Review by Plans Check: _____ Date: _____
 Issued by: _____ Date: _____
 Check Cash

Occupancy type:	Type of Construction	11.00	11.00
Valuation (declared) \$	Fee calculated	7.00	7.00
Other Fees (226)	Total Fees	18.00	18.00

11.00 Square
 ELE Footage 19.00
 A/C \$ 16.00
 STL \$ 35.00
 TOTL \$ 35.00
 CHEK \$ 35.00
 R#3153 SR#001/01

- Other inspections and fees:
 1. Inspections outside of normal business hours = \$25.00 per hour (minimum charge two hours).
 2. Re-inspection fee during normal business hours assessed under provisions of TABLE 3-A of the Uniform Building Code = \$15.00 per hour.
 3. Inspections during normal business hours for which no fee is specifically indicated = \$15.00 per hour (minimum charge one half hour).
 4. Additional plan review required by changes, additions or revisions to approved plans = \$15.00 per hour (minimum charge one half hour).
 5. Expires 180 days after abandonment of work.

Approval for the work under this permit will be given only after refuse and debris have been removed from jobsite and outside of way.

09/30/82
 RECEIPT

I hereby certify that I have carefully examined and read the above application; that the same is true and correct; and that the work herein described is to be done in accordance with all provisions of the applicable Ordinances of the City of Las Vegas, Nevada and the State Laws, whether herein specified or not. City Master Card No. _____

SIGNED Jack Stewart Date _____
 Master (Electrician) (Technician) (Owner)

BUILDING DIVISION _____ Date _____

PERMIT NO. 3153 PERMIT FEE \$ 18.00

Longfield 9-8-82

CITY OF LAS VEGAS, NEVADA

DEPARTMENT OF BUILDING AND SAFETY - AIR CONDITIONING APPLICATION & PERMIT

ADDRESS OF CONSTRUCTION: 2302 So 15th

PHONE NO. _____

OWNER'S NAME: Jack Stewart

CIRCLE: Addition, Remodel, New Bldg. TYPE OF BLDG.: SFD APT. COMM. PUBLIC

CONTRACTOR'S NAME: owner

STATE LICENSE # _____ CITY LICENSE # _____

UNITS	DESCRIPTION	FEE	TOTAL
PERMIT ISSUANCE			
1	For the issuance of each permit.	10.00	<u>10.00</u>
	For issuing each supplemental permit.	3.00	
UNIT FEE SCHEDULE			
	For the installation or relocation of each forced-air or gravity-type furnace or burner, including ducts and vents attached to such appliance, up to and including 100,000 Btu/h.	6.00	
	For the installation or relocation of each forced-air or gravity-type furnace or burner, including ducts and vents attached to such appliance over 100,000 Btu/h.	7.50	
	For the installation or relocation of each floor furnace, including vent.	6.00	
	For the installation or relocation of each suspended heater, recessed wall heater or floor-mounted unit heater.	6.00	
	For the installation, relocation or replacement of each appliance vent installed and not included in an appliance permit.	3.00	
	For the repair of, alteration of, or addition to each heating appliance, refrigeration unit, cooling unit, absorption unit, or each heating, cooling, absorption, or evaporative cooling system, including installation of controls regulated by this code.	6.00	
1	For the installation or relocation of each boiler or compressor, to and including three horsepower, or each absorption system to and including 100,000 Btu/h.	6.00	<u>6.00</u>
	For the installation or relocation of each boiler or compressor over three horsepower to and including 15 horsepower, or each absorption system over 100,000 Btu/h and including 500,000 Btu/h.	11.00	
	For the installation or relocation of each boiler or compressor over 15 horsepower to and including 50 horsepower, or for each absorption system over 500,000 Btu/h to and including 1,000,000 Btu/h.	15.00	
	For the installation or relocation of each boiler or compressor over 30 horsepower to and including 50 horsepower, or for each absorption system over 1,000,000 Btu/h to and including 1,750,000 Btu/h.	22.50	
	For the installation or relocation of each boiler or refrigeration compressor over 50 horsepower, or each absorption system over 1,750,000 Btu/h.	37.50	

UNITS	DESCRIPTION	FEE	TOTAL
	For each air-handling unit to and including 10,000 cubic feet per minute, including ducts attached thereto. <i>Note: This fee shall not apply to an air-handling unit which is a portion of a factory-assembled appliance, cooling unit, evaporative cooler or absorption unit for which a permit is required elsewhere in this code.</i>	4.50	
	For each air-handling unit over 10,000 cfm.	7.50	
	For each evaporative cooler other than portable type.	4.50	
	For each ventilation fan connected to a single duct.	3.00	
	For each ventilation system which is not a portion of any heating or air-conditioning system authorized by a permit.	4.50	
	For the installation of each hood which is served by mechanical exhaust, including the ducts for such hood.	4.50	
	No. of openings		
	Ductwork		
	For each appliance or piece of equipment regulated by this code but not classed in other appliance categories, or for which no other fee is listed in this code.	4.50	
	When Chapter 22 is applicable (see Section 103), permit fees for fuel-gas piping shall be as follows: For each gas-piping system of one to four outlets. For each gas-piping system of more than four outlets, per outlet.	2.00	
	For each gas-piping system of more than four outlets, per outlet.	.50	
OTHER INSPECTIONS AND FEES:			
	Inspections outside of normal business hours (minimum charge - two hours).	15.00 per hour	
	Reinspection fee, assessed under provisions of Section 305 (1).	15.00 each	
	Inspections for which no fee is specifically indicated (minimum charge - one-half hour).	15.00 per hour	
	Additional plan review required by changes, additions or revisions to approved plans (minimum charge - one-half hour).	15.00 per hour	
	Misc.		
	TOTAL PERMIT FEE \$ <u>16.00</u>		

Mechanical permit fees may be computed the same as building permit fees by using the cost of installation for valuation amount when such work is not included in the above schedule. I hereby certify that I have carefully examined and read the above application; that the same is true and correct; and that the work herein described is to be done in accordance with all the provisions of the applicable Ordinances of the City of Las Vegas, Nevada and the State Laws, whether herein specified or not.

Approval for the work under this permit will be given only after refuse and debris have been removed from job site and public right-of-way.

SIGNED Jack Stewart City Master Card No. _____ Date _____
Air Conditioning Contractor - Owner

BUILDING DIVISION lu Date _____

PERMIT NO. 3153-1 PERMIT FEE \$ 16.00

RECEIPT

Dona Healy

2-24-84

DEPARTMENT OF BUILDING & SAFETY
CITY OF LAS VEGAS, NEVADA

KARDEX CARD
FENCE & RETAINING
WALLS

OWNER W. Rainbolt ADDRESS 2300 & 2302 So 15th DATE 4-15-70

CONTRACTOR McKinley Enterprises PERMIT NO. 52687

LOT 19 BLOCK 7 SUBDIVISION Francisco Park # 1 wire fence

Fence (wire, wood, etc.)		Walls (masonry, rock, etc.)	
Location _____	Location _____	Footings _____	Footings _____
Final Inspection <u>Sept 16, 70</u>	Final Inspection _____	Wall Steel 1st _____ 2d _____ 3d _____	Wall Steel 1st _____ 2d _____ 3d _____
Retaining Wall (masonry)		Retaining Wall (concrete)	
Location _____	Location _____	Footings _____	Footings _____
Wall Steel 1st _____ 2d _____ 3d _____	Wall Steel 1st _____ 2d _____ 3d _____	Bond Beam 1st _____ 2d _____ 3d _____	Final Inspection _____
Final Inspection _____	Final Inspection _____		

23.14 B ADDRESS 2300 & 2302 So 15th St. LOG NO. 7 AREA _____

ELEC. ONLY PLBG. ONLY, A.C. ONLY	
OWNER <u>Stewart</u>	DATE <u>9-2-82</u>
ADDRESS <u>2302 So 15th</u>	
CONTRACTOR _____	PERMIT NO. <u>3153</u>
LOT _____	FINAL INSPECTION _____
BLOCK _____	
SUBDIVISION _____	
LOG NO. _____	AREA _____
ELECTRIC ONLY	
Contractor <u>Owner</u>	Contractor _____
Permit No. <u>3153</u>	Permit No. _____
Rough Elec. _____	Rough Soil _____
Final Rough _____	Rough Water _____
Final A/C <u>9-9-82</u>	Top Out _____
Temp. Service _____	Rough Gas _____
HEAT & VENT. A/C-ONLY	
Contractor <u>Owner</u>	Final Plbg. _____
Permit No. <u>3153-1</u>	Final Gas _____
A/C Rough Duct _____	Sewer Final _____
Rough Gas _____	
Final A/C <u>12-13-83</u>	
Final Gas _____	
79-3-15 (811-81) DEPT. OF BLDG. & SAFETY CITY OF LAS VEGAS	

Dona Hoels

2-24-84

Department of Building & Safety
City of Las Vegas, Nevada

Special Kardex
Elec. only, Plbg. only, A.C. only

Owner Pardee Phillips Address 2302 S. 15th St. Date: 4/1/67

Contractor _____ Permit No. _____

Lot _____ Block _____ Subdivision _____

Electric Only	Plumbing Only	Heat & Vent. A. C. Only
Contractor _____	Contractor <u>Sterling</u>	Contractor _____
Permit No. _____	Permit No. <u>20799</u>	Permit No. _____
Slab _____	Rough Soil _____	A.C. Rough duct _____
Rough Elect _____	Rough Water _____	Ref. Ro. Piping _____
Final Rough _____	Top Out _____	Rough Gas _____
Final Fixture _____	Rough Gas _____	Final Refrig _____
Final Elec _____	Final Plbg. _____	Final Air Cond _____
Temp. Service _____	Final Gas <u>Whithead 4567</u>	Final Gas _____
	Final Sewer _____	
	Final Septic Tank _____	

23.06 D Address 2302 S. 15th St. Log No. _____ Area _____