

Thomas R. ... 24 80

CITY OF LAS VEGAS, NEVADA

LOG NO. & AREA _____ CONST. VAL. \$ 94⁰⁰
DEPARTMENT OF BUILDING & SAFETY APPLICATION & BUILDING PERMIT — for:

ADDRESS OF CONSTRUCTION: 309 W 9th OWNER: Bonnie R. Fox
Fence, Wall, Retaining Wall.

LOT(s) 11 BLOCK 17 SUBDIVISION Bucks. Sub. ZONE: R-4

Materials of Construction: Block Concrete Wire Wood Other Yes No
ARCHITECT: owner ENGINEER: _____ PLANS:
CONTRACTOR: _____ STATE LICENSE # _____ CITY LICENSE # _____ CALCS:

TOTAL SQUARE FEET: _____ TOTAL LINEAL FEET: 47'

Remarks:

CONDITIONS OF THE PERMIT:

1. Any type of retaining wall must be engineered by a Civil or Structural Engineer.
2. If a home owner takes out the Building Permit and if the owner sublets the work to a Contractor, then the Contractor must take out the permit and pay for it.
3. No fence or wall can be built on City property or rights-of-way, but this is not intended to preclude construction within utility easements if utilities will not be damaged or made inaccessible.
4. The fence or wall shall not enclose any water meter, light standard, or fire alarm box and shall not come closer than 2' from the nearest fire hydrant outlet.
5. Department Inspectors must approve footings before concrete is poured and block wall reinforcing before grouting is done.
6. Maximum height of any wall or fence is 6', side and rear yards; 4' maximum in front yard with the vertical surface above the height of 2' — 50% open and further that fencing within 25' of the intersection of curb faces on corner and through lots is limited to a maximum height of 30".
7. I must not obstruct required onsite parking space (1 space for each dwelling unit) by the erection of this fence or wall.
8. By the signing of this application I herewith agree to the requirements outlined above.

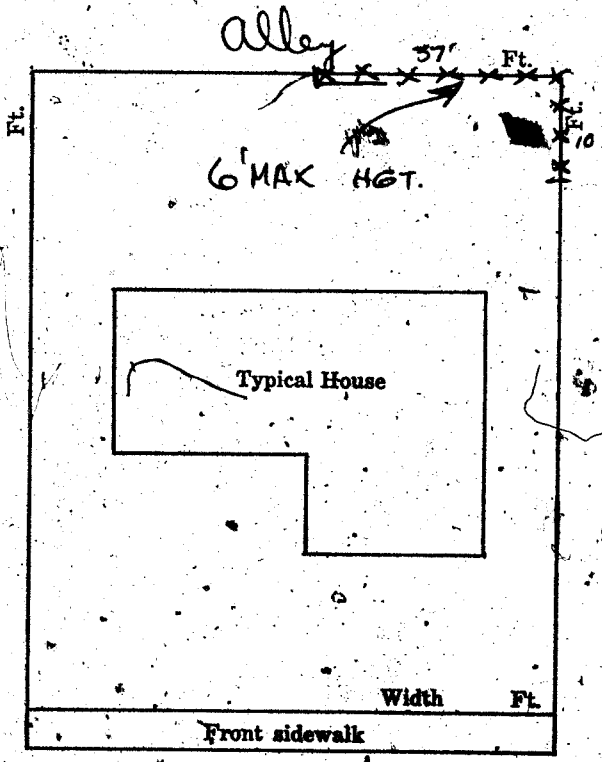

SIGNED: Bonnie R. Fox DATE: 12-10-68
CONTRACTOR AGENT OWNER

PLANNING DEPT: _____ Date: 12-10-68

ENGINEERING DEPT: _____ Date: _____

BUILDING DEPT: G. ... Date: 12-10-68

#1286 PERMIT NO: 45417 PERMIT FEE: 3.00

RECEIPT
8887- \$003.00 - 8
CITY OF LAS VEGAS
DEPT. OF BUILDING & SAFETY
MUST BE MACHINE VALIDATED
10 DEC 68

Theresa Refinings 11-20-80

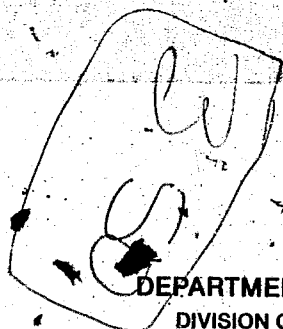

CITY OF LAS VEGAS, NEVADA

DEPARTMENT OF PUBLIC SERVICES—PLUMBING APPLICATION & PERMIT
DIVISION OF BUILDING AND SAFETY

ADDRESS OF CONSTRUCTION: *309 W 9th St*

OWNER'S NAME: *Development & Control*

CIRCLE: Addition; Remodel; New Bldg. TYPE OF BLDG.: SFD (APT) CO. PUBLIC

CONTRACTOR'S NAME: *Metropolitan Plb.* STATE LICENSE # *1547* CITY LICENSE # *18527*

UNITS	DESCRIPTION	FEE	TOTAL
PERMIT ISSUANCE			
	For Issuing Each Permit	10.00	10.00
	For Issuing Each Supplemental Permit	4.50	
FIXTURE CHARGE			
<i>24</i>	Bath Tub	2.00	<i>68.00</i>
	Shower	2.00	
<i>34</i>	Lavatory	2.00	
<i>34</i>	Toilet	2.00	<i>68.00</i>
	Urinal	2.00	<i>68.00</i>
	Floor Drain	2.00	
	Floor Sink	2.00	
	Wash Tray	2.00	
<i>34</i>	Sink	2.00	<i>68.00</i>
	Garbage Disposal (residential)	2.00	
	Garbage Disposal (commercial)	8.00	
	Clothes Dryer (gas) (venting)	2.00	
<i>2</i>	Clothes Washer (residential)	2.00	<i>4.00</i>
	Clothes Washer (commercial)	2.00	
	Dishwasher (residential)	2.00	
<i>L</i>	Dishwasher (commercial)	2.00	
	Dental Unit	2.00	
	Drinking Fountain	2.00	
	Refrigerator, Ice Maker, Water Dispenser	2.00	
	Any other water using equipment, Attached Makers, Ice Makers	2.00	
<i>2</i>	Water Heaters (gas) (electric)	2.00	<i>4.00</i>
SEWER SYSTEM			
	New, Replacement, Modification, or Any Drainage Work	10.00	<i>10.00</i>
	Grease or Sand Trap or Interceptor	2.00	
	Trailer Trap (rental paid)	5.00	
WATER SOFTENERS			
	Non Permanent Type	2.00	
	Permanent Type (connected to drain)	2.00	
SWIMMING POOLS			
	Private or Wading Pool (including spa)	20.00	
	Public or Semi-Private Pool	30.00	
	Spas	10.00	
	Spas (hot tubs)	20.00	
WATER DISTRIBUTION			
<i>34</i>	Single Family Dwelling	6.00	<i>102.00</i>
	Multi-Family Dwelling	6.00	
	Plus Each Dwelling Unit	3.00	
	Commercial Building per floor	3.00	
	Plus Each Unit (leased space or office)	2.00	

UNITS	DESCRIPTION	FEE	TOTAL
	Hotel or Motel	8.00	
	Plus Each Unit	3.00	
	Trailer Park	30.00	
	Plus Each Space	2.00	
	Irrigation	8.00	
FUEL PIPING SYSTEM			
	Single Family Dwelling	6.00	
	Multi-Family Dwelling	10.00	<i>100.00</i>
	Plus Each Unit	2.00	
	Commercial Building (per floor)	6.00	
	Plus Each Unit (leased space or office)	6.00	
	Medium Pressure Gas System (plan check)	12.00	
<i>2</i>	Each Gas Appliance (any type)	2.00	<i>4.00</i>
	Standby Emergency (generating engines)	5.00	
	Steam Boilers	5.00	
	Service Station Fuel Tank and Piping System	10.00	
		10.00	
AUTOMATIC FIRE EXTINGUISHING SYSTEM			
	Underground Piping	20.00	
	Distribution Piping (per foot)	05	
	Sprinkler Head (each)	20	
	In Range Hood and Vent	10.00	
	Dry Standpipe System		
	Piping	75.00	
	Each Outlet	2.00	
	Wet Standpipe System		
	Piping	10.00	
	Fire Hose Cabinet	2.00	
SOLAR ENERGY SYSTEMS			
	Collectors (including piping) (per collector)	5.00	
	Storage Tanks (each)	5.00	
PIPELINE CONTRACT			
	For Onsite Sewer, Gas or Water Contract Value. Fee based on Building Code Permit Valuation Chart.		
	Inspections for which no fee is specifically indicated (minimum charge - one half hour)	15.00	per hour
	Additional plan review required by changes, additions or revisions to approved plans (minimum charge - one half hour)	15.00	per hour

Plumbing permit fees may be computed the same as building permit fees by using the cost of installation for valuation amount when such work is not included in the above schedule.

I hereby certify that I have carefully examined and read the above application; that the same is true and correct; and that the work herein described is to be done in accordance with all the provisions of the applicable Ordinances of the City of Las Vegas, Nevada and the State Laws, whether herein specified or not.

Approval for the work under this permit will be given only after refuse and debris have been removed from job site and public right of way.

SIGNED: *J. G. Barrett* Date: *11-12-80*
Registered Master Plumber, Special Inspector or Owner

BUILDING DIVISION: *RCM* Date: *11-12-80*
6438

PERMIT NO. *6438* PERMIT FEE \$ *416.00*

RECEIPT
CITY OF LAS VEGAS
DIVISION OF BUILDING AND SAFETY

Home *Hooley*

2-16-84

DEPARTMENT OF BUILDING & SAFETY
CITY OF LAS VEGAS, NEVADA

KARDEX CARD
FENCE & RETAINING
WALLS

OWNER omnie Fox ADDRESS 309 N. 9th St. DATE 12/10/68

CONTRACTOR Owner PERMIT NO. 45417

LOT 11 BLOCK 17 SUBDIVISION Bucks Sub
Wire Wood

Fence (wire, wood, etc.)		Walls (masonry, rock, etc.)	
Location _____	Location _____	Location _____	Location _____
Final Inspection <u>AM 3-4-69</u>	Footings _____	Footings _____	Footings _____
	Wall Steel 1st _____ 2d _____ 3d _____	Wall Steel 1st _____ 2d _____ 3d _____	Wall Steel 1st _____ 2d _____ 3d _____
	Final Inspection _____	Final Inspection _____	Final Inspection _____
Retaining (masonry)		Retaining Wall (concrete)	
Location _____	Location _____	Location _____	Location _____
Footings _____	Footings _____	Footings _____	Footings _____
Wall Steel 1st _____ 2a _____ 3d _____	Wall Steel 1st _____ 2d _____ 3d _____	Wall Steel 1st _____ 2d _____ 3d _____	Wall Steel 1st _____ 2d _____ 3d _____
Bond Beam 1st _____ 3d _____	Bond Beam 1st _____ 3d _____	Bond Beam 1st _____ 3d _____	Bond Beam 1st _____ 3d _____
Final Inspection _____	Final Inspection _____	Final Inspection _____	Final Inspection _____

23.14 B

ADDRESS 309 N. 9th St. LOG NO. _____ AREA _____