

230 No. 1st St.

Gloria Caly 9-5-80

CITY OF LAS VEGAS, NEVADA

DEPARTMENT OF BUILDING & SAFETY - APPLICATION AND PERMIT FOR PLUMBING
Ayers Apts

ADDRESS OF CONSTRUCTION: 230 No. 1st St.

OWNER'S NAME: James Pollack

CIRCLE: New Bldg.; Add'n; Remodel; TYPE OF BLDG.: SFD. APT. PUBLIC COMM.

CONTRACTOR'S NAME: Larkin Plbg & Htg Co.

STATE LICENSE # 2041

CITY LICENSE # 914

UNITS	DESCRIPTION	FEE	TOTAL
	Bathtub	1.00	
	Shower	1.00	
	Lavatory	1.00	
	Toilet	1.00	
	Urinal	1.00	
	Floor Drain	1.00	
	Floor Sink	1.00	
	Wash Tray	1.00	
	Sink	1.00	
	Garbage Disposal	1.00	
	Garbage Disposal (comm.)	3.00	
	Clothes Dryer (gas)	1.00	
	Clothes Washer	1.00	
	Clothes Washer (comm.)	5.00	
	Dishwasher	1.00	
	Dishwasher (commercial)	5.00	
	Dental Unit	10.00	
	Drinking Fountain	1.00	
	Any Water using Equipment	1.00	
	Water Heater, (gas, elect.)	1.00	
	Sewer System - New, Replacement, or any Drainage System	4.00	
	Grease or Sand Trap	2.00	
	Trailer Trap	2.00	
	Septic Disposal System	4.00	
WATER SOFTENERS			
	Nonpermanent Type	4.00	
	Permanent Type (connected to Drainage)	5.00	
SWIMMING POOLS			
	Private or Wading Pool	10.00	
	Public or Semi-public	20.00	

UNITS	DESCRIPTION	FEE	TOTAL
WATER DISTRIBUTION SYSTEM			
	Single Family Dwelling	4.00	
	Multiple Family Dwelling plus each unit	4.00 2.00	
	Bldg. Group "A" thru "G" per each floor	6.00	
	Hotel or Motel plus each bath	4.00 1.50	
	Trailer Park plus each space	20.00 1.00	
	Irrigation	4.00	
GAS PIPING SYSTEM			
	Single Family Dwelling	3.00	
I	Multiple Family Dwelling plus each unit	6.00 1.00	6.00
	Commercial Bldg. per floor plus each unit	3.00 3.00	
	Gas Appliance (any type)	1.00	
AUTOMATIC FIRE EXTINGUISHING SYSTEM			
	Underground Piping	10.00	
	Distribution Piping ea. ft.	.01	
	Sprinkler Head each	.10	
	In Range Hood and Vent	5.00	
DRY STANDPIPE SYSTEM			
	Piping	50.00	
	Each Outlet	1.00	
WET STANDPIPE SYSTEM			
	Piping	5.00	
	Fire Hose Cabinet	1.00	
MINIMUM PERMIT FEE 4.00			
PIPELINE CONTRACTOR; SECT. 14-B.P.F. \$			
TOTAL PERMIT FEE \$ 6.00			

I hereby certify that I have carefully examined and read the above application; that the same is true and correct; and that the work herein described is to be done in accordance with all the provisions of the applicable Ordinances of the City of Las Vegas, Nevada and the State Laws, whether herein specified or not.

Signed: *Daniel S. Perkins*
REGISTERED MASTER PLUMBER, SPEC. CONT'R OR OWNER

Date: 11/21/73

Building Department: *J. Miller*

Date: Permit No. 11935 Permit Fee \$ 6.00

#12870

RECEIPT
4513 \$006:00 -- 7
CITY OF LAS VEGAS
DEPT. OF BUILDING & SAFETY
MUST BE MACHINE VALIDATED
27 NOV 73

~~Thomas KYRIAKOS 12 16 80~~

CITY OF LAS VEGAS, NEVADA

CONST. VAL. \$ 816.00

LOG NO. & AREA _____
DEPARTMENT OF PUBLIC SERVICES
DIVISION OF BUILDING & SAFETY

APPLICATION & BUILDING PERMIT - for:
Fence, Wall, Retaining Wall.

ADDRESS OF CONSTRUCTION: 230 No 21st

OWNER: J. Henderson

LOT(s) _____ BLOCK _____ SUBDIVISION _____

Materials of Construction: Block Concrete Wire Wood Other

Yes No
PLANS:
CALCS:

ARCHITECT: _____
CONTRACTOR: Fencing Inc

ENGINEER: _____
STATE LICENSE # 4019

CITY LICENSE # 100-9

TOTAL SQUARE FEET: _____ TOTAL LINEAL FEET: 204'

Remarks:

Remarks section with three blank lines.

CONDITIONS OF THE PERMIT:

1. Any type of retaining wall must be engineered by a Civil or Structural Engineer.
2. If a home owner takes out the Building Permit and if the owner sublets the work to a Contractor, then the Contractor must take out the permit and pay for it.
3. No fence or wall can be built on City property or rights-of-way, but this is not intended to preclude construction within utility easements if utilities will not be damaged or made inaccessible.
4. The fence or wall shall not enclose any water meter, light standard, or fire alarm box and shall not come closer than 24" from the nearest fire hydrant outlet.
5. Department Inspectors must approve footings before concrete is poured and block wall reinforcing before grouting is done.
6. Maximum height of any wall or fence is 6', side and rear yards; 4' maximum in front yard with the vertical surface above the height of 2' - 50% open.
7. I must not obstruct required onsite parking space (2 spaces for each dwelling unit) by the erection of this fence or wall.
8. By the signing of this application I herewith agree to the requirements outlined above.

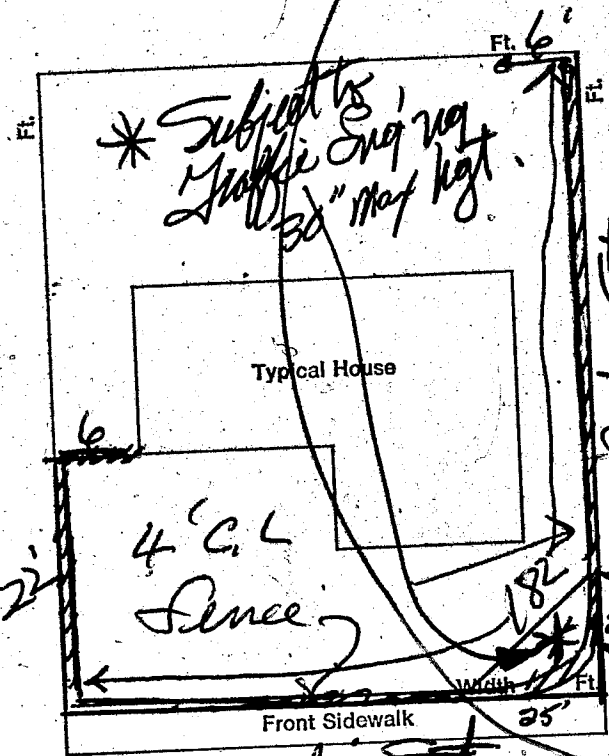

CANNOT EXCEED 30" MAXIMUM HEIGHT IN 25'x25' CORNER AREA.

SIGNED: [Signature]
CONTRACTOR AGENT

1 TONI	\$.00
WALL	\$	16.00
STL	\$	16.00
TOTL	\$	16.00
CHEK	\$	16.00

PN7217 SCH 001/01
CITY OF LAS VEGAS
BLDG. & SAFETY
12/12/80

PLANNING DEPT: [Signature] Date: 12/6/80

PUBLIC WORKS DEPT: [Signature] Date: 12/12/80

BUILDING DIVISION: [Signature] Date: 12/12/80

#12850 PERMIT NO: 7213 PERMIT FEE \$ 16.00

MUST BE MACHINE VALIDATED

None Hovalz 2-1-84

Department of Building & Safety
City of Las Vegas, Nevada

Special Kardex
Elec. only, Plbg. only, A.C. only

Owner James Pollack Address 230 N. 1st St Date: 11/27/73
Contractor _____ Permit No. _____
Lot _____ Block _____ Subdivision _____

Electric Only	Plumbing Only	Heat & Vent. A. C. Only
Contractor <u>Rg Park Temp Pole</u>	Contractor <u>Larkin</u>	Contractor _____
Permit No. <u>9866</u>	Permit No. <u>11935</u>	Permit No. _____
Slab _____	Rough Soil _____	A.C. Rough Duct _____
Rough Elect _____	Rough Water _____	Ref. Ro. Piping _____
Final Rough _____	Top Out _____	Rough Gas _____
Final Fixture _____	Rough Gas _____	Final Refrig _____
Final Elec <u>HB 9-13-74</u>	Final Plbg. _____	Final Air Cond _____
Temp. Service _____	Final Gas _____	Final Gas _____
	Final Sewer _____	
	Final Septic Tank _____	

23.06 D Address 230 N. 1st St Log No. Gas Area _____

DEPARTMENT OF BUILDING & SAFETY
CITY OF LAS VEGAS, NEVADA

KARDEX CARD
SIGN

OWNER Peter Piccale ADDRESS 230 N. 1st DATE 6-29-65
CONTRACTOR Atomic Neon PERMIT NO. 2007
LOT _____ BLOCK _____ SUBDIVISION _____

LOCATION _____	ELECT. ROUGH _____
SHOP (WIRING, CONST.) _____	ELECT. FINAL _____
SITE (BLDG., ETC.) <u>HB 7-1-65</u>	
INST. (SERV: STRUCT.) <u>HB 7-1-65</u>	
BILLBOARD _____	
ELECTRIFIED _____	
FINAL <u>HB 7-1-65</u>	

23.06 E ADDRESS 230 N. 1st LOG NO. _____ AREA _____