

616 Watkins Dr.

L27 Blk. 2 Sub. Watkins Manor Unit #1 Zone RPD 6

Gloria Caly August 15, 1980

4-12

CITY OF LAS VEGAS, NEVADA

LOG NO. & AREA T-3-3

CONST. VAL \$ 3,5842

DEPARTMENT OF BUILDING & SAFETY

APPLICATION & BUILDING PERMIT - for: Dwellings, Duplexes, Misc. Residential Const.

ADDRESS OF CONSTRUCTION: 616 Watkins Drive

OWNER: Watkins Development Corp.

LOT(s) 27 BLOCK 2 SUBDIVISION Watkins Manor Unit 1 ZONE R-R06

Existing structure on lot: Dwelling Accessory bldg. Vacant lot Other

PROPOSED CONSTRUCTION: SFD W/FP USE: Residence

MATERIALS OF CONSTRUCTION: Wood Frame Concrete Block Reinforced Concrete Steel Frame Entry 78

SQUARE FEET OF FLOOR AREAS: 1st 1524 2nd 3rd Other 427 TOTAL SQ. FT. 2029

FIRE ZONE: 1 2 3 Occupancy Group A B C D E F G H I 1 2-3-4-5 CONST. TYPE: I II III IV V

ARCHITECT: ENGINEER: NO. of UNITS 1 NO. of STORIES 1

Plans Submitted: Yes No Calculations Submitted: Yes No Sewer Fee Req'd: Yes No

CONTRACTOR: Kraft-Sportsman Const. Inc. STATE LICENSE # 12010B CITY LICENSE # C11-241204485

ADD'L PERMITS REQ'D: Air Cond. Elec. Plumbing Signs Paving Fence Public Walls Curb-gutters Incinerators Fire Sprinkling System

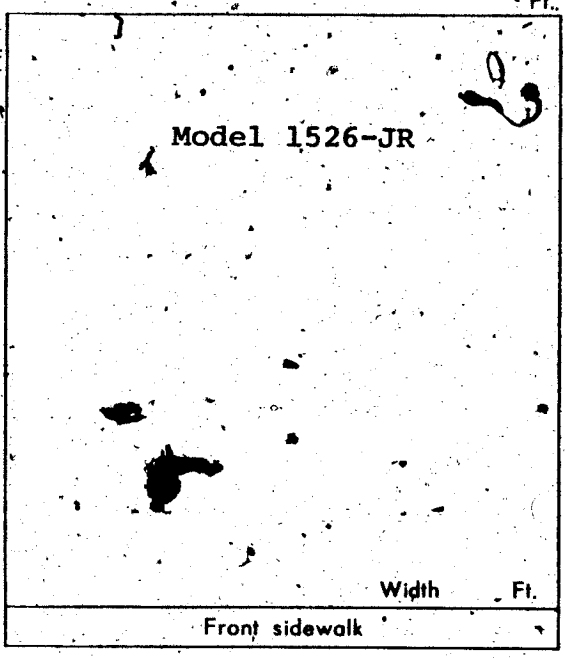

CONDITIONS-OF THE PERMIT:

- 1. I agree to call the City Building Department for inspections before concrete is poured, before rough wiring, electrical, plumbing, framing is covered. Also for Air conditioning, sheet rock and sheathing inspection.
2. I agree that when the job is completed that I will call for final inspection before occupancy.
3. I agree to perform all construction in accordance with City Ordinances and Building Codes.
4. The Contractor's signature below denotes authority from the owner to sign in his behalf and that the owner is aware of all requirements of this application and permit. Separate permits must be taken out for work outlined above this agreement.
5. I have read and understand the contents of this application and permit; I hereby state that the information I have supplied on this application is true and correct.

SIGNED: Kraft-Sportsman Const. Inc. Contractor

BY: R. H. Sportsman Agent or Owner

CLARK COUNTY HEALTH DEPT. Date

LAS VEGAS FIRE DEPARTMENT Date

PLANNING DEPT. Date: 4/6/76

PUBLIC WORKS DEPT. Date: 4-10-76

BUILDING DEPT. Date: 4/21/76

PERMIT NO. 1763 PERMIT FEE \$ 134.00

RECEIPT 9690 \$134.00 - 8 CITY OF LAS VEGAS DEPT. OF BUILDING & SAFETY MUST BE MACHINE VALIDATED

Gloria Ealy August 15, 1980

CITY OF LAS VEGAS, NEVADA
DEPARTMENT OF BUILDING & SAFETY

RECEIPT
FOR
SEWER CONNECTION FEE

JOB ADDRESS: 616 Watkins Drive OWNER'S NAME: Watkins Development Corp.

LOT 27 BLOCK 2 SUBDIVISION Watkins Manor Unit 1

QUANTITY	OCCUPANCY	UNIT FEE	AMOUNT
1	SFR		150.00

PAID BY: Kraft-Sportsman Const. Inc.

[Signature]
R.H. Sportsman

TOTAL \$150.00

Less Credit * -0-

TOTAL FEE \$ 150.00

* Credit for existing sewer is applied to the new sewer connection fee based on previous type of occupancy and only when the new occupancy requires an additional fee.
This receipt does not authorize the owner or his representative to start any work without obtaining a plumbing permit.

DEPARTMENT OF BUILDING & SAFETY

DATE

mm 4-6-76

73102

RECEIPT NO. 1205 SEWER FEE \$ 150.00

RECEIPT
9704 \$150.00 - 3
CITY OF LAS VEGAS
DEPT. OF BUILDING & SAFETY
MUST BE MACHINE VALIDATED
- 7 APR 76

Gloria Ealy August 15, 1980

CITY OF LAS VEGAS, NEVADA
DEPARTMENT OF BUILDING & SAFETY

RECEIPT
FOR
SEWER CONNECTION FEE

JOB ADDRESS: 616 Watkins Drive OWNER'S NAME: Watkins Development Corp.
LOT 27 BLOCK 2 SUBDIVISION Watkins Manor Unit 1

QUANTITY	OCCUPANCY	UNIT FEE	AMOUNT
1	SFR		150.00

PAID BY: Kraft-Sportsman Const. Inc.

[Signature]
R.H. Sportsman

TOTAL \$150.00
Less Credit * -0-
TOTAL FEE \$ 150.00

*Credit for existing sewer is applied to the new sewer connection fee based on previous type of occupancy and only when the new occupancy requires an additional fee. This receipt does not authorize the owner or his representative to start any work without obtaining a plumbing permit.

MM 4-6-76
DEPARTMENT OF BUILDING & SAFETY DATE

73102

RECEIPT NO. 1205 SEWER FEE \$ 150.00

RECEIPT
9704 \$150.00 - 3
CITY OF LAS VEGAS
DEPT. OF
BUILDING & SAFETY
MUST BE MACHINE VALIDATED
- 7 APR 76

Gloria Ealy August 15, 1980

CITY OF LAS VEGAS, NEVADA

DEPARTMENT OF BUILDING & SAFETY - APPLICATION AND PERMIT FOR PLUMBING

ADDRESS OF CONSTRUCTION: 616 Watkins Drive OWNER'S NAME: Watkins Development
 CIRCLE: New Bldg. Add'n.; Remodel; TYPE OF BLDG.: SFD. APT. PUBLIC COMM.
 CONTRACTOR'S NAME: Hynds Plumbing and Heating Co. STATE LICENSE # 1021 CITY LICENSE # C11-01660

UNITS	DESCRIPTION	FEE	TOTAL
2	Bathtub	1.00	2.00
	Shower	1.00	
2	Lavatory	1.00	2.00
2	Toilet	1.00	2.00
	Urinal	1.00	
	Floor Drain	1.00	
	Floor Sink	1.00	
	Wash Tray	1.00	
1	Sink	1.00	1.00
1	Garbage Disposal	1.00	1.00
	Garbage Disposal (comm.)	3.00	
1	Clothes Dryer (gas)	1.00	1.00
1	Clothes Washer	1.00	1.00
	Clothes Washer (comm.)	5.00	
	Dishwasher	1.00	
	Dishwasher (commercial)	5.00	
	Dental Unit	10.00	
	Drinking Fountain	1.00	
	Any Water using Equipment	1.00	
1	Water Heater (gas) (elect.)	1.00	1.00
	Sewer System - New, Replacement, or any Drainage System	4.00	4.00
	Grease or Sand Trap	2.00	
	Trailer Trap	2.00	
	Septic Disposal System	4.00	
WATER SOFTENERS			
	Nonpermanent Type	4.00	
	Permanent Type (connected to Drainage)	5.00	
SWIMMING POOLS			
	Private or Wading Pool	10.00	
	Public or Semi-public	20.00	

UNITS	DESCRIPTION	FEE	TOTAL
WATER DISTRIBUTION SYSTEM			
1	Single Family Dwelling	4.00	4.00
	Multiple Family Dwelling plus each unit	4.00	
	Bldg. Group "A" thru "G" per each floor	2.00	
	Hotel or Motel plus each bath	6.00	
	Trailer Park plus each space	4.00	
	Irrigation	20.00	
		1.00	
		4.00	
GAS PIPING SYSTEM			
1	Single Family Dwelling	3.00	3.00
	Multiple Family Dwelling plus each unit	6.00	
	Commercial Bldg. per floor plus each unit	1.00	
		3.00	
		3.00	
4	Gas Appliance (any type)	1.00	4.00
AUTOMATIC FIRE EXTINGUISHING SYSTEM			
	Underground Piping	0.00	
	Distribution Piping ea. ft.	.01	
	Sprinkler Head each	.10	
	In Range Hood and Vent	5.00	
DRY STANDPIPE SYSTEM			
	Piping	50.00	
	Each Outlet	1.00	
WET STANDPIPE SYSTEM			
	Piping	5.00	
	Fire Hose Cabinet	1.00	
	MINIMUM PERMIT FEE	4.00	
PIPELINE CONTRACTOR; SECT. 14.B.P.F. \$			
TOTAL PERMIT FEE \$			26.00

I hereby certify that I have carefully examined and read the above application; that the same is true and correct; and that the work herein described is to be done in accordance with all the provisions of the applicable Ordinances of the City of Las Vegas, Nevada and the State Laws, whether herein specified or not.

Approval for the work under this permit will be given only after refuse and debris have been removed from job site and public right of way.

Signed: Robert J. Keffer Date: 4-20-76
 Registered Master Plumber, Spec. Contr. or Owner
 Building Department: N. Miller Date: 4-20-76
 Permit No. 1427 Permit Fee \$ 26.00

#12870

RECEIPT

438 \$026.00 - 7

CITY OF LAS VEGAS
 DEPT. OF BUILDING & SAFETY

MUST BE MACHINE VALIDATED

21 APR 76

Gloria Ealy August 15, 1980

CITY OF LAS VEGAS, NEVADA

DEPARTMENT OF BUILDING & SAFETY - AIR CONDITIONING APPLICATION & PERMIT

ADDRESS OF CONSTRUCTION: 616 Watkins OWNER'S NAME: Kraft & Sportsman Const. Co.

CIRCLE: Addition; Remodel; New Bldg; TYPE OF BLDG: SFD APT. COMM. PUBLIC

CONTRACTOR'S NAME: Certified Air Cond. Co. STATE LICENSE # 11191 CITY LICENSE # 11417 C11-900-2-

UNITS	DESCRIPTION	FEE	TOTAL	UNITS	DESCRIPTION	FEE	TOTAL
	Unit heater - floor, wall or suspended	4.00			EVAPORATIVE COOLERS:		
	FOR EACH FORCED-AIR OR GRAVITY-TYPE FURNACE OR BURNER INCLUDING DUCTS AND VENT ATTACHED TO SUCH APPLIANCES:				5 outlets or under	3.00	
	Up to and including 100,000 B.t.u.'s	4.00			Over 5 and up to and including 10	9.00	
	Over 100,000 B.t.u.'s	6.00			Each additional outlet over 10	.25	
	FOR EACH HEATING APPLICATION, REFRIGERATION UNIT, COMFORT COOLING AND HEATING UNIT, ABSORPTION UNIT, COMPRESSOR OR BOILER:				VENTILATION:		
	Up to and including 3 ton or horsepower, or absorption system up to and including 100,000 B.t.u.'s	4.00			For each fan connected to a single duct	1.00	
1	Over 3 ton or 3 horsepower up to and including 10, or absorption system over 100,000 B.t.u.'s up to and including 250,000 B.t.u.'s	7.00	7.00		For each commercial or industrial ventilation system	5.00	
	Over 10 ton or 10 horsepower up to and including 30, or absorption system over 250,000 B.t.u.'s up to and including 1,000,000 B.t.u.'s	12.00			For each commercial kitchen hood	5.00	
	Over 30 ton or 30 horsepower up to and including 50, or absorption system over 1,000,000 B.t.u.'s up to and including 1,700,000 B.t.u.'s	20.00			MISCELLANEOUS:		
	Over 50 ton or 50 horsepower, or absorption system over 1,700,000 B.t.u.'s	30.00		2	For each water cooling tower	8.00	
	FOR EACH AIR HANDLING UNIT INCLUDING DUCTS ATTACHED THERETO:				Duct work only - each opening	.25	.50
	Up to and including 10,000 CFM	2.00			For installation or relocation of each commercial or industrial incinerator	15.00	
	Over 10,000 CFM	4.00			Gas piping related to the air cond. work in single family dwelling only	3.00	
					For each appliance, piece of equipment, any mechanical work or alteration or replacement not included in this schedule, the permit fee shall be computed the same as building permit fees by using the cost of installation for the valuation amount.		
					FOR THE ISSUANCE OF EACH PERMIT		3.00
					TOTAL PERMIT FEE \$	10.50	

I hereby certify that I have carefully examined and read the above application; that the same is true and correct; and that the work herein described is to be done in accordance with all the provisions of the applicable Ordinances of the City of Las Vegas, Nevada and the State Laws, whether herein specified or not.

Approval for the work under this permit will be given only after refuse and debris have been removed from job site and public right of way.

SIGNED [Signature] Date 5-17-76
Air Conditioning Contractor - Owner

BUILDING DEPARTMENT [Signature] Date 5-20-76

PERMIT NO. 553 PERMIT FEE \$ 10.50

#12890

RECEIPT
2115 \$010.50 - 4
CITY OF LAS VEGAS
DEPT. OF BUILDING & SAFETY
MUST BE MACHINE VALIDATED
20 MAY 76

Gloria Caly August 15, 1980

CITY OF LAS VEGAS, NEVADA

DEPARTMENT OF BUILDING & SAFETY - ELECTRICAL APPLICATION & PERMIT

ADDRESS OF CONSTRUCTION: 616 Watkins Dr. OWNER'S NAME: KRAFT-SPORTSMAN Co.

CIRCLE: New Bldg.; Add'n.; Remodel; TYPE OF BLDG.: SFD; APT. PUBLIC COMM.

CONTRACTOR'S NAME: ANDERSON ELECTRIC STATE LICENSE # 10997 CITY LICENSE 890-2-00350

NUMBER	FIXTURE OR INSTALLATION	UNIT PRICE	TOTAL
	Rm addition, carport or garage enclosure	4.00	
	Temporary power	4.00	
64	Light, receptacle or switch outlet	.20	12.80
	Wall or ceiling space heater	.35	
1	Garbage grinder outlet	.35	.35
1	Dishwasher outlet	.35	.35
1	Clothes dryer outlet	.35	.35
1	Automatic clothes washer	.35	.35
1	Electric range outlet	.35	.35
1	Electric water heater outlet	.35	.35
	Special purpose outlet	.35	
	X-ray unit and its appurtenances	5.00	
	Watts of festoon lighting (Watts) First 3,000 watts for each additional thousand watts	4.00 1.50	
	Horsepower each motor first horsepower or less for each additional horsepower	1.75 .35	
1	Electric service (including any single meter socket) for each additional socket	3.00 .35	3/00
1	Air conditioning service	1.50	1.50
	Each KW(KVA) Generator (Transformer, Welder) First 100 KVA for each additional KW(KVA)	2.00 .01	
2	Speaker, signal or alarm outlet	.15	.30
	Amplifiers	.50	
	Control panels	.25	
	Main control racks	1.00	
	T.V. and radio antennas master system only	.75	
	Minimum fee for any permit	4.00	
TOTAL FEE			\$19.35

Approval for the work under this permit will be given only after refuse and debris have been removed from job site and public right of way.

I hereby certify that I have carefully examined and read the above application; that the same is true and correct; and that the work herein described is to be done in accordance with all the provisions of the applicable Ordinances of the City of Las Vegas, Nevada and State laws whether herein specified or not.

SIGNED Alan E. Anderson DATE 5/20/76
MASTER (ELECTRICIAN) (TECHNICIAN) (OWNER) #65

BUILDING DEPARTMENT MM DATE _____

#12860 PERMIT NO. 1322 PERMIT FEE: \$ 19.35

RECEIPT
 2360 \$019.35 - 6
 CITY OF LAS VEGAS
 DEPT. OF BUILDING & SAFETY
 MUST BE MACHINE VALIDATED
 24 MAY 16

Gloria Ealy August 15, 1980

CITY OF LAS VEGAS, NEVADA

BUILDING AND SAFETY DEPARTMENT - APPLICATION AND PERMIT FOR SWIMMING POOL

LOG No. M-298 Const. valuation \$ 5200

ADDRESS OF CONSTRUCTION: 616 Watkins Dr. OWNER'S NAME: Dominic Luciano
~~6500 Sanderson~~ Gordon F. Peterson

LOT 27 BLOCK 2 SUBDIVISION WATKINS MANOR ZONE EPD

CIRCLE TYPE OF POOL THAT APPLIES: Private Semi-public Public

MATERIALS OF CONSTRUCTION: Reinforced gunite Reinforced concrete Other

SQUARE FEET OF SURFACE AREA: 600 VOLUME IN GALLONS 26,100

ARCHITECTS NAME: _____ ENGINEER NAME: _____

PLANS SUBMITTED: Yes _____ No _____ CALCULATIONS SUBMITTED: Yes 3 No _____

CONTRACTOR'S NAME: Tropicana Pools Inc. State License # 9656 City License # C11 171 2 07454

ADDITIONAL PERMITS REQUIRED: Electrical Plumbing Other Sewer fee req'd: Yes No

I state that I am familiar with effective Ordinances of the City of Las Vegas, Nevada, and effective Statutes of the State of Nevada covering construction and use of the above type; I agree to perform said construction in conformity therewith. I further agree that issuance of a permit on above application will not excuse me from conforming with said Ordinances and Statutes despite any errors on the part of the building Inspector or Engineer in checking plans and application herewith submitted.

All swimming pools must be fenced before the pool is filled with water. No electric lines shall go over a pool.
I have read and understand the contents of above application; I hereby state that same are true and correct.
I also agree to repair any utility line if damaged during excavation work.

Signed: Tropicana Pools Inc.
(Contractor)
By: [Signature]
(Agent or Owner)

CITY SWIMMING POOL ORDINANCE

Applicant must have separate plot plan showing location of power pole, proposed or existing pool fencing and location of swimming pool.

The Contractor's signature above denotes authority from the owner to sign on his behalf and that the owner is aware of all requirements of this application. Separate permits must be obtained for electrical and plumbing work.

APPROVED BY: (5-04)
[Signature]

PLANNING DEPT. _____ DATE 7-19-76

PUBLIC WORKS DEPT. _____ DATE _____

BUILDING DEPT. H. J. Keller DATE _____

PERMIT No. 3737 PERMIT FEE: \$ 39.00

RECEIPT
4989 . \$039.00 - 8

CITY OF LAS VEGAS
DEPT. OF BUILDING & SAFETY

MUST BE MACHINE VALIDATED

20 JUL 76

Gloria Ealy August 15, 1980

Tropicana Pools, Inc.

2890 TROPICANA AVENUE • LAS VEGAS, NEVADA 89121



• TELEPHONE (702) 736-1327 •

City of Las Vegas
400 Stewart Avenue
Las Vegas, Nevada

Re: ~~Gordon F. Peterson~~
~~6593 Gauderson~~
Dominic Luciani
216 Watkins Dr.

Gentlemen:

Please be advised that Tropicana Pools Inc. has instructed all sub-contractors and employees of Tropicana Pools Inc. that any dirt removed from the above mentioned project shall be transported and disposed of in an appropriate landfill dump such as the dump at the base of Sunrise Mountain.

Under no circumstances is any dirt to be dumped in violation of the City of Las Vegas Municipal Code, Title 8, Chapter 3, Section 6.

Sincerely,

William L. Palmer
Vice President/General Manager

WLP:ls

Gloria Ealy August 15, 1980

CITY OF LAS VEGAS, NEVADA

DEPARTMENT OF BUILDING & SAFETY - APPLICATION AND PERMIT FOR PLUMBING

ADDRESS OF CONSTRUCTION: 616 Watkins Dr. OWNER'S NAME: Dominic Luciano
~~6593 Gundersen~~ Gordon F. Peterson

CIRCLE: New Bldg.; Add'n.; Remodel; TYPE OF BLDG.: SFD. APT. PUBLIC COMM.

CONTRACTOR'S NAME: Tropicana Pools Inc. STATE LICENSE # 9656A CITY LICENSE # C11 171 2 07454

UNITS	DESCRIPTION	FEE	TOTAL
	Bathtub	1.00	
	Shower	1.00	
	Lavatory	1.00	
	Toilet	1.00	
	Urinal	1.00	
	Floor Drain	1.00	
	Floor Sink	1.00	
	Wash Tray	1.00	
	Sink	1.00	
	Garbage Disposal	1.00	
	Garbage Disposal (comm.)	3.00	
	Clothes Dryer (gas)	1.00	
	Clothes Washer	1.00	
	Clothes Washer (comm.)	5.00	
	Dishwasher	1.00	
	Dishwasher (commercial)	5.00	
	Dental Unit	10.00	
	Drinking Fountain	1.00	
	Any Water using Equipment	1.00	
	Water Heater (gas)-(elect.)	1.00	
	Sewer System—New, Replacement, or any Drainage System	4.00	
	Grease or Sand Trap	2.00	
	Trailer Trap	2.00	
	Septic Disposal System	4.00	
WATER SOFTENERS			
	Nonpermanent Type	4.00	
	Permanent Type (connected to Drainage)	5.00	
SWIMMING POOLS			
1	Private or Wading Pool	10.00	10.00
	Public or Semi-public	20.00	

UNITS	DESCRIPTION	FEE	TOTAL
WATER DISTRIBUTION SYSTEM			
	Single Family Dwelling	4.00	
	Multiple Family Dwelling plus each unit	4.00 2.00	
	Bldg. Group "A" thru "G" per each floor	6.00	
	Hotel or Motel plus each bath	4.00 1.50	
	Trailer Park plus each space	20.00 1.00	
	Irrigation	4.00	
GAS PIPING SYSTEM			
	Single Family Dwelling	3.00	
	Multiple Family Dwelling plus each unit	6.00 1.00	
	Commercial Bldg. per floor plus each unit	3.00 3.00	
	Gas Appliance (any type)	1.00	
AUTOMATIC FIRE EXTINGUISHING SYSTEM			
	Underground Piping	10.00	
	Distribution Piping ea. ft.	.01	
	Sprinkler Head each	.10	
	In Range Hood and Vent	5.00	
DRY STANDPIPE SYSTEM			
	Piping	50.00	
	Each Outlet	1.00	
WET STANDPIPE SYSTEM			
	Piping	5.00	
	Fire Hose Cabinet	1.00	
	MINIMUM PERMIT FEE	4.00	
PIPELINE CONTRACTOR; SECT. 14-B.P.F. \$			
TOTAL PERMIT FEE \$ 10.00			

I hereby certify that I have carefully examined and read the above application; that the same is true and correct; and that the work herein described is to be done in accordance with all the provisions of the applicable Ordinances of the City of Las Vegas, Nevada and the State Laws, whether herein specified or not.

Approved: The work under this permit will be given only after refuse and debris have been removed from job site and public right of way.

Signed: Tropicana Pools Inc by Dan Tull Date: _____
Registered Master Plumber, Spec. Cont'r. or Owner

Building Department: H. T. Blevins Date: 7-19-76

Permit No. 2447 Permit Fee \$ 10.00

#12870

RECEIPT

4988 \$010.00 - 7

CITY OF LAS VEGAS
BUILDING & SAFETY

MUST BE MACHINE VALIDATED
20 JUL 76

Gloria Caly August 15, 1980

CITY OF LAS VEGAS, NEVADA
DEPARTMENT OF BUILDING & SAFETY

RECEIPT
FOR
SEWER CONNECTION FEE

JOB ADDRESS: 616 Watkins Dr. ~~5593 Gauderson~~ OWNER'S NAME: Dominic Luciano ~~Gordon P. Peterson~~

LOT _____ BLOCK _____ SUBDIVISION _____

QUANTITY	OCCUPANCY	UNIT FEE	AMOUNT
1	Pool Sewer Tap ✓		37.50

PAID BY: Tropicana Pools Inc
by Don Ford

TOTAL _____
Less Credit* _____
TOTAL FEE \$ 37.50

*Credit for existing sewer is applied to the new sewer connection fee based on previous type of occupancy and only when the new occupancy requires an additional fee.

This receipt does not authorize the owner or his representative to start any work without obtaining a plumbing permit.

H J. Ellis
DEPARTMENT OF BUILDING & SAFETY
DATE: 7-19-76

RECEIPT NO. 2448 SEWER FEE \$ 37.50

73102

RECEIPT
4987 \$037.50 - 3
CITY OF LAS VEGAS
BUILDING & SAFETY
MUST BE MACHINE VALIDATED
20 JUL 76

Gloria Ealy August 15, 1980

CITY OF LAS VEGAS, NEVADA

DEPARTMENT OF BUILDING & SAFETY - ELECTRICAL APPLICATION & PERMIT

ADDRESS OF CONSTRUCTION: 636 Watkins Dr. OWNER'S NAME: Luciano

CIRCLE: New Bldg.; Add'n.; Remodel; TYPE OF BLDG.: SFD. APT. PUBLIC COMM. Invoice #1024

Swimming Pool
CONTRACTOR'S NAME: Center Line Electric Inc. STATE LICENSE # 11728-B CITY LICENSE # 06884

NUMBER	FIXTURE OR INSTALLATION	UNIT PRICE	TOTAL
	Rm addition, carport or garage enclosure	4.00	
	Temporary power	4.00	
3	Light, receptacle or switch outlet	.20	.60
	Wall or ceiling space heater	.35	
	Garbage grinder outlet	.35	
	Dishwasher outlet	.35	
	Clothes dryer outlet	.35	
	Automatic clothes washer	.35	
	Electric range outlet	.35	
	Electric water heater outlet	.35	
	Special purpose outlet	.35	
	X-ray unit and its appurtenances	5.00	
	Watts of festoon lighting (Watts) First 3,000 watts for each additional thousand watts	4.00 1.50	
1	Horsepower-each motor first horsepower or less for each additional horsepower	1.75 .35	1.75
	Electric service (including any single meter socket) for each additional socket	3.00 .35	
	Air conditioning service	1.50	
	Each KW(KVA) Generator (Transformer, Welder) First 100 KVA for each additional KW(KVA)	2.00 .01	
	Speaker, signal or alarm outlet	.15	
	Amplifiers	.50	
	Control panels	.25	
	Main control racks	1.00	
	T.V. and radio antennas-master system only	.75	
	Minimum fee for any permit	4.00	4.00
	TOTAL FEE		4.00

Approval for the work under this permit will be given only after refuse and debris have been removed from job site and public right of way.

I hereby certify that I have carefully examined and read the above application; that the same is true and correct; and that the work herein described is to be done in accordance with all the provisions of the applicable Ordinances of the City of Las Vegas, Nevada and State laws whether herein specified or not.

SIGNED Cal Logan #47 DATE 7/29/76
MASTER (ELECTRICIAN) (TECHNICIAN) (OWNER)

BUILDING DEPARTMENT N.M. DATE 7/29/76

PERMIT NO. 1851 PERMIT FEE: \$ 4.00

RECEIPT

5526 * \$004.00 - 6

CITY OF LAS VEGAS
DEPT. OF BUILDING & SAFETY

MUST BE MACHINE VALIDATED

3-2-86

Gloria Ealy August 15, 1980

CITY OF LAS VEGAS, NEVADA

LOG NO. & AREA _____ DEPARTMENT OF BUILDING & SAFETY CONST. VAL. \$ 1035.00

APPLICATION & BUILDING PERMIT — for: Fence, Wall, Retaining Wall

ADDRESS OF CONSTRUCTION: 11-1-2 616 WATKINS DR. OWNER: Dominic Luciano

LOT(s) 27 BLOCK 2 SUBDIVISION [unclear] ZONE RPD6

Materials of Construction: Block Concrete Wire Wood Other PLANS:

ARCHITECT: _____ ENGINEER: _____ CALCS:

CONTRACTOR: OWNER STATE LICENSE # _____ CITY LICENSE # _____

TOTAL SQUARE FEET: 690 TOTAL LINEAL FEET: 115'

Remarks: _____

CONDITIONS OF THE PERMIT:

1. Any type of retaining wall must be engineered by a Civil or Structural Engineer.
2. If a home owner takes out the Building Permit and if the owner sublets the work to a Contractor, then the Contractor must take out the permit and pay for it.
3. No fence or wall can be built on City property or rights-of-way, but this is not intended to preclude construction within utility easements if utilities will not be damaged or made inaccessible.
4. The fence or wall shall not enclose any water meter, light standard, or fire alarm box and shall not come closer than 24" from the nearest fire hydrant outlet.
5. Department Inspectors must approve footings before concrete is poured and block wall reinforcing before grouting is done.
6. Maximum height of any wall or fence is 6', side and rear yards; 4' maximum in front yard with the vertical surface above the height of 2' — 50% open.
7. I must not obstruct required onsite parking space (2 spaces for each dwelling unit) by the erection of this fence or wall.
8. By the signing of this application I herewith agree to the requirements outlined above.

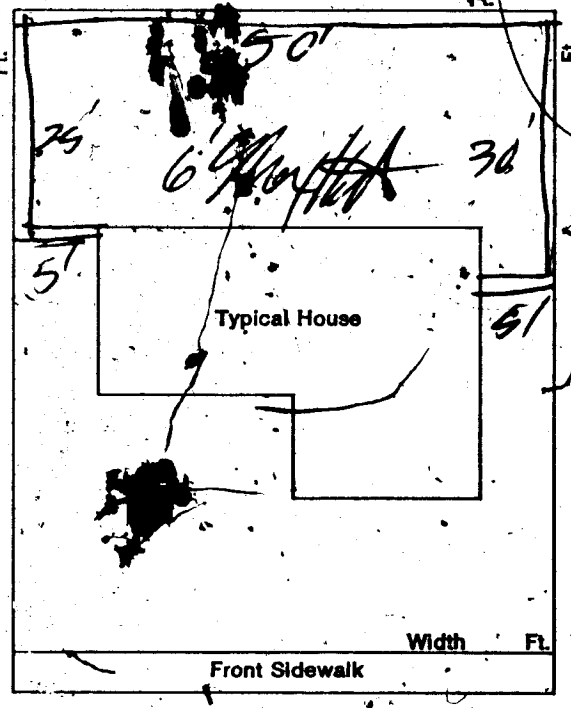

SIGNED: [Signature] DATE: _____ CONTRACTOR AGENT OWNER

PLANNING DEPT: [Signature] Date: 9-21-76

PUBLIC WORKS DEPT: [Signature] Date: _____

BUILDING DEPT: [Signature] Date: 9-21-76

PERMIT NO: 4725 PERMIT FEE \$ 150.00

454-01-250

RECEIPT

7941 8015.00 - 8

CITY OF LAS VEGAS

DEPT. OF BUILDING & SAFETY

MUST BE MACHINE VALIDATED

21 SEP 76

Dona Hishy 12-2-83

DEPT. of BLDG. & SAFETY - CITY of LAS VEGAS, NEVADA

OWNER Watkins Development Co ADDRESS 616 Watkins Dr. DATE 4-7-76
 GEN. CONT. Kraft Sportsman Const TYPE OF STRUCTURE STX SFD w fp
 PERMIT NO. 1763 LEGAL DESCRIPTION L#27 B 2 Watkins Manor Unit # 1

BUILDING	MECHANICAL	ELECTRICAL
Investigation	Plumbing Cont. <u>Hughes</u>	Temp. pole cont.
Location & Footing <u>R 94-9-26</u>	Permit No. <u>5127</u> Date <u>4-11-76</u>	Permit No. _____ Date _____
Stem Wall	Heat & Vent. A/C Cont. <u>Artifical</u>	Inspection _____ Date _____
Concrete Slab Floor	Permit No. <u>553</u> Date <u>5-20-76</u>	Electrical Cont. <u>J. Jensen</u>
Floor Framing	Sewer Cont. <u>Kraft Sportsman Const</u>	Permit No. <u>1322</u> Date <u>4-14</u>
Fireplace Footing	Permit No. <u>1205</u> Date _____	Final _____ Date _____
Chimney Steel	Rough Soil <u>WEP 4-22-76</u>	Final _____ Date _____
Vert. Steel Reinf.	Rough Water <u>WEP 4-22-76</u>	Slab _____
Horiz. Steel Reinf.	Top-Out <u>WEP 6-21-76</u>	Rough <u>HD 6-23-76</u>
Roof Sheathing <u>296-9-76</u>	Rough Gas _____	Final Rough _____
Framing <u>296-3-76</u>	A/C Rough Duct <u>WEP 6-11-76</u>	Final Fixture _____
Backing for siding	Ref. Rough Piping _____	Final Electrical _____
Ext Lath <u>297-6-76</u>	Final Plumbing <u>WEP 8-6-76</u>	Temporary Service <u>HD 8-4-76</u>
Ext. Scratch <u>297-15-76</u>	Final Gas <u>WEP 8-6-76</u>	MISCELLANEOUS
Ext Brown <u>297-23-76</u>	Final Air Cond. <u>WEP 8-6-76</u>	Grading & Drainage _____
Int. Lath _____	Final Refrig. _____	On Site Parking Spaces _____ App. _____
Int Brown _____	Final Sewer <u>WEP 4-22-76</u>	Eng. Approval of _____
Drywall <u>297-6-76</u>	Final Septic Tank _____	Off Site Improvement _____
Permit No. _____		
Final Building _____		
Appr. for Occu. _____		

INSPECTOR: _____

DATE _____

APPROVED FOR OCCUPANCY & METER _____

PLEASE NOTE REMARKS ON REVERSE SIDE

616 Watkins Dr.

LOG # _____

AREA # _____

T 3-3

DEPARTMENT OF BUILDING & SAFETY
CITY OF LAS VEGAS, NEVADA

KARDEX CARD
SWIMMING POOL

OWNER Dominic Luciano ADDRESS 616 Watkins DATE 7-20-76

CONTRACTOR Tropicana Pools, Inc. PERMIT NO. 3737

LOT 27 BLOCK 2 SUBDIVISION Watkins Manor

LOCATION <u>299-8-76</u>	FINAL PLUMBING _____
ROUGH SOIL _____	FINAL ELECTRIC _____
ROUGH WATER <u>299-8-76</u>	FINAL GAS _____
ROUGH GAS _____	FINAL SEWER _____
ROUGH ELECTRIC 1st <u>299-8-76</u> 2nd _____ 3rd _____	FINAL SEPTIC TANK _____
STEEL INSPECTION <u>299-8-76</u>	

FINAL POOL INSPECTION

Plmbg: 2447
sewer: 2448

Center Line 1851

(Inspector)

DATE _____

23.24.B

ADDRESS 616 Watkins

LOG NO. 4-299

AREA _____

Dona Hestley 12-2-83

DEPARTMENT OF BUILDING & SAFETY
CITY OF LAS VEGAS, NEVADA

KARDEX CARD
FENCE & RETAINING
WALLS

OWNER Dominic Luciano

ADDRESS 616 Watkins Dr.

DATE 9-21-76

CONTRACTOR Owner

PERMIT NO. 4725

LOT 27

BLOCK 2

SUBDIVISION

Watkins Manor Unit # 1 block fence

Fence (wire, wood, etc.)	Walls (masonry, rock, etc.)
Location _____	Location <u>BW 10-30-76</u>
Final Inspection _____	Footing <u>BW 10-30-76</u>
	Wall Steel 1st <u>BW 10-30-76</u> 2d _____ 3d _____
	Final Inspection _____
Retaining Wall (masonry)	Retaining Wall (concrete)
Location _____	Location _____
Footing _____	Footing _____
Wall Steel 1st _____ 2d _____ 3d _____	Wall Steel 1st _____ 2d _____ 3d _____
Bond Beam 1st _____ 2d _____ 3d _____	Final Inspection _____
Final Inspection _____	

ADDRESS 616 Watkins Dr.