

· 6237 W. Washington ·

· L89 Blk. 1 Sub. Char. Hgts. 29-5 Zone R-3 PUD ·

B Ealy August 13, 1980

CITY OF LAS VEGAS, NEVADA

LOG NO. & AREA F-29-3  
DEPARTMENT OF BUILDING & SAFETY

CONST. VAL. \$ 16,000

APPLICATION & BUILDING PERMIT for:  
Dwellings, Duplexes, Misc. Residential Const.

ADDRESS OF CONSTRUCTION: 6237 Washington Avenue

OWNER: BECKER & SONS

LOT(s) 89 BLOCK 1 SUBDIVISION Charleston Heights 29-5 ZONE: R-3 PUD

Existing structure on lot: Dwelling  Accessory bldgs.  Vacant lot  Other

PROPOSED CONSTRUCTION: Single Family Residence USE: Same

MATERIALS OF CONSTRUCTION: Wood Frame  Concrete Block  Reinforced Concrete  Steel Frame

SQ. FEET OF FLOOR AREAS: 1st 608 2nd 646 3rd \_\_\_\_\_ Other \_\_\_\_\_ TOTAL SQ. FT. 1254

FIRE ZONE: 1 2 3 \_\_\_\_\_ Occupancy Group L, J 1-2 CONST. TYPE: I II III IV V

ARCHITECT: BECKER BUILT ENGINEER: BECKER BUILT NO. of UNITS: 1 NO. of STORIES 2

Plans Submitted: Yes  No  Calculations Submitted Yes  No  Sewer Fee Req'd. Yes  No

CONTRACTOR: BECKER BUILT STATE LICENSE # 11092 CITY LICENSE # C 11 520

ADD'L. PERMITS REQ'D: Air Cond.  Elec.  Plumbing  Signs  Paving  Fence  Public Walks  Curb-gutters   
Incinerators  Fire Sprinkling System

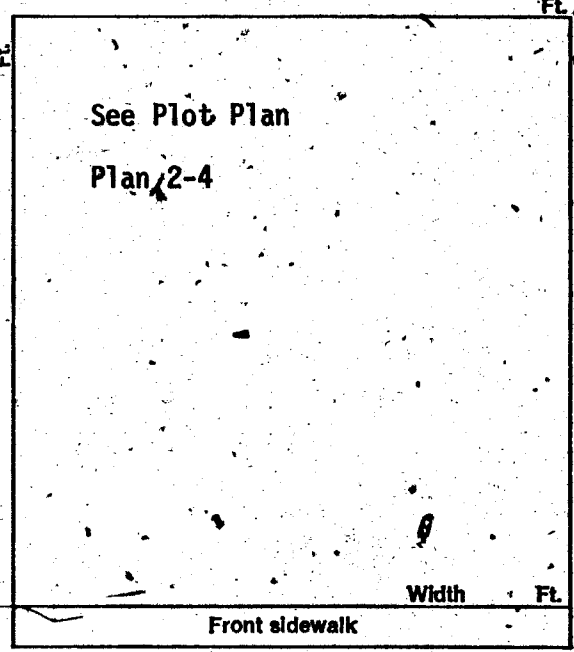

CONDITIONS OF THE PERMIT:

1. I agree to call the City Building Department for inspections before concrete is poured, before rough wiring, electrical, plumbing, framing is covered. Also for air conditioning, sheet-rock and sheathing inspection.
2. I agree that when the job is completed that I will call for final inspection before occupancy.
3. I agree to perform all construction in accordance with City Ordinances and Building Codes.
4. The Contractor's signature below denotes authority from the owner to sign in his behalf and that the owner is aware of all requirements of this application and permit. Separate permits must be taken out for work outlined above this agreement.
5. I have read and understand the contents of this application and permit; I hereby state that the information I have supplied on this application is true and correct.

SIGNED: Ernest A. Becker, Jr. Contractor

BY: \_\_\_\_\_ Agent or Owner

CLARK COUNTY HEALTH DEPT. Date \_\_\_\_\_

LAS VEGAS FIRE DEPARTMENT Date \_\_\_\_\_

PLANNING DEPT.: [Signature] Date: 9-12-72

PUBLIC WORKS DEPT.: [Signature] Date: 9-13

BUILDING DEPT.: [Signature] Date: 7-6-72

PERMIT NO.: 6380 PERMIT FEE \$: 70

RECEIPT

1129 \$070.00 - 8

CITY OF LAS VEGAS  
DEPT. OF BUILDING & SAFETY

MUST BE MACHINE VALIDATED

27 JUL 72

Early August 13, 1980

**CITY OF LAS VEGAS, NEVADA**  
**DEPARTMENT OF BUILDING & SAFETY**  
**RECEIPT**  
**FOR**  
**SEWER CONNECTION FEE**

JOB ADDRESS: 6237 Washington Avenue OWNER'S NAME: BECKER & SONS  
LOT 89 BLOCK 1 SUBDIVISION CHARLESTON HEIGHTS 29-5

QUANTITY	OCCUPANCY	UNIT FEE	AMOUNT
1	Single Family Residence		\$150.00

PAID BY: \_\_\_\_\_

TOTAL \$150.00

Less Credit\* \_\_\_\_\_

TOTAL FEE \$ 150.00

\*Credit for existing sewer is applied to the new sewer connection fee based on previous type of occupancy and only when the new occupancy requires an additional fee.

This receipt does not authorize the owner or his representative to start any work without obtaining a plumbing permit.

  
DEPARTMENT OF BUILDING & SAFETY

5/10/80  
DATE

RECEIPT NO. 5830 SEWER FEE \$ 150.00

# 73102

RECEIPT

1036 \$150.00 - 3

CITY OF LAS VEGAS  
DEPT. OF  
BUILDING & SAFETY

MUST BE MACHINE VALIDATED

27 JUL 72

H. Ealy August 13, 1980

CITY OF LAS VEGAS, NEVADA

LOG NO. & AREA

DEPARTMENT OF BUILDING & SAFETY

APPLICATION & BUILDING PERMIT - for: Fence, Wall, Retaining Wall

CONST. VAL. \$ 174<sup>00</sup>

ADDRESS OF CONSTRUCTION: 6237 Washington Avenue

OWNER: BECKER & SONS

LOT(s) 89 BLOCK 1 SUBDIVISION

Charleston Heights 29-5

ZONE: R-3 PUD

Materials of Construction: Block  Concrete  Wire  Wood  Other  Yes No

ARCHITECT: BECKER BUILT

ENGINEER: BECKER BUILT

PLANS:

CALCS:

CONTRACTOR: BECKER BUILT

STATE LICENSE # 11092

CITY LICENSE # C 11 520

TOTAL SQUARE FEET: 1204 TOTAL LINEAL FEET: 29

Remarks: 6' Block Wall

CONDITIONS OF THE PERMIT:

- 1. Any type of retaining wall must be engineered by a Civil or Structural Engineer.
2. If a home owner takes out the Building Permit and if the owner sublets the work to a Contractor, then the Contractor must take out the permit and pay for it.
3. No fence or wall can be built on City property or rights-of-way, but this is not intended to preclude construction within utility easements, if utilities will not be damaged or made inaccessible.
4. The fence or wall shall not enclose any water meter, light standard, or fire alarm box and shall not come closer than 24" from the nearest fire hydrant outlet.
5. Department Inspectors must approve footings before concrete is poured and block wall reinforcing before grouting is done.
6. Maximum height of any wall or fence is 6', side and rear yards; 4' maximum in front yard with the vertical surface above the height of 2' -- 50% open.
7. I must not obstruct required onsite parking space (1 space for each dwelling unit) by the erection of this fence or wall.
8. By the signing of this application I herewith agree to the requirements outlined above.

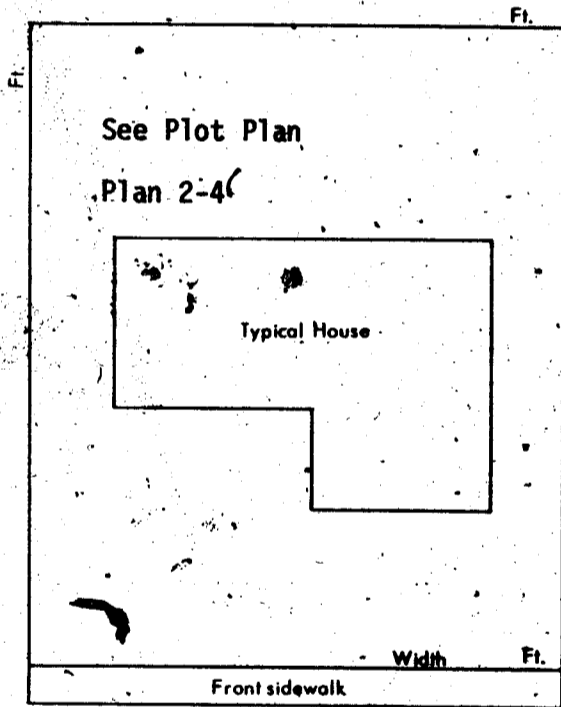

SIGNED:

CONTRACTOR  AGENT  OWNER

DATE: 6/30/72

PLANNING DEPT.:

Date: 9-12-72

PUBLIC WORKS DEPT.:

Date:

BUILDING DEPT.:

Date: 7-6-72

#12850

PERMIT NO.: 6393

PERMIT FEE \$ 5

RECEIPT

1020 \$005.00 - 8

CITY OF LAS VEGAS DEPT. OF BUILDING & SAFETY MUST BE MACHINE VALIDATED

27 JUL 72

J. Ealy August 13, 1980

CITY OF LAS VEGAS, NEVADA

DEPARTMENT OF BUILDING & SAFETY - APPLICATION AND PERMIT FOR PLUMBING

ADDRESS OF CONSTRUCTION: 6737 Washington OWNER'S NAME: Becker

CIRCLE: New Bldg.; Add'n; Remodel; TYPE OF BLDG.: RES. APT. PUBLIC COMM.

CONTRACTOR'S NAME: Byrdman Plbg STATE LICENSE # \_\_\_\_\_ CITY LICENSE # 01201

UNITS	DESCRIPTION	FEE	TOTAL
1	Bathub	1.00	1-
	Shower	1.00	
3	Lavatory	1.00	3-
2	Toilet	1.00	2-
	Urinal	1.00	
	Floor Drain	1.00	
	Floor Sink	1.00	
	Wash Tray	1.00	
1	Sink	1.00	1-
1	Garbage Disposal	1.00	1-
	Garbage Disposal (comm.)	3.00	
	Clothes Dryer (gas)	1.00	
1	Clothes Washer	1.00	1-
	Clothes Washer (comm.)	5.00	
1	Dishwasher	1.00	1-
	Dishwasher (commercial)	5.00	
	Dental Unit	10.00	
	Drinking Fountain	1.00	
	Any Water using Equipment	1.00	
1	Water Heater (gas/elect)	1.00	1-
1	Sewer System - New, Replacement, or any Drainage System	4.00	4-
	Grease or Sand Trap	2.00	
	Trailer Trap	2.00	
	Septic Disposal System	4.00	
WATER SOFTENERS			
	Nonpermanent Type	4.00	
	Permanent Type (connected to Drainage)	5.00	
SWIMMING POOLS			
	Private or Wading Pool	10.00	
	Public or Semi-public	20.00	

UNITS	DESCRIPTION	FEE	TOTAL
WATER DISTRIBUTION SYSTEM			
1	Single Family Dwelling	4.00	4-
	Multiple Family Dwelling plus each unit	4.00	
	Bldg. Group "A" thru "G" per each floor	2.00	
	Hotel or Motel plus each bath	6.00	
	Trailer Park plus each space	4.00	
	Irrigation	1.50	
		20.00	
		1.00	
		4.00	
GAS PIPING SYSTEM			
	Single Family Dwelling	3.00	
	Multiple Family Dwelling plus each unit	6.00	
	Commercial Bldg. per floor plus each unit	1.00	
	Gas Appliance (any type)	3.00	
		3.00	
		1.00	
AUTOMATIC FIRE EXTINGUISHING SYSTEM			
	Underground Piping	10.00	
	Distribution Piping ea. ft.	.01	
	Sprinkler Head each	.10	
	In Range Hood and Vent	5.00	
DRY STANDPIPE SYSTEM			
	Piping	50.00	
	Each Outlet	1.00	
WET STANDPIPE SYSTEM			
	Piping	5.00	
	Fire Hose Cabinet	1.00	
MINIMUM PERMIT FEE			
		4.00	
PIPELINE CONTRACTOR, SECT. 14-B.P.F. \$			
TOTAL PERMIT FEE \$ <u>19.00</u>			

I hereby certify that I have carefully examined and read the above application; that the same is true and correct; and that the work herein described is to be done in accordance with all the provisions of the applicable Ordinances of the City of Las Vegas, Nevada and the State Laws, whether herein specified or not.

Signed Stan S. Parkin Date: 8-7-72  
REGISTERED MASTER PLUMBER, SPEC. CONT'R. OR OWNER

Building Department W. M. Miller Date: \_\_\_\_\_  
 #12870 Permit No. 6060 Permit Fee \$ 19.00

RECEIPT

1773 \$019.00 - 7

CITY OF LAS VEGAS  
 DEPT. OF  
 BUILDING & SAFETY

MUST BE MACHINE VALIDATED  
 - 8 AUG 72

Early August 13, 1980

**CITY OF LAS VEGAS, NEVADA**

**DEPARTMENT OF BUILDING & SAFETY — ELECTRICAL APPLICATION & PERMIT**

ADDRESS OF CONSTRUCTION: 6237 Washington Avenue OWNER'S NAME: E.A. Becker Apts.

CIRCLE: New Bldg.; Add'n; Remodel; TYPE OF BLDG.: SFD. APT. PUBLIC COMM.

CONTRACTOR'S NAME: Denton Electric Co. STATE LICENSE # 9750 CITY LICENSE # C11-249

NUMBER	FIXTURE OR INSTALLATION	UNIT PRICE	
10	Fixture or sockets	.15	1.50
42	Light, receptacle or switch outlet	.20	8.40
	Wall or ceiling space heater	.35	
	Blast coil heater per kilowatt	.35	
1	Garbage grinder outlet	.35	.35
1	Dishwasher outlet	.35	.35
1	Clothes dryer outlet	.35	.35
1	Automatic clothes washer	.35	.35
1	Electric range outlet	.35	.35
1	Electric water heater outlet	.35	.35
	Mercury arc lamp and equipment	.35	
	Special purpose outlet	.35	
	X-ray unit and its appurtenances	5.00	
	Watts of festoon lighting (Watts) First 3,000 watts	4.00	
	for each additional thousand watts	1.50	
	Horsepower — all motors first horsepower or less	1.75	
	for each additional horsepower	.35	
	Temporary power and lights (temporary pole)	4.00	
1	Electric service (including any single meter socket)	3.00	
	for each additional socket	.35	3.00
1	Air conditioning service 60 amps	1.50	1.50
	Each KW (KVA) Generator (Transformer) (Welder) KW (KVA)	2.00	
	First 100 KVA — For each additional KW (KVA)	.01	
	Special inspection per hour	4.00	
	Speaker outlets	.15	
	Signal or Alarm outlets	.15	
	Amplifiers	.50	
	Control panels	.25	
	T. V. outlets — master system only	.15	
	Radio outlets	.15	
	Main control racks	1.00	
	T. V. and Radio antennas — master system only	.75	
	Minimum fee for any permit	4.00	
	<b>Total fee</b>		<b>16.50</b>

I hereby certify that I have carefully examined and read the above application; that the same is true and correct; and that the work herein described is to be done in accordance with all the provisions of the applicable Ordinances of the City of Las Vegas, Nevada and State laws whether herein specified or not.

SIGNED E.H. Denton DATE 8-11-72  
MASTER (ELECTRICIAN) (TECHNICIAN) (OWNER)  
 BUILDING DEPARTMENT M. J. Miller DATE 8-11-72  
 #12860 PERMIT NO. 3892 PERMIT FEE: \$ 16.50

**RECEIPT**  
 2099 \$016.50 - 6  
 CITY OF LAS VEGAS  
 DEPT. OF BUILDING & SAFETY  
 MUST BE MACHINE VALIDATED  
 11 AUG 72

D. Early August 13, 1980

**CITY OF LAS VEGAS, NEVADA**  
**DEPARTMENT OF BUILDING & SAFETY — AIR CONDITIONING APPLICATION & PERMIT**

ADDRESS OF CONSTRUCTION: 6237 Washington OWNER'S NAME: Charleston Heights Townhomes 29-5

CIRCLE: Addition; Remodel; New Bldg; TYPE OF BLDG.: SFD APT. COMM. PUBLIC

CONTRACTOR'S NAME: Keno Refrigeration STATE LICENSE 10681 CITY LICENSE C11725-2-09702

UNITS	DESCRIPTION	FEE	TOTAL	UNITS	DESCRIPTION	FEE	TOTAL
	Unit heater — floor, wall or suspended	4.00			<b>EVAPORATIVE COOLERS:</b>		
	<b>FOR EACH FORCED AIR OR GRAVITY-TYPE FURNACE OR BURNER INCLUDING DUCTS AND VENT ATTACHED TO SUCH APPLIANCES:</b>				5 outlets or under	3.00	
	Up to and including 100,000 B.t.u.'s	4.00			Over 5 and up to and including 10	5.00	
	Over 100,000 B.t.u.'s	6.00			Each additional outlet over 10	.25	
	<b>FOR EACH HEATING APPLICATION, REFRIGERATION UNIT, COMFORT COOLING AND HEATING UNIT, ABSORPTION UNIT, COMPRESSOR OR BOILER:</b>				<b>VENTILATION:</b>		
	Up to and including 3 ton or horsepower, or absorption system up to and including 100,000 B.t.u.'s	4.00	<u>4.00</u>		For each fan connected to a single duct	1.00	
	Over 3 ton or 3 horsepower up to and including 10, or absorption system over 100,000 B.t.u.'s up to and including 250,000 B.t.u.'s	7.00			For each commercial or industrial ventilation system	5.00	
	Over 10 ton or 10 horsepower up to and including 30, or absorption system over 250,000 B.t.u.'s up to and including 1,000,000 B.t.u.'s	12.00			For each commercial kitchen hood	5.00	
	Over 30 ton or 30 horsepower up to and including 50, or absorption system over 1,000,000 B.t.u.'s up to and including 1,700,000 B.t.u.'s	20.00			<b>MISCELLANEOUS:</b>		
	Over 50 ton or 50 horsepower, or absorption system over 1,700,000 B.t.u.'s	30.00			For each water cooling tower	8.00	
	<b>FOR EACH AIR HANDLING UNIT INCLUDING DUCTS ATTACHED THERETO:</b>				Duct work only — each opening	.25	
	Up to and including 10,000 CFM	2.00			For installation or relocation of each commercial or industrial incinerator	15.00	
	Over 10,000 CFM	4.00			Gas piping related to the air cond. work in single family dwelling only	3.00	
					For each appliance, piece of equipment, any mechanical work or alteration or replacement not included in this schedule, the permit fee shall be computed the same as building permit fees by using the cost of installation for the valuation amount.		
					<b>FOR THE ISSUANCE OF EACH PERMIT</b>		<u>3.00</u>
					<b>TOTAL PERMIT FEE \$</b>		<u>7.00</u>

I hereby certify that I have carefully examined and read the above application; that the same is true and correct; and that the work herein described is to be done in accordance with all the provisions of the applicable Ordinances of the City of Las Vegas, Nevada and the State Laws, whether herein specified or not.

SIGNED Keno O'Leary Date 10-2-72  
Air Conditioning Contractor - Owner

BUILDING DEPARTMENT N. Miller Date 10-3-72

PERMIT NO. 2471 PERMIT FEE \$ 7.00

# 12890

**RECEIPT**

4487 \$007.00 - 4

CITY OF LAS VEGAS  
 DEPT. OF BUILDING & SAFETY  
 MUST BE MACHINE VALIDATED  
 - 3 OCT 72

*One Study* **18-73**

DEPT. of BLDG & SAFETY—CITY of LAS VEGAS, NEVADA

OWNER Becker & Sons ADDRESS 6237 Washington Ave. DATE 7-26-72  
 GEN CONT. Becker TYPE OF STRUCTURE SED  
 PERMIT NO. 6380 LEGAL DESCRIPTION 189 B 1 Charleston Heights 29-B

BUILDING	MECHANICAL	ELECTRICAL
LOCATION <u>298-7-72</u>	PLUMBING CONT <u>Becker</u>	TEMP POLE CONT
FIREPLACE PYS	PERMIT NO. <u>6060</u> DATE <u>8-8-72</u>	PERMIT NO. _____ DATE _____
FOOTINGS <u>298-7-72</u>	HEAT & VENT. AC CONT <u>Kins</u>	INSPECTION _____ DATE _____
FOUNDATION WALL <u>298-7-72</u>	PERMIT NO. <u>1471</u> DATE <u>10-3-71</u>	ELECTRICAL CONT <u>Becker</u>
FLOOR FRAMING	SEWER CONT. <u>Becker</u>	PERMIT NO. <u>3872</u> DATE <u>8-11-72</u>
SLAB <u>298-11-72</u>	PERMIT NO. <u>5830</u> DATE _____	FIXTURES CONT _____
CHIMNEY STEEL (FIREPLACE)	ROUGH SOIL <u>WEP 8-12-72</u>	SLAB _____
WALL STEEL	ROUGH WATER <u>WEP 8-12-72</u>	ROUGH <u>7-9-20-72</u>
COLUMN STEEL	TOP-OUT <u>WEP 10-4-72</u>	FINAL ROUGH _____
BEAM STEEL	ROUGH GAS _____	FINAL FIXTURE _____
FRAMING <u>298-11-72</u>	AC ROUGH DUCT <u>WEP 11-4-72</u>	FINAL ELECTRICAL <u>7-11-72-72</u>
ROOF SHEATHING <u>298-11-72</u>	REF ROUGH PIPING _____	TEMPORARY SERVICE _____
INTERIOR	FINAL PLUMBING <u>7-11-72</u>	MISCELLANEOUS _____
EXTERIOR	FINAL GAS _____	GRADING & DRAINAGE _____
BRICK WALL <u>2910-12-72</u>	FINAL AIR COND <u>7-11-72</u>	ON-SITE PARKING SPACES _____ APP. _____
LATHING <u>2910-12-72</u>	FINAL SEWER <u>WEP 8-25-72</u>	ENG APPROVAL OF _____
BACKING (SIDING) _____	FINAL SEPTIC TANK _____	OFF-SITE IMPROVEMENTS _____
PLASTER SCRATCH _____		
PLASTER BROWN _____		
URBAN REDEVELOPMENT APPROVAL _____		
FINAL BLDG _____ DATE _____		

APPROVED FOR OCCUPANCY & METER 2911-14-72 INSPECTOR \_\_\_\_\_ DATE \_\_\_\_\_  
 PLEASE NOTE REMARKS ON REVERSE SIDE LOG # \_\_\_\_\_ AREA # \_\_\_\_\_ 23.0

6237 Washington Ave. T29-3

DEPARTMENT OF BUILDING & SAFETY  
 CITY OF LAS VEGAS, NEVADA  
 OWNER Becker & Sons ADDRESS 6237 Washington Ave. KARDEX CARD  
 FENCE & RETAINING WALLS  
 DATE 7-26-72  
 CONTRACTOR Becker PERMIT NO. 6393  
 LOT 89 BLOCK 1 SUBDIVISION Charleton Heights 29-5 block fence

Fence (wire, wood, etc.)	Walls (masonry, rock, etc.)
Location _____	Location <u>298-7-72</u>
Final Inspection _____	Footing <u>298-7-72</u>
	Wall Steel 1st <u>298-7-72</u> 2d _____ 3d _____
	Final Inspection <u>298-7-72</u>
Retaining Wall (masonry)	Retaining Wall (concrete)
Location _____	Location _____
Footing _____	Footing _____
Wall Steel 1st _____ 2d _____ 3d _____	Wall Steel 1st _____ 2d _____ 3d _____
Bond Beam 1st _____ 2d _____ 3d _____	Final Inspection _____
Final Inspection _____	

23.14 B ADDRESS 6237 Washington Ave. LOG NO. \_\_\_\_\_ AREA \_\_\_\_\_