

6225 W. Washington

L-A Blk. 1 Sub. Charleston Hgts. 29-5 Zone RPD R-3 PUD

Early August 13, 1980

CITY OF LAS VEGAS, NEVADA

LOG NO. & AREA T-29-3 DEPARTMENT OF BUILDING & SAFETY CONST. VAL. \$ 16,050
APPLICATION & BUILDING PERMIT — for:
Dwellings, Duplexes, Misc. Residential Const.

ADDRESS OF CONSTRUCTION: 6225 Washington Avenue OWNER: BECKER & SONS

LOT(s) 95 BLOCK 1 SUBDIVISION Charleston Heights 29-5 ZONE: R-3 PUD

Existing structure on lot: Dwelling Accessory bldgs. Vacant lot Other

PROPOSED CONSTRUCTION: Single Family Residence USE: Same

MATERIALS OF CONSTRUCTION: Wood Frame Concrete Block Reinforced Concrete Steel Frame

SQ. FEET OF FLOOR AREAS: 1st 608 2nd 646 3rd _____ Other _____ TOTAL SQ. FT. 1254

FIRE ZONE: 1 2 3 Occupancy Group 1 J 1-2 CONST. TYPE: I II III IV V

ARCHITECT: BECKER BUILT ENGINEER: BECKER BUILT NO. of UNITS 1 NO. of STORIES 2

Plans Submitted: Yes No Calculations Submitted: Yes No Sewer Fee Req'd. Yes No

CONTRACTOR: BECKER BUILT STATE LICENSE #: 11092 CITY LICENSE #: C 11 520

ADD'L PERMITS REQ'D: Air Cond. Elec. Plumbing Signs Paving Fence Public Walks Curb-gutters
Incinerators Fire Sprinkling System

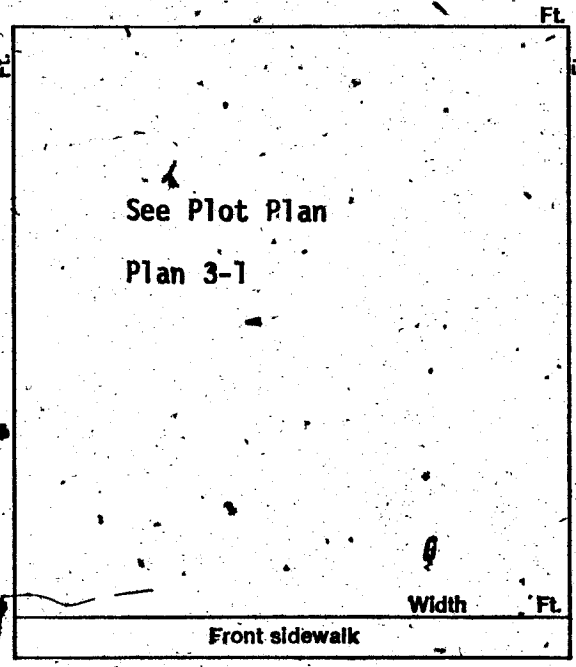

CONDITIONS OF THE PERMIT:

1. I agree to call the City Building Department for inspections before concrete is poured, before rough wiring, electrical, plumbing, framing is covered. Also for air conditioning, sheet-rock and sheathing inspection.
2. I agree that when the job is completed that I will call for final inspection before occupancy.
3. I agree to perform all construction in accordance with City Ordinances and Building Codes.
4. The Contractor's signature below denotes authority from the owner to sign in his behalf and that the owner is aware of all requirements of this application and permit. Separate permits must be taken out for work outlined above this agreement.
5. I have read and understand the contents of this application and permit; I hereby state that the information I have supplied on this application is true and correct.

SIGNED: _____ Contractor

BY: Ernest A. Becker, Jr. Agent or Owner

CLARK COUNTY HEALTH DEPT. _____ Date _____

LAS VEGAS FIRE DEPARTMENT _____ Date _____

PLANNING DEPT.: _____ Date: 9-12-72
PUBLIC WORKS DEPT.: _____ Date: 9-13
BUILDING DEPT.: _____ Date: 7-6-72
#12850 PERMIT NO.: 6386 PERMIT FEE \$ 70.00

RECEIPT

1135 \$070.00 - 8

CITY OF LAS VEGAS
DEPT. OF BUILDING & SAFETY

MUST BE MACHINE VALIDATED

27 JUL 72

Early August 13, 1980

CITY OF LAS VEGAS, NEVADA

LOG NO. & AREA

DEPARTMENT OF BUILDING & SAFETY

CONST. VAL. \$

300⁰⁰

APPLICATION & BUILDING PERMIT - for:
Fence, Wall, Retaining Wall.

ADDRESS OF CONSTRUCTION: 6225 Washington Avenue

OWNER: Becker & Sons

LOT(s) 95 BLOCK 1 SUBDIVISION

Charleston Heights 29-5

ZONE: R-3
PUD

Materials of Construction: Block Concrete Wire Wood Other

Yes No

ARCHITECT: BECKER BUILT

ENGINEER: BECKER BUILT

PLANS:

CALCS:

CONTRACTOR: BECKER BUILT

STATE LICENSE # 11092

CITY LICENSE # C 11 520

TOTAL SQUARE FEET: 300⁰⁰ TOTAL LINEAL FEET: 50

Remarks:
6' Block Wall

CONDITIONS OF THE PERMIT:

- Any type of retaining wall must be engineered by a Civil or Structural Engineer.
- If a home owner takes out the Building Permit and if the owner sublets the work to a Contractor, then the Contractor must take out the permit and pay for it.
- No fence or wall can be built on City property or rights-of-way, but this is not intended to preclude construction within utility easements if utilities will not be damaged or made inaccessible.
- The fence or wall shall not enclose any water meter, light standard, or fire alarm box and shall not come closer than 24" from the nearest fire hydrant outlet.
- Department inspectors must approve footings before concrete is poured and block wall reinforcing before grouting is done.
- Maximum height of any wall or fence is 6', side and rear yards; 4' maximum in front yard with the vertical surface above the height of 2' - 50% open.
- I must not obstruct required onsite parking space (1 space for each dwelling unit) by the erection of this fence or wall.
- By the signing of this application I herewith agree to the requirements outlined above.

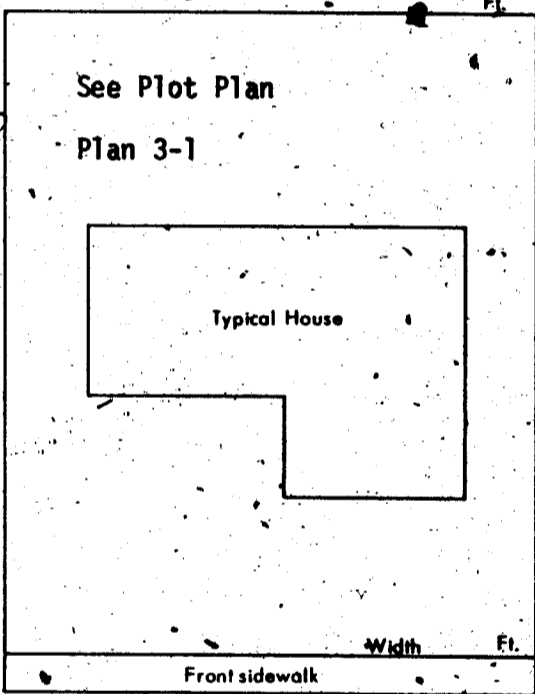

SIGNED:

DATE: 6/30/72

CONTRACTOR AGENT OWNER

PLANNING DEPT.: *JPA*

Date: 9-12-72

PUBLIC WORKS DEPT.:

Date:

BUILDING DEPT.:

Date: 7-6-72

#12850

PERMIT NO.: 6387

PERMIT FEE \$ 5⁰⁰

RECEIPT

1026 \$005.00 - 8

CITY OF LAS VEGAS
MUST BE MACHINE VANDATED
BUILDING & SAFETY

Y Early August 13, 1980.

CITY OF LAS VEGAS, NEVADA
DEPARTMENT OF BUILDING & SAFETY

RECEIPT
FOR
SEWER CONNECTION FEE

JOB ADDRESS: 6225 Washington Avenue OWNER'S NAME: BECKER & SONS
LOT 95 BLOCK 1 SUBDIVISION CHARLESTON HEIGHTS 29-5

QUANTITY	OCCUPANCY	UNIT FEE	AMOUNT
1	Single Family Residence		\$150.00

PAID BY: _____	TOTAL <u>\$150.00</u>
	Less Credit* _____
	TOTAL FEE \$ <u>150.00</u>

*Credit for existing sewer is applied to the new sewer connection fee based on previous type of occupancy and only when the new occupancy requires an additional fee.

This receipt does not authorize the owner or his representative to start any work without obtaining a plumbing permit.

DEPARTMENT OF BUILDING & SAFETY

7-10-72
DATE

RECEIPT NO. 5824 SEWER FEE \$ 150.00

#73102

RECEIPT
1030 \$150.00 - 3
CITY OF LAS VEGAS
DEPT. OF
BUILDING & SAFETY
MUST BE MACHINE VALIDATED
27 JUL 72

Early August 13, 1980

CITY OF LAS VEGAS, NEVADA

DEPARTMENT OF BUILDING & SAFETY - APPLICATION AND PERMIT FOR PLUMBING

ADDRESS OF CONSTRUCTION: 6275 Washington OWNER'S NAME: Becker

CIRCLE: New Bldg.; Add'n; Remodel; TYPE OF BLDG. SFD APT. PUBLIC COMM.

CONTRACTOR'S NAME: Bytner P lbg STATE LICENSE # _____ CITY LICENSE # 01201

UNITS	DESCRIPTION	FEE	TOTAL
1	Bathtub	1.00	1-
	Shower	1.00	
3	Lavatory	1.00	3-
2	Toilet	1.00	2-
	Urinal	1.00	
	Floor Drain	1.00	
	Floor Sink	1.00	
	Wash Tray	1.00	
1	Sink	1.00	1-
1	Garbage Disposal	1.00	1-
	Garbage Disposal (comm.)	3.00	
	Clothes Dryer (gas)	1.00	
1	Clothes Washer	1.00	1-
	Clothes Washer (comm.)	5.00	
1	Dishwasher	1.00	1-
	Dishwasher (commercial)	5.00	
	Dental Unit	10.00	
	Drinking Fountain	1.00	
	Any Water using Equipment	1.00	
1	Water Heater (gas/elect.)	1.00	1-
1	Sewer System - New, Replacement, or any Drainage System	4.00	7-
	Grease or Sand Trap	2.00	
	Trailer Trap	2.00	
	Septic Disposal System	4.00	
WATER SOFTENERS			
	Nonpermanent Type	4.00	
	Permanent Type (connected to Drainage)	5.00	
SWIMMING POOLS			
	Private or Wading Pool	10.00	
	Public or Semi-public	20.00	

UNITS	DESCRIPTION	FEE	TOTAL
WATER DISTRIBUTION SYSTEM			
1	Single Family Dwelling	4.00	4-
	Multiple Family Dwelling plus each unit	4.00	
	Bldg. Group "A" thru "G", per each floor	2.00	
	Hotel or Motel plus each bath	6.00	
	Trailer Park plus each space	4.00	
	Irrigation	1.50	
		20.00	
		1.00	
		4.00	
GAS PIPING SYSTEM			
	Single Family Dwelling	3.00	
	Multiple Family Dwelling plus each unit	6.00	
	Commercial Bldg. per floor plus each unit	1.00	6-
	Gas Appliance (any type)	3.00	
		3.00	
		1.00	
AUTOMATIC FIRE EXTINGUISHING SYSTEM			
	Underground Piping	10.00	
	Distribution Piping ea. ft.	.01	
	Sprinkler Head each	.10	
	In Range Hood and Vent	5.00	
DRY STANDPIPE SYSTEM			
	Piping	50.00	
	Each Outlet	1.00	
WET STANDPIPE SYSTEM			
	Piping	5.00	
	Fire Hose Cabinet	1.00	
	MINIMUM PERMIT FEE	4.00	
PIPELINE CONTRACTOR, SECT. 14-B.P.F. \$			
TOTAL PERMIT FEE \$ 19 ⁰⁰			

I hereby certify that I have carefully examined and read the above application, that the same is true and correct, and that the work herein described is to be done in accordance with all the provisions of the applicable Ordinances of the City of Las Vegas, Nevada and the State Laws, whether herein specified or not.

Signed Don S. Parker Date: 8-7-72
REGISTERED MASTER PLUMBER, SPEC. CONTR., OR OWNER

Building Department M. Miller Date: _____

#12870 Permit No. 6054 Permit Fee \$ 19⁰⁰

RECEIPT

1767 \$019.00 - 7

CITY OF LAS VEGAS
 DEPT. OF BUILDING & SAFETY

MUST BE MACHINE VALIDATED
 - 8 AUG 72

Y. Early August 13, 1980

CITY OF LAS VEGAS, NEVADA

DEPARTMENT OF BUILDING & SAFETY - ELECTRICAL APPLICATION & PERMIT

ADDRESS OF CONSTRUCTION: 6225 Washington Avenue

OWNER'S NAME: E.A. Becker Apts.

CIRCLE: New Bldg.; Add'n; Remodel; TYPE OF BLDG.: SFD. APT. PUBLIC COMM.

CONTRACTOR'S NAME: Denton Electric Co.

STATE LICENSE # 9750

CITY LICENSE # C11-249

NUMBER	FIXTURE OR INSTALLATION	UNIT PRICE	
10	Fixture or sockets	.15	1.50
45	Light, receptacle or switch outlet	.20	9.00
	Wall or ceiling space heater	.35	
	Blast coil heater per kilowatt	.35	
1	Garbage grinder outlet	.35	.35
1	Dishwasher outlet	.35	.35
1	Clothes dryer outlet	.35	.35
1	Automatic clothes washer	.35	.35
1	Electric range outlet	.35	.35
1	Electric water heater outlet	.35	.35
	Mercury arc lamp and equipment	.35	
	Special purpose outlet	.35	
	X-ray unit and its appurtenances	5.00	
	Watts of festoon lighting (Watts) First 3,000 watts for each additional thousand watts	4.00 1.50	
	Horsepower — all motors first horsepower or less for each additional horsepower	1.75 .35	
	Temporary power and lights (temporary pole)	4.00	
1	Electric service (including any single meter socket) for each additional socket	3.00 .35	3.00
1	Air conditioning service 60 amps	1.50	1.50
	Each KW (KVA) Generator (Transformer) (Welder) KW (KVA) First 100 KVA — For each additional KW (KVA)	2.00 .01	
	Special inspection per hour	4.00	
	Speaker outlets	.15	
	Signal or Alarm outlets	.15	
	Amplifiers	.50	
	Control panels	.25	
	T. V. outlets — master system only	.15	
	Radio outlets	.15	
	Main control racks	1.00	
	T. V. and Radio antennas — master system only	.75	
	Minimum fee for any permit	4.00	
	Total fee		17.10

I hereby certify that I have carefully examined and read the above application; that the same is true and correct; and that the work herein described is to be done in accordance with all the provisions of the applicable Ordinances of the City of Las Vegas, Nevada and State laws whether herein specified or not.

SIGNED E.H. Denton MASTER (ELECTRICIAN) (TECHNICIAN) (OWNER)

DATE 8-11-72

BUILDING DEPARTMENT T.M. Miller

DATE 8-11-72

#12860 PERMIT NO. 3886

PERMIT FEE: \$ 17.10

RECEIPT

2093 \$017.10 - 6

CITY OF LAS VEGAS DEPT. OF BUILDING & SAFETY

MUST BE MACHINE VALIDATED

11 AUG 72

Early August 13, 1980

CITY OF LAS VEGAS, NEVADA
DEPARTMENT OF BUILDING & SAFETY — AIR CONDITIONING APPLICATION & PERMIT

ADDRESS OF CONSTRUCTION: 6225 Washington OWNER'S NAME: Charleston Heights Townhouses 29-5

CIRCLE: Addition; Remodel; New Bldg; TYPE OF BLDG.: SFD APT. COMM. PUBLIC

CONTRACTOR'S NAME: Kerr's Refrigeration STATE LICENSE 10681 CITY LICENSE C-119252-09702

UNITS	DESCRIPTION	FEE	TOTAL	UNITS	DESCRIPTION	FEE	TOTAL
	Unit heater — floor, wall or suspended	4.00			EVAPORATIVE COOLERS:		
	FOR EACH FORCED-AIR OR GRAVITY-TYPE FURNACE OR BURNER INCLUDING DUCTS AND VENT ATTACHED TO SUCH APPLIANCES:				5 outlets or under	3.00	
	Up to and including 100,000 B.t.u.'s	4.00			Over 5 and up to and including 10	5.00	
	Over 100,000 B.t.u.'s	6.00			Each additional outlet over 10	.25	
	FOR EACH HEATING APPLICATION, REFRIGERATION UNIT, COMFORT COOLING AND HEATING UNIT, ABSORPTION UNIT, COMPRESSOR OR BOILER:				VENTILATION:		
	Up to and including 3 ton or horsepower, or absorption system up to and including 100,000 B.t.u.'s	4.00	4.00		For each fan connected to a single duct	1.00	
	Over 3 ton or 3 horsepower up to and including 10, or absorption system over 100,000 B.t.u.'s up to and including 250,000 B.t.u.'s	7.00			For each commercial or industrial ventilation system	5.00	
	Over 10 ton or 10 horsepower up to and including 30, or absorption system over 250,000 B.t.u.'s up to and including 1,000,000 B.t.u.'s	12.00			For each commercial kitchen hood	5.00	
	Over 30 ton or 30 horsepower up to and including 50, or absorption system over 1,000,000 B.t.u.'s up to and including 1,700,000 B.t.u.'s	20.00			MISCELLANEOUS:		
	Over 50 ton or 50 horsepower, or absorption system over 1,700,000 B.t.u.'s	30.00			For each water cooling tower	8.00	
	FOR EACH AIR HANDLING UNIT INCLUDING DUCTS ATTACHED THERETO:				Duct work only — each opening	.25	
	Up to and including 10,000 CFM	2.00			For installation or relocation of each commercial or industrial incinerator	15.00	
	Over 10,000 CFM	4.00			Gas piping related to the air cond. work in single family dwelling only	3.00	
					For each appliance, piece of equipment, any mechanical work or alteration or replacement not included in this schedule, the permit fee shall be computed the same as building permit fees by using the cost of installation for the valuation amount.		
					FOR THE ISSUANCE OF EACH PERMIT		3.00
					TOTAL PERMIT FEE \$		7.00

I hereby certify that I have carefully examined and read the above application; that the same is true and correct; and that the work herein described is to be done in accordance with all the provisions of the applicable Ordinances of the City of Las Vegas, Nevada and the State Laws, whether herein specified or not.

SIGNED Kerr's Date 10-2-72
 Air Conditioning Contractor - Owner

BUILDING DEPARTMENT J. Miller Date 10-3-72

PERMIT NO. 2465 PERMIT FEE \$ 7.00

RECEIPT

4481 \$007.00 - 4

CITY OF LAS VEGAS
 DEPT. OF BUILDING & SAFETY
 MUST BE MACHINE VALIDATED

- 3 OCT 72

* 12890

Early August 13, 1980

CITY OF LAS VEGAS, NEVADA

LOG NO. & AREA T-293 CONST. VAL. \$ 4680⁰⁰
 DEPARTMENT OF BUILDING & SAFETY APPLICATION & BUILDING PERMIT — for:
 Dwellings, Duplexes, Misc. Residential Const.
 ADDRESS OF CONSTRUCTION: 6225 Washington OWNER: Baker
 LOT(s) A BLOCK _____ SUBDIVISION CHARLESTON HEIGHTS 29-5 ZONE R2D
 Existing structure on lot: Dwelling Accessory bldgs. Vacant lot Other
 PROPOSED CONSTRUCTION: 20 X 126' CARPORT USE: _____
 MATERIALS OF CONSTRUCTION: Wood Frame Concrete Block Reinforced Concrete Steel Frame
 SQ. FEET OF FLOOR AREAS: 1st _____ 2nd _____ 3rd _____ Other _____ TOTAL SQ. FT. 3,120
 FIRE ZONE: 1 2 3 _____ Occupancy Group 1-1-2 CONST. TYPE: I II III IV V
 ARCHITECT: _____ ENGINEER: I.C.B.O. NO. of UNITS _____ NO. of STORIES _____
 Plans Submitted: Yes No Calculations Submitted Yes No Sewer Fee Req'd. Yes No
 CONTRACTOR: AAA BUILDING + SCULPT STATE LICENSE # 11248 CITY LICENSE # 122158
 ADD'L. PERMITS REQ'D: Air Cond. Elec. Plumbing Signs Paving Fence Public Walks Curb-gutters
 Incinerators Fire Sprinkling System

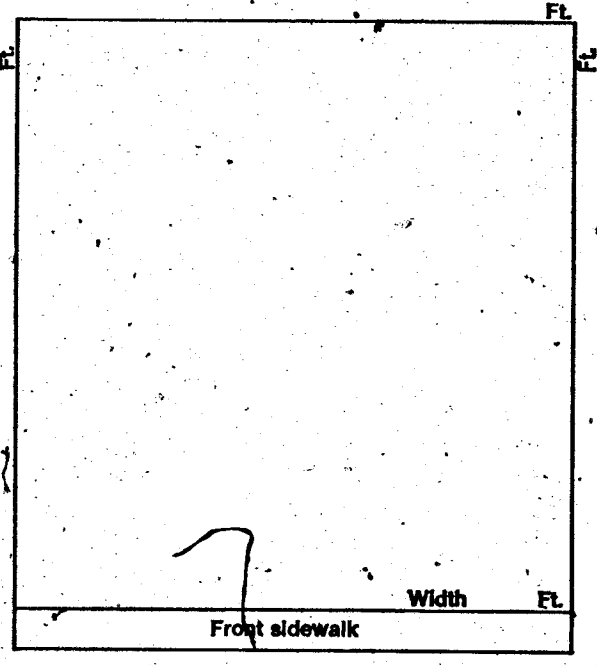

CONDITIONS OF THE PERMIT:

1. I agree to call the City Building Department for inspections before concrete is poured, before rough wiring, electrical, plumbing, framing is covered. Also for air conditioning, sheet-rock and sheathing inspection.
2. I agree that when the job is completed that I will call for final inspection before occupancy.
3. I agree to perform all construction in accordance with City Ordinances and Building Codes.
4. The Contractor's signature below denotes authority from the owner to sign in his behalf and that the owner is aware of all requirements of this application and permit. Separate permits must be taken out for work outlined above this agreement.
5. I have read and understand the contents of this application and permit; I hereby state that the information I have supplied on this application is true and correct.

SIGNED: AAA Building Co Contractor
 BY: Peter L. Koblack Agent or Owner

CLARK COUNTY HEALTH DEPT. _____ Date _____
 LAS VEGAS FIRE DEPARTMENT _____ Date _____

PLANNING DEPT.: _____ Date: 1-12-73
 PUBLIC WORKS DEPT.: _____ Date: _____
 BUILDING DEPT.: DMiller Date: 1-12-73
12850 PERMIT NO.: 8799 PERMIT FEE \$ 3300

RECEIPT
 9037 \$033.00 - 8
 CITY OF LAS VEGAS
 DEPT. OF BUILDING & SAFETY
 MUST BE MACHINE VALIDATED
 15 JAN 73

Don Hooley

1148-23

DEPT. of BLDG & SAFETY - CITY of LAS VEGAS, NEVADA

OWNER Becker ADDRESS 6225 Washington DATE 1-12-73
GEN CONT. AAA Awning & Screen TYPE OF STRUCTURE carport
PERMIT NO. 8799 LEGAL DESCRIPTION

BUILDING	MECHANICAL	ELECTRICAL
LOCATION <u>BWP 24-13</u>	PLUMBING CONT.	TEMP. POLE CONT.
FIREPLACE FTG.	PERMIT NO. _____ DATE _____	PERMIT NO. _____ DATE _____
FOOTINGS <u>Bul-21-B</u>	HEAT & VENT. AC CONT.	INSPECTION _____ DATE _____
FOUNDATION WALL	PERMIT NO. _____ DATE _____	ELECTRICAL CONT. _____
FLOOR FRAMING	SEWER CONT.	PERMIT NO. _____ DATE _____
SLAB	PERMIT NO. _____ DATE _____	FIXTURES CONT.
CHIMNEY STEEL (FIREPLACE)	ROUGH SOL.	PERMIT NO. _____ DATE _____
WALL STEEL	ROUGH WATER	SLAB _____
COLUMN STEEL	TOP-OUT	ROUGH _____
BEAM STEEL	ROUGH GAS	FINAL ROUGH _____
FRAMING	AC ROUGH DUCT	FINAL FIXTURE _____
ROOF SHEATHING	REF. ROUGH PIPING	FINAL ELECTRICAL _____
INTERIOR _____	FINAL PLUMBING _____	TEMPORARY SERVICE _____
EXTERIOR _____	FINAL GAS _____	
DRYWALL _____	FINAL AIR COND. _____	
LATHING _____	FINAL REFRIG. _____	
BACKING (SIENNA) _____	FINAL SEWER _____	
PLASTER SCRATCH _____	FINAL SEPTIC TANK _____	
BROWN _____		
URBAN REDEVELOPMENT APPROVAL _____		
FINAL BLDG _____ DATE _____		

APPROVED FOR OCCUPANCY & METER 09-1-26-73 INSPECTOR _____ DATE _____
PLEASE NOTE REMARKS ON REVERSE SIDE LOG # _____ AREA # _____ ES.0

6225 Washington

DEPT. of BLDG & SAFETY - CITY of LAS VEGAS, NEVADA

OWNER Becker & Sons ADDRESS 6225 Washington Ave. DATE 7-26-72
GEN CONT. Becker TYPE OF STRUCTURE SFD
PERMIT NO. 6386 LEGAL DESCRIPTION L95 B I Charleston Heights 29-5

BUILDING	MECHANICAL	ELECTRICAL
LOCATION <u>29-5-72</u>	PLUMBING CONT. <u>Bigelow</u>	TEMP. POLE CONT.
FIREPLACE FTG.	PERMIT NO. <u>6024</u> DATE <u>8-4-72</u>	PERMIT NO. _____ DATE _____
FOOTINGS <u>19-8-72</u>	HEAT & VENT. AC CONT. <u>Becker Ref</u>	INSPECTION _____ DATE _____
FOUNDATION WALL <u>29-5-72</u>	PERMIT NO. <u>2462</u> DATE <u>10-3-72</u>	ELECTRICAL CONT. <u>Donator</u>
FLOOR FRAMING	SEWER CONT. <u>Becker</u>	PERMIT NO. <u>3856</u> DATE <u>8-11-72</u>
SLAB <u>17-4-72</u>	PERMIT NO. <u>5824</u> DATE _____	FIXTURES CONT.
CHIMNEY STEEL (FIREPLACE)	ROUGH SOL. <u>W.P.S. 15-72</u>	PERMIT NO. _____ DATE _____
WALL STEEL	ROUGH WATER <u>W.P.S. 15-72</u>	SLAB _____
COLUMN STEEL	TOP-OUT <u>W.P.S. 15-72</u>	ROUGH <u>19-9-20-72</u>
BEAM STEEL	ROUGH GAS _____	FINAL ROUGH _____
FRAMING	AC ROUGH DUCT <u>10-4-72</u>	FINAL FIXTURE _____
ROOF SHEATHING	REF. ROUGH PIPING _____	FINAL ELECTRICAL <u>19-11-72</u>
INTERIOR _____	FINAL PLUMBING <u>Jul 11-9-72</u>	TEMPORARY SERVICE _____
EXTERIOR _____	FINAL GAS _____	
DRYWALL <u>11-17-72</u>	FINAL AIR COND. <u>Jul 11-9-72</u>	
LATHING _____	FINAL REFRIG. _____	
BACKING (SIENNA) _____	FINAL SEWER <u>W.P.S. 15-72</u>	
PLASTER SCRATCH _____	FINAL SEPTIC TANK _____	
BROWN _____		
URBAN REDEVELOPMENT APPROVAL _____		
FINAL BLDG _____ DATE _____		

APPROVED FOR OCCUPANCY & METER 09-11-17-72 INSPECTOR _____ DATE _____
PLEASE NOTE REMARKS ON REVERSE SIDE LOG # _____ AREA # _____ ES.04

6225 Washington Ave.

T 29-3

Don Hooley 11-18-23

DEPARTMENT OF BUILDING & SAFETY
CITY OF LAS VEGAS, NEVADA

KARDEX CARD
FENCE & RETAINING
WALLS

OWNER Becker & Sons ADDRESS 6225 Washington Ave. DATE 7-26-72

CONTRACTOR Becker PERMIT NO. 6387

LOT 95 BLOCK 1 SUBDIVISION Charleson Heights 29-5" block fence

Fence (wire, wood, etc.)	Walls (masonry, rock, etc.)
Location _____	Location <u>29 E 272</u>
Final Inspection _____	Footings <u>29 E 272</u>
	Wall Steel 1st <u>29 E 272</u> 2d _____ 3d _____
	Final Inspection <u>29 E 272</u>
Retaining Wall (masonry)	Retaining Wall (concrete)
Location _____	Location _____
Footings _____	Footings _____
Wall Steel 1st _____ 2d _____ 3d _____	Wall Steel 1st _____ 2d _____ 3d _____
Bond Beam 1st _____ 2d _____ 3d _____	Final Inspection _____
Final Inspection _____	

23.14.B ADDRESS 6225, Washington Ave. LOG NO. _____ AREA _____