

5601 W. Washington

None

Florida City August 11, 1980

CITY OF LAS VEGAS, NEVADA

LOG NO. & AREA

DEPARTMENT OF BUILDING & SAFETY

CONST. VAL. \$ 2880⁰⁰

APPLICATION & BUILDING PERMIT — for: Fence, Wall, Retaining Wall.

ADDRESS OF CONSTRUCTION:

5600 W. Washington Ave

OWNER: Beasley Dev.

LOT(s)

BLOCK

SUBDIVISION

Ridge

ZONE: R-PD7

Materials of Construction:

Block

Concrete

Wire

Wood

Other

Yes

No

PLANS:

ARCHITECT:

ENGINEER:

CALCS:

CONTRACTOR:

J.H. Masonry

STATE

LICENSE #

2252

CITY

LICENSE #

TOTAL SQUARE FEET: 2880

TOTAL LINEAL FEET: 480

Remarks:

Remarks section with three empty lines.

CONDITIONS OF THE PERMIT:

1. Any type of retaining wall must be engineered by a Civil or Structural Engineer.
 2. If a home owner takes out the Building Permit and if the owner sublets the work to a Contractor, then the Contractor must take out the permit and pay for it.
 3. No fence or wall can be built on City property or rights-of-way, but this is not intended to preclude construction within utility easements if utilities will not be damaged or made inaccessible.
 4. The fence or wall shall not enclose any water meter, light standard, or fire alarm box and shall not come closer than 24" from the nearest fire hydrant outlet.
 5. Department inspectors must approve footings before concrete is poured and block wall reinforcing before grouting is done.
 6. Maximum height of any wall or fence is 6' side and rear yards; 4' maximum in front yard with the vertical surface above the height of 2' 50% open.
 7. I must not obstruct required onsite parking space (2 spaces for each dwelling unit) by the erection of this fence or wall.
- By the signing of this application I herewith agree to the requirements outlined above.

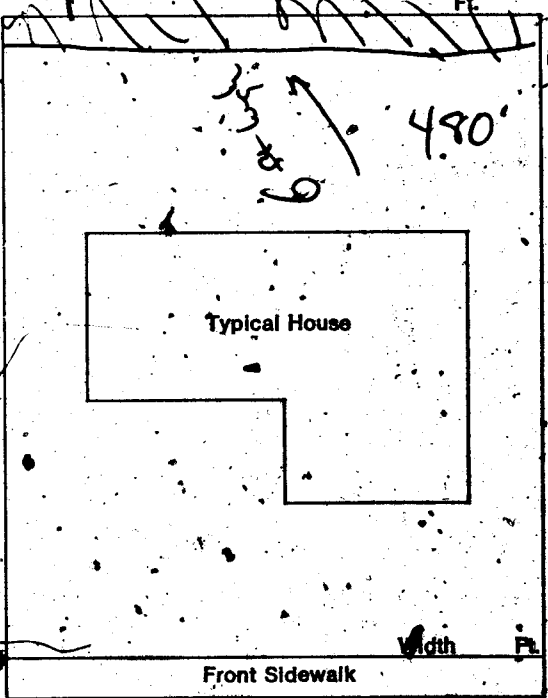

SIGNED:

Signature of J.H. Masonry

CONTRACTOR

AGENT

OWNER

DATE:

PLANNING DEPT:

Date:

4/22/74

PUBLIC WORKS DEPT:

Date:

4-22-74

BUILDING DEPT:

Date:

4-22-74

#12850

PERMIT NO:

16191

PERMIT FEE \$

18⁰⁰

RECEIPT

1117 501200 - 8

CITY OF LAS VEGAS
DEPT. OF
BUILDING & SAFETY

MUST BE MACHINE VALIDATED