

3820 W. Washington

L-38 B-3 Sub Twin Lakes C.C. Est #3

Bloria Ealy August 4, 1980

CITY OF LAS VEGAS, NEVADA  
DEPARTMENT OF BUILDING & SAFETY

PERMIT FEE \$ \_\_\_\_\_  
APPLICATION & PERMIT FOR  
PLUMBING

JOB ADDRESS: 3820 WASHINGTON OWNER'S NAME: FIRST WESTERN SAVINGS & LOAN

LOT \_\_\_\_\_ BLOCK \_\_\_\_\_ SUBDIVISION \_\_\_\_\_ Bldg. type: SFD  APT  COMM \_\_\_\_\_

Circle: New bldg; old bldg; Add'n; Remodel; Pool; Wtr. Sftner; Lawn Sprkr; Other \_\_\_\_\_

CONTRACTOR: JARAMILLO LANDSCAPE & SPR. CO. State Lic. # 19700 City Lic. # 1856

QUANTITY	FIXTURE OR INSTALLATION	Unit Price	AMOUNT
	Bathtub	1.00	
	Clothes dryer (gas)	1.00	
	Clothes washer	1.00	
	Dental unit	1.00	
	Dishwasher	1.00	
	Drinking fountain	1.00	
	Fire sprinkling - underground piping	5.00	
	Fire sprinkling - distribution piping per each foot	.01	
	Fire sprinkling heads - per each head	.10	
	Floor drain \$1.00 Floor sink	1.00	
	Gas appliance (any type)	1.00	
	Gas piping system - single family dwelling	3.00	
	Gas piping system - multiple family \$3 per each unit plus	1.00	
	Gas piping system - commercial bldg. per each floor	3.00	
	Grease trap	1.00	
	Irrigation system	4.00	4.00
	Lavatory	1.00	
	Minimum fee for any permit	4.00	
	Piping, Drainage	4.00	
	Sewer replacement	4.00	
	Septic disposal system - Health Dept. approval required	4.00	
	Shower	1.00	
	Sink - kitchen type	1.00	
	Swimming pool - private - wading pool	8.00	
	Swimming pool - public - semi-public	12.00	
	Toilet	1.00	
	Urinal	1.00	
	Water distribution system, single family dwelling	4.00	
	Water distribution system multiple dwg. \$4 + each unit	1.00	
	Water distribution system, Group "A" thru "C" per each floor	4.00	
	Water distribution system, Group "H" (hotel) \$4 + per bath*	.50	
	Water heater (gas) (electric)	1.00	
	Water using equipment	1.00	
	Water softener nonpermanent type	4.00	
	Water softener permanent (connected to drainage)	5.00	
	Wash tray	1.00	

I hereby certify that I have carefully examined & read the above application; that the same is true & correct; and the work herein described is to be done in accordance with the provisions of City of Las Vegas Ordinances & State Laws, whether herein specified or not. \* As defined in City Code and Ordinances.

TOTAL FEE \$ 4.00

SIGNED: P.D. Brown Date: 3-21-67  
Registered Plumber, Spec. Cont'r, Owner

Engineering Dept. Date \_\_\_\_\_  
Sewer Co'n. Fee \$ \_\_\_\_\_  
Paid in Engr. Dept. #1287  
PERMIT NO 2074 PERMIT FEE \$ 4.00

RECEIPT  
1337 \$004.00 - 7  
CITY OF LAS VEGAS  
DEPT. OF BUILDING & SAFETY  
Must be machine validated  
24 MAR 67

Bloria Ealy August 4, 1980

CITY OF LAS VEGAS, NEVADA

LOG NO. & AREA:                      CONST. VAL: \$ 202<sup>00</sup>  
 DEPARTMENT OF BUILDING & SAFETY APPLICATION & BUILDING PERMIT — for:  
 Fence, Wall, Retaining Wall.  
 ADDRESS OF CONSTRUCTION: 3820 Washington OWNER: F. S. Western  
 LOT(s) 38 BLOCK 3 SUBDIVISION Twin Lakes Cont. Club Est. #3 ZONE: R-1  
 Materials of Construction: Block  Concrete  Wire  Wood  Other  Yes No  
 ARCHITECT:                      ENGINEER:                      PLANS:    
 CONTRACTOR: Artistic Masonry Co STATE LICENSE # 8319 CITY LICENSE #                      CALCS:

TOTAL SQUARE FEET:                      TOTAL LINEAL FEET: 101'

Remarks:  
\_\_\_\_\_  
\_\_\_\_\_  
\_\_\_\_\_

CONDITIONS OF THE PERMIT:

1. Any type of retaining wall must be engineered by a Civil or Structural Engineer.
2. If a home owner takes out the Building Permit and if the owner sublets the work to a Contractor, then the Contractor must take out the permit and pay for it.
3. No fence or wall can be built on City property or rights-of-way, but this is not intended to preclude construction within utility easements if utilities will not be damaged or made inaccessible.
4. The fence or wall shall not enclose any water meter, light standard, or fire alarm box and shall not come closer than 24" from the nearest fire hydrant outlet.
5. Department Inspectors must approve footings before concrete is poured, and block wall reinforcing before grouting is done.
6. Maximum height of any wall or fence is 6', side and rear yards; 4' maximum in front yard with the vertical surface above the height of 2' — 50% open and further that facing within 25' of the intersection of curb faces on corner and through lots is limited to a maximum height of 30".
7. I must not obstruct required onsite parking space (1 space for each dwelling unit) by the erection of this fence or wall.
8. By the signing of this application I herewith agree to the requirements outlined above.

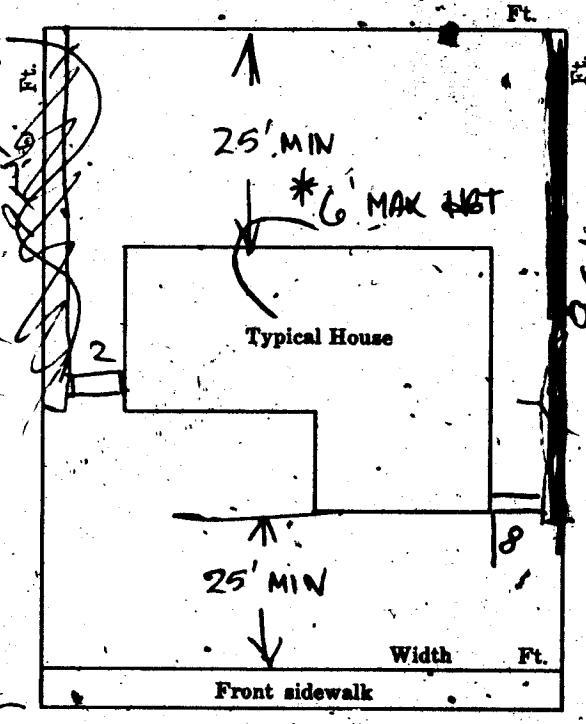

SIGNED: Harry Ealy DATE:                       
 CONTRACTOR  AGENT  OWNER

PLANNING DEPT:                      Date: 6-30-67  
 ENGINEERING DEPT:                      Date:                       
 BUILDING DEPT:                      Date: 6-30-67  
 #1285 PERMIT NO: 38041 PERMIT FEE \$ 4.00

RECEIPT  
 3660 \$004.00 — 3  
 CITY OF LAS VEGAS  
 DEPT. OF BUILDING & SAFETY  
 MUST BE MACHINE VALIDATED  
 30 JUN 67

*Don Hooley* 11-9-63

Department of Building & Safety  
City of Las Vegas, Nevada

Special Kardex  
Elec. only, Plbg only, A.C. only

Owner First Western Sav. & Lndress Address 3820 Washington Date: 3/24/67  
Contractor H. JARAMILLO Permit No. 20741  
Lot \_\_\_\_\_ Block \_\_\_\_\_ Subdivision \_\_\_\_\_

Electric Only	Plumbing Only	Heat & Vent. A. C. Only
Contractor _____	Contractor _____	Contractor _____
Permit No. _____	Permit No. _____	Permit No. _____
Slab _____	Rough Soil _____	A.C. Rough Duct _____
Rough Elect _____	Rough Water _____	Ref. Ro. Piping _____
Final Rough _____	Top Out _____	Rough Gas _____
Final Fixture _____	Rough Gas _____	Final Refrig _____
Final Elec _____	Final Plbg <u>Jacobs 3-31-67</u>	Final Air Cond _____
Temp. Service _____	Final Gas _____	Final Gas _____
	Final Sewer _____	
	Final Septic Tank _____	

23.06 D Address 3820 Washington Log No. \_\_\_\_\_ Irrig. Sys. \_\_\_\_\_ Area \_\_\_\_\_

DEPARTMENT OF BUILDING & SAFETY  
CITY OF LAS VEGAS, NEVADA

KARDEX CARD  
FENCE & RETAINING  
WALLS

OWNER J. St. Western ADDRESS 3820 Washington DATE 6/30/67

CONTRACTOR Artistic Masonry PERMIT NO. 38041

LOT 38 BLOCK 3 SUBDIVISION Twin Lakes Cont Club #3  
Block Fence

Fence (wire, wood, etc.)	Walls (masonry, rock, etc.)
Location _____	Location <u>Ag 6-30-67</u>
Final Inspection _____	Footing <u>Ag 6-30-67</u>
	Wall Steel 1st <u>Ag 7-26/2d</u> 3d _____
	Final Inspection <u>W.P. 8-14-67</u>
Retaining Wall (masonry)	Retaining Wall (concrete)
Location _____	Location _____
Footing _____	Footing _____
Wall Steel 1st _____ 2d _____ 3d _____	Wall Steel 1st _____ 2d _____ 3d _____
Bond Beam 1st _____ 2d _____ 3d _____	Final Inspection _____
Final Inspection _____	

23.14 B ADDRESS 3820 W. Washington AREA \_\_\_\_\_

Don Hooley 11-9-63

DEPT. of BLDG & SAFETY - CITY of LAS VEGAS, NEVADA  
 OWNER Barnette & Assoc. ADDRESS 3820 W. Washington DATE 3/18/63  
 GEN CONT. Viking Const. TYPE OF STRUCTURE SFD  
 PERMIT NO. 16785 LEGAL DESCRIPTION lot 38, block 3, Twin Lakes Country Club Est #3

BUILDING	MECHANICAL	ELECTRICAL
LOCATION _____	PLUMBING CONT. <u>Edman</u>	TEMP POLE CONT. _____
FIREPLACE FTS _____	PERMIT NO. <u>11847</u> DATE <u>5-24-63</u>	PERMIT NO. _____ DATE _____
FOOTINGS <u>1-5-28-63</u>	HEAT & VENT AC CONT. <u>Edman</u>	INSPECTION _____ DATE _____
FOUNDATION WALL _____	PERMIT NO. <u>8530</u> DATE <u>6-3-63</u>	ELECTRICAL CONT. <u>Dege &amp; Volney</u>
FLOOR FRAMING _____	SEWER CONT. <u>Edman</u>	PERMIT NO. <u>12301</u> DATE <u>6-2-63</u>
SLAB <u>1-17-63</u>	PERMIT NO. <u>11847</u> DATE <u>5-24-63</u>	FIXTURES CONT. <u>Dege &amp; Volney</u>
CHIMNEY STEEL (FIREPLACE) _____	ROUGH SOIL <u>WS 4-7-63</u>	PERMIT NO. <u>12301</u> DATE _____
WALL STEEL _____	ROUGH WATER <u>WS 6-7-63</u>	SLAB _____
COLUMN STEEL _____	TOP-OUT <u>WS 7-15-63</u>	ROUGH _____
BEAM STEEL _____	ROUGH GAS _____	FINAL ROUGH _____
FRAMING <u>1-18-63</u>	AC ROUGH DUCT <u>WS 8-8-63</u>	FINAL FIXTURE _____
ROOF SHEATHING _____	REF. ROUGH PIPING _____	FINAL ELECTRICAL <u>G.O. 1-10-64</u>
INTERIOR _____	FINAL PLUMBING <u>WP 11-22-63</u>	TEMPORARY SERVICE _____
EXTERIOR _____	FINAL GAS _____	MISCELLANEOUS _____
RYTHM WALL <u>WS 8-20-63</u>	FINAL AIR COND. <u>WS 1-28-64</u>	GRADING & DRAINAGE _____
CLAYING _____	FINAL REFRIG _____	ON-SITE PARKING SPACES _____ APP. _____
BACKING (SIDING) _____	FINAL SEWER <u>WS 8-8-63</u>	ENG APPROVAL OF _____
PLASTER SCRATCH _____	FINAL SEPTIC TANK _____	OFF-SITE IMPROVEMENTS _____
BROWN _____		
URBAN REDEVELOPMENT APPROVAL _____		
FINAL BLDG _____ DATE _____		

APPROVED FOR OCCUPANCY METER [Signature] INSPECTOR [Signature] DATE 1-26-64  
 PLEASE NOTE REMARKS ON REVERSE SIDE 3365 LDB # \_\_\_\_\_ AREA # \_\_\_\_\_ Z3.04  
 3820 W. Washington T-29 3