

3813 W. Washington

L-55 B-2 Sub Char Est #5

Blown Early August 4, 1980

Permit fee 1/3 of orig.

LOG NO. & AREA R-56/65 CITY OF LAS VEGAS, NEVADA Sec No 31502
CONST. VAL. \$ 21,748.00

DEPARTMENT OF BUILDING & SAFETY APPLICATION & BUILDING PERMIT — for:
Dwellings, Duplexes, Misc. Residential Const.

ADDRESS OF CONSTRUCTION: 3813 W. WASHINGTON OWNER: Small Building

LOT(S) 55 BLOCK 2 SUBDIVISION Charleston Estate #5 ZONE: R-1

Existing structure on lot: Dwelling Accessory bldgs. Vacant lot Other

PROPOSED CONSTRUCTION: S.F.D - Reactivation No USE: _____

MATERIALS OF CONSTRUCTION: Wood Frame Concrete Block Reinforced Concrete Steel Frame

SQUARE FEET OF FLOOR AREAS: 1st _____ 2nd _____ 3rd _____ Other _____ TOTAL SQ. FT. 1984 + 2 car

FIRE ZONE: 1 2 3 Occupancy Group A B C D E F G H I J-1-2-3-4-5 CONST. TYPE: I II III IV V Case 436

ARCHITECT: _____ ENGINEER: _____ NO. of UNITS: _____ NO. of STORIES: _____

Plans Submitted: Yes No Calculations Submitted Yes No Sewer Fee Req'd, Yes No

CONTRACTOR: E. A. BECKER STATE LICENSE # 3480 CITY LICENSE # 1248

ADD'L. PERMITS REQ'D: Air Cond. Elec. Plumbing Signs Paving Fence Public Walks Curb-gutters
Incinerators Fire Sprinkling System

See original application for Bldg Permit for PLOT PLAN

CONDITIONS OF THE PERMIT:

1. I agree to call the City Building Department for inspections before concrete is poured, before rough wiring, electrical, plumbing, framing is covered. Also for Air conditioning, sheet-rock and sheathing inspection.
2. I agree that when the job is completed that I will call for final inspection before occupancy.
3. I agree to perform all construction in accordance with City Ordinances and Building Codes.
4. The Contractor's signature below denotes authority from the owner to sign in his behalf and that the owner is aware of all requirements of this application and permit. Separate permits must be taken out for work outlined above this agreement.
5. I have read and understand the contents of this application and permit; I hereby state that the information I have supplied on this application is true and correct.

SIGNED: E. A. Becker Contractor

BY: [Signature] Agent or Owner

CLARK COUNTY HEALTH DEPT. Date _____
LAS VEGAS FIRE DEPARTMENT Date _____

PLANNING DEPT: Sec orig Date: _____
ENGINEERING DEPT: Sec orig Date: _____
BUILDING DEPT: [Signature] Date: 4/27/67
#1285 PERMIT NO: 37145 PERMIT FEE \$ 36.00

RECEIPT
2836 \$036.00 → 8.
CITY OF LAS VEGAS
DEPT. OF BUILDING & SAFETY
MUST BE MACHINE VALIDATED
28 APR 67

Storia Early August 4, 1980

CITY OF LAS VEGAS, NEVADA
DEPARTMENT OF BUILDING & SAFETY - ELECTRICAL APPLICATION & PERMIT

ADDRESS OF CONSTRUCTION: 3813 W. Washington OWNER'S NAME: SHAW BLDG Co.

LOT(S) _____ BLOCK _____ SUBDIVISION _____ Type of bldg. SFD Apt. Comm.

Check Proper Construction: New Bldg. Addn. Remodel Temporary Pole Old Bldg.

CONTRACTOR'S NAME: FRONTIER ELECTRIC STATE LICENSE # 7132 CITY LICENSE # 4819

NUMBER	FIXTURE OR INSTALLATION	UNIT PRICE	
			2,25
15	Fixture or sockets	.15	
57	Light, receptacle or switch outlet	.20	
	Wall or ceiling space heater	.35	
	Blast coil heater per kilowatt	.35	
1	Garbage grinder outlet	.35	.35
1	Dishwasher outlet	.35	.35
1	Clothes dryer outlet	.35	.35
1	Automatic clothes washer	.35	.35
1	Electric range outlet	.35	.35
1	Electric water heater outlet	.35	.35
	Mercury arc lamp and equipment	.35	
	Special purpose outlet	.35	
	X-ray unit and its appurtenances	5.00	
	Watts of festoon lighting (Watts) First 3,000 watts	4.00	
	for each additional thousand watts	1.50	
	Horsepower all motors first horsepower or less	1.75	
	for each additional horsepower	.35	
	Temporary power and lights (temporary pole)	2.00	
1	Electric service (including any single meter socket)	3.00	3.00
	for each additional socket	.35	
1	Air conditioning service amps	1.50	1.50
	Each KW (KVA) Generator (Transformer) (Welder) KW (KVA)	2.00	
	First 100 KVA - For each additional KW (KVA)	.01	
	Special inspection per hour	4.00	
	Speaker outlets	.15	
	Signal or Alarm outlets	.15	
	Amplifiers	.50	
	Control panels	.25	
	T. V. outlets - master system only	.15	
	Radio outlets	.15	
	Main control racks	1.00	
	T. V. and Radio antennas - master system only	.75	
	Minimum fee for any permit	4.00	
	Total fee		8.85

I hereby certify that I have carefully examined and read the above application; that the same is true and correct; and that the work herein described is to be done in accordance with all the provisions of the applicable ordinances of the City of Las Vegas, Nevada and State laws whether herein specified or not.

SIGNED: Ray J. Sisk Date: 5-17-67
MASTER (ELECTRICIAN) (TECHNICIAN) (OWNER)

BUILDING DEPARTMENT: John Repeagle Date: 5-17-67

#1286 PERMIT NO. 23201 PERMIT FEE: 8.85

RECEIPT
445 \$008.85 - 6
 CITY OF LAS VEGAS
 DEPT. OF BUILDING & SAFETY
 MUST BE MACHINE VALIDATED
 17 MAY 67

Gloria Ealy August 4, 1980

CITY OF LAS VEGAS, NEVADA
DEPARTMENT OF BUILDING & SAFETY

PERMIT FEE \$ 4.00
APPLICATION & PERMIT FOR
PLUMBING

JOB ADDRESS: 3813 Washington OWNER'S NAME: Mr. & Mrs. Ealy

LOT _____ BLOCK _____ SUBDIVISION _____ Bldg. type: SFD APT COMM
Circle: New bldg; Old bldg; Add'n; Remodel; Pool; Wtr. Sftner; Lawn Sprkr; Other _____

CONTRACTOR: P. Sedillo Landscape + Sprinkler State Lic. # 7029 City Lic. # 1111

QUANTITY	FIXTURE OR INSTALLATION	Unit Price	AMOUNT
	bathtub	1.00	
	clothes dryer (gas)	1.00	
	Clothes washer	1.00	
	Dental unit	1.00	
	Dishwasher	1.00	
	Drinking fountain	1.00	
	Fire sprinkling - underground piping	5.00	
	Fire sprinkling - distribution piping per each foot	.01	
	Fire sprinkling heads - per each head	.10	
	Floor drain \$1.00 Floor sink	1.00	
	Gas appliance (any type)	1.00	
	Gas piping system - single family dwelling	3.00	
	Gas piping system - multiple family \$3 per each unit plus	1.00	
	Gas piping system - commercial bldg. per each floor	3.00	
	Grease trap	1.00	
X	Irrigation system	4.00	4.00
	Lavatory	1.00	
	Minimum fee for any permit	4.00	
	Piping, Drainage	4.00	
	Sewer replacement	4.00	
	Septic disposal system - Health Dept. approval required	4.00	
	Shower	1.00	
	Sink - kitchen type	1.00	
	Swimming pool - private - wading pool	8.00	
	Swimming pool - public - semi-public	12.00	
	Toilet	1.00	
	Urinal	1.00	
	Water distribution system, single family dwelling	4.00	
	Water distribution system multiple dwg. \$4 + each unit	1.00	
	Water distribution system, Group "A" thru "G" per each floor	4.00	
	Water distribution system, Group "H" (hotel) \$4 + per bath*	.50	
	Water heater (gas) (electric)	1.00	
	Water using equipment	1.00	
	Water softener nonpermanent type	4.00	
	Water softener permanent (connected to drainage)	5.00	
	Wash tray	1.00	

I hereby certify that I have carefully examined & read the above application; that the same is true & correct; and the work herein described is to be done in accordance with the provisions of City of Las Vegas Ordinances & State Laws, whether herein specified or not. * As defined in City Code and Ordinances.

TOTAL FEE \$ 4.00

SIGNED: P. Sedillo Date: 9/12/67
Registered Plumber Spec. Cont'r. Owner

Engineering Dept. Date _____ Building Department Date _____
Sewer Conn. Fees _____
Paid in Engr. Dept. PERMIT NO. 21878 PERMIT FEE \$ 4.00
23.10 #1287

RECEIPT
638 \$004.00 - 2
CITY OF LAS VEGAS
DEPT. OF BUILDING & SAFETY
Must be machine validated
15 80-43

Glenn Ealy August 4, 1980

CITY OF LAS VEGAS, NEVADA

LOG NO. & AREA _____ CONST. VAL. \$ _____

DEPARTMENT OF BUILDING & SAFETY

APPLICATION & BUILDING PERMIT for: Fence, Wall, Retaining Wall.

ADDRESS OF CONSTRUCTION: 3813 W Washington OWNER: E. Beckner

LQT(s) 55 BLOCK 2 SUBDIVISION Charleston Estates Units ZONE: R-1

Materials of Construction: Block Concrete Wire Wood Other Yes No

ARCHITECT: _____ ENGINEER: _____ PLANS: CALCS:

CONTRACTOR: Fortune Fencing STATE LICENSE # 5906A CITY LICENSE # 8489

TOTAL SQUARE FEET: 180 TOTAL LINEAL FEET: 45

Remarks:

CONDITIONS OF THE PERMIT:

- 1. Any type of retaining wall must be engineered by a Civil or Structural Engineer.
2. If a home owner takes out the Building Permit and if the owner sublets the work to a Contractor, then the Contractor must take out the permit and pay for it.
3. No fence or wall can be built on City property or rights-of-way, but this is not intended to preclude construction within utility easements if utilities will not be damaged or made inaccessible.
4. The fence or wall shall not enclose any water meter, light standard, or fire alarm box and shall not come closer than 24" from the nearest fire hydrant outlet.
5. Department Inspectors must approve footings before concrete is poured and block wall reinforcing before grouting is done.
6. Maximum height of any wall or fence is 6', side and rear yards; 4' maximum in front yard with the vertical surface above the height of 2' - 50% open and further that fencing within 25' of the intersection of curb faces on corner and through lots is limited to a maximum height of 30".
7. I must not obstruct required onsite parking space (1 space for each dwelling unit) by the erection of this fence or wall.
8. By the signing of this application I herewith agree to the requirements outlined above.

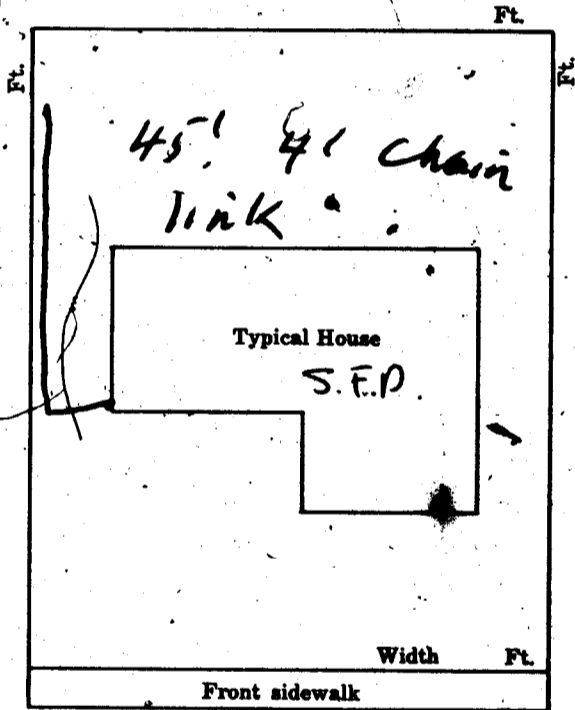

SIGNED: R M Beckner CONTRACTOR [checked] AGENT [] OWNER [] DATE: Sept 26 1980

PLANNING DEPT: Lernal Magula Date: 9-26-80
ENGINEERING DEPT: Date:
BUILDING DEPT: J. Wang Date: 9-26-80
PERMIT NO: 38852 PERMIT FEE: 3.00

RECEIPT
036 \$003.00 - 8
CITY OF LAS VEGAS
DEPT. OF BUILDING & SAFETY
MUST BE MACHINE VALIDATED
27 SEP 80

Done Hooley

11-9-63

DEPARTMENT OF BUILDING & SAFETY
CITY OF LAS VEGAS, NEVADA

KARDEX CARD
FENCE & RETAINING
WALLS

OWNER E. Becker ADDRESS 3813 W. Washington DATE 9/26/67

CONTRACTOR Fortune Fencing PERMIT NO. 38852

LOT 55 BLOCK 2 SUBDIVISION Charleston Estates #5
Wire Fence

Fence (wire, wood, etc.)	Walls (masonry, rock, etc.)
Location _____	Location _____
Final Inspection <u>By Miller 10-10-67</u>	Footings _____
	Wall Steel 1st _____ 2d _____ 3d _____
	Final Inspection _____
Retaining Wall (masonry)	Retaining Wall (concrete)
Location _____	Location _____
Footings _____	Footings _____
Wall Steel 1st _____ 2d _____ 3d _____	Wall Steel 1st _____ 2d _____ 3d _____
Bond Beam 1st _____ 2d _____ 3d _____	Final Inspection _____
Final Inspection _____	

23.14 B ADDRESS 3813 W. Washington LOG NO. _____ AREA _____

Department of Building & Safety
City of Las Vegas, Nevada

Special Kardex
Elec. only, Plbg. only, A.C. only

Owner Mr & Mrs Green Address 3813 Washington Date: 9-12-67

Contractor _____ Permit No. _____

Lot _____ Block _____ Subdivision _____

Electric Only	Plumbing Only	Heat & Vent. A. C. Only
Contractor _____	Contractor <u>Sedillo Landscape</u>	Contractor _____
Permit No. _____	Permit No. <u>21878</u>	Permit No. _____
Slab _____	Rough Soil _____	A.C. Rough Duct _____
Rough Elect _____	Rough Water _____	Ref. Ro. Piping _____
Final Rough _____	Top Out _____	Rough Gas _____
Final Fixture _____	Rough Gas _____	Final Refrig _____
Final Elec <u>Miller 9-14-67</u>	Final Plbg <u>Permit 9-18-67</u>	Final Air Cond _____
Temp. Service _____	Final Gas _____	Final Gas _____
	Final Sewer _____	
	Final Septic Tank _____	

23.06 D Address 3813 Washington Log No. _____ Area _____
irrigation system

Born Hovely

11-9-83

DEPT. of BLDG & SAFETY—CITY of LAS VEGAS, NEVADA

OWNER Snead Building ADDRESS 3813 W. Washington DATE 1/27/67
GEN CONT E.A. Becker TYPE OF STRUCTURE SFD
PERMIT NO 37115 LEGAL DESCRIPTION I 55 B 2 Charleston Estates #5

BUILDING	MECHANICAL	ELECTRICAL
LOCATION _____	PLUMBING CONT. _____	TEMP. POLE CONT. _____
FIREPLACE FTS. _____	PERMIT NO. _____ DATE _____	PERMIT NO. _____ DATE _____
FOOTINGS _____	HEAT & VENT. AC CONT. _____	INSPECTION _____ DATE _____
FOUNDATION WALL _____	PERMIT NO. _____ DATE _____	ELECTRICAL CONT. <u>Janice</u>
FLOOR FRAMING _____	SEWER CONT. _____	PERMIT NO. <u>13201</u> DATE <u>5-12-67</u>
SLAB _____	PERMIT NO. _____ DATE _____	FIXTURES CONT. <u>Janice</u>
CHIMNEY STEEL (FIREPLACE) _____	ROUGH SOIL _____	PERMIT NO. <u>13201</u> DATE <u>5-12-67</u>
WALL STEEL _____	ROUGH WATER _____	SLAB _____
COLUMN STEEL _____	TOP-OUT <u>WJ 5-24-67</u>	ROUGH <u>Miller 2-24-67</u>
BEAM STEEL _____	ROUGH GAS _____	FINAL ROUGH _____
FRAMING <u>24 7-31-67</u>	AC ROUGH DUCT <u>P 7-31-67</u>	FINAL FIXTURE _____
ROOF SHEATHING <u>WJ 5-23-67</u>	REF ROUGH PIPING _____	FINAL ELECTRICAL _____
INTERIOR _____	FINAL PLUMBING <u>WJ 9-14-67</u>	TEMPORARY SERVICE _____
EXTERIOR _____	FINAL GAS _____	MISCELLANEOUS
DRYWALL <u>CH 8-26-67</u>	FINAL AIR COND <u>WJ 9-14-67</u>	GRADING & DRAINAGE _____
LATHING _____	FINAL REFRIG _____	ON-SITE PARKING SPACES _____ APP. _____
BACKING (SIDING) _____	FINAL SEWER _____	ENG APPROVAL OF _____
PLASTER SCRATCH _____	FINAL SEPTIC TANK _____	OFF-SITE IMPROVEMENTS _____
BROWN _____		
URBAN REDEVELOPMENT APPROVAL _____		
FINAL BLDG <u>Hyman</u> DATE <u>9-14-67</u>		

APPROVED FOR OCCUPANCY & METER _____ INSPECTOR _____ DATE _____
PLEASE NOTE REMARKS ON REVERSE SIDE 3813 W. Washington Ave. LOG # _____ AREA # _____ 23.04

DEPT. of BLDG & SAFETY—CITY of LAS VEGAS, NEVADA

OWNER Snead Bldg. Co. ADDRESS 3813 Washington DATE 9/24/65
GEN CONT E. A. BECKER TYPE OF STRUCTURE S.F.D.
PERMIT NO 31502 LEGAL DESCRIPTION Lot 55, Blk 2, Chas. Estates #5

BUILDING	MECHANICAL	ELECTRICAL
LOCATION <u>CH 10-1-65</u>	PLUMBING CONT. <u>1329</u>	TEMP. POLE CONT. _____
FIREPLACE FTS. _____	PERMIT NO. <u>12715</u> DATE <u>11-8-65</u>	PERMIT NO. _____ DATE _____
FOOTINGS <u>CH 10-7-65</u>	HEAT & VENT. AC CONT. _____	INSPECTION _____ DATE _____
FOUNDATION WALL <u>HR 10-12-65</u>	PERMIT NO. _____ DATE _____	ELECTRICAL CONT. <u>Janice</u>
FLOOR FRAMING _____	SEWER CONT. <u>Big Town</u>	PERMIT NO. <u>20340</u> DATE <u>11-22-65</u>
SLAB _____	PERMIT NO. <u>12715</u> DATE <u>11-8-65</u>	FIXTURES CONT. <u>Janice</u>
CHIMNEY STEEL (FIREPLACE) <u>CH 10-7-65</u>	ROUGH SOIL _____	PERMIT NO. <u>20340</u> DATE <u>11-22-65</u>
WALL STEEL <u>CH 12-7-65</u>	ROUGH WATER _____	SLAB _____
COLUMN STEEL _____	TOP-OUT _____	ROUGH _____
BEAM STEEL _____	ROUGH GAS _____	FINAL ROUGH <u>WJ 1-31-67</u>
FRAMING _____	AC ROUGH DUCT _____	FINAL FIXTURE _____
ROOF SHEATHING _____	REF ROUGH PIPING _____	FINAL ELECTRICAL <u>WJ 6-9-66</u>
INTERIOR _____	FINAL PLUMBING _____	TEMPORARY SERVICE _____
EXTERIOR _____	FINAL GAS _____	MISCELLANEOUS
DRYWALL _____	FINAL AIR COND _____	GRADING & DRAINAGE _____
LATHING _____	FINAL REFRIG _____	ON-SITE PARKING SPACES _____ APP. _____
BACKING (SIDING) _____	FINAL SEWER _____	ENG APPROVAL OF _____
PLASTER SCRATCH _____	FINAL SEPTIC TANK _____	OFF-SITE IMPROVEMENTS _____
BROWN _____		
URBAN REDEVELOPMENT APPROVAL _____		
FINAL BLDG _____ DATE _____		

APPROVED FOR OCCUPANCY & METER _____ INSPECTOR _____ DATE _____
PLEASE NOTE REMARKS ON REVERSE SIDE 3813 Washington LOG # R56 AREA # _____ 3 23.0