

3801 W. Washington

L-52 B-2 Sub Char Est #5

Florida only August 4, 1980

CITY OF LAS VEGAS, NEVADA

LOG NO. & AREA T-18-14 CONST. VAL. \$ 22,420⁰⁰

DEPARTMENT OF BUILDING & SAFETY

APPLICATION & BUILDING PERMIT - for: Dwellings, Duplexes, Misc. Residential Const.

ADDRESS OF CONSTRUCTION: 3801 W. WASHINGTON OWNER: E.A. BECKER

LOT(s) 52 BLOCK 2 SUBDIVISION CHARLESTON EST. #15 ZONE: R-1

Existing structure on lot: Dwelling Accessory bldgs. Vacant lot Other ATTACH GARAGE

PROPOSED CONSTRUCTION: SINGLE FAMILY DWELLING USE: SAME

MATERIALS OF CONSTRUCTION: Wood Frame Concrete Block Reinforced Concrete Steel Frame

SQUARE FEET OF FLOOR AREAS: 1st 460 2nd 460 3rd 470 Other 210 TOTAL SQ. FT. 1800

FIRE ZONE: 1 2 3 Occupancy Group A B C D E F G H (D) 2-3-4-5 CONST. TYPE: I II III IV V

ARCHITECT: Earl Johnston ENGINEER: _____ NO. UNITS _____ NO. of STORIES 1

Plans Submitted: Yes No Calculations Submitted: Yes No Sewer Fee Req'd. Yes No

CONTRACTOR: ERNEST A. BECKER STATE LICENSE # 3480 CITY LICENSE # 1248

ADD'L. PERMITS REQ'D.: Air Cond. Elec. Plumbing Signs Paving Fence Public Walks Curb-gutters Incinerators Fire Sprinkling System

ONE KITCHEN ONLY
SEE PLOT PLAN
VALLEY VIEW B...

CONDITIONS OF THE PERMIT:

- 1. I agree to call the City Building Department for inspections before concrete is poured, before rough wiring, electrical, plumbing, framing is covered. Also for Air conditioning, sheet-rock and sheathing inspection.
- 2. I agree that when the job is completed that I will call for final inspection before occupancy.
- 3. I agree to perform all construction in accordance with City Ordinances and Building Codes.
- 4. The Contractor's signature below denotes authority from the owner to sign in his behalf and that the owner is aware of all requirements of this application and permit. Separate permits must be taken out for work outlined above this agreement.
- 5. I have read and understand the contents of this application and permit; I hereby state that the information I have supplied on this application is true and correct.

SIGNED: ERNEST A BECKER Contractor
BY: [Signature] Agent or Owner

CLARK COUNTY HEALTH DEPT. _____ Date _____
LAS VEGAS FIRE DEPARTMENT _____ Date _____

Washington
PLANNING DEPT: M.C. Date: 9-25-69
PUBLIC WORKS DEPT: [Signature] Date: 9-25
BUILDING DEPT: [Signature] Date: 9-29-69
PERMIT NO: 49474 PERMIT FEE \$ 112.50

RECEIPT
843 \$112.50
CITY OF LAS VEGAS
DEPT. OF BUILDING & SAFETY
MUST BE MACHINALLY MADE

Bloria Ealy August 4, 1980

CITY OF LAS VEGAS, NEVADA
DEPARTMENT OF BUILDING & SAFETY

SEWER CONNECTION FEE: \$ 150⁰⁰

RECEIPT
for
SEWER CONNECTION FEE

JOB ADDRESS: 3801 N. WASHWATER OWNER'S NAME: ERNEST A. BECKER

LOT 52 BLOCK 2 SUBDIVISION CHARLSTON ESTATES

QUANTITY	OCCUPANCY	UNIT FEE	AMOUNT
1	Sewer Conn - S.F.D.	150 ⁰⁰	150 ⁰⁰

TOTAL _____
 Less Credit* _____
 TOTAL FEE \$ 150⁰⁰

*Credit for existing sewer is applied to the new sewer connection fee based on previous type of occupancy and only when the new occupancy requires an additional fee.
 This receipt does not authorize the owner or his representative to start any work without obtaining a plumbing permit.

J. Williams 10-1-69
 DEPARTMENT OF BUILDING & SAFETY DATE

Receipt
 844 \$150.00 - 3
 CITY OF LAS VEGAS
 DEPT. OF
 BUILDING & SAFETY
 Must be machine validated
 OCT 69

73102 RECEIPT NO. 28057 SEWER FEE \$ 150⁰⁰

Gloria Ealy August 4, 1980

CITY OF LAS VEGAS, NEVADA

DEPARTMENT OF BUILDING & SAFETY - ELECTRICAL APPLICATION & PERMIT

ADDRESS OF CONSTRUCTION: 3801 West Washington OWNER'S NAME: E. A. Bishop

CIRCLE: New Bldg.; Add'n; Remodel; TYPE OF BLDG.: SFD. APT. PUBLIC COMM.

CONTRACTOR'S NAME: Dante Electric Co. STATE LICENSE: 9750 CITY LICENSE: CI-249

NUMBER	FIXTURE OR INSTALLATION	UNIT PRICE	
	Fixture sockets	.15	
	Light receptacle or switch outlet	.20	
	Wall ceiling space heater	.35	
	Blas heater per kilowatt	.35	
	Garbage grinder outlet	.35	
	Dishwasher outlet	.35	
	Clothes dryer outlet	.35	
	Automatic clothes washer	.35	
	Electric range outlet	.35	
	Electric water heater outlet	.35	
	Mercury arc lamp and equipment	.35	
	Special purpose outlet	.35	
	X-ray unit and its appurtenances	5.00	
	Watts of festoon lighting (Watts) First 3,000 watts for each additional thousand watts	4.00 1.50	
	Horsepower - all motors first horsepower or less for each additional horsepower	1.75 .35	
	Temporary power and lights (temporary pole)	4.00	4.00
	Electric service (including any single meter socket) for each additional socket	3.00 .35	
	Air conditioning service amps	1.50	
	Each KW (KVA) Generator (Transformer) (Welder) KW (KVA) First 100 KVA - For each additional KW (KVA)	2.00 .01	
	Special inspection per hour	4.00	
	Speaker outlets	.15	
	Signal or Alarm outlets	.15	
	Amplifiers	.50	
	Control panels	.25	
	T. V. outlets - master system only	.15	
	Radio outlets	.15	
	Main control racks	1.00	
	T. V. and Radio antennas - master system only	.75	4.00
	Minimum fee for any permit	4.00	
	Total fee		

I hereby certify that I have carefully examined and read the above application; that the same is true and correct; and that the work herein described is to be done in accordance with all the provisions of the applicable Ordinances of the City of Las Vegas, Nevada and State laws whether herein specified or not.

SIGNED E. A. Bishop DATE Oct. 16-69
(MASTER ELECTRICIAN) (TECHNICIAN) (OWNER)

BUILDING DEPARTMENT Janet Meyer DATE 10-21-69

#12860 PERMIT NO. 29044 PERMIT FEE: \$ 4.00

RECEIPT
 1969 \$004.00 - 6
 CITY OF LAS VEGAS
 DEPT. OF BUILDING & SAFETY
 MUST BE MACHINE VALIDATED
 2-1 OCT 69

Gloria Ealy August 4, 1980

CITY OF LAS VEGAS, NEVADA

DEPARTMENT OF BUILDING & SAFETY - APPLICATION AND PERMIT FOR PLUMBING

ADDRESS OF CONSTRUCTION: 3801 West Washington OWNER'S NAME: Becker Enterprises

CIRCLE: New Bldg. Add'n; Remodel; TYPE OF BLDG.: SFD. APT. PUBLIC COMM.

CONTRACTOR'S NAME: Big Town Plbg Co. STATE LICENSE # 3241A CITY LICENSE # _____

UNITS	DESCRIPTION	FEE	TOTAL
1	Bathtub	1.00	1.00
1	Shower	1.00	1.00
2	Lavatory	1.00	2.00
2	Toilet	1.00	2.00
	Urinal	1.00	
	Floor Drain	1.00	
	Floor Sink	1.00	
	Wash Tray	1.00	
1	Sink	1.00	1.00
1	Garbage Disposal	1.00	1.00
	Garbage Disposal (comm.)	3.00	
	Clothes Dryer (gas)	1.00	
1	Clothes Washer	1.00	1.00
	Clothes Washer (comm.)	5.00	
1	Dishwasher	1.00	1.00
	Dishwasher (commercial)	5.00	
	Dental Unit	10.00	
	Drinking Fountain	1.00	
	Any Water using Equipment	1.00	
1	Water Heater (gas) <u>(elect)</u>	1.00	1.00
1	Sewer System - New, Replacement, or any Drainage System	4.00	4.00
	Grease or Sand Trap	2.00	
	Trailer Trap	2.00	
	Septic Disposal System	4.00	
WATER SOFTENERS			
	Nonpermanent Type	4.00	
	Permanent Type (connected to Drainage)	5.00	
SWIMMING POOLS			
	Private or Wading Pool	10.00	
	Public or Semi-public	20.00	

UNITS	DESCRIPTION	FEE	TOTAL
WATER DISTRIBUTION SYSTEM			
1	Single Family Dwelling	4.00	4.00
	Multiple Family Dwelling plus each unit	4.00	
		2.00	
	Bldg. Group "A" thru "G" per each floor	6.00	
	Hotel or Motel plus each bath	4.00	
		1.50	
	Trailer Park plus each space	20.00	
		1.00	
	Irrigation	4.00	
GAS PIPING SYSTEM			
	Single Family Dwelling	3.00	
	Multiple Family Dwelling plus each unit	6.00	
		1.00	
	Commercial Bldg. per floor plus each unit	3.00	
		3.00	
	Gas Appliance (any type)	1.00	
AUTOMATIC FIRE EXTINGUISHING SYSTEM			
	Underground Piping	10.00	
	Distribution Piping ea. ft.	.01	
	Sprinkler Head each	.10	
	In Range Hood and Vent	5.00	
DRY STANDPIPE SYSTEM			
	Piping	50.00	
	Each Outlet	1.00	
WET STANDPIPE SYSTEM			
	Piping	5.00	
	Fire Hose Cabinet	1.00	
	MINIMUM PERMIT FEE	4.00	
TOTAL PERMIT FEE \$			<u>19.00</u>

I hereby certify that I have carefully examined and read the above application; that the same is true and correct; and that the work herein described is to be done in accordance with all the provisions of the applicable Ordinances of the City of Las Vegas, Nevada and the State Laws, whether herein specified or not.

Signed Ivan S. Perkins Date: 10-30-69
REGISTERED MASTER PLUMBER, SPEC. CONTR. OR OWNER

Building Department H. T. Eddy Date: 10-30-69

#12870 Permit No. 28359 Permit Fee \$ 19.00

RECEIPT
1383 \$019.00 - 7
CITY OF LAS VEGAS
DEPT. OF BUILDING & SAFETY
MUST BE MACHINE VALIDATED
- 3 NOV 69

Gloria Ealy August 4, 1980

CITY OF LAS VEGAS, NEVADA

DEPARTMENT OF BUILDING & SAFETY - ELECTRICAL APPLICATION & PERMIT

ADDRESS OF CONSTRUCTION: 3801 Washington OWNER'S NAME: E. A. Becker

LOT(S) _____ BLOCK _____ SUBDIVISION _____ Type of bldg. SFD Apt. Comm.

Check Proper Construction: New Bldg. Addn. Remodel Temporary Pole Old Bldg.

CONTRACTOR'S NAME: Denta Electric Co. STATE LICENSE # 9250 CITY LICENSE # C11-249

NUMBER	FIXTURE OR INSTALLATION	UNIT PRICE	
14	Fixture or sockets	.15	1.65
59	Light. receptacle or switch outlet	.20	11.80
	Wall or ceiling space heater	.35	
	Blast coil heater per kilowatt	.35	
1	Garbage grinder outlet	.35	.35
1	Dishwasher outlet	.35	.35
1	Clothes dryer outlet	.35	.35
1	Automatic clothes washer	.35	.35
1	Electric range outlet	.35	.35
1	Electric water heater outlet	.35	.35
	Mercury arc lamp and equipment	.35	
	Special purpose outlet	.35	
	X-ray unit and its appurtenances	5.00	
	Watts of festoon lighting (Watts) First 3,000 watts	4.00	
	for each additional thousand watts	1.50	
	Horsepower - all motors first horsepower or less	1.75	
	for each additional horsepower	.35	
	Temporary power and lights (temporary pole)	4.00	
1	Electric service (including any single meter socket)	3.00	3.00
	for each additional socket	.35	
1	Air conditioning service	1.50	1.50
	Each KW (KVA) Generator (Transformer) (Welder) KW (KVA)	2.00	
	First 100 KVA - For each additional KW (KVA)	.01	
	Special inspection per hour	4.00	
	Speaker outlets	.15	
	Signal or Alarm outlets	.15	
	Amplifiers	.50	
	Control panels	.25	
	T. V. outlets - master system only	.15	
	Radio outlets	.15	
	Main control racks	1.00	
	T. V. and Radio antennas - master system only	.75	
	Minimum fee for any permit	4.00	
	Total fee.		\$20.05

I hereby certify that I have carefully examined and read the above application; that the same is true and correct; and that the work herein described is to be done in accordance with all the provisions of the applicable Ordinances of the City of Las Vegas, Nevada and State laws whether herein specified or not.

SIGNED E. A. Becker Date Nov-12-69
(MASTER ELECTRICIAN) (TECHNICIAN) (OWNER)

BUILDING DEPARTMENT [Signature] Date 1-18-69

#1286 PERMIT NO. 29244 PERMIT FEE: \$ 20.05

RECEIPT

1992 \$020.05 - 6

CITY OF LAS VEGAS
 DEPT. OF BUILDING & SAFETY
 MUST BE MACHINE VALIDATED

18 NOV 69

Gloria Ealy August 4, 1980

CITY OF LAS VEGAS, NEVADA
DEPARTMENT OF BUILDING & SAFETY - AIR CONDITIONING APPLICATION & PERMIT

ADDRESS OF CONSTRUCTION: 3801 W. Washington OWNER'S NAME: Becker Enterprises

CIRCLE: Addition; Remodel; New Bldg; TYPE OF BLDG.: 3FD APT. COMM. PUBLIC

CONTRACTOR'S NAME: Rapid Ref. STATE LICENSE 9375 CITY LICENSE 11509

UNITS	DESCRIPTION	FEE	TOTAL	UNITS	DESCRIPTION	FEE	TOTAL
	Unit heater-floor, wall or suspended	4.00			EVAPORATIVE COOLERS:		
	FOR EACH FORCED-AIR OR GRAVITY-TYPE FURNACE OR BURNER INCLUDING DUCTS AND VENT ATTACHED TO SUCH APPLIANCES:				5 outlets or under	3.00	
	Up to and including 100,000 B.t.u.'s	4.00			Over 5 and up to and including 10	5.00	
	Over 100,000 B.t.u.'s	6.00			Each additional outlet over 10	.25	
	FOR EACH HEATING APPLICATION, REFRIGERATION UNIT, COMFORT COOLING AND HEATING UNIT, ABSORPTION UNIT, COMPRESSOR OR BOILER:				VENTILATION:		
	Up to and including 3 ton or horsepower, or absorption system up to and including 100,000 B.t.u.'s	4.00	4.00		For each fan connected to a single duct	1.00	^
	Over 3 ton or 3 horsepower up to and including 10, or absorption system over 100,000 B.t.u.'s up to and including 250,000 B.t.u.'s	7.00			For each commercial or industrial ventilation system	5.00	
	Over 10 ton or 10 horsepower up to and including 30, or absorption system over 250,000 B.t.u.'s up to and including 1,000,000 B.t.u.'s	12.00			For each commercial kitchen hood	5.00	
	Over 30 ton or 30 horsepower up to and including 50, or absorption system over 1,000,000 B.t.u.'s up to and including 1,700,000 B.t.u.'s	20.00			MISCELLANEOUS:		
	Over 50 ton or 50 horsepower, or absorption system over 1,700,000 Btu's	30.00			For each water cooling tower	8.00	
	FOR EACH AIR HANDLING UNIT INCLUDING DUCTS ATTACHED THERETO:				Duct work only-each opening	.25	2.00
	Up to and including 10,000 CFM	2.00			For installation or relocation of each commercial or industrial incinerator	15.00	
	Over 10,000 CFM	4.00			Gas piping related to the air cond. work in single family dwelling only	3.00	
					For each appliance, piece of equipment, any mechanical work or alteration or replacement not included in this schedule, the permit fee shall be computed the same as building permit fees by using the cost of installation for the valuation amount.		
					FOR THE ISSUANCE OF EACH PERMIT		3.00
					TOTAL PERMIT FEE \$	<u>9.00</u>	

I hereby certify that I have carefully examined and read the above application; that the same is true and correct; and that the work herein described is to be done in accordance with all the provisions of the applicable Ordinances of the City of Las Vegas, Nevada and the State Laws, whether herein specified or not.

SIGNED Chuck Ferris Date 11-17-69
 Air Conditioning Contractor - Owner

BUILDING DEPARTMENT J. Smith Date 11-20-69

PERMIT NO. 28127 PERMIT-FEE \$ 9.00

#12890

RECEIPT
 5116 \$009.00 - 4
 CITY OF LAS VEGAS
 DEPT. OF BUILDING & SAFETY
 MUST BE MACHINE VALIDATED

Gloria Ealy August 4, 1980

CITY OF LAS VEGAS, NEVADA

LOG NO. & AREA _____ CONST. VAL. \$ 510.00

DEPARTMENT OF BUILDING & SAFETY APPLICATION & BUILDING PERMIT — for:
Fence, Wall, Retaining Wall.

ADDRESS OF CONSTRUCTION: 3801 W. WASHINGTON OWNER: E. A. BECKER

LOT(s) 52 BLOCK 2 SUBDIVISION CHARLESTON ESTATES, N. 5 ZONE: R-1

Materials of Construction: Block Concrete Wire Wood Other Yes No
PLANS:

ARCHITECT: BUILDER ENGINEER: BUILDER CALCS:

CONTRACTOR: E. A. BECKER STATE LICENSE # 4035 CITY LICENSE # CH-3782

TOTAL SQUARE FEET: 8510 TOTAL LINEAL FEET: 102

Remarks:

CONDITIONS OF THE PERMIT:

1. Any type of retaining wall must be engineered by a Civil or Structural Engineer.
2. If a home owner takes out the Building Permit and if the owner sublets the work to a Contractor, then the Contractor must take out the permit and pay for it.
3. No fence or wall can be built on City property or rights-of-way, but this is not intended to preclude construction within utility easements if utilities will not be damaged or made inaccessible.
4. The fence or wall shall not enclose any water meter, light standard, or fire alarm box and shall not come closer than 24" from the nearest fire hydrant outlet.
5. Department Inspectors must approve footings before concrete is poured and block wall reinforcing before grouting is done.
6. Maximum height of any wall or fence is 6', side and rear yards; 4' maximum in front yard with the vertical surface above the height of 2' — 50% open and further that fencing within 25' of the intersection of curb faces on corner and through lots is limited to a maximum height of 30".
7. I must not obstruct required onsite parking space (1 space for each dwelling unit) by the erection of this fence or wall.
8. By the signing of this application I herewith agree to the requirements outlined above.

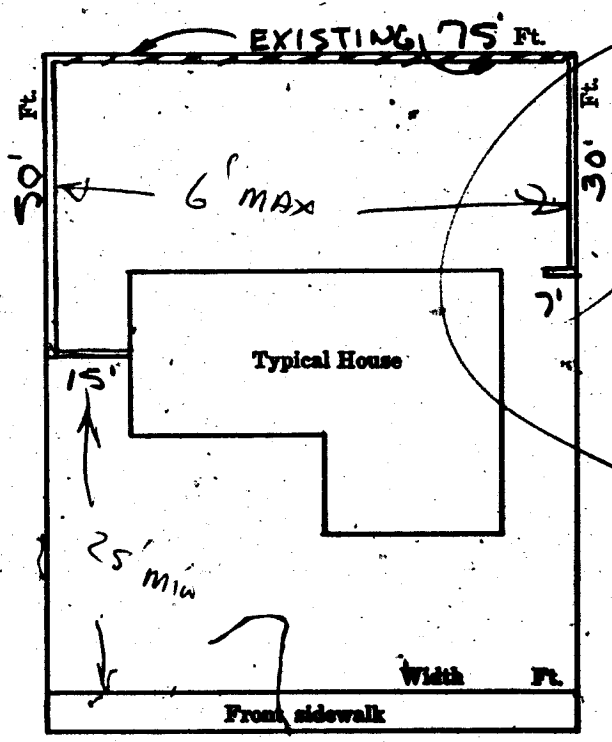

SIGNED: [Signature] DATE: 12-22-69
CONTRACTOR AGENT OWNER

PLANNING DEPT: [Signature] Date: 12/23/69
 ENGINEERING DEPT: [Signature] Date: _____
 BUILDING DEPT: [Signature] Date: 12/23/69
 #1285 PERMIT NO: 50505 PERMIT FEE \$ 600

RECEIPT
6580 \$006.00 — 8
 CITY OF LAS VEGAS
 DEPT. OF BUILDING & SAFETY
 MUST BE MACHINE VALIDATED
 24 DEC 69

Gloria Ealy August 4, 1980

CITY OF LAS VEGAS, NEVADA

DEPARTMENT OF BUILDING & SAFETY - APPLICATION AND PERMIT FOR PLUMBING

ADDRESS OF CONSTRUCTION: 3801 West Washington OWNER'S NAME: BECKER

CIRCLE: New Bldg.; Add'n; Remodel; TYPE OF BLDG.: SFD. APT. PUBLIC COMM.

CONTRACTOR'S NAME: PAT SEDILLO STATE LICENSE # 7029 CITY LICENSE # 1111

UNITS	DESCRIPTION	FEE	TOTAL
	Bathtub	1.00	
	Shower	1.00	
	Lavatory	1.00	
	Toilet	1.00	
	Urinal	1.00	
	Floor Drain	1.00	
	Floor Sink	1.00	
	Wash Tray	1.00	
	Sink	1.00	
	Garbage Disposal	1.00	
	Garbage Disposal (comm.)	3.00	
	Clothes Dryer (gas)	1.00	
	Clothes Washer	1.00	
	Clothes Washer (comm.)	5.00	
	Dishwasher	1.00	
	Dishwasher (commercial)	5.00	
	Dental Unit	10.00	
	Drinking Fountain	1.00	
	Any Water using Equipment	1.00	
	Water Heater (gas)(elect.)	1.00	
	Sewer System - New, Replacement, or any Drainage System	4.00	
	Grease or Sand Trap	2.00	
	Trailer Trap	2.00	
	Septic Disposal System	4.00	
WATER SOFTENERS			
	Nonpermanent Type	4.00	
	Permanent Type (connected to Drainage)	5.00	
SWIMMING POOLS			
	Private or Wading Pool	10.00	
	Public or Semi-public	20.00	

UNITS	DESCRIPTION	FEE	TOTAL
WATER DISTRIBUTION SYSTEM			
	Single Family Dwelling	4.00	
	Multiple Family Dwelling plus each unit	4.00 2.00	
	Bldg. Group "A" thru "G" per each floor	6.00	
	Hotel or Motel plus each bath	4.00 1.50	
	Trailer Park plus each space	20.00 1.00	
X	Irrigation	4.00	4.00
GAS PIPING SYSTEM			
	Single Family Dwelling	3.00	
	Multiple Family Dwelling plus each unit	6.00 1.00	
	Commercial Bldg. per floor plus each unit	3.00 3.00	
	Gas Appliance (any type)	1.00	
AUTOMATIC FIRE EXTINGUISHING SYSTEM			
	Underground Piping	10.00	
	Distribution Piping ea. ft.	.01	
	Sprinkler Head each	.10	
	In Range Hood and Vent	5.00	
DRY STANDPIPE SYSTEM			
	Piping	50.00	
	Each Outlet	1.00	
WET STANDPIPE SYSTEM			
	Piping	5.00	
	Fire Hose Cabinet	1.00	
	MINIMUM PERMIT FEE	4.00	4.00
		00	
	TOTAL PERMIT FEE \$	4	

I hereby certify that I have carefully examined and read the above application; that the same is true and correct; and that the work herein described is to be done in accordance with all the provisions of the applicable Ordinances of the City of Las Vegas, Nevada and the State Laws, as herein specified or not.

Signed Pat Sedillo Date: 1/14/70
REGISTERED MASTER PLUMBER, SPEC. CONT'R. OR OWNER

Building Department N. Smith Date: 1/14/70
29073
 #12870 Permit No. 29073 Permit Fee \$ 4.00

RECEIPT
 7483 \$004.00 - 7

CITY OF LAS VEGAS
 DEPT. OF BUILDING & SAFETY

MUST BE MACHINE VALIDATED
 14 JAN 70

Home Agency 11-9-83

DEPT. of BLDG & SAFETY—CITY of LAS VEGAS, NEVADA

OWNER E. A. Becker ADDRESS 3801 W. Washington DATE 10/1/69
 GEN CONT. Same TYPE OF STRUCTURE SFD
 PERMIT NO. 40474 LEGAL DESCRIPTION L 52 B 2 Charleston Estates #5

BUILDING	MECHANICAL	ELECTRICAL
LOCATION _____	PLUMBING CONT. <u>10/20/69</u>	TEMP. POLE CONT. _____
FIREPLACE FTS _____	PERMIT NO. <u>28370</u> DATE <u>10/20/69</u>	PERMIT NO. <u>29094</u> DATE <u>10-21-69</u>
FOOTINGS <u>10/28/69 12-31-69</u>	HEAT & VENT. AC CONT. <u>10/20/69</u>	INSPECTION _____ DATE _____
FOUNDATION WALL _____	PERMIT NO. _____ DATE <u>11-20-69</u>	ELECTRICAL CONT. _____
FLOOR FRAMING _____	SEWER CONT. <u>E. A. Becker</u>	PERMIT NO. <u>29294</u> DATE <u>11/16/69</u>
SLAB <u>11-1-69</u>	PERMIT NO. <u>RR 28051</u> DATE <u>10/1/69</u>	FIXTURES CONT. _____
CHIMNEY STEEL (FIREPLACE) _____	ROUGH SOIL <u>11/3/69</u>	PERMIT NO. _____ DATE _____
WALL STEEL _____	ROUGH WATER <u>11/3/69</u>	SLAB _____
COLUMN STEEL _____	TOP-OUT _____	ROUGH <u>11-19-69</u>
BEAM STEEL _____	ROUGH GAS _____	FINAL ROUGH _____
FRAMING <u>11-21-69</u>	AC ROUGH DUCT <u>11-20-69</u>	FINAL FIXTURE _____
ROOF SHEATHING _____	REF. ROUGH PIPING _____	FINAL ELECTRICAL <u>11-19-70</u>
DRYWALL _____	FINAL PLUMBING _____	TEMPORARY SERVICE _____
LATHING _____	FINAL GAS _____	
BACKING (SHEATH) _____	FINAL AIR COND. <u>11-13-70</u>	
PLASTER _____	FINAL REFRIG. _____	
URBAN REDEVELOPMENT APPROVAL _____	FINAL SEWER <u>11-13-69</u>	
FINAL BL. <u>11-13-70</u> DATE <u>1-13-70</u>	FINAL SEPTIC TANK _____	

APPROVED FOR OCCUPANCY & METER 11-13-70 INSPECTOR _____ DATE _____
 PLEASE NOTE REMARKS ON REVERSE SIDE 3801 W. Washinton LOG # T-18 AREA # 4 23.04

**DEPARTMENT OF BUILDING & SAFETY
CITY OF LAS VEGAS, NEVADA**

**KARDEX CARD
FENCE & RETAINING
WALLS**

OWNER E. A. BECKER ADDRESS 3801 West Washington DATE 12/24/69
 CONTRACTOR E. A. BECKER PERMIT NO. 50505
 LOT 52 BLOCK 2 SUBDIVISION Chas. Estates #5
 Block fence

Fence (wire, wood, etc.)	Walls (masonry, rock, etc.)
Location _____	Location _____
Final Inspection _____	Footing _____
	Wall Steel 1st _____ 2d _____ 3d _____
	Final Inspection <u>12-22-70</u>
Retaining Wall (masonry)	Retaining Wall (concrete)
Location _____	Location _____
Footing _____	Footing _____
Wall Steel 1st _____ 2d _____ 3d _____	Wall Steel 1st _____ 2d _____ 3d _____
Bond Beam 1st _____ 2d _____ 3d _____	Final Inspection _____
Final Inspection _____	

23.14 B ADDRESS 3801 West Washington AREA _____

Done Hively 11-9-83

Department of Building & Safety
City of Las Vegas, Nevada

Special Kardex
Elec. only, Plbg. only, A.C. only

Owner Becker Address 3801 W. Washington Date: 1-14-70
Contractor _____ Permit No. _____
Lot _____ Block _____ Subdivision _____

Electric Only	Plumbing Only	Heat & Vent. A. C. Only
Contractor _____	Contractor <u>Pat Sedillo</u>	Contractor _____
Permit No. _____	Permit No. <u>29073</u>	Permit No. _____
Slab _____	Rough Soil _____	A.C. Rough Duct _____
Rough Elect _____	Rough Water _____	Ref. Ro. Piping _____
Final Rough _____	Top Out _____	Rough Gas _____
Final Fixture _____	Rough Gas _____	Final Refrig _____
Final Elec _____	Final Plbg. <u>WX-19-70</u>	Final Air Cond _____
Temp. Service _____	Final Gas _____	Final Gas _____
	Final Sewer _____	
	Final Septic Tank _____	

23.06 D Address 3801 W. Washington Log No. _____ Area irrigation system

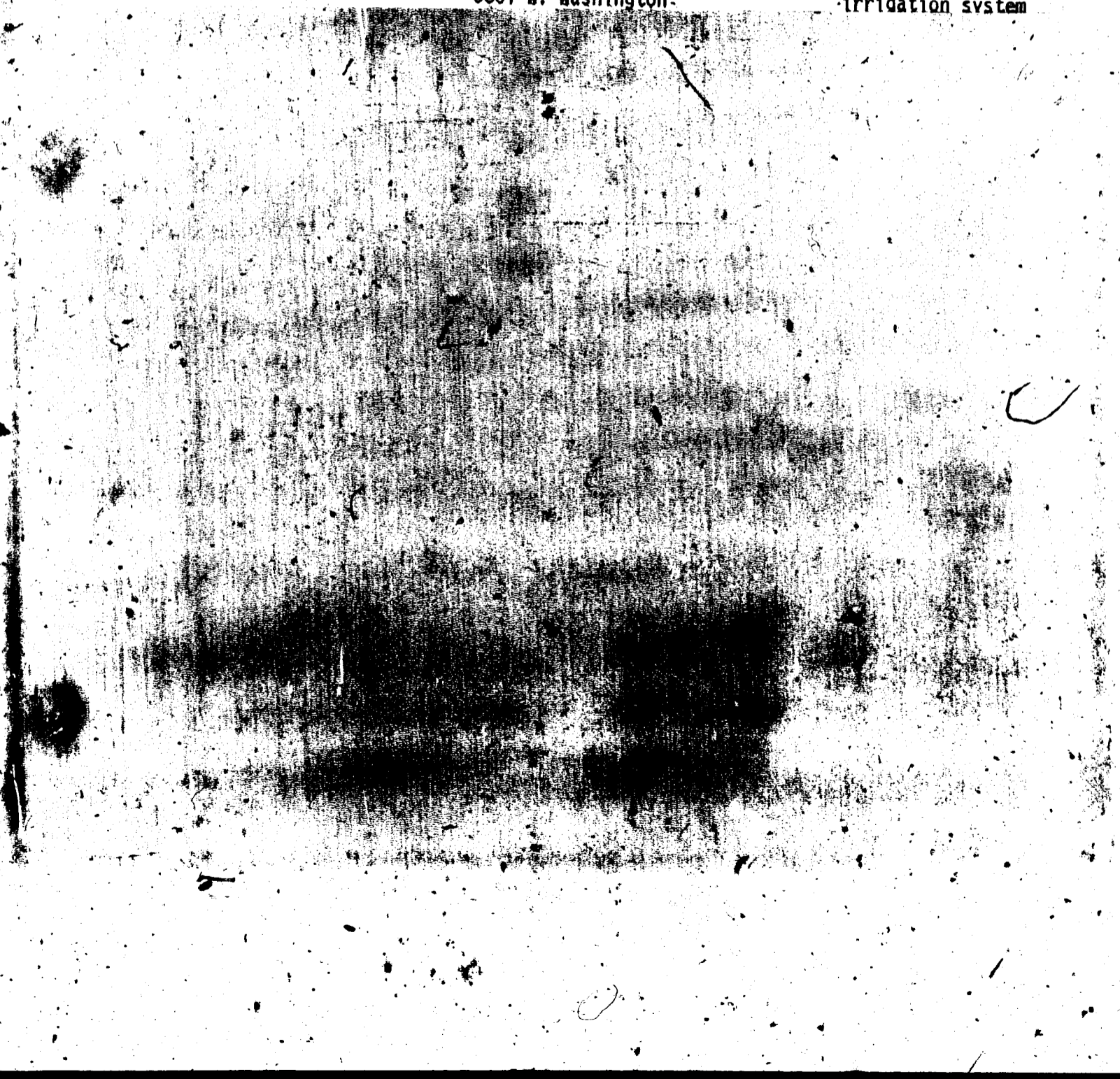

Don Hooley

12/29/87

CITY OF LAS VEGAS, NEVADA

LOG NO. & AREA

DATE 12-17-87

CONST. VAL: \$ 2800.00

DEPARTMENT OF BUILDING AND SAFETY
PHONE 386-6251 FOR INSPECTIONS, CALL 799-2071

AIR CONDITIONING PERMIT

ADDRESS OF CONSTRUCTION 3801 W Washington

OWNER Margaret Waters PHONE 870-4854

CONTRACTOR Remac

STATE LICENSE NO. 5409

CITY LICENSE NO. 8426

LOT(S) BLOCK SUBDIVISION

PROPOSED CONSTRUCTION: AIR COND. PERMIT NO. 5135-2 Replace A/C

USE:

UNITS	DESCRIPTION	FEE	TOTAL
PERMIT ISSUANCE			
1	For the issuance of each permit	15.00	15.00
	For issuing each supplemental permit	4.50	
UNIT FEE SCHEDULE			
	For the installation or relocation of each forced-air or gravity-type furnace or burner, including ducts and vents attached to such appliance, up to and including 100,000 Btu/h.	9.00	
	For the installation or relocation of each forced-air or gravity-type furnace or burner, including ducts and vents attached to such appliance over 100,000 Btu/h.	11.00	
	For the installation or relocation of each floor furnace, including vent.	9.00	
	For the installation or relocation of each suspended heater, recessed wall heater or floor-mounted unit heater.	9.00	
	For the installation, relocation or replacement of each appliance vent installed and not included in an appliance permit.	4.50	
	For the repair of, alteration of, or addition to each heating appliance, refrigeration, cooling unit, absorption unit, or each heating, cooling, absorption, or evaporative cooling system, including installation of controls regulated by code.	9.00	
1	For the installation or relocation of each boiler or compressor to and including 15 horsepower, or each absorption system to and including 100,000 Btu/h.	9.00	9.00
	For the installation or relocation of each boiler or compressor over three horsepower to and including 15 horsepower, or each absorption system over 100,000 Btu/h and including 500,000 Btu/h.	16.50	
	For the installation or relocation of each boiler or compressor over 15 horsepower to and including 30 horsepower, or each absorption system over 500,000 Btu/h to and including 1,000,000 Btu/h.	22.50	
	For the installation or relocation of each boiler or compressor over 30 horsepower to and including 50 horsepower, or for each absorption system over 1,000,000 Btu/h to and including 1,750,000 Btu/h.	33.50	
	For the installation or relocation of each boiler or refrigeration compressor over 50 horsepower, or each absorption system over 1,750,000 Btu/h.	56.00	

Approval for the work under this permit will be given only after refuse and debris have been removed from job site and public right of way.

UNITS	DESCRIPTION	FEE	TOTAL
	For each air-handling unit to and including 10,000 cubic feet per minute, including ducts attached thereto. Note: This fee shall not apply to an air-handling unit which is a portion of a factory-assembled appliance, cooling unit, evaporative cooler or absorption unit for which a permit is required elsewhere in this code.	6.00	
	For each air-handling unit over 10,000 cfm	11.00	
	For each evaporative cooler other than portable type	6.50	
	For each ventilation fan	4.50	
	For each ventilation system which is not a portion of any heating or air-conditioning system authorized by a permit	2.35	
	For the installation of each hood which is served by mechanical exhaust, including the ducts for such hood	6.50	
	For each appliance or piece of equipment regulated by this code but not classed in other appliance categories or for which no other fees are listed in this code.	6.50	
OTHER INSPECTIONS AND FEES:			
	Inspections outside of normal business hours (minimum charge — three hours)	25.00 per hour	
	Reinspection fee assessed under provisions of TABLE 3-A of the Uniform Building Code = \$15.00 EACH	15.00 each	
	Inspections for which no fee is specifically indicated (minimum charge — one-half hour).	30.00 per hour	
	Additional plan review required by changes, additions or revisions to approved plans (minimum charge — two hours).	30.00 per hour	
	Mechanical permit fees may be computed the same as building permit fees by using the cost of installation for valuation amount when such work is not included in the above schedule.		
	Gas piping which is directly related and necessary to the repair or replacement of heating, air conditioning, or refrigeration systems not exceeding 500,000 B.T.U.H.	6.00	

2310-2405

RECEIVED
 A/C 24.00
 A/C 24.00
 A/C 31.50
 CHEK 79.50
 5135A000 10:51

12/17/87

I hereby certify that I have carefully examined and read the above application; that the same is true and correct; and that the work herein described is to be done in accordance with all the provisions of the applicable Ordinances of the City of Las Vegas, Nevada and the State Laws, whether herein specified or not.

SIGNED *Tom P. Pinsky* CONTRACTOR

MASTER CARD NO.

PERMIT FEE 24.00

BY *J. Alfano* BUILDING DEPT

Spec. Contr. or Owner

DATE 12-17-87 TOTAL FEES 24.00

Permit Expires 180 Days After Abandonment of Work

MUST BE MACHINE VALIDATED

11/10/88 James 8-888

ELEC. ONLY PLBG. ONLY, A.C. ONLY		
OWNER	Margaret Waters	DATE 12/17/87
ADDRESS	3801 W. Washington	
CONTRACTOR	PERMIT NO.	FINAL INSPECTION
LOT	BLOCK	SUBDIVISION
LOG NO.	AREA	
ELECTRIC ONLY	PLUMBING ONLY	
Contractor	Contractor	
Permit No.	Permit No.	
Rough Elec.	Rough Soil	
Final Rough	Rough Water	
Final Elec.	Tap Out	
Temp. Service	Rough Gas	
HEAT & VENT. A/C ONLY	Final Plbg.	
Contractor	Final Gas	
Permit No. 5135	Sewer Final	
A/C Rough Duct		
Rough Gas		
Final A/C	EXP 6/24/88	
Final Gas		

79-3-13 (11-81) DEPT. OF BLDG. & SAFETY CITY OF LAS VEGAS