

3605 W. Washington

L-18 B-3 Sub Twin Lakes Est #1

Storia Ealy August 4, 1980

CITY OF LAS VEGAS, NEVADA

LOG NO. & AREA

CONST. VAL. \$ 20.00

DEPARTMENT OF BUILDING & SAFETY

APPLICATION & BUILDING PERMIT — for: Fence, Wall, Retaining Wall.

ADDRESS OF CONSTRUCTION:

3605 W. Washington Ave.

OWNER:

JACK DE ROSA

LOT(S)

18

BLOCK

3

SUBDIVISION

T. L. EST.

UNIT 1

ZONE: R-1

Materials of Construction:

Block

Concrete

Wire

Wood

Other

Yes No

PLANS:

ARCHITECT:

ENGINEER:

CALCS:

CONTRACTOR:

STATE LICENSE #

CITY LICENSE #

TOTAL SQUARE FEET:

TOTAL LINEAL FEET: 20

Remarks:

CONDITIONS OF THE PERMIT:

1. Any type of retaining wall must be engineered by a Civil or Structural Engineer.
2. If a home owner takes out the Building Permit and if the owner sublets the work to a Contractor, then the Contractor must take out the permit and pay for it.
3. No fence or wall can be built on City property or rights-of way, but this is not intended to preclude construction within utility easements if utilities will not be damaged or made inaccessible.
4. The fence or wall shall not enclose any water meter, light standard, or fire alarm box and shall not come closer than 24" from the nearest fire hydrant outlet.
5. Department Inspectors must approve footings before concrete is poured and block wall reinforcing before grouting is done.
6. Maximum height of any wall or fence is 6', side and rear yards; maximum in front yard with the vertical surface above the height of 2' — 50% open and further that fencing within 25' of the intersection of curb faces on corner and through lots is limited to a maximum height of 30".
7. I must not obstruct required onsite parking space (1 space for each dwelling unit) by the erection of this fence or wall.
8. By the signing of this application I herewith agree to the requirements outlined above.

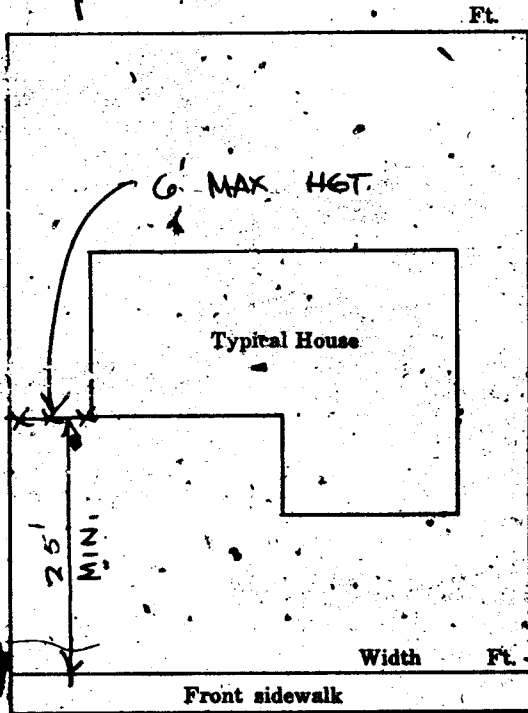

SIGNED:

Jack B. De Rosa

DATE:

CONTRACTOR AGENT OWNER

PLANNING DEPT:

Date:

2-12-68

ENGINEERING DEPT:

Date:

BUILDING DEPT:

Date:

2-12-68

#1285

PERMIT NO:

40142

PERMIT FEE \$

3.00

RECEIPT

4389 \$800.00 - 8

CITY OF LAS VEGAS DEPT. OF BUILDING & SAFETY

MUST BE MACHINE VALIDATED

12 FEB 68

Gloria Ealy August 4, 1980

CITY OF LAS VEGAS, NEVADA

LOG NO. & AREA _____ CONST. VAL. \$ 95.00

DEPARTMENT OF BUILDING & SAFETY

APPLICATION & BUILDING PERMIT — for:
Dwellings, Duplexes, Misc. Residential Const.

ADDRESS OF CONSTRUCTION: 360.5 W. Washington Ave OWNER: Jack E. De Rosa

LOT(s) 18 BLOCK 3 SUBDIVISION T.L. Est. Units 1 ZONE: R-1

Existing structure on lot: Dwelling Accessory bldgs. Vacant lot Other

PROPOSED CONSTRUCTION: Admin. STORAGE BLDG - DETACHED USE: STOR.

MATERIALS OF CONSTRUCTION: Wood Frame Concrete Block Reinforced Concrete Steel Frame

SQUARE FEET OF FLOOR AREAS: 1st _____ 2nd _____ 3rd _____ Other _____ TOTAL, SQ. FT. 35

FIRE ZONE: 1 2 3 Occupancy Group A B C D E F G H I J-1-2-3-4-5 CONST. TYPE: I II III IV V

ARCHITECT: _____ ENGINEER: _____ NO. of UNITS _____ NO. of STORIES _____

Plans Submitted: Yes No Calculations Submitted Yes No Sewer Fee Req'd. Yes No

CONTRACTOR: owner STATE LICENSE # _____ CITY LICENSE # _____

ADD'L PERMITS REQ'D: Air Cond. Elec. Plumbing Signs Paving Fence Public Walks Curb-gutters
Incinerators Fire Sprinkling System

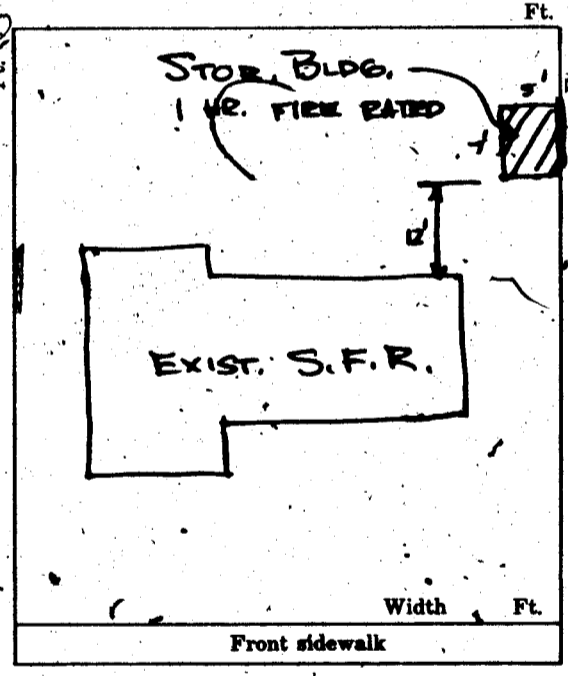

CONDITIONS OF THE PERMIT:

- I agree to call the City Building Department for inspections before concrete is poured, before rough wiring, electrical, plumbing, framing is covered. Also for Air conditioning, sheet-rock and sheathing inspection.
- I agree that when the job is complete that I will call for final inspection before occupancy.
- I agree to perform all construction in accordance with City Ordinances and Building Codes.
- The Contractor's signature below denotes authority from the owner to sign in his behalf and that the owner is aware of all requirements of this application and permit. Separate permits must be taken out for work outlined above this agreement.
- I have read and understand the contents of this application and permit; I hereby state that the information I have supplied on this application is true and correct.

SIGNED: _____ Contractor

BY: Jack E. De Rosa Agent or Owner

CLARK COUNTY HEALTH DEPT. Date: _____

LAS VEGAS FIRE DEPARTMENT Date: _____

PLANNING DEPT: _____ Date: 2-13-68

ENGINEERING DEPT: _____ Date: _____

BUILDING DEPT: _____ Date: 2-13-68

#12850 PERMIT NO: 40165 PERMIT FEE \$ 30.00

RECEIPT
 1954 \$95.00 - 8
 CITY OF LAS VEGAS
 DEPT. OF BUILDING & SAFETY
 MUST BE MACHINE VALIDATED
 1-3-68

Gloria Ealy August 4, 1980

CITY OF LAS VEGAS, NEVADA

LOG NO. & AREA _____ CONST. VAL. \$ 32.00

DEPARTMENT OF BUILDING & SAFETY

APPLICATION & BUILDING PERMIT — for
Fence, Wall, Retaining Wall.

ADDRESS OF CONSTRUCTION: 3605-W. Washington Ave. OWNER: Jack R. De Rosa

LOT(s) 18 BLOCK 3 SUBDIVISION TWIN LAKES ESTATES UNIT #1 ZONE: R-1

Materials of construction: Block Concrete Wire Wood Other Yes No

ARCHITECT: _____ ENGINEER: _____ PLANS:

CONTRACTOR: OWNER STATE LICENSE # _____ CITY LICENSE # _____ CALCS:

TOTAL SQUARE FEET: _____ TOTAL LINEAL FEET: 16'

Remarks:

CONDITIONS OF THE PERMIT:

1. Any type of retaining wall must be engineered by a Civil or Structural Engineer.
2. If a home owner takes out the Building Permit and if the owner sublets the work to a Contractor, then the Contractor must take out the permit and pay for it.
3. No fence or wall can be built on City property or rights-of-way, but this is not intended to preclude construction within utility easements if utilities will not be damaged or made inaccessible.
4. The fence or wall shall not enclose any water meter, light standard, or fire alarm box and shall not come closer than 24" from the nearest fire hydrant outlet.
5. Department Inspectors must approve footings before concrete is poured and block wall reinforcing before grouting is done.
6. Maximum height of any wall or fence is 6', side and rear yards; 4' maximum in front yard with the vertical surface above the height of 2' — 50% open and further that fencing within 25' of the intersection of curb faces on corner and through lots is limited to a maximum height of 30".
7. Must not obstruct required onsite parking space (1 space for each dwelling unit) by the erection of this fence or wall.
8. By the signing of this application I herewith agree to the requirements outlined above.

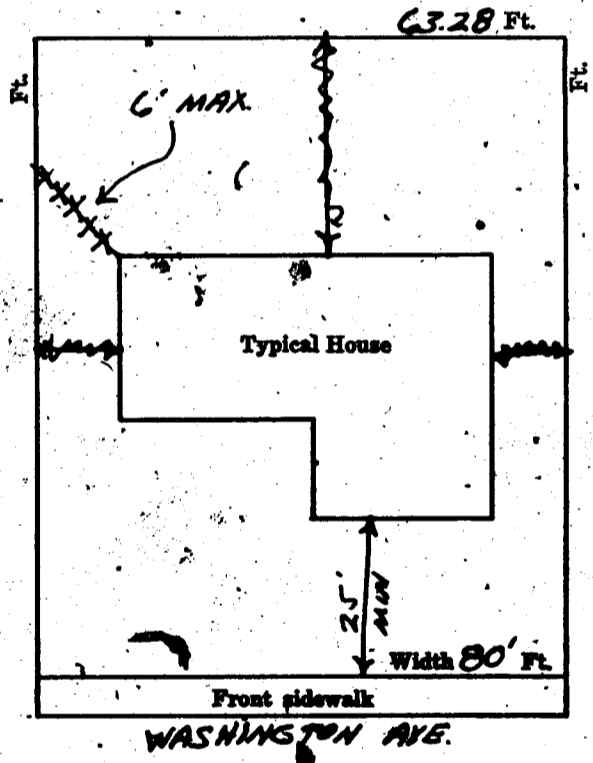

SIGNED: Jack R. De Rosa DATE: 11/8/68
CONTRACTOR AGENT OWNER

PLANNING DEPT: RM Date: 11-8-68

ENGINEERING DEPT: _____ Date: _____

BUILDING DEPT: g. w. [unclear] Date: 11-8-68

#1285 PERMIT NO: 45123 PERMIT FEE \$ 3.00

RECEIPT
7655 \$003.00 - 8

CITY OF LAS VEGAS
DEPT. OF
BUILDING & SAFETY

MUST BE MACHINE VALIDATED
- 8 NOV 68

Done Hooley 11-9-68

DEPARTMENT OF BUILDING & SAFETY
CITY OF LAS VEGAS, NEVADA

KARDEX CARD
FENCE & RETAINING
WALLS

OWNER Jack DeRosa ADDRESS 3605 W. Washington DATE 11/8/68

CONTRACTOR Order PERMIT NO. 145123

LOT 18 BLOCK 3 SUBDIVISION Twin Lakes #1
Wood

Fence (wire, wood, etc.)

Walls (masonry, rock, etc.)

Location _____
Final Inspection 2/28 4-3-69

Location _____
Footings _____
Wall Steel 1st _____ 2d _____ 3d _____
Final Inspection _____

Retaining Wall (masonry)

Retaining Wall (concrete)

Location _____
Footings _____
Wall Steel 1st _____ 2d _____ 3d _____
Bond Beam 1st _____ 2d _____ 3d _____
Final Inspection _____

Location _____
Footings _____
Wall Steel 1st _____ 2d _____ 3d _____
Final Inspection _____

23.14 B ADDRESS 3605 W. Washington AREA _____

DEPT. of BLDG & SAFETY—CITY of LAS VEGAS, NEVADA

OWNER Jack DeRosa ADDRESS 3605 W. Washington DATE 2/13/68
GEN CONT. Owner TYPE OF STRUCTURE Alum Storage
PERMIT NO. 10165 LEGAL DESCRIPTION L 18 B 3 Twin Lakes Estates #1 Shed

BUILDING		MECHANICAL	ELECTRICAL
LOCATION _____		PLUMBING CONT. _____	TEMP POLE CONT. _____
FIREPLACE FTS _____		PERMIT NO. _____ DATE _____	PERMIT NO. _____ DATE _____
FOOTINGS _____		HEAT & VENT. AC CONT. _____	INSPECTION _____ DATE _____
FOUNDATION WALL _____		PERMIT NO. _____ DATE _____	ELECTRICAL CONT. _____
FLOOR FRAMING _____		SEWER CONT. _____	PERMIT NO. _____ DATE _____
SLAB _____		PERMIT NO. _____ DATE _____	FIXTURES CONT. _____
CHIMNEY STEEL (FIREPLACE) _____		ROUGH SOL. _____	PERMIT NO. _____ DATE _____
WALL STEEL _____		ROUGH WATER _____	SLAB _____
COLUMN STEEL _____		TOP-OUT _____	ROUGH _____
BEAM STEEL _____		ROUGH GAS _____	FINAL ROUGH _____
FRAMING _____		AC ROUGH DUCT _____	FINAL FIXTURE _____
ROOF SHEATHING _____		REF. ROUGH PIPING _____	FINAL ELECTRICAL _____
INTERIOR _____ EXTERIOR _____		FINAL PLUMBING _____	TEMPORARY SERVICE _____
DRYWALL _____		FINAL GAS _____	MISCELLANEOUS _____
LATHING _____		FINAL AIR COND. _____	GRADING & DRAINAGE _____
BACKING (SINGS) _____		FINAL REFRIG. _____	ON-SITE PARKING SPACES _____ APP. _____
PLASTER SCRATCH _____		FINAL SEWER _____	ENG. APPROVAL OF _____
PLASTER BROWN _____		FINAL SEPTIC TANK _____	OFF-SITE IMPROVEMENTS _____
URBAN REDEVELOPMENT APPROVAL _____			
FINAL BLDG <u>Wet</u> DATE <u>12-19-68</u>			

APPROVED FOR OCCUPANCY & METER _____ INSPECTOR _____ DATE _____
PLEASE NOTE REMARKS ON REVERSE SIDE 3605 W. Washington LOG # _____ AREA # _____ 23.04

Don Hooley 11-9-53

DEPARTMENT OF BUILDING & SAFETY
CITY OF LAS VEGAS, NEVADA

KARDEX CARD
FENCE & RETAINING
WALLS

OWNER Jack DeBass ADDRESS 3605 Washington DATE 2/9/68
CONTRACTOR Ordet PERMIT NO. 10112
LOT 18 BLOCK 3 SUBDIVISION Twin Lakes Estates #1

Fence (wire, wood, etc.)	Walls (masonry, rock, etc.)
Location _____ Final Inspection <u>WPA 12-10-68</u>	Location _____ Footings _____ Wall Steel 1st _____ 2d _____ 3d _____ Final Inspection _____
Retaining Wall (masonry)	Retaining Wall (concrete)
Location _____ Footings _____ Wall Steel 1st _____ 2d _____ 3d _____ Bond Beam 1st _____ 2d _____ 3d _____ Final Inspection _____	Location _____ Footings _____ Wall Steel 1st _____ 2d _____ 3d _____ Final Inspection _____

ADDRESS: 3605 Washington AREA _____

DEPT. of BLDG. & SAFETY - CITY of LAS VEGAS, NEVADA
OWNER: HEERS INC. ADDRESS: 3605 Washington DATE 7-11-57
GEN. CONT. TWIN LAKES VILLAGE INC. TYPE OF STRUCTURE DWELLING W/GARAGE
PERMIT NO. 29269 LEGAL DESCRIPTION: Lot 18, Bl. 3, Twin Lakes Est. #1.

LOCATION & FLOOR ELEVATION <u>Edo 7-18-57</u>	PLUMBING CONT. <u>ACE</u> PERMIT NO. <u>26967</u> DATE <u>7-19-57</u>	TEMP. POLE CONT. PERMIT NO. _____ DATE _____
FOOTINGS <u>Edo 7-18-57</u>	HEAT & VENT. CONT. <u>W.M. P. P. L. L.</u> PERMIT NO. <u>27149</u> DATE <u>8/2/57</u>	INSPECTION DATE _____
FOUND. & PIERS _____	SEWER CONT. <u>ACE</u> PERMIT NO. <u>26967</u> DATE <u>7-19-57</u>	ELECTRICAL CONT. <u>Gene</u> PERMIT NO. <u>21163</u> DATE <u>8/2/57</u>
WALL STEEL _____	ROUGH SOIL <u>Balloy 7-24-57</u>	OUTLETS <u>52</u>
BOND BEAM STEEL _____	ROUGH WATER <u>Balloy 7-24-57</u>	MOTORS <u>1</u> H.P. <u>3</u>
FRAMING & ROOF SHEATHING <u>Edo 8-16-57</u>	ROUGH WATER <u>Balloy 7-24-57</u>	SLAB _____
STEEL FABRICATION _____	SEWER OR SEPTIC TANK _____	ROUGH _____
CONNECTIONS & PAINTING _____	TOP-OUT <u>Balloy 8-15-57</u>	FINAL ROUGH <u>go 8/16/57</u>
LATHING _____	ROUGH GAS <u>Balloy 8-15-57</u>	FIXTURE CONT. <u>same</u>
PLASTER _____	ROUGH DUCT <u>Balloy 8-15-57</u>	PERMIT NO. _____ DATE _____
SCRATCH _____	FINAL PLUMBING <u>Edo 10-10-57</u>	FIXTURES <u>16</u>
BROWN _____	FINAL HEATING <u>Edo 10-10-57</u>	FINAL FIXTURE _____
FINAL BLDG. <u>Walker 10-10-57</u>	FINAL GAS <u>Balloy 10-10-57</u>	APPROVED FOR METER <u>Walker 10/10/57</u>
GRADING & DRAINAGE _____		
ON-SITE PARKING _____ SPACES _____		
ENG. APPROVAL OF _____		
OFF-SITE IMPROVEMENTS _____		

APPROVED for OCCUPANCY: _____ INSPECTOR _____ DATE _____

* PLEASE NOTE REMARKS ON REVERSE SIDE

3605 Washington DWELLING WITH GARAGE 7/11/57 23.04