

6436 STAR JASMINE

LOT 31 BLK 4 JADE PARK #2 ZONE R-1

J. Gatewood May 30, 1983

CITY OF LAS VEGAS, NEVADA

LOG NO. & AREA T15-3 DEPARTMENT OF BUILDING & SAFETY CONST. VAL. \$ 2500.00  
APPLICATION & BUILDING PERMIT — for:  
Dwellings, Duplexes, Misc. Residential Const.

ADDRESS OF CONSTRUCTION: 6486 STAR JARDINE COURT OWNER: MOBILE AMERICA INC.

LOT(s) 31 BLOCK 4 UNIT 2 SUBDIVISION JADE PARK MOBILE HOME ESTATES ZONE: R MH

Existing structure on lot: Dwelling  Accessory bldgs.  Vacant lot  Other

PROPOSED CONSTRUCTION: MOBILE HOME ESTATES IMPROVEMENTS USE: MOB. HOME

MATERIALS OF CONSTRUCTION: Wood Frame  Concrete Block  Reinforced Concrete  Steel Frame

SQ. FEET OF FLOOR AREAS: 1st \_\_\_\_\_ 2nd \_\_\_\_\_ 3rd \_\_\_\_\_ Other 63 TOTAL SQ. FT. \_\_\_\_\_

FIRE ZONE: 1 2 3 Occupancy Group J, 1-2 CONST. TYPE: I II III IV V

ARCHITECT: \_\_\_\_\_ ENGINEER: VTN NO. of UNITS \_\_\_\_\_ NO. of STORIES \_\_\_\_\_

Plans Submitted: Yes  No  Calculations Submitted Yes  No  Sewer Fee Req'd. Yes  No

CONTRACTOR: CHEYENNE CONST. INC. STATE LICENSE # 10168 CITY LICENSE # 09053

ADD'L. PERMITS REQ'D: Air Cond.  Elec.  Plumbing  Signs  Paving  Fence  Public Walks  Curb-gutters   
Incinerators  Fire Sprinkling System

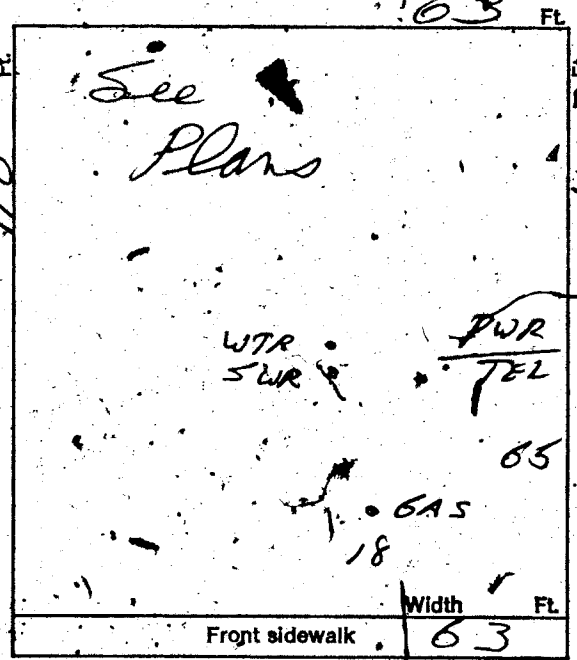

CONDITIONS OF THE PERMIT:

- 1. I agree to call the City Building Department for inspections before concrete is poured, before rough wiring, electrical, plumbing, framing is covered. Also for air conditioning, sheet-rock and sheathing inspection.
- 2. I agree that when the job is completed that I will call for final inspection before occupancy.
- 3. I agree to perform all construction in accordance with City Ordinances and Building Codes.
- 4. The Contractor's signature below denotes authority from the owner to sign in his behalf and that the owner is aware of all requirements of this application and permit. Separate permits must be taken out for work outlined above this agreement.
- 5. I have read and understand the contents of this application and permit; I hereby state that the information I have supplied on this application is true and correct.

SIGNED: Mobile America Inc Contractor

BY: Don Steth Agent or Owner

CLARK COUNTY HEALTH DEPT. Date \_\_\_\_\_

LAS VEGAS FIRE DEPARTMENT Date \_\_\_\_\_

PLANNING DEPT.: \_\_\_\_\_ Date: 3/21/73

PUBLIC WORKS DEPT.: \_\_\_\_\_ Date: \_\_\_\_\_

BUILDING DEPT.: WRJ Date: 3/28/73

#12850 PERMIT NO.: 10209 PERMIT FEE \$ 18.00

RECEIPT  
3334 \$018.00 - 8  
CITY OF LAS VEGAS  
DEPT. OF BUILDING & SAFETY  
MUST BE MACHINE VALIDATED  
30 MAR 73

21 Gatewood May 30, 1983

CITY OF LAS VEGAS, NEVADA

LOG NO. & AREA \_\_\_\_\_  
DEPARTMENT OF BUILDING & SAFETY

CONST. VAL. \$ 720  
~~10.00~~

APPLICATION & BUILDING PERMIT — for:  
Fence, Wall, Retaining Wall.

ADDRESS OF CONSTRUCTION: 6436 Star Jasmine Ct OWNER: Mobile America

LOT(s) 31 BLOCK 4 SUBDIVISION Jade Park #2 ZONE RMA

Materials of Construction: Block  Concrete  Wire  Wood  Other  Yes No

PLANS:

ARCHITECT: \_\_\_\_\_ ENGINEER: \_\_\_\_\_ CALCS:

CONTRACTOR: Tom Yelley STATE LICENSE # 10350 CITY LICENSE # C11346-200

TOTAL SQUARE FEET: 720 TOTAL LINEAL FEET: 180

Remarks:  
\_\_\_\_\_  
\_\_\_\_\_  
\_\_\_\_\_

CONDITIONS OF THE PERMIT:

1. Any type of retaining wall must be engineered by a Civil or Structural Engineer.
2. If a home owner takes out the Building Permit and if the owner sublets the work to a Contractor, then the Contractor must take out the permit and pay for it.
3. No fence or wall can be built on City property or rights-of-way, but this is not intended to preclude construction within utility easements if utilities will not be damaged or made inaccessible.
4. The fence or wall shall not enclose any water meter, light standard, or fire alarm box and shall not come closer than 24" from the nearest fire hydrant outlet.
5. Department Inspectors must approve footings before concrete is poured and block wall reinforcing before grouting is done.
6. Maximum height of any wall or fence is 6', side and rear yards: 4' maximum in front yard with the vertical surface above the height of 2' — 50% open.
7. I must not obstruct required onsite parking space (2 spaces for each dwelling unit) by the erection of this fence or wall.
8. By the signing of this application I herewith agree to the requirements outlined above.

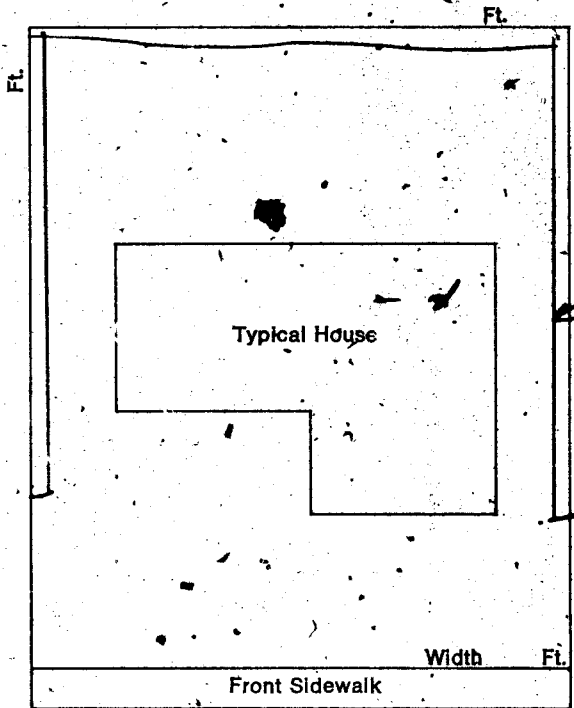

SIGNED By Tom Yelley DATE: 7-17-73  
CONTRACTOR  AGENT  OWNER

PLANNING DEPT: WA Date: 7-19-73

PUBLIC WORKS DEPT: \_\_\_\_\_ Date: \_\_\_\_\_

BUILDING DEPT: WRB Date: 7/17/73

#12850 PERMIT NO: 12163 PERMIT FEE \$ 10.00

RECEIPT

9297 \$010.00 - 8

CITY OF LAS VEGAS  
DEPT. OF  
BUILDING & SAFETY

MUST BE MACHINE VALIDATED

18 JUL 73

21. Gatewood May 30, 1930

CITY OF LAS VEGAS, NEVADA

DEPARTMENT OF BUILDING & SAFETY - ELECTRICAL APPLICATION & PERMIT

ADDRESS OF CONSTRUCTION:

6436 Star Jasmine Court  
JADE PARK #2 Bldg 4 Lot 31

OWNER'S NAME:

MOBILE AMERICA

CIRCLE: New Bldg.; Add'n; Remodel; TYPE OF BLDG.: SFD. APT. PUBLIC COMM.

TRAILER SERVICE

CONTRACTOR'S NAME:

ACME ELECTRIC

STATE LICENSE #

2307

C&D

CITY LICENSE #

1048

NUMBER	FIXTURE OR INSTALLATION	UNIT PRICE	
	Fixture or sockets	.15	
	Light, receptacle or switch outlet	.20	
	Wall or ceiling space heater	.35	
	Blast coil heater per kilowatt	.35	
	Garbage grinder outlet	.35	
	Dishwasher outlet	.35	
	Clothes dryer outlet	.35	
	Automatic clothes washer	.35	
	Electric range outlet	.35	
	Electric water heater outlet	.35	
	Mercury arc lamp and equipment	.35	
	Special purpose outlet	.35	
	X-ray unit and its appurtenances	5.00	
	Watts of festoon lighting (Watts) First 3,000 watts	4.00	
	for each additional thousand watts	1.50	
	Horsepower - all motors first horsepower or less	1.75	
	for each additional horsepower	.35	
	Temporary power and lights (temporary pole)	4.00	
1	Electric service (including any single meter socket)	3.00	3.00
	for each additional socket	.35	
	Air conditioning service	amps 1.50	
	Each KW (KVA) Generator (Transformer) (Welder) KW (KVA)	2.00	
	First 100 KVA - For each additional KW (KVA)	.01	
	Special inspection per hour	4.00	
	Speaker outlets	.15	
	Signal or Alarm outlets	.15	
	Amplifiers	.50	
	Control panels	.25	
	T. V. outlets - master system only	.15	
	Radio outlets	.15	
	Main control racks	1.00	
	T. V. and Radio antennas - master system only	.75	
	Minimum fee for any permit	4.00	
	Total fee		4.00

I hereby certify that I have carefully examined and read the above application; that the same is true and correct; and that the work herein described is to be done in accordance with all the provisions of the applicable Ordinances of the City of Las Vegas, Nevada and State laws whether herein specified or not.

SIGNED

*L. P. Dooling*  
MASTER (ELECTRICIAN) (TECHNICIAN) (OWNER)

DATE

10/1/73

BUILDING DEPARTMENT

*NM*

DATE

\*12860

PERMIT NO.

7742

PERMIT FEE: \$

4.00

RECEIPT

2453 5004.00 - 6

CITY OF LAS VEGAS

DEPT. OF BUILDING & SAFETY

- 3 OCT 73

L. Gatewood May 30, 1980

CITY OF LAS VEGAS, NEVADA

LOG NO. & AREA \_\_\_\_\_ DEPARTMENT OF BUILDING & SAFETY CONST. VAL. \$ \_\_\_\_\_ APPLICATION & BUILDING PERMIT — for: Dwellings, Duplexes, Misc. Residential Const.

ADDRESS OF CONSTRUCTION: 6436 Star Jasmine Ct. OWNER: KURT JOHNSON

LOT(s) 31 BLOCK 4 SUBDIVISION JADE PACIFIC #2 ZONE R-111

Existing structure on lot: Dwelling  Accessory bldg.  Vacant lot  Other

PROPOSED CONSTRUCTION: Mobile Home Inst. USE: \_\_\_\_\_

MATERIALS OF CONSTRUCTION: Wood Frame  Concrete Block  Reinforced Concrete  Steel Frame

SQ. FEET OF FLOOR AREAS: 1st \_\_\_\_\_ 2nd \_\_\_\_\_ 3rd \_\_\_\_\_ Other \_\_\_\_\_ TOTAL SQ. FT. \_\_\_\_\_

FIRE ZONE: 1-2-3 Occupancy Group 1-1-2 CONST. TYPE I II III IV V

ARCHITECT: \_\_\_\_\_ ENGINEER: \_\_\_\_\_ NO. of UNITS \_\_\_\_\_ NO. of STORIES \_\_\_\_\_

Plans Submitted: Yes  No  Calculations Submitted: Yes  No  Sewer Fee Req'd. Yes  No

CONTRACTOR: Owall STATE LICENSE # \_\_\_\_\_ CITY LICENSE # \_\_\_\_\_

ADD'L PERMITS REQ'D: Air Cond.  Elec.  Plumbing  Signs  Paving  Fence  Public Walks  Curb-gutters  Incinerators  Fire Sprinkling System

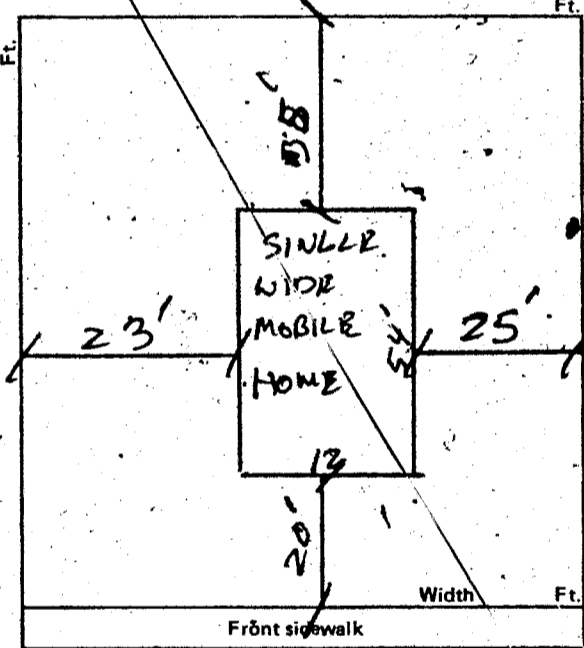

CONDITIONS OF THE PERMIT:

- 1. I agree to call the City Building Department for inspections before concrete is poured, before rough wiring, electrical, plumbing, framing is covered. Also for air conditioning, sheet-rock and sheathing inspection.
2. I agree that when the job is completed that I will call for final inspection before occupancy.
3. I agree to perform all construction in accordance with City Ordinances and Building Codes.
4. The Contractor's signature below denotes authority from the owner to sign in his behalf and that the owner is aware of all requirements of this application and permit. Separate permits must be taken out for work outlined above this agreement.
5. I have read and understand the contents of this application and permit; I hereby state that the information I have supplied on this application is true and correct.

Approval for the work under this permit will be given only after refuse and debris have been removed from job site and public right of way.

SIGNED: \_\_\_\_\_ Contractor

BY: K M Johnson Agent or Owner

CLARK COUNTY HEALTH DEPT. Date \_\_\_\_\_ LAS VEGAS FIRE DEPARTMENT Date \_\_\_\_\_

PLANNING DEPT.: \_\_\_\_\_ Date: 4/22/75

PUBLIC WORKS DEPT.: \_\_\_\_\_ Date: \_\_\_\_\_

BUILDING DEPT.: N Miller Date: 4-22-75

# 12850 PERMIT NO.: 1590 PERMIT FEE \$ 5.00

RECEIPT 4032 \$005.00 - 8 CITY OF LAS VEGAS DEPT. OF BUILDING & SAFETY MUST BE MACHINE VALIDATED 23 APR 75

21. Gatewood May 30, 1980

CITY OF LAS VEGAS, NEVADA

LOG NO. & AREA \_\_\_\_\_ DEPARTMENT OF BUILDING & SAFETY CONST. VAL. \$ \_\_\_\_\_

ADDRESS OF CONSTRUCTION: 6436 Star Jasmine Ct. OWNER: KIRK JOHNSON

LOT(s) 31 BLOCK 4 SUBDIVISION JADE PACIFIC #2 ZONE R-111

Existing structure on lot: Dwelling  Accessory bldg.  Vacant lot  Other

PROPOSED CONSTRUCTION: Mobile Home Ins. USE: \_\_\_\_\_

MATERIALS OF CONSTRUCTION: Wood Frame  Concrete Block  Reinforced Concrete  Steel Frame

SQ. FEET OF FLOOR AREAS: 1st \_\_\_\_\_ 2nd \_\_\_\_\_ 3rd \_\_\_\_\_ Other \_\_\_\_\_ TOTAL SQ. FT. \_\_\_\_\_

FIRE ZONE 1-2-3 \_\_\_\_\_ Occupancy Group 1-2-3 \_\_\_\_\_ CONST. TYPE I II III IV V

ARCHITECT: \_\_\_\_\_ ENGINEER: \_\_\_\_\_ NO. of UNITS \_\_\_\_\_ NO. of STORIES \_\_\_\_\_

Plans Submitted: Yes  No  Calculations Submitted Yes  No  Sewer Fee Req'd. Yes  No

CONTRACTOR: O'Quinn STATE LICENSE # \_\_\_\_\_ CITY LICENSE # \_\_\_\_\_

ADDL. PERMITS REQ'D: Air Cond.  Elec.  Plumbing  Signs  Paving  Fence  Public Walks  Curb-gutters  Incinerators  Fire Sprinkling System

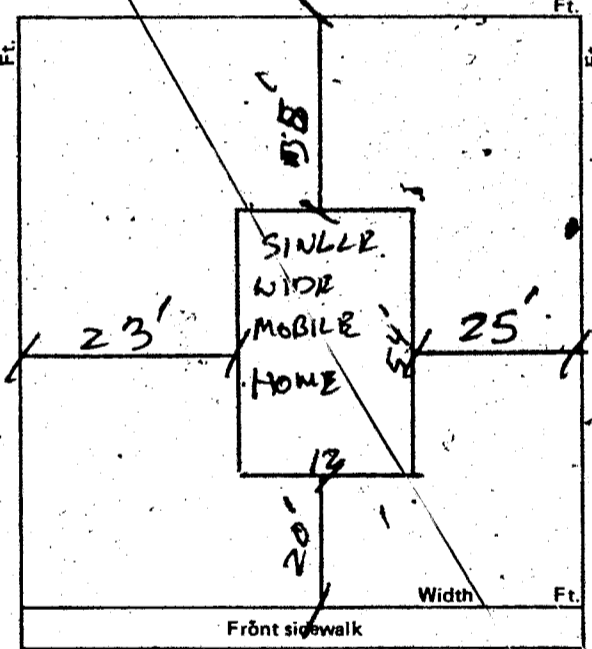

CONDITIONS OF THE PERMIT:

- 1. I agree to call the City Building Department for inspections before concrete is poured, before rough wiring, electrical, plumbing, framing is covered. Also for air conditioning, sheet-rock and sheathing inspection.
2. I agree that when the job is completed that I will call for final inspection before occupancy.
3. I agree to perform all construction in accordance with City Ordinances and Building Codes
4. The Contractor's signature below denotes authority from the owner to sign in his behalf and that the owner is aware of all requirements of this application and permit. Separate permits must be taken out for work outlined above this agreement.
I have read and understand the contents of this application and permit; I hereby state that the information I have supplied on this application is true and correct.

Approval for the work under this permit will be given only after refuse and debris have been removed from job site and public right of way.

SIGNED: \_\_\_\_\_ Contractor
BY: R M Johnson Agent or Owner

CLARK COUNTY HEALTH DEPT. Date \_\_\_\_\_
LAS VEGAS FIRE DEPARTMENT Date \_\_\_\_\_

PLANNING DEPT.: \_\_\_\_\_ Date: 4/22/75
PUBLIC WORKS DEPT.: \_\_\_\_\_ Date: \_\_\_\_\_
BUILDING DEPT.: N Miller Date: 4-22-75
# 12850 PERMIT NO.: 1590 PERMIT FEE \$ 5.00

RECEIPT
4062 \$005.00 - 8
CITY OF LAS VEGAS
DEPT. OF BUILDING & SAFETY
MUST BE MACHINE VALIDATED
23 APR 75

*Wona Amely* 7-7-83

DEPT. of BLDG & SAFETY - CITY of LAS VEGAS, NEVADA  
 OWNER Mobile America ADDRESS 6436 Star Jasmine Court DATE 3-29-73  
 GEN. CONT. Cheyenne Const TYPE OF STRUCTURE Slab  
 PERMIT NO. 10209 LEGAL DESCRIPTION L 31 B 4 Unit 2 Jade Park Estates

BUILDING	MECHANICAL	ELECTRICAL
LOCATION _____	PLUMBING CONT. <u>9747</u> DATE <u>4-19-73</u>	TEMP. POLE CONT. _____
FIREPLACE FTG. _____	HEAT & VENT. AC CONT. _____	PERMIT NO. _____ DATE _____
FOOTINGS _____	PERMIT NO. _____ DATE _____	INSPECTION _____ DATE _____
FOUNDATION WALL _____	SEWER CONT. <u>Cheyenne Const</u>	ELECTRICAL CONT. <u>Blank</u>
FLOOR FRAMING _____	PERMIT NO. <u>9039</u> DATE _____	PERMIT NO. <u>7742</u> DATE <u>10-3-73</u>
SLAB _____	ROUGH SOIL _____	FIXTURES CONT. _____
CHIMNEY STEEL (FIREPLACE) _____	ROUGH WATER _____	PERMIT NO. _____ DATE _____
WALL STEEL _____	ROUGH GAS _____	SLAB _____
COLUMN STEEL _____	TOP-OUT _____	ROUGH _____
BEAM STEEL _____	ROUGH GAS _____	FINAL ROUGH _____
FRAMING _____	AC ROUGH DUCT _____	FINAL FIXTURE _____
ROOF SHEATHING _____	REF. ROUGH PIPING _____	FINAL ELECTRICAL _____
INTERIOR _____	FINAL PLUMBING _____	TEMPORARY SERVICE _____
EXTERIOR _____	FINAL GAS _____	
DRYWALL _____	FINAL AIR COND. _____	
LATHING _____	FINAL REFRIG. _____	
BACKING (SIDING) _____	FINAL SEWER <u>WEPV-2473</u>	
PLASTER SCRATCH _____	FINAL SEPTIC TANK _____	
BROWN _____		
URBAN REDEVELOPMENT APPROVAL _____		
FINAL BLDG. _____ DATE _____		

APPROVED FOR OCCUPANCY & METER 291-7-74 INSPECTOR \_\_\_\_\_ DATE \_\_\_\_\_  
 PLEASE NOTE REMARKS ON REVERSE SIDE LOG # \_\_\_\_\_ AREA # \_\_\_\_\_ 23.04  
 6436 Star Jasmine Court T 15-3

DEPT. of BLDG. & SAFETY - CITY of LAS VEGAS, NEVADA  
 OWNER Kirk Johnson ADDRESS 6436 Star Jasmine DATE 4-22-75  
 GEN. CONT. Owner TYPE OF STRUCTURE Mobile Home Insp  
 PERMIT NO. 1590 LEGAL DESCRIPTION \_\_\_\_\_

BUILDING	MECHANICAL	ELECTRICAL
Investigation _____	Plumbing Cont. _____	Temp. pole cont. _____
Location & Footing _____	Permit No. _____ Date _____	Permit No. _____ Date _____
Stem Wall _____	Heat & Vent. A/C Cont. _____	Inspection _____ Date _____
Concrete Slab Floor _____	Permit No. _____ Date _____	ELECTRICAL CONT. _____
Floor Framing _____	SEWER CONT. _____	Permit No. _____ Date _____
Fireplace Footing _____	Permit No. _____ Date _____	FIXTURES CONT. _____
Chimney Steel _____	ROUGH SOIL _____	Permit No. _____ Date _____
Vert. Steel Reinf. _____	ROUGH WATER _____	SLAB _____
Horiz. Steel Reinf. _____	TOP-OUT _____	ROUGH _____
Roof Sheathing _____	ROUGH GAS _____	Final Rough <u>HD 5-275</u>
Framing _____	A/C ROUGH DUCT _____	Final Fixture _____
Backing for siding _____	REF. ROUGH PIPING _____	Final Electrical _____
Ext. Lath _____	Final Plumbing _____	TEMPORARY SERVICE _____
Ext. Scratch _____	Final Gas <u>WEPV-8-75</u>	
Ext. Brown _____	Final Air Cond. _____	
Int. Lath _____	Final Refrig. _____	
Int. Brown _____	Final Sewer _____	
Drywall _____	Final Septic Tank _____	
Permit No. _____		
Final Building _____		
Appr. for Occu. _____		

APPROVED FOR OCCUPANCY & METER 294-24-75 INSPECTOR \_\_\_\_\_ DATE \_\_\_\_\_  
 PLEASE NOTE REMARKS ON REVERSE SIDE 6436 Star Jasmine Ct LOG # \_\_\_\_\_ AREA # \_\_\_\_\_

Bona America 7-7-83

5

DEPARTMENT OF ENGINEERING & SURVEYING  
CITY OF LAS VEGAS, NEVADA

MARDEX CARD  
FENCE & RETAINING  
WALLS

OWNER Mobilis America DATE 7-17-79

CONTRACTOR Tom Yaley PERMIT NO. 12163

LOT 31 BLOCK 4 SUPERVISION Jade Park # 2 block fence

Fence (wire, wood, etc.)		Wall (masonry, rock, etc.)	
Location _____		Location _____	
Final Inspection _____		Footing _____	
		Wall Steel 1st _____ 2d _____ 3d _____	
		Final Inspection _____	
Retaining Wall (masonry)		Retaining Wall (concrete)	
Location _____		Location _____	
Footing _____		Footing _____	
Wall Steel 1st _____ 2d _____ 3d _____		Wall Steel 1st _____ 2d _____ 3d _____	
Bond Beam 1st _____ 2d _____ 3d _____		Final Inspection _____	
Final Inspection _____			

*Pulled 4-9-74*

23.14 B ADDRESS 5936 Star Jasmine Court LOG NO. \_\_\_\_\_ AREA \_\_\_\_\_