

5804 Paseo Montana

— L-12 Blk. 2 sub. Char. Hgts. #53-B Z-RPD-2 —

29/1980

CITY OF LAS VEGAS, NEVADA

77-09

LOG NO. & AREA 739-4

CONST. VAL. \$ 41280

DEPARTMENT OF PUBLIC SERVICE
DIVISION OF BUILDING AND SAFETY

APPLICATION & BUILDING PERMIT - for
Dwellings, Duplexes, Misc. Residential Const.

ADDRESS OF CONSTRUCTION: 5804. Paseo Montana, Las Vegas, Nev

OWNER: BECKER & SONS

LOT NO. 12 BLOCK 2 SUBDIVISION CHARLESTON HEIGHTS TRACT 53-B ZONE RPD 2

Existing structure on lot: Dwelling Accessory Bldgs. Vacant Lot Other

PROPOSED CONSTRUCTION: single family residence USE: single family residence

MATERIALS OF CONSTRUCTION: Wood Frame Concrete Block Reinforced Concrete Steel Frame

SQUARE FEET OF FLOOR AREAS: 1st 2018 2nd 3rd Other 230 TOTAL SQ. FT. 2248

FIRE ZONE: 3 Occupancy Group R-3 CONST. TYPE: V-A

ARCHITECT: BECKER & SONS ENGINEER: BECKER & SONS NO. of UNITS 1 NO. of STORIES 1

Plans Submitted: Yes No Calculations Submitted: Yes No Sewer Fee Paid: Yes No

CONTRACTOR: BECKER BUILT STATE LICENSE # 17092 CITY LICENSE # C11 956 2 00520

ADD'L PERMITS REQ'D.: Air Cond. Elec. Plumbing Signs Paving Fence Public Walks Curb gutters Incinerator Fire Sprinkling System

M. L. L. 2018 B.R.
SEE ATTACHED PLOT PLAN

CONDITIONS OF THE PERMIT:

- I agree to call the City Building Department for inspections before concrete is poured, before rough wiring, electrical, plumbing, framing is covered. Also for Air conditioning, drywall and sheathing inspection.
- I agree that when the job is completed that I will call for final inspection before occupancy.
- I agree to perform all construction in accordance with City Ordinances and Building Codes.
- The Contractor's signature below denotes authority from the owner to sign in his behalf and that the owner is aware of all requirements of this application and permit. Separate permits must be taken out for work outlined above this agreement.
- I have read and understand the contents of this application and permit; I hereby state that the information I have supplied on this application is true and correct.

Approval for the work under this permit will be given only after refuse and debris have been removed from job-site and public right of way.

SIGNED: BECKER BUILT Contractor

BY: Ernest H. Becker, Jr. Agent or Owner

PLANNING DEPT. Date: 9-28-78

PUBLIC WORKS DEPT. Charles Suik Date: 9/29/78

BUILDING DIVISION: Das Date: 10-10-78

PERMIT NO.: 10791-48 PERMIT FEE \$ 219.⁰⁰/₁₀₀

154-01-220

RECEIPT

MUST BE MACHINE VALIDATED

H. Hesterwood January 29, 1980

08-09

CITY OF LAS VEGAS, NEVADA

LOG NO. & AREA 139-1

CONST. VAL. \$ 2278.00

DEPARTMENT OF BUILDING & SAFETY

APPLICATION & BUILDING PERMIT - for: Fence, Wall, Retaining Wall.

ADDRESS OF CONSTRUCTION: 5804 Paseo Montana, Las Vegas, Nev. OWNER: BECKER & SONS

LOT(s) 12 BLOCK 2 SUBDIVISION CHARLESTON HEIGHTS TRACT 53-B ZONE: RPD 2

Materials of Construction: Block Concrete Wire Wood Other Yes No PLANS:

ARCHITECT: BECKER & SONS ENGINEER: BECKER & SONS ALCS:

CONTRACTOR: BECKER BUILT STATE LICENSE # 11092 CITY LICENSE # CV1 9562 00520

TOTAL SQUARE FEET: 1518 TOTAL LINEAL FEET: 235

Remarks:

CONDITIONS OF THE PERMIT

- Any type of retaining wall must be engineered by a Civil or Structural Engineer.
- If a home owner takes out the Building Permit and if the owner sublets the work to a Contractor, then the Contractor must take out the permit and pay for it.
- No fence or wall can be built on City property or rights-of-way, but this is not intended to preclude construction within utility easements if utilities will not be damaged or made inaccessible.
- The fence or wall shall not enclose any water meter, light standard, or fire alarm box and shall not come closer than 24" from the nearest fire hydrant outlet.
- Department inspectors must approve footings before concrete is poured and block wall reinforcing before grouting is done.
- Maximum height of any wall or fence is 6' side and rear yards; 4' maximum in front yard with the vertical surface above the height of 2' - 50% open.
- I must not obstruct required onsite parking space (2 spaces for each dwelling unit) by the erection of this fence or wall.
- By the signing of this application I herewith agree to the requirements outlined above.

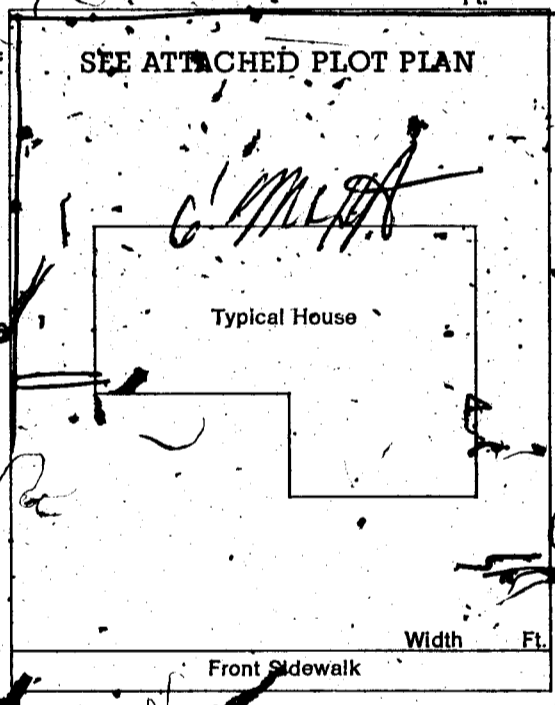

BECKER BUILT

SIGNED Ernest A. Becker, Jr. DATE 7-31-78

CONTRACTOR AGENT OWNER

PLANNING DEPT: Date: 9-28-78

PUBLIC WORKS DEPT: Charles Jurek Date: 9/29/78

BUILDING DEPT: Date: 10-10-78

#12850 PERMIT NO: 10791-49 PERMIT FEE \$ 18.00

RECEIPT

MUST BE MACHINE VALIDATED

U. Haterwood January 29, 1980

CITY OF LAS VEGAS, NEVADA

LOG NO. & AREA 29-06 T39-1

CONST. VAL. \$ 6600

DEPARTMENT OF PUBLIC SERVICES
DIVISION OF BUILDING AND SAFETY

APPLICATION & BUILDING PERMIT for:
Dwellings, Duplexes, Misc. Residential Const.

ADDRESS OF CONSTRUCTION: 5804 PASEO MONTANA

OWNER: BECKER & SONS

LOT(s) 12 BLOCK 2 SUBDIVISION CHAR. HGTS 53-B

ZONE R-PDZ

Existing structure on lot: Dwelling Accessory Bldgs. Vacant Lot Other

PROPOSED CONSTRUCTION: (DETACHED) GARAGE CARPORT

USE SONG

MATERIALS OF CONSTRUCTION: Wood Frame Concrete Block Reinforced Concrete Steel Frame

SQUARE FEET OF FLOOR AREAS: 1st 660 2nd 3rd Other TOTAL SQ. FT. 660

FIRE ZONE: 3 Occupancy Group M-1

CONST. TYPE: V-TA

ARCHITECT: ENGINEER: NO. of UNITS 1 NO. of STORIES 1

Plans Submitted: Yes No Calculations Submitted: Yes No Sewer Fee Req'd: Yes No

CONTRACTOR: BECKER STATE LICENSE # CITY LICENSE #

ADD'L. PERMITS REQ'D: Air Cond. Elec. Plumbing Signs Paving Fence Public Walks Curb-gutters
Incinerators Fire Sprinkling System

CONDITIONS OF THE PERMIT:

1. I agree to call the City Building Department for inspections before concrete is poured, before rough wiring, electrical, plumbing, framing is covered. Also for Air conditioning, drywall and sheathing inspection.
2. I agree that when the job is completed that I will call for final inspection before occupancy.
3. I agree to perform all construction in accordance with City Ordinances and Building Codes.
4. The Contractor's signature below denotes authority from the owner to sign in his behalf and that the owner is aware of all requirements of this application and permit. Separate permits must be taken out for work outlined above this agreement.
5. I have read and understand the contents of this application and permit; I hereby state that the information I have supplied on this application is true and correct.

Approval for the work under this permit will be given only after refuse and debris have been removed from job site and public right of way.

SIGNED: Contractor

BY: Agent or Owner

2018
Mid 218 B New
Becker & Sons

Front property line

PLANNING DEPT. Date: 9-28-78

PUBLIC WORKS DEPT. Charles Turk Date: 9-29-78

BUILDING DIVISION Date: 10-10-78

PERMIT NO.: 10791-50 PERMIT FEE \$ 45.00

154-01-220

MUST BE MACHINE VALIDATED

RECEIPT

M. Woodward January 29, 1980

CITY OF LAS VEGAS, NEVADA

DEPARTMENT OF PUBLIC SERVICES—APPLICATION AND PERMIT FOR PLUMBING DIVISION OF BUILDING AND SAFETY

ADDRESS OF CONSTRUCTION: 5804 Paseo Montana OWNER'S NAME: Becker Enterprises
 CIRCLE: New Bldg. Add'n., Remodel, TYPE OF BLDG.: SFD APT. PUBLIC COMM.
 CONTRACTOR'S NAME: Big Town Plumbing STATE LICENSE # 3241A CITY LICENSE # 01201

UNITS	DESCRIPTION	FEE	TOTAL
2	Bathtub	1.00	2.00
	Shower	1.00	
4	Lavatory	1.00	4.00
3	Toilet	1.00	3.00
	Urinal	1.00	
	Floor Drain	1.00	
	Floor Sink	1.00	
	Wash Tray	1.00	
1	Sink	1.00	1.00
1	Garbage Disposal	1.00	1.00
	Garbage Disposal (comm.)	3.00	
	Clothes Dryer (gas)	1.00	
1	Clothes Washer	1.00	1.00
	Clothes Washer (comm.)	5.00	
1	Dishwasher	1.00	1.00
	Dishwasher (commercial)	5.00	
	Dental Unit	10.00	
	Drinking Fountain	1.00	
	Any Water using Equipment	1.00	
1	Water Heater (gas) (elect.)	1.00	1.00
1	Sewer System—New, Replacement, or any Drainage System	4.00	4.00
	Grease or Sand Trap	2.00	
	Trailer Trap	2.00	
	Septic Disposal System	4.00	
WATER SOFTENERS			
	Nonpermanent Type	4.00	
	Permanent Type (connected to Drainage)	5.00	
SWIMMING POOLS			
	Private or Wading Pool	10.00	
	Public or Semi-public	20.00	

UNITS	DESCRIPTION	FEE	TOTAL
WATER DISTRIBUTION SYSTEM			
1	Single Family Dwelling	4.00	4.00
	Multiple Family Dwelling plus each unit	4.00	
	Commercial Bldg. per floor	6.00	
	Hotel or Motel plus each bath	4.00	
	Trailer Park plus each space	20.00	
	Irrigation	1.00	
		4.00	
GAS PIPING SYSTEM			
	Single Family Dwelling	3.00	
	Multiple Family Dwelling plus each unit	6.00	
	Commercial Bldg. per floor plus each unit	1.00	
	Gas Appliance (any type)	3.00	
		3.00	
		1.00	
AUTOMATIC FIRE EXTINGUISHING SYSTEM			
	Underground Piping	10.00	
	Distribution Piping ea. ft.	01	
	Sprinkler Head each	10	
	In Range Hood and Vent	5.00	
DRY STANDPIPE SYSTEM			
	Piping	50.00	
	Each Outlet	1.00	
WET STANDPIPE SYSTEM			
	Piping	5.00	
	Fire Hose Cabinet	1.00	
	MINIMUM PERMIT FEE	4.00	
PIPELINE CONTRACTOR, SECT. 14 B.P.F.S.			
TOTAL PERMIT FEE \$			22.00

I hereby certify that I have carefully examined and read the above application; that the same is true and correct, and that the work to be done is to be done in accordance with all the provisions of the applicable Ordinances of the City of Las Vegas, Nevada and the State Laws, whether herein specified or not.

Approval for the work under this permit will be given only after refuse and debris have been removed from job site and public right of way.

Signed: [Signature] Date: 12/12/78
 Registered Master Plumber, Spec. Cont'r. or Owner
 Building Division: [Signature] Date: 12/13/78
 Permit No. 11569-8 Permit Fee \$ 22.00

154-01-222

RECEIPT

MUST BE MACHINE VALIDATED

L. Watson January 29, 1980

CITY OF LAS VEGAS, NEVADA

DEPARTMENT OF PUBLIC SERVICES - AIR CONDITIONING APPLICATION & PERMIT
DIVISION OF BUILDING AND SAFETY

ADDRESS OF CONSTRUCTION: 5804 Paseo Montana

OWNER'S NAME: Becker Enterprises

CIRCLE: Addition; Remodel; New Bldg; TYPE OF BLDG.: SFD APT. COMM. PUBLIC

CONTRACTOR'S NAME: Central Air Conditioning STATE LICENSE # 11997 CITY LICENSE # 00057

UNITS	DESCRIPTION	FEE	TOTAL	UNITS	DESCRIPTION	FEE	TOTAL
	Unit heater - floor, wall or suspended	4.00		EVAPORATIVE COOLERS:			
FOR EACH FORCED-AIR OR GRAVITY-TYPE FURNACE OR BURNER INCLUDING DUCTS AND VENT ATTACHED TO SUCH APPLIANCES:					5 outlets or under	3.00	
	Up to and including 100,000 B.t.u.'s	4.00			Over 5 and up to and including 10	5.00	
	Over 100,000 B.t.u.'s	6.00			Each additional outlet over 10	.25	
FOR EACH HEATING APPLICATION, REFRIGERATION UNIT, COMFORT COOLING AND HEATING UNIT, ABSORPTION UNIT, COMPRESSOR OR BOILER:				VENTILATION:			
	Up to and including 3 ton or horsepower, or absorption system up to and including 100,000 B.t.u.'s	4.00			For each fan connected to a single duct	1.00	
1-4	Over 3 ton or 3 horsepower up to and including 10, or absorption system over 100,000 B.t.u.'s up to and including 250,000 B.t.u.'s	7.00	7.00		For each commercial or industrial ventilation system	5.00	
	Over 10 ton or 10 horsepower up to and including 30, or absorption system over 250,000 B.t.u.'s up to and including 1,000,000 B.t.u.'s	12.00			For each commercial kitchen hood	5.00	
	Over 30 ton or 30 horsepower up to and including 50, or absorption system over 1,000,000 B.t.u.'s up to and including 1,700,000 B.t.u.'s	20.00		MISCELLANEOUS:			
	Over 50 ton or 50 horsepower, or absorption system over 1,700,000 B.t.u.'s	30.00			For each water cooling tower	8.00	
FOR EACH AIR HANDLING UNIT INCLUDING DUCTS ATTACHED THERETO:					Duct work only - each opening	.25	
	Up to and including 10,000 CFM	2.00			For installation or relocation of each commercial or industrial fan	15.00	
	Over 10,000 CFM	4.00			Gas piping related to the air cond. work in single family dwelling only	3.00	
					For each appliance, piece of equipment, any mechanical work or alteration or replacement not included in this schedule, the permit fee shall be computed the same as building permit fees by using the cost of installation for the valuation amount.		
						FOR THE ISSUANCE OF EACH PERMIT	3.00
						TOTAL PERMIT FEE \$	10.00

I hereby certify that I have carefully examined and read the above application; that the same is true and correct and that the work herein described is to be done in accordance with all the provisions of the applicable Ordinances of the City of Las Vegas, Nevada and the State Laws, whether herein specified or not.

Approval for the work under this permit will be given only after refuse and debris have been removed from job site and public right of way.

SIGNED: O. McDonald Date: 5/16/79
Air Conditioning Contractor - Owner

BUILDING DIVISION: M.S. Date: 5/18/79

PERMIT NO. 4145-19 PERMIT FEE \$ 10.00

154-01-224
#128

RECEIPT

MUST BE MACHINE VALIDATED

H. Gatawood February 8, 1980

CITY OF LAS VEGAS, NEVADA

DEPARTMENT OF PUBLIC SERVICES—ELECTRICAL APPLICATION & PERMIT

ADDRESS OF CONSTRUCTION: 5804 Paseo Montana OWNER'S NAME: Ernest Becker Enterprises

FILE: New Bldg. Add'l. Remodel TYPE OF BLDG.: APT. PUBLIC COMM. CITY: Gargae

CONTRACTOR'S NAME: Centerline Electric Inc LICENSE # 117288 CITY LICENSE # 011166

NUMBER	FIXTURE OR INSTALLATION	UNIT PRICE	TOTAL
	Rm addition, ceiling or floor enclosure	4.00	
	Temporary power	4.00	
6	Light receptacle or switch outlet	.20	1.20
	Wall or ceiling space heater	.35	
	Garbage grinder outlet	.35	
	Dishwasher outlet	.35	
	Clothes dryer outlet	.35	
	Automatic clothes washer	.35	
	Electric range outlet	.35	
	Electric water heater outlet	.35	
	Special purpose outlet	.35	
	X-ray unit and its equipment	5.00	
	Watts of festoon lighting (Wattage First 3,000 watts for each additional thousand watts)	4.00 1.50	
	Horsepower per each motor (First horsepower per less for each additional horsepower)	1.75 .35	
	Electric service (including any single meter socket) for each additional socket	3.00 .35	
	Air conditioning service	1.50	
	Each KW(KVA) Generator (Transformer, Welder) First 100 KVA for each additional KW(KVA)	2.00 .01	
	Speaker, signal or alarm outlet	.15	
	Amplifiers	.50	
	Control panels	.25	
	Main control racks	1.00	
	T.V. and radio antennas-master system only	.75	
	Minimum fee for any permit	4.00	
	TOTAL FEE		4.00

Approval for the work under this permit will be given only after refuse and debris have been removed from job site and public right of way.

I hereby certify that I have carefully examined and read the above application; that the same is true and correct; and that the work described is to be done in accordance with all the provisions of the applicable Ordinances of the City of Las Vegas, Nevada and State laws, whether herein specified or not.

SIGNED: [Signature] DATE: 11/16/79
 MASTER (ELECTRICIAN) (TECHNICIAN) (OWNER)

BUILDING DIVISION: M.S. DATE: 11/17/79

PERMIT NO.: 8437-8 PERMIT FEE: \$ 400

RECEIPT

MUST BE MACHINE VALIDATED

N. Gatewood February 8, 1980

CITY OF LAS VEGAS, NEVADA

DEPARTMENT OF PUBLIC SERVICES - ELECTRICAL APPLICATION & PERMIT
DIVISION OF BUILDING AND SAFETY

ADDRESS OF CONSTRUCTION: 5804 P... OWNER'S NAME: ...
 CIRCLE: New Bldg. Add'n. Remodel. TYPE OF BLDG.: SFD. APT. PUBLIC COMM.
 Contractor's Name: Centerline Electric Inc. STATE: 11728B CITY: C-11-189
 License #: XXXXX LICENSE #: XXXXX

NUMBER	FIXTURE OR INSTALLATION	UNIT PRICE	TOTAL
	Rm addition, carport or garage enclosure	4.00	
	Temporary power	4.00	
95	Light, receptacle or switch outlet	.20	19.00
	Wall or ceiling space heater	.35	
1	Garbage grinder outlet	.35	
1	Dishwasher outlet	.35	
1	Clothes dryer outlet	.35	
1	Automatic clothes washer	.35	
1	Electric range outlet	.35	
1	Electric water heater outlet	.35	
	Special purpose outlet	.35	
	X-ray unit and its appurtenances	5.00	
	Watts of festoon lighting (Watts) First 3,000 watts for each additional thousand watts	4.00 1.50	
	Horsepower each motor (First horsepower or less, for each additional horsepower)	1.75 .35	
1	Electric service (including any single meter socket) for each additional socket	3.00 .35	3.00
1	Air conditioning service	1.50	1.50
	Each KW(KVA) Generator (Transformer, Welder) First 100 KVA for each additional KW(KVA)	2.00 .01	
	Speaker, signal or alarm outlet	.15	
	Amplifiers	.50	
	Control panels	.25	
	Main control racks	1.00	
	T.V. and radio antennas-master system only	.75	
	Minimum fee for any permit	4.00	
	TOTAL FEE		25.60

200 Amp Underground Service

Approval for the work under this permit will be given only after refuse and debris have been removed from job site and public right of way.

I hereby certify that I have carefully examined and read the above application; that the same is true and correct; and that the work herein described is to be done in accordance with all the provisions of the applicable Ordinances of the City of Las Vegas, Nevada and State laws whether herein specified or not.

SIGNED: *[Signature]* DATE: 1-10-79
 MASTER ELECTRICIAN (TECHNICIAN) OWNER: John G. Black, President
 BUILDING DIVISION: M.S. DATE: 11/19/79
 PERMIT NO: 8434-15 PERMIT FEE \$: 25.60

RECEIPT
 MUST BE MACHINE ALIGNED

Done [unclear] 11/18/82

OWNER Becker & Sons ADDRESS 5804 Paseo
 DATE 11-13-78 GEN. CONT. same Montana
 TYPE OF STRUCTURE Garage Carport PERMIT NO. 10791-50
 LEGAL DESCRIPTION L12 B2 LOG # T39-4 AREA #
 APPROVED FOR OCCUPANCY & METER Char Hgts 53-B

BUILDING	MECHANICAL
Investigation	Plumbing Cont. <i>Be Town</i>
Location & Footing <i>OK 11-30-78</i>	Permit No. <i>11569</i> Date <i>12/13/78</i>
Concrete Slab Floor <i>OK 12-12-78</i>	Heat & Vent. A/C Cont.
Fireplace Footing	Permit No. Date
Chimney Steel	Sewer Cont. <i>Becker & Sons</i>
Vert. Steel Reinf.	Permit No. <i>10791</i> Date
Horiz. Steel Reinf.	Rough Soil <i>MC 1-8-79</i>
Framing <i>OK 3-9-79</i>	Rough Water
Ext. Lath <i>OK 5-12-79</i>	Top-Out <i>MC 4-17-79</i>
Ext. Brown	Rough Gas
Drywall	A/C Rough Duct <i>MC 4-19-79</i>
Final Building <i>2/25/80</i>	Final Plumbing <i>OK 12-7-79</i>
Appr. for Occu.	Final Gas
ELECTRICAL	MECHANICAL
Temp. Pole Cont.	Final Air Cond. <i>OK 12-7-79</i>
Permit No. Date	Final Sewer
Inspection Date	REMARKS
Electrical Cont. <i>Becker & Sons</i>	
Permit No. <i>8434</i> Date <i>11-19-79</i>	
Rough <i>MC 4-19-79</i>	
Final Rough	
Final Electrical <i>3 27 FEB 80</i>	
Temporary Service	

OWNER Becker & Sons ADDRESS 5804 Paseo
 DATE 11-31-78 GEN. CONT. same Montana
 TYPE OF STRUCTURE SFD PERMIT NO. 10791-48
 LEGAL DESCRIPTION L12 B2 LOG # T39-4 AREA #
 APPROVED FOR OCCUPANCY & METER Char Hgts Tr 53-B

BUILDING	MECHANICAL
Investigation	Plumbing Cont. <i>Be Town</i>
Location & Footing <i>OK 11-30-78</i>	Permit No. <i>11569</i> Date <i>12/13/78</i>
Concrete Slab Floor <i>OK 12-12-78</i>	Heat & Vent. A/C Cont.
Fireplace Footing	Permit No. Date
Chimney Steel	Sewer Cont. <i>Becker & Sons</i>
Vert. Steel Reinf.	Permit No. <i>10791</i> Date
Horiz. Steel Reinf.	Rough Soil <i>MC 1-8-79</i>
Framing <i>OK 3-9-79</i>	Rough Water
Ext. Lath <i>OK 5-12-79</i>	Top-Out <i>MC 4-17-79</i>
Ext. Brown	Rough Gas
Drywall	A/C Rough Duct <i>MC 4-19-79</i>
Final Building <i>2/25/80</i>	Final Plumbing <i>OK 12-7-79</i>
Appr. for Occu.	Final Gas
ELECTRICAL	MECHANICAL
Temp. Pole Cont.	Final Air Cond. <i>OK 12-7-79</i>
Permit No. Date	Final Sewer
Inspection Date	REMARKS
Electrical Cont. <i>Becker & Sons</i>	
Permit No. <i>8474</i> Date <i>1-19-79</i>	
Rough	
Final Rough	
Final Electrical <i>MC 10-12-79</i>	
Temporary Service	

PLEASE NOTE ADDITIONAL REMARKS ON REVERSE SIDE.
 DIV. OF BLDG. & SAFETY
 CITY OF LAS VEGAS
 REV. 10-78
 79-3-16

FENCE & RETAINING WALLS

OWNER Becker & Sons DATE 11-13-78
 ADDRESS 5804 Paseo Montana
 CONTRACTOR Becker Built PERMIT NO. 10791-49
 LOT 12 BLOCK 2 SUBDIVISION Char Hgts Tr
 LOG # T39-4 AREA 53-B

FENCES (wire, wood, block, & retaining walls)

Location	1st	2nd
<i>OK 11-1-79</i>		
<i>OK 11-1-79</i>		
Wall Steel		
Bond Beam		
1st		
2nd		
Final		
<i>OK 2-2-80</i>		

Specify Type Of Fence

DIV. OF BLDG. & SAFETY
 CITY OF LAS VEGAS

Don't know 11.18.82

Insulation JK6-29-79

1079-42

2