

6300 Parsifal Pl.

— L 16

B 17

CHARLESTON HEIGHTS #29-A ZONE R-1

5-21

1966 January 20 1966

964

CITY OF LAS VEGAS, NEVADA
DEPARTMENT OF BUILDING AND SAFETY
APPLICATION FOR FENCE, WALL OR
RETAINING WALL

LOG NO. _____
AREA: _____
KARDEX CARD: _____
TELEPHONE: _____

CONSTRUCTION VALUATION: _____
INSPECTION VALUATION: _____
PERMIT FEE: _____
PERMIT NUMBER: 33812
DATE: 1-19-66

ADDRESS OF CONSTRUCTION: 300 Parry Pl. OWNER'S NAME: W.M. LaRue OWNER'S ADDRESS: 6300 Parry Pl.

Lot (s) 16 Block 17 Subdivision Trust 294 Charleston Heights Zone 21

Materials of Concrete Construction: Block (X) Concrete (X) Wire () Wood () Other ()

Total Square Feet: 270 SQ. FT. DRIVEWAY Total Linear Feet: 129.52 WALL

CONTRACTOR'S NAME: OWNER STATE LICENSE # _____ CITY LICENSE # _____

Architect's Name: _____ PLANS SUBMITTED: Yes No
Engineer's Name: _____ CALCULATIONS: Yes No

Street Name: Parry Place
Front Yard: _____ Feet

I understand that any portion of this (fence) (wall) constructed or erected on City property or right-of-way will be removed from said location at my expense upon request received from the City of Las Vegas, Nevada. I understand that the (fence) (wall) shall not enclose water meter, light standard, fire alarm box and shall not come closer than two (2') feet in any direction from any fire hydrant. I further state that I am familiar with effective Ordinances of the City of Las Vegas, Nev. and effective Statutes of the State of Nevada covering construction and use of above type; I agree to perform said construction in conformity therewith. I further agree that issuance of a permit on above application will not excuse me from conforming with said Ordinances and Statutes, despite any errors on the part of the Building Inspector or Engineer in checking plans and applications herewith submitted.

I have read and understand the contents of above application. I hereby state that same are true and correct.

SIGN HERE: Wm. M. LaRue
By: _____

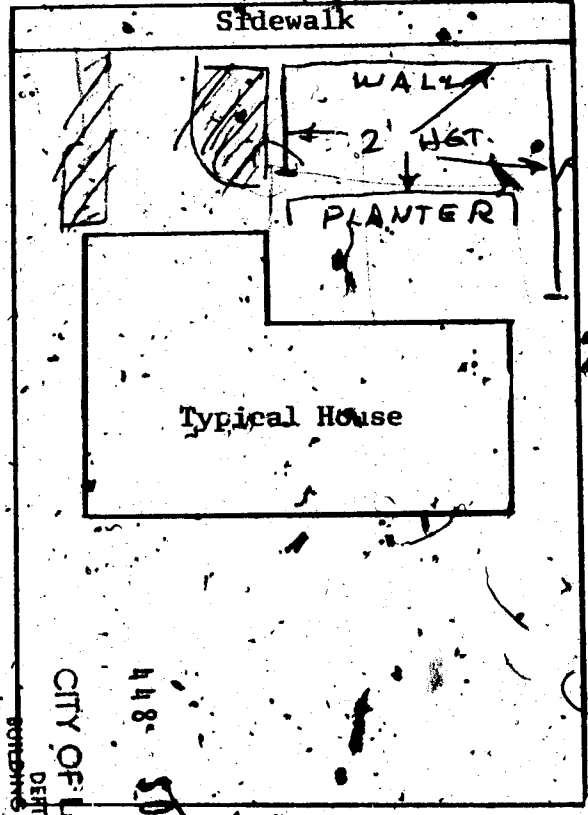

Side Yard Length _____ Feet
CITY OF LAS VEGAS
DEPT. OF BUILDING AND SAFETY
REAR YARD _____ Feet
19 JAN 66

APPROVED BY: [Signature] DATE: 5/19/66
PLANNING DEPT. & CODE ASSISTANCE
FIRE DEPARTMENT DATE: _____
ENGINEERING DEPT. DATE: _____
BUILDING & SAFETY DEPT. DATE: _____

Note: Owner or Contractor must call for all inspections required.

Home Today 11-17-82

DEPT. of BLDG & SAFETY - CITY of LAS VEGAS, NEVADA

OWNER Sproul Homes ADDRESS 6300 Parsifal Place DATE 3/27/63
 GEN. CONT. owner TYPE OF STRUCTURE SEV
 PERMIT NO. 17796 LEGAL DESCRIPTION lot 16, block 7, 29-A

| BUILDING | MECHANICAL | ELECTRICAL |
|--|---|---|
| LOCATION <u>82 27-00</u> | PLUMBING CONT. <u>10/21/62</u> | TEMP. POLE CONT. |
| FIREPLACE FTG. <u>59-63</u> | PERMIT NO. <u>10912</u> DATE <u>4-1-63</u> | PERMIT NO. _____ DATE _____ |
| FOOTINGS <u>15-15-63</u> | HEAT & VENT. AC CONT. <u>Acme</u> | INSPECTION _____ DATE _____ |
| FOUNDATION WALL _____ | PERMIT NO. <u>8131</u> DATE <u>5-4-60</u> | ELECTRICAL CONT. <u>12559</u> |
| FLOOR FRAMING _____ | SEWER CONT. <u>109412</u> | PERMIT NO. <u>12559</u> DATE <u>5-25-63</u> |
| SLAB <u>5-15-63</u> | PERMIT NO. <u>109412</u> DATE <u>4-1-60</u> | FIXTURES CONT. _____ |
| CHIMNEY STEEL (FIREPLACE) _____ | ROUGH SOIL <u>10-6-63</u> | PERMIT NO. <u>12559</u> DATE _____ |
| WALL STEEL _____ | ROUGH WATER <u>10-6-63</u> | SLAB _____ |
| COLUMN STEEL _____ | TOP-OUT <u>7-17-63</u> | ROUGH _____ |
| BEAM STEEL _____ | ROUGH GAS _____ | FINAL ROUGH _____ |
| FRAMING _____ | AC ROUGH DUCT <u>10-6-63</u> | FINAL FIXTURE _____ |
| ROOF SHEATHING _____ | REF. ROUGH PIPING _____ | FINAL ELECTRICAL <u>10-28-63</u> |
| DRYWALL _____ | FINAL PLUMBING <u>10-26-63</u> | TEMPORARY SERVICE _____ |
| LATHING _____ | FINAL GAS _____ | |
| BACKING (SIDING) _____ | FINAL AIR COND. <u>10-26-63</u> | |
| PLASTER SCRATCH _____ | FINAL REFRIG. _____ | |
| BROWN _____ | FINAL SEWER _____ | |
| URBAN REDEVELOPMENT APPROVAL _____ | FINAL SEPTIC TANK _____ | |
| FINAL BLDG. <u>10-26-63</u> DATE <u>10-26-63</u> | | |

APPROVED FOR OCCUPANCY & METER Shultz INSPECTOR 8-26-63 DATE _____

PLEASE NOTE REMARKS ON REVERSE SIDE see reverse LOG # 4 AREA # _____ 23.04

6300 Parsifal Place T-35

DEPT. of BLDG & SAFETY - CITY of LAS VEGAS, NEVADA

OWNER Dwight N. Larue ADDRESS 6300 Parsifal Pl. DATE 6-3-64
 GEN. CONT. Same TYPE OF STRUCTURE Conc. Blk
 PERMIT NO. 25813 LEGAL DESCRIPTION _____

| BUILDING | MECHANICAL | ELECTRICAL |
|--|-----------------------------|-----------------------------|
| LOCATION _____ | PLUMBING CONT. _____ | TEMP. POLE CONT. |
| FIREPLACE FTG. _____ | PERMIT NO. _____ DATE _____ | PERMIT NO. _____ DATE _____ |
| FOOTINGS _____ | HEAT & VENT. AC CONT. _____ | INSPECTION _____ DATE _____ |
| FOUNDATION WALL _____ | PERMIT NO. _____ DATE _____ | ELECTRICAL CONT. _____ |
| FLOOR FRAMING _____ | SEWER CONT. _____ | PERMIT NO. _____ DATE _____ |
| SLAB _____ | PERMIT NO. _____ DATE _____ | FIXTURES CONT. _____ |
| CHIMNEY STEEL (FIREPLACE) _____ | ROUGH SOIL _____ | PERMIT NO. _____ DATE _____ |
| WALL STEEL _____ | ROUGH WATER _____ | SLAB _____ |
| COLUMN STEEL _____ | TOP-OUT _____ | ROUGH _____ |
| BEAM STEEL _____ | ROUGH GAS _____ | FINAL ROUGH _____ |
| FRAMING _____ | AC ROUGH DUCT _____ | FINAL FIXTURE _____ |
| ROOF SHEATHING _____ | REF. ROUGH PIPING _____ | FINAL ELECTRICAL _____ |
| DRYWALL _____ | FINAL PLUMBING _____ | TEMPORARY SERVICE _____ |
| LATHING _____ | FINAL GAS _____ | |
| BACKING (SIDING) _____ | FINAL AIR COND. _____ | |
| PLASTER SCRATCH _____ | FINAL REFRIG. _____ | |
| BROWN _____ | FINAL SEWER _____ | |
| URBAN REDEVELOPMENT APPROVAL _____ | FINAL SEPTIC TANK _____ | |
| FINAL BLDG. <u>6-3-64</u> DATE <u>6-3-64</u> | | |

APPROVED FOR OCCUPANCY & METER _____ INSPECTOR _____ DATE _____

PLEASE NOTE REMARKS ON REVERSE SIDE _____ LOG # _____ AREA # _____ 23.04

6300 Parsifal Pl.

Done 4/18/82

Sam Lee
9-19-63 + 735730
water softener
17796

DEPARTMENT OF BUILDING & SAFETY
CITY OF LAS VEGAS, NEVADA

KARBEX CARD
FENCE & RETAINING
WALLS

OWNER D. M. La Rue ADDRESS XX4 6300 Parsifal DATE 5/19/66

CONTRACTOR Owner PERMIT NO. 33812

LOT 16 BLOCK 17 SUBDIVISION Chs. Hgts Tr 29A

fence (wire, wood, etc.) Concrete block wall & planter
Walls (masonry, rock, etc.)

Location _____
Final Inspection [Signature] Location _____
Footings _____
Wall Steel 1st [Signature] 2d _____ 3d _____
Final Inspection [Signature]

Retaining Wall (masonry) Retaining Wall (concrete)
Location _____ Location _____
Footings _____ Footings _____
Wall Steel 1st _____ 2d _____ 3d _____
Bond Beam 1st _____ 2d _____ 3d _____
Final Inspection _____ Final Inspection _____

23.14 B ADDRESS 6300 Parsifal LOG NO. _____ AREA _____