

6204 Parsifal Pl.

— — L 2

B 7

CHARLESTON EHIGHTS #29-A

ZONE R-1 — —

City of Las Vegas, Nevada January 20, 1980

CITY OF LAS VEGAS, NEVADA

LOG NO. & AREA

CONST. VAL. \$ 149 00

DEPARTMENT OF BUILDING & SAFETY

APPLICATION & BUILDING PERMIT — for: Fence, Wall, Retaining Wall.

ADDRESS OF CONSTRUCTION:

6204 PARISIAL PLACE OWNER: Rainey & Louise

LOT(S)

BLOCK

SUBDIVISION

C. Hy. No. 29-A

ZONE: R-1

Materials of Construction:

Block

Concrete

Wire

Wood

Other

Yes No

PLANS:

ARCHITECT:

ENGINEER:

CALCS:

CONTRACTOR

American Fence

STATE LICENSE #

8587

CITY LICENSE #

7584

TOTAL SQUARE FEET:

TOTAL LINEAL FEET: 27 000

Remarks:

CONDITIONS OF THE PERMIT:

1. Any type of retaining wall must be engineered by a Civil or Structural Engineer.
2. If a home owner takes out the Building Permit and if the owner sublets the work to a Contractor, then the Contractor must take out the permit and pay for it.
3. No fence or wall can be built on City property or rights-of-way, but this is not intended to preclude construction within utility easements if utilities will not be damaged or made inaccessible.
4. The fence or wall shall not enclose any water meter, light standard, or fire alarm box and shall not come closer than 24" from the nearest fire hydrant outlet.
5. Department Inspectors must approve footings before concrete is poured and block wall reinforcing before grouting is done.
6. Maximum height of any wall or fence is 6', side and rear yards; 4' maximum in front yard with the vertical surface above the height of 2' - 50% open and further that fencing within 25' of the intersection of curb faces on corner and through lots is limited to a maximum height of 30".
7. I must not obstruct required onsite parking space (1 space for each dwelling unit) by the erection of this fence or wall.
8. By the signing of this application I herewith agree to the requirements outlined above.

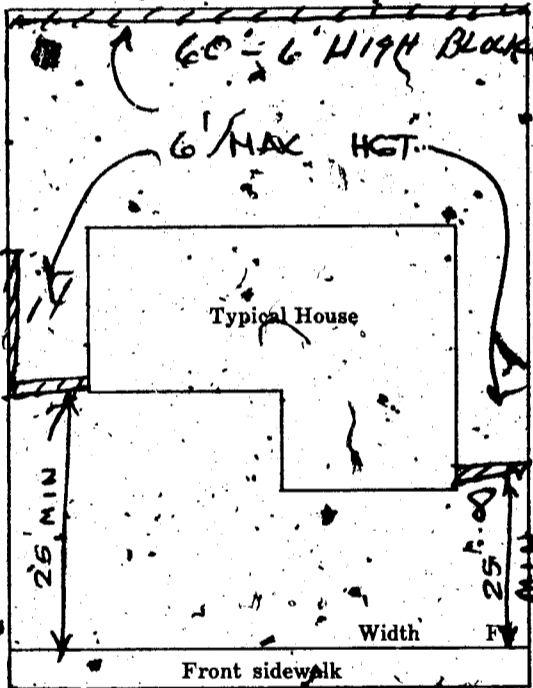

SIGNED

*[Signature]*

DATE:

4-18-68

CONTRACTOR  AGENT  OWNER

PLANNING DEPT:

Date:

4-4-68

ENGINEERING DEPT:

Date:

BUILDING DEPT:

Date:

4-4-68

#1285

PERMIT NO:

41154

PERMIT FEE \$

400

RECEIPT

7263 \$000.00 - 8

CITY OF LAS VEGAS

DEPT. OF BUILDING & SAFETY

MUST BE MACHINE VALIDATED

APR 68

H. H. Greenwood January 29, 1968

CITY OF LAS VEGAS, NEVADA

CONST. VAL. \$ 9000

LOG NO. & AREA \_\_\_\_\_

DEPARTMENT OF BUILDING & SAFETY

APPLICATION & BUILDING PERMIT — for:  
Fence, Wall, Retaining Wall.

ADDRESS OF CONSTRUCTION: 6204 PARISIAL

OWNER: R.H. GROSSE

LOT(s) 2 BLOCK 7 SUBDIVISION Ch. City to # 29-A

ZONE: R-1

Materials of Construction: Block  Concrete  Wire  Wood  Other

PLANS:

ARCHITECT: \_\_\_\_\_ ENGINEER: \_\_\_\_\_

CALCS:

CONTRACTOR: American Fence

STATE LICENSE 8581

CITY LICENSE 7574

TOTAL SQUARE FEET: \_\_\_\_\_ TOTAL LINEAL FEET: 145

Remarks:  
\_\_\_\_\_  
\_\_\_\_\_  
\_\_\_\_\_

CONDITIONS OF THE PERMIT:

1. Any type of retaining wall must be engineered by a Civil or Structural Engineer.
2. If a home owner takes out the Building Permit and if the owner sublets the work to a Contractor, then the Contractor must take out the permit and pay for it.
3. No fence or wall can be built on City property or rights of way, but this is not intended to preclude construction within utility easements if utilities will not be damaged or made inaccessible.
4. The fence or wall shall not enclose any water meter, light standard, or fire alarm box and shall not come closer than 24" from the nearest fire hydrant outlet.
5. Department Inspectors must approve footings before concrete is poured and block wall reinforcing before grouting is done.
6. Maximum height of any wall or fence is 6', side and rear yards; 4' maximum in front yard with the vertical surface above the height of 2' — 50% open, and further that fencing within 25' of the intersection of curb faces on corner and through lots is limited to a maximum height of 30".
7. I must not obstruct required onsite parking space (1 space for each dwelling unit) by the erection of this fence or wall.
8. By the signing of this application, I herewith agree to the requirements outlined above.

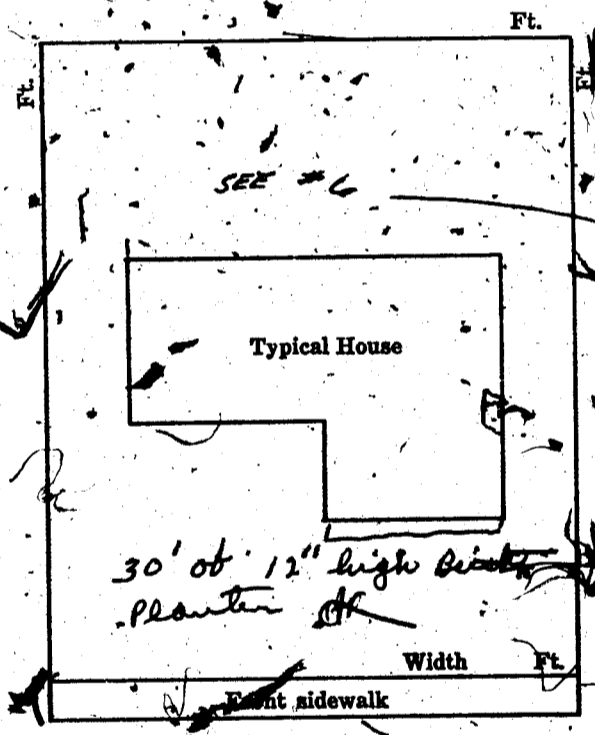

SIGNED: [Signature] DATE: 10-28-68  
CONTRACTOR  AGENT  OWNER

PLANNING DEPT: [Signature] Date: 10-28-68  
ENGINEERING DEPT: \_\_\_\_\_ Date: \_\_\_\_\_  
BUILDING DEPT: [Signature] Date: 10-29-68

#1285 PERMIT NO: 238 PERMIT FEE \$ 300

RECEIPT  
7384 \$003.00 - 8

CITY OF LAS VEGAS  
DEPT. OF  
BUILDING & SAFETY

MUST BE MACHINE VALIDATED  
NOV 68

Done [unclear] 11-18-82

DEPARTMENT OF BUILDING & SAFETY  
CITY OF LAS VEGAS, NEVADA

KARDEX CARD  
FENCE & RETAINING  
WALLS

OWNER R. H. GROSSE ADDRESS 6201 PARSIFAL DATE 11-1-68

CONTRACTOR AMERICAN FENCE PERMIT NO. 45038

LOT 2 BLOCK 7 SUBDIVISION CHS HTS. #29-A  
BLK. FENCE

Fence (wire, wood, etc.)		Walls (masonry, rock, etc.)	
Location _____		Location _____	
Final Inspection _____		Footing _____	
		Wall Steel 1st _____ 2d _____ 3d _____	
		Final Inspection <u>Offn 3-19-71</u>	
Retaining Wall (masonry)		Retaining Wall (concrete)	
Location _____		Location _____	
Footing _____		Footing _____	
Wall Steel 1st _____ 2d _____ 3d _____		Wall Steel 1st _____ 2d _____ 3d _____	
Bond Beam 1st _____ 2d _____ 3d _____		Final Inspection _____	
Final Inspection _____			

23.14 B ADDRESS 6201 PARSIFAL LOG NO. \_\_\_\_\_ AREA \_\_\_\_\_

DEPARTMENT OF BUILDING & SAFETY  
CITY OF LAS VEGAS, NEVADA

KARDEX CARD  
FENCE & RETAINING  
WALLS

OWNER RAINIER GROSSE ADDRESS 6201 PARSIFAL PL. DATE 1-1-68

CONTRACTOR AMERICAN FENCE PERMIT NO. 11151

LOT 2 BLOCK 7 SUBDIVISION C.H. #29-A  
BLK & WOOD FENCE

Fence (wire, wood, etc.)		Walls (masonry, rock, etc.)	
Location <u>CH 4-5-68</u>		Location _____	
Final Inspection <u>CH 4-22-68</u>		Footing <u>CH 4-5-68</u>	
		Wall Steel 1st _____ 2d _____ 3d _____	
		Final Inspection <u>CH 4-22-68</u>	
Retaining Wall (masonry)		Retaining Wall (concrete)	
Location _____		Location _____	
Footing _____		Footing _____	
Wall Steel 1st _____ 2d _____ 3d _____		Wall Steel 1st _____ 2d _____ 3d _____	
Bond Beam 1st _____ 2d _____ 3d _____		Final Inspection _____	
Final Inspection _____			

23.14 B ADDRESS 6201 PARSIFAL PL. LOG NO. \_\_\_\_\_ AREA \_\_\_\_\_

Done by 11/18/82

DEPT. of BLDG & SAFETY - CITY of LAS VEGAS, NEVADA

OWNER Sproul Homes ADDRESS 6204 Parsifal Place DATE 6/63  
GEN CONT. owner TYPE OF STRUCTURE SPD  
PERMIT NO. 17792 LEGAL DESCRIPTION lot 2, block 7, 29-A

BUILDING		MECHANICAL		ELECTRICAL	
LOCATION <u>7-17-63</u>		PLUMBING CONT. <u>11013</u>		TEMP. POLE CONT.	
FIREPLACE FTG.		PERMIT NO. <u>11013</u>	DATE <u>7-1-63</u>	PERMIT NO.	DATE
FOOTINGS <u>7-17-63</u>		HEAT & VENT. AC CONT. <u>Acme</u>		INSPECTION	DATE
FOUNDATION WALL		PERMIT NO. <u>8086</u>	DATE <u>5-14-63</u>	ELECTRICAL CONT. <u>2543</u>	DATE <u>5-2-63</u>
FLOOR FRAMING		SEWER CONT. <u>11013</u>		PERMIT NO. <u>2543</u>	DATE <u>5-2-63</u>
SLAB <u>7-17-63</u>		PERMIT NO. <u>11013</u>	DATE <u>7-1-63</u>	FIXTURES CONT. <u>2543</u>	DATE
CHIMNEY STEEL (FIREPLACE)		ROUGH SOIL <u>6-7-63</u>		PERMIT NO. <u>2543</u>	DATE
WALL STEEL		ROUGH WATER <u>6-7-63</u>		ROUGH <u>7-1-63</u>	
COLUMN STEEL		ROUGH GAS <u>7-1-63</u>		FINAL ROUGH	
BEAM STEEL		AC ROUGH DUCT <u>6-7-63</u>		FINAL FIXTURE	
FRAMING <u>7-16-63</u>		REF ROUGH PIPING		FINAL ELECTRICAL <u>West 8-27-63</u>	
ROOF SHEATHING <u>6-17-63</u>		FINAL PLUMBING <u>Johnston 8-27-63</u>		TEMPORARY SERVICE	
	INTERIOR	FINAL GAS			
DRYWALL <u>8-25-63</u>		FINAL AIR COND. <u>Philips 8-27-63</u>			
LATHING		FINAL REFRIG.			
D. KIND (SIDING)		FINAL SEWER <u>6-28-63</u>			
PLASTER SCRATCH		FINAL SEPTIC TANK			
PLASTER BROWN					
URBAN REDEVELOPMENT APPROVAL					
FINAL BLDG <u>11/18</u>	DATE <u>8-29-63</u>				

APPROVED FOR OCCUPANCY & METER

INSPECTOR

DATE

PLEASE NOTE REMARKS ON REVERSE SIDE

LOG #

AREA #

23.04

6204 Parsifal Place

T-85

4