

-2407
2405 Pardee

L-9 B1k. 7 Sub. Fran. Pk. Z-R2

M. Holman 25, 1980

CITY OF LAS VEGAS, NEVADA

LOG NO. & AREA _____ CONST. VAL. \$ 218.00

DEPARTMENT OF BUILDING & SAFETY

APPLICATION & BUILDING PERMIT - for: Fence, Wall, Retaining Wall.

ADDRESS OF CONSTRUCTION: 2405 S. P. Ave. OWNER: Lennard Jones

LOT(s) 41 BLOCK 7 SUBDIVISION FRANCISCO PARK ZONE R-2

Materials of Construction: Block Concrete Wire Wood Other Yes No
ARCHITECT: _____ ENGINEER: _____ PLANS:
CALCS:

CONTRACTOR: LOWE Fencing STATE LICENSE # 11891 CITY LICENSE # C11-9636

TOTAL SQUARE FEET: _____ TOTAL LINEAL FEET: 109

Remarks:

CONDITIONS OF THE PERMIT:

1. Any type of retaining wall must be engineered by a Civil or Structural Engineer.
2. If a home owner takes out the Building Permit and if the owner sublets the work to a Contractor, then the Contractor must take out the permit and pay for it.
3. No fence or wall can be built on City property or rights-of-way, but this is not intended to preclude construction within utility easements if utilities will not be damaged or made inaccessible.
4. The fence or wall shall not enclose any water meter, light standard, or fire alarm box and shall not come closer than 24" from the nearest fire hydrant outlet.
5. Department Inspectors must approve footings before concrete is poured and block wall reinforcing before grouting is done.
6. Maximum height of any wall or fence is 6' side and rear yards, 4' maximum in front yard with the vertical surface above the height of 2' - 50% open.
7. I must not obstruct required onsite parking space (1 space for each dwelling unit) by the erection of this fence or wall.
8. By the signing of this application I herewith agree to the requirements outlined above.

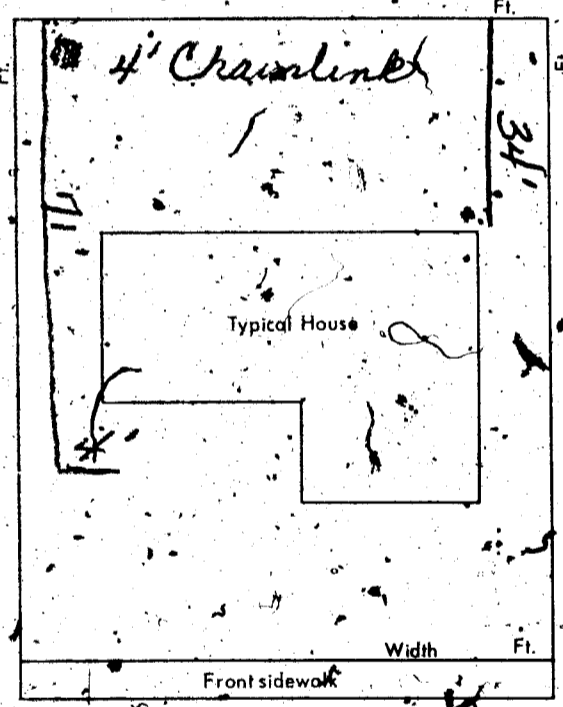

SIGNED: Rita P. Lowe DATE 5-14-74
CONTRACTOR AGENT OWNER

PLANNING DEPT.: _____ Date: 5-19-74
PUBLIC WORKS DEPT.: _____ Date: _____
BUILDING DEPT.: _____ Date: 5-14-74
#12850 PERMIT NO: 16682 PERMIT FEE \$ 5.00

RECEIPT
2303 \$005.00 - 8
CITY OF LAS VEGAS
DEPT. OF BUILDING & SAFETY
MUST BE MACHINE VALIDATED
4 MAY 74

H. Barton January 25, 1980

CITY OF LAS VEGAS, NEVADA

DEPARTMENT OF BUILDING & SAFETY - APPLICATION AND PERMIT FOR PLUMBING

ADDRESS OF CONSTRUCTION: 2405 S. PAROSE

OWNER'S NAME: L. Jones

CIRCLE: New Bldg.; Add'n.; Remodel; TYPE OF BLDG.: SFD. APT. PUBLIC COMM.

CONTRACTOR'S NAME: Ray Plumbing

STATE LICENSE # 6025

CITY LICENSE # 8056

| UNITS | DESCRIPTION | FEE | TOTAL |
|------------------------|---|-------|-------|
| | Bathtub | 1.00 | |
| | Shower | 1.00 | |
| | Lavatory | 1.00 | |
| | Toilet | 1.00 | |
| | Urinal | 1.00 | |
| | Floor Drain | 1.00 | |
| | Floor Sink | 1.00 | |
| | Wash Tray | 1.00 | |
| | Sink | 1.00 | |
| | Garbage Disposal | 1.00 | |
| | Garbage Disposal (comm.) | 3.00 | |
| | Clothes Dryer (gas) | 1.00 | |
| | Clothes Washer | 1.00 | |
| | Clothes Washer (comm.) | 5.00 | |
| | Dishwasher | 1.00 | |
| | Dishwasher (commercial) | 5.00 | |
| | Dental Unit | 10.00 | |
| | Drinking Fountain | 1.00 | |
| | Any Water using Equipment | 1.00 | |
| | Water Heater (gas/elect.) | 1.00 | |
| | Sewer System - New, Replacement, or any Drainage System | 4.00 | |
| | Grease or Sand Trap | 2.00 | |
| | Trailer Trap | 2.00 | |
| | Septic Disposal System | 4.00 | |
| WATER SOFTENERS | | | |
| | Non-permanent Type | 4.00 | |
| | Permanent Type (connected to Drainage) | 5.00 | |
| SWIMMING POOLS | | | |
| | Private or Wading Pool | 10.00 | |
| | Public or Semi-public | 20.00 | |

| UNITS | DESCRIPTION | FEE | TOTAL |
|--|---|---------------|-------|
| WATER DISTRIBUTION SYSTEM | | | |
| | Single Family Dwelling | 4.00 | |
| | Multiple Family Dwelling plus each unit | 4.00 2.00 | |
| | Bldg. Group "A" thru "G" per each floor | 6.00 | |
| | Hotel or Motel plus each bath | 4.00 1.50 | |
| | Trailer Park plus each space | 20.00 1.00 | |
| | Irrigation | 4.00 | |
| GAS PIPING SYSTEM | | | |
| | Single Family Dwelling | 3.00 | 3.00 |
| | Multiple Family Dwelling plus each unit | 6.00 1.00 | |
| | Commercial Bldg. per floor plus each unit | 3.00 3.00 | |
| | Gas Appliance (any type) | 1.00 | 3.00 |
| AUTOMATIC FIRE EXTINGUISHING SYSTEM | | | |
| | Underground Piping | 10.00 | |
| | Distribution Piping ea. ft. | .01 | |
| | Sprinkler Head each | .10 | |
| | In Range Hood and Vent | 5.00 | |
| DRY STANDPIPE SYSTEM | | | |
| | Piping | 50.00 | |
| | Each Outlet | 1.00 | |
| WET STANDPIPE SYSTEM | | | |
| | Piping | 5.00 | |
| | Fire Hose Cabinet | 1.00 | |
| | MINIMUM PERMIT FEE | 4.00 | |
| PIPELINE CONTRACTOR: SECT. 14-B.P.F. \$ | | | |
| TOTAL PERMIT FEE \$ <u>6.00</u> | | | |

I hereby certify that I have carefully examined and read the above application; that the same is true and correct and that the work herein described is to be done in accordance with all the provisions of the applicable Ordinances of the City of Las Vegas, Nevada and the State Laws, whether herein specified or not.

Approval for the work under this permit will be given only after refuse and debris have been removed from job site and public right of way.

Signed: Troy Ray Date: 5-29-75
Registered Master Plumber, Spec. Contr. or Owner
 Building Department: [Signature] Date: 5-29-75
 Permit No. 301 Permit Fee \$ 6.00

#12870

RECEIPT
 5777 \$006.00 - 8
 CITY OF LAS VEGAS
 DEPT. OF BUILDING & SAFETY
 MUST BE MACHINE VALIDATED
 29 MAY 75

11-16-82

Department of Building & Safety
City of Las Vegas, Nevada

Special Kardex
Elec. only, Plbg. only, A.C. only

Owner L. Loves Address 2405 S. Pardee Date: 5/29/75
Contractor _____ Permit No. _____
Lot _____ Block _____ Subdivision _____

| Electric Only | Plumbing Only | Heat & Vent. A. C. Only |
|---------------------|----------------------------|-------------------------|
| Contractor _____ | Contractor <u>Ray</u> | Contractor _____ |
| Permit No. _____ | Permit No. <u>1301</u> | Permit No. _____ |
| Slab _____ | Rough/Soil _____ | A.C. Rough Duct _____ |
| Rough Elect _____ | Rough Water _____ | Ref. Ro. Piping _____ |
| Final Rough _____ | Top Out _____ | Rough Gas _____ |
| Final Fixture _____ | Rough Gas _____ | Final Refrig _____ |
| Final Elec _____ | Final Plbg. _____ | Final Air Cond _____ |
| Temp. Service _____ | Final Gas <u>RW 6-1-75</u> | Final Gas _____ |
| | Final Sewer _____ | |
| | Final Septic Tank _____ | |

23.06 D Address 2405 S. Pardee Log No. Gas Area _____

DEPARTMENT OF BUILDING & SAFETY
CITY OF LAS VEGAS, NEVADA

KARDEX CARD
FENCE & RETAINING
WALLS
DATE 5-14-74

OWNER Leonard Jones ADDRESS 2405 S. Pardee
CONTRACTOR Low Fencing PERMIT NO. 16682
LOT 9 BLOCK 7 SUBDIVISION Francisco Park wire fence

| Fence (wire, wood, etc.) | Walls (masonry, rock, etc.) |
|--|--|
| Location _____ | Location _____ |
| Final Inspection <u>AB 6-13-74</u> | Footings _____ |
| | Wall Steel 1st _____ 2d _____ 3d _____ |
| | Final Inspection _____ |
| Retaining Wall (masonry) | Retaining Wall (concrete) |
| Location _____ | Location _____ |
| Footings _____ | Footings _____ |
| Wall Steel 1st _____ 2d _____ 3d _____ | Wall Steel 1st _____ 2d _____ 3d _____ |
| Bond Beam 1st _____ 2d _____ 3d _____ | Final Inspection _____ |
| Final Inspection _____ | |

23.14 B ADDRESS 2405 S. Pardee LOG NO. _____ AREA _____

Debbie Hightman 11-16-88

CITY OF LAS VEGAS, NEVADA

LOG NO. & AREA _____ DATE _____ CONST. VAL. \$ _____

DEPARTMENT OF BUILDING AND SAFETY

PLUMBING PERMIT

PHONE 386-6251

ADDRESS OF CONSTRUCTION 2407 Paradise Pl OWNER Miguel Gonzalez PHONE _____

CONTRACTOR owner STATE LICENSE NO. _____ CITY LICENSE NO. _____

LOT(s) _____ BLOCK _____ SUBDIVISION _____ ZONE _____

PROPOSED CONSTRUCTION: REPLACING EXISTING GAS LINE USE _____
 PLUMBING PERMIT NO. 7123

Approval for the work under this permit will be given only after refuse and debris have been removed from job site and public right of way.

| UNITS | DESCRIPTION | FEE | TOTAL |
|----------------------------------|---|----------|-------|
| PERMIT ISSUANCE | | | |
| 1 | For Issuing Each Permit | 10.00 | 10 |
| | For Issuing Each Supplemental Permit | 4.50 | |
| FIXTURE CHARGE | | | |
| | Bathub, Shower, Lavatory, Toilet, Urinal | EA. 2.00 | |
| | Floor Drain, Floor Sink, Wash Tray, Sink | EA. 2.00 | |
| | Garbage Disposal, Clothes Washer, Dishwasher (residential) | EA. 2.00 | |
| | Garbage Disposal (commercial) | EA. 8.00 | |
| | Clothes Washer, Dishwasher (commercial) | EA. 2.00 | |
| | Clothes Dryer (gas) (venting) | 2.00 | |
| | Dental Unit | 8.00 | |
| | Drinking Fountain | 2.00 | |
| | Refrigerator - Ice Maker, Water Dispenser | 2.00 | |
| | Any other water using equipment, Attached Coffee Makers, Ice Makers | 2.00 | |
| | Hot Water Heater (Gas or Electric) | EA. 2.00 | |
| SEWER SYSTEM | | | |
| | New, Replacement, Modification, or Any Drainage Work | 10.00 | |
| | Grease or Sand Trap or Interceptor | 2.00 | |
| | Trailer Trap (rental parks) | 5.00 | |
| WATER SOFTENERS | | | |
| | Non Permanent Type (rental) | 2.00 | |
| | Permanent Type (connected to drain) | 2.00 | |
| WATER DISTRIBUTION SYSTEM | | | |
| | Single Family Dwelling | 6.00 | |
| | Multi-Family Dwelling | 6.00 | |
| | Plus Each Dwelling Unit | 3.00 | |
| | Commercial Building per floor | 3.00 | |
| | Plus Each Unit (leased space or office) | 2.00 | |
| | Hotel or Motel | 8.00 | |
| | Plus Each Unit | 3.00 | |
| | Trailer Park | 30.00 | |
| | Plus Each Space | 2.00 | |
| | Irrigation Single Family Dwelling | 8.00 | |
| | Irrigation Commercial Fee Based on Building Code Valuation Chart | | |
| | Construction Valuation | | |

| UNITS | DESCRIPTION | FEE | TOTAL |
|------------------------------------|--|----------------|-------|
| FUEL PIPING SYSTEM | | | |
| 1 | Single Family Dwelling | 6.00 | 6 |
| | Multi-Family Dwelling | 10.00 | |
| | Plus Each Unit | -2.00 | |
| | Commercial Building (per floor) | 6.00 | |
| | Plus Each Unit (leased space or office) | 6.00 | |
| | Medium Pressure System (Plan Check) | 12.00 | |
| | Each Gas Appliance (Any Type) | 2.00 | |
| | Steam Boilers | 5.00 | |
| SOLAR ENERGY SYSTEMS | | | |
| | Collectors (including piping) (per collector) | 5.00 | |
| | Storage Tanks (each) | 5.00 | |
| PIPELINE CONTRACT | | | |
| | For Onsite Sewer, Gas or Water Contract Value. Fee based on Building Code Permit Valuation Chart. | | |
| OTHER INSPECTIONS AND FEES: | | | |
| | Inspections outside of normal business hours (minimum charge—three hours) | 25.00 per hour | |
| | Under provisions of Table 3-A of the Uniform Building Code, work which has been inspected once and not approved may be subject to a Reinspection Fee not less than \$30.00 per each inspection during business hours | 30.00 each | |
| | Additional plan review required by changes. Additions to or revisions to approved plans (minimum charge two hours) | 30.00 per hour | |
| | Plumbing permit fees may be computed the same as building permit fees by using the cost of installation for valuation amount when such work is not included in the above schedule. | | |
| | Construction Valuation | | |

I hereby certify that I have carefully examined and read the above application; that the same is true and correct; and that the work herein described is to be done in accordance with all the provisions of the applicable Ordinances of the City of Las Vegas, Nevada and the State Laws, whether herein specified or not.

FOR INSPECTIONS CALL 799-2071

SEWER # 7114-3654 CONNECTION

FIXTURES X 11/08/88

RECEIPT
 0004
 PLED 16.00
 CHEK 16.00
 7623A000 11:46

SIGNED Miguel Gonzalez CONTRACTOR MASTER CARD NO. _____

2310-2403 PERMIT FEE 16

B. N. Kl Registered Master Plumber, Spec. Contr. or Owner DATE 11-8-88

TOTAL FEES 16

BUILDING DEPT. _____ DATE _____ PERMIT NO. _____

MUST BE MACHINE VALIDATED

PERMIT EXPIRES 180 DAYS AFTER ABANDONMENT OF WORK

Debbie Johnson 11-30-88

ELEC. ONLY PLBG. ONLY, A.C. ONLY

| | | | | | |
|-----------------------|-------|--------------------------|------------------|------|----------|
| OWNER | | Miguel Gonzalez | | DATE | 11/30/88 |
| ADDRESS | | 2407 Nevada | | | |
| CONTRACTOR | | PERMIT NO. | FINAL INSPECTION | | |
| LOT | BLOCK | SUBDIVISION | | | |
| LOG NO. | | AREA | | | |
| | | Las | | | |
| ELECTRIC ONLY | | | PLUMBING ONLY | | |
| Contractor | | Contractor | | | |
| Permit No. | | Permit No. <i>Burnes</i> | | | |
| Rough Elec. | | Rough Soil | | | |
| Final Rough | | Rough Water | | | |
| Final Elec. | | Top Out | | | |
| Temp. Service | | Rough Gas | | | |
| HEAT & VENT. A/C ONLY | | Final Plbg. | | | |
| Contractor | | Final Gas | | | |
| Permit No. | | Sewer Final | | | |
| A/C Rough Duct | | | | | |
| Rough Gas | | | | | |
| Final A/C | | | | | |
| Final Gas | | | | | |

79-3-15 (R11-81) DEPT. OF BLDG. & SAFETY
CITY OF LAS VEGAS