

229 Page St.

— L-38 Blk. 2 Sub. Char. #1 Z-R1 —

H. Hatered January 23, 1980

CITY OF LAS VEGAS, NEVADA
DEPARTMENT OF BUILDING & SAFETY

RECEIPT
FOR
SEWER CONNECTION FEE

JOB ADDRESS: 229 Page OWNER'S NAME: Cal-American Communities of Nevada, Inc.
LOT 38 BLOCK 2 SUBDIVISION Charleston Gardens Unit No. 1

QUANTITY	OCCUPANCY	UNIT FEE	AMOUNT
1	SFD		\$150.00

PAID BY: Cal-American Communities of Nevada, Inc.
Alvin R. [Signature]

TOTAL \$150.00
Less Credit*
TOTAL FEE \$ 150.00

*Credit for existing sewer is applied to the new sewer connection fee based on previous type of occupancy and only when the new occupancy requires an additional fee.
This receipt does not authorize the owner or his representative to start any work without obtaining a plumbing permit.

WRJ 9/3/72
DEPARTMENT OF BUILDING & SAFETY DATE
RECEIPT NO. 12119 SEWER FEE \$ 150

RECEIPT
5217 \$150.00 - 3
CITY OF LAS VEGAS
DEPT. OF BUILDING & SAFETY
MUST BE RETURNED

Y. Material January 23, 1973

CITY OF LAS VEGAS, NEVADA

LOG NO. & AREA T29-2
DEPARTMENT OF BUILDING & SAFETY

CONST. VAL. \$ 19072-

APPLICATION & BUILDING PERMIT — for:
Dwellings, Duplexes, Misc. Residential Const.

ADDRESS OF CONSTRUCTION: 229 Page

OWNER: Cal-American Communities of Nevada, Inc.

LOT(s) 38 BLOCK 2 SUBDIVISION Charleston Gardens Unit No. 1 ZONE: R-1

Existing structure on lot: Dwelling Accessory bldgs. Vacant lot Other

PROPOSED CONSTRUCTION: Single Family Dwelling USE: Residence

MATERIALS OF CONSTRUCTION: Wood Frame Concrete Block Reinforced Concrete Steel Frame

SQ. FEET OF FLOOR AREAS: 1st 1316 2nd 1316 3rd 1753 Other 480 TOTAL SQ. FT. 4885

FIRE ZONE 1 2 3 Occupancy Group 1 2 CONST. TYPE I II III IV V

ARCHITECT: Red C. Grant ENGINEER: VIN-Nevada NO. of UNITS 1 NO. of STORIES 1

Plans Submitted: Yes No Calculations Submitted: Yes No Sewer Fee Req'd. Yes No

CONTRACTOR: Same as Owner STATE LICENSE # 11660 CITY LICENSE # C11-077-2-00546

ADD'L. PERMITS REQ'D: Air Cond. Incinerators Elec. Fire Sprinkling System Plumbing Signs Paving Fence Public Walks Curb-gutters

SEE PLOT PLAN

Model 1316

4-Bedrooms

Width Ft.

Front sidewalk

CONDITIONS OF THE PERMIT:

- I agree to call the City Building Department for inspections before concrete is poured, before rough wiring, electrical, plumbing, framing is covered. Also for air conditioning, sheet-rock and sheathing inspection.
- I agree that when the job is completed that I will call for final inspection before occupancy.
- I agree to perform all construction in accordance with City Ordinances and Building Codes.
- The Contractor's signature below depotes authority from the owner to sign in his behalf and that the owner is aware of all requirements of this application and permit. Separate permits must be taken out for work outlined above this agreement.
- I have read and understand the contents of this application and permit; I hereby state that the information I have supplied on this application is true and correct.

Approval for the work under this permit will be given only after refuse and debris have been removed from job site and public right of way.

SIGNED Cal-American Communities of Nevada, Inc Contractor

BY: Steve R. DeJardin Agent or Owner

CLARK COUNTY HEALTH DEPT. Date 9-12-73

LAS VEGAS FIRE DEPARTMENT Date 9-13-73

PLANNING DEPT.: JMA Date: 9-12-73

PUBLIC WORKS DEPT.: WRF Date: 9-13-73

BUILDING DEPT.: WRF Date: 9-13-73

12850 PERMIT NO.: 14259 PERMIT FEE \$ 82-

RECEIPT

5205 \$082.00 - 8

CITY OF LAS VEGAS
DEPT. OF BUILDING & SAFETY

MUST BE MACHINE VALIDATED

12 DEC 73

M. Hatawood January 23, 1983

CITY OF LAS VEGAS, NEVADA

DEPARTMENT OF BUILDING & SAFETY - APPLICATION AND PERMIT FOR PLUMBING

ADDRESS OF CONSTRUCTION: 229 Page St.

OWNER'S NAME: Cal American Communities

CIRCLE New Bldg. Add'n.; Remodel; TYPE OF BLDG. SFD, APT., PUBLIC COMM.

CONTRACTOR'S NAME: Mojave Pllg. Inc.

STATE LICENSE # 10317 CITY LICENSE # 12057

UNITS	DESCRIPTION	FEE	TOTAL
1	Bathtub	1.00	100
1	Shower	1.00	100
2	Lavatory	1.00	200
2	Toilet	1.00	200
	Urinal	1.00	
	Floor Drain	1.00	
	Floor Sink	1.00	
	Wash. Tray	1.00	
	Sink	1.00	100
1	Garbage Disposal	1.00	100
	Garbage Disposal (comm.)	3.00	
	Clothes Dryer (gas)	1.00	
1	Clothes Washer	1.00	100
	Clothes Washer (comm.)	5.00	
	Dishwasher	1.00	
	Dishwasher (commercial)	5.00	
	Dental Unit	10.00	
	Drinking Fountain	1.00	
	Any Water using Equipment	1.00	
1	Water Heater (gas) (elect.)	1.00	100
1	Sewer System - New, Replacement, or any Drainage System	4.00	400
	Grease or Sand Trap	2.00	
	Trailer Trap	2.00	
	Septic Disposal System	4.00	
WATER SOFTENERS			
	Nonpermanent Type	4.00	
	Permanent Type (connected to Drainage)	5.00	
SWIMMING POOLS			
	Private or Wading Pool	10.00	
	Public or Semi-public	20.00	

UNITS	DESCRIPTION	FEE	TOTAL
WATER DISTRIBUTION SYSTEM			
1	Single Family Dwelling	4.00	400
	Multiple Family Dwelling plus each unit	4.00	
	Bldg. Group "A" thru "G" per each floor	2.00	
	Hotel or Motel plus each bath	6.00	
	Trailer Park plus each space	4.00	
	Irrigation	1.00	
GAS PIPING SYSTEM			
1	Single Family Dwelling	3.00	300
	Multiple Family Dwelling plus each unit	6.00	
	Commercial Bldg. per floor plus each unit	1.00	
2	Gas Appliance (any type)	3.00	200
AUTOMATIC FIRE EXTINGUISHING SYSTEM			
	Underground Piping	10.00	
	Distribution Piping ea. ft.	.01	
	Sprinkler Head each	.10	
	In Range Hood and Vent	5.00	
DRY STANDPIPE SYSTEM			
	Piping	50.00	
	Each Outlet	1.00	
WET STANDPIPE SYSTEM			
	Piping	5.00	
	Fire Hose Cabinet	1.00	
	MINIMUM PERMIT FEE	4.00	
PIPELINE CONTRACTOR, SEC. 14 B.P.C. \$			
TOTAL PERMIT FEE \$ 23.00			

I hereby certify that I have carefully examined and read the above application, that the same is true and correct, and that the work herein described is to be done in accordance with all the provisions of the applicable Ordinances of the City of Las Vegas, Nevada and the State Laws, whether herein specified or not.

Approval for the work under this permit will be given only after refuse and debris have been removed from job site and public right of way.

Signed Thomas J. Wallin Registered Master Plumber, Spec. Contr. or Owner Date: _____

Building Department J. Miller Date: _____

Permit No. 5257 Permit Fee \$ 23.00

#12870

RECEIPT

5362 \$023.00 - 7

CITY OF LAS VEGAS
DEPT. OF BUILDING & SAFETY

MUST BE MACHINE VALIDATED

18 DEC 73

Historical January 23, 1980

CITY OF LAS VEGAS, NEVADA

DEPARTMENT OF BUILDING & SAFETY - AIR CONDITIONING APPLICATION & PERMIT

ADDRESS OF CONSTRUCTION: 229 Page Street
Charleston Gardens # -1 OWNER'S NAME: Cal American Communities

Lot 38 Block 2

CIRCLE: Addition; Remodel; New Bldg TYPE OF BLDG.: SFD APT. COMM. PUBLIC

CONTRACTOR'S NAME: Lewis Brothers Inc. STATE LICENSE # 11997 CITY LICENSE # 7232

UNITS	DESCRIPTION	FEE	TOTAL	UNITS	DESCRIPTION	FEE	TOTAL
	Unit heater - floor, wall, or suspended	4.00			EVAPORATIVE COOLERS:		
FOR EACH FORCED-AIR OR GRAVITY-TYPE FURNACE OR BURNER INCLUDING DUCTS AND VENTS ATTACHED TO SUCH APPLIANCES:					5 outlets or under	3.00	
	Up to and including 100,000 B.t.u.'s	4.00		Over 5 and up to and including 10	5.00		
	Over 100,000 B.t.u.'s	6.00		Each additional outlet over 10	.25		
FOR EACH HEATING APPLICATION, REFRIGERATION UNIT, COMFORT COOLING AND HEATING UNIT, ABSORPTION UNIT, COMPRESSOR OR BOILER:					VENTILATION:		
	Up to and including 3 ton or horsepower, or absorption system up to and including 100,000 B.t.u.'s	4.00		For each fan connected to a single duct	1.00		
	Over 3 ton or 3 horsepower up to and including 10, or absorption system over 100,000 B.t.u.'s up to and including 250,000 B.t.u.'s	7.00	7.00	For each commercial or industrial ventilation system	5.00		
	Over 10 ton or 10 horsepower up to and including 30, or absorption system over 250,000 B.t.u.'s up to and including 1,000,000 B.t.u.'s	12.00		For each commercial kitchen hood	5.00		
	Over 30 ton or 30 horsepower up to and including 50, or absorption system over 1,000,000 B.t.u.'s up to and including 1,700,000 B.t.u.'s	20.00		MISCELLANEOUS:			
	Over 50 ton or 50 horsepower, or absorption system over 1,700,000 B.t.u.'s	30.00		For each water cooling tower	8.00		
FOR EACH AIR HANDLING UNIT INCLUDING DUCTS ATTACHED THERETO:					Duct work only - each opening	.25	
	Up to and including 10,000 CFM	2.00		For installation or relocation of each commercial or industrial incinerator	15.00		
	Over 10,000 CFM	4.00		Gas piping related to the air cond. work in single family dwelling only	3.00		
				For each appliance, piece of equipment, any mechanical work or alteration or replacement not included in this schedule, the permit fee shall be computed the same as building permit fees by using the cost of installation for the valuation amount.			
FOR THE ISSUANCE OF EACH PERMIT						3.00	
TOTAL PERMIT FEE \$						10.00	

I hereby certify that I have carefully examined and read the above application; that the same is true and correct; and that the work herein described is to be done in accordance with all the provisions of the applicable Ordinances of the City of Las Vegas, Nevada and the State Laws, whether herein specified or not.

Approval for the work under this permit will be given only after refuse and debris have been removed from job site and public right of way.

SIGNED C. D. Lewis Date 1-18-74
 Air Conditioning Contractor - Owner

BUILDING DEPARTMENT R. Miller Date _____
 PERMIT NO. 4913 PERMIT FEE \$ 10.00

#12890

RECEIPT
 6264 \$010.00 - 4
 CITY OF LAS VEGAS
 DEPT. OF BUILDING & SAFETY
 MUST BE MACHINE VALIDATED
 21 JAN 74

Y. Motwood January 23, 1980

Charleston Gardens
Lt. 38, B 2

CITY OF LAS VEGAS, NEVADA

DEPARTMENT OF BUILDING & SAFETY - ELECTRICAL APPLICATION & PERMIT

ADDRESS OF CONSTRUCTION: 229 Page Street OWNER'S NAME: Cal-American Communities

CIRCLE: New Bldg.; Add'n.; Remodel; TYPE OF BLDG.: SFD, APT. PUBLIC COMM.

CONTRACTOR'S NAME: Urban Electric Corporation STATE LICENSE # 8016A CITY LICENSE # 9013

NUMBER	FIXTURE OR INSTALLATION	UNIT PRICE	TOTAL
	Rm addition, carport or garage enclosure	4.00	
	Temporary power	4.00	
52	Light, receptacle or switch outlet	.20	10.40
	Wall or ceiling space heater	.35	
1	Garbage grinder outlet	.35	.35
1	Dishwasher outlet	.35	.35
	Clothes dryer outlet	.35	
1	Automatic clothes washer	.35	.35
	Electric range outlet	.35	
	Electric water heater outlet	.35	
1	Special purpose outlet	.35	.35
	X-ray unit and its appurtenances	5.00	
	Watts of festoon lighting (Watts) First 3,000 watts for each additional thousand watts	4.00 1.50	
	Horsepower each motor first horsepower or less for each additional horsepower	1.75 .35	
1	Electric service (including any single meter socket) for each additional socket	3.00 .35	3.00
	Air conditioning service	1.50	
	Each KW(KVA) Generator (Transformer, Welder) First 100 KVA for each additional KW(KVA)	2.00 .01	
	Speaker, signal or alarm outlet	.15	
	Amplifiers	.50	
	Control panels	.25	
	Main control racks	1.00	
	T.V. and radio antennas-master system only	.75	
	Minimum fee for any permit	4.00	
	TOTAL FEE		14.80

Approval for the work under this permit will be given only after refuse and debris have been removed from job site and public right of way.

I hereby certify that I have carefully examined and read the above-application; that the same is true and correct; and that the work herein described is to be done in accordance with all the provisions of the applicable Ordinances of the City of Las Vegas, Nevada and State laws whether herein specified or not.

SIGNED [Signature] DATE 1-28-74
MASTER (ELECTRICIAN) (TECHNICIAN) (OWNER)

BUILDING DEPARTMENT [Signature] DATE _____

#12860 PERMIT NO. 8506 PERMIT FEE: \$ 14.80

RECEIPT
6660 \$014.80 - 6
CITY OF LAS VEGAS
DEPT. OF BUILDING & SAFETY
MUST BE MACHINE VALIDATED
30 JAN 74

Y. Gatewood January 23, 1980

10-02

CITY OF LAS VEGAS, NEVADA

LOG NO. & AREA _____
DEPARTMENT OF BUILDING & SAFETY

CONST. VAL. \$ 855.00

APPLICATION & BUILDING PERMIT — for:
Fence, Wall, Retaining Wall.

ADDRESS OF CONSTRUCTION: 229 PAGE ST.

OWNER: DAVID H JONES

LOT(s) 38 BLOCK 2 SUBDIVISION CHARLSTON GARDENS #1

ZONE R1

Materials of Construction: Block Concrete Wire Wood Other

Yes No
PLANS:
CALCS:

ARCHITECT: _____ ENGINEER: _____

CONTRACTOR: owner

STATE LICENSE # _____

CITY LICENSE # _____

TOTAL SQUARE FEET: 570

TOTAL LINEAL FEET: 95'

Remarks:

CONDITIONS OF THE PERMIT:

1. Any type of retaining wall must be engineered by a Civil or Structural Engineer.
2. If a home owner takes out the Building Permit and if the owner sublets the work to a Contractor, then the Contractor must take out the permit and pay for it.
3. No fence or wall can be built on City property or rights-of-way, but this is not intended to preclude construction within utility easements if utilities will not be damaged or made inaccessible.
4. The fence or wall shall not enclose any water meter, light standard, or fire alarm box and shall not come closer than 24" from the nearest fire hydrant outlet.
5. Department inspectors must approve footings before concrete is poured and block wall reinforcing before grouting is done.
6. Maximum height of any wall or fence is 6', side and rear yards; 4' maximum in front yard with the vertical surface above the height of 2' 50% open.
7. I must not obstruct required onsite parking space (2 spaces for each dwelling unit) by the erection of this fence or wall.
8. By the signing of this application I herewith agree to the requirements outlined above.

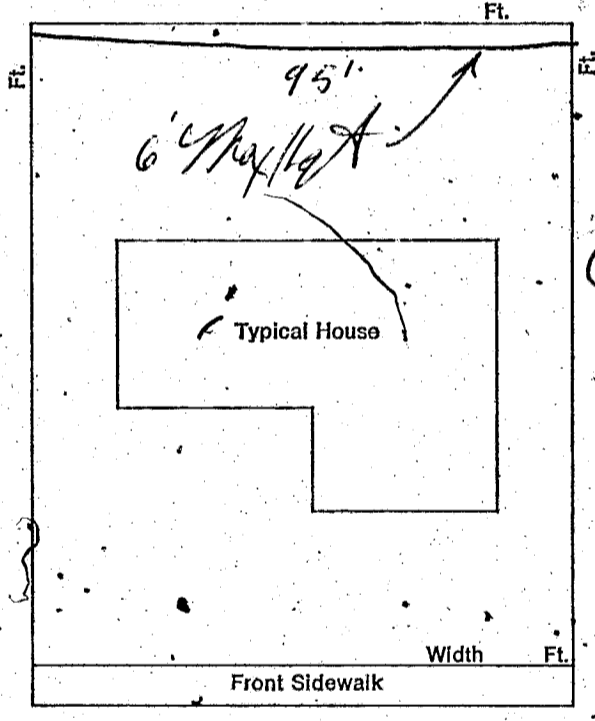

SIGNED: Robert H. Ellis DATE: 2 FEB 76
 CONTRACTOR AGENT OWNER

PLANNING DEPT: MA Date: 2-2-76
 PUBLIC WORKS DEPT: Kelt K... Date: 2-2-76
 BUILDING DEPT: W W Miller Date: 2-2-76
 #12850 PERMIT NO: 428 PERMIT FEE \$ 11.00

RECEIPT
 6351 - \$011.00 - 8
 CITY OF LAS VEGAS
 DEPT. OF BUILDING & SAFETY
 MUST BE MACHINE VALIDATED
 - 2 FEB 76

W. Gatewood January 23, 1981

24-11

CITY OF LAS VEGAS, NEVADA

LOG NO. & AREA _____ CONST. VAL. \$ 2655⁰⁰

DEPARTMENT OF BUILDING & SAFETY

APPLICATION & BUILDING PERMIT — for:
Fence, Wall, Retaining Wall.

ADDRESS OF CONSTRUCTION: 229 Page Street OWNER: David H. Jones

LOT(s) 38 BLOCK 2 SUBDIVISION Charleston Gardens #1 ZONE R-1

Materials of Construction: Block Concrete Wire Wood Other Yes No

ARCHITECT: _____ ENGINEER: _____ PLANS:

CONTRACTOR: _____ STATE LICENSE # _____ CITY LICENSE # _____ CALCS:

TOTAL SQUARE FEET: 1770 TOTAL LINEAL FEET: 295

Remarks:

CONDITIONS OF THE PERMIT:

1. Any type of retaining wall must be engineered by a Civil or Structural Engineer.
2. If a home owner takes out the Building Permit and if the owner sublets the work to a Contractor, then the Contractor must take out the permit and pay for it.
3. No fence or wall can be built on City property or rights-of-way, but this is not intended to preclude construction within utility easements if utilities will not be damaged or made inaccessible.
4. The fence or wall shall not enclose any water meter, light standard, or fire alarm box and shall not come closer than 24" from the nearest fire hydrant outlet.
5. Department Inspectors must approve footings before concrete is poured and block wall reinforcing before grouting is done.
6. Maximum height of any wall or fence is 6', side and rear yards; 4' maximum in front yard with the vertical surface above the height of 2' — 50% open.
7. I must not obstruct required onsite parking space (2 spaces for each dwelling unit) by the erection of this fence or wall.
8. By the signing of this application I herewith agree to the requirements outlined above.

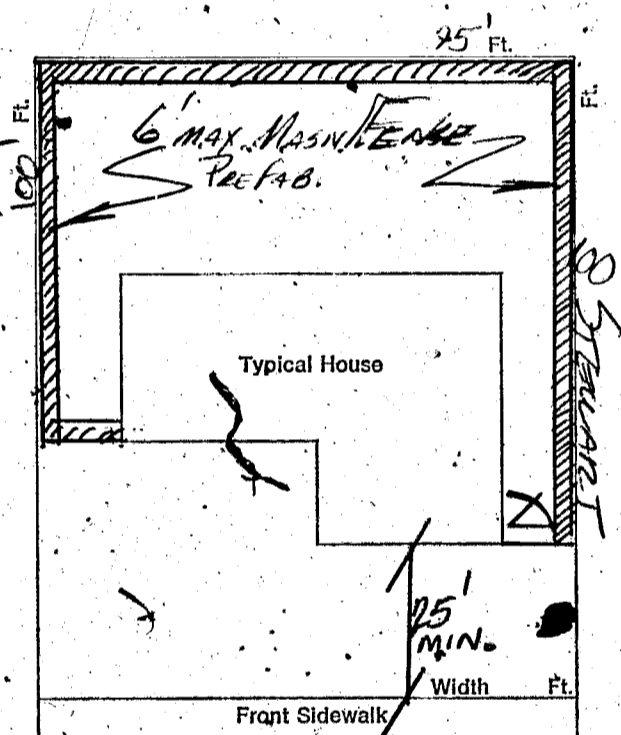

PAID

SIGNED: Julie D Jones DATE: 2/25/76
CONTRACTOR AGENT OWNER

PLANNING DEPT: [Signature] Date: 2/25/76

4 PUBLIC WORKS DEPT: [Signature] Date: 2/25/76

BUILDING DEPT: [Signature] Date: 2-25-76

#12850 PERMIT NO: 508 PERMIT FEE \$ 18⁰⁰

RECEIPT

7510 \$018.00 - 8

CITY OF LAS VEGAS
DEPT. OF
BUILDING & SAFETY
MUST BE MACHINE VALIDATED

26 FEB 76

Harmon Denise Bryant 6-23-82

CITY OF LAS VEGAS, NEVADA

LOG NO. & AREA _____

CONST. VAL. \$ 432.00

DEPARTMENT OF BUILDING AND SAFETY

APPLICATION & BUILDING PERMIT - for:
Fence, Wall, Retaining Wall.

ADDRESS OF CONSTRUCTION: 229 Page

OWNER: Tran Phu Cam

LOT(s) 38 BLOCK 2 SUBDIVISION Charleston Cooper unit #1 ZONE: R1

Material of Construction: Block Concrete Wire Wood Other Yes No

ARCHITECT: _____ ENGINEER: _____ PLANS:

CONTRACTOR: Owner STATE LICENSE # _____ CITY LICENSE # _____ CALCS:

TOTAL SQUARE FEET: _____ TOTAL LINEAL FEET: 108'

Remarks:

CONDITIONS OF THE PERMIT:

1. Any type of retaining wall must be engineered by a Civil or Structural Engineer.
2. If a home owner takes out the Building Permit and if the owner sublets the work to a Contractor, then the Contractor must take out the permit and pay for it.
3. No fence or wall can be built on City property or rights-of-way, but this is not intended to preclude construction within utility easements if utilities will not be damaged or made inaccessible.
4. The fence or wall shall not enclose any water meter, light standard, or fire alarm box and shall not come closer than 24" from the nearest fire hydrant outlet.
5. Department inspectors must approve footings before concrete is poured and block wall reinforcing before grouting is done.
6. Maximum height of any wall or fence is 6', side and rear yards; 4' maximum in front yard with the vertical surface above the height of 2' - 50% open.
7. I must not obstruct required onsite parking space (2 spaces for each dwelling unit) by the erection of this fence or wall.
8. By the signing of this application I herewith agree to the requirements outlined above.

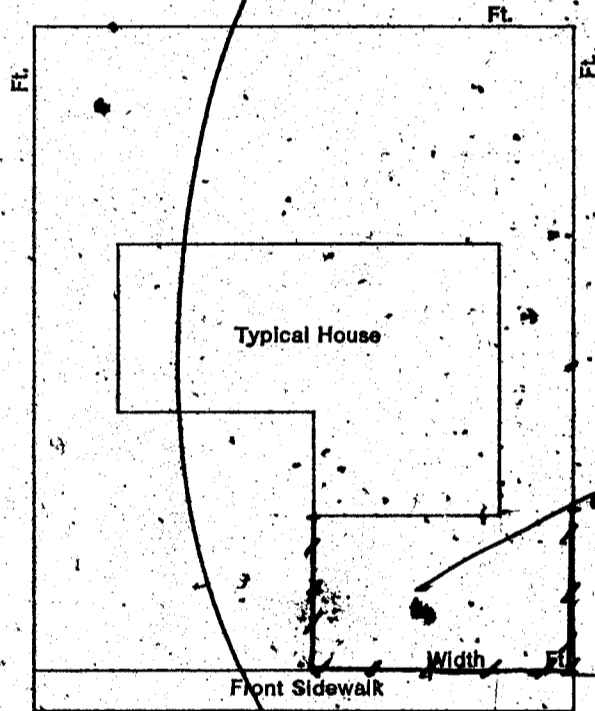

1 TONI \$.00
WALL \$ 10.00

SIGNED: [Signature] (ST) DATE: 10.00

CONTRACTOR AGENT OWNER TOTAL \$ 10.00
CASH \$ 10.00

PLANNING DEPT: [Signature] Date: 5/3/82

PUBLIC WORKS DEPT: [Signature] Date: 5/3/82

BUILDING DIVISION: [Signature] Date: 5/3/82

PERMIT NO: 0238 PERMIT FEE: 10.00

AW 0238 58X001 '01

CITY - LAS VEGAS
BLDG. & SAFETY

05/03/82

MUST BE MACHINE VALIDATED

Doney 11-9-82

FENCE & RETAINING WALLS		
OWNER	Tran Phu-Cam	
DATE	5/3/82	
ADDRESS 229 Page		
CONTRACTOR	PERMIT NO.	FINAL INSPECTION
Owner	0238	Wire fence
LOT	BLOCK	SUBDIVISION
38	2 Char Garden Unit #1	
LOG #	AREA	
FENCES (wire, wood, block, & retaining walls)		
1	Location	
2	Footing	
3	Wall Steel	
	1st	2nd
4	Bond Beam	
	1st	2nd
	Final	
	Specify Type Of Fence	

22-1-33 DIV OF BLDG & SAFETY CITY OF LAS VEGAS REV 10-78 E-Z-WAY SYSTEMS NEWARK OH 43055 LITHO IN U.S.A

DEPARTMENT OF BUILDING & SAFETY
CITY OF LAS VEGAS, NEVADA

KARDEX CARD
FENCE & RETAINING
WALLS

OWNER David H. Jones ADDRESS 229 Page St. DATE 2-2-76
 CONTRACTOR Owner PERMIT NO. 428
 LOT 38 BLOCK 2 SUBDIVISION Charleston Gardens # 1 concrete fence

<input checked="" type="checkbox"/> Fence (wire, wood, etc.)	<input type="checkbox"/> Walls (masonry, rock, etc.)
Location _____	Location _____
Final Inspection _____	Footing _____
	Wall Steel 1st _____ 2d _____ 3d _____
	Final Inspection _____
<input type="checkbox"/> Retaining Wall (masonry)	<input type="checkbox"/> Retaining Wall (concrete)
Location _____	Location _____
Footing _____	Footing _____
Wall Steel 1st _____ 2d _____ 3d _____	Wall Steel 1st _____ 2d _____ 3d _____
Bond Beam 1st _____ 2d _____ 3d _____	Final Inspection _____
Final Inspection _____	

23.14 B ADDRESS 229 Page St. LOG NO. _____ AREA _____

Done Tuesday 11-9-82

DEPT. of BLDG. & SAFETY - CITY of LAS VEGAS, NEVADA

OWNER Cal American ADDRESS 229 Page DATE 12-12-73
GEN. CONT. Same TYPE OF STRUCTURE SFD
PERMIT NO. 14259 LEGAL DESCRIPTION L 38 B 2 Charleston Gardens Unit # 1

BUILDING	MECHANICAL	ELECTRICAL
Investigation	Plumbing Cont. <u>Meyoul Bing</u>	Temp. pole cont.
Location & Footing <u>BW1-11-74</u>	Permit No. <u>8257</u> Date	Permit No. Date
Stem Wall	Heat & Vent. A/C Cont. <u>James Brown</u>	Inspection
Concrete Slab Floor <u>BW1-11-74</u>	Permit No. <u>4973</u> Date <u>12-21-74</u>	Electrical Cont. <u>Urban</u>
Floor Framing	Sawer Cont. <u>Cal American</u>	Permit No. <u>8506</u> Date <u>1-30-74</u>
Fireplace Footing	Permit No. <u>12119</u> Date	Fixtures Cont.
Chimney Steel	Rough Soil <u>RW2-8-74</u>	Permit No. Date
Vert. Steel Reinf.	Rough Water	Slab
Horiz. Steel Reinf.	Top-Out <u>RW2-8-74</u>	Rough <u>VP2-5-74</u>
Roof Sheathing <u>BW1-24-74</u>	Rough Gas <u>RW2-8-74</u>	Final Rough
Framing <u>BW2-8-74</u>	A/C Rough Duct <u>RW2-8-74</u>	Final Fixture
Backing for siding	Ref. Rough Piping	Final Electrical <u>VP4-2-75</u>
Ext. Lath <u>BW2-8-74</u>	Final Plumbing <u>BW4-3-74</u>	Temporary Service
Ext. Scratch	Final Gas <u>BW5-22-74</u>	MISCELLANEOUS
Ext. Brown <u>BW2-26-74</u>	Final Air Cond. <u>BW4-3-74</u>	Grading & Drainage
Int. Lath	Final Refrig.	On-Site Parking Spaces App.
Int. Brown <u>BW3-6-74</u>	Final Sewer	Eng. Approval of
Drywall <u>BW2-15-74</u>	Final Septic Tank	Off-Site Improvements
Permit No.		
Final Building		
Appr. for Occu.		

INSPECTOR:

DATE

APPROVED FOR OCCUPANCY & METER

HB 4-2-75

PLEASE NOTE REMARKS ON REVERSE SIDE

229 Page

LOG #

AREA #

T29-2

DEPARTMENT OF BUILDING & SAFETY
CITY OF LAS VEGAS, NEVADA

OWNER David Jones ADDRESS 229 Page St. DATE 2-25-76

KARDEX CARD
FENCE & RETAINING
WALLS

CONTRACTOR Owner PERMIT NO. 808

LOT BLOCK SUBDIVISION concrete fence

Fence (wire, wood, etc.)	Walls (masonry, rock, etc.)
Location	Location
Final Inspection	Footing
	Wall Steel 1st 2d 3d
	Final Inspection
Retaining Wall (masonry)	Retaining Wall (concrete)
Location	Location
Footing	Footing
Wall Steel 1st 2d 3d	Wall Steel 1st 2d 3d
Bond Beam 1st 2d 3d	Final Inspection <u>WES-2676</u>
Final Inspection	

23.14 B

ADDRESS 229 Page St.

LOG NO.

AREA

Done Today 11-9-82

DEPT. of BLDG. & SAFETY - CITY of LAS VEGAS, NEVADA

OWNER Cal American ADDRESS 229 Page DATE 12-12-79
 GEN. CONT. Same TYPE OF STRUCTURE SFD
 PERMIT NO. 14259 LEGAL DESCRIPTION L 38 B 2 Charleston Gardens Unit # 1

BUILDING	MECHANICAL	ELECTRICAL
Investigation	Plumbing Cont. <u>Maxwell Biny</u>	Temp. pole cont.
Location & Footing <u>BW1-11-74</u>	Permit No. <u>8257</u> Date	Permit No. _____ Date
Stem Wall	Heat & Vent. A/C Cont. <u>James Brown</u>	Inspection
Concrete Slab Floor <u>BW1-11-74</u>	Permit No. <u>4913</u> Date <u>12-21-74</u>	Electrical Cont. <u>Urban</u>
Floor Framing	Sewer Cont. <u>Cal American</u>	Permit No. <u>8506</u> Date <u>1-30-74</u>
Fireplace Footing	Permit No. <u>12119</u> Date	Fixtures Cont.
Chimney Steel	Rough Soil <u>RW2-8-74</u>	Permit No. _____ Date
Vert. Steel Reinf.	Rough Water	Slab
Horiz. Steel Reinf.	Top Out <u>NW2-8-74</u>	Rough <u>VP2-8-74</u>
Roof Sheathing <u>BW1-29-74</u>	Rough Gas <u>RW2-8-74</u>	Final Rough
Framing <u>BW2-8-74</u>	A/C Rough Duct <u>RW2-8-74</u>	Final Fixture
Backing for siding	Ref. Rough Piping	Final Electrical <u>VP4-2-75</u>
Ext. Lath <u>BW2-8-74</u>	Final Plumbing <u>JW4-3-74</u>	Temporary Service
Ext. Scratch	Final Gas <u>JW5-22-74</u>	MISCELLANEOUS
Ext. Brown <u>BW2-26-74</u>	Final Air Cond. <u>JW4-3-74</u>	Grading & Drainage
Int. Lath	Final Refrig.	On-Site Parking Spaces
Int. Brown <u>BW3-6-74</u>	Final Sewer	Eng. Approval of
Drywall <u>BW2-15-74</u>	Final Septic Tank	Off-Site Improvements
Permit No.		
Final Building		
Appr. for Occu.		

INSPECTOR:

DATE

APPROVED FOR OCCUPANCY & METER

HB4-2-75

PLEASE NOTE REMARKS ON REVERSE SIDE

229 Page

LOG #

AREA #

T29-2

DEPARTMENT OF BUILDING & SAFETY
CITY OF LAS VEGAS, NEVADA

OWNER David Jones ADDRESS 229 Page St. KARDEX CARD
FENCE & RETAINING WALLS DATE 2-25-76

CONTRACTOR Owner PERMIT NO. 808

LOT _____ BLOCK _____ SUBDIVISION concrete fence

Fence (wire, wood, etc.)	Walls (masonry, rock, etc.)
Location _____	Location _____
Final Inspection _____	Footings _____
	Wall Steel 1st _____ 2d _____ 3d _____
	Final Inspection _____
Retaining Wall (masonry)	Retaining Wall (concrete)
Location _____	Location _____
Footings _____	Footings _____
Wall Steel 1st _____ 2d _____ 3d _____	Wall Steel 1st _____ 2d _____ 3d _____
Bond Beam 1st _____ 2d _____ 3d _____	Final Inspection <u>WEST-26-76</u>
Final Inspection _____	

23.14 B

ADDRESS 229 Page St.

LOG NO.

AREA