

6716 Oveja Cir.

L-12 Blk. 3 Sub. Char Rainbow #5-B Z-R1

Dated January 15, 1968

1968

CITY OF LAS VEGAS, NEVADA

LOG-NO. & AREA T-174

CONST. VAL. \$ 16,275.00

DEPARTMENT OF BUILDING & SAFETY

APPLICATION & BUILDING PERMIT — for: Dwellings, Duplexes, Misc. Residential Const.

ADDRESS OF CONSTRUCTION: 6716 Oveja Circle

OWNER: Sproul Homes, Inc.

LOT(s) 12 BLOCK 3 SUBDIVISION Charleston Rainbow # 5-B ZONE: R-1

Existing structure on lot: Dwelling  Accessory bldgs.  Vacant lot  Other

PROPOSED CONSTRUCTION: Single Family Dwelling USE: same

MATERIALS OF CONSTRUCTION: Wood Frame  Concrete Block  Reinforced Concrete  Steel Frame

SQUARE FEET OF FLOOR AREAS: 1st 2nd 3rd Other TOTAL SQ. FT. 1477

FIRE ZONE: 1 2 3 Occupancy Group A B C D E F G H I 1-2-3-4-5 CONST. TYPE: I II III IV V

ARCHITECT: ENGINEER: NO. of UNITS NO. of STORIES

Plans Submitted: Yes  No  Calculations Submitted Yes  No  Sewer Fee Req'd. Yes  No

CONTRACTOR: Sproul Homes, Inc. STATE LICENSE # 6011B CITY LICENSE # 6427

ADD'L. PERMITS REQ'D: Air Cond.  Elec.  Plumbing  Signs  Paving  Fence  Public Walks  Curb-gutters  Incinerators  Fire Sprinkling System

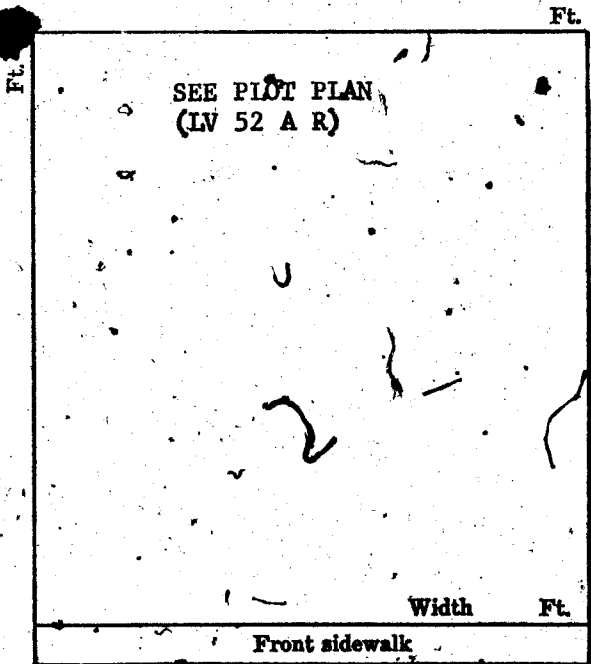

CONDITIONS OF THE PERMIT:

- 1. I agree to call the City Building Department for inspections before concrete is poured, before rough wiring, electrical, plumbing, framing is covered. Also for Air conditioning, sheet-rock and sheathing inspection.
2. I agree that when the job is completed that I will call for final inspection before occupancy.
3. I agree to perform all construction in accordance with City Ordinances and Building Codes.
4. The Contractor's signature below denotes authority from the owner to sign in his behalf and that the owner is aware of all requirements of this application and permit. Separate permits must be taken out for work outlined above this agreement.
5. I have read and understand the contents of this application and permit; I hereby state that the information I have supplied on this application is true and correct.

SIGNED: SPROUL HOMES, INC. Contractor

BY: [Signature] Agent or Owner

CLARK COUNTY HEALTH DEPT. Date

LAS VEGAS FIRE DEPARTMENT Date

PLANNING DEPT: [Signature] Date: 8-8-68

ENGINEERING DEPT: [Signature] Date: 8-8

BUILDING DEPT: [Signature] Date: 8-8-68

#1285 PERMIT NO: 43894 PERMIT FEE \$ 57.00

RECEIPT
3522 \$057.00 - 8
CITY OF LAS VEGAS
DEPT. OF BUILDING & SAFETY
MUST BE MACHINE VALIDATED
- 9 AUG 68



Watered January 18, 1968

CITY OF LAS VEGAS, NEVADA  
DEPARTMENT OF BUILDING & SAFETY

PERMIT FEE \$ 21.00  
APPLICATION & PERMIT FOR  
PLUMBING

JOB ADDRESS: 6716 OYEJA CIR OWNER'S NAME: SPROW HOMES, INC

LOT 12 BLOCK 3 SUBDIVISION C R Bldg. type: SFD VAPT COMM  
Circle: New bldg; Old bldg; Add'n; Remodel; Pool; Wtr. Sftner; Lawn Sprkr; Other

CONTRACTOR: UNITED PLUMBING State Lic. # 1295 City Lic. # 904

QUANTITY	FIXTURE OR INSTALLATION	Unit Price	AMOUNT
1	Bathtub	1.00	1.00
	Clothes dryer (gas)	1.00	
1	Clothes washer	1.00	1.00
1	Dental unit	1.00	
	Dishwasher	1.00	
	Drinking fountain	1.00	
	Fire sprinkling - underground piping	5.00	
	Fire sprinkling - distribution piping per each foot	.01	
	Fire sprinkling heads - per each head	.10	
	Floor drain \$1.00 Floor sink	1.00	
	Gas appliance (any type)	1.00	
1	Gas piping system - single family dwelling	3.00	3.00
	Gas piping system - multiple family \$3 per each unit plus	1.00	
	Gas piping system - commercial bldg. per each floor	3.00	
	Grease trap	1.00	
	Irrigation system	4.00	
3	Lavatory	1.00	3.00
	Minimum fee for any permit	4.00	
1	Piping, Drainage	4.00	4.00
1	Sewer replacement	4.00	
	Septic disposal system - Health Dept. approval required	4.00	
1	Shower	1.00	1.00
1	Sink - kitchen type	1.00	1.00
	Swimming pool - private - wading pool	8.00	
	Swimming pool - public - semi-public	12.00	
2	Toilet	1.00	2.00
	Urinal	1.00	
1	Water distribution system, single family dwelling	4.00	4.00
	Water distribution system, multiple dwg. \$4 + each unit	1.00	
	Water distribution system, Group "A" thru "G" per each floor	4.00	
	Water distribution system, Group "H" (Hotel) \$4 + per bath*	.50	
1	Water heater (gas) (electric)	1.00	1.00
	Water using equipment	1.00	
	Water softener nonpermanent type	4.00	
	Water softener permanent (connected to drainage)	5.00	
	Wash tray	1.00	

TOTAL FEE \$ 21.00

I hereby certify that I have carefully examined & read the above application; that the same is true & correct; and the work herein described is to be done in accordance with the provisions of City of Las Vegas Ordinances & State Laws, whether herein specified or not. \* As defined in City Code and Ordinances.

SIGNED: [Signature] Date: 7-1-68  
Registered Plumber Spec. Cont'r Owner

Engineering Dept. Date 8-9-68 Building Department Date  
Sewer Conn. Fees  
Paid in Engr. Dept. PERMIT NO. 24598 PERMIT FEE \$ 21.00  
#12870

RECEIPT  
3524 \$021.00 - 7  
CITY OF LAS VEGAS  
DEPT. OF BUILDING & SAFETY  
Must be machine validated  
- 9 AUG 68

**CITY OF LAS VEGAS, NEVADA**  
**DEPARTMENT OF BUILDING & SAFETY - AIR CONDITIONING APPLICATION & PERMIT**

ADDRESS OF CONSTRUCTION: LOT 17 BUC 3 - CIR 5-B  
6716 OVEJA CIR OWNER'S NAME: SPROUL

CIRCLE:  New bldg.  Old bldg.;  Add'n;  Remodel; TYPE OF BLDG.  SFD  APT.  COMM.

CONTRACTOR'S NAME: GRADING AC STATE LICENSE # 6058 CITY LICENSE # \_\_\_\_\_

UNITS	HEATERS	PRICE	FEE	UNITS	GAS	PRICE	FEE
	Unit Heaters (floor, suspended & wall)	\$2.00			Gas piping system 1 to 5 outlets	\$3.00	
	Floor Furnace	\$3.00			Gas piping system over 5 outlets (per outlet)	.20	
	Forced Air or Gravity Type under 100,000 BTU's	\$7.00			Swimming pool heater	\$4.00	
	Steam or hot water heating system, under 15 outlets (Boiler Excluded)	\$8.00		VENTS			
	Steam or hot water heating system 15 to 30 outlets (Boiler Excluded)	\$10.00			Combustion products vent other than a chimney	\$1.00	
	Each outlet over 30	.50			Residential kitchen or bathroom vent each	.25	50
	Radiant type heating system under 1000 sq. ft. to be heated	\$8.00			Commercial Hood	\$4.00	
	Radiant type heating system 1000 to 2000 sq. ft. to be heated	\$10.00			Ventilation system not a portion of any heating or air conditioning system up to \$1,000 valuation	\$5.00	
	Each additional 500 sq. ft. over 2000 sq. ft.	.50		BOILER			
AIR CONDITIONING					Boiler installation 15 H.P. and under	\$5.00	
	Heat pump or refrigerant 3 tons or less.	\$4.00			Boiler installation over 15 H.P.	\$10.00	
	Heat pump or refrigerant 3 tons to 10 tons	\$6.00	6.00	REPAIR			
	Each addn. ton over 10 ton	.50			Inspection of alteration or replacement of any mechanical cooling equipment which is a portion of any air conditioning system.	\$3.00	
	Refrigeration system 3 ton or less	\$5.00			DUCT WORK ONLY (each opening)	.25	
	Refrigeration system 3 to 10 ton	\$7.00			WATER TOWER	\$4.00	
	Each addn. ton over 10 ton	.50			MINIMUM PERMIT FEE	\$4.00	
	Evaporative cooler 5 outlets and under	\$3.00		TOTAL PERMIT FEE			
	Evaporative cooler 5 to 10 outlets	\$5.00					6.50
	Each addn. outlet over 10	.25					

I hereby certify that I have carefully examined and read the above application; that the same is true and correct; and that the work herein described is to be done in accordance with all the provisions of the applicable Ordinances of the City of Las Vegas, Nevada and the State laws, whether herein specified or not.

SIGNED [Signature] Date 7-24-68  
 AIR CONDITIONING CONTRACTOR / OWNER

BUILDING DEPARTMENT [Signature] Date 8-8-68  
 PERMIT NO. 244-70 PERMIT FEE \$ 6.50

**RECEIPT**  
 3525 \$006.50 - 4  
 CITY OF LAS VEGAS  
 DEPT. OF BUILDING & SAFETY  
 MUST BE MACHINE VALIDATED  
 - 9 AUG 68

#1289

M. Waterwood January 18, 1968

CITY OF LAS VEGAS, NEVADA

DEPARTMENT OF BUILDING & SAFETY - ELECTRICAL APPLICATION & PERMIT

ADDRESS OF CONSTRUCTION: 4716 Omega Circle OWNER'S NAME: Spirit Home

LOT(S) 12 BLOCK 3 SUBDIVISION Charlotte Park Type of bldg. SFD [ ] Apt. [ ] Comm. [ ]

Check Proper Construction: New Bldg. [ ] Addn. [ ] Remodel [ ] Temporary Pole [ ] Old Bldg. [ ]

CONTRACTOR'S NAME: Robert G. Wenzl STATE LICENSE #: 5144 CITY LICENSE #: 3392

Table with columns: NUMBER, FIXTURE OR INSTALLATION, UNIT PRICE. Rows include: Fixture or sockets (.15), Light, receptacle or switch outlet (.20), Wall or ceiling space heater (.35), Blast coil heater per kilowatt (.35), Garbage grinder outlet (.35), Dishwasher outlet (.35), Clothes dryer outlet (.35), Automatic clothes washer (.35), Electric range outlet (.35), Electric water heater outlet (.35), Mercury arc lamp and equipment (.35), Special purpose outlet (.35), X-ray unit and its appurtenances (5.00), Watts of festoon lighting (4.00), Horsepower - all motors (1.75), Temporary power and lights (4.00), Electric service (3.00), Air conditioning service (1.50), Each KW (KVA) Generator (2.00), Special inspection per hour (4.00), Speaker outlets (.15), Signal or Alarm outlets (.15), Amplifiers (.50), Control panels (.25), T. V. outlets - master system only (.15), Radio outlets (.15), Main control racks (1.00), T. V. and Radio antennas - master system only (.75), Minimum fee for any permit (4.00), Total fee (19.40).

I hereby certify that I have carefully examined and read the above application; that the same is true and correct; and that the work herein described is to be done in accordance with all the provisions of the applicable Ordinances of the City of Las Vegas, Nevada and State laws whether herein specified or not.

SIGNED: R. G. Wenzl (TECHNICIAN) (OWNER) Date: 8/21 BUILDING DEPARTMENT: G. Wenzl Date: 8-22-68 PERMIT NO. 26169 PERMIT FEE: \$ 19.40

RECEIPT 4045 - \$019.40 - 6 CITY OF LAS VEGAS DEPT. OF BUILDING & SAFETY MUST BE MACHINE VALIDATED 22 AUG 68

#1286

W. Waterwood January 13, 11

CITY OF LAS VEGAS, NEVADA

LOG NO. & AREA

CONST. VAL. \$

492.00

DEPARTMENT OF BUILDING & SAFETY

APPLICATION & BUILDING PERMIT - for:  
Fence, Wall, Retaining Wall.

ADDRESS OF CONSTRUCTION:

6716 Oveja Circle

OWNER:

Herbert L. Cummings

LOT(s)

17A

BLOCK

3

SUBDIVISION

Charleston Rainbow SB

ZONE:

R1

Materials of Construction:

Block

Concrete

Wire

Wood

Other

Yes

No

PLANS:

CALCS:

ARCHITECT:

ENGINEER:

CONTRACTOR:

owner

STATE LICENSE #

CITY LICENSE #

TOTAL SQUARE FEET:

TOTAL LINEAL FEET:

82

Remarks:

CONDITIONS OF THE PERMIT:

- Any type of retaining wall must be engineered by a Civil or Structural Engineer.
- If a home owner takes out the Building Permit and if the owner lets the work to a Contractor, then the Contractor must take out the permit and pay for it.
- No fence or wall can be built on City property or rights-of-way, but this is not intended to preclude construction within utility easements if utilities will not be damaged or made inaccessible.
- The fence or wall shall not enclose any water meter, light standard, or fire alarm box and shall not come closer than 24" from the nearest fire hydrant outlet.
- Department Inspectors must approve footings before concrete is poured and block wall reinforcing before grouting is done.
- Maximum height of any wall or fence is 6', side and rear yards; 4' maximum in front yard with the vertical surface above the height of 2' - 50% open.
- I must not obstruct required onsite parking space (1 space for each dwelling unit) by the erection of this fence or wall.
- By the signing of this application I herewith agree to the requirements outlined above.

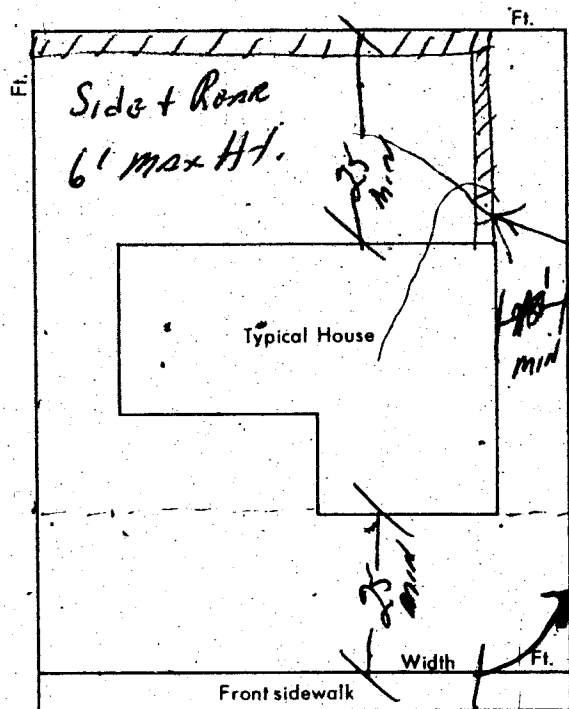

SIGNED:

Herbert L. Cummings

DATE:

CONTRACTOR  AGENT  OWNER

PLANNING DEPT.:

Diana K. May

Date:

6-7-72

PUBLIC WORKS DEPT.:

Date:

BUILDING DEPT.:

M. J. Miller

Date:

6-7-72

#12850

PERMIT NO.:

5149

PERMIT FEE \$

700

RECEIPT

8632 \$007.00 - 8

CITY OF LAS VEGAS  
DEPT. OF  
BUILDING & SAFETY

MUST BE MACHINE VALIDATED

- 7 JUN 72

Done Today 11-2-82

DEPARTMENT OF BUILDING & SAFETY  
CITY OF LAS VEGAS, NEVADA

KARDEX CARD  
FENCE & RETAINING  
WALLS

OWNER Herbert L. Cummings ADDRESS 6716 Oveja Cr. DATE 6-7-72

CONTRACTOR Owner PERMIT NO. 5149

LOT 12 BLOCK 3 SUBDIVISION Charleston Rainbow 5 B block fence

Fence (wire, wood, etc.)	Walls (masonry, rock, etc.)
Location _____	Location <u>296-5-72</u>
Final Inspection _____	Footing <u>296-5-72</u>
	Wall Steel 1st _____ 2d _____ 3d _____
	Final Inspection <u>296-13-72</u>
Retaining Wall (masonry)	Retaining Wall (concrete)
Location _____	Location _____
Footing _____	Footing _____
Wall Steel 1st _____ 2d _____ 3d _____	Wall Steel 1st _____ 2d _____ 3d _____
Bond Beam 1st _____ 2d _____ 3d _____	Final Inspection _____
Final Inspection _____	

23.14 B ADDRESS 6716 Oveja Cr. LOG NO. \_\_\_\_\_ AREA \_\_\_\_\_

Department of Building & Safety  
City of Las Vegas, Nevada

Special Kardex  
Elec. only, Plbg. only, A.C. only

Owner S. T. Nielson Address 6716 Oveja Circle Date: 10/28/68

Contractor Las Vegas Water Cond. Permit No. 25168

Lot \_\_\_\_\_ Block \_\_\_\_\_ Subdivision \_\_\_\_\_

Electric Only	Plumbing Only	Heat & Vent. A. C. Only
Contractor _____	Contractor _____	Contractor _____
Permit No. _____	Permit No. _____	Permit No. _____
Slab _____	Rough Soil _____	A.C. Rough Duct _____
Rough Elect _____	Rough Water _____	Ref. Ro. Piping _____
Final Rough _____	Top Out _____	Rough Gas _____
Final Fixture _____	Rough Gas _____	Final Refrig _____
Final Elec _____	Final Plbg. <u>11-1-68</u>	Final Air Cond _____
Temp. Service _____	Final Gas _____	Final Gas _____
	Final Sewer _____	
	Final Septic Tank _____	

23.06 D Address 6716 Oveja Circle Log No. Softener Area \_\_\_\_\_

Done Today 11-2-82

DEPT. of BLDG & SAFETY - CITY of LAS VEGAS, NEVADA

OWNER Sproul Homes ADDRESS 6716 Oveja Circle DATE 8/9/68  
 GEN CONT. Same TYPE OF STRUCTURE SFD  
 PERMIT NO. 113894 LEGAL DESCRIPTION L 12 B 2 Charleston Rainbow # 5B

BUILDING		MECHANICAL		ELECTRICAL	
LOCATION	<u>CH 8-9-68</u>	PLUMBING CONT.	<u>Unfiled</u>	TEMP. POLE CONT.	
FIREPLACE FTS.		PERMIT NO.	<u>24548</u>	PERMIT NO.	
FOOTINGS	<u>CH 8-9-68</u>	HEAT & VENT. AC CONT.	<u>Gearing</u>	INSPECTION	
FOUNDATION WALL	<u>CH 8-12-68</u>	PERMIT NO.	<u>16177</u>	ELECTRICAL CONT.	<u>Robert</u>
FLOOR FRAMING		SEWER CONT.	<u>Sproul</u>	PERMIT NO.	<u>26168</u>
SLAB	<u>CH 8-20-68</u>	PERMIT NO.	<u>24540</u>	DATE	<u>8-22-68</u>
CHIMNEY STEEL (FIREPLACE)		ROUGH SOIL	<u>8-14-68</u>	FIXTURES CONT.	<u>Robert</u>
WALL STEEL		TOP-OUT	<u>8-14-68</u>	PERMIT NO.	<u>26168</u>
COLUMN STEEL		ROUGH GAS	<u>8-14-68</u>	DATE	<u>8-22-68</u>
BEAM STEEL		AC ROUGH DUCT	<u>8-23-68</u>	SLAB	
FRAMING	<u>CH 8-9-68</u>	REF. ROUGH PIPING		ROUGH	<u>Miller 9-3-68</u>
ROOF SHEATHING	<u>CH 8-30-68</u>	FINAL PLUMBING	<u>8-24-68</u>	FINAL ROUGH	
INTERIOR		FINAL GAS	<u>8-24-68</u>	FINAL FIXTURE	
EXTERIOR		FINAL AIR COND.	<u>8-24-68</u>	FINAL ELECTRICAL	<u>Miller 10-23-68</u>
DRYWALL	<u>CH 9-13-68</u>	FINAL REFRIG.		TEMPORARY SERVICE	
LATHING		FINAL SEWER			
BACKING (SDWG)		FINAL SEPTIC TANK			
PLASTER	SCRATCH				
	BROWN				
URBAN REDEVELOPMENT APPROVAL					
FINAL BLDG	<u>CH</u>				
DATE	<u>10-23-68</u>				

APPROVED FOR OCCUPANCY & METER CH 10-23-68 INSPECTOR \_\_\_\_\_ DATE \_\_\_\_\_

PLEASE NOTE REMARKS ON REVERSE SIDE 6716 Oveja Circle LOG # T-12 AREA # 4 23.04

Done Today 11-2-82

DEPT. of BLDG. & SAFETY - CITY of LAS VEGAS, NEVADA

OWNER Sproul Homes ADDRESS 6716 Oveja Circle DATE 8/9/68  
GEN. CONT. Same TYPE OF STRUCTURE SFD  
PERMIT NO. 43894 LEGAL DESCRIPTION L 12 B 2 Charleston Rainbow # 5B

BUILDING		MECHANICAL		ELECTRICAL	
LOCATION	CH 8-9-68	PLUMBING CONT. United	PERMIT NO. 24548	TEMP. POLE CONT.	PERMIT NO. _____ DATE _____
FIREPLACE FTS.		HEAT & VENT. AC CONT. Gearing	DATE 8/9/68	INSPECTION	DATE _____
FOOTINGS	CH 8-9-68	PERMIT NO. 16477	DATE 8/9/68	ELECTRICAL CONT. Roberts	DATE _____
FOUNDATION WALL	CH 8-12-68	SEWER CONT. Sproul		PERMIT NO. 26168	DATE 8-22-68
FLOOR FRAMING		PERMIT NO. 24540	DATE 8/9/68	FIXTURES CONT. Roberts	DATE 8-22-68
SLAB	CH 8-20-68	ROUGH SOIL	8-14-68	PERMIT NO. 26168	DATE 8-22-68
CHIMNEY STEEL (FIREPLACE)		ROUGH WATER	8-14-68	SLAB	
WALL STEEL		TOP-OUT	8-14-68	ROUGH	Miller 9-3-68
COLUMN STEEL		ROUGH GAS	8-14-68	FINAL ROUGH	
BEAM STEEL		AC ROUGH DUCT	8-23-68	FINAL FIXTURE	
FRAMING	CH 8-20-68	REF. ROUGH PIPING		FINAL ELECTRICAL	Miller 10-23-68
ROOF SHEATHING	INTERIOR CH 8-30-68	FINAL PLUMBING	8-24-68	TEMPORARY SERVICE	
DRYWALL	CH 9-13-68	FINAL GAS	8-24-68	MISCELLANEOUS	
LATHING		FINAL AIR COND.	8-24-68	GRADING & DRAINAGE	
BACKING (SIDING)		FINAL REFRIG.		ON-SITE PARKING SPACES	4
PLASTER	SCRATCH	FINAL SEWER		ENG. APPROVAL OF	
	BROWN	FINAL SEPTIC TANK		OFF-SITE IMPROVEMENTS	
URBAN REDEVELOPMENT APPROVAL					
FINAL BLDG	CH				
	DATE 10-23-68				

APPROVED FOR OCCUPANCY & METER CH 10-23-68 INSPECTOR

PLEASE NOTE REMARKS ON REVERSE SIDE 6716 Oveja Circle

LOG # T-12 AREA # 4 23.04