

A 1117 NORMAN

• B 1120 NORMAN

C 1124 NORMAN

— L-29 Blk. 10 Sub. Huntridge #2 Z-R1 —

Y. Dated January 4, 1979

#25669

CITY OF LAS VEGAS, NEVADA

LOG NO. & AREA \_\_\_\_\_ 1970 \_\_\_\_\_ CONST. VAL. \$ 100.00

DEPARTMENT OF BUILDING & SAFETY

APPLICATION & BUILDING PERMIT - for: Dwellings, Duplexes, Misc. Residential Const.

ADDRESS OF CONSTRUCTION: 1117 Norman OWNER: Joan Kelly

LOT(s) \_\_\_\_\_ BLOCK \_\_\_\_\_ SUBDIVISION \_\_\_\_\_ ZONE: \_\_\_\_\_

Existing structure on lot: Dwelling  Accessory bldgs.  Vacant lot  Other

PROPOSED CONSTRUCTION: Roofing USE \_\_\_\_\_

MATERIALS OF CONSTRUCTION: Wood Frame  Concrete Block  Reinforced Concrete  Steel Frame

SQUARE FEET OF FLOOR AREAS: 1st \_\_\_\_\_ 2nd \_\_\_\_\_ 3rd \_\_\_\_\_ Other \_\_\_\_\_ TOTAL SQ. FT. \_\_\_\_\_

FIRE ZONE: 1 2 3 Occupancy Group A B C D E F G H I J-1-2-3-4-5 CONST. TYPE: I II III IV V

ARCHITECT: \_\_\_\_\_ ENGINEER: \_\_\_\_\_ NO. of UNITS: \_\_\_\_\_ NO. of STORIES: \_\_\_\_\_

Plans Submitted: Yes  No  Calculators Submitted Yes  No  Sewer Fee Req'd. Yes  No

CONTRACTOR: Dean Roofing STATE LICENSE # 6136A CITY LICENSE # C11 225 2 01098

ADD'L. PERMITS REQ'D: Air Cond.  Elec.  Plumbing  Signs  Paving  Fence  Public Walks  Curb-gutters  Incinerators  Fire Sprinkling System

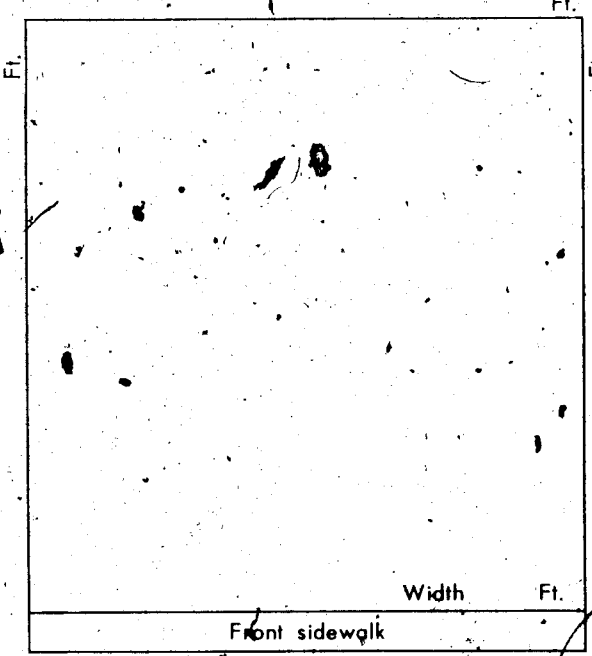

CONDITIONS OF THE PERMIT:

1. I agree to call the City Building Department for inspections before concrete is poured, before rough wiring, electrical, plumbing, framing is covered. Also, for Air conditioning, sheet-rock and sheathing inspection.
2. I agree that when the job is completed that I will call for final inspection before occupancy.
3. I agree to perform all construction in accordance with City Ordinances and Building Codes.
4. The Contractor's signature below denotes authority from the owner to sign in his behalf and that the owner is aware of all requirements of this application and permit. Separate permits must be taken out for work outlined above this agreement.
5. I have read and understand the contents of this application and permit; I hereby state that the information I have supplied on this application is true and correct.

SIGNED: Dean Roofing Co. Inc. Contractor

BY: [Signature] Agent or Owner

CLARK COUNTY HEALTH DEPT. Date \_\_\_\_\_

LAS VEGAS FIRE DEPARTMENT Date \_\_\_\_\_

PLANNING DEPT. Date: \_\_\_\_\_

PUBLIC WORKS DEPT. Date: \_\_\_\_\_

BUILDING DEPT: [Signature] Date: 8-24-70

#12850 PERMIT NO: 54637 PERMIT FEE \$500

RECEIPT

8873 \$005.00 - 8

CITY OF LAS VEGAS  
DEPT. OF BUILDING & SAFETY

MUST BE MACHINE VALIDATED  
24 AUG 70

4) Dated January 4, 1979

### CITY OF LAS VEGAS, NEVADA

#### DEPARTMENT OF BUILDING & SAFETY - ELECTRICAL APPLICATION & PERMIT

ADDRESS OF CONSTRUCTION: 1717 NORMAN AVENUE OWNER'S NAME: JIM KELLY

CIRCLE: New Bldg.; Add'n.; Remodel; TYPE OF BLDG.: (SFD.) APT. PUBLIC COMM.

CONTRACTOR'S NAME: SIMPSON ELECTRIC, INC. STATE LICENSE # 11276 CITY LICENSE # 7564

NUMBER	FIXTURE OR INSTALLATION	UNIT PRICE	TOTAL
	Rm addition, carport or garage enclosure	4.00	
	Temporary power	4.00	
	Light, receptacle or switch outlet	.20	
	Wall or ceiling space heater	.35	
	Garbage grinder outlet	.35	
	Dishwasher outlet	.35	
	Clothes dryer outlet	.35	
	Automatic clothes washer	.35	
	Electric range outlet	.35	
	Electric water heater outlet	.35	
	Special purpose outlet	.35	
	X-ray unit and its appurtenances	5.00	
	Watts of festoon lighting (Watts) First 3,000 watts for each additional thousand watts	4.00 .50	
	Horsepower-each motor first horsepower or less for each additional horsepower	1.75 .35	
	Electric service (including any single meter socket) for each additional socket	3.00 .35	
	Air conditioning service	1.50	
	Each KW(KVA) Generator (Transformer, Welder) First 100 KVA for each additional KW(KVA)	2.00 .01	
	Speaker, signal or alarm outlet	.15	
	Amplifiers	.50	
	Control panels	.25	
	Main control racks	1.00	
	T.V. and radio antennas-master system only	.75	
	Minimum fee for any permit	4.00	4.00
	TOTAL FEE		4.00

Approval for the work under this permit will be given only after refuse and debris have been removed from job site and public right of way.

I hereby certify that I have carefully examined and read the above application; that the same is true and correct; and that the work herein described is to be done in accordance with all the provisions of the applicable Ordinances of the City of Las Vegas, Nevada and State laws whether herein specified or not.

SIGNED William B. Simpson #20 DATE 11-23-73  
 MASTER (ELECTRICIAN) W. Miller  
 BUILDING DEPARTMENT DATE \_\_\_\_\_  
 #12860 PERMIT NO. 8143 PERMIT FEE: \$ 4.00

RECEIPT  
 4548 \$004.00 - 6  
 CITY OF LAS VEGAS  
 DEPT. OF BUILDING & SAFETY  
 MUST BE MACHINE VALIDATED  
 28 NOV 73

Gatewood - January 4, 1979

### CITY OF LAS VEGAS, NEVADA

#### DEPARTMENT OF BUILDING & SAFETY - AIR CONDITIONING APPLICATION & PERMIT

ADDRESS OF CONSTRUCTION: 1117 NORMAN OWNER'S NAME: JIM KELLEY

CIRCLE: Addition; Remodel; New Bldg; TYPE OF BLDG.: SFD APT. COMM. PUBLIC

CONTRACTOR'S NAME: VEGAS HEATING & SHEET METAL STATE LICENSE # 3157 A CITY LICENSE # 02369

UNITS	DESCRIPTION	FEE	TOTAL	UNITS	DESCRIPTION	FEE	TOTAL
	Unit heater - floor, wall or suspended	4.00			EVAPORATIVE COOLERS:		
	FOR EACH FORCED AIR OR GRAVITY-TYPE FURNACE OR BURNER INCLUDING DUCTS AND VENT ATTACHED TO SUCH APPLIANCES:				5 outlets or under	3.00	
	Up to and including 100,000 B.t.u.'s	4.00			Over 5 and up to and including 10	5.00	
	Over 100,000 B.t.u.'s	6.00			Each additional outlet over 10	.25	
	FOR EACH HEATING APPLICATION, REFRIGERATION UNIT, COMFORT COOLING AND HEATING UNIT, ABSORPTION UNIT, COMPRESSOR OR BOILER:				VENTILATION:		
	Up to and including 3 ton or horsepower, or absorption system up to and including 100,000 B.t.u.'s	4.00			For each fan connected to a single duct	1.00	
1	Over 3 ton or 3 horsepower up to and including 10, or absorption system over 100,000 B.t.u.'s up to and including 250,000 B.t.u.'s	7.00	7.00		For each commercial or industrial ventilation system	5.00	
	Over 10 ton or 10 horsepower up to and including 30, or absorption system over 250,000 B.t.u.'s up to and including 1,000,000 B.t.u.'s	12.00			For each commercial kitchen hood	5.00	
	Over 30 ton or 30 horsepower up to and including 50, or absorption system over 1,000,000 B.t.u.'s up to and including 1,700,000 B.t.u.'s	20.00			MISCELLANEOUS:		
	Over 50 ton or 50 horsepower, or absorption system over 1,700,000 B.t.u.'s	30.00			For each water cooling tower	8.00	
	FOR EACH AIR HANDLING UNIT INCLUDING DUCTS ATTACHED THERETO:				Duct work only - each opening	.25	
	Up to and including 10,000 CFM	2.00			For installation or relocation of each commercial or industrial incinerator	15.00	
	Over 10,000 CFM	4.00			Gas piping related to the air cond. work in single family dwelling only	3.00	
					For each appliance, piece of equipment, any mechanical work or alteration or replacement not included in this schedule, the permit fee shall be computed the same as building permit fees by using the cost of installation for the valuation amount.		
					FOR THE ISSUANCE OF EACH PERMIT		3.00
					TOTAL PERMIT FEE \$		10.00

I hereby certify that I have carefully examined and read the above application; that the same is true and correct; and that the work herein described is to be done in accordance with all the provisions of the applicable Ordinances of the City of Las Vegas, Nevada and the State Laws, whether herein specified or not.

Approval for the work under this permit will be given only after refuse and debris have been removed from job site and public right of way.

SIGNED [Signature] Date \_\_\_\_\_  
Air Conditioning Contractor - Owner

BUILDING DEPARTMENT [Signature] Date \_\_\_\_\_

PERMIT NO. 4709 PERMIT FEE \$ 10.00

#12890

RECEIPT

4741 \$010.00 - 4

CITY OF LAS VEGAS  
DEPT. OF BUILDING & SAFETY  
MUST BE MACHINE VALIDATED

- 3 DEC 73

133 Gatewood January 4, 1979

CITY OF LAS VEGAS, NEVADA

LOG NO. & AREA \_\_\_\_\_ CONST. VAL. \$ 690<sup>00</sup>

DEPARTMENT OF BUILDING & SAFETY

APPLICATION & BUILDING PERMIT — for:  
Dwellings, Duplexes, Misc. Residential Const.

ADDRESS OF CONSTRUCTION: 1117 Norman Avenue OWNER: JIM KELLEY

LOT(s) 29 BLOCK 10 SUBDIVISION Huntley Sub No 2 ZONE R-1

Existing structure on lot: Dwelling  Accessory bldgs.  Vacant lot  Other

PROPOSED CONSTRUCTION: Roof over existing slab for porch USE: 230<sup>00</sup>

MATERIALS OF CONSTRUCTION: Wood Frame  Concrete Block  Reinforced Concrete  Steel Frame

SQ. FEET OF FLOOR AREAS: 1st \_\_\_\_\_ 2nd \_\_\_\_\_ 3rd \_\_\_\_\_ Other \_\_\_\_\_ TOTAL SQ. FT. \_\_\_\_\_

FIRE ZONE: 1 2 3 \_\_\_\_\_ Occupancy Group 1 J 1 - 2 \_\_\_\_\_ CONST. TYPE I II III IV V \_\_\_\_\_

ARCHITECT: \_\_\_\_\_ ENGINEER: \_\_\_\_\_ NO. of UNITS \_\_\_\_\_ NO. of STORIES \_\_\_\_\_

Plans Submitted: Yes  No  Calculations Submitted Yes  No  Sewer Fee Req'd Yes  No

CONTRACTOR: WENDELL C. MILLER STATE LICENSE # 6097 CITY LICENSE # XXXXXX 12406

ADD'L. PERMITS REQ'D: Air Cond.  Elec.  Plumbing  Signs  Paving  Fence  Public Walks  Curb/gutters   
Incinerators  Fire Sprinkling System

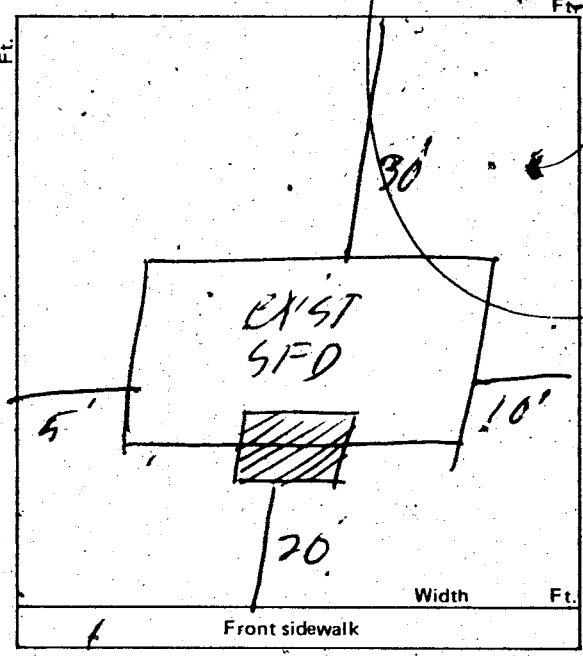

CONDITIONS OF THE PERMIT:

1. I agree to call the City Building Department for inspections before concrete is poured, before rough wiring, electrical, plumbing, framing is covered. Also for air conditioning, sheet-rock and sheathing inspection.
2. I agree that when the job is completed that I will call for final inspection before occupancy.
3. I agree to perform all construction in accordance with City Ordinances and Building Codes.
4. The Contractor's signature below denotes authority from the owner to sign in his behalf and that the owner is aware of all requirements of this application and permit. Separate permits must be taken out for work outlined above this agreement.
5. I have read and understand the contents of this application and permit; I hereby state that the information I have supplied on this application is true and correct.

Approval for the work under this permit will be given only after refuse and debris have been removed from job site and public right of way.

SIGNED: Wendell C. Miller Contractor  
BY: \_\_\_\_\_ Agent or Owner

CLARK COUNTY HEALTH DEPT. \_\_\_\_\_ Date \_\_\_\_\_  
LAS VEGAS FIRE DEPARTMENT \_\_\_\_\_ Date \_\_\_\_\_

PLANNING DEPT.: \_\_\_\_\_ Date: 8-2-79

PUBLIC WORKS DEPT.: \_\_\_\_\_ Date: \_\_\_\_\_

BUILDING DEPT.: Lodger Attulke Date: 9-2-74

# 12850 PERMIT NO.: 17950 PERMIT FEE \$ 900

RECEIPT  
5353 \$009.00 - 8  
CITY OF LAS VEGAS  
DEPT. OF BUILDING & SAFETY  
MUST BE MACHINE VALIDATED  
- 5 AUG 74

*Dona Healy 10-20-82*

DEPT. of BLDG. & SAFETY - CITY of LAS VEGAS, NEVADA

OWNER Jim Kelly ADDRESS 1117 Norman DATE 8/5/74  
 GEN. QONT. Wendell C Miller TYPE OF STRUCTURE roof over slab for  
 PERMIT NO. 17950 LEGAL DESCRIPTION Lot 29 Blk 10 Huntridge #2 porch

BUILDING	MECHANICAL	ELECTRICAL
Investigation	Plumbing Cont.	Temp. pole cont.
Location & Footing	Permit No. _____ Date _____	Permit No. _____ Date _____
Stem Wall	Heat & Vent. A/C Cont.	Inspection _____ Date _____
Concrete Slab Floor	Permit No. _____ Date _____	Electrical Cont. _____
Floor Framing	Sewer Cont.	Permit No. _____ Date _____
Fireplace Footing	Permit No. _____ Date _____	Fixtures Cont. _____
Chimney Steel	Rough Soil	Permit No. _____ Date _____
Vert. Steel Reinf.	Rough Water	Slab _____
Horiz. Steel Reinf.	Top Out	Rough _____
Roof Sheathing <u>H.B.S.-714</u>	Rough Gas	Final Rough _____
Framing <u>H.B.S.-714</u>	A/C Rough Duct	Final Fixture _____
Backing for siding	Ref. Rough Piping	Final Electrical _____
Ext. Lath	Final Plumbing	Temporary Service _____
Ext. Scratch	Final Gas	MISCELLANEOUS
Ext. Brown	Final Air Cond.	Grading & Drainage _____
Int. Lath	Final Refrig.	On-Site Parking Spaces _____ App. _____
Int. Brown	Final Sewer	Eng. Approval of _____
Drywall	Final Septic Tank	Off-Site Improvements _____
Permit No. _____		
Final Building		
Appr. for Occu.		

INSPECTOR: \_\_\_\_\_ DATE \_\_\_\_\_

APPROVED FOR OCCUPANCY & METER

PLEASE NOTE REMARKS ON REVERSE SIDE 1117 Norman LOG # \_\_\_\_\_ AREA # \_\_\_\_\_

Department of Building & Safety  
City of Las Vegas, Nevada

Special Kardex  
Elec. only, Plbg. only, A.C. only

Owner Jim Kelly Address 1117 Norman Date: 11/28/73  
 Contractor \_\_\_\_\_ Permit No. \_\_\_\_\_  
 Lot \_\_\_\_\_ Block \_\_\_\_\_ Subdivision \_\_\_\_\_

Electric Only	Plumbing Only	Heat & Vent. A. C. Only
Contractor <u>Simpson</u>	Contractor _____	Contractor <u>Vegas Hestley</u>
Permit No. <u>8143</u>	Permit No. _____	Permit No. <u>4769</u>
Slab _____	Rough Soil _____	A.C. Rough Duct _____
Rough Elect _____	Rough Water _____	Ref. Ro. Piping _____
Final Rough _____	Top Out _____	Rough Gas _____
Final Fixture _____	Rough Gas _____	Final Refrig _____
Final Elec <u>VP 1-20-84</u>	Final Plbg. _____	Final Air Cond _____
Temp. Service _____	Final Gas _____	Final Gas _____
	Final Sewer _____	
	Final Septic Tank _____	

23.06 D Address 1117 Norman AC Service Log No. \_\_\_\_\_ Area \_\_\_\_\_

*Dona Healy* 10-20-59

**DEPT. of BLDG. & SAFETY - CITY of LAS VEGAS, NEVADA**

OWNER: J. A. KELLY ADDRESS: 1117 Norman Ave. DATE: 11/1/59  
 GEN. CONT. CLIFFORD M. MILLER CONTR. TYPE OF STRUCTURE: ADDITION BATHRM.  
 PERMIT NO. 34876 LEGAL DESCRIPTION: \_\_\_\_\_

LOCATION & FLOOR ELEVATION _____ FOOTINGS <u>Miller 12-14-59</u> FOUND. & PIERS _____ WALL STEEL _____ BOND BEAM STEEL _____ FRAMING & ROOF SHEATHING <u>Miller 12-14-59</u> STEEL FABRICATION _____ CONNECTIONS & PAINTING _____ LATHING INTERIOR EXTERIOR <u>Miller 12-14-59</u> PLASTER SCRATCH _____ BROWN _____ FINAL BLDG. _____ GRADING & DRAINAGE _____ ON-SITE PARKING SPACES _____ ENG. APPROVAL OF OFF-SITE IMPROVEMENTS _____	PLUMBING CONT. <u>Western Pkly</u> PERMIT NO. <u>32145</u> DATE <u>12-4-59</u> HEAT & VENT. CONT. _____ PERMIT NO. _____ DATE _____ SEWER CONT. _____ PERMIT NO. _____ DATE _____ ROUGH SOIL <u>London 12-3-59</u> ROUGH WATER <u>London 12-3-59</u> SEWER OR SEPTIC TANK _____ TOP-OUT <u>London 12-3-59</u> ROUGH GAS _____ ROUGH DUCT _____ FINAL PLUMBING <u>London 7-27-61</u> FINAL HEATING _____ FINAL GAS _____	TEMP. POLE CONT. _____ PERMIT NO. _____ DATE _____ INSPECTION _____ DATE _____ ELECTRICAL CONT. <u>Fitzgerald</u> PERMIT NO. <u>25256</u> DATE <u>11-20-59</u> OUTLETS _____ MOTORS _____ H.S. _____ SLAB _____ ROUGH _____ FINAL ROUGH _____ FIXTURE CONT. _____ PERMIT NO. _____ DATE _____ FIXTURES _____ FINAL FIXTURE _____ APPROVED FOR METER: <u>Marshall 2-5-60</u>
---	---	---

APPROVED for OCCUPANCY: Webb INSPECTOR DATE: 6/27/61

\* PLEASE NOTE REMARKS ON REVERSE SIDE  
 1117 Norman Ave. ADDN. BATHROOM 11/1/59 23.04

**DEPT. of BLDG & SAFETY - CITY of LAS VEGAS, NEVADA**

OWNER: Jim Kelly ADDRESS: 1117 Norman DATE: 8/24/70  
 GEN. CONT. Dean TYPE OF STRUCTURE: Reroof  
 PERMIT NO. 54637 LEGAL DESCRIPTION: \_\_\_\_\_

BUILDING	MECHANICAL	ELECTRICAL
LOCATION _____	PLUMBING CONT. _____	TEMP. POLE CONT. _____
FIREPLACE FTG. _____	PERMIT NO. _____ DATE _____	PERMIT NO. _____ DATE _____
FOOTINGS _____	HEAT & VENT. AC CONT. _____	INSPECTION _____ DATE _____
FOUNDATION WALL _____	PERMIT NO. _____ DATE _____	ELECTRICAL CONT. _____
FLOOR FRAMING _____	SEWER CONT. _____	PERMIT NO. _____ DATE _____
SLAB _____	PERMIT NO. _____ DATE _____	FIXTURES CONT. _____
CHIMNEY STEEL (FIREPLACE) _____	ROUGH SOIL _____	PERMIT NO. _____ DATE _____
WALL STEEL _____	ROUGH WATER _____	SLAB _____
COLUMN STEEL _____	TOP-OUT _____	ROUGH _____
BEAM STEEL _____	ROUGH GAS _____	FINAL ROUGH _____
FRAMING _____	AC ROUGH DUCT _____	FINAL FIXTURE _____
ROOF SHEATHING INTERIOR EXTERIOR _____	REF. ROUGH PIPING _____	FINAL ELECTRICAL _____
DRYWALL _____	FINAL PLUMBING _____	TEMPORARY SERVICE _____
LATHING _____	FINAL GAS _____	
BACKING (SIDING) _____	FINAL AIR COND. _____	MISCELLANEOUS
PLASTER SCRATCH _____	FINAL REFRIG. _____	GRADING & DRAINAGE _____
BROWN _____	FINAL SEWER _____	ON-SITE PARKING SPACES _____ APP. _____
URBAN REDEVELOPMENT APPROVAL _____	FINAL SEPTIC TANK _____	ENG. APPROVAL OF _____
FINAL BLDG. <u>JK</u> DATE <u>9-20-70</u>		OFF-SITE IMPROVEMENTS _____

APPROVED FOR OCCUPANCY & METER: \_\_\_\_\_ INSPECTOR DATE: \_\_\_\_\_

PLEASE NOTE REMARKS ON REVERSE SIDE 1117 Norman LOG: # AREA: # 23.04

*Chibi Sigman 9-20-88*

NP176

**CITY OF LAS VEGAS, NEVADA**

LOG NO. & AREA \_\_\_\_\_

DATE 9/14/88

CONST. VAL. \$ \_\_\_\_\_

DEPARTMENT OF BUILDING AND SAFETY  
PHONE 886-6251 FOR INSPECTIONS, CALL 799-2071

**AIR CONDITIONING PERMIT**

ADDRESS OF CONSTRUCTION 1117 Norman Avenue

OWNER James A. Kelly PHONE: 382-2023

CONTRACTOR Lloyd's Refrigeration Inc.

STATE LICENSE NO. 019531

CITY LICENSE NO. C11-01855

LOT(S) \_\_\_\_\_ BLOCK \_\_\_\_\_ SUBDIVISION \_\_\_\_\_

ZONE \_\_\_\_\_

PROPOSED CONSTRUCTION Installation of 5-Ton Trane Heat Pump

USE \_\_\_\_\_

AIR COND. \_\_\_\_\_

PERMIT NO. 5762

Approval for the work under this permit will be given only after refuse and debris have been removed from job site and public right of way.

UNITS	DESCRIPTION	FEE	TOTAL
<b>PERMIT ISSUANCE</b>			
1	For the issuance of each permit.	15.00	15.00
	For issuing each supplemental permit.	4.50	
<b>UNIT FEE SCHEDULE</b>			
	For the installation or relocation of each forced-air or gravity-type furnace or burner, including ducts and vents attached to such appliance, up to and including 100,000 Btu/h.	9.00	
	For the installation or relocation of each forced-air or gravity-type furnace or burner, including ducts and vents attached to such appliance over 100,000 Btu/h.	11.00	
	For the installation or relocation of each floor furnace, including vent.	9.00	
	For the installation or relocation of each suspended heater, recessed wall heater or floor-mounted unit heater.	9.00	
	For the installation, relocation or replacement of each appliance vent installed and not included in an appliance permit.	4.50	
	For the repair of, alteration of, or addition to each heating appliance, refrigeration unit, cooling unit, absorption unit, or each heating, cooling absorption, or evaporative cooling system, including installation of controls regulated by this code.	9.00	
	For the installation or relocation of each boiler or compressor to and including three horsepower, or each absorption system to and including 100,000 Btu/h.	9.00	
1	For the installation or relocation of each boiler or compressor over three horsepower to and including 15 horsepower, or each absorption system over 100,000 Btu/h and including 500,000 Btu/h.	16.50	16.50
	For the installation or relocation of each boiler or compressor over 15 horsepower to and including 30 horsepower, or each absorption system over 500,000 Btu/h to and including 1,000,000 Btu/h.	22.50	
	For the installation or relocation of each boiler or compressor over 30 horsepower to and including 50 horsepower, or for each absorption system over 1,000,000 Btu/h to and including 1,750,000 Btu/h.	33.50	
	For the installation or relocation of each boiler or refrigeration compressor over 50 horsepower, or each absorption system over 1,750,000 Btu/h.	56.00	

UNITS	DESCRIPTION	FEE	TOTAL
	For each air-handling unit to and including 10,000 cubic feet per minute, including ducts attached thereto. <i>Note: This fee shall not apply to an air-handling unit which is a portion of a factory-assembled appliance, cooling unit, evaporative cooler or absorption unit for which a permit is required elsewhere in this code.</i>	6.50	
	For each air-handling unit over 10,000 cfm.	11.00	
	For each evaporative cooler other than portable type.	6.50	
	For each ventilation fan	COMMERCIAL 4.50 RESIDENTIAL 2.35	
	For each ventilation system which is not a portion of any heating or air-conditioning system authorized by a permit.	6.50	
	For the installation of each hood which is served by mechanical exhaust, including the ducts for such hood.	6.50	
	For each appliance or piece of equipment regulated by this code but not classed in other appliance categories, or for which no other fee is listed in this code.	6.50	
<b>OTHER INSPECTIONS AND FEES:</b>			
	Inspections outside of normal business hours (minimum charge — three hours.)	25.00 per hour	
	Reinspection fee assessed under provisions of TABLE 3-A of the Uniform Building Code = \$15.00 EACH	15.00 each	
	Inspections for which no fee is specifically indicated (minimum charge — one-half hour).	30.00 per hour	
	Additional plan review required by changes, additions or revisions to approved plans (minimum charge — two hours).	30.00 per hour	
	Mechanical permit fees may be computed the same as building permit fees by using the cost of installation for valuation amount when such work is not included in the above schedule.		
	Gas piping which is directly related and necessary to the repair or replacement of heating, air conditioning, or refrigeration systems not exceeding 500,000 B.T.U.H.	6.00	

I hereby certify that I have carefully examined and read the above application; that the same is true and correct; and that the work herein described is to be done in accordance with all the provisions of the applicable Ordinances of the City of Las Vegas, Nevada, and the State Laws, whether herein specified or not.

SIGNED *William J. Harkin* CONTRACTOR MASTER CARD NO \_\_\_\_\_  
BY *Clare Hooley* Spec. Copy of Owner DATE 9/13/88  
BUILDING DEPT.

PERMIT FEE \$15.00  
TOTAL FEES \$31.50

2310-2405  
09/14/88  
RECEIVED 03\*\*  
A/C 31.50  
CHEK 31.50  
5168A000 13:03

Permit Expires 180 Days After Abandonment of Work.

MUST BE MACHINE VALIDATED

*Debbie Ingram 10-11-88*

C-6387

# CITY OF LAS VEGAS, NEVADA

LOG NO. & AREA \_\_\_\_\_ DATE 9-22-88 CONST. VAL \$ \_\_\_\_\_

DEPARTMENT OF BUILDING AND SAFETY  
PHONE 386-6251 FOR INSPECTIONS, CALL 799-2071  
ADDRESS OF CONSTRUCTION 1117 Norman Ave.

## ELECTRICAL PERMIT

OWNER James A. Kelly

CONTRACTOR Electric Construction Co.

STATE LICENSE NO. 9383

CITY LICENSE NO. 2193

Bert G. Vaughan  
(PRINT NAME OF MASTER ELECTRICIAN)

120  
MASTER CARD NO.

PHONE 452-2142

PROPOSED CONSTRUCTION: hookup A/C

USE: \_\_\_\_\_

ELECTRIC PERMIT NO. 6051

Approval for the work under this permit will be given only after refuse and debris have been removed from job site and public right-of-way.

UNITS	DESCRIPTION	FEE	TOTAL
<b>PERMIT ISSUANCE</b>			
1	For Issuance Each Permit	10.00	10.00
	Supplemental Fee	4.50	
<b>APPLIANCE CHARGE</b>			
<b>Residential or General Commercial</b>			
	Receptacle _____ Switch _____	.40	
	Each Light Fixture, Socket, or Exit Light, Smoke Detector or Exhaust Fan	.30	
	EACH OUTLET FOR SPECIAL PURPOSE: Dishwasher, Garbage Grinder, Trash Compactor, G.F.I., Clothes Washer, Dryer, Electric Range, OverS, Water Heater, Space Heater, Blast Coil Heater, (PER K.W.), Mercury Lamp, Quartz Lamp, Sodium Lamp, 20AMP Sign Circuit	.70	
	X-Ray Unit	10.00	
	Area Lighting (First 3,000 Watts)	8.00	
	Each Additional 1,000 Watts	8.00	
<b>MOTORS (1 H.P. AND OVER) TRANSFORMERS, ELEVATORS, WELDERS, GENERATORS, CHILLERS, SIGNS AND A/C UNITS (OVER 5 TONS)</b>			
	First H.P. or Ton For each Unit	3.00	
	First KVA For Each Unit	3.00	
	Each Additional H.P., Ton or KVA up to 50	.50	
	Each Additional H.P., Ton or KVA over 50	.35	
	Temporary power or Pole	6.00	
<b>ELECTRIC SERVICE OR MAIN DISCONNECT</b>			
	Up to 200 AMP	6.00	
	400 AMP And 600 AMP	12.50	
	Over 600 AMP To 1200 AMP	25.00	
	Over 1200 AMP	50.00	
	Each Additional Meter Socket	.50	
	Sub Panel, Motor Control Center Disconnect Switch, Transfer Switch (Each)	3.00	
	Swimming Pool (Residential)	20.00	
	Swimming Pool (Semi-Public)	30.00	
	Spas	8.00	
	Recreational Vehicle Spaces (Each)	3.00	

UNITS	DESCRIPTION	FEE	TOTAL
	Burways-Trolley or Plug-in (Ea. 100 Ft.)	3.00	
	Gas Pumps, Dispensers (Each)	3.00	
1	Permanent A/C Unit (5 Tons or Less)	3.00	3.00
	Each Air Handler	1.00	
<b>RESIDENTIAL LOW VOLTAGE INSTALLATIONS</b>			
	Speaker Outlets (Each)	.30	
	Signal or Alarm Outlets (Each)	.30	
	Amplifiers	2.00	
	Control Panel	.50	
	TV Master System	.30	
	Telephone or Computer Outlet	.30	
<b>OTHER INSPECTIONS AND FEES: INCLUDES ISSUANCE FEES WHEN APPLICABLE</b>			
	Inspections outside of normal business hours (minimum charge - three hours)	30.00	per hour
	Reinspection fee assessed under provisions of TABLE 3-A of the Uniform Building Code - \$30.00 EACH	30.00	each
	Inspections for which no fee is specifically indicated (minimum charge - one-half hour)	30.00	per hour
	Additional plan review required by changes, additions or revisions to approved plans (minimum charge - one-half hour). After work hours - \$30.00 per hour - minimum 1 hour.	30.00	per hour
	Starter Permit	50.00	
<b>CONTRACT PRICE OR COST OF INSTALLATION</b>			
	Commercial - Burglar Alarms		
	- Music Systems		
	- Data Processing		
	- Communication		
	Conduit Only - Contract Price		
	All Misc. Electric		

Electrical permit fees may be computed the same as building permit fees by using the cost of installation for valuation amount when such work is not included in the above schedule.

# 2310-2402 10/05/88

### RECEIPT

\*\*0004\*\*  
ELEC 13.00  
CHEK 13.00  
6101A000 10:37

I hereby certify that I have carefully examined and read the above application; that the same is true and correct; and that the work herein described is to be done in accordance with all the provisions of the applicable Ordinances of the City of Las Vegas, Nevada and the State Laws, whether herein specified or not.

SIGNED HOMEOWNER, CONTRACTOR

BUILDING DEPT.

DATE

Permit Expires 180 Days After Abandonment of Work

PERMIT FEE 13.00

LESS STARTER PERMIT \_\_\_\_\_

TOTAL FEES 13.00

PERMIT NO. \_\_\_\_\_

MUST BE MACHINE VALIDATED

*Dona Hooley* 10-20-62

DEPT. of BLDG & SAFETY—CITY of LAS VEGAS, NEVADA  
 OWNER William H. Walker ADDRESS 1120 Norman DATE 8/10/65  
 GEN. CONT. Owner TYPE OF STRUCTURE carport  
 PERMIT NO. 31138 LEGAL DESCRIPTION Lot 6, Blk. 11, Huntridge #2

BUILDING		MECHANICAL		ELECTRICAL	
LOCATION		PLUMBING CONT.		TEMP. POLE CONT.	
FIREPLACE FTS.		PERMIT NO.	DATE	PERMIT NO.	DATE
FOOTINGS		HEAT & VENT. AC CONT.		INSPECTION	DATE
FOUNDATION WALL		PERMIT NO.	DATE	ELECTRICAL CONT.	DATE
FLOOR FRAMING		SEWER CONT.		PERMIT NO.	DATE
SLAB		PERMIT NO.	DATE	FIXTURES CONT.	DATE
CHIMNEY STEEL (FIREPLACE)		ROUGH SOIL		PERMIT NO.	DATE
WALL STEEL		ROUGH WATER		SLAB	
COLUMN STEEL		TOP-OUT		ROUGH	
BEAM STEEL		ROUGH GAS		FINAL ROUGH	
FRAMING		AC ROUGH DUCT		FINAL FIXTURE	
ROOF SHEATHING		REF. ROUGH PIPING		FINAL ELECTRICAL	
	INTERIOR	FINAL PLUMBING		TEMPORARY SERVICE	
DRYWALL		FINAL GAS			
LATHING		FINAL AIR COND.			
BACKING (SIGNS)		FINAL REFRIG.			
PLASTER	SCRATCH	FINAL SEWER			
	BROWN	FINAL SEPTIC TANK			
URBAN REDEVELOPMENT APPROVAL					
FINAL BLDG	DATE				

INSPECTOR \_\_\_\_\_ DATE \_\_\_\_\_  
 APPROVED FOR OCCUPANCY & METER \_\_\_\_\_  
 PLEASE NOTE REMARKS ON REVERSE SIDE 1120 Norman LOG: # AREA: # 23.04

DEPT. of BLDG & SAFETY—CITY of LAS VEGAS, NEVADA  
 OWNER William Walker ADDRESS 1120 Norman DATE 10-28-64  
 GEN. CONT. Superior Const Co. TYPE OF STRUCTURE int repairs  
 PERMIT NO. 28185 LEGAL DESCRIPTION Lot 6 Blk 11 Huntridge #2

BUILDING		MECHANICAL		ELECTRICAL	
LOCATION		PLUMBING CONT.		TEMP. POLE CONT.	
FIREPLACE FTS.		PERMIT NO. 16780	DATE 11-6-64	PERMIT NO.	DATE
FOOTINGS		HEAT & VENT. AC CONT.		INSPECTION	DATE
FOUNDATION WALL		PERMIT NO. 16780	DATE 11-18-64	ELECTRICAL CONT.	DATE
FLOOR FRAMING		SEWER CONT.		PERMIT NO. 15595	DATE 4-25-64
SLAB		PERMIT NO.	DATE	FIXTURES CONT.	DATE
CHIMNEY STEEL (FIREPLACE)		ROUGH SOIL	BB 11-6-64	PERMIT NO.	DATE
WALL STEEL		ROUGH WATER	BB 11-6-64	SLAB	
COLUMN STEEL		TOP-OUT		ROUGH	22-1-64
BEAM STEEL		ROUGH GAS		FINAL ROUGH	
FRAMING	11-11-64	AC ROUGH DUCT	15-BU-2064	FINAL FIXTURE	
ROOF SHEATHING		REF. ROUGH PIPING		FINAL ELECTRICAL	12-1-64
	INTERIOR	FINAL PLUMBING		TEMPORARY SERVICE	
DRYWALL		FINAL GAS			
LATHING	11-12-64	FINAL AIR COND.			
BACKING (SIGNS)		FINAL REFRIG.			
PLASTER	SCRATCH	FINAL SEWER			
	BROWN	FINAL SEPTIC TANK			
URBAN REDEVELOPMENT APPROVAL					
FINAL BLDG	DATE 1-20-65				

INSPECTOR \_\_\_\_\_ DATE \_\_\_\_\_  
 APPROVED FOR OCCUPANCY & METER \_\_\_\_\_  
 PLEASE NOTE REMARKS ON REVERSE SIDE 1120 Norman LOG: # AREA: # 23.04

*Dona Hooley*

*10-20-72*

DEPT. of BLDG. & SAFETY - CITY of LAS VEGAS, NEVADA  
 OWNER: SAM EARL ADDRESS: 1124 Norman Ave. DATE: 3/3/60  
 GEN. CONT. SAM EARL CONSTR. CO. TYPE OF STRUCTURE: EXTEND LIVING ROOM  
 PERMIT NO. 35738 LEGAL DESCRIPTION: & ADD FIREPLACE

LOCATION & FLOOR ELEVATION _____	PLUMBING CONT. _____ PERMIT NO. _____ DATE _____	TEMP. POLE CONT. _____ PERMIT NO. _____ DATE _____
FOOTINGS _____	HEAT. & VENT. CONT. _____ PERMIT NO. _____ DATE _____	INSPECTION _____ DATE _____
FOUND. & PIERS _____	SEWER CONT. _____ PERMIT NO. _____ DATE _____	ELECTRICAL CONT. _____ PERMIT NO. _____ DATE _____
WALL STEEL _____	ROUGH SOIL _____	OUTLETS _____
BOND BEAM STEEL _____	ROUGH WATER _____	MOTORS _____ H.P. _____
FRAMING & ROOF SHEATHING _____	SEWER OR SEPTIC TANK _____	SLAB _____
STEEL FABRICATION _____	TOP-OUT _____	ROUGH _____
CONNECTIONS & PAINTING _____	ROUGH GAS _____	FINAL ROUGH _____
LATHING _____	ROUGH DUCT _____	FIXTURE CONT. _____ PERMIT NO. _____ DATE _____
PLASTER _____	FINAL PLUMBING _____	FIXTURES _____
SCRATCH _____	FINAL HEATING _____	FINAL FIXTURE _____
BROWN _____	FINAL GAS _____	APPROVED FOR METER _____
FINAL BLDG. <u>CC 6-28-61</u>		
GRADING & DRAINAGE _____		
ON-SITE PARKING _____ SPACES _____		
ENG. APPROVAL OF _____		
OFF-SITE IMPROVEMENTS _____		

APPROVED for OCCUPANCY: Webb INSPECTOR DATE: 6/28/61

\* PLEASE NOTE REMARKS ON REVERSE SIDE

1124 Norman Ave. EXTEND LIVING RM., & ADD FIREPLACE 3/3/60

23.04