

1412 E MC WILLIAMS

L137 B12 GLV ADD TR #2 ZONE R-1

D. Gatewood 11-7-79

L-B

CITY OF LAS VEGAS, NEVADA

LCG NO. & AREA _____

CONST. VAL: \$ 1130

DEPARTMENT OF BUILDING & SAFETY

APPLICATION & BUILDING PERMIT — for:

ADDRESS OF CONSTRUCTION: 1412 E. Mc Williams OWNER: PHILIP ULLMAN

LOT(S) 1374-138 BLOCK 12 SUBDIVISION Greater Las Vegas Add. Tr. 2 ZONE: R-1

Materials of Construction: Block Concrete Wire Wood Other Yes No

ARCHITECT: _____ ENGINEER: _____ PLANS:

CONTRACTOR: Owner STATE LICENSE # _____ CITY LICENSE # _____ CALCS:

TOTAL SQUARE FEET: _____ TOTAL LINEAL FEET: _____

Remarks: _____

CONDITIONS OF THE PERMIT:

1. Any type of retaining wall must be engineered by a Civil or Structural Engineer.
2. If a home owner takes out the Building Permit and if the owner sublets the work to a Contractor, then the Contractor must take out the permit and pay for it.
3. No fence or wall can be built on City property or rights-of-way, but this is not intended to preclude construction within utility easements if utilities will not be damaged or made inaccessible.
4. The fence or wall shall not enclose any water meter, light standard, or fire alarm box and shall not come closer than 24" from the nearest fire hydrant outlet.
5. Department Inspectors must approve footings before concrete is poured and block wall reinforcing before grouting is done.
6. Maximum height of any wall or fence is 6', side and rear yards; 4' maximum in front yard with the vertical surface above the height of 2' — 50% open.
7. I must not obstruct required onsite parking space (2 spaces for each dwelling unit) by the erection of this fence or wall.
8. By the signing of this application I herewith agree to the requirements outlined above.

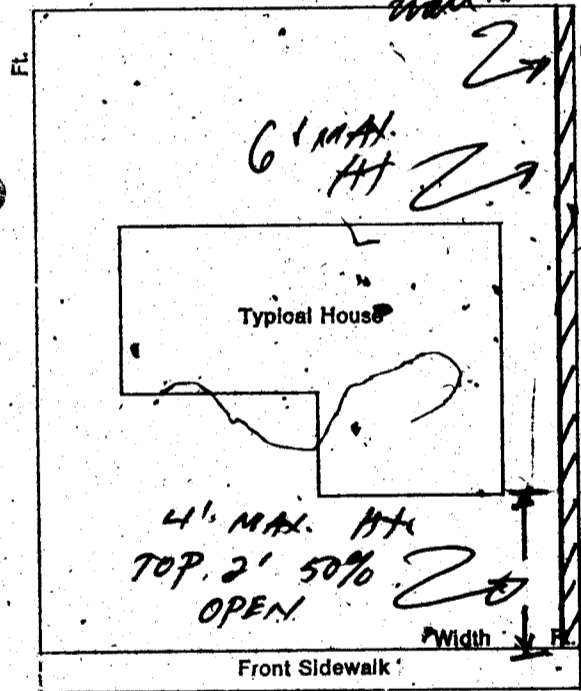

SIGNED: Barbara Ullman DATE: 10/6/75
CONTRACTOR AGENT OWNER

PLANNING DEPT: _____ Date: 10-6-75

PUBLIC WORKS DEPT: _____ Date: 10-6-75

BUILDING DEPT: [Signature] Date: 10-6-75

#12850 PERMIT NO: 4365 PERMIT FEE 15

RECEIPT
 1645 \$015.00 - 8
 CITY OF LAS VEGAS
 DEPT. OF BUILDING & SAFETY
 MUST BE MACHINE VALIDATED
 - 10-15

M. Matewood 11-7-79

CITY OF LAS VEGAS, NEVADA

LOG NO. & AREA

DEPARTMENT OF BUILDING & SAFETY

CONST. VAL. \$

2400⁰⁰

APPLICATION & BUILDING PERMIT — for:
Dwellings, Duplexes, Misc. Residential Const.

ADDRESS OF CONSTRUCTION:

1412 E McWilliams

OWNER:

Barbara Ullom

LOT(s)

137 BLOCK 12

SUBDIVISION

SPATER L.V. ADD. TR. #2

ZONE: R-1

Existing structure on lot: Dwelling

Accessory Bldg.

Vacant lot

Other

FAMILY ROOM UTILITY

PROPOSED CONSTRUCTION:

Carport Enc. & Add.

USE:

MATERIALS OF CONSTRUCTION:

Wood Frame

Concrete Block

Reinforced Concrete

Steel Frame

SQ. FEET OF FLOOR AREAS:

1st

2nd

3rd

Other

TOTAL SQ. FT.

100

FIRE ZONE: 1 2 3

Occupancy Group 1 J 4 - 2

CONST. TYPE

I II III IV V

ARCHITECT:

ENGINEER:

NO. of UNITS

NO. of STORIES

Plans Submitted: Yes No

Calculations Submitted

Yes No

Sever Fee Req'd.

Yes No

CONTRACTOR:

owner

STATE LICENSE #

CITY LICENSE #

ADD'L. PERMITS REQ'D:

Air Cond.
Incinerators

Elec.
Fire Sprinkling System

Plumbing

Signs

Paving

Fence

Public Walks

Curbscutters

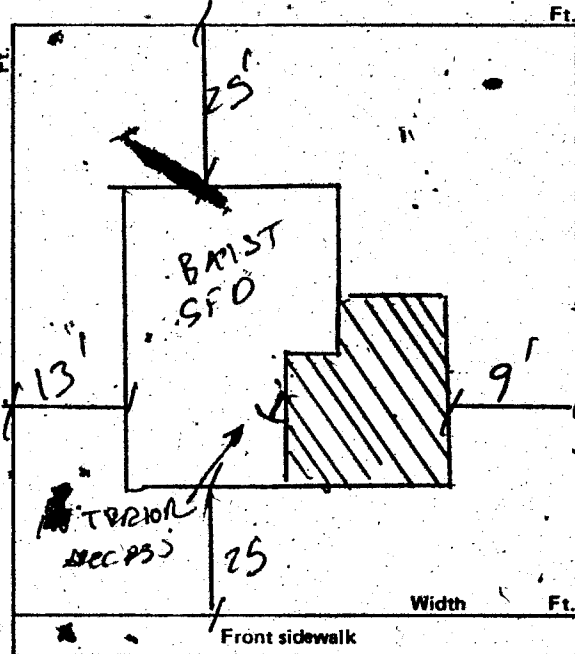

CONDITIONS OF THE PERMIT:

1. I agree to call the City Building Department for inspections before concrete is poured, before rough wiring, electrical, plumbing, framing is covered. Also for air conditioning, sheet-rock and sheathing inspection.
2. I agree that when the job is completed that I will call for final inspection before occupancy.
3. I agree to perform all construction in accordance with City Ordinances and Building Codes.
4. The Contractor's signature below denotes authority from the owner to sign in his behalf and that the owner is aware of all requirements of this application and permit. Separate permits must be taken out for work outlined above this agreement.
5. I have read and understand the contents of this application and permit, I hereby state that the information I have supplied on this application is true and correct.

Approval for the work under this permit will be given only after rebar and debris have been removed from job site and public right of way.

SIGNED: Barbara Ullom Contractor

BY: _____ Agent or Owner

CLARK COUNTY HEALTH DEPT.

LAS VEGAS FIRE DEPARTMENT

PLANNING DEPT. [Signature] Date: 1/20/76

PUBLIC WORKS DEPT. _____ Date: _____

BUILDING DEPT. [Signature] Date: 1-21-76

12850

PERMIT NO.:

272

PERMIT FEE \$

24⁰⁰

RECEIPT

5921 \$024.00 - 8

CITY OF LAS VEGAS
DEPT. OF BUILDING & SAFETY

MUST BE MACHINE VALIDATED

22 JAN 76

H. Matusood 11-7-79

CITY OF LAS VEGAS, NEVADA

DEPARTMENT OF BUILDING & SAFETY - ELECTRICAL APPLICATION & PERMIT

ADDRESS OF CONSTRUCTION: 1412 E. McWilliams OWNER'S NAME: Barbara Ulbon

CIRCLE: New Bldg.; Add'n; Remodel; TYPE OF BLDG.: SFD. APT. PUBLIC COMM.

CONTRACTOR'S NAME: Mead Electric STATE LICENSE # 9559 CITY LICENSE # 11-272-5-13224

NUMBER	FIXTURE OR INSTALLATION	UNIT PRICE	TOTAL
	Rm addition, <u>carport</u> or garage enclosure	4.00	<u>4.00</u>
	Temporary power	4.00	
<u>16</u>	Light, receptacle or switch outlet	.20	<u>8.00</u>
	Wall or ceiling space heater	.35	
	Garbage grinder outlet	.35	
	Dishwasher outlet	.35	
	Clothes dryer outlet	.35	
	Automatic clothes washer	.35	
	Electric range outlet	.35	
	Electric water heater outlet	.35	
	Special purpose outlet	.35	
	X-ray unit and its appurtenances	5.00	
	Watts of festoon lighting (Watts) First 3,000 watts for each additional thousand watts	4.00 1.50	
	Horsepower-each motor first horsepower or less for each additional horsepower	1.75 .35	
	Electric service (including any single meter socket) for each additional socket	3.00 .35	
	Air conditioning service	1.50	
	Each KW(KVA) Generator (Transformer, Welder) First 100 KVA for each additional KW(KVA)	2.00 .01	
	Speaker, signal or alarm outlet	.15	
	Amplifiers	.50	
	Control panels	.25	
	Main control racks	1.00	
	T.V. and radio antennas-master system only	.75	
	Minimum fee for any permit	4.00	
	TOTAL FEE		<u>12.00</u>

Approval for the work under this permit will be given only after refuse and debris have been removed from job site and public right of way.

I hereby certify that I have carefully examined and read the above application; that the same is true and correct; and that the work herein described is to be done in accordance with all the provisions of the applicable Ordinances of the City of Las Vegas, Nevada and State laws whether herein specified or not.

SIGNED Kenneth O. Dennis DATE 2/11/76
MASTER (ELECTRICIAN) (TECHNICIAN) (OWNER)

BUILDING DEPARTMENT WLF 7 DATE 2/4/76

PERMIT NO. 398 PERMIT FEE \$ 12.00

RECEIPT

7016 \$012.00 7/6

CITY OF LAS VEGAS
DEPT. OF BUILDING & SAFETY

MUST BE MACHINE VALIDATED

12-23

M. Matewood 11-7-79

19-19

CITY OF LAS VEGAS, NEVADA

LOG NO. & AREA

DEPARTMENT OF BUILDING & SAFETY

CONST. VAL. \$

800.00

APPLICATION & BUILDING PERMIT - for:
Dwellings, Duplexes, Misc. Residential Const.

ADDRESS OF CONSTRUCTION: 1412 E. McWilliams

OWNER: BARBARA ULLOM

LOT(s) 137 BLOCK 12 SUBDIVISION GREATER LAS VEGAS APP TR. 2 ZONE R-1

Existing structure on lot: Dwelling Accessory bldg. Vacant lot Other

PROPOSED CONSTRUCTION: FIRE PLACE USE:

MATERIALS OF CONSTRUCTION: Wood Frame Concrete Block Reinforced Concrete Steel Frame

SQ. FEET OF FLOOR AREAS: 1st 2nd 3rd Other TOTAL SQ. FT.

FIRE ZONE: 1 2 3 Occupancy Group: 1 J 1 - 2 CONST. TYPE I II III IV V

ARCHITECT: ENGINEER: NO. of UNITS NO. of STORIES

Plans Submitted: Yes No Calculations Submitted: Yes No Sewer Fee Req'd: Yes No

CONTRACTOR: OWNER STATE LICENSE # CITY LICENSE #

ADD'L. PERMITS REQ'D: Air Cond. Elec. Plumbing Signs Paving Fence Public Walks Curb-gutters
Incinerators Fire Sprinkling System

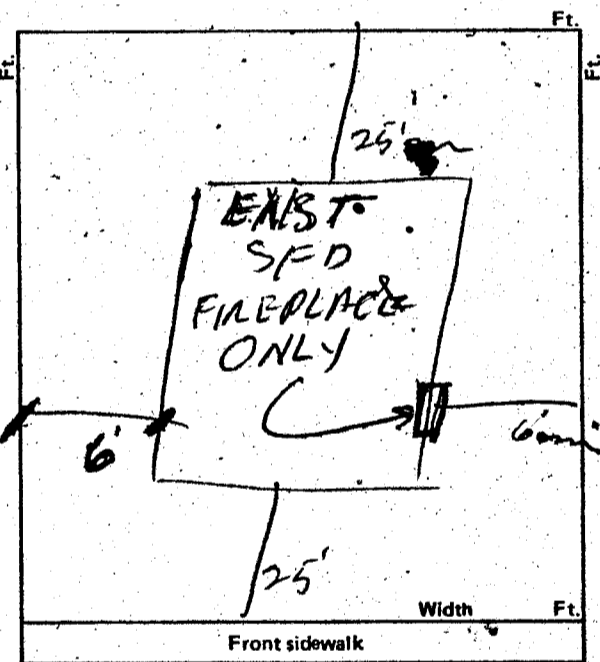

CONDITIONS OF THE PERMIT:

- 1. I agree to call the City Building Department for inspections before concrete is poured, before rough wiring, electrical, plumbing, framing is covered. Also for air conditioning, sheet-rock and sheathing inspection.
- 2. I agree that when the job is completed that I will call for final inspection before occupancy.
- 3. I agree to perform all construction in accordance with City Ordinances and Building Codes.
- 4. The Contractor's signature below denotes authority from the owner to sign in his behalf and that the owner is aware of all requirements of this application and permit. Separate permits must be taken out for work outlined above this agreement.
- 5. I have read and understand the contents of this application and permit; I hereby state that the information I have supplied on this application is true and correct.

Approval for the work under this permit will be given only after refuse and debris have been removed from job site and public right of way.

SIGNED: Barbara Ullom Contractor

BY: Agent or Owner

CLARK COUNTY HEALTH DEPT. Date

LAS VEGAS FIRE DEPARTMENT Date

PLANNING DEPT.: Date: 2-18-76

PUBLIC WORKS DEPT.: Date:

BUILDING DEPT.: Date: 2-18-76

12850 PERMIT NO.: 693 PERMIT FEE \$ 10.00

RECEIPT
7222 \$010.00 - 8
CITY OF LAS VEGAS
DEPT. OF BUILDING & SAFETY
MUST BE MACHINE VALIDATED
18 FEB 76

M. Matewood 11-7-79

7453

CITY OF LAS VEGAS, NEVADA

DEPARTMENT OF BUILDING & SAFETY - APPLICATION AND PERMIT FOR PLUMBING

ADDRESS OF CONSTRUCTION: 1412 E McWilliams OWNER'S NAME: _____

CIRCLE: New Bldg.; Add'n.; Remodel; TYPE OF BLDG.: SFD. APT. PUBLIC COMM.

CONTRACTOR'S NAME: Negs Valley Water Corp STATE LICENSE # _____ CITY LICENSE # _____

UNITS	DESCRIPTION	FEE	TOTAL
	Bathtub	1.00	
	Shower	1.00	
	Lavatory	1.00	
	Toilet	1.00	
	Urinal	1.00	
	Floor Drain	1.00	
	Floor Sink	1.00	
	Wash Tray	1.00	
	Sink	1.00	
	Garbage Disposal	1.00	
	Garbage Disposal (comm.)	3.00	
	Clothes Dryer (gas)	1.00	
	Glothes Washer	1.00	
	Clothes Washer (comm.)	5.00	
	Dishwasher	1.00	
	Dishwasher (commercial)	5.00	
	Dental Unit	10.00	
	Drinking Fountain	1.00	
	Any Water-using Equipment	1.00	
	Water Heater (gas) (elect.)	1.00	
	Sewer System - New, Replacement, or any Drainage System	4.00	
	Grease or Sand Trap	2.00	
	Trailer Trap	2.00	
	Septic Disposal System	4.00	
WATER SOFTENERS			
	Nonpermanent Type	4.00	
	Permanent Type (connected to Drainage)	5.00	5.00
SWIMMING POOLS			
	Private or Wading Pool	10.00	
	Public or Semi-public	20.00	

UNITS	DESCRIPTION	FEE	TOTAL
WATER DISTRIBUTION SYSTEM:			
	Single Family Dwelling	4.00	
	Multiple Family Dwelling plus each unit.	4.00 2.00	
	Bldg. Group "A" thru "G" per each floor	6.00	
	Hotel or Motel plus each bath	4.00 1.50	
	Trailer Park plus each space	20.00 1.00	
	Irrigation	4.00	
GAS PIPING SYSTEM			
	Single Family Dwelling	3.00	
	Multiple Family Dwelling plus each unit	6.00 1.00	
	Commercial Bldg. per floor plus each unit	3.00 3.00	
	Gas Appliance (any type)	1.00	
AUTOMATIC FIRE EXTINGUISHING SYSTEM			
	Underground Piping	10.00	
	Distribution Piping ea. ft.	.01	
	Sprinkler Head each	.10	
	In Range Hood and Vent	5.00	
DRY STANDPIPE SYSTEM			
	Piping	50.00	
	Each Outlet	1.00	
WET STANDPIPE SYSTEM			
	Piping	5.00	
	Fire Hose Cabinet	1.00	
MINIMUM PERMIT FEE 4.00			
PIPELINE CONTRACTOR, SECT. 14-B.P.F. \$			
TOTAL PERMIT FEE \$			

I hereby certify that I have carefully examined and read the above application; that the same is true and correct; and that the work herein described is to be done in accordance with all the provisions of the applicable Ordinances of the City of Las Vegas, Nevada and the State Laws, whether herein specified or not.

Approval for the work under this permit will be given only after refuse and debris have been removed from job site and public right of way.

Signed: [Signature] Date: _____
Registered Master Plumber, Spec. Cont'r. or Owner

Building Department: [Signature] Date: 3-30-71
Permit No. 1045 Permit Fee \$ 5.00

#12870

RECEIPT

9174 \$005.00 - 7

CITY OF LAS VEGAS
DEPT. OF BUILDING & SAFETY

MUST BE MACHINE VALIDATED

Done Today

9-17-76

Department of Building & Safety
City of Las Vegas, Nevada

Special Kardex
Elec. only, Plbg. only, A.C. only

Owner _____ Address 1412 E. McWilliams Date: 3/30/76
Contractor _____ Permit No. _____
Lot _____ Block _____ Subdivision _____

Electric Only	Plumbing Only	Heat & Vent. A. C. Only
Contractor _____	Contractor <u>Vegas Valley Water</u>	Contractor _____
Permit No. _____	Permit No. <u>1045</u>	Permit No. _____
Slab _____	Rough Soil _____	A.C. Rough Duct _____
Rough Elect _____	Rough Water _____	Ref. Ro. Piping _____
Final Rough _____	Top Out _____	Rough Gas _____
Final Fixture _____	Rough Gas _____	Final Refrig _____
Final Elec _____	Final Plbg. _____	Final Air Cond _____
Temp. Service _____	Final Gas _____	Final Gas _____
	Final Sewer _____	
	Final Septic Tank _____	

23.06 D Address 1412 E. McWilliams Log # Softener Area _____

DEPT. of BLDG. & SAFETY - CITY of LAS VEGAS, NEVADA
OWNER Barbara Ullom ADDRESS 1412 E. McWilliams DATE 1-21-76
GEN. CONT. Owner
PERMIT NO. 272 TYPE OF STRUCTURE Carpport enc, addn
LEGAL DESCRIPTION L 137 B 12 Greater L.V. Add Tract # 2

BUILDING	MECHANICAL	ELECTRICAL
Investigation _____	Plumbing Cont. _____	Temp. pole cont. _____
Location & Footing <u>RP 1-2-76</u>	Permit No. _____ Date _____	Permit No. _____ Date _____
Stem Wall _____	Heat & Vent. A/C Cont. _____	Inspection _____ Date _____
Concrete Slab Floor _____	Permit No. _____ Date _____	Electrical Cont. <u>MR cad</u>
Floor Framing _____	Sewer Cont. _____	Permit No. <u>395</u> Date <u>2/12/76</u>
Fireplace Footing _____	Permit No. _____ Date _____	Fixtures Cont. _____
Chimney Steel _____	Rough Soil _____	Permit No. _____ Date _____
Vert. Steel Reinf. _____	Rough Water _____	Slab _____
Horiz. Steel Reinf. _____	Top Out _____	Rough _____
Roof Sheathing <u>RP 2-17-76</u>	Rough Gas _____	Final Rough <u>RP 2-18-76</u>
Framing <u>RP 2-18-76</u>	A/C Rough Duct _____	Final Fixture _____
Backing for siding _____	Ref. Rough Piping _____	Final Electrical <u>VP 9-1-76</u>
Ext. Lath <u>HB 2-20-76</u>	Final Plumbing _____	Temporary Service _____
Ext. Scratch <u>HB 2-23-76</u>	Final Gas <u>W 2-18-76</u>	MISCELLANEOUS
Ext. Brown <u>RP 2-26-76</u>	Final Air Cond. <u>W 2-23-76</u>	Grading & Drainage _____
Int. Lath _____	Final Refrig. _____	On-Site Parking Spaces _____ App. _____
Int. Brown _____	Final Sewer _____	Eng. Approval of _____
Drywall <u>HB 2-24-76</u>	Final Septic Tank _____	Off-Site Improvements _____
Permit No. _____		
Final Building _____		
Appr. for Occu. _____		

INSPECTOR: _____ DATE _____

APPROVED FOR OCCUPANCY & METER _____

PLEASE NOTE REMARKS ON REVERSE SIDE 1412 E. McWilliams LOG # _____ AREA # _____

Done Today 9-17-72

DEPT. of BLDG. & SAFETY - CITY of LAS VEGAS, NEVADA

OWNER Barbara Ullom ADDRESS 1412 E. McWilliams DATE 2-18-76
 GEN. CONT. Owner TYPE OF STRUCTURE Fireplace
 PERMIT NO. 693 LEGAL DESCRIPTION L 137 B 12 Greater Las Vegas

BUILDING	MECHANICAL	ELECTRICAL
Investigation	Plumbing Cont.	Temp. pole cont.
Location & Footing	Permit No. _____ Date _____	Permit No. _____ Date _____
Stem Wall	Heat & Vent. A/C Cont.	Inspection _____ Date _____
Concrete Slab Floor	Permit No. _____ Date _____	Electrical Cont.
Floor Framing	Sewer Cont.	Permit No. _____ Date _____
Fireplace Footing	Permit No. _____ Date _____	Fixtures Cont.
Chimney Steel	Rough Soil	Permit No. _____ Date _____
Vert. Steel Reinf.	Rough Water	Slab _____
Horiz. Steel Reinf.	Top-Out _____	Rough _____
Roof Sheathing	Rough Gas _____	Final Rough _____
Framing	A/C Rough Duct _____	Final Fixture _____
Backing for siding	Ref. Rough Piping _____	Final Electrical _____
Ext. Lath	Final Plumbing _____	Temporary Service _____
Ext. Scratch	Final Gas _____	MISCELLANEOUS
Ext. Brown	Final Air Cond. _____	Grading & Drainage _____
Int. Lath	Final Refrig. _____	On-Site Parking Spaces _____ App. _____
Int. Brown	Final Sewer _____	Eng. Approval of _____
Drywall	Final Septic Tank _____	Off-Site Improvements _____
Permit No. _____		
Final Building		
Appr. for Occu.		

INSPECTOR: _____ DATE _____

APPROVED FOR OCCUPANCY & METER _____

PLEASE NOTE REMARKS ON REVERSE SIDE 1412 E. McWilliams LOG # _____ AREA # _____

DEPARTMENT OF BUILDING & SAFETY
CITY OF LAS VEGAS, NEVADA

KARDEX CARD
FENCE & RETAINING
WALLS

OWNER Philip Ullom ADDRESS 1412 E. McWilliams DATE 10-6-75

CONTRACTOR Owner PERMIT NO. 4365

LOT _____ BLOCK _____ SUBDIVISION block fence

Fence (wire, wood, etc.)	Walls (masonry, rock, etc.)
Location _____	Location _____
Final Inspection _____	Footing _____
	Wall Steel 1st <u>10/1-3</u> 2d _____ 3d _____
	Final Inspection _____
Retaining Wall (masonry)	Retaining Wall (concrete)
Location _____	Location _____
Footing _____	Footing _____
Wall Steel 1st _____ 2d _____ 3d _____	Wall Steel 1st _____ 2d _____ 3d _____
Bond Beam 1st _____ 2d _____ 3d _____	Final Inspection _____
Final Inspection _____	

23.14 B ADDRESS _____ LOG NO. _____ AREA _____

1412 E. McWilliams

Done Today (9-17-62

Department of Building & Safety
City of Las Vegas, Nevada

Special Kardex
Elect. only-Plbg: only-A.C. only

Owner EARL SORENSON Address 1112 MCWILLIAMS Date 11-5-61
Contractor GIFFORD ELECTRIC Permit No. 18492
Lot _____ Block _____ Subdivision _____

Electric Only	Plumbing Only	Heat & Vent. A.C. Only
Contractor _____	Contractor _____	Contractor _____
Permit No. _____	Permit No. _____	Permit No. _____
Slab _____	Rough Soil _____	A.C. Rough Duct _____
Rough Elect. _____	Rough Water _____	Ref. Ro. Piping _____
Final Rough _____	Top Out _____	Rough Gas _____
Final Fixture _____	Rough Gas _____	Final Refrig _____
Final Elect. <u>Permit 1-1-62</u>	Final Plbg _____	Final Air Cond _____
Temp. Service _____	Final Gas _____	Final Gas _____
	Final Sewer _____	
	Final Septic Tank _____	

23.06 D Address 1112 Mc Williams Log No. _____ Area Elec only

Done Tuesday 9-17-62

Department of Building & Safety
City of Las Vegas, Nevada

Special Kardex
Elect. only-Plbg: only-A.C. only

Owner EARL SORENSON Address 1112 MCWILLIAMS Date 11-5-61

Contractor GIFFORD ELECTRIC Permit No. 18492

Lot _____ Block _____ Subdivision _____

Electric Only	Plumbing Only	Heat & Vent. A.C. Only
Contractor _____	Contractor _____	Contractor _____
Permit No. _____	Permit No. _____	Permit No. _____
Slab _____	Rough Soil _____	A.C. Rough Duct _____
Rough Elect. _____	Rough Water _____	Ref. Ro. Piping _____
Final Rough _____	Top Out _____	Rough Gas _____
Final Fixture _____	Rough Gas _____	Final Refrig. _____
Final Elect. <u>Quintessence 7-14-65</u>	Final Plbg. _____	Final Air Cond. _____
Temp. Service _____	Final Gas _____	Final Gas _____
	Final Sewer _____	
	Final Septic Tank _____	

23.06 D Address 1112 Mc Williams Log No. _____ Area Elec only