

6221 Littlewater Lane

L45 B9 Kings^{way}~~way~~ Est#4 Zone R-1

15-70
H. Gatewood 10-3-79

CITY OF LAS VEGAS, NEVADA

LOG NO. & AREA T32-3

CONST. VAL. \$ 42428

DEPARTMENT OF PUBLIC SERVICES
DIVISION OF BUILDING AND SAFETY

APPLICATION & BUILDING PERMIT - for:
Dwellings, Duplexes, Misc. Residential Const.

ADDRESS OF CONSTRUCTION 6221 Littlewater Lane

OWNER Chism Homes, Inc.

LOT(s) 45 - BLOCK 9 SUBDIVISION Kingswood Estates #4 ZONE R-1

Existing structure on lot: Dwelling Accessory Bldg. Vacant Lot Other

PROPOSED CONSTRUCTION: S.F. Dwelling w/F.P. USE: Resident

MATERIALS OF CONSTRUCTION: Wood Frame Concrete Block Reinforced Concrete Steel Frame

SQUARE FEET OF FLOOR AREAS: 1st 969 2nd 882 3rd Deck 32 Other 448 TOTAL SQ. FT. 2299

FIRE ZONE: 3 Occupancy Group R-3 & M1 CONST. TYPE: V-N

ARCHITECT: _____ ENGINEER: _____ NO. of UNITS 1 NO. of STORIES 2

Plans Submitted: Yes No Calculations Submitted: Yes No Sewer Fee Req'd: Yes No

CONTRACTOR: Chism Homes, Inc. STATE LICENSE # 7834 CITY LICENSE # G-11-466-2-04918

ADD'L. PERMITS REQ'D.: Air Cond. Elec. Plumbing Signs Paving Fence Public Walks Curb-gutters
Incinerators Fire Sprinkling System

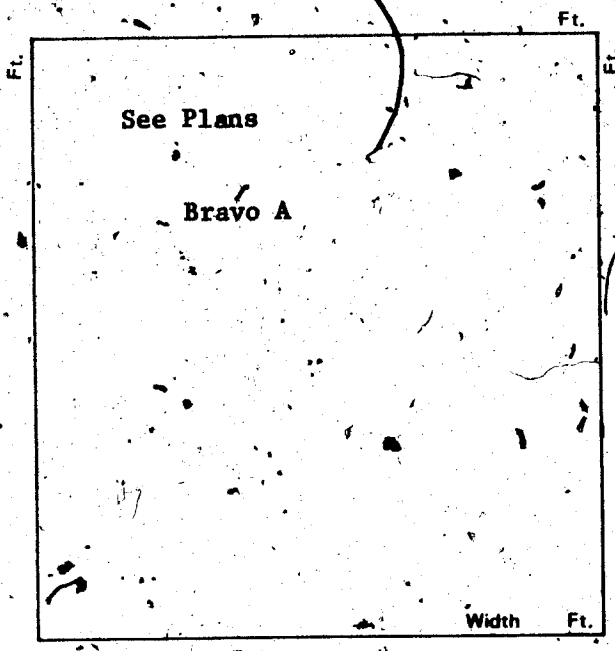

CONDITIONS OF THE PERMIT:

- I agree to call the City Building Department for inspections before concrete is poured, before rough wiring, electrical, plumbing, framing is covered. Also for Air conditioning, drywall and sheathing inspection.
- I agree that when the job is completed that I will call for final inspection before occupancy.
- I agree to perform all construction in accordance with City Ordinances and Building Codes.
- The Contractor's signature below denotes authority from the owner to sign in his behalf and that the owner is aware of all requirements of this application and permit. Separate permits must be taken out for work outlined above this agreement.
- I have read and understand the contents of this application and permit; I hereby state that the information I have supplied on this application is true and correct.

Approval for the work under this permit will be given only after refuse and debris have been removed from job site and public right of way.

SIGNED: Chism Homes, Inc. Contractor

BY: Donald K. Chism Agent or Owner

PLANNING DEPT.: _____ Date: 5/12/78

PUBLIC WORKS DEPT.: Charles Judd Date: 5/12/78

BUILDING DIVISION: BCA Date: 5-17-78

PERMIT NO.: 6436-46 3/4 PERMIT FEE \$ 166

154-01-220

RECEIPT

MUST BE MACHINE VALIDATED

A Gatewood 10-3-79

CITY OF LAS VEGAS, NEVADA

DEPARTMENT OF BUILDING & SAFETY - APPLICATION AND PERMIT FOR PLUMBING

ADDRESS OF CONSTRUCTION: **6221 Littlewater Lane** OWNER'S NAME: **Chism Homes, Inc.**

CIRCLE: New Bldg.; Add'n.; Remodel; TYPE OF BLDG.: SFD. APT. PUBLIC COMM.

CONTRACTOR'S NAME: **Sunrise Plumbing, Inc.** STATE LICENSE # **12672A** CITY LICENSE # **13790** C11 902-2-

UNIT'S	DESCRIPTION	FEE	TOTAL
1	Bathtub	1.00	1.00
1	Shower	1.00	1.00
3	Lavatory	1.00	3.00
3	Toilet	1.00	3.00
	Urinal	1.00	
	Floor Drain	1.00	
	Floor Sink	1.00	
	Wash Tray	1.00	
1	Sink	1.00	1.00
1	Garbage Disposal	1.00	1.00
	Garbage Disposal (comm.)	3.00	
1	Clothes Dryer (gas)	1.00	1.00
1	Clothes Washer	1.00	1.00
	Clothes Washer (comm.)	5.00	
1	Dishwasher	1.00	1.00
	Dishwasher (commercial)	5.00	
	Dental Unit	10.00	
	Drinking Fountain	1.00	
	Any Water using Equipment	1.00	
1	Water Heater (gas) (elect.)	1.00	1.00
1	Sewer System - New, Replacement, or any Drainage System	4.00	4.00
	Grease or Sand Trap	2.00	
	Trailer Trap	2.00	
	Septic Disposal System	4.00	
WATER SOFTENERS			
	Nonpermanent Type	4.00	
	Permanent Type (connected to Drainage)	5.00	
SWIMMING POOLS			
	Private or Wading Pool	10.00	
	Public or Semi-public	20.00	

UNITS	DESCRIPTION	FEE	TOTAL
WATER DISTRIBUTION SYSTEM			
1	Single Family Dwelling	4.00	4.00
	Multiple Family Dwelling plus each unit	4.00	
	Bldg. Group "A" thru "G" per each floor	6.00	
	Hotel or Motel plus each bath	4.00	
	Trailer Park plus each space	1.50	
	Irrigation	20.00	
		1.00	
		4.00	
GAS PIPING SYSTEM			
1	Single Family Dwelling	3.00	3.00
	Multiple Family Dwelling plus each unit	6.00	
	Commercial Bldg. per floor plus each unit	1.00	
		3.00	
		3.00	
4	Gas Appliance (any type)	1.00	4.00
AUTOMATIC FIRE EXTINGUISHING SYSTEM			
	Underground Piping	10.00	
	Distribution Piping ea. ft.	.01	
	Sprinkler, Head each	.10	
	In Range Hood and Vent	5.00	
DRY STANDPIPE SYSTEM			
	Piping	50.00	
	Each Outlet	1.00	
WET STANDPIPE SYSTEM			
	Piping	5.00	
	Fire Hose Cabinet	1.00	
MINIMUM PERMIT FEE			
PIPELINE CONTRACTOR SECT. 14-B.P.F. \$		4.00	
TOTAL PERMIT FEE \$			29.00

I hereby certify that I have carefully examined and read the above application; that the same is true and correct; and that the work herein described is to be done in accordance with all the provisions of the applicable Ordinances of the City of Las Vegas, Nevada and the State Laws, whether herein specified or not.

Approval for the work under this permit will be given only after refuse and debris have been removed from job site and public right of way.

Signed: Richard P. Edwards Date: _____
Registered Master Plumber, Spec. Cont'r. or Owner

Building Department: MM Date: 7-5-78

Permit No. 7694-34 Permit Fee \$ 29.00

#12870

RECEIPT

MUST BE MACHINE VALIDATED

A. Waterwood 10-8-79

CITY OF LAS VEGAS, NEVADA

DEPARTMENT OF PUBLIC SERVICES - AIR-CONDITIONING APPLICATION & PERMIT DIVISION OF BUILDING AND SAFETY

ADDRESS OF CONSTRUCTION: 6221 LITTLEWATER LANE

OWNER'S NAME: CHISM HOMES

CIRCLE: Addition; Remodel; New Bldg. TYPE OF BLDG. RESID. APT. COMM. PUBLIC

CARL'S AIR CONDITIONING AND SHEET METAL INC.

STATE LICENSE # 8370-B

CITY LICENSE # 2302-2-10793

UNITS	DESCRIPTION	FEE	TOTAL	UNITS	DESCRIPTION	FEE	TOTAL
	Unit heater - floor, wall or suspended	4.00			EVAPORATIVE COOLERS:		
	FOR EACH FORCED-AIR OR GRAVITY-TYPE FURNACE OR BURNER INCLUDING DUCTS AND VENT ATTACHED TO SUCH APPLIANCES:				5 outlets or under	3.00	
	Up to and including 100,000 B.t.u.'s	4.00			Over 5 and up to and including 10	5.00	
	Over 100,000 B.t.u.'s	6.00			Each additional outlet over 10	.25	
	FOR EACH HEATING APPLICATION, REFRIGERATION UNIT, COMFORT COOLING AND HEATING UNIT, ABSORPTION UNIT, COMPRESSOR OR BOILER:				VENTILATION:		
	Up to and including 3 ton or 3 horsepower, or absorption system up to and including 100,000 B.t.u.'s	4.00		2	For each fan connected to a single duct	1.00	2.00
1	Over 3 ton or 3 horsepower up to and including 10, or absorption system over 100,000 B.t.u.'s up to and including 250,000 B.t.u.'s	7.00	7.00		For each commercial or industrial ventilation system	5.00	
	Over 10 ton or 10 horsepower up to and including 30, or absorption system over 250,000 B.t.u.'s up to and including 1,000,000 B.t.u.'s	12.00			For each commercial kitchen hood	5.00	
	Over 30 ton or 30 horsepower up to and including 50, or absorption system over 1,000,000 B.t.u.'s up to and including 1,700,000 B.t.u.'s	20.00			MISCELLANEOUS:		
	Over 50 ton or 50 horsepower, or absorption system over 1,700,000 B.t.u.'s	30.00			For each water cooling tower	8.00	
	FOR EACH AIR HANDLING UNIT INCLUDING DUCTS ATTACHED THERETO:			12	Duct work only - each opening	.25	3.00
	Up to and including 10,000 CFM	2.00			For installation or relocation of each commercial or industrial incinerator	15.00	
	Over 10,000 CFM	4.00			Gas piping related to the air cond. work in single family dwelling only	3.00	
					For each appliance, piece of equipment, any mechanical work or alteration or replacement not included in this schedule, the permit fee shall be computed the same as building permit fees by using the cost of installation for the valuation amount.		
					FOR THE ISSUANCE OF EACH PERMIT		3.00
					TOTAL PERMIT FEE \$15.00		

I hereby certify that I have carefully examined and read the above application; that the same is true and correct; and that the work herein described is to be done in accordance with all the provisions of the applicable Ordinances of the City of Las Vegas, Nevada and the State Laws, whether herein specified or not.

Approval for the work under this permit will be given only after refuse and debris have been removed from job site and public right of way.

SIGNED Carl Butcher/kb Date 10-14-78
Air Conditioning Contractor - Owner

BUILDING DIVISION [Signature] Date 8-7-78

PERMIT NO. 8541-2 PERMIT FEE \$ 15.00

#12890

RECEIPT

MUST BE MACHINE VALIDATED

L. H. Gatewood 10-3-79

CITY OF LAS VEGAS, NEVADA

DEPARTMENT OF PUBLIC SERVICES—ELECTRICAL APPLICATION & PERMIT
DIVISION OF BUILDING AND SAFETY

ADDRESS OF CONSTRUCTION: 6221 Littlewater OWNER'S NAME: Chism Homes

CIRCLE: (New Bldg.) Add'n; Remodel; TYPE OF BLDG: SFD APT: PUBLIC COMM.

CONTRACTOR'S NAME: Electrical Systems STATE LICENSE # 14718 CITY LICENSE # 14422

NUMBER	FIXTURE OR INSTALLATION	UNIT PRICE	TOTAL
	Rm addition, carport or garage enclosure	4.00	
	Temporary power	4.00	
40	Light, receptacle or switch outlet	.20	8.00
	Wall or ceiling space heater	.35	
1	Garbage grinder outlet	.35	.35
1	Dishwasher outlet	.35	.35
1	Clothes dryer outlet	.35	.35
1	Automatic clothes washer	.35	.35
	Electric range outlet	.35	
	Electric water heater outlet	.35	
	Special purpose outlet	.35	
	X-ray unit and its appurtenances	5.00	
	Watts of festoon lighting (Watts) First 2,000 watts for each additional thousand watts	4.00 1.50	
	Horsepower each motor first horsepower or less for each additional horsepower	1.75 .35	
1	Electric service (including any single meter socket) for each additional socket	1.00 ELEC \$ 97.30	
1	Air conditioning service	3.00 311 \$ 97.30	
	Each KW(KVA) Generator (Transformer, Welder) First 100 KVA for each additional KW(KVA)	TOTL \$ 97.30 CHK \$ 97.30	
	Speaker, signal or alarm outlet	NO 0410 SR#001/01	
	Amplifiers	CITY 15 LAS VEGAS	
	Control panels	BLDG & SAFETY	
	Main control racks	10/25/78	
	T.V. and radio antennas-master system only	.75	
	Minimum fee for any permit	4.00	
	TOTAL FEE		13.90

Approval for the work under this permit will be given only after refuse and debris have been removed from job site and public right of way.

I hereby certify that I have carefully examined and read the above application; that the same is true and correct; and that the work herein described is to be done in accordance with all the provisions of the applicable Ordinances of the City of Las Vegas, Nevada and State laws whether herein specified or not.

SIGNED George D. Miller DATE 10/24/78
 MASTER (ELECTRICIAN) (TECHNICIAN) (OWNER)

BUILDING DIVISION: B.D. DATE 10-25-78

PERMIT NO. 10440 PERMIT FEE: \$ 13.90

RECEIPT

MUST BE MACHINE VALIDATED

H. Waters 10-3-79

10-17

CITY OF LAS VEGAS, NEVADA

LOG NO. & AREA _____

CONST. VAL. \$ 225

DEPARTMENT OF PUBLIC SERVICES
DIVISION OF BUILDING & SAFETY

APPLICATION & BUILDING PERMIT - for:
Fence, Wall, Retaining Wall.

ADDRESS OF CONSTRUCTION: 6221 Little Water

OWNER: CHISIM

LOT(S) 45 BLOCK 9 SUBDIVISION 14 WOODWOOD ESTATES # 9 ZONE: R-1

Materials of Construction: Block Concrete Wire Wood Other

PLANS: Yes No

ARCHITECT: _____

ENGINEER: _____

CALCS: Yes No

CONTRACTOR: G. STRAIN

STATE LICENSE # 13399

CITY LICENSE # CI-15319

TOTAL SQUARE FEET: 150

TOTAL LINEAL FEET: 25

Remarks:

CONDITIONS OF THE PERMIT:

1. Any type of retaining wall must be engineered by a Civil or Structural Engineer.
2. If a home owner takes out the Building Permit and if the owner sublets the work to a Contractor, then the Contractor must take out the permit and pay for it.
3. No fence or wall can be built on City property or rights-of-way, but this is not intended to preclude construction within utility easements if utilities will not be damaged or made inaccessible.
4. The fence or wall shall not enclose any water meter, fire standard, or fire alarm box and shall not come closer than 24" from the nearest fire hydrant outlet.
5. Department Inspectors must approve footings before concrete is poured and block wall reinforcing before grouting is done.
6. Maximum height of any wall or fence is 6' side and rear yards; 4' maximum in front yard with the vertical surface above the height of 2' - 50% open.
7. I must not obstruct required onsite parking space (2 spaces for each dwelling unit) by the erection of this fence or wall.
8. By the signing of this application I herewith agree to the requirements outlined above.

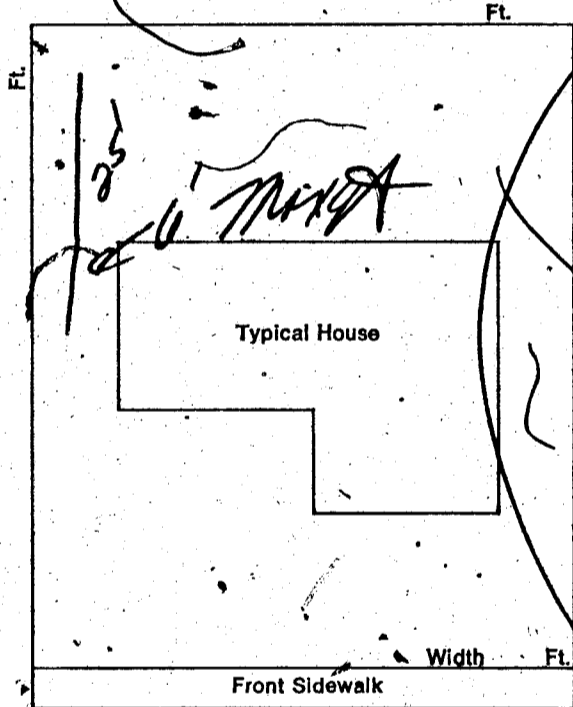

SIGNED: Pete Strain
CONTRACTOR AGENT

1 DEN	\$.00
WALL	\$	5.00
WOOD	\$	5.00
WALL	\$	5.00
CITY	\$	15.00
TOTL	\$	15.00
CASH	\$	15.00

PLANNING DEPT: _____

Date: 11/9-78

PUBLIC WORKS DEPT: _____

Date: 11/9/78

BUILDING DIVISION: _____

Date: 11/9/78

#12850

PERMIT NO: 10798

PERMIT FEE \$ 500

#0798 SR 502/01
CITY - LAS VEGAS
BLDG. & SAFETY
11/09/78

MUST BE MACHINE VALIDATED

Dona Healy P-25-82

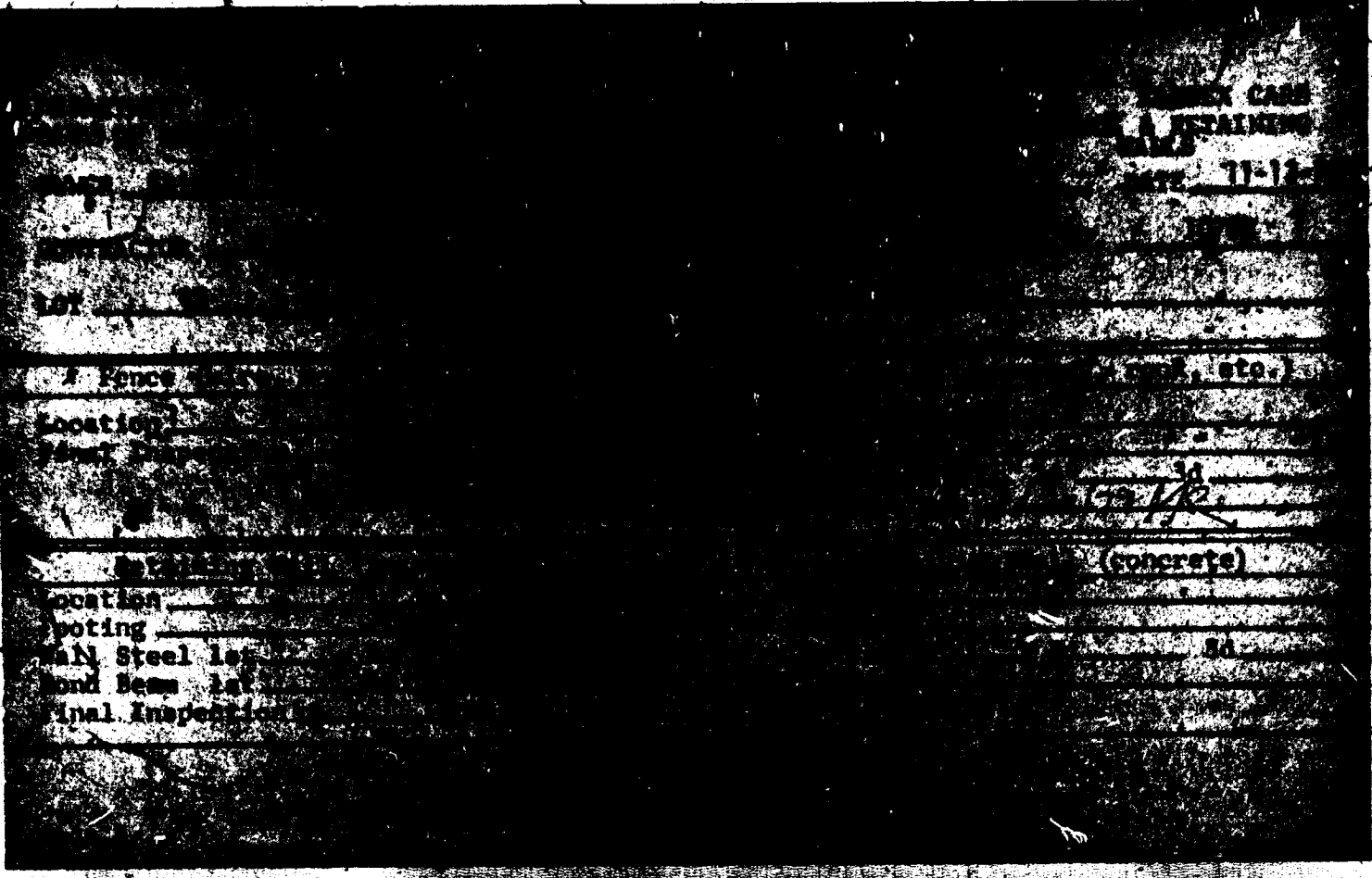

OWNER: **CHISM HOMES INC.** ADDRESS: **6221 Littlewater Lane** DATE: **5/18/78**
 GEN. CONT: **Same** TYPE OF STRUCTURE: **S.F. Dwelling w/F.P.**
 PERMIT NO.: **6436-46** LEGAL DESCRIPTION: **Kingswood Estates 4**

BUILDING	MECHANICAL	ELECTRICAL
Investigation	Plumbing Cont. <i>Chunrise</i>	Temp. pole cont.
Location & Footing <i>1206-2-78</i>	Permit No. <i>7694-34</i> Date <i>7-5-78</i>	Permit No. _____ Date _____
Stem Wall	Heat & Vent. A/C Cont. <i>Carl</i>	Inspection _____ Date _____
Concrete Slab Floor <i>R.P. 8-2-78</i>	Permit No. <i>8511-2</i> Date <i>8-2-78</i>	Electrical Cont. <i>Erica Sypinski</i>
Floor Framing	Sewer Cont. CHISM HOMES INC.	Permit No. <i>10440</i> Date <i>1-25-78</i>
Fireplace Footing	Permit No. 6435 Date _____	Fixtures Cont. _____
Chimney Steel	Rough Soil <i>Mc 2-18-78</i>	Permit No. _____ Date _____
Vert. Steel Reinf. <i>JK 11-4-78</i>	Rough Water _____	Slab _____
Horiz. Steel Reinf. <i>JK 11-4-78</i>	Top-Out <i>Mc 6-18-78</i>	Rough <i>Curie 1-8-78</i>
Roof Sheathing <i>M 7-10-3-78</i>	Rough Gas <i>Mc 10-18-78</i>	Final Rough _____
Framing <i>M 11-1-78</i>	A/C Rough Duct <i>Mc 10-18-78</i>	Final Fixture _____
Backing for Siding	Ref. Rough Piping _____	Final Electrical <i>Jg 1-16-79</i>
Ext. Lath <i>JK 11-8-78</i>	Final Plumbing <i>Mc 1-24-79</i>	Temporary Service _____
Ext. Scratch	Final Gas <i>Mc 1-24-79</i>	MISCELLANEOUS
Ext. Brown <i>M 12-26-78</i>	Final Air Cond. <i>Mc 1-24-79</i>	Grading & Drainage _____
Int. Lath	Final Refrig. _____	On-Site Parking Spec. _____ App. _____
Int. Brown	Final Sewer _____	Eng. Approval of _____
Drywall <i>JK 11-17-78</i>	Final Septic Tank _____	Off-Site Improvements _____
Insulation		
Final Building <i>JK 1-25-79</i>		
Appr. for Occu. <i>J</i>		

INSPECTOR: _____ DATE: _____
 APPROVED FOR OCCUPANCY & METER: *JK 1-25-79*

PLEASE NOTE REMARKS ON REVERSE SIDE 6221 Littlewater Lane LOG # _____ AREA # _____ 76-114

Dona Hovely 9-23-82

ELEC. ONLY, PLBG. ONLY, A.C. ONLY		
OWNER <i>Jim Ross</i>	DATE <i>3/11/79</i>	
ADDRESS <i>6221 Litter Water</i>		
CONTRACTOR <i>Danneberger</i>	PERMIT NO. <i>2283-15</i>	FINAL INSPECTION
LOT	BLOCK	SUBDIVISION
LOG NO.	AREA	
ELECTRIC ONLY		PLUMBING ONLY
Contractor	Contractor <i>Danneberger</i>	
Permit No.	Permit No. <i>2283-15</i>	
Rough Elec.	Rough Soil	
Final Rough	Rough Water	
Final Elec.	Top Out	
Temp. Service	Rough Gas	
HEAT & VENT. A/C ONLY	Final Plbg. <i>MOB-1779</i>	
Contractor	Final Gas	
Permit No.	Sewer Final	
A/C Rough Duct	<i>Water Softner</i>	
Rough Gas		
Final A/C		
Final Gas		
2-1-30	DIV. OF BLDG. & SAFETY CITY OF LAS VEGAS REV. 10-78	E-Z-WAY SYSTEMS NEWARK OH 43055 LITHO IN U.S.A.