

208 Lightning St

L7 B7 Char Rainbow 12-D Zone R-1

H. Hesterwood 9-28-79

CITY OF LAS VEGAS, NEVADA

LOG NO. & AREA T-10-4
DEPARTMENT OF BUILDING & SAFETY

CONST. VAL. \$ 34440

APPLICATION & BUILDING PERMIT — for:
Dwellings, Duplexes, Misc. Residential Const.

ADDRESS OF CONSTRUCTION: 208 Lightning Street

OWNER: Sproul Homes of Nevada

LOT(s) 9 BLOCK 7 SUBDIVISION Charleston Rainbow Unit No. 12-D ZONE 1

Existing structure on lot: Dwelling Accessory bldg. Vacant lot Other

PROPOSED CONSTRUCTION: Single Family Dwelling USE: Same

MATERIALS OF CONSTRUCTION: Wood Frame Concrete Block Reinforced Concrete Steel Frame

SO. FEET OF FLOOR AREAS: 1st 1482 2nd _____ 3rd _____ Other 480 TOTAL SQ. FT. 1962

RE ZONE: 1 3 Occupancy Group 1-2 CONST. TYPE I II III IV V

ARCHITECT: _____ ENGINEER: _____ NO. of UNITS 1 NO. of STORIES 1

Plans Submitted: Yes No Calculations Submitted: Yes No Sewer Fee Req'd. Yes No

CONTRACTOR: Sproul Homes of Nevada STATE LICENSE # 60118 CITY LICENSE # 6427

ADD'L. PERMITS REQ'D: Air Cond. Elec. Plumbing Signs Paving Fence Public Walks Curb-gutters
Incinerators Fire Sprinkling System

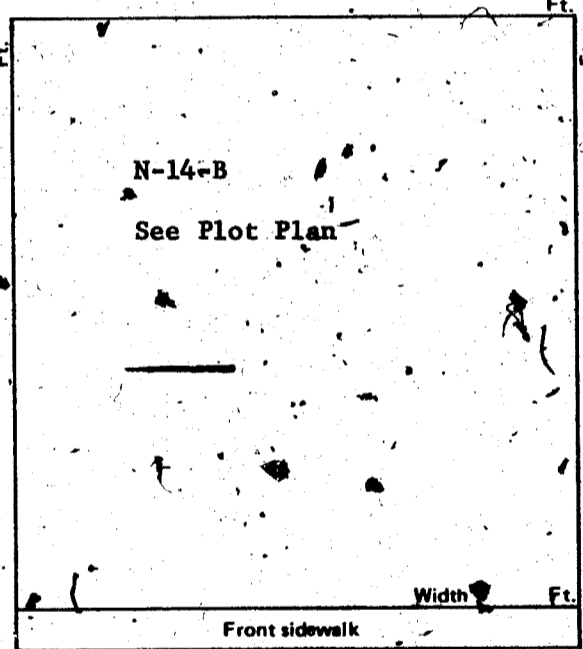

CONDITIONS OF THE PERMIT:

1. I agree to call the City Building Department for inspections before concrete is poured, before rough wiring, electrical, plumbing, framing is covered. Also for air conditioning, sheet-rock and sheathing inspection.
2. I agree that when the job is completed that I will call for final inspection before occupancy.
3. I agree to perform all construction in accordance with City Ordinances and Building Codes.
4. The Contractor's signature below denotes authority from the owner to sign in his behalf and that the owner is aware of all requirements of this application and permit. Separate permits must be taken out for work outlined above this agreement.
5. I have read and understand the contents of this application and permit. I hereby state that the information I have supplied on this application is true and correct.

Approval for the work under this permit will be given only after refuse and debris have been removed from job site and public right of way.

SIGNED: SPROUL HOMES OF NEVADA Contractor

BY: [Signature] Agent or Owner

CLARK COUNTY HEALTH DEPT. Date _____

LAS VEGAS FIRE DEPARTMENT Date _____

PLANNING DEPT.: [Signature] Date: 3/20/76

PUBLIC WORKS DEPT.: [Signature] Date: 3-17-76

BUILDING DEPT.: [Signature] Date: 3-23-76

12850 PERMIT NO.: 1392 PERMIT FEE \$ 131.00

RECEIPT
8780 \$131.00

CITY OF LAS VEGAS
DEPT. OF BUILDING & SAFETY

MUST BE MACHINE VALIDATED
24 MAR 76

H. Hesterwood 9-28-79

CITY OF LAS VEGAS, NEVADA

LOG NO. & AREA T-10-4 DEPARTMENT OF BUILDING & SAFETY CONST. VAL. \$ 34440

APPLICATION & BUILDING PERMIT — for: Dwellings, Duplexes, Misc. Residential Const.

ADDRESS OF CONSTRUCTION: 208 Lightning Street OWNER: Sproul Homes of Nevada

LOT(s) 9 BLOCK 7 SUBDIVISION Charleston Rainbow Unit No. 12-D ZONE 1

Existing structure on lot: Dwelling Accessory bldgs. Vacant lot Other

PROPOSED CONSTRUCTION: Single Family Dwelling USE: Same

MATERIALS OF CONSTRUCTION: Wood Frame Concrete Block Reinforced Concrete Steel Frame

SQ. FEET OF FLOOR AREAS: 1st 1482 2nd _____ 3rd _____ Other 480 TOTAL SQ. FT. 1962

FIRE ZONE: 1 3 Occupancy Group 1 2 _____ CONST. TYPE I II III IV V

ARCHITECT: _____ ENGINEER: _____ NO. of UNITS 1 NO. of STORIES 1

Plans Submitted: Yes No Calculations Submitted: Yes No Sewer Fee Req'd.: Yes No

CONTRACTOR: Sproul Homes of Nevada STATE LICENSE # 60118 CITY LICENSE # 6427

ADD'L. PERMITS REQ'D: Air Cond. Elec. Plumbing Signs Paving Fence Public Walks Curb-gutters Incinerators Fire Sprinkling System

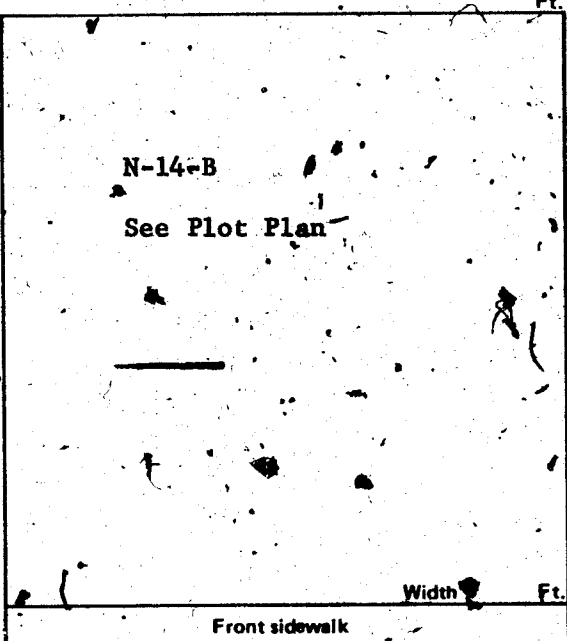

CONDITIONS OF THE PERMIT:

- 1. I agree to call the City Building Department for inspections before concrete is poured, before rough wiring, electrical, plumbing, framing is covered. Also for air conditioning, sheet-rock and sheathing inspection.
2. I agree that when the job is completed that I will call for final inspection before occupancy.
3. I agree to perform all construction in accordance with City Ordinances and Building Codes.
4. The Contractor's signature below denotes authority from the owner to sign in his behalf and that the owner is aware of all requirements of this application and permit. Separate permits must be taken out for work outlined above this agreement.
5. I have read and understand the contents of this application and permit; I hereby state that the information I have supplied on this application is true and correct.

Approval for the work under this permit will be given only after refuse and debris have been removed from job site and public right of way.

SIGNED: SPROUL HOMES OF NEVADA Contractor

BY: [Signature] Agent or Owner

CLARK COUNTY HEALTH DEPT. Date _____

LAS VEGAS FIRE DEPARTMENT Date _____

PLANNING DEPT.: [Signature] Date: 3/20/76

PUBLIC WORKS DEPT.: [Signature] Date: 3-17-76

BUILDING DEPT.: [Signature] Date: 3-23-76

12850 PERMIT NO.: 1392 PERMIT FEE \$ 131.00

RECEIPT 8780 \$131.00 CITY OF LAS VEGAS DEPT. OF BUILDING & SAFETY MUST BE MACHINE VALIDATED 24 MAR 76

H. H. H. 9-28-79

CITY OF LAS VEGAS, NEVADA
DEPARTMENT OF BUILDING & SAFETY

RECEIPT
FOR
SEWER CONNECTION FEE

JOB ADDRESS: 208 Lightning Street OWNER'S NAME: Sproul Homes of Nevada

LOT 9 BLOCK 7 SUBDIVISION Charleston Rainbow Unit No. 12-D

QUANTITY	OCCUPANCY	UNIT FEE	AMOUNT
1	Sewer Connection Fee for SED		\$150.00

PAID BY: _____

TOTAL \$150.00
 Less Credit* _____
 TOTAL FEE \$ 150.00

*Credit for existing sewer is applied to the new sewer connection fee based on previous type of occupancy and only when the new occupancy requires an additional fee.

This receipt does not authorize the owner or his representative to start any work without obtaining a plumbing permit.

NM
DEPARTMENT OF BUILDING & SAFETY

3-23-76
DATE

RECEIPT NO. 920 SEWER FEE \$ 150.00

73102

RECEIPT
 8745 \$150.00 - 3
 CITY OF LAS VEGAS
 DEPT. OF
 BUILDING & SAFETY
 MUST BE MACHINE VALIDATED
3-23-76

H. Gatewood 9-28-79

CITY OF LAS VEGAS, NEVADA

DEPARTMENT OF BUILDING & SAFETY - APPLICATION AND PERMIT FOR PLUMBING

ADDRESS OF CONSTRUCTION: 208 LIGHTNING ST OWNER'S NAME: SPROUT HOMES INC

CIRCLE: (New Bldg.) Add'n.; Remodel; TYPE OF BLDG. SFD APT. PUBLIC COMM.

CONTRACTOR'S NAME: UNITED PLUMBING STATE LICENSE # 1295 CITY LICENSE # 904

UNITS	DESCRIPTION	FEE	TOTAL
1	Bathtub	1.00	1-
1	Shower	1.00	1-
3	Lavatory	1.00	3-
2	Toilet	1.00	2-
	Urinal	1.00	
	Floor Drain	1.00	
	Floor Sink	1.00	
	Wash Tray	1.00	
1	Sink	1.00	1-
	Garbage Disposal	1.00	
	Garbage Disposal (comm.)	3.00	
	Clothes Dryer (gas)	1.00	
1	Clothes Washer	1.00	1-
	Clothes Washer (comm.)	5.00	
	Dishwasher	1.00	
	Dishwasher (commercial)	5.00	
	Dental Unit	10.00	
	Drinking Fountain	1.00	
	Any Water using Equipment	1.00	
1	Water Heater (gas) (elect.)	1.00	1-
	Sewer System—New, Replacement, or any Drainage System	4.00	
	Grease or Sand Trap	2.00	
	Trailer Trap	2.00	
	Septic Disposal System	4.00	
WATER SOFTENERS			
	Nonpermanent Type	4.00	
	Permanent Type (connected to Drainage)	5.00	
SWIMMING POOLS			
	Private or Wading Pool	10.00	
	Public or Semi-public	20.00	

UNITS	DESCRIPTION	FEE	TOTAL
WATER-DISTRIBUTION SYSTEM			
1	Single Family Dwelling	4.00	4-
	Multiple Family Dwelling plus each unit	4.00 2.00	
	Bldg. Group "A" thru "G" per each floor	6.00	
	Hotel or Motel plus each bath	4.00 1.50	
	Trailer Park plus each space	20.00 1.00	
	Irrigation	4.00	
GAS PIPING SYSTEM			
1	Single Family Dwelling	3.00	3-
	Multiple Family Dwelling plus each unit	6.00 1.00	
	Commercial Bldg. per floor plus each unit	3.00 3.00	
	Gas Appliance (any type)	1.00	
AUTOMATIC FIRE EXTINGUISHING SYSTEM			
	Underground Piping	10.00	
	Distribution Piping ea. ft.	.01	
	Sprinkler Head each	.10	
	In Range Hood and Vent	5.00	
DRY STANDPIPE SYSTEM			
	Piping	50.00	
	Each Outlet	1.00	
WET STANDPIPE SYSTEM			
	Piping	5.00	
	Fire Hose Cabinet	1.00	
MINIMUM PERMIT FEE 4.00			
PIPELINE CONTRACTOR, SECT. 14-B.P.F.S.			
TOTAL PERMIT FEE \$ 21.00			

I hereby certify that I have carefully examined and read the above application; that the same is true and correct, and that the work herein described is to be done in accordance with all the provisions of the applicable Ordinances of the City of Las Vegas, Nevada and the State Laws, whether herein specified or not.

Approval for the work under this permit will be given only after refuse and debris have been removed from job site and public right of way.

Signed: [Signature] Date: 3-15-76
 Registered Master Plumber, Spec. Contr. or Owner
 Building Department: [Signature] Date: _____
 Permit No. 992 Permit Fee \$ 21.00

#12870

RECEIPT
 8992 \$021.00 - 7
 CITY OF LAS VEGAS
 DEPT. OF BUILDING & SAFETY
 MUST BE MACHINE VALIDATED
 26 MAR 76

H. Gatewood 9-28-79

CITY OF LAS VEGAS, NEVADA

DEPARTMENT OF BUILDING & SAFETY - APPLICATION AND PERMIT FOR PLUMBING

ADDRESS OF CONSTRUCTION: 208 LIGHTNING ST OWNER'S NAME: SPROU HOMES INC

CIRCLE: (New Bldg.) Add'n.; Remodel; TYPE OF BLDG. (SFD) APT. PUBLIC COMM.

CONTRACTOR'S NAME: UNITED PLUMBING STATE LICENSE # 1295 CITY LICENSE # 904

UNITS	DESCRIPTION	FEE	TOTAL
1	Bathtub	1.00	1-
1	Shower	1.00	1-
3	Lavatory	1.00	3-
2	Toilet	1.00	2-
	Urinal	1.00	
	Floor Drain	1.00	
	Floor Sink	1.00	
	Wash Tray	1.00	
1	Sink	1.00	1-
	Garbage Disposal	1.00	
	Garbage Disposal (comm.)	3.00	
	Clothes Dryer (gas)	1.00	
1	Clothes Washer	1.00	1-
	Clothes Washer (comm.)	5.00	
	Dishwasher	1.00	
	Dishwasher (commercial)	5.00	
	Dental Unit	10.00	
	Drinking Fountain	1.00	
	Any Water using Equipment	1.00	
1	Water Heater (gas) (elect.)	1.00	1-
	Sewer System—New, Replacement, or any Drainage System	4.00	
1	Grease or Sand Trap	2.00	
	Trailer Trap	2.00	
	Septic Disposal System	4.00	
WATER SOFTENERS			
	Nonpermanent Type	4.00	
	Permanent Type (connected to Drainage)	5.00	
SWIMMING POOLS			
	Private or Wading Pool	10.00	
	Public or Semi-public	20.00	

UNITS	DESCRIPTION	FEE	TOTAL
WATER-DISTRIBUTION SYSTEM			
1	Single Family Dwelling	4.00	4-
	Multiple Family Dwelling plus each unit	4.00	
	Bldg. Group "A" thru "G" per each floor	2.00	
	Hotel or Motel plus each bath	6.00	
	Trailer Park plus each space	4.00	
	Irrigation	1.00	
GAS PIPING SYSTEM			
1	Single Family Dwelling	3.00	3-
	Multiple Family Dwelling plus each unit	6.00	
	Commercial Bldg. per floor plus each unit	1.00	
	Gas Appliance (any type)	3.00	
		1.00	
AUTOMATIC FIRE EXTINGUISHING SYSTEM			
	Underground Piping	10.00	
	Distribution Piping ea. ft.	.01	
	Sprinkler Head each	.10	
	In Range Hood and Vent	5.00	
DRY STANDPIPE SYSTEM			
	Piping	50.00	
	Each Outlet	1.00	
WET STANDPIPE SYSTEM			
	Piping	5.00	
	Fire Hose Cabinet	1.00	
MINIMUM PERMIT FEE			
PIPELINE CONTRACTOR; SECT. 14-B.P.F.		4.00	
TOTAL PERMIT FEE \$		210-	

I hereby certify that I have carefully examined and read the above application; that the same is true and correct; and that the work herein described is to be done in accordance with all the provisions of the applicable Ordinances of the City of Las Vegas, Nevada and the State Laws, whether herein specified or not.

Approval for the work under this permit will be given only after refuse and debris have been removed from job site and public right of way.

Signed: [Signature] Date: 3-15-76
 Registered Master Plumber, Spec. Cont'r. or Owner
 Building Department: [Signature] Date: _____
 Permit No. 992 Permit Fee \$ 210-

#12870

RECEIPT

8992 - \$021.00 - 7

CITY OF LAS VEGAS
 DEPT. OF BUILDING & SAFETY

MUST BE MACHINE VALIDATED

2 APR 76

H. Watson 9-28-79

CITY OF LAS VEGAS, NEVADA

DEPARTMENT OF BUILDING & SAFETY - AIR CONDITIONING APPLICATION & PERMIT

ADDRESS OF CONSTRUCTION: 208 Lightning Street OWNER'S NAME: Sproul Homes

CIRCLE: Addition; Remove; New Bldg; TYPE OF BLDG.: SFD APT. COMM. PUBLIC

CONTRACTOR'S NAME: Gearing Air Conditioning STATE LICENSE # 6058 CITY LICENSE # 7618

UNITS	DESCRIPTION	FEE	TOTAL	UNITS	DESCRIPTION	FEE	TOTAL
	Unit heater - floor, wall or suspended	4.00			EVAPORATIVE COOLERS:		
	FOR EACH FORCED-AIR OR GRAVITY-TYPE FURNACE OR BURNER INCLUDING DUCTS AND VENT ATTACHED TO SUCH APPLIANCES:				5 outlets or under	3.00	
	Up to and including 100,000 B.t.u.'s	4.00			Over 5 and up to and including 10	5.00	
	Over 100,000 B.t.u.'s	6.00			Each additional outlet over 10	.25	
	FOR EACH HEATING APPLICATION, REFRIGERATION UNIT, COMFORT COOLING AND HEATING UNIT, ABSORPTION UNIT, COMPRESSOR OR BOILER:				VENTILATION:		
	Up to and including 3 ton or horsepower, or absorption system up to and including 100,000 B.t.u.'s	4.00		2	For each fan connected to a single duct	1.00	2.00
1	Over 3 ton or 3 horsepower up to and including 10, or absorption system over 100,000 B.t.u.'s up to and including 250,000 B.t.u.'s	7.00	7.00		For each commercial or industrial ventilation system	5.00	
	Over 10 ton or 10 horsepower up to and including 30, or absorption system over 250,000 B.t.u.'s up to and including 1,000,000 B.t.u.'s	12.00			For each commercial kitchen hood	5.00	
	Over 30 ton or 30 horsepower up to and including 50, or absorption system over 1,000,000 B.t.u.'s up to and including 1,700,000 B.t.u.'s	20.00			MISCELLANEOUS:		
	Over 50 ton or 50 horsepower, or absorption system over 1,700,000 B.t.u.'s	30.00			For each water cooling tower	8.00	
	FOR EACH AIR HANDLING UNIT INCLUDING DUCTS ATTACHED THERETO:				Duct work only - each opening	.25	
	Up to and including 10,000 CFM	2.00			For installation or relocation of each commercial or industrial incinerator	15.00	
	Over 10,000 CFM	4.00			Gas piping related to the air cond. work in single family dwelling only	3.00	
					For each appliance, piece of equipment, any mechanical work or alteration or replacement not included in this schedule, the permit fee shall be computed the same as building permit fees by using the cost of installation for the valuation amount.		
					FOR THE ISSUANCE OF EACH PERMIT		3.00
					TOTAL PERMIT FEE \$		12.00

I hereby certify that I have carefully examined and read the above application; that the same is true and correct; and that the work herein described is to be done in accordance with all the provisions of the applicable Ordinances of the City of Las Vegas, Nevada and the State Laws, whether herein specified or not.

Approval for the work under this permit will be given only after refuse and debris have been removed from job site and public right of way.

SIGNED [Signature] Date 4-12-76
Air Conditioning Contractor - Owner

BUILDING DEPARTMENT [Signature] Date 4-22-76

PERMIT NO. 403 PERMIT FEE \$ 12.00

RECEIPT
552 \$012.00 - 4
CITY OF LAS VEGAS
DEPT. OF BUILDING & SAFETY
MUST BE MACHINE VALIDATED
22 APR 76

#12890

H. Hatedood 9-28-79

CITY OF LAS VEGAS, NEVADA

DEPARTMENT OF BUILDING & SAFETY - ELECTRICAL APPLICATION & PERMIT

ADDRESS OF CONSTRUCTION: 208 Lightning Street OWNER'S NAME: Sprout 12d

CIRCLE: New Bldg.; Add'n.; Remodel; TYPE OF BLDG.: BFD. APT. PUBLIC COMM.

CONTRACTOR'S NAME: Roberts Electric STATE LICENSE # 4528 CITY LICENSE # 3392

NUMBER	FIXTURE OR INSTALLATION	UNIT PRICE	TOTAL
	Rm addition, carport or garage enclosure	4.00	
	Temporary power	4.00	
59	Light, receptacle or switch outlet	.20	11.80
	Wall or ceiling space heater	.35	
1	Garbage grinder outlet	.35	.35
	Dishwasher outlet	.35	
	Clothes dryer outlet	.35	
	Automatic clothes washer	.35	
1	Electric range outlet	.35	.35
	Electric water heater outlet	.35	
	Special purpose outlet	.35	
	X-ray unit and its appurtenances	5.00	
	Watts of festoon lighting (Watts) First 3,000 watts for each additional thousand watts	4.00 1.50	
	Horsepower each motor first horsepower or less for each additional horsepower	1.75 .35	
1	Electric service (including any single meter socket) for each additional socket	3.00 .35	3.00
1	Air conditioning service	1.50	1.50
	Each KW(KVA) Generator (Transformer, Welder) First 100 KVA for each additional KW(KVA)	2.00 .01	
	Speaker, signal or alarm outlet	.15	
	Amplifiers	.50	
	Control panels	.25	
	Main control racks	1.00	
	T.V. and radio antennas-master system only	.75	
	Minimum fee for any permit	4.00	
	TOTAL FEE		17.00

Approval for the work under this permit will be given only after refuse and debris have been removed from job site and public right of way.

I hereby certify that I have carefully examined and read the above application; that the same is true and correct; and that the work herein described is to be done in accordance with all the provisions of the applicable Ordinances of the City of Las Vegas, Nevada and State laws whether herein specified or not.

SIGNED [Signature] DATE _____
MASTER (ELECTRICIAN) (TECHNICIAN) (OWNER)

BUILDING DEPARTMENT [Signature] DATE 5-7-76

#12860 PERMIT NO. 1167 PERMIT FEE: 17.00

RECEIPT

1584 \$017.00 - 6

CITY OF LAS VEGAS

MUST BE MACHINE VALIDATED

H. Gatewood 9-28-79

6-16

CITY OF LAS VEGAS, NEVADA

CONST. VAL. \$1500

LOG NO. & AREA

DEPARTMENT OF BUILDING & SAFETY

APPLICATION & BUILDING PERMIT for: Fence, Wall, Retaining Wall.

ADDRESS OF CONSTRUCTION

208 Lightning

OWNER

Edw. Stepp

LOT(s)

9

BLOCK

7

SUBDIVISION

Charleston Mountain 12-D

ZONE B-1

Materials of Construction:

Block

Concrete

Wire

Wood

Other

PLANS:

Yes No

ARCHITECT:

ENGINEER:

CALCS:

Yes No

CONTRACTOR:

Owners

STATE LICENSE #

CITY LICENSE #

TOTAL SQUARE FEET: 1020

TOTAL LINEAL FEET: 170

Remarks:

CONDITIONS OF THE PERMIT:

1. Any type of retaining wall must be engineered by a Civil or Structural Engineer.
2. If a home owner takes out the Building Permit and if the owner sublets the work to a Contractor, then the Contractor must take out the permit and pay for it.
3. No fence or wall can be built on City property or rights-of-way, but this is not intended to preclude construction within utility easements if utilities will not be damaged or made inaccessible.
4. The fence or wall shall not enclose any water meter, light standard, or fire alarm box and shall not come closer than 24" from the nearest fire hydrant outlet.
5. Department Inspectors must approve footings before concrete is poured and block wall reinforcing before grouting is done.
6. Maximum height of any wall or fence is 6', side and rear yards; 4' maximum in front yard with the vertical surface above the height of 2' - 50% open.
7. I must not obstruct required onsite parking space (2 spaces for each dwelling unit) by the erection of this fence or wall.
8. By the signing of this application I herewith agree to the requirements outlined above.

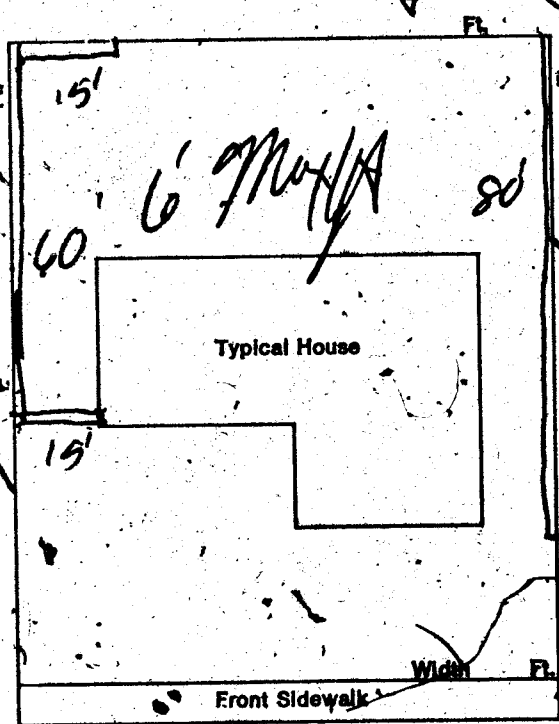

SIGNED: Edw. Stepp

CONTRACTOR AGENT OWNER

DATE:

PLANNING DEPT:

MA

Date: 3-8-77

PUBLIC WORKS DEPT:

Date:

BUILDING DEPT:

NM

Date: 3-8-77

#12850

PERMIT NO:

1161

PERMIT FEE \$

1500

RECEIPT

4556 2015.00 - 8

CITY OF LAS VEGAS
BUILDING & SAFETY

MUST BE MACHINE VALIDATED

- 8 MAR 77

Done

DEPT. of BLDG. & SAFETY - CITY of LAS VEGAS, NEVADA
OWNER Sproul Homes ADDRESS 208 Lightning St. DATE 3-24-76
GEN. CONT. Same TYPE OF STRUCTURE SPD
PERMIT NO. 1392 LEGAL DESCRIPTION L 9 B 7 Charleston Rainbow 12-D

BUILDING	MECHANICAL	ELECTRICAL
Investigation	Plumbing Cont. <u>United</u>	Temp. pole cont.
Location & Footing <u>BW 3-24-76</u>	Permit No. <u>492</u> Date <u>2-26-76</u>	Permit No. _____ Date _____
Stem Wall	Heat & Vent. A/C Cont. <u>Quincy</u>	Inspection _____ Date _____
Concrete Slab Floor <u>BW 4-8-76</u>	Permit No. <u>403</u> Date <u>4-27-76</u>	Electrical Cont. <u>Roberts</u>
Floor Framing	Sewer Cont. <u>Sproul Homes</u>	Permit No. <u>1767</u> Date <u>1-26</u>
Fireplace Footing	Permit No. <u>920</u> Date _____	Fixtures Cont. _____
Chimney Shaft	Roll Soil <u>WSP 4-6-76</u>	Permit No. _____ Date _____
Vert. Steel Reinf.	Rough Water <u>WSP 4-6-76</u>	Slab _____
Horiz. Steel Reinf.	Top-Out <u>WSP 4-30-76</u>	Rough <u>H 9 5-3-76</u>
Roof Sheathing <u>BW 4-29-76</u>	Rough Gas _____	Final Rough _____
Framing <u>BW 5-3-76</u>	A/C Rough Duct <u>WSP 4-27-76</u>	Final Fixture _____
Backing for siding	Ref. Rough Piping _____	Final Electrical <u>ADG 25-AD. 5-1-76</u>
Ext. Lath _____	Final Plumbing <u>WSP 6-2-76</u>	Temporary Service _____
Ext. Scaff. _____	Final Gas <u>WSP 6-2-76</u>	MISCELLANEOUS
Ext. Brown _____	Final Air Cond. <u>WSP 6-2-76</u>	Grading & Drainage _____
Int. Lath _____	Final Refrig. _____	On-Site Parking Spaces _____ App. _____
Int. Brown _____	Final Sewer <u>WSP 5-4-76</u>	Eng. Approval of _____
Drywall <u>BW 5-11-76</u>	Final Septic Tank _____	Off-Site Improvements _____
Permit No. _____		
Final Building _____		
Appr. for Occu. _____		

INSPECTOR: _____ DATE _____
APPROVED FOR OCCUPANCY & METER BW 1-3-76
PLEASE NOTE REMARKS ON REVERSE SIDE 208 Lightning St. LOG # _____ AREA # _____ T10-4

DEPARTMENT OF BUILDING & SAFETY - CITY OF LAS VEGAS, NEVADA
OWNER EDWIN STIFF KARDEX CARD
CONTRACTOR Owner PERMIT NO. 1181
LOT _____ BLOC _____
Fence (wire, wood, etc.) _____ Walls (masonry, rock, etc.) _____
Location _____
Final Inspection _____
Steel Lath _____ 2d _____ 3d _____
Inspection 12-5-76
Retaining Wall (masonry) _____ Retaining Wall (concrete) _____
Location _____
Footing _____
Wall Steel lath _____
Bond Beam lath _____
Final Inspection _____

23.14