

3941 Lighthouse

L11 B1 Park Bonanza East 5-B Zone R-1

Datwood 9-27-79

CITY OF LAS VEGAS, NEVADA

DEPARTMENT OF BUILDING & SAFETY - APPLICATION AND PERMIT FOR PLUMBING

ADDRESS OF CONSTRUCTION: 3941 LIGHTHOUSE

OWNER'S NAME: JACK KENNEY JR.

CIRCLE: New Bldg. Add'n.; Remodel; TYPE OF BLDG. SFD. APY. PUBLIC COMM.

CONTRACTOR'S NAME: HENDERSON PLBG. & HTG. CO., INC. STATE LICENSE # 10547 CITY LICENSE # CL1-7511

UNITS	DESCRIPTION	FEE	TOTAL
1	Bathtub	1.00	1.00
1	Shower	1.00	1.00
2	Lavatory	1.00	2.00
2	Toilet	1.00	2.00
	Urinal	1.00	
	Floor Drain	1.00	
	Floor Sink	1.00	
	Wash Tray	1.00	
1	Sink	1.00	1.00
1	Garbage Disposal	1.00	1.00
	Garbage Disposal (comm.)	3.00	
	Clothes Dryer (gas)	1.00	
1	Clothes Washer	1.00	1.00
	Clothes Washer (comm.)	5.00	
	Dishwasher	1.00	
	Dishwasher (commercial)	5.00	
	Dental Unit	10.00	
	Drinking Fountain	1.00	
	Any Water using Equipment	1.00	
	Water Heater (gas) (elect.)	1.00	
1	Sewer System - New, Replacement, or any Drainage System	4.00	4.00
	Grease or Sand Trap	2.00	
	Trailer Trap	2.00	
	Septic Disposal System	4.00	
WATER SOFTENERS			
	Nonpermanent Type	4.00	
	Permanent Type (connected to Drainage)	5.00	
SWIMMING POOLS			
	Private or Wading Pool	10.00	
	Public or Semi-public	20.00	

UNITS	DESCRIPTION	FEE	TOTAL
WATER DISTRIBUTION SYSTEM			
1	Single Family Dwelling	4.00	4.00
	Multiple Family Dwelling plus each unit	4.00 2.00	
	Bldg. Group "A" thru "G" per each floor	6.00	
	Hotel or Motel plus each bath	4.00 1.50	
	Trailer Park plus each space	20.00 1.00	
	Irrigation	4.00	
GAS PIPING SYSTEM			
1	Single Family Dwelling	3.00	3.00
	Multiple Family Dwelling plus each unit	6.00 1.00	
	Commercial Bldg. per floor plus each unit	3.00 3.00	
	Gas Appliance (any type)	1.00	
AUTOMATIC FIRE EXTINGUISHING SYSTEM			
	Underground Piping	10.00	
	Distribution Piping ea. ft.	.01	
	Sprinkler Head each	10	
	In Range Hood and Vent	5.00	
DRY STANDPIPE SYSTEM			
	Piping	50.00	
	Each Outlet	1.00	
WET STANDPIPE SYSTEM			
	Piping	5.00	
	Fire Hose Cabinet	1.00	
MINIMUM PERMIT FEE			
PIPELINE CONTRACTOR, SECT. 14-B.P.F. \$		4.00	
TOTAL PERMIT FEE \$			20.00

I hereby certify that I have carefully examined and read the above application; that the same is true and correct; and that the work herein described is to be done in accordance with all the provisions of the applicable Ordinance of the City of Las Vegas, Nevada and the State Laws, whether herein specified or not.

Approval for the work under this permit will be given only after refuse and debris have been removed from job site and public right of way.

Signed: *M. Taylor* Date: 2/10/76
Registered Master Plumber, Spec. Cont'r. or Owner
 Building Department: *N. Miller* Date: 2-12-76
 Permit No. 544 Permit Fee \$ 20.00

#12870

RECEIPT
 7026 \$20.00 - 7
 CITY OF LAS VEGAS
 DEPARTMENT OF BUILDING & SAFETY
 MUST BE MACHINE VALIDATED
 13 FEB 76

Watwood 9-27-79

CITY OF LAS VEGAS, NEVADA

DEPARTMENT OF BUILDING & SAFETY - APPLICATION AND PERMIT FOR PLUMBING

ADDRESS OF CONSTRUCTION: 3941 LIGHTHOUSE

OWNER'S NAME: JACK KENNEY JR.

CIRCLE: New Bldg. Add'n.; Remodel; TYPE OF BLDG. SFD APY. PUBLIC COMM.

CONTRACTOR'S NAME: HENDERSON PLBG. & HTG. CO., INC. STATE LICENSE # 10547 CITY LICENSE # G11-7511

UNITS	DESCRIPTION	FEE	TOTAL
1	Bathtub	1.00	1.00
1	Shower	1.00	1.00
2	Lavatory	1.00	2.00
2	Toilet	1.00	2.00
	Urinal	1.00	
	Floor Drain	1.00	
	Floor Sink	1.00	
	Wash Tray	1.00	
1	Sink	1.00	1.00
1	Garbage Disposal	1.00	1.00
	Garbage Disposal (comm.)	3.00	
	Clothes Dryer (gas)	1.00	
1	Clothes Washer	1.00	1.00
	Clothes Washer (comm.)	5.00	
	Dishwasher	1.00	
	Dishwasher (commercial)	5.00	
	Dental Unit	10.00	
	Drinking Fountain	1.00	
	Any Water using Equipment	1.00	
	Water Heater (gas) (elect.)	1.00	
1	Sewer System - New, Replacement, or any Drainage System	4.00	4.00
	Grease or Sand Trap	2.00	
	Trailer Trap	2.00	
	Septic Disposal System	4.00	
WATER SOFTENERS			
	Nonpermanent Type	4.00	
	Permanent Type (connected to Drainage)	5.00	
SWIMMING POOLS			
	Private or Wading Pool	10.00	
	Public or Semi-public	20.00	

UNITS	DESCRIPTION	FEE	TOTAL
WATER DISTRIBUTION SYSTEM			
1	Single Family Dwelling	4.00	4.00
	Multiple Family Dwelling plus each unit	4.00 2.00	
	Bldg. Group "A" thru "G" per each floor	6.00	
	Hotel or Motel plus each bath	4.00 1.50	
	Trailer Park plus each space	20.00 1.00	
	Irrigation	4.00	
GAS PIPING SYSTEM			
1	Single Family Dwelling	3.00	3.00
	Multiple Family Dwelling plus each unit	6.00 1.00	
	Commercial Bldg. per floor plus each unit	3.00 3.00	
	Gas Appliance (any type)	1.00	
AUTOMATIC FIRE EXTINGUISHING SYSTEM			
	Underground Piping	10.00	
	Distribution Piping ea. ft.	.01	
	Sprinkler Head each	10	
	In Range Hood and Vent	5.00	
DRY STANDPIPE SYSTEM			
	Piping	50.00	
	Each Outlet	1.00	
WET STANDPIPE SYSTEM			
	Piping	5.00	
	Fire Hose Cabinet	1.00	
	MINIMUM PERMIT FEE	4.00	
PIPELINE CONTRACTOR; SECT. 14-B.P.F. \$			
		TOTAL PERMIT FEE \$	20.00

I hereby certify that I have carefully examined and read the above application; that the same is true and correct; and that the work herein described is to be done in accordance with all the provisions of the applicable Ordinance of the City of Las Vegas, Nevada and the State Laws, whether herein specified or not.

Approval for the work under this permit will be given only after refuse and debris have been removed from job site and public right of way.

Signed: [Signature] Registered Master Plumber, Spec. Contr. or Owner

Date: 2/10/76

Building Department

Date: 2-12-76

Permit No. 544

Permit Fee \$ 20.00

#12870

RECEIPT

7026 \$20.00 - 7

CITY OF LAS VEGAS
DEPARTMENT OF BUILDING & SAFETY

MUST BE MACHINE VALIDATED
13 FEB 76

Dated 9-27-74

CITY OF LAS VEGAS, NEVADA

LOG NO. & AREA: 13-10 T-7-2

CONST. VAL: 26250

DEPARTMENT OF BUILDING & SAFETY

APPLICATION & BUILDING PERMIT for: Dwellings, Duplexes, Misc. Residential Const.

ADDRESS OF CONSTRUCTION: 3941 LIGHTHOUSE

OWNER: J. KENNEY MOBILE HOMES INC

LOT(s) 11 BLOCK 1 SUBDIVISION PARK BONANZA EAST S/B ZONE: R-1

Existing structure on lot: Dwelling Accessory bldgs. Vacant lot Other

PROPOSED CONSTRUCTION: SFD USE: RESIDENCE

MATERIALS OF CONSTRUCTION: Wood Frame Concrete Block Reinforced Concrete Steel Frame

SQ. FEET OF FLOOR AREAS: 1st 1085 2nd 3rd GAR 455 TOTAL SQ. FT. 1540

FIRE ZONE: 1 2 3 Occupancy Group: 1 1-2 CONST. TYPE: I II III IV V

ARCHITECT: ENGINEER: R. KRAEMER NO. of UNITS: 1 NO. of STORES: 1

Plans Submitted: Yes No Calculations Submitted: Yes No Sewer Fee Req'd: Yes No

CONTRACTOR: J. KENNEY JR. STATE LICENSE: 11008 CITY LICENSE: C-11-4087

ADD'L. PERMITS REQ'D: Air Cond. Incinerators Elec. Plumbing Signs Paving Fence Public Walks Curb-gutters Fire Sprinkling System

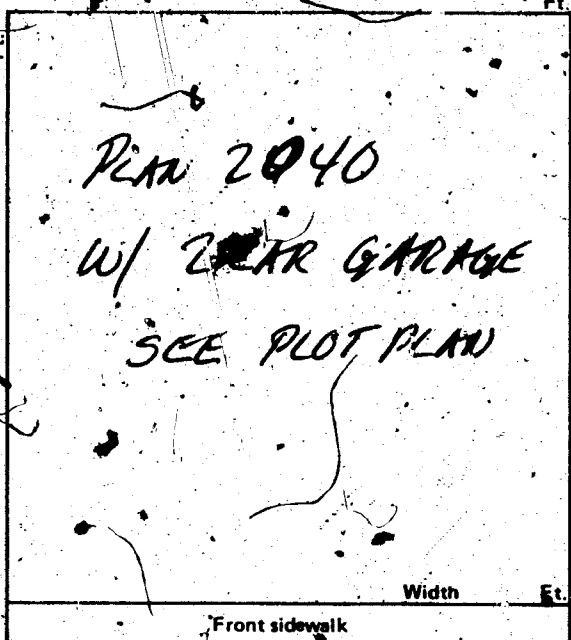

CONDITIONS OF THE PERMIT:

- 1. I agree to call the City Building Department for inspection before concrete is poured, before rough wiring, electrical, plumbing, framing is covered. Also for air conditioning, sheet-rock and sheathing inspection.
2. I agree that when the job is completed that I will call for final inspection before occupancy.
3. I agree to perform all construction in accordance with City Ordinances and Building Codes.
4. The Contractor's signature below denotes authority from the owner to sign in his behalf and that the owner is aware of all requirements of this application and permit. Separate permits must be taken out for work outlined above this agreement.
5. I have read and understand the contents of this application and permit; I hereby state that the information I have supplied on this application is true and correct.

Approval for the work under this permit will be given only after reference and debris have been removed from job site and public right of way.

SIGNED: J. Kenney Jr. Contractor
BY: KENNEY MOBILE HOMES INC Agent or Owner

CLARK COUNTY HEALTH DEPT. Date
LAS VEGAS FIRE DEPARTMENT Date

PLANNING DEPT.: Date: 2/5/76
PUBLIC WORKS DEPT.: Date: 2/5/76
BUILDING DEPT.: Date: 2/5/76
12850 PERMIT NO.: 645 PERMIT FEE \$ 104.00

RECEIPT
7089 \$104.00 - 8
CITY OF LAS VEGAS
DEPT. OF BUILDING & SAFETY
MUST BE MACHINE VALIDATED
17 FEB 76

Dated 9-27-79

13-10
LOG NO. & AREA: F-7-2

CITY OF LAS VEGAS, NEVADA

CONST. VAL. 26250

DEPARTMENT OF BUILDING & SAFETY

APPLICATION & BUILDING PERMIT for:
Dwellings, Duplexes, Misc. Residential Const.

ADDRESS OF CONSTRUCTION: 3941 LIGHTHOUSE

OWNER: J. KENNEY MOBILE HOMES INC

LOT(s) 11 BLOCK 1 SUBDIVISION PARK BONANZA EAST 5B ZONE R-1

Existing structure on lot: Dwelling Accessory bldg. Vacant lot Other

PROPOSED CONSTRUCTION: SFD USE: RESIDENCE

MATERIALS OF CONSTRUCTION: Wood Frame Concrete Block Reinforced Concrete Steel Frame

SQ. FEET OF FLOOR AREAS: 1st 1085 2nd 3rd GAR 455 TOTAL SQ. FT. 1540

FIRE ZONE: 1 2(3) Occupancy Group 1 1-2 CONST. TYPE I II III IV V

ARCHITECT: ENGINEER: R. KRAEMER NO. of UNITS 1 NO. of STORES 1

Plans Submitted: Yes No Calculations Submitted: Yes No Sewer Fee Req'd: Yes No

CONTRACTOR: J. KENNEY JR. STATE LICENSE # 11008 CITY LICENSE # C-11-4087

ADD'L. PERMITS REQ'D: Air Cond. Incinerators Elec. Plumbing Signs Paving Fence Public Walks Curb-gutters Fire Sprinkling System

PLAN 2040
W/ 2 CAR GARAGE
SEE PLOT PLAN

Front sidewalk

CONDITIONS OF THE PERMIT:

- I agree to call the City Building Department for inspection before concrete is poured, before rough wiring, electrical, plumbing, framing is covered. Also for air conditioning, sheet-rock and sheathing inspection.
- I agree that when the job is completed that I will call for final inspection before occupancy.
- I agree to perform all construction in accordance with City Ordinances and Building Codes.
- The Contractor's signature below denotes authority from the owner to sign in his behalf and that the owner is aware of all requirements of this application and permit. Separate permits must be taken out for work outlined above this agreement.
- I have read and understand the contents of this application and permit; I hereby state that the information I have supplied on this application is true and correct.

Approval for the work under this permit will be given only after rebar and debris have been removed from job site and public right of way.

SIGNED: John E. Kenney Contractor
BY: KENNEY MOBILE HOMES INC Agent of Owner

CLARK COUNTY HEALTH DEPT. Date
LAS VEGAS FIRE DEPARTMENT Date

PLANNING DEPT.: [Signature] Date: 2/5/76
PUBLIC WORKS DEPT.: [Signature] Date: 2-5-76
BUILDING DEPT.: [Signature] Date: 2/5/76
12850 PERMIT NO.: 645 PERMIT FEE \$ 104.00

RECEIPT
7089 \$104.00 - 8
CITY OF LAS VEGAS
DEPT. OF BUILDING & SAFETY
MUST BE MACHINE VALIDATED
1/7 FEB 76

W. Latawood 9 27-79

CITY OF LAS VEGAS, NEVADA
DEPARTMENT OF BUILDING & SAFETY
RECEIPT
FOR
SEWER CONNECTION FEE

KENNEY MOBILE HOMES, INC.

JOB ADDRESS: *394 LIGHTHOUSE* OWNER'S NAME: *JOHN E KENNEY JR PRES*
LOT *117* LOCK *1* SUBDIVISION *PARK BONANA EAST STS*

QUANTITY	OCCUPANCY	UNIT FEE	AMOUNT
<i>1</i>	<i>SFD</i>	<i>150</i>	<i>150</i>

PAID BY: *Kenney Mobile Homes Inc*

TOTAL: *150*

Less Credit: *0*

TOTAL FEE \$ *150*

*Credit for existing sewer is applied to the new sewer connection fee based on previous type of occupancy and only when the new occupancy requires an additional fee.
This receipt does not authorize the owner or his representative to start any work without obtaining a plumbing permit.

WR7 2/5/76
DEPARTMENT OF BUILDING & SAFETY DATE

RECEIPT NO. *540* SEWER FEE \$ *150*

73102

RECEIPT

7096 - \$150.00 - 3

CITY OF LAS VEGAS
DEPT. OF
BUILDING & SAFETY
MUST BE MACHINE VALIDATED

Latwood 9 27 79

CITY OF LAS VEGAS, NEVADA
DEPARTMENT OF BUILDING & SAFETY

RECEIPT
FOR
SEWER CONNECTION FEE

KENNEY MOBILE HOMES, INC.

JOB ADDRESS: 394 LIGHTHOUSE

OWNER'S NAME: JOHN E. KENNEY JR. PRES.

LOT 117

LOCK 1

SUBDIVISION PARK BOUNDARY EAST SIDE

QUANTITY	OCCUPANCY	UNIT FEE	AMOUNT
1	SFD	150	150

PAID BY: Kenney Mobile Homes Inc.

TOTAL	150
Less Credit	0
TOTAL FEE \$	150

*Credit for existing sewer is applied to the new sewer connection fee based on previous type of occupancy and only when the new occupancy requires an additional fee.

This receipt does not authorize the owner or his representative to start any work without obtaining a plumbing permit.

DEPARTMENT OF BUILDING & SAFETY

DATE

WR7 2/5/76

RECEIPT NO. 580

SEWER FEE \$ 150

73102

RECEIPT

7096 - \$150.00 - 3

CITY OF LAS VEGAS
DEPT. OF
BUILDING & SAFETY
MUST BE MACHINE VALIDATED

9. Hattwood 9-27-76

CITY OF LAS VEGAS, NEVADA

DEPARTMENT OF BUILDING & SAFETY - AIR CONDITIONING APPLICATION & PERMIT

ADDRESS OF CONSTRUCTION: 1941 Lighthouse Avenue OWNER'S NAME: John E. Kenney, Jr.

CIRCLE: Addition Remodel New Bldg TYPE OF BLDG.: SFD APT. COMM. PUBLIC

CONTRACTOR'S NAME: Tropic-Aire Conditioning Co. STATE LICENSE # 10426A CITY LICENSE # 03382

UNITS	DESCRIPTION	FEE	TOTAL	UNITS	DESCRIPTION	FEE	TOTAL
	Unit heater - wall or suspended	4.00		EVAPORATIVE COOLERS:			
FOR EACH FORCED DRAUGHT OR GRAVITY-TYPE FURNACE OR BURNER ATTACHED TO SUCH	DUCTS AND VENTILANCES:				5 outlets or under	3.00	
Up to and including 100,000 B.t.u.'s		4.00			Over 5 and up to and including 10	5.00	
Over 100,000 B.t.u.'s		6.00			Each additional outlet over 10	.25	
FOR EACH HEATING UNIT, COMFORT UNIT, ABSORPTION UNIT, APPLICATION, REFRIGERATION, COOLING AND HEATING COMPRESSOR OR BOILER:				VENTILATION:			
Up to and including 100,000 B.t.u.'s	3 ton or horsepower, or up to and including	4.00	4.00		For each fan connected to a single duct	1.00	
Over 3 ton or 3 horsepower up to and including 10, or absorption system over 100,000 B.t.u.'s up to and including		7.00			For each commercial or industrial ventilation system	5.00	
Over 10 ton or 10 horsepower up to and including 30, or 250,000 B.t.u. up to and including 1,000,000 B.t.u.'s		12.00			For each commercial kitchen hood	5.00	
Over 30 ton or 30 horsepower up to and including 50, or 1,000,000 B.t.u. up to and including 1,700,000 B.t.u.'s		20.00		MISCELLANEOUS:			
Over 50 ton or 50 horsepower, or absorption system over 1,700,000 B.t.u.'s		30.00			For each water cooling tower	8.00	
FOR EACH AIR HANDLING UNIT INCLUDING DUCTS ATTACHED HERETO:					Duct work only - each opening	.25	
Up to and including 10,000 CFM		2.00			For installation or relocation of each commercial or industrial incinerator	15.00	
Over 10,000 CFM		4.00			Gas piping related to the air cond. work in single family dwelling only	3.00	
					For each appliance, piece of equipment, any mechanical work or alteration or replacement not included in this schedule, the permit fee shall be computed the same as building permit fees by using the cost of installation for the valuation amount.		
				FOR THE ISSUANCE OF EACH PERMIT			3.00
				TOTAL PERMIT FEE \$ 7.00			

I hereby certify that I have carefully examined and read the above application; that the same is true and correct; and that the work herein described is to be done in accordance with all the provisions of the applicable Ordinances of the City of Las Vegas, Nevada and the State Laws, whether specifically specified or not.

Approval for the work under this permit will be given only after refuse and debris have been removed from job site and public right of way.

SIGNED Lisa L. Lichner Date 3/19/76
Air Conditioning Contractor - Owner

BUILDING DEPARTMENT WR7 Date 3/19/76

PERMIT NO. 309 PERMIT-FEE \$ 7.00

#12890

RECEIPT

8588 \$007.00 - 4

CITY OF LAS VEGAS
DEPT. OF BUILDING & SAFETY

MUST BE MACHINE VALIDATED

19 MAR 76

9 Hatwood 9-27-79

CITY OF LAS VEGAS, NEVADA

DEPARTMENT OF BUILDING & SAFETY - ELECTRICAL APPLICATION & PERMIT

ADDRESS OF CONSTRUCTION: 3941 Lighthouse Ave OWNER'S NAME: JACK HONEY

CIRCLE: New Bldg.; Add'n.; Remodel; TYPE OF BLDG.: SFD; APT. PUBLIC COMM.

CONTRACTOR'S NAME: ANDERSON ELECTRIC STATE LICENSE # 10997 CITY LICENSE # 090-2-00350

NUMBER	FIXTURE OR INSTALLATION	UNIT PRICE	TOTAL
	Rm addition, carport or garage enclosure	4.00	
	Temporary power	4.00	
<u>40</u>	Light, receptacle or switch outlet	<u>.20</u>	<u>8.00</u>
	Wall or ceiling space heater	.35	
<u>1</u>	Garbage grinder outlet	.35	<u>.35</u>
	Dishwasher outlet	.35	
	Clothes dryer outlet	.35	
	Automatic clothes washer	.35	
	Electric range outlet	.35	
	Electric water heater outlet	.35	
	Special purpose outlet	.35	
	X-ray unit and its appurtenances	5.00	
	Watts/ of festoon lighting (Watts) First 3,000 watts for each additional thousand watts	4.00 1.50	
	Horsepower-each motor first horsepower or less for each additional horsepower	1.75 .35	
<u>1</u>	Electric service (including any single meter socket) for each additional socket	3.00 .35	<u>3.00</u>
<u>1</u>	Air conditioning service	1.50	<u>1.50</u>
	Each KW(KVA) Generator (Transformer, Welder) First 100 KVA for each additional KW(KVA)	2.00 .01	
	Speaker, signal or alarm outlet	.75	
	Amplifiers	.50	
	Control panels	.25	
	Main control racks	1.00	
	T.V. and radio antennas-master system only	.75	
	Minimum fee for any permit	4.00	
	TOTAL FEE		<u>\$12.85</u>

Approval for the work under this permit will be given only after refuse and debris have been removed from job site and public right of way.

I hereby certify that I have carefully examined and read the above application; that the same is true and correct; and that the work herein described is to be done in accordance with all the provisions of the applicable Ordinances of the City of Las Vegas, Nevada and State laws, whether herein specified or not.

SIGNED Allen E. Anderson DATE 3/22/76
MASTER (ELECTRICIAN) (TECHNICIAN) (OWNER)

BUILDING DEPARTMENT MM DATE _____

#12860 PERMIT NO. 726 PERMIT FEE: \$ 12.85

RECEIPT
9004 \$012.85 - 6

CITY OF LAS VEGAS
DEPT. OF BUILDING & SAFETY

MUST BE MACHINE VALIDATED

9 Hatedwood 9-27-79

CITY OF LAS VEGAS, NEVADA

DEPARTMENT OF BUILDING & SAFETY - ELECTRICAL APPLICATION & PERMIT

ADDRESS OF CONSTRUCTION: 3941 Lighthouse Ave OWNER'S NAME: JACK MONEY

CIRCLE: New Bldg.; Add'n.; Remodel; TYPE OF BLDG.: SFD; APT. PUBLIC COMM.

CONTRACTOR'S NAME: ANDERSON ELECTRIC STATE LICENSE # 10997 CITY LICENSE # 090-2-00350

NUMBER	FIXTURE OR INSTALLATION	UNIT PRICE	TOTAL
	Rm addition, carport or garage enclosure	4.00	
	Temporary power	4.00	
40	Light, receptacle or switch outlet	.20	8.00
	Wall or ceiling space heater	.35	
1	Garbage grinder outlet	.35	.35
	Dishwasher outlet	.35	
	Clothes dryer outlet	.35	
	Automatic clothes washer	.35	
	Electric range outlet	.35	
	Electric water heater outlet	.35	
	Special purpose outlet	.35	
	X-ray unit and its appurtenances	5.00	
	Watts/ of festoon lighting (Watts) First 3,000 watts for each additional thousand watts	4.00 1.50	
	Horsepower each motor first horsepower or less for each additional horsepower	1.75 .35	
1	Electric service (including any single meter, socket) for each additional socket	3.00 .35	3.00 ✓
1	Air conditioning service	1.50	1.50
	Each KW(KVA) Generator (Transformer, Welder) First 100 KVA for each additional KW(KVA)	2.00 .01	
	Speaker, signal or alarm outlet	.75	
	Amplifiers	.50	
	Control panels	.25	
	Main control racks	1.00	
	T.V. and radio antennas-master system only	.75	
	Minimum fee for any permit	4.00	
TOTAL FEE			\$12.85

Approval for the work under this permit will be given only after refuse and debris have been removed from job site and public right of way.

I hereby certify that I have carefully examined and read the above application; that the same is true and correct; and that the work herein described is to be done in accordance with all the provisions of the applicable Ordinances of the City of Las Vegas, Nevada and State laws whether herein specified or not.

SIGNED Alan E. Anderson DATE 3/22/76
MASTER (ELECTRICIAN) (TECHNICIAN) (OWNER)

BUILDING DEPARTMENT MM DATE _____

#12860 PERMIT NO. 726 PERMIT FEE: \$ 12.85

RECEIPT
9004 5012.85 - 6

CITY OF LAS VEGAS
DEPT. OF BUILDING & SAFETY

MUST BE MACHINE VALIDATED

Y. Gatuwood 17-27-79

2-08

CITY OF LAS VEGAS, NEVADA

LOG NO. & AREA

CONST. VAL. \$ 210.00

DEPARTMENT OF BUILDING & SAFETY

APPLICATION & BUILDING PERMIT — for:
Fence, Wall, Retaining Wall.

ADDRESS OF CONSTRUCTION: 394 Lighthouse

OWNER: Jack Kenny

LOT(S) #11 BLOCK 1 SUBDIVISION PARK BONANZA EAST UNIT 57B ZONE R-1

Materials of Construction: Block Concrete Wire Wood Other Yes No

ARCHITECT: ENGINEER: TRANS: CALCS:

CONTRACTOR: THE TIBERTI COMPANY

STATE LICENSE # 4632E

CITY LICENSE # 1128

TOTAL SQUARE FEET: TOTAL LINEAL FEET: 69'

Remarks:

CONDITIONS OF THE PERMIT

- Any type of retaining wall must be engineered by a Civil or Structural Engineer.
- If a home owner takes out the Building Permit and if the owner sublets the work to a Contractor, then the Contractor must take out the permit and pay for it.
- No fence or wall can be built on City property or rights-of-way, but this is not intended to preclude construction within utility easements if utilities will not be damaged or made inaccessible.
- The fence or wall shall not enclose any water meter, light standard, or fire alarm box and shall not come closer than 24" from the nearest fire hydrant outlet.
- Department inspectors must approve footings before concrete is poured and block wall reinforcing before grouting is done.
- Maximum height of any wall or fence is 6', side and rear yards; 4' maximum in front yard with the vertical surface above the height of 2' — 50% open.
- Must not obstruct required onsite parking space (2 spaces for each dwelling unit) by the erection of this fence or wall.
- By the signing of this Application I herewith agree to the requirements outlined above.

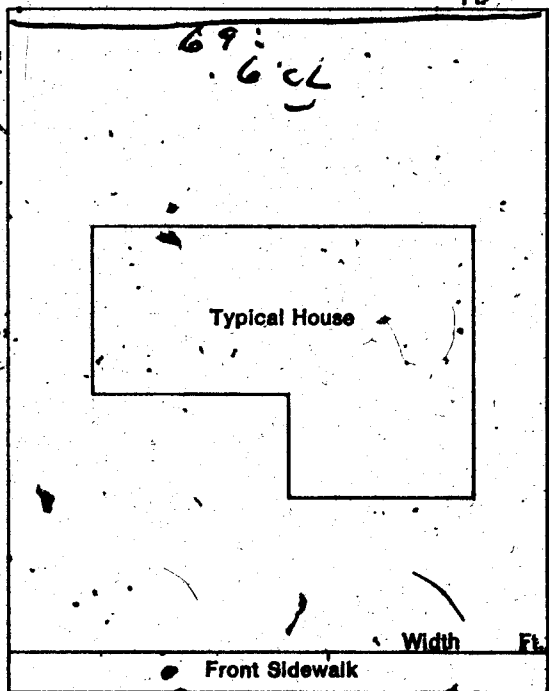

THE TIBERTI COMPANY

SIGNED: [Signature] DATE: 4-30-76

CONTRACTOR AGENT OWNER

PLANNING DEPT: [Signature] Date: 5-3-76

PUBLIC WORKS DEPT: [Signature] Date: 5-4-76

BUILDING DEPT: [Signature] Date: 5-4-76

#12850 PERMIT NO: 2249 PERMIT FEE \$ 5.00

RECEIPT

1039 \$005.00 - 8

CITY OF LAS VEGAS

MUST BE MACHINE VALIDATED

9. State and 9-27-79

CITY OF LAS VEGAS, NEVADA

LOG NO. & AREA _____
DEPARTMENT OF BUILDING & SAFETY

CONST. VAL: \$ 567
APPLICATION & BUILDING PERMIT — for:
Dwellings, Duplexes, Misc. Residential Const.

ADDRESS OF CONSTRUCTION: 3941 Lighthouse Ave.

OWNER: SCHLESINGER KEN

LOT(s) 11 BLOCK 1 SUBDIVISION W. BONAZZA EAST 5-B ZONE RT

Existing structure on lot: Dwelling Accessory bldgs. Vacant lot Other

PROPOSED CONSTRUCTION: Patio-Cover & Cement USE: _____

MATERIALS OF CONSTRUCTION: Wood Frame Concrete Block Reinforced Concrete Steel Frame

SQ. FEET OF FLOOR AREAS: 1st _____ 2nd _____ 3rd _____ Other _____ TOTAL SQ. FT. 162

FIRE ZONE: 1 2 3 _____ Occupancy Group I J 1-2 _____ CONST. TYPE: I II III IV V

ARCHITECT: _____ ENGINEER: _____ NO. of UNITS _____ NO. of STORIES _____

Plans Submitted: Yes No Calculations Submitted: Yes No Sewer Fee Req'd. Yes No

CONTRACTOR: DURABILTY, INC. STATE LICENSE # 12692 CITY LICENSE # 11107

ADD'L. PERMITS REQ'D: Air Cond. Elec. Plumbing Signs Paving Fence Public Walks Curb-gutters
Incinerators Fire Sprinkling System

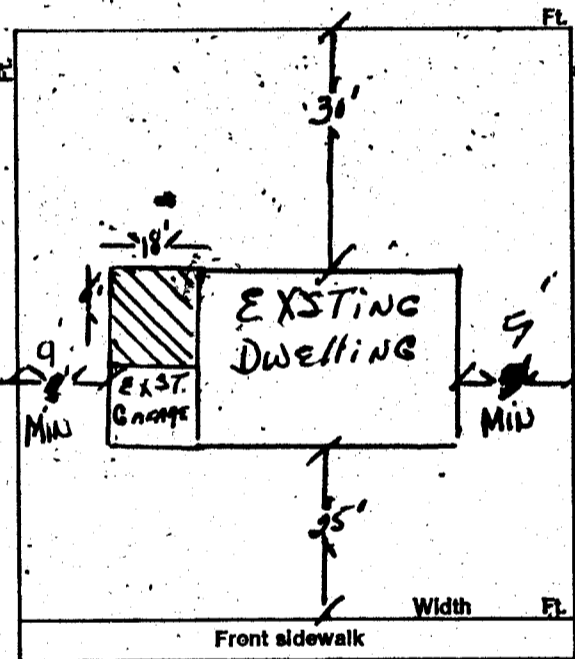

CONDITIONS OF THE PERMIT:

1. I agree to call the City Building Department for inspections, before concrete is poured, before rough wiring, electrical, plumbing, framing is covered. Also for air conditioning, sheet-rock and sheathing inspection.
2. I agree that when the job is completed that I will call for final inspection before occupancy.
3. I agree to perform all construction in accordance with City Ordinances and Building Codes.
4. The Contractor's signature below denotes authority from the owner to sign in his behalf and that the owner is aware of all requirements of this application and permit. Separate permits must be taken out for work outlined above this agreement.
5. I have read and understand the contents of this application and permit; I hereby state that the information I have supplied on this application is true and correct.

SIGNED: Durability, Inc. Contractor

BY: Ken Schlesinger Agent or Owner

CLARK COUNTY HEALTH DEPT. _____ Date _____

LAS VEGAS FIRE DEPARTMENT _____ Date _____

PLANNING DEPT.: _____ Date: 6/23/76

PUBLIC WORKS DEPT.: _____ Date: 6/23/76

BUILDING DEPT.: _____ Date: 6/23/76

PERMIT NO.: 3346 PERMIT FEE \$ 800

RECEIPT
3955 \$008.00 - 8
CITY OF LAS VEGAS
DEPT. OF BUILDING & SAFETY
MUST BE MACHINE VALIDATED
21 JUN 76

(12-07)

Donna Kenney Page 82

DEPT. of BLDG. & SAFETY - CITY of LAS VEGAS, NEVADA
 OWNER Kenney Mobile Home ADDRESS 3941 Lighthouse DATE 2-13-76
 GEN. CONT. John Kenney TYPE OF STRUCTURE SFD
 PERMIT NO. 545 LEGAL DESCRIPTION L 11 B 1 Park Bonanza East 5 B

BUILDING	MECHANICAL	ELECTRICAL
Investigation	Plumbing Cont. <i>Handwritten</i>	Temp. pole cont.
Location & Footing <i>WB 2-27-76</i>	Permit No. <i>544</i> Date <i>2-13-76</i>	Permit No. _____ Date _____
Stem Wall <i>WB 3-5-76</i>	Heat & Vent. A/C Cont. <i>Handwritten</i>	Inspection _____ Date _____
Concrete Slab Floor <i>WB 3-5-76</i>	Permit No. <i>307</i> Date <i>2-19-76</i>	Electrical Cont. <i>Handwritten</i>
Floor Framing	Sewer Cont. <i>John Kenney</i>	Permit No. <i>726</i> Date <i>2-25-76</i>
Fireplace Footing	Permit No. <i>560</i> Date _____	Fixtures Cont. _____
Chimney Steel	Rough Soil <i>WB 3-8-76</i>	Permit No. _____ Date _____
Vert. Steel Reinf.	Rough Water <i>WB 3-8-76</i>	Slab _____
Horiz. Steel Reinf.	Top-Out <i>WB 4-1-76</i>	Rough _____
Roof Sheathing <i>WB 3-31-76</i>	Rough Gas <i>WB 4-1-76</i>	Final Rough _____
Framing	A/C Rough Duct <i>WB 4-1-76</i>	Final Fixture _____
Backing for siding	Ref. Rough Piping _____	Final Electrical <i>WB 2-20-76</i>
Ext. Lath <i>WB 4-9-76</i>	Final Plumbing <i>WB 5-20-76</i>	Temporary Service _____
Ext. Scratch <i>WB 5-22-76</i>	Final Gas <i>WB 5-20-76</i>	MISCELLANEOUS
Ext. Brown <i>WB 5-23-76</i>	Final Air Cond. _____	Grading & Drainage _____
Int. Lath	Final Refrig. _____	On-Site Parking Spaces _____ App. _____
Int. Brown	Final Sewer <i>WB 4-7-76</i>	Eng. Approval of _____
Drywall <i>WB 4-19-76</i>	Final Septic Tank _____	Off-Site Improvements _____
Permit No.		
Final Building <i>WB 5-21-76</i>		
Appr. for Occu.		

INSPECTOR: _____ DATE _____
 APPROVED FOR OCCUPANCY & METER *WB 5-21-76*
 PLEASE NOTE REMARKS ON REVERSE SIDE 3941 Lighthouse LOG # _____ AREA # _____ T 7-2

DEPT. of BLDG. & SAFETY - CITY of LAS VEGAS, NEVADA
 OWNER Schlesinger Ken ADDRESS 3941 Lighthouse Ave. DATE 6-23-76
 GEN. CONT. Durabilt, Inc. TYPE OF STRUCTURE patio cover, slab
 PERMIT NO. 3346 LEGAL DESCRIPTION L 11 B 1 Park Bonanza East 5-B

BUILDING	MECHANICAL	ELECTRICAL
Investigation	Plumbing Cont.	Temp. pole cont.
Location & Footing	Permit No. _____ Date _____	Permit No. _____ Date _____
Stem Wall	Heat & Vent. A/C Cont.	Inspection _____ Date _____
Concrete Slab Floor	Permit No. _____ Date _____	Electrical Cont. _____
Floor Framing	Sewer Cont.	Permit No. _____ Date _____
Fireplace Footing	Permit No. _____ Date _____	Fixtures Cont. _____
Chimney Steel	Rough Soil	Permit No. _____ Date _____
Vert. Steel Reinf.	Rough Water	Slab _____
Horiz. Steel Reinf.	Top-Out	Rough _____
Roof Sheathing	Rough Gas	Final Rough _____
Framing	A/C Rough Duct	Final Fixture _____
Backing for siding	Ref. Rough Piping	Final Electrical _____
Ext. Lath	Final Plumbing	Temporary Service _____
Ext. Scratch	Final Gas	MISCELLANEOUS
Ext. Brown	Final Air Cond.	Grading & Drainage _____
Int. Lath	Final Refrig.	On-Site Parking Spaces _____ App. _____
Int. Brown	Final Sewer	Eng. Approval of _____
Drywall	Final Septic Tank	Off-Site Improvements _____
Permit No.		
Final Building		
Appr. for Occu.		

INSPECTOR: _____ DATE _____
 APPROVED FOR OCCUPANCY & METER *WB 5 2-19-76*
 PLEASE NOTE REMARKS ON REVERSE SIDE 3941 Lighthouse LOG # _____ AREA # _____

CITY OF WASH DEPT. OF PUBLIC WORKS DIVISION OF STREETS AND SANITATION DATE 5-11-38 2719	
FENCE (wire, iron, etc.) (masonry, rock, etc.)	
Location _____ Final Inspection _____	
Retaining Wall (masonry) Retaining Wall (concrete)	
Location _____ Footing _____ Wall Steel 1st _____ 2d _____ 3d _____ Bond Beam 1st _____ 2d _____ 3d _____ Final Inspection _____	Location _____ Footing _____ Wall Steel 1st _____ 2d _____ 3d _____ Bond Beam 1st _____ 2d _____ 3d _____ Final Inspection _____