

3813 Lighthouse

L3 B A Park Bonanza East 6B Zone R-1

9 Gatewood 9-27-79

CITY OF LAS VEGAS, NEVADA

15-13

LOG NO. & AREA

T-11-2

CONST. VAL. 27570

DEPARTMENT OF PUBLIC SERVICES
DIVISION OF BUILDING AND SAFETY

APPLICATION & BUILDING PERMIT - for:
Dwellings, Duplexes, Misc. Residential Const.

ADDRESS OF CONSTRUCTION: 3813 Lighthouse

OWNER: KENNEY MOBILE HOMES INC.

LOT(s) 3 BLOCK A SUBDIVISION PARK BONANZA EAST 6 B ZONE: R-1

Existing structure on lot: Dwelling Accessory Bldgs. Vacant Lot Other

PROPOSED CONSTRUCTION: SINGLE FAMILY DWELLING USE: SAME

MATERIALS OF CONSTRUCTION: Wood Frame Concrete Block Reinforced Concrete Steel Frame

SQUARE FEET OF FLOOR AREAS: 1st 1232 2nd 3rd Other GAR 293 TOTAL SQ. FT. 1525

FIRE ZONE: 3 Occupancy Group I CONST. TYPE: V

ARCHITECT: ENGINEER: R. Kraemer NO. of UNITS 1 NO. of STORIES 1

Plans Submitted: Yes No Calculations Submitted: Yes No Sewer Fee Req'd. Yes No #1768

CONTRACTOR: J. KENNEY JR. STATE LICENSE # 11008 CITY LICENSE # C-11-4087

ADD'L. PERMITS REQ'D.: Air Cond. Elec. Plumbing Signs Paving Fence Public Walks Curb-gutters
Incinerators Fire Sprinkling System

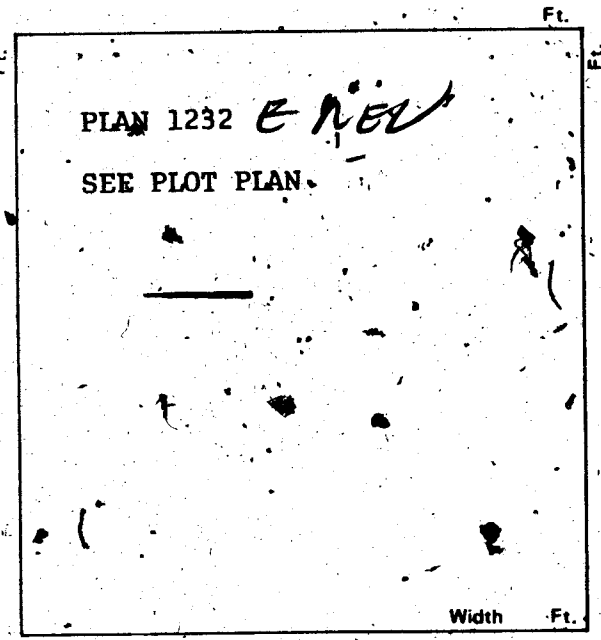

CONDITIONS OF THE PERMIT:

- I agree to call the City Building Department for inspections before concrete is poured, before rough wiring, electrical, plumbing, framing is covered. Also for Air conditioning, drywall and sheathing inspection.
- I agree that when the job is completed that I will call for final inspection before occupancy.
- I agree to perform all construction in accordance with City Ordinance and Building Codes.
- The Contractor's signature below denotes authority from the owner to sign in his behalf and that the owner is aware of all requirements of this application and permit. Separate permits must be taken out for work outlined above this agreement.
- I have read and understand the contents of this application and permit; I hereby state that the information I have supplied on this application is true and correct.

Approval for the work under this permit will be given only after refuse and debris have been removed from job site and public right of way.

SIGNED: *J. Kenney Jr.* Contractor

BY: Kenney Mobile Homes - Pres. Agent or Owner
J. Kenney Jr.

PLANNING DEPT.: *[Signature]* Date: 5-13-77

PUBLIC WORKS DEPT.: *[Signature]* Date: 5-16-77

BUILDING DIVISION: *[Signature]* Date: 5/17/77

PERMIT NO.: 2767 PERMIT FEE \$ 10700

154-01-220

RECEIPT

1313 \$107.00 - 8

CITY OF LAS VEGAS
DEPT. OF BUILDING & SAFETY
MUST BE MACHINE VALIDATED

20 MAY 77

Y. Gatewood 9-27-79

CITY OF LAS VEGAS, NEVADA
DEPARTMENT OF BUILDING & SAFETY - AIR CONDITIONING APPLICATION & PERMIT

ADDRESS OF CONSTRUCTION: 3813 Lighthouse

OWNER'S NAME: JOHN E. KENNEY, JR.

CIRCLE: Addition; Remodel; ~~RENOVATE~~ TYPE OF BLDG.: ~~RES~~ APT. COMM. PUBLIC

CONTRACTOR'S NAME: TROPIC-AIRE CONDITIONING CO. STATE LICENSE # 10426A CITY LICENSE # 03382

UNITS	DESCRIPTION	FEE	TOTAL	UNITS	DESCRIPTION	FEE	TOTAL
	Unit heater - floor, wall or suspended	7.00					
	FOR EACH FORCED-AIR OR GRAVITY-TYPE FURNACE OR BURNER INCLUDING DUCTS AND VENT ATTACHED TO SUCH APPLIANCES:				EVAPORATIVE COOLERS:		
	Up to and including 100,000 B.t.u.'s	4.00			5 outlets or under	3.00	
	Over 100,000 B.t.u.'s	6.00			Over 5 and up to and including 10	5.00	
	FOR EACH HEATING APPLICATION, REFRIGERATION UNIT, COMFORT COOLING AND HEATING UNIT, ABSORPTION UNIT, COMPRESSOR OR BOILER:				Each additional outlet over 10	.25	
1-3	Up to and including 3 ton or horsepower, or absorption system up to and including 100,000 B.t.u.'s	4.00	4.00		VENTILATION:		
	Over 3 ton or 3 horsepower up to and including 10, or absorption system over 100,000 B.t.u.'s up to and including 250,000 B.t.u.'s	7.00			For each fan connected to a single duct	1.00	
	Over 10 ton or 10 horsepower up to and including 30, or absorption system over 250,000 B.t.u.'s up to and including 1,000,000 B.t.u.'s	12.00			For each commercial or industrial ventilation system	5.00	
	Over 30 ton or 30 horsepower up to and including 50, or absorption system over 1,000,000 B.t.u.'s up to and including 1,700,000 B.t.u.'s	20.00			For each commercial kitchen hood	5.00	
	Over 50 ton or 50 horsepower, or absorption system over 1,700,000 B.t.u.'s	30.00			MISCELLANEOUS:		
	FOR EACH AIR HANDLING UNIT INCLUDING DUCTS ATTACHED THERETO:				For each water cooling tower	8.00	
	Up to and including 10,000 CFM	2.00			Duct work only - each opening	.25	
	Over 10,000 CFM	4.00			For installation or relocation of each commercial or industrial incinerator	15.00	
					Gas piping related to the air cond. work in single family dwelling only	3.00	
					For each appliance, piece of equipment, any mechanical work or alteration or replacement not included in this schedule, the permit fee shall be computed the same as building permit fees by using the cost of installation for the valuation amount.		
					FOR THE ISSUANCE OF EACH PERMIT		3.00
					TOTAL PERMIT FEE \$	7.00	

I hereby certify that I have carefully examined and read the above application; that the same is true and correct; and that the work herein described is to be done in accordance with all the provisions of the applicable Ordinances of the City of Las Vegas, Nevada and the State Laws, whether herein specified or not.

Approval for the work under this permit will be given only after refuse and debris have been removed from job site and public right of way.

SIGNED: *William P. Williams* Date: 6-7-77
Air Conditioning Contractor - Owner

BUILDING DEPARTMENT: *WJ* Date: 7-6-77

PERMIT NO. 911 PERMIT FEE \$ 700

154-01-224

RECEIPT
3899 \$007.00 - 4
CITY OF LAS VEGAS
DEPT. OF BUILDING & SAFETY
MUST BE MACHINE VALIDATED
76 JUL 77

J. Gatewood 9-27-79

CITY OF LAS VEGAS, NEVADA

DEPARTMENT OF PUBLIC SERVICES—ELECTRICAL APPLICATION & PERMIT
DIVISION OF BUILDING AND SAFETY

ADDRESS OF CONSTRUCTION: 3813 Lighthouse OWNER'S NAME: KENNEY MOBILE HOMES, INC.

CIRCLE: New Bldg. Add'n.; Remodel; TYPE OF BLDG.: SFD. APT. PUBLIC COMM.

CONTRACTOR'S NAME: ANDERSON ELECTRIC STATE LICENSE # 10997 CITY LICENSE # 090-2-00350

NUMBER	FIXTURE OR INSTALLATION	UNIT PRICE	TOTAL
	Rm addition, carport or garage enclosure	4.00	
	Temporary power	4.00	
43	Light, receptacle or switch outlet	.20	9.00
	Wall or ceiling space heater	.35	
1	Garbage grinder outlet	.35	.35
1	Dishwasher outlet	.35	.35
	Clothes dryer outlet	.35	
	Automatic clothes washer	.35	
	Electric range outlet	.35	
	Electric water heater outlet	.35	
	Special purpose outlet	.35	
	X-ray unit and its appurtenances	5.00	
	Watts of festoon lighting (Watts) First 3,000 watts for each additional thousand watts	4.00 .150	
	Horsepower each motor first horsepower or less for each additional horsepower	1.75 .35	
1	Electric service (including any single meter socket) for each additional socket	3.00 .35	3.00
1	Air conditioning service	1.50	1.50
	Each KW(KVA) Generator (Transformer, Welder) First 100 KVA for each additional KW(KVA)	2.00 .01	
1	Speaker, signal or alarm outlet	.15	.15
	Amplifiers	.50	
	Control panels	.25	
	Main control racks	1.00	
	T.V. and radio antennas-master system only	.75	
	Minimum fee for any permit	4.00	
	TOTAL FEE		14.35

Approval for the work under this permit will be given only after refuse and debris have been removed from jobsite and public right of way.

I hereby certify that I have carefully examined and read the above application; that the same is true and correct; and that the work herein described is to be done in accordance with all the provisions of the applicable Ordinances of the City of Las Vegas, Nevada and State laws whether herein specified or not.

SIGNED: [Signature] DATE: 7/22/77
 MASTER (ELECTRICIAN) (TECHNICIAN) (OWNER) 485

BUILDING DIVISION: [Signature] DATE: _____

PERMIT NO.: 3086 PERMIT FEE: \$ 14.35

RECEIPT

4336 \$014.35 - 6

CITY OF LAS VEGAS
 DEPT. OF
 BUILDING & SAFETY
 MUST BE MACHINE VALIDATED

13 JUL 77

J. Gatuwood 9-27-79

2A-09

CITY OF LAS VEGAS, NEVADA

LOG NO. & AREA _____ CONST. VAL. \$ 210.00
DEPARTMENT OF BUILDING & SAFETY APPLICATION & BUILDING PERMIT — for: Fence, Wall, Retaining Wall

ADDRESS OF CONSTRUCTION: 3813 Lighthouse OWNER: Jack Kenny

LOT(s): 3 BLOCK: A SUBDIVISION: Park Bonanza - 6B ZONE: R-1

Materials of Construction: Block Concrete Wire Wood Other Yes No

ARCHITECT: _____ ENGINEER: _____ PLANS: CALCS:

CONTRACTOR: THE TIBERTI COMPANY STATE LICENSE # 4632E CITY LICENSE # 1128

TOTAL SQUARE FEET: _____ TOTAL LINEAL FEET: 70

Remarks:

CONDITIONS OF THE PERMIT:

1. Any type of retaining wall must be engineered by a Civil or Structural Engineer.
2. If a home owner takes out the Building Permit and if the owner sublets the work to a Contractor, then the Contractor must take out the permit and pay for it.
3. No fence or wall can be built on City property or rights-of-way, but this is not intended to preclude construction within utility easements if utilities will not be damaged or made inaccessible.
4. The fence or wall shall not enclose any water meter, light standard, or fire alarm box and shall not come closer than 24" from the nearest fire hydrant outlet.
5. Department inspectors must approve footings before concrete is poured and block wall reinforcing before grouting is done.
6. Maximum height of any wall or fence is 6', side and rear yards: 4' maximum in-front yard with the vertical surface above the height of .2' — 50% open.
7. I must not obstruct required onsite parking space (2 spaces for each dwelling unit) by the erection of this fence or wall.
8. By the signing of this application I herewith agree to the requirements outlined above.

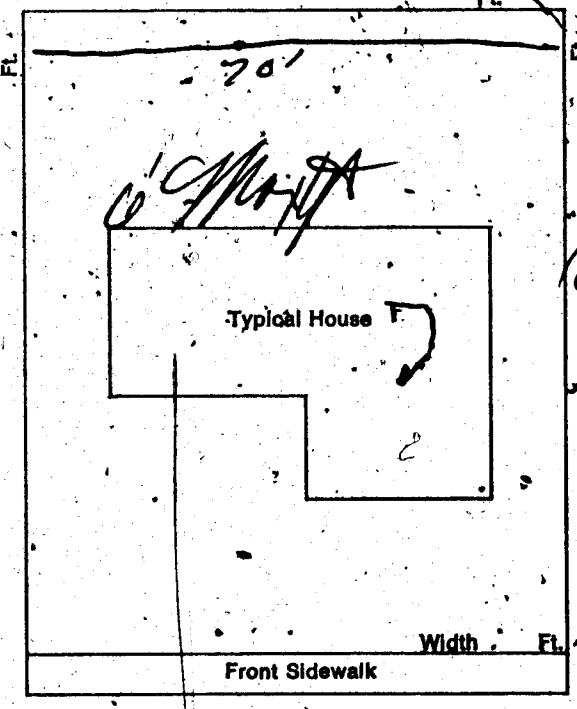

THE TIBERTI COMPANY

SIGNED: [Signature] DATE: 9-28-77
CONTRACTOR AGENT

PLANNING DEPT: [Signature] Date: 9-30-77

PUBLIC WORKS DEPT: [Signature] Date: 9-30

BUILDING DEPT: [Signature] Date: 9-30

#12850 PERMIT NO. 202 PERMIT FEE \$ 5.00

1 JOB \$.00
MINUTES 8.00

STAMP: CITY - LAS VEGAS BLDG & SAFETY 10/03/77

MUST BE MACHINE VALIDATED

J. Haterwood 9-27-79

CITY OF LAS VEGAS, NEVADA

DEPARTMENT OF PUBLIC SERVICES—APPLICATION AND PERMIT FOR PLUMBING
DIVISION OF BUILDING AND SAFETY

ADDRESS OF CONSTRUCTION: 3813 Lighthouse Ave. OWNER'S NAME: Jack Kenney Jr.

CIRCLE: New Bldg.; Add'n.; Remodel; TYPE OF BLDG.: SFD. APT. PUBLIC COMM.

CONTRACTOR'S NAME: Henderson Plumbing Co. STATE LICENSE # 10547 CITY LICENSE # c11-7511

UNITS	DESCRIPTION	FEE	TOTAL
1	Bathub	1.00	1.00
1	Shower	1.00	1.00
2	Lavatory	1.00	2.00
2	Toilet	1.00	2.00
	Urinal	1.00	
	Floor Drain	1.00	
	Floor Sink	1.00	
	Wash Tray	1.00	
1	Sink	1.00	1.00
1	Garbage Disposal	1.00	1.00
	Garbage Disposal (comm.)	3.00	
	Clothes Dryer (gas)	1.00	
1	Clothes Washer	1.00	1.00
	Clothes Washer (comm.)	5.00	
	Dishwasher	1.00	
	Dishwasher (commercial)	5.00	
	Dental Unit	10.00	
	Drinking Fountain	1.00	
	Any Water Using Equipment	1.00	
1	Water Heater (gas) (elect.)	1.00	1.00
1	Sewer System—New, Replacement, or any Drainage System	4.00	4.00
	Grease or Sand Trap	2.00	
	Trailer Trap	2.00	
	Septic Disposal System	4.00	
WATER SOFTENERS			
	Nonpermanent Type	4.00	
	Permanent Type (connected to Drainage)	5.00	
SWIMMING POOLS			
	Private or Wading Pool	10.00	
	Public or Semi-public	20.00	

UNITS	DESCRIPTION	FEE	TOTAL
WATER DISTRIBUTION SYSTEM			
1	Single Family Dwelling	4.00	4.00
	Multiple Family Dwelling plus each unit	4.00	
	Commercial Bldg. per floor	2.00	
	Hotel or Motel plus each bath	6.00	
	Trailer Park plus each space	4.00	
	Irrigation	1.50	
		20.00	
		1.00	
		4.00	
GAS PIPING SYSTEM			
1	Single Family Dwelling	3.00	3.00
	Multiple Family Dwelling plus each unit	6.00	
	Commercial Bldg. per floor plus each unit	3.00	
	Gas Appliance (any type)	3.00	
		1.00	
AUTOMATIC FIRE EXTINGUISHING SYSTEM			
	Underground Piping	10.00	
	Distribution Piping ea. ft.	.01	
	Sprinkler Head each	.10	
	In Range Hood and Vent	5.00	
DRY STANDPIPE SYSTEM			
	Piping	50.00	
	Each Outlet	1.00	
WET STANDPIPE SYSTEM			
	Piping	5.00	
	Fire Hose Cabinet	1.00	
	MINIMUM PERMIT FEE	4.00	
PIPELINE CONTRACTOR, SECT. 14-B.P.F. \$			
TOTAL PERMIT FEE \$ 21.00			

I hereby certify that I have carefully examined and read the above application; that the same is true and correct; and that the work herein described is to be done in accordance with all the provisions of the applicable Ordinances of the City of Las Vegas, Nevada and the State Laws, whether herein specified or not.

Approval for the work under this permit will be given only after refuse and debris have been removed from job site and public right of way.

Signed: [Signature] Date: 10/27/77
Registered Master Plumber, Spec. Cont'r. or Owner

Building Division: [Signature] Date: 11-1-77

Permit No. 1088-1 Permit Fee \$ 21.00

154-01-222

RECEIPT

MUST BE MACHINE VALIDATED

Donna Grealy *P-2182*

DIVISION of BUILDING & SAFETY - CITY of LAS VEGAS, NEVADA

OWNER Kennedy Mobile Homes ADDRESS 3813 Lighthouse DATE 5-19-77
 GEN. CONT. Same TYPE OF STRUCTURE SFD
 PERMIT NO. 2767 LEGAL DESCRIPTION L 3 B A Park Bonanza East 6 B

BUILDING	MECHANICAL	ELECTRICAL
Investigation <u>X</u>	Plumbing Cont. <u>Henderson</u>	Temp. pole cont.
Location & Footing <u>BW 6-7-77</u>	Permit No. <u>1088-1</u> Date	Permit No. Date
Stair Wall <u>BW 6-9-77</u>	Heat & Vent. A/C Cont. <u>Tropic Air</u>	Inspection Date
Concrete Slab Floor <u>BW 6-16-77</u>	Permit No. <u>977</u> Date <u>7-6-77</u>	Electrical Cont. <u>Anderson</u>
Floor Framing	Sewer Cont. <u>J. Kennedy</u>	Permit No. <u>2021</u> Date
Fireplace Footing	Permit No. <u>1768</u> Date	Fixtures Cont.
Chimney Steel	Rough Soil <u>WEP 1-11-77</u>	Permit No. Date
Vert. Steel Reinf.	Rough Water <u>WEP 1-11-77</u>	Slab
Horiz. Steel Reinf.	Top-Out <u>WEP 7-15-77</u>	Rough <u>2B 7-18-77</u>
Roof Sheathing <u>BW 7-11-77</u>	Rough Gas	Final Rough
Framing <u>BW 7-18-77</u>	A/C Rough Duct <u>WEP 7-15-77</u>	Final Fixture
Backing for siding	Ref. Rough Piping	Final Electrical <u>2B 8-31-77</u>
Ext. Bath <u>BW 7-21-77</u>	Final Plumbing <u>WEP 8-31-77</u>	Temporary Service
Ext. Scratch	Final Gas <u>WEP 8-31-77</u>	MISCELLANEOUS
Ext. Brown <u>BW 8-12-77</u>	Final Air Cond. <u>WEP 8-31-77</u>	Grading & Drainage
Int. Lath	Final Refrig.	On-Site Parking Spaces App.
Int. Brown	Final Sewer <u>WEP 7-15-77</u>	Eng. Approval of
Drywall <u>BF 7-11-77</u>	Final Septic Tank	Off-Site Improvements
Insulation		
Final Building		
Appr. for Occu.		

INSPECTOR: BW 8-13-77 DATE _____
 APPROVED FOR OCCUPANCY & METER _____
 PLEASE NOTE REMARKS ON REVERSE SIDE 3813 Lighthouse LOG # _____ AREA # _____ T 11-2 76-114

DEPARTMENT OF BUILDING & SAFETY - CITY OF LAS VEGAS, NEVADA

OWNER Jack Kenny **INDEX CARD** 9-30-77

CONTRACTOR Tiberti Company **2020**

LOT _____ **BLOCK** _____

Fence (wire, wood, etc.) _____ **Masonry, rock, etc.)** _____

Location _____

Final Inspection _____

Retaining Wall (masonry) _____ **Retaining Wall (concrete)** _____

Location _____

Footing _____

Wall Steel 1st _____ **2d** _____ **3d** _____

Bond Beam 1st _____ **2d** _____ **3d** _____

Final Inspection _____

23.14 B ADDRESS _____